



TUALATIN CITY COUNCIL MEETING

MONDAY, MAY 11, 2020

JUANITA POHL CENTER
8513 SW TUALATIN ROAD
TUALATIN, OR 97062

Mayor Frank Bubenik
Council President Nancy Grimes
Councilor Paul Morrison Councilor Robert Kellogg
Councilor Bridget Brooks Councilor Maria Reyes
Councilor Valerie Pratt

Special Announcement Regarding the May 11, 2020 City Council Meeting

The Tualatin City Council meeting scheduled for Monday, May 11 will proceed at this time with several modifications:

To the extent possible, the public is encouraged to watch the meeting live on local cable channel 28, or on the City's website.

For those wishing to provide comment during the meeting, there is one opportunity on the agenda: Public Comment. Written statements may be sent in advance of the meeting to Deputy City Recorder Nicole Morris up until 4:30 pm on Monday, May 11. These statements will be included in the official meeting record, but not read during the meeting.

For those who would prefer to make verbal comment, there are two ways to do so. As always, public comment is limited to three minutes per person.

Phone: +1 669 900 6833

Meeting ID: 830 2878 6291

Link: <https://us02web.zoom.us/j/83028786291?pwd=by9LWmpETU9KVlJkSjhzeUtsY0JiQT09>

Questions? Please contact Assistant to the City Manager Megan George.

6:00 PM WORK SESSION

- 1. 6:00 p.m. (30 min) – Regional Land Use & Transportation Update.** Staff will give an overview of key land use and transportation projects for the quarter (Q1) in an effort to discuss opportunities for advocacy and coordination.
 - 2. 6:30 p.m. (30 min) – Council Meeting Agenda Review, Communications & Roundtable.** Council will review the agenda for the May 11th City Council meeting and brief the Council on issues of mutual interest.
-

7:00 P.M. CITY COUNCIL MEETING

Call to Order

Public Comment

This section of the agenda allows anyone to address the Council regarding any issue not on the agenda, or to request to have an item removed from the consent agenda. The duration for each individual speaking is limited to 3 minutes. Matters requiring further investigation or detailed answers will be referred to City staff for follow-up and report at a future meeting.

Consent Agenda

The Consent Agenda will be enacted with one vote. The Mayor will ask Councilors if there is anyone who wishes to remove any item from the Consent Agenda for discussion and consideration. If you wish to request an item to be removed from the consent agenda you should do so during the Citizen Comment section of the agenda.

1. Consideration of Approval of the Work Session and Regular Meeting Minutes of April 27, 2020
2. Consideration of **Resolution No. 5491-20** Authorizing the Purchase of Right-of-Way and Easements for the Construction of the Garden Corner Curves Project

Special Reports

1. Tualatin Moving Forward Quarterly Update
2. Annual Report of the Tualatin Historical Society
3. Annual Report of the Tualatin Park Advisory Committee

General Business

1. Consideration of **Resolution No. 5492-20** a Resolution Supporting the Washington County Public Safety Levy, Ballot Measure 34-296
2. Consideration of **Resolution No. 5493-12** Supporting the Washington County Supporting the Renewal of the Washington County Cooperative Library Services (WCCLS) Local Option Levy, Ballot Measure 34-297

Council Communications

Items Removed from Consent Agenda

Items removed from the Consent Agenda will be discussed individually at this time. The Mayor may impose a time limit on speakers addressing these issues.

Adjournment

Meeting materials, including agendas, packets, public hearing and public comment guidelines, and Mayor and Councilor bios are available at www.tualatinoregon.gov/council.

Tualatin City Council meets are broadcast live, and recorded, by Tualatin Valley Community Television (TVCTV) Government Access Programming. For more information, contact TVCTV at 503.629.8534 or visit www.tvctv.org/tualatin.

In compliance with the Americans with Disabilities Act, this meeting location is accessible to persons with disabilities. To request accommodations, please contact the City Manager's Office at 503.691.3011 36 hours in advance of the meeting.



City of Tualatin

CITY OF TUALATIN Staff Report

TO: Honorable Mayor and Members of the City Council
THROUGH: Aquilla Hurd-Ravich, AICP, Director of Community Development
FROM: Gareth Prior, AICP, Policy Analyst
DATE: May 11, 2020

SUBJECT:

Regional Land Use and Transportation Update: Quarter 1 (2020)

RECOMMENDATION:

Community Development staff will give an overview of key land use and transportation projects for the first quarter (Q1) of 2020 to discuss opportunities for advocacy and coordination.

EXECUTIVE SUMMARY:

The purpose of this update is to accomplish the following:

1. Highlight the top 2020 Q1 projects that are active in the decision-making or engagement process.
2. Discussion of Council, staff, and community coordination for input on these projects.
3. Provide a directory of projects going on within the county, region, and state that have an impact on Tualatin.

For Q1, staff deemed the following as top projects:

- **Oregon Department of Transportation's (ODOT) I-5 and I-205 Tolling Study:** *ODOT*
- **99W Corridor Study and Let's Get Moving 2020:** *Metro, ODOT, Tualatin, Tigard, Sherwood, King City, Durham, and Washington County*
- **Southwest Corridor Plan:** *TriMet and Metro*

Attached to this agenda is a description of the top projects and a list of active and less active projects. Staff will not provide a presentation on all of the projects, but will follow up on questions, contact speakers to come to Council, or bring forward these topics to a future work session for discussion.

FINANCIAL IMPLICATIONS:

None.

ATTACHMENTS:

- A. Transportation Policy and Funding Map
- B. Regional project tracking list for Q1 (2020)
- C. Presentation for May 11th City Council work session

I-5 and I-205 Tolling Study: *ODOT*

Q1 Top 3

Q1 Update

ODOT started the project in early 2020 by holding technical staff coordination meetings and briefings at county and regional public meetings. I-205 tolling study will start before I-5, and ODOT began a community survey to better understand driving patterns pre-COVID that will reopen this fall. They are currently accepting applications for people who would like to serve on the Equity and Mobility Committee (apply [here](#)). **ODOT staff will be presenting at the May 26 Council meeting.**

Metro has started by gathering research and has been coordinating through [TPAC](#) and [JPACT](#). Due to the feedback received, they are setting up a technical work group to review and provide input along the way.

At the May 11 Council meeting, staff would like to know what items or issues are important for Tualatin. What are concerns or opportunities should staff advocate for in meetings? Staff has generated the following list of items:

1. Fully account for the transportation, economic, and quality of life impacts from traffic diversion on local roads, especially in equity neighborhoods.
2. Fully account for the impact to Tualatin employees and employers.
3. Study increased transportation options from tolling revenue, especially for connectivity (new roads, trails, sidewalks, etc.) and increased transit service.

Description: ODOT will continue their process of studying tolling segments ([map](#)) on Interstate 5 and 205.

Impact to Tualatin: Direct impact to Tualatin residents and businesses traveling along the interstate or state highway system. Possible impact to roads with vehicles diverting from highways to avoid tolls.

Website ODOT: <https://www.oregon.gov/ODOT/Pages/VP-join-conversation.aspx>.

Contact ODOT: Mandy Putney, ODOT's Policy and Development Manager Region 1, at (503) 731-8356 or mandy.putney@odot.state.or.us.

Contact Tualatin: Garet Prior, Policy Analyst, at (503) 691-3020 or gprior@tualatin.gov

Highway 99W Corridor Study: *ODOT, Tualatin, Tigard, King City, Sherwood, Durham, Metro, and Washington County*

Q1 Top 3

Q1 Update

ODOT and their consultant, Nelson/Nygaard, are nearing the completion of an “initial look” at the cost and intent of a full corridor study.

Although the state legislature ended abruptly, \$1 million was recommended in HB 5204, also known as the “Christmas Tree” bill, to fund a 99W corridor study.

Through Metro’s Let’s Get Moving 2020 transportation measure, \$3.5 million is recommended to fund a 99W corridor study. The measure has yet to adjust for revenue, so 99W funding is not final. **Metro staff will be coming to the May 26 Council meeting to present an update on the transportation measure.**

Description: A corridor study could help prioritize and direct larger efforts to achieve transformational change to meet future equity, safety, congestion, and climate smart strategy needs. For example, Tualatin’s Transportation System Plan envisioned a park-and-ride facility along 99W that would collect commuters and shift them on to public transit, thus reducing congestion on internal roads.

Impact to Tualatin: Highway 99W dissects Tualatin’s northwest corner and serves as a gateway into our major employment areas. Safety and congestion are major needs for the corridor and Tualatin residents. Tualatin Moving Forward has begun to address these needs by filling in sidewalk gaps, but larger investment is necessary to meet community needs.

Website (project): <https://www.oregon.gov/odot/projects/pages/project-details.aspx?project=99WP>

Contact (project): Glen Bolen, ODOT, at Glen.A.BOLEN@odot.state.or.us or (503) 731 – 4753.

Contact (Tualatin): Aquilla Hurd-Ravich, Community Development Director, at (503) 691-3018 or ahurd-ravich@tualatin.gov.

Southwest Corridor: *TriMet*

Q1 Top 3

Q1 Update

There is still a \$93 million funding gap that the Steering Committee and project partners will have to solve through additional revenue or cuts to the project. The Conceptual Design Report (CDR), which explains the look, feel, and design of the project, is nearing completion of public engagement (website). Early takeaways from the community engagement report include:

- Bridgeport Transit Center Station was the favorite!
- Concerns about at-grade crossing at Upper Boones Ferry
- Park-and-ride spaces were polarizing; less in Portland, more at Bridgeport
- Feedback from Aging Task Force, open house, and online: maintain and expand bus access, more park-and-ride at Bridgeport, extend line or don't preclude with design, and glad to see Village Inn preserved

The publication of construction drawings describing the project's impact, called the Final Environmental Impact Statement (FEIS), has been pushed from spring to late summer.

In 2020, TriMet will need a letter of support from Tualatin to include with their federal funding application. This will be an opportunity to clarify how Tualatin items or issues are being addressed.

Description: An effort to establish a new 12-mile [TriMet MAX line](#) (light rail) between southwest Portland and Bridgeport Village in Tualatin (watch this excellent [video](#)). In addition to light rail, the plan includes roadway, bicycle and pedestrian projects, a strategy to promote equitable development in the corridor ([SWEDS](#)), and a shared investment strategy for transportation improvements that connect the corridor's communities to the proposed light rail line.

Impact to Tualatin: Major opportunities and challenges that come with new light rail. Bridgeport Transit Center is planned to serve not only locals, but as a regional hub for transportation connections.

Website (project): <https://trimet.org/swcorridor/>

Contact (project): Jennifer Koozer, Senior Community Affairs Manager at TriMet, at (503) 962-2116 or koozerj@trimet.org.

Website (Tualatin): <https://www.tualatinoregon.gov/communitydevelopment/southwest-corridor-plan>

Contact (Tualatin): Garet Prior, Policy Analyst, at (503) 691-3020 or gprior@tualatin.gov

BUILD grant for Basalt Creek parkway extended: *Washington County*

Active

Q1 Update: Washington County is applying for a federal BUILD grant to pay for the construction of Basalt Creek Parkway extended. In 2019, they applied and did not receive the grant. This is an annual grant application.

\$6 million for design and right-of-way acquisition has already been provided through the Federal Highway Administration and the Major Streets and Transportation Improvement Program (MSTIP 3e). The estimated total project cost is \$31 million.

Description: This project is intended for design of the Basalt Creek Parkway extension between Grahams Ferry and Boones Ferry roads. Basalt Creek Parkway will be a five lane arterial with bicycle and pedestrian facilities, drainage and street lighting. The project includes a bridge across Sealy Ditch and a new signalized intersection at Boones Ferry Road.

Impact to Tualatin: As identified in the transportation study for the Basalt Creek Concept Plan, the transportation connection between Grahams Ferry and Boones Ferry roads is needed for circulation and connectivity.

Website (project):

<https://www.co.washington.or.us/LUT/TransportationProjects/basaltcreekparkway.cfm>

Contact (project): Erin Wardell, Washington County, at 503-846-3876 or erin_wardell@co.washington.or.us.

Contact (Tualatin): Aquilla Hurd-Ravich, Community Development Director, at (503) 691-3018 or ahurd-ravich@tualatin.gov.

Shuttle expansion in Tualatin: *Ride Connection*

Q1 Update: Ride Connection received 69 responses to a community survey, as well as feedback at the Tualatin Library, Aging Task Force, Juanita Pohl Center, and through discussion with city staff. With the current restrictions, they are planning to conduct phone interviews and shuttle drivers. They are working on ways to contact employers and employees.

For expansion, they are in a holding pattern. Ridership on the Tualatin Shuttle is down about 70%. The major funding source for operation comes from the State Transportation Improvement Fund (STIF). Since STIF is generated through payroll tax, rising unemployment could have significant budget implications.

Description: Through HB 2017/Keep Oregon Moving Regional Coordination funding, Washington County in coordination with Ride Connection will be evaluating and funding expansion of the Tualatin Shuttle.

Impact to Tualatin: Identify specific investments or expansion areas for the Tualatin Shuttle.

Contact (project): John Whitman, Lead Service Planner, at (503) 290-3684 or jwhitman@rideconnection.com

Contact (Tualatin): Gareth Prior, Policy Analyst, at (503) 691-3020 or gprior@tualatin.gov



Shuttle study connecting Tualatin to West Linn and Oregon City: *Clackamas County*

Q1 Update: Clackamas County selected Kittleson & Associates to begin work on the project which includes multiple transit projects in the county. Due to time constraints, they began with Oregon City and Clackamas industrial shuttles. They are in the process to develop a public engagement plan for the shuttle study with Tualatin.

Description: Through HB 2017/Keep Oregon Moving Regional Coordination funding, Clackamas County will be hiring a consultant to lead a transit evaluation between Tualatin and Oregon City.

Impact to Tualatin: Identify specific investments and costs for a transit connection with West Linn and Oregon City.

Contact (project): Kristina Babcock, Clackamas County Transit Coordinator, at (971) 349-0481 or KBabcock@clackamas.us.

Contact (Tualatin): Gareth Prior, Policy Analyst, at (503) 691-3020 or gprior@tualatin.gov

Let's Get Moving 2020 transportation measure: *Metro*

Q1 Update: In April, Metro Council recommended \$3.5 million for funding a 99W corridor study as a Tier II corridor investment. The measure has yet to adjust for revenue, so 99W funding is not final.

Description: By early 2020, Metro Council will decide on whether or not to refer a multi-billion dollar transportation investment measure to voters on the November 2020 ballot.

Impact to Tualatin: If issued by Metro Council, Tualatin residents will have an opportunity to vote on a regional transportation funding measure. This funding would be necessary to build the Southwest Corridor light rail to Tualatin. It would come with additional taxes, but would establish a new source for transportation funding.

Website (project): <https://www.oregonmetro.gov/public-projects/2020-transportation-investment-measure>

Contact (project): Tyler Frisbee, Transportation Policy and Federal Affairs Manager at Metro, at (503) 797-1935 or Tyler.Frisbee@oregonmetro.gov.

Contact (Tualatin): Gareth Prior, Policy Analyst, at (503) 691-3020 or gprior@tualatin.gov

Regional mobility policy update: *Metro and ODOT*

Q1 Update: During 2020, Metro and ODOT staff will be preparing and analyzing mobility policy options to gain feedback for a final option in 2021.

Description: Metro and ODOT have been working to begin updating the Regional Mobility Policy, which sets standards for which transportation and land use development is measured or receives investment.

Impact to Tualatin: The existing mobility standards require Tualatin to have targets for reducing emissions and single-occupancy vehicles, along with levels of service are requirements. The mobility policy and new standards will have a major impact on Tualatin’s ability to develop or secure transportation funding.



Website (project): <https://www.oregonmetro.gov/public-projects/regional-mobility-policy-update>

Contact (project): Kim Ellis, Metro, Principal Transportation Planner, at (503) 797-1617 or kim.ellis@oregonmetro.gov.

Contact (Tualatin): Garet Prior, Policy Analyst, at (503) 691-3020 or gprior@tualatin.gov

Designing Livable Streets update: *Metro*

Q1 Update: Metro Council adopted the Designing Livable Streets and Trails guide in late December. This will serve as best practice and guidelines for Metro-funded transportation projects.

Description: Metro’s Designing Livable Streets and Trails Guide provides design guidance for regional streets and trails. The guidelines were developed to help implement the 2040 Growth Concept and the Regional Transportation Plan.

Impact to Tualatin: Design guidelines set by Metro could be used as requirements for regionally funded projects or through the regional functional transportation plan, which we are required to follow in our Transportation Systems Plan.

Website (project): <https://www.oregonmetro.gov/public-projects/updating-street-design-guidance>

Contact (project): Lake Strongheart McTighe, Senior Regional Planner, Metro, at (503) 797-1660 or lake.mctighe@oregonmetro.gov.

Contact (Tualatin): Mike McCarthy, Transportation Engineer, at (503) 691-3674 or mmccarthy@tualatin.gov.

Statewide Transportation Improvement Program (STIP) project list: *ODOT*

Q1 Update: Public comment was open for projects in the 2021-2024 and amendments to the 2018-2021 STIP. In Tualatin’s benefit, funding to replace the bridge travel surface and joints on the 99W Tualatin River bridge, northbound, was recently moved from the 2021-2024 STIP into the current period.

Description: ODOT’s capital improvement plan for all state and federally funded projects.

Impact to Tualatin: This is a funding source for transportation investment on state roads.

Website (project): <https://www.oregon.gov/ODOT/STIP/Pages/About.aspx>

Contact (project): Mandy Putney, ODOT Policy and Development Manager Region 1, at (503) 731-8356 or mandy.putney@odot.state.or.us.

Contact (Tualatin): Garet Prior, Policy Analyst, at (503) 691-3020 or gprior@tualatin.gov

Bus on Shoulder Study: *ODOT and TriMet*

Active

Q1 Update: Funding has been allocated through the Metropolitan Transportation Improvement Plan (MTIP) to complete a year-long study of the feasibility.

Description: TriMet and ODOT will study “freeway express service” using bus on shoulder. The primary goal of the project is to determine where the market is for express and limited stop service.

Impact to Tualatin: This could be a huge benefit to Tualatin to increase TriMet or SMART bus speed and reliability along existing routes, as well as open a path for new connections (e.g. Oregon City).

Website (project): None at this time.

Contact (project): Rory Renfro, ODOT’s Transit and Major Projects Principal Planner, at (503) 731-8245 or rory.j.renfor@odot.state.or.us and Tom Mills, TriMet’s Manager of Service Planning and Development, at millst@trimet.org.

Contact (Tualatin): Gareth Prior, Policy Analyst, at (503) 691-3020 or gprior@tualatin.gov

First-last mile transportation study: *Washington County*

Less Active

Description: The First and Last Mile study will provide information on how to improve connections between transit and commuter destinations. The project will result in recommendations for infrastructure investments and ideas on how to integrate mobility or new technology options. Tualatin's downtown WES station was selected as one of 10 finalist locations that will receive the full analysis.

Impact to Tualatin: Possible source for identifying transportation improvements to secure funding.

Website (project):

<https://www.co.washington.or.us/LUT/Divisions/LongRangePlanning/PlanningPrograms/TransportationPlanning/first-and-last-mile.cfm>

Contact (project): Dyami Valentine, Washington County Department of Land Use & Transportation Senior Planner, at (503) 846-3821 or dyami_valentine@co.washington.or.us.

Contact (Tualatin): Garet Prior, Policy Analyst, at (503) 691-3020 or gprior@tualatin.gov

Vehicle Registration Fee (VRF): *Clackamas County*

Description: The VRF established a new fund to increase safety, relieve congestion, and maintain local roads in Clackamas County.

Impact to Tualatin: Estimated \$58,741 in new revenue for road maintenance and transportation investment in Clackamas County.

Website (project): <https://www.clackamas.us/transportation/vrf>

Contact (project): Trent Wilson, Clackamas County Public & Government Affairs, at (503) 655-8206 or TWilson2@co.clackamas.or.us.

Contact (Tualatin): Garet Prior, Policy Analyst, at (503) 691-3020 or gprior@tualatin.gov

Statewide Transportation Improvement Fund (STIF): *TriMet and ODOT*

Description: Established by the HB2017/Keep Oregon Moving legislation, this is a new state fund for public transportation.

Impact to Tualatin: This is a possible funding source for transit investment. Although it is a state program, much of the allocation control is given to TriMet and then through the counties (Washington and Clackamas). Examples of investment are TriMet's Line 76 service increase and Ride Connection's shuttle expansion.

Website (ODOT project):

<https://www.oregon.gov/ODOT/RPTD/Pages/STIF.aspx>

Website (TriMet project):

<https://trimet.org/meetings/hb2017/index.htm>

Contact (project): Tom Mills, TriMet's Manager of Service Planning and Development, at millst@trimet.org.

Contact (Tualatin): Garet Prior, Policy Analyst, at (503) 691-3020 or gprior@tualatin.gov

Less Active

I-205 widening and Abernathy Bridge replacement: ODOT and Clackamas County

Description: ODOT's I-205 Widening and Seismic Improvements Project will add a third lane in each direction and upgrade the Abernathy Bridge and the eight other I-205 bridges in the project area to withstand a major earthquake. As of April 2020, funding has not been secured for construction.

Impact to Tualatin: In addition to the transportation benefits for Tualatin, elements of the Stafford area planning agreement are coordinated with I-205 widening completion.

Website (project): <http://www.i205corridor.org/>

Contact (project): Ellen Sweeney, ODOT Community Affairs Coordinator, at (503) 731-8230 or ellen.sweeney@odot.state.or.us.

Contact (Tualatin): Garet Prior, Policy Analyst, at (503) 691-3020 or gprior@tualatin.gov

Urban Reserves Transportation Study: Washington County

Description: Washington County is planning for the urban reserve areas by getting a better idea of existing and future transportation system needs. The project is expected to create an infrastructure finance plan template to use in concept and comprehensive planning.

Impact to Tualatin: Projections for transportation infrastructure costs for the following urban reserve areas ([see map](#)): Tonquin, I-5 East-Washington County, and Ellingsen Road North. These numbers could inform or guide future urban growth boundary expansion requests to Metro.

Website (project):

<https://www.co.washington.or.us/LUT/Divisions/LongRangePlanning/PlanningPrograms/TransportationPlanning/urban-reserves-transportation-study.cfm>

Contact (project): Jessica Pelz, Senior Planner Washington County Department of Land Use & Transportation, (503) 846-3960 or jessica_pelz@co.washington.or.us.

Contact (Tualatin): Steve Koper, AICP, Planning Manager, at (503) 691-3028 or skoper@tualatin.gov.

Road Standards Update: Washington County

Description: Washington County is updating their road design standards to better achieve community priorities and aspirations. The expected completion is summer of 2021.

Less Active

Impact to Tualatin: Key roads within Tualatin are owned and maintained by Washington County (Grahams Ferry, 124th, Tualatin-Sherwood, Lower Boones, and 65th). Standards for roads plays a key role in future planning and through development permitting.

Website (project):

<https://www.co.washington.or.us/LUT/Divisions/LongRangePlanning/PlanningPrograms/TransportationPlanning/road-design-standards.cfm>

Contact (project): Erin Wardell, Principal Planner, Washington County, at (503) 846-3876 or Erin_Wardell@co.washington.or.us.

Contact (Tualatin): Gareth Prior, Policy Analyst, at (503) 691-3020 or gprior@tualatin.gov.

TRANSPORTATION POLICY & FUNDING FRAMEWORK



**additional funding opportunities exist*



2020 Quarter 1 Regional Land Use and Transportation Update

Tualatin City Council
Work Session
5.11.2020





#WeAreTualatin



Purpose

1. Highlight top Q1 projects receiving public input
2. Discussion on coordinating Council, staff, and/or community input
3. Provide a directory of projects you may hear about at regional meetings

I-5 and I-205 Tolling Study

ODOT

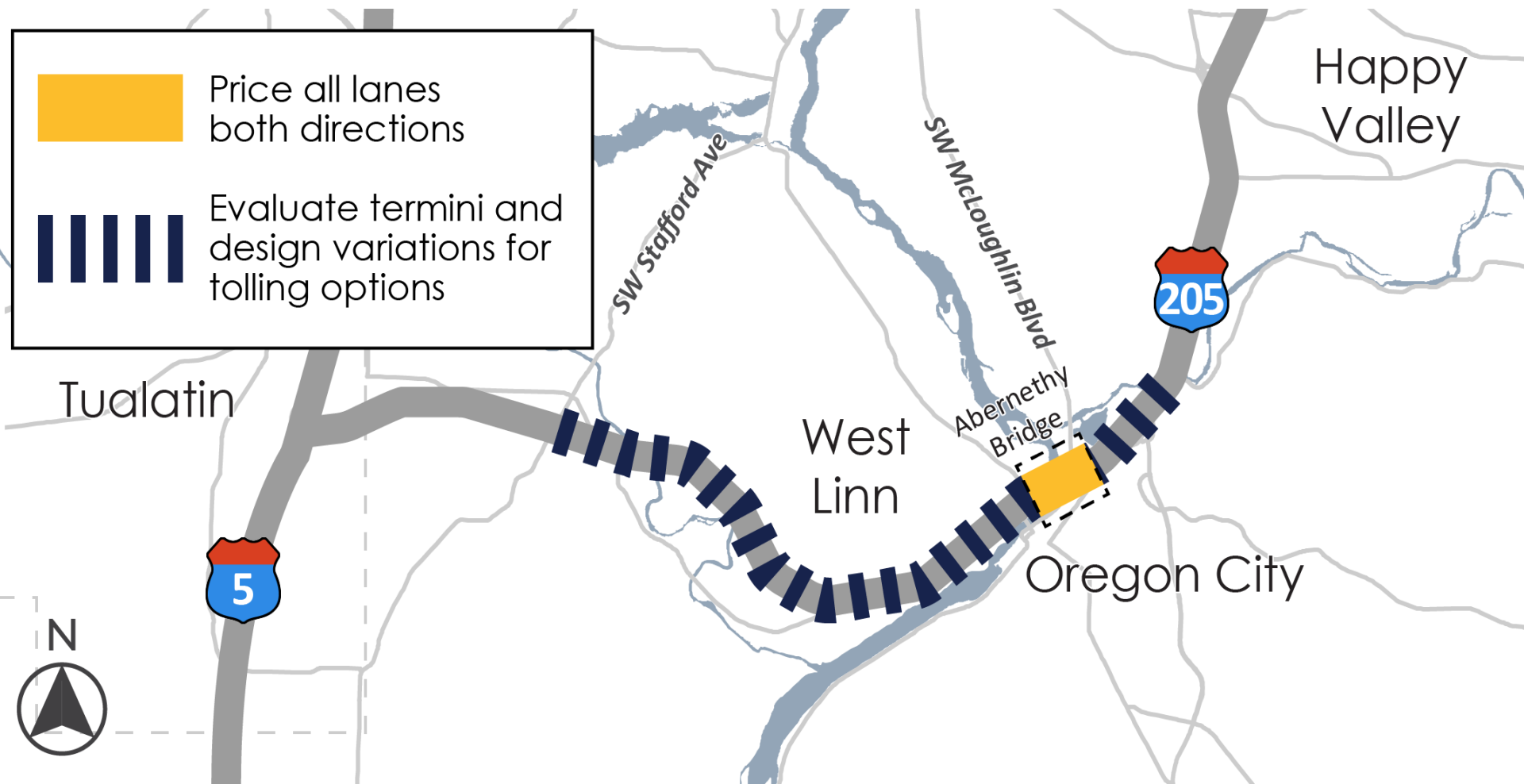

 Price all lanes both directions
 Evaluate termini and design variations for tolling options

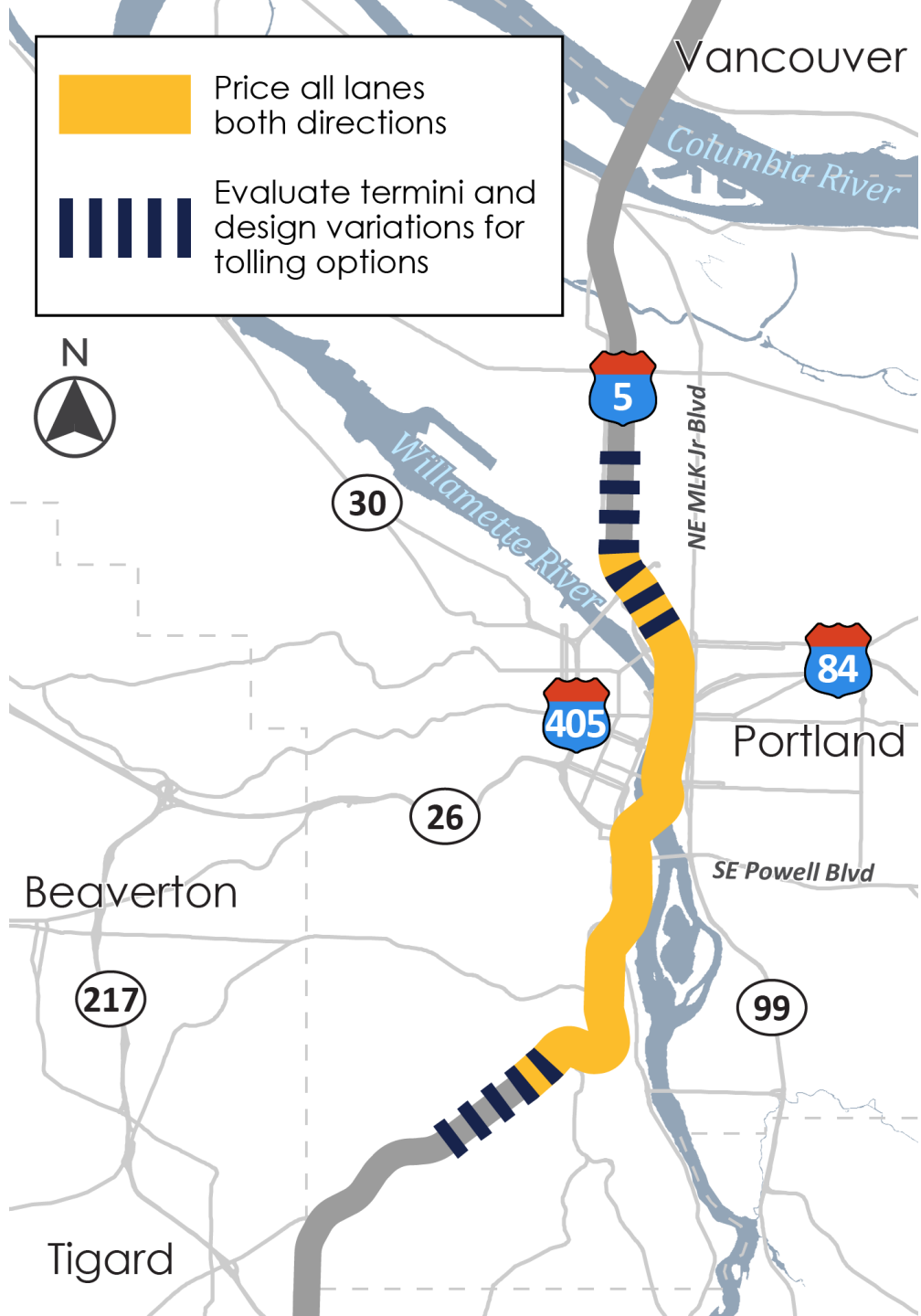

TRANSPORTATION POLICY & FUNDING FRAMEWORK



elected, appointed, or volunteer staff

policy or plans

funding

federal funding

**additional funding opportunities exist*

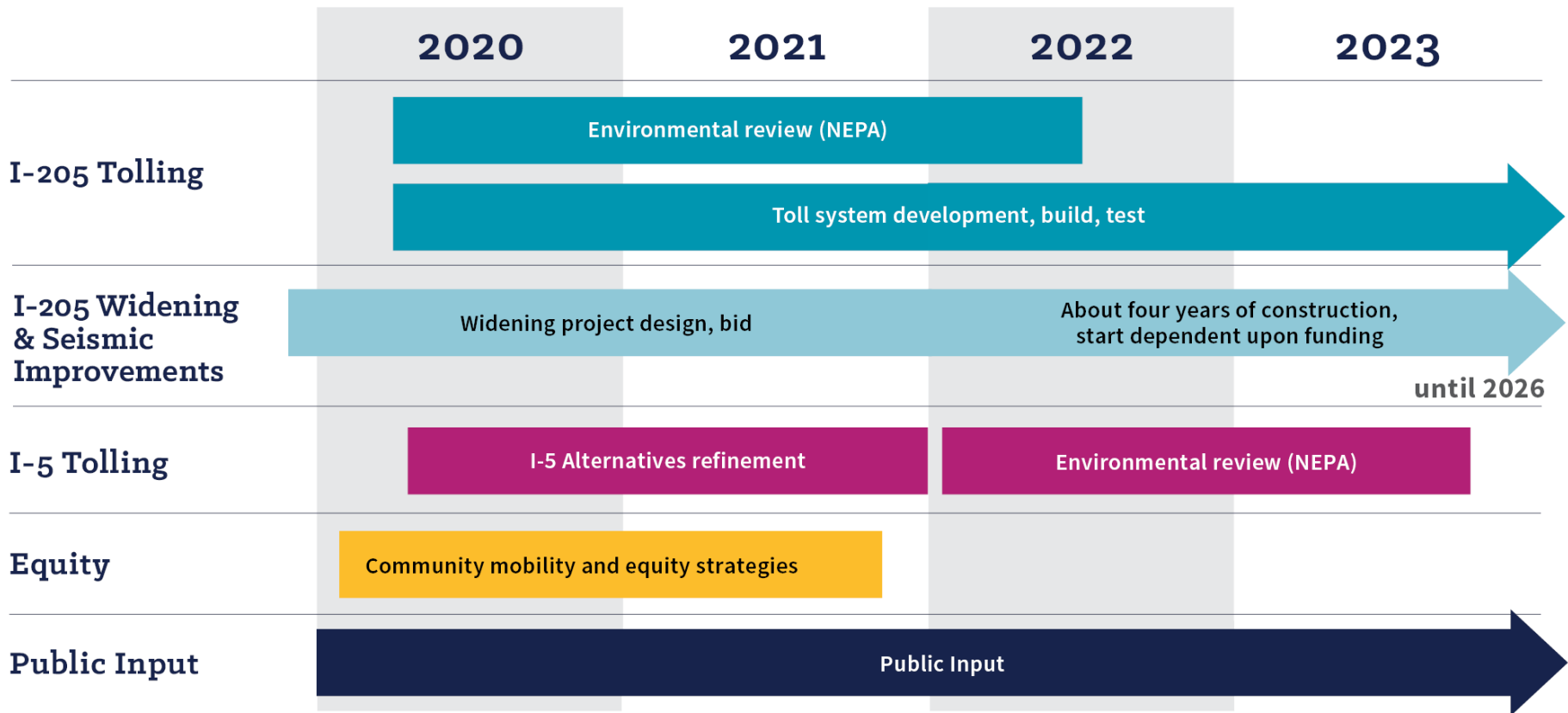

Important issues?

1. Transportation, economic, and quality of life impact from traffic diversion on local roads, especially in equity neighborhoods.
2. Impact to Tualatin employees and employers.
3. Transportation options from tolling revenue, especially for connectivity (new roads, trails, sidewalks, etc.) and increased transit service.

Questions, Comments, or Direction for Staff

1. Feedback on important issues
2. Equity committee and Region 1 ACT = public engagement
3. ODOT to present at Council on May 26
4. Tualatin staff on technical working groups:
Garet Prior and Mike McCarthy

Highway 99W

ODOT, Washington County, Tigard, Sherwood, King City, Durham, Tualatin, and Metro

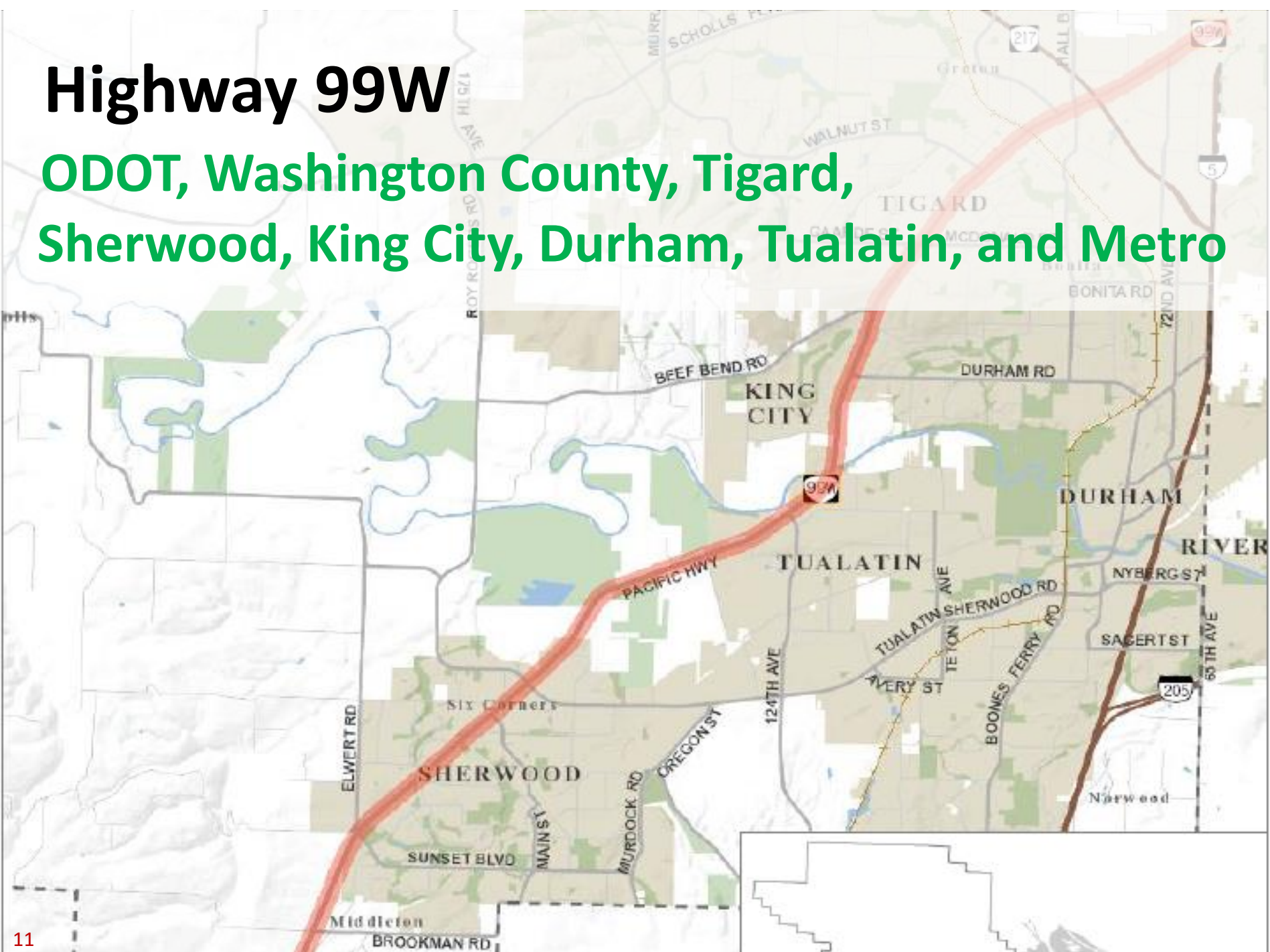

TRANSPORTATION POLICY & FUNDING FRAMEWORK



elected, appointed, or volunteer staff

policy or plans

funding

federal funding

**additional funding opportunities exist*

Update

- \$3.5M to fund study through Metro's November 2020 measure (not set, revenue check still needs to occur)
- ODOT's "Early Look" about complete
- \$1M in "Christmas Tree" bill, did not pass legislature, but an encouraging sign

Questions, Comments, or Direction for Staff

1. Metro to present to Council about November 2020 measure on May 26
2. Interest in findings from ODOT's "Early Look"?

Southwest Corridor Plan

TriMet



Bridgeport in Tualatin



TriMet MAX Line

TRANSPORTATION POLICY & FUNDING FRAMEWORK



elected, appointed, or volunteer
 staff
 policy or plans
 funding
 federal funding
 *additional funding opportunities exist

Garet Prior and Erin Engman
City of Tualatin (2019)

 **Trolley Trail**

TRAIL RULES:

-  Yield to pedestrians.
-  Keep animals under control. Keep pets on a leash and waste must be removed.
-  Keep the trail clean.
-  Stop at intersections and obey all traffic laws.
-  Keep right and pass on the left.
-  Motorized vehicles are prohibited.
-  Please be respectful of neighbors.

In an emergency dial 911

Milwaukee Police Dept.
Non-Emergency Dispatch
503-746-7500

Trail Contact
503-744-9830

NCPED.com
NCTAD 06B-07-2004



CDR

Conceptual Design Report

How well does the station serve the community?

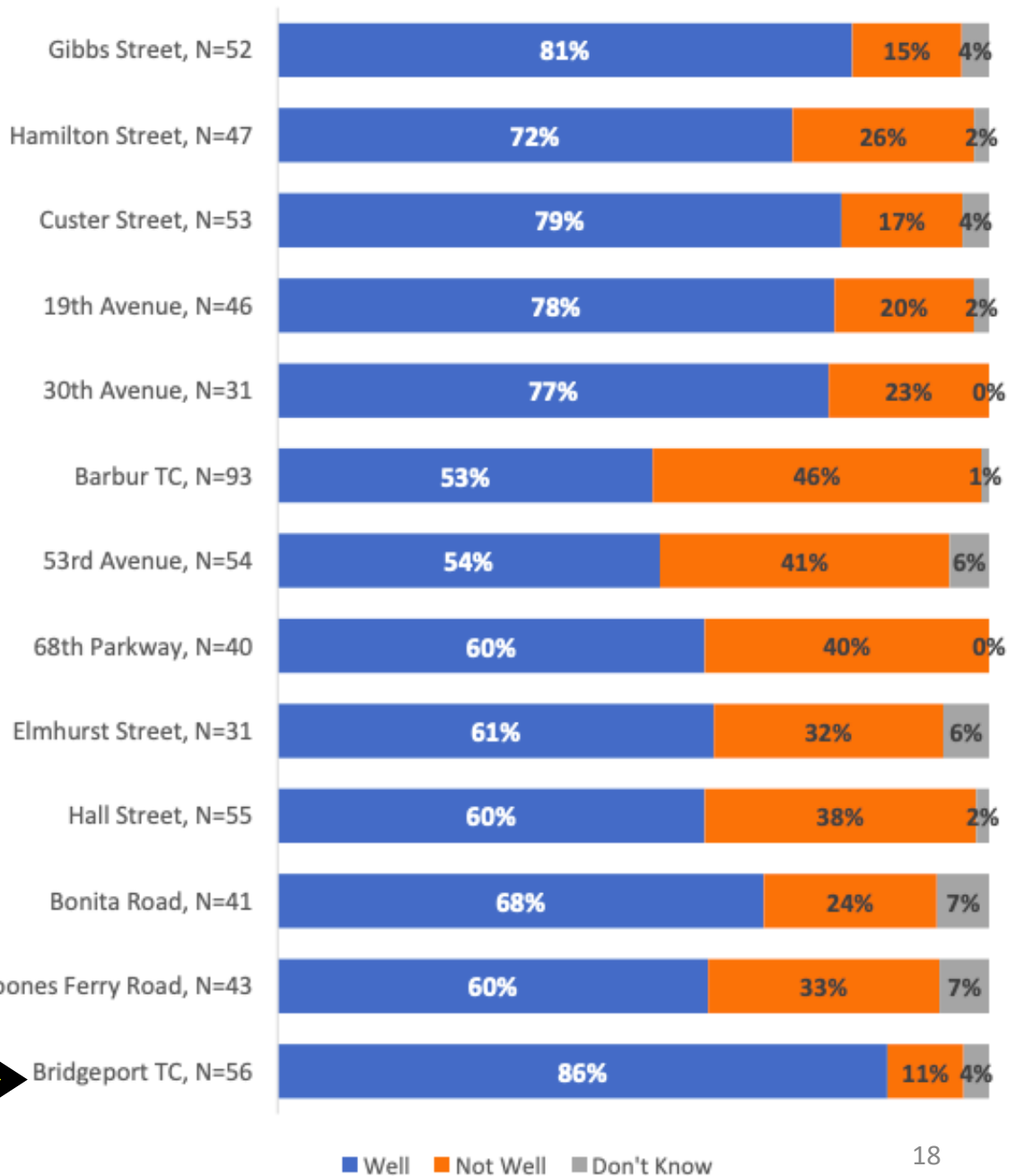

Tualatin is #1!

Location-Specific Park & Ride Comments

When sorted by station, the Park & Ride options were less polarized, and the majority of station-specific Park & Ride comments were about Barbur Transit Center.

	Comments for <u>more</u> Park & Ride	Comments for <u>less</u> Park & Ride
Barbur Transit Center	24	7
53rd Avenue Station	0	8
68th Avenue Station	2	6
Hall Boulevard Station	6	5
Bridgeport Transit Center	8	1

Feedback

- Bridgeport Transit Center Station was the favorite!
- Concerns about at-grade crossing at Upper Boones Ferry
- Park-and-ride spaces were polarizing; less in Portland, more at Bridgeport

Aging Task Force, Tualatin ES open house, and online

- Maintain and expand bus access
- More park-and-ride at Bridgeport
- Extend line or don't preclude with design
- Glad to see Village Inn preserved

There were 56 ratings received related to Bridgeport Transit Center.

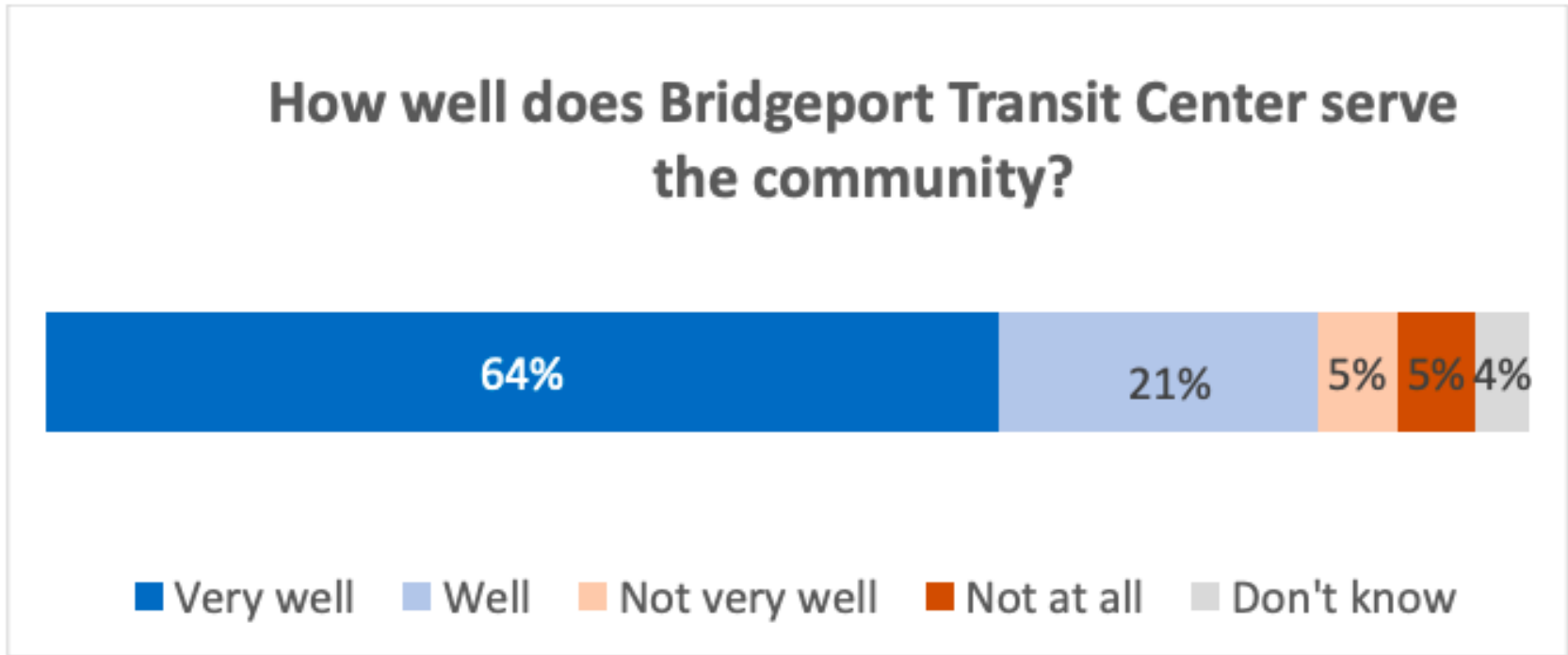

Comments

There were 47 comments received specifically about Bridgeport Transit Center. Common themes include:

- Add more Park & Ride stalls (8 comments)
- Excitement that Village Inn is being retained (4 comments)
- Extend this line and/or design in a way that doesn't prelude extension (4 comments)

Creative/notable comments:

- Add fun lighting to the station that could serve as an icon and be seen from the freeway



FEIS

Final Environment Impact Statement

Questions, Comments, or Direction for Staff

1. In 2020, TriMet will be looking for a letter of support from Tualatin as a part of their federal application. Council feedback on important items or issues?
2. Thoughts about community feedback from CDR

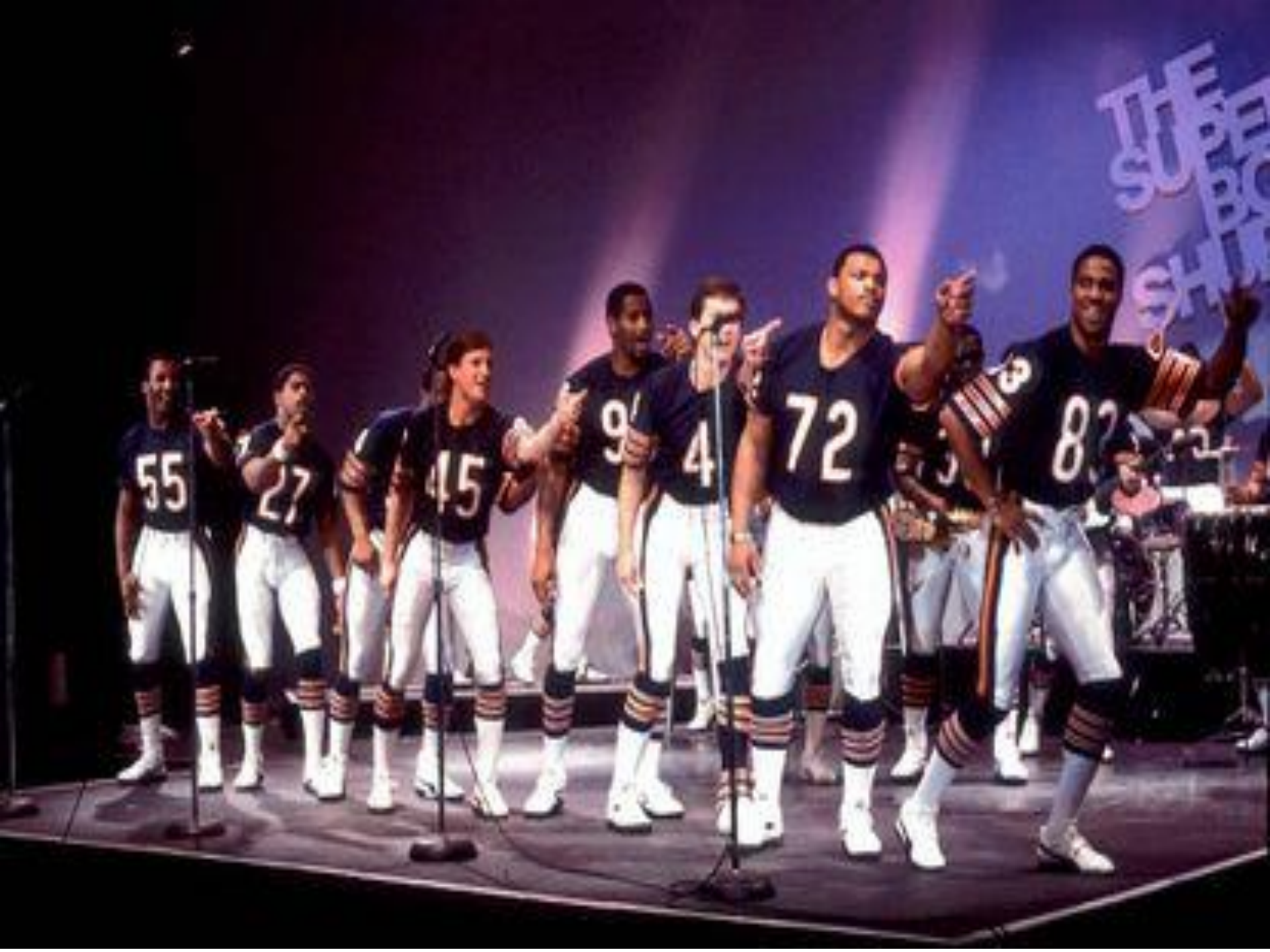

Other

- Good news! ODOT's STIP shuffle moved funding for 99W Tualatin River bridge, northbound, from 2021-24 to 2018-21
- Projects in the *active* or *less active* list you want to hear about in the future?

Contact Us!

Aquilla Hurd-Ravich, AICP

Community Development Director

(503) 691-3018

ahurd-ravich@tualatin.gov

Garet Prior, AICP

Policy Analyst

(503) 691-3020

gprior@tualatin.gov



City of Tualatin

CITY OF TUALATIN
Staff Report

TO: Honorable Mayor and Members of the City Council
THROUGH: Sherilyn Lombos, City Manager
FROM: Nicole Morris, Deputy City Recorder
DATE: May 11, 2020

SUBJECT:
Consideration of Approval of the Work Session and Regular Meeting Minutes of April 27, 2020

RECOMMENDATION:
Staff respectfully recommends the Council adopt the attached minutes.

ATTACHMENTS:

- City Council Work Session Meeting Minutes of April 27, 2020
- City Council Regular Meeting Minutes of April 27, 2020



OFFICIAL MINUTES OF THE TUALATIN CITY COUNCIL WORK SESSION FOR APRIL 27, 2020

Present: Mayor Frank Bubenik, Council President Nancy Grimes, Councilor Bridget Brooks, Councilor Robert Kellogg, Councilor Paul Morrison, Councilor Maria Reyes, Councilor Valerie Pratt

Mayor Bubenik called the meeting to order at 6:31 p.m.

1. Tualatin 2040 Work Plan.

Community Development Director Aquilla Hurd-Ravich presented the Tualatin 2040 work plan. She recapped what has been accomplished including both analysis and the priorities. The work plan for the remainder of the project will span 2020-2021 and consist of three main pieces: comprehensive plan update, development code update, and community engagement. The comprehensive plan update will remove it from the development code and update chapters to reflect the housing needs analysis. The development code update will include regulations that reflect the policies of the comprehensive plan.

Director Hurd-Ravich stated the comprehensive plan will have several goals: to separate the comprehensive plan from the development code, add photos and graphics, update the introduction to make the plan more relatable and usable, and to incorporate the housing element to encourage a diversity of housing types in Tualatin. The timeline for team creation and kick off is Spring/Summer 2020, public outreach in Summer/Fall 2020, and plan adoption in the Spring/Summer 2021.

Director Hurd-Ravich stated the development code update is to make it consistent with the comprehensive plan updates to comply with HB 2001. The timeline includes completion of a DLCDC grant for technical assistant in November 2020, team creation and kick-off in early 2021, public outreach in Summer/Fall 2021, and code adoption in June 2022.

Director Hurd-Ravich stated the community engagement plan includes heavily involving the community. Staff will be providing updates to the Planning Commission and City Council, establishing a web presence, going to where the people are, and committing to diversity, equity, and inclusion. Director Hurd-Ravich stated the next update to Council on the work plan will come in July.

Councilor Pratt asked about diversity of housing types and when they will get added into the development code. Director Hurd-Ravich stated it will be part of the development code update and done through a plan text amendment.

Councilor Morrison asked about the possibility of extending the deadline so public outreach can be conducted most effectively. Director Hurd-Ravich stated legislation would most likely have to be changed in order for an extension to be granted.

Councilor Kellogg asked if the DLCDC grant had been allocated for and if the city budget appropriately in case it was not received. Director Hurd-Ravich stated they have already been allocated and the city budgeted for both.

Councilor Kellogg asked if there was a timeline for further substantive updates in relation to the comprehensive plan. Director Hurd-Ravich stated the main focus for this update is housing.

Council President Grimes suggested community outreach and soliciting input from active developers in other communities that can be applied to Tualatin.

Mayor Bubenik asked if staff is confident with the timeline with the current state of the city. Director Hurd-Ravich stated she believes the timeline is still valid. She noted she will be having further discussions with staff on community engagement.

Mayor Bubenik asked about the separation of the development code and zoning code. Director Hurd-Ravich stated it is part of this phase.

Mayor Bubenik adjourned the meeting at 7:03 p.m.

Adjournment

Sherilyn Lombos, City Manager

_____ / Nicole Morris, Recording Secretary

_____ / Frank Bubenik, Mayor



OFFICIAL MINUTES OF THE TUALATIN CITY COUNCIL MEETING FOR APRIL 27, 2020

Present: Mayor Frank Bubenik, Council President Nancy Grimes, Councilor Bridget Brooks, Councilor Robert Kellogg, Councilor Paul Morrison, Councilor Maria Reyes, Councilor Valerie Pratt

7:00 P.M. CITY COUNCIL MEETING

Call to Order

Mayor Bubenik called the meeting to order at 7:04 p.m.

Announcements

1. Proclamation Declaring May 10-16, 2020 as National Police Week in the City of Tualatin

Councilor Brooks read the proclamation declaring May 10-16, 2020 as National Police Week in the City of Tualatin.

2. Proclamation Declaring the Week of May 3 – May 9, 2020 as Public Service Recognition Week

Council President Grimes read the proclamation declaring the week of May 3-9, 2020 as Public Service Recognition week in the City of Tualatin.

Mayor Bubenik thanked city staff for all their hard work and dedication.

Public Comment

Tualatin Chamber of Commerce Director Linda Moholt spoke about the Gift Card for Good program. She stated the program has raised \$3,660.

Consent Agenda

Motion to adopt the consent agenda made by Councilor Kellogg, Seconded by Councilor Morrison. Voting Yea: Mayor Bubenik, Council President Grimes, Councilor Brooks, Councilor Kellogg, Councilor Morrison, Councilor Reyes, Councilor Pratt
MOTION PASSED

1. Consideration of Approval of the Regular Meeting Minutes of April 27, 2020

Public Hearings - Quasi-Judicial

1. Consideration of **Ordinance No. 1432-20** Requesting the Annexation of Approximately 1.2 acres of Public Right-of-Way Identified as SW 120th Ave on Tax Map 2S127C into the City of Tualatin; Withdrawing the Territory from the Washington County Enhanced Sheriff Patrol District; and Annexing Territory into the Boundary of Clean Water Services (File No. ANN 20-0001)

Mayor Bubenik opened the hearing for consideration of annexing approximately 1.2 acres of public right-of-way identified as SW 120th Ave on tax map 2S127C into the City of Tualatin;

withdrawing the territory from the Washington County Enhanced Sheriff Patrol District; and annexing territory into the boundary of Clean Water Services. He read the rules of the hearing in accordance with ORS 197.763(5) and (6) and ORS 197.796(3)(b).

Assistant Planner Tabitha Boschetti presented ANN 20-0001 Right of Way (ROW) Annexation for SW 120th Ave (SW 119th). She stated the proposal is to annex public ROW at SW 120th Ave. The ROW is owned by Washington County and would be transferred to the City. She noted the new road will be called SW 119th Ave. Planner Boschetti stated the proposed annexation complies with all applicable criteria and staff recommends approval.

City Engineer Kim McMillian stated the City partnered with the County so the Majestic could build the road. She added the city wanted to be in charge of the permitting and inspections so this could happen quickly.

PUBLIC COMMENT

None.

COUNCIL DISCUSSION

None.

Motion for first reading by title only made by Councilor Kellogg, Seconded by Councilor Morrison.

Voting Yea: Mayor Bubenik, Council President Grimes, Councilor Brooks, Councilor Kellogg, Councilor Morrison, Councilor Reyes, Councilor Pratt

MOTION PASSED

Motion for second reading by title only made by Councilor Kellogg, Seconded by Councilor Pratt.

Voting Yea: Mayor Bubenik, Council President Grimes, Councilor Brooks, Councilor Kellogg, Councilor Morrison, Councilor Reyes, Councilor Pratt

MOTION PASSED

Motion to adopt Ordinance No. 1432-20 requesting the annexation of approximately 1.2 acres of public right-of-way identified as SW 120th Ave on tax map 2S127C into the City of Tualatin; withdrawing the territory from the Washington County Enhanced Sheriff Patrol District; and annexing territory into the boundary of Clean Water Services (File No. ANN 20-0001) made by Councilor Kellogg, Seconded by Councilor Reyes.

Voting Yea: Mayor Bubenik, Council President Grimes, Councilor Brooks, Councilor Kellogg, Councilor Morrison, Councilor Reyes, Councilor Pratt

MOTION PASSED

Council Communications

Councilor Brooks asked if the changes had been made to the council rules. Attorney Brady stated there has been no update as the adopted changes don't go into effect for thirty days.

Councilor Brooks reiterated appreciation for city staff and the police department during this time. She stated many committee meetings have been cancelled and she looks forward to them resuming. She noted she has been staying up to date on the pandemic so she can make the best choices possible for the good of the public.

Councilor Kellogg thanked Jonathon Taylor for his work on the Economic Stabilization Program. He congratulated the winners of the Volunteer Service Awards. Councilor Kellogg encouraged citizens to wear masks in public.

Councilor Pratt thanked city staff for their efforts during this time. She stated the Tualatin Community Garden is thriving and they will continue to donate thousands of pounds of food to the Tualatin Food Pantry. Councilor Pratt added going forward it will be important for the city to work with other communities on soft openings moving forward.

Councilor Reyes thanked the community for coming together during this time of crisis. She stated she attended a Town Hall hosted by the Governor on plans on how the state will be reopened.

Councilor Morrison has been participating in zoom meetings including the C4 meeting where they discussed Metro's Homeless Policy.

Councilor Morrison encouraged the Council to increase the city's nonprofit grant program funding for the fiscal year.

Council President Grimes thanked city staff for their continued efforts.

Mayor Bubenik stated the Mayors and County Chairs continue to meet to discuss what is going on in relation to the crisis. He stated he attended the Westside Economic Alliance meeting, Metro Mayors Consortium meeting, attend the Governor's Town Hall, and the Washington County Chair and Mayors meeting.

Mayor Bubenik adjourned the meeting at 8:07 p.m.

Adjournment

Sherilyn Lombos, City Manager

_____ / Nicole Morris, Recording Secretary

_____ / Frank Bubenik, Mayor



City of Tualatin

CITY OF TUALATIN Staff Report

TO: Honorable Mayor and Members of the City Council

THROUGH: Sherilyn Lombos, City Manager

FROM: Mike McCarthy, PE, Principal Transportation Engineer
Jeff Fuchs, PE, Public Works Director

DATE: May 11, 2020

SUBJECT:

Consideration of **Resolution No. 5491-20** Authorizing the Purchase of Right-of-Way and easements for the construction of the Garden Corner Curves project, part of the Tualatin Moving Forward Bond Program.

RECOMMENDATION:

Staff recommends that the Council approve the attached resolution to purchase right-of-way and easements for the Garden Corner Curves project.

EXECUTIVE SUMMARY:

This resolution enables the City Manager to execute legal documents to acquire the property needed to construct and maintain the Garden Corner Curves project.

The majority of the project will be constructed within existing right-of-way. However, some additional right of way and easements are need along both sides of the roadway.

During the conceptual design phase, the project team evaluated multiple configurations to reduce the project footprint in order to reduce right of way impacts, avoid structures, minimize creek and wetland impacts, and reduce project costs while still meeting transportation requirements. The property we are proposing to purchase allows us to meet the goals established during conceptual design by moving the roadway slightly to the north and west to provide space for the shared use path along the east side of the roadway.

Four properties are affected. The City's offering prices were based on appraisal performed by BBG, Inc. and recommendations from Universal Field Services, Inc. and they have been agreed to by each of the property owners. Acquisitions on each property are as follows (note that offer amounts are rounded):

Karsseboom (Garden Corner Nursery)

- Property is located on the south side of Blake St and east side of 108th Ave, and includes a residence and the Garden Corner Nursery.
- Owners: Jonn C. Karsseboom and Tracy L. Bigej-Karsseboom

- The City is purchasing public right-of-way (435 sq ft), a public utility easement (4,185 sq ft) and a temporary construction easement (8,733 sq ft)
- **Acquisition amount \$55,200**, which includes \$21,284 for right-of-way, \$23,436 for public utility easement, and \$10,480 for temporary construction easement.

Helenius/Hall Tax Lot 1300; 10665 SW Blake St

- Property is located on the north side of Blake St and includes a residence
- Owners: Betty A. Helenius, Beverly J. Hall, and Larry E. Helenius
- The City is purchasing public right-of-way (3,606 sq ft), public utility easement (7,934 sq ft), temporary construction easement (16,052 sq ft, including area for temporary contractor storage), and slope easement (3,658 sq ft).
- **Acquisition amount \$57,500**, which includes \$29,257 for right-of-way, \$6,347 for public utility easement, \$2,634 for slope easement, and \$19,262 for temporary construction easement

Helenius/Hall Tax Lot 1400; 21215 SW 105th Ave

- Property is located on the west side of 105th extending to the north side of Blake St and includes a residence, vacant land, and portions of Hedges Creek
- Owners: Betty A. Helenius, Beverly J. Hall, and Larry E. Helenius
- The City is purchasing public right-of-way (1,051 sq ft), public utility easement (10,372 sq ft), slope easement (7,252 sq ft), and stormwater easement (7,236 sq ft).
- **Acquisition amount \$63,292**, which includes \$8,408 for right-of-way, \$8,298 for public utility easement, \$5,222 for slope easement, and \$41,364 for stormwater easement.

Thomson Property; 10630 SW Blake St

- Property is located on the south side of Blake St and includes a residence
- Owners: Robert Kevin Thomson and Tana M. Thomson
- The City is purchasing public utility easement (360 sq ft), and temporary construction easement (3,477 sq ft).
- **Acquisition amount \$1,410**, which includes \$576 for 360 sq ft public utility easement and \$834 for temporary construction easement.

OUTCOMES OF DECISION:

Approval of the attached resolution would allow staff to purchase right-of-way and easements for the Garden Corner Curves project.

ALTERNATIVES TO RECOMMENDATION:

Council could elect to not approve the attached resolution, which would make the project unconstructible in its current configuration.

FINANCIAL IMPLICATIONS:

The total cost of property and easement acquisition is \$177,402. This is included in the total project budget in the Transportation Project Fund (Tualatin Moving Forward bond program).

ATTACHMENTS:

Resolution No. 5491-20

Exhibits showing areas to be acquired on each property

RESOLUTION NO. 5491-20

A RESOLUTION AUTHORIZING THE CITY MANAGER TO EXECUTE DEEDS
ACQUIRING PROPERTY FOR THE GARDEN CORNER CURVES
TRANSPORTATION PROJECT

WHEREAS, the Garden Corner Curves Project is a transportation project funded through the Tualatin Moving Forward bond program;

WHEREAS, the City has identified the need to acquire certain properties in order to facilitate the construction of the Garden Corner Curves project; and

WHEREAS, the City has negotiated property transactions with willing sellers to acquire right-of-way, public utility easements, storm, water, slope, sidewalk, access easements, and temporary construction easements.

NOW THEREFORE, BE IT RESOLVED BY THE CITY COUNCIL OF THE CITY OF TUALATIN, OREGON, that:

Section 1. The City Manager is authorized to acquire and execute deeds for the following properties:

- A. Tax Lot 2S127DD00200 - Karsseboom Property
 - Right-of-Way for \$21,284.00
 - Public Utility Easement for \$23,436.00
 - Temporary Construction Easement for \$10,480.00

- B. Tax Lot 2S127DD00120 – Thomson Property
 - Temporary Construction Easement for \$834.00
 - Public Utility Easement for \$576.00

- C. Tax Lot 2S127DD01300 – Helenius Property
 - Right-of-Way for \$29,257.00
 - Public Utility Easement - North for \$5,577.00
 - Public Utility Easement - South for \$770.00
 - Storm, Water, Slope, Sidewalk, and Access Easement for \$2,634.00
 - Temporary Construction Easement for \$14,533.00
 - Temporary Construction Easement for \$4,729.00

- D. Tax Lot 2S127DD01300 – Helenius Property
 - Right-of-Way for \$8,408.00
 - Public Utility Easement for \$5,802.00
 - Public Utility Easement for \$2,496.00
 - Storm, Water, Slope, Sidewalk, and Access Easement for \$5,222.00
 - Storm, Water, Slope, Sidewalk, and Access Easement for \$41,364.00

Section 2. The City Manager is hereby authorized to execute any and all documents necessary to acquire property and property interests identified in Section 1.

Section 3. This resolution is effective upon adoption.

INTRODUCED and ADOPTED by the City Council this 11th day of May, 2020.

CITY OF TUALATIN, OREGON

BY _____
Mayor

APPROVED AS TO FORM

ATTEST:

BY _____
City Attorney

BY _____
City Recorder





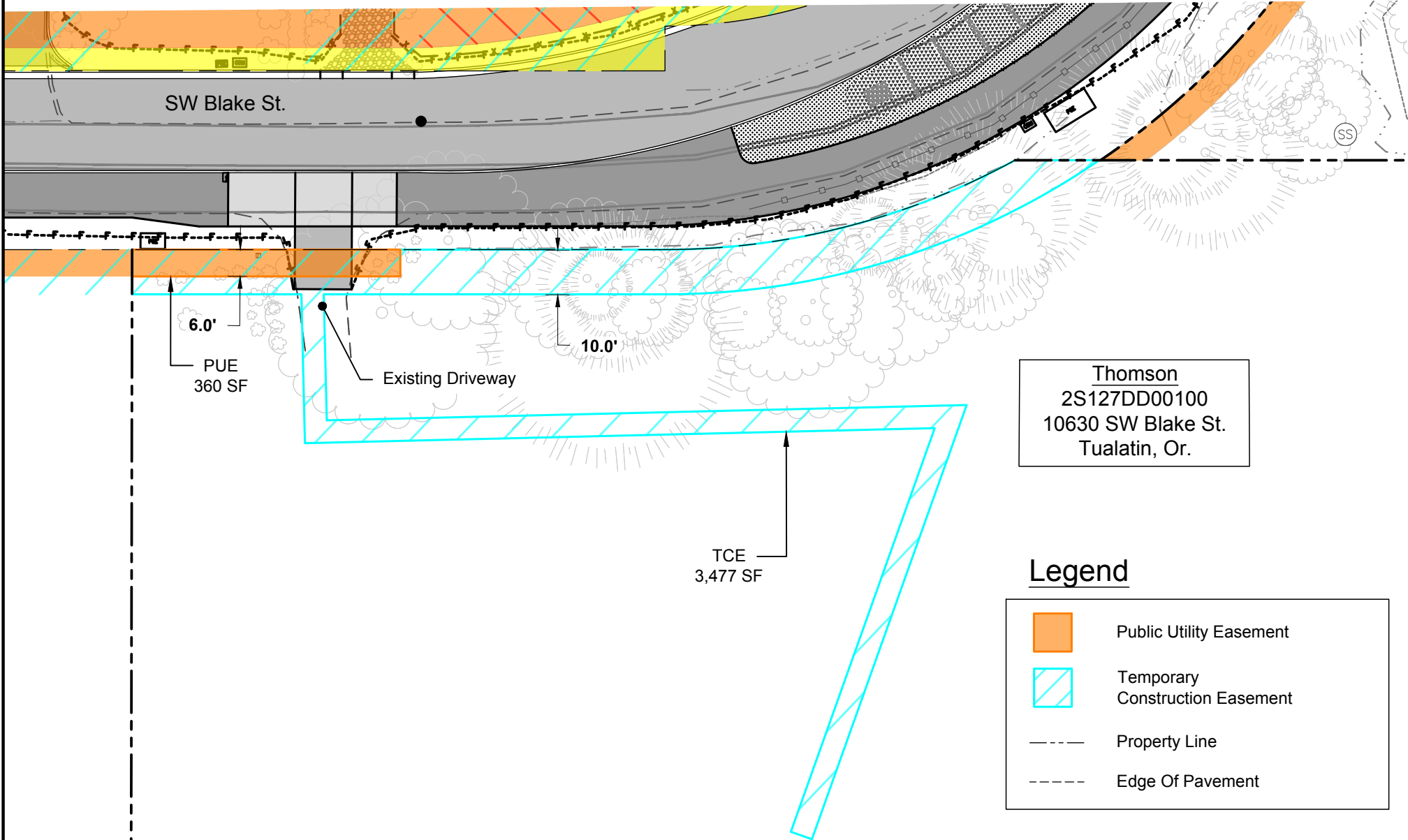

0 30 60
SCALE IN FEET

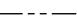

Thomson
2S127DD00100
10630 SW Blake St.
Tualatin, Or.

Legend





-  Public Utility Easement
-  Temporary Construction Easement
-  Property Line
-  Edge Of Pavement

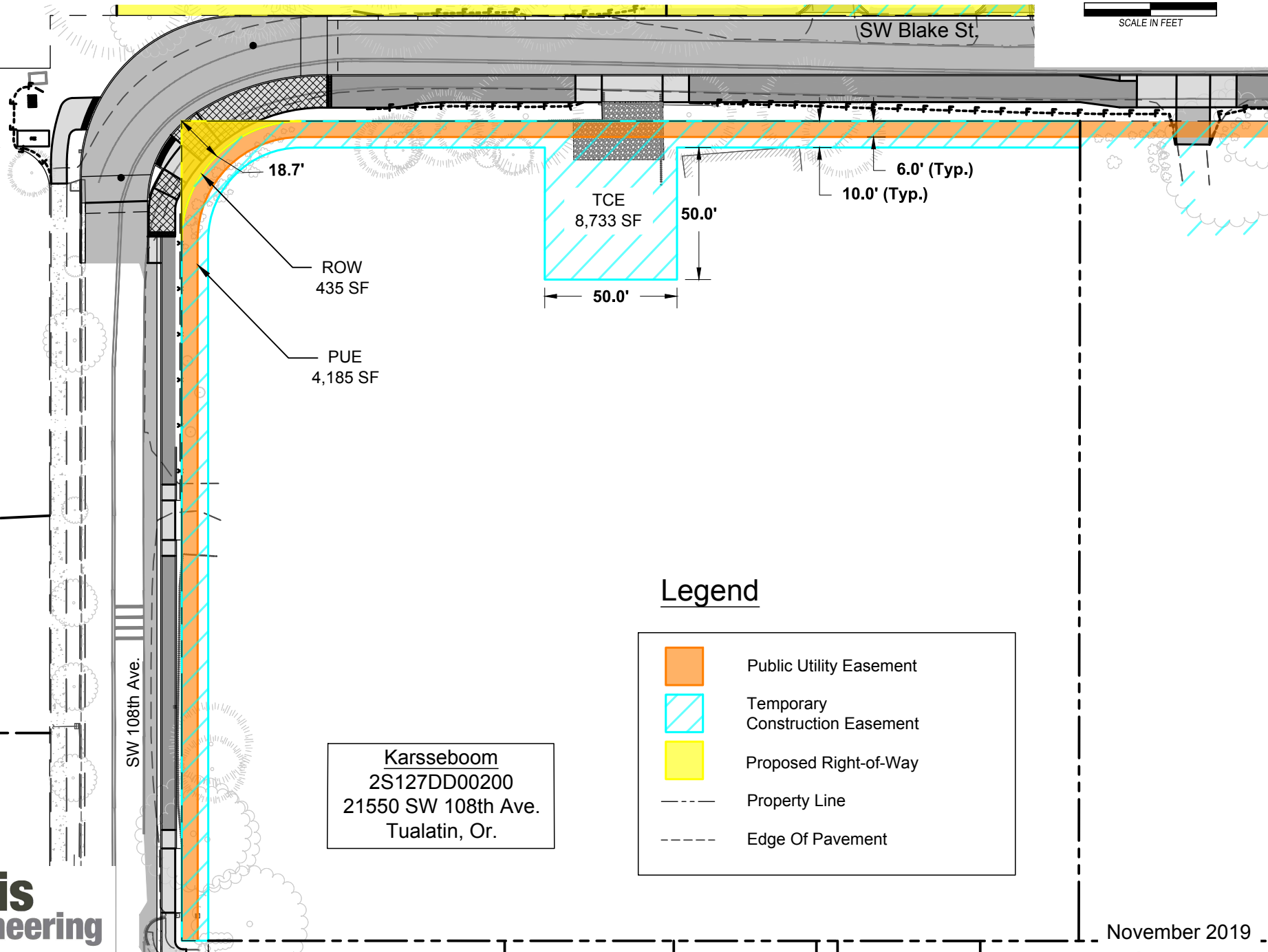

0 50 100
SCALE IN FEET

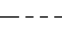
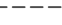

Legend

-  Proposed Right-of-Way
-  Public Utility Easement (PUE)
-  Slope Easement (SE)
-  Proposed Stormwater Easement (PSWE)
-  Property Line
-  Edge Of Pavement

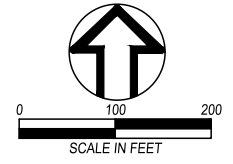

Helenius
 2S127D001400
 21215 SW 105th Ave.
 Tualatin, Or.

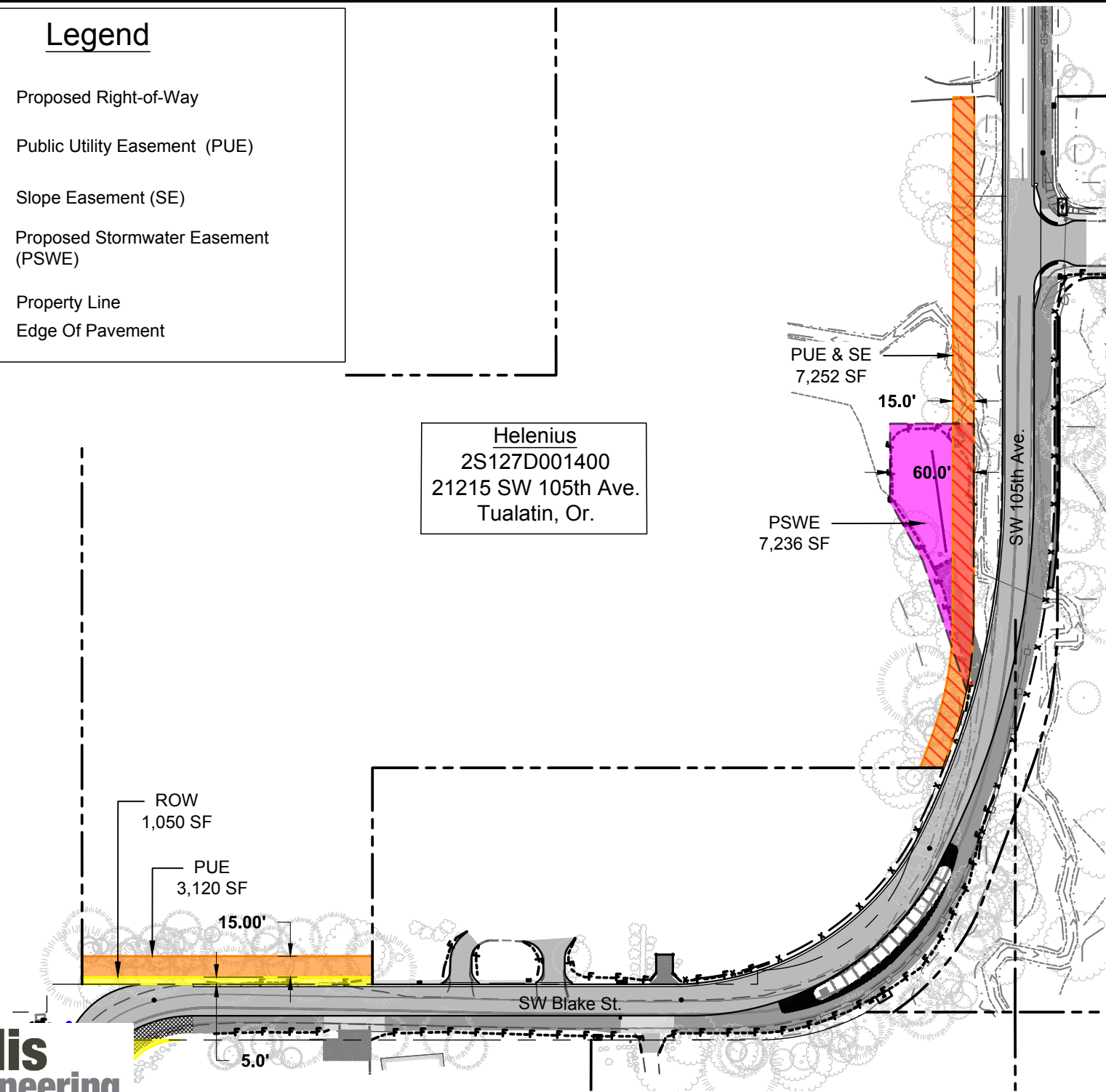







P:\141470A_Garden_Corner_Curves\Imp_P1600_DWG\505 Exhibit\Right of way\RIGHT OF WAY ACQUISITION.dwg, 3/31/2020 1:02:08 PM, David Brokaw



March 2020

Legend

-  Temporary Construction Easement
-  Slope Easement
-  Right-of-Way
-  Public Utility Easement
-  Property Line
-  Edge Of Pavement

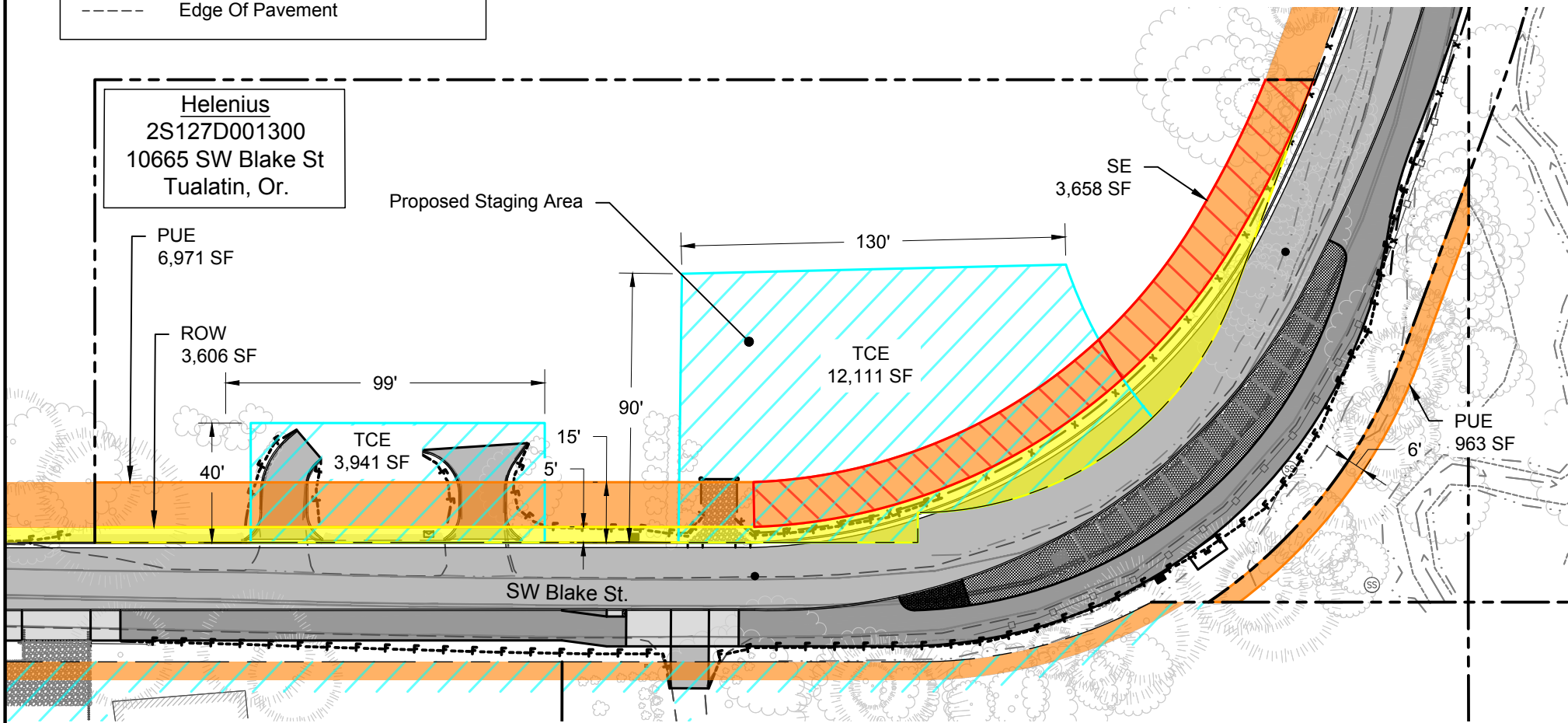
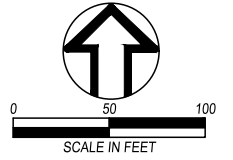

P:\141470A_Garden_Corner_Curves\Imp_P\600_DWG\505_Excelsior\Right of Way\RIGHT OF WAY ACQUISITION.dwg, 12/4/2019 11:02:20 AM, David Bicklaw



City of Tualatin

CITY OF TUALATIN Staff Report

TO: Honorable Mayor and Members of the City Council

THROUGH: Sherilyn Lombos, City Manager

FROM: Jeff Fuchs, PE, Public Works Director
Megan George, Assistant to the City Manager

DATE: May 11, 2020

SUBJECT: Tualatin Moving Forward Quarterly Update

EXECUTIVE SUMMARY:

This quarterly update will provide you with a summary of construction projects planned for this summer, a summary of on-going design and planning work, an update on the overall program schedule and budget, updates on priority projects, and information about upcoming work.

In May 2018, Tualatin voters approved a \$20 million bond measure to pay for projects that improve traffic flow, neighborhood safety, and provide safe access to schools and parks citywide. Five projects are already built, nine will be constructed this summer, and five more are in planning and design. The Tualatin Moving Forward Bond Team is committed to providing the City Council with quarterly updates in alignment with the agreed-upon communication goals to:

- Be fully transparent and commit to communicating at every stage;
- Continue to engage the community in the designing and planning the projects;
- Use multiple channels to communicate with diverse audiences; and
- Demonstrate progress and build confidence with the community using score cards, quarterly reports, project signage, and other tools.

Current activity on the program

Despite COVID-19 disruptions, the bond team is not slowing down. We are meeting virtually using Zoom and other virtual meeting platforms, we are continuing to finalize plans for construction this summer, and we are designing and planning work for the next wave of construction projects. We are also developing outreach plans for each project using appropriate tools that help everyone stay safe and allow us to get much needed public input on the projects.

Design, construction, and planning work

This summer we will start constructing nine projects listed below. You can see project descriptions for each on the program website: www.tualatinmovingforward.com.

- Garden Corner Curves
- Boones Ferry at Tualatin High School
- Grahams Ferry at Dogwood Street
- Mohawk: East of Martinazzi at PGE
- 90th and Sweek Drive
- Borland Rd: Bridgeport Elementary to 60th
- Martinazzi: Avery to Dakota
- Tualatin Road and 112th
- Nasoma Lane: Near Marquis

We are also continuing to work on design and planning for five projects. Descriptions and maps for these projects are also available on the Tualatin Moving Forward website.

- Martinazzi and Sagert Street
- Tualatin-Sherwood Road: Martinazzi to I-5
- Highway 99W: Pony Ridge to 124th Avenue
- 95th Avenue and Avery Street
- Nyberg Lane: 50th to 65th Avenue

And we are starting design on two more projects and soliciting project suggestions for the Neighborhood Traffic Safety program.

- Boones Ferry Road: Warm Springs to south City limits
- 65th Avenue at the Hospital
- The next round of Neighborhood Traffic Safety Projects

Overall program schedule and budget

Exhibit A is a three-page summary of the overall program schedule and budget. The first page shows projects that have been completed. The second page shows projects we are currently working on. And, the third page shows projects planned for the coming years. This schedule/budget summary document will continue to evolve as we complete projects, move projects from our future list to our current list, and add projects to the program for the Neighborhood Traffic Safety Program.

We are still projected to finish the bond program within the total budget of \$20-million and we are expecting to complete the program in 2023.

Updated program report card

Exhibit B is the Program Report Card that we have shared with you at each quarterly update. The report card shows how we are doing – what we are working on and how much each project is estimated to cost at the nearest milestone. Once we receive bids from contractors, we will update the report card to reflect the actual bid amount for each project.

The report card and other internal tools help us make sure we are staying on track with our project budgets so we can stay within budget through the end of the program. As we notice trends or identify potential issues, we can course correct early to deliver the program we promised for the budget we have available.

ATTACHMENTS:

- Exhibit A: Overall Program Schedule and Budget
- Exhibit B: Tualatin Moving Forward Report Card



TUALATIN MOVING FORWARD BOND PROGRAM
OVERALL PROGRAM/PROJECT SCHEDULE

PHASES: PLANNING DESIGN CONSTRUCTION

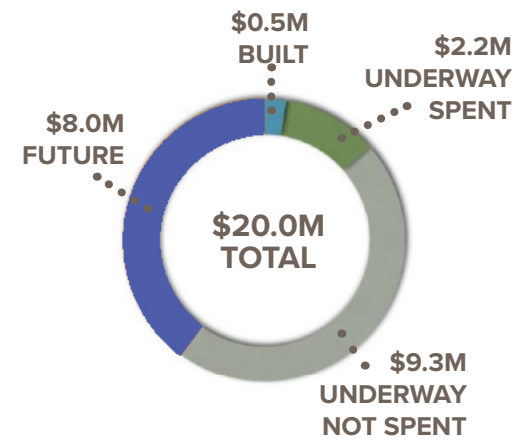
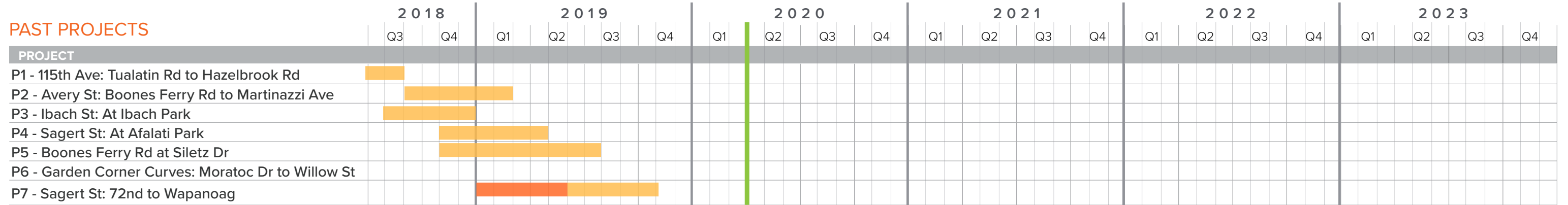



TUALATIN MOVING FORWARD BOND PROGRAM
OVERALL PROGRAM/PROJECT SCHEDULE

PHASES: PLANNING DESIGN CONSTRUCTION

CURRENT PROJECTS

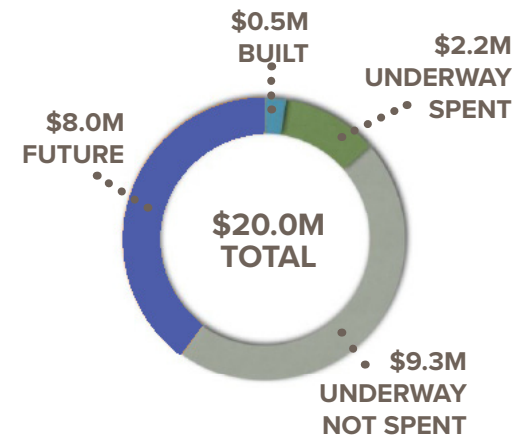
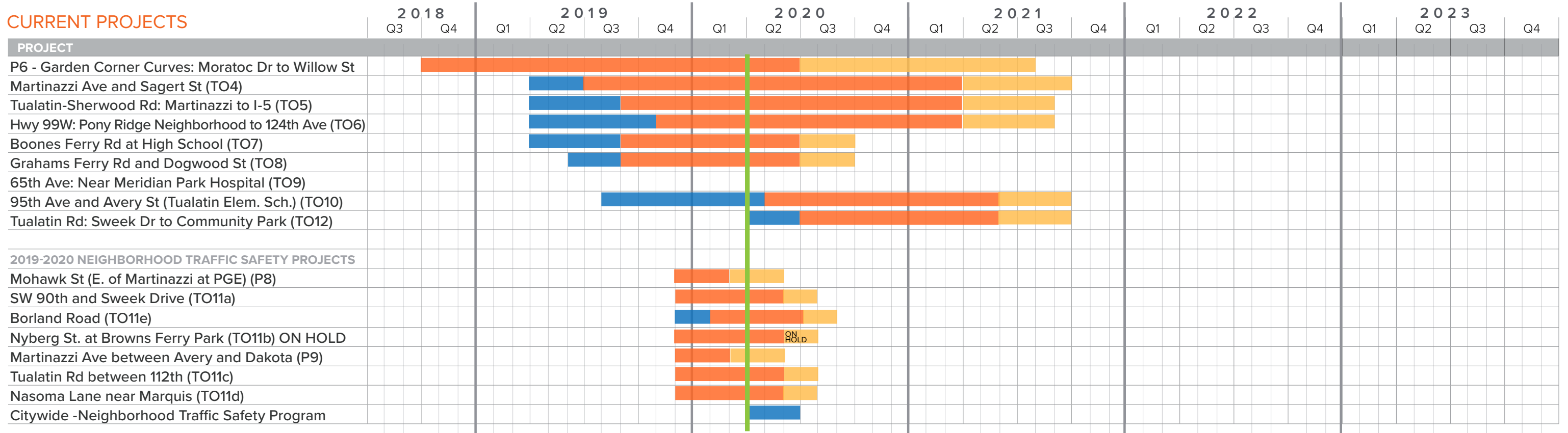



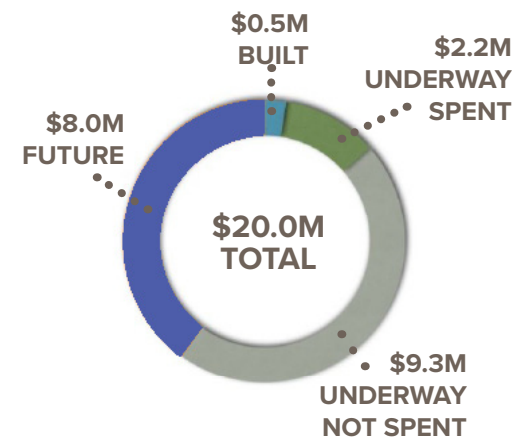
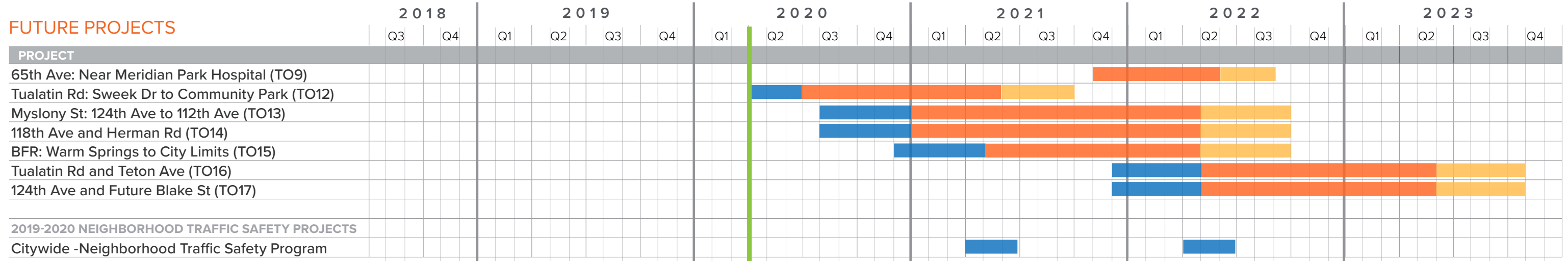

TUALATIN MOVING FORWARD BOND PROGRAM
OVERALL PROGRAM/PROJECT SCHEDULE

PHASES: PLANNING DESIGN CONSTRUCTION



TUALATIN MOVING FORWARD – REPORT CARD
May 2020

	CONGESTION RELIEF	PLAN	DESIGN	CONSTRUCT	BUILT!	COST
	Tualatin-Sherwood Rd: Martinazzi Ave to I-5 Add eastbound lane; upgrade Fred Meyer intersection	●				\$2,339,000
	Martinazzi Ave and Sagert St New traffic signal	●	●			\$2,407,000
	Tualatin Rd and Teton Ave New traffic signal					
	Myslony St: 124th Ave to 112th Ave Upgrade street and sidewalks					
	118th Ave and Herman Rd Upgrade intersection					
	124th Ave and Future Blake St New traffic signal for future road construction					
	SAFE ACCESS TO SCHOOLS	PLAN	DESIGN	CONSTRUCT	BUILT!	COST
	115th Ave: Tualatin Rd to Hazelbrook Rd Buffered bike lanes and crosswalk serving Hazelbrook School	●	●	●	●	\$15,100
	Boones Ferry Rd at High School Midblock crosswalk with pedestrian activated flashing beacons	●	●			\$310,000
	95th Ave and Avery St (Tualatin Elementary School) Upgrade road and sidewalk to reduce speed and improve pedestrian safety	●				\$901,000
	Borland Rd: Bridgeport Elementary to 60th Ave New crossing	●	●			\$80,000
	NEIGHBORHOOD TRAFFIC SAFETY	PLAN	DESIGN	CONSTRUCT	BUILT!	COST
	Garden Corner Curves: Morotoc Dr to Willow St Pedestrian, bike and roadway improvements to reduce speed and improve safety.	●	●			\$3,577,000
	Avery St: Boones Ferry Rd to Martinazzi Ave Driver feedback signs	●	●	●	●	\$31,000
	Ibach St at Ibach Park Midblock crosswalk with pedestrian activated flashing beacons	●	●	●	●	\$85,500
	Sagert St at Atfalati Park Midblock crosswalk with pedestrian activated flashing beacons	●	●	●	●	\$86,200
	Boones Ferry Rd at Siletz Dr Upgrade intersection and add pedestrian activated flashing beacons	●	●	●	●	\$297,500
	Hwy 99W: Pony Ridge Neighborhood to 124th Ave Add new sidewalks	●	●			\$558,000

	NEIGHBORHOOD TRAFFIC SAFETY (Continued)	PLAN	DESIGN	CONSTRUCT	BUILT!	COST
	Grahams Ferry Rd at Dogwood St Midblock crosswalk with pedestrian activated flashing beacons	●	●			\$226,000
	Tualatin Rd: Sweek Dr to Community Park Upgrade sidewalk and midblock crosswalk	●				\$525,000
	Boones Ferry Rd: Warm Springs St. to Norwood Rd Fill in missing segments on sidewalk and bike lane	●				\$1,410,500
	65th Ave near Meridian Park Hospital Midblock crosswalk with pedestrian activated flashing beacons	●				
	Mohawk St: East of Martinazzi Ave at PGE New pedestrian activated signal	●	●			\$40,000
	90th and Sweek Dr New pedestrian activated signal	●	●			\$80,000
	Nyberg Ln: at Browns Ferry Park New pedestrian activated signal and signage	●	●			\$90,000
	Martinazzi Ave: between Avery St & Dakota Dr Driver feedback sign(s)	●	●			\$30,000
	Tualatin Road: between 105th Ave and 115th Ave New pedestrian activated signal and driver feedback sign(s)	●	●			\$100,000
	Nasoma Ln: near Marquis Assisted Living New crossing	●	●			\$80,000



Quarterly Update

City Council
May 11, 2020

Construction



Project updates

Program update

What's next



Construction! Summer 2020*

1. Garden Corner Curves
2. Boones Ferry Rd at Tualatin High School
3. Grahams Ferry Rd and Dogwood St
4. Mohawk St: East of Martinazzi at PGE
5. 90th Ave and Sweek Dr
6. Borland Rd: Bridgeport Elementary to 60th Ave
7. Martinazzi Ave: Avery St to Dakota Ave
8. Tualatin Rd and 112th Ave
9. Nasoma Ln: Near Marquis

**2020 construction adheres to COVID-19 safety standards with appropriate social distancing.*

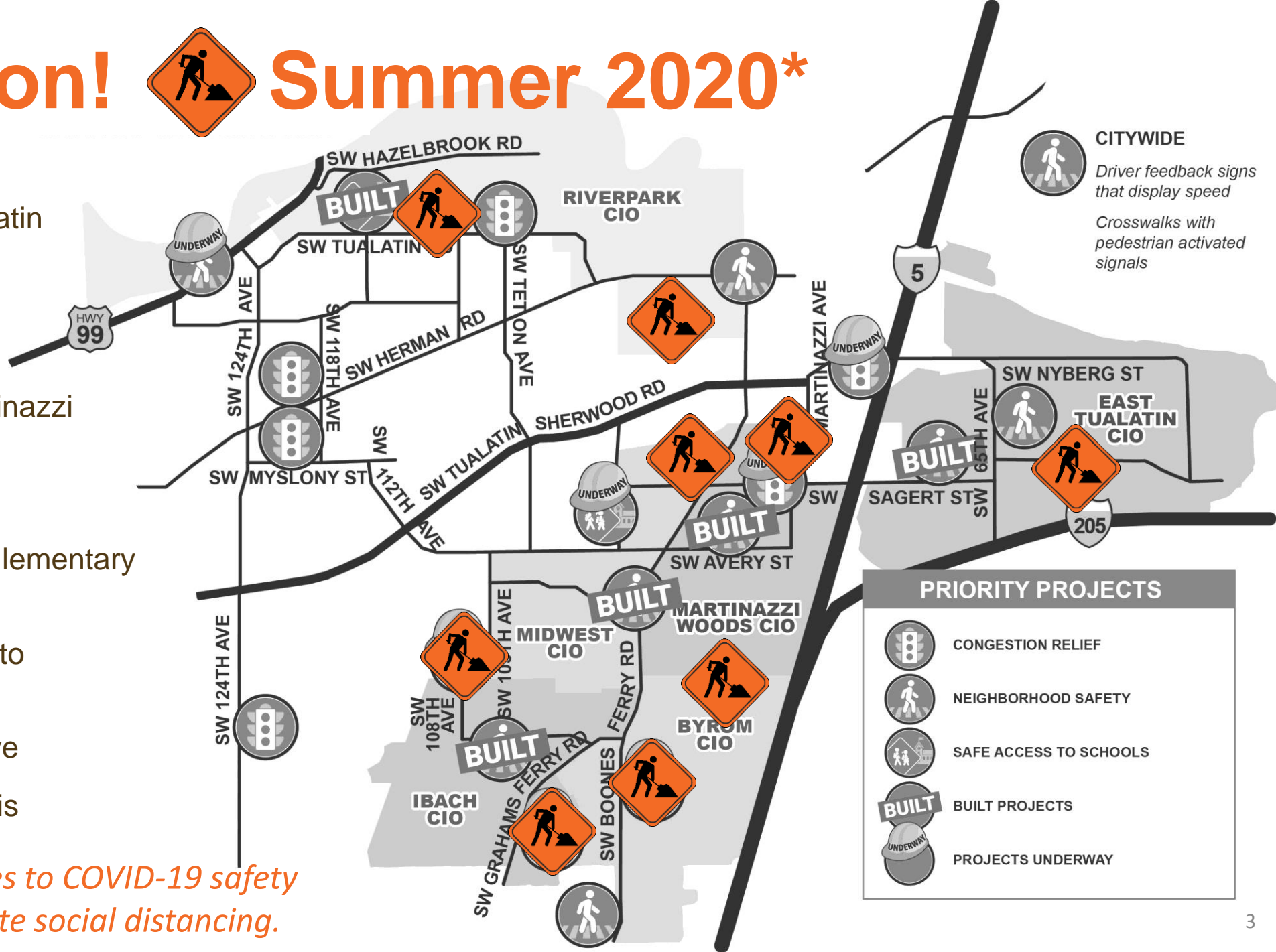

CITYWIDE
 Driver feedback signs that display speed
 Crosswalks with pedestrian activated signals

PRIORITY PROJECTS

- CONGESTION RELIEF
- NEIGHBORHOOD SAFETY
- SAFE ACCESS TO SCHOOLS
- BUILT PROJECTS
- PROJECTS UNDERWAY

Being Designed

Martinazzi Ave and Sagert St

Tualatin-Sherwood Rd:
Martinazzi to I-5

Highway 99W: Pony Ridge
to 124th Ave

95th Ave and Avery Street

Nyberg Lane: 50th Ave
to 65th Ave

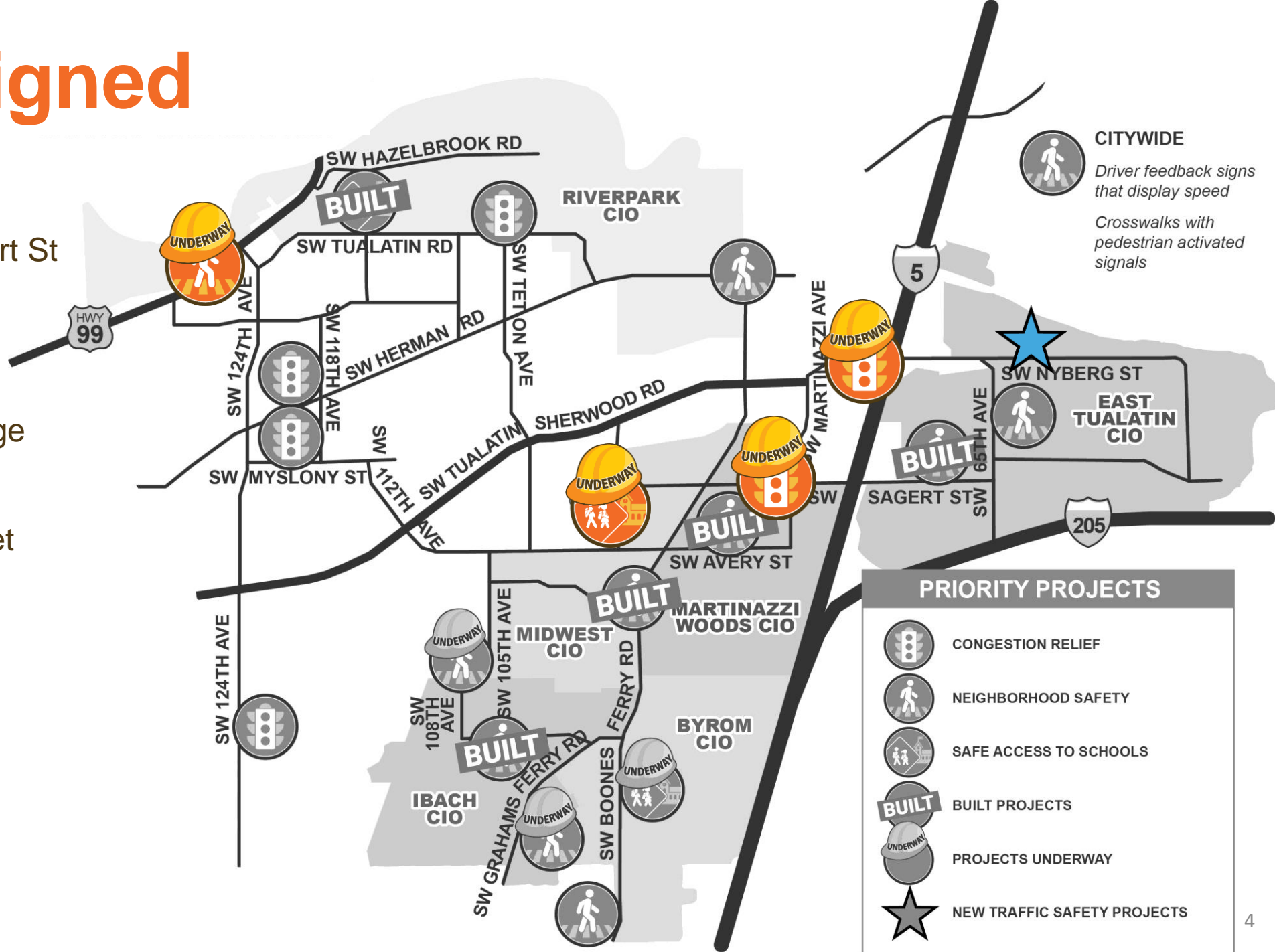

CITYWIDE
Driver feedback signs that display speed
Crosswalks with pedestrian activated signals

PRIORITY PROJECTS	
	CONGESTION RELIEF
	NEIGHBORHOOD SAFETY
	SAFE ACCESS TO SCHOOLS
	BUILT PROJECTS
	PROJECTS UNDERWAY
	NEW TRAFFIC SAFETY PROJECTS

Budget Update

Half of Bond Funds are Programmed or Spent

TUALATIN MOVING FORWARD BOND PROGRAM
OVERALL PROGRAM/PROJECT SCHEDULE

PHASES: **PLANNING**

CURRENT PROJECTS	2018		2019				
	Q3	Q4	Q1	Q2	Q3	Q4	Q1
PROJECT							
P6 - Garden Corner Curves: Moratoc Dr to Willow St	[Orange bar from Q4 2018 to Q1 2019]						
Martinazzi Ave and Sagert St (TO4)			[Blue bar from Q2 2019 to Q3 2019]		[Orange bar from Q3 2019 to Q1 2020]		
Tualatin-Sherwood Rd: Martinazzi to I-5 (TO5)			[Blue bar from Q2 2019 to Q3 2019]		[Orange bar from Q3 2019 to Q1 2020]		
Hwy 99W: Pony Ridge Neighborhood to 124th Ave (TO6)			[Blue bar from Q2 2019 to Q3 2019]		[Orange bar from Q3 2019 to Q1 2020]		
Boones Ferry Rd at High School (TO7)			[Blue bar from Q2 2019 to Q3 2019]		[Orange bar from Q3 2019 to Q1 2020]		
Grahams Ferry Rd and Dogwood St (TO8)				[Blue bar from Q2 2019 to Q3 2019]	[Orange bar from Q3 2019 to Q1 2020]		
65th Ave: Near Meridian Park Hospital (TO9)					[Blue bar from Q3 2019 to Q1 2020]		
95th Ave and Avery St (Tualatin Elem. Sch.) (TO10)					[Blue bar from Q3 2019 to Q1 2020]		
Tualatin Rd: Sweek Dr to Community Park (TO12)					[Blue bar from Q3 2019 to Q1 2020]		
2019-2020 NEIGHBORHOOD TRAFFIC SAFETY PROJECTS							
Mohawk St (E. of Martinazzi at PGE) (P8)							[Orange bar from Q4 2019 to Q1 2020]
SW 90th and Sweek Drive (TO11a)							[Orange bar from Q4 2019 to Q1 2020]
Borland Road (TO11e)							[Blue bar from Q4 2019 to Q1 2020]
Nyberg St. at Browns Ferry Park (TO11b) ON HOLD							[Orange bar from Q4 2019 to Q1 2020]
Martinazzi Ave between Avery and Dakota (P9)							[Orange bar from Q4 2019 to Q1 2020]
Tualatin Rd between 112th (TO11c)							[Orange bar from Q4 2019 to Q1 2020]
Nasoma Lane near Marquis (TO11d)							[Orange bar from Q4 2019 to Q1 2020]
Citywide -Neighborhood Traffic Safety Program							[Blue bar from Q4 2019 to Q1 2020]

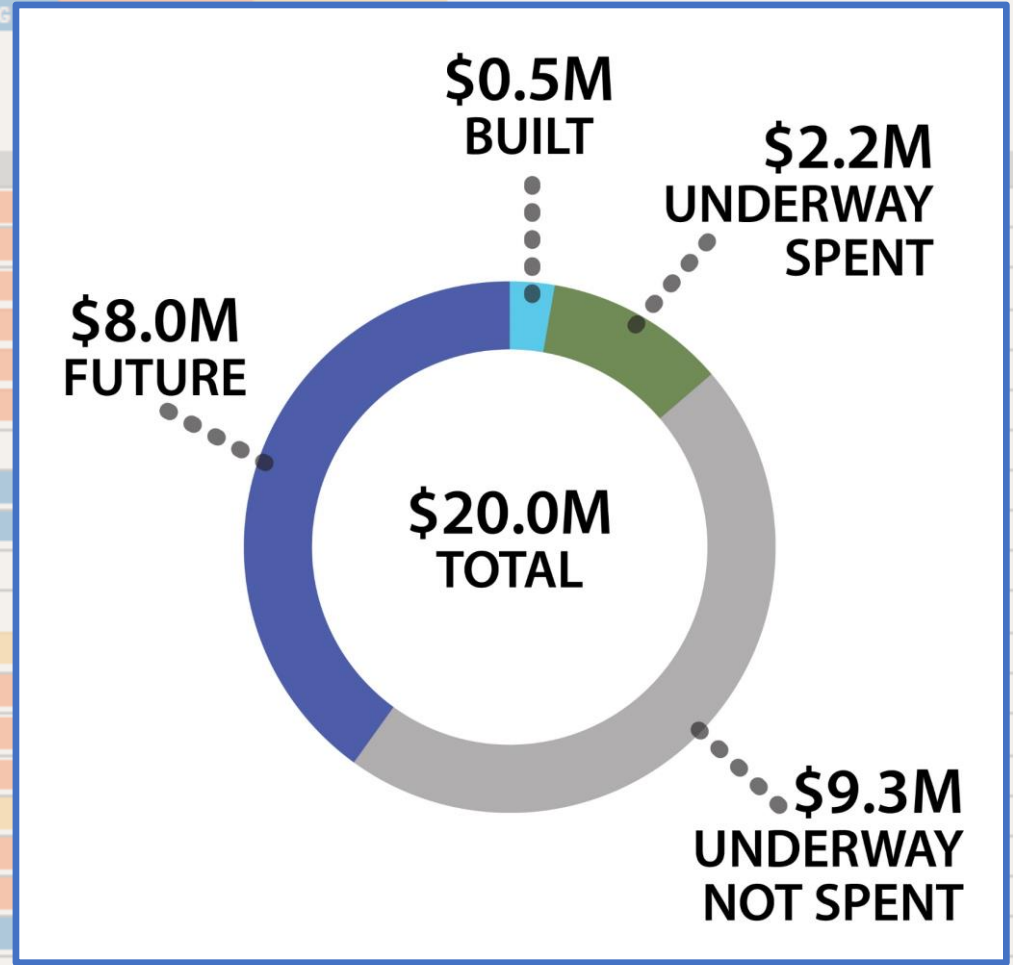

Project Update – Garden Corner Curves

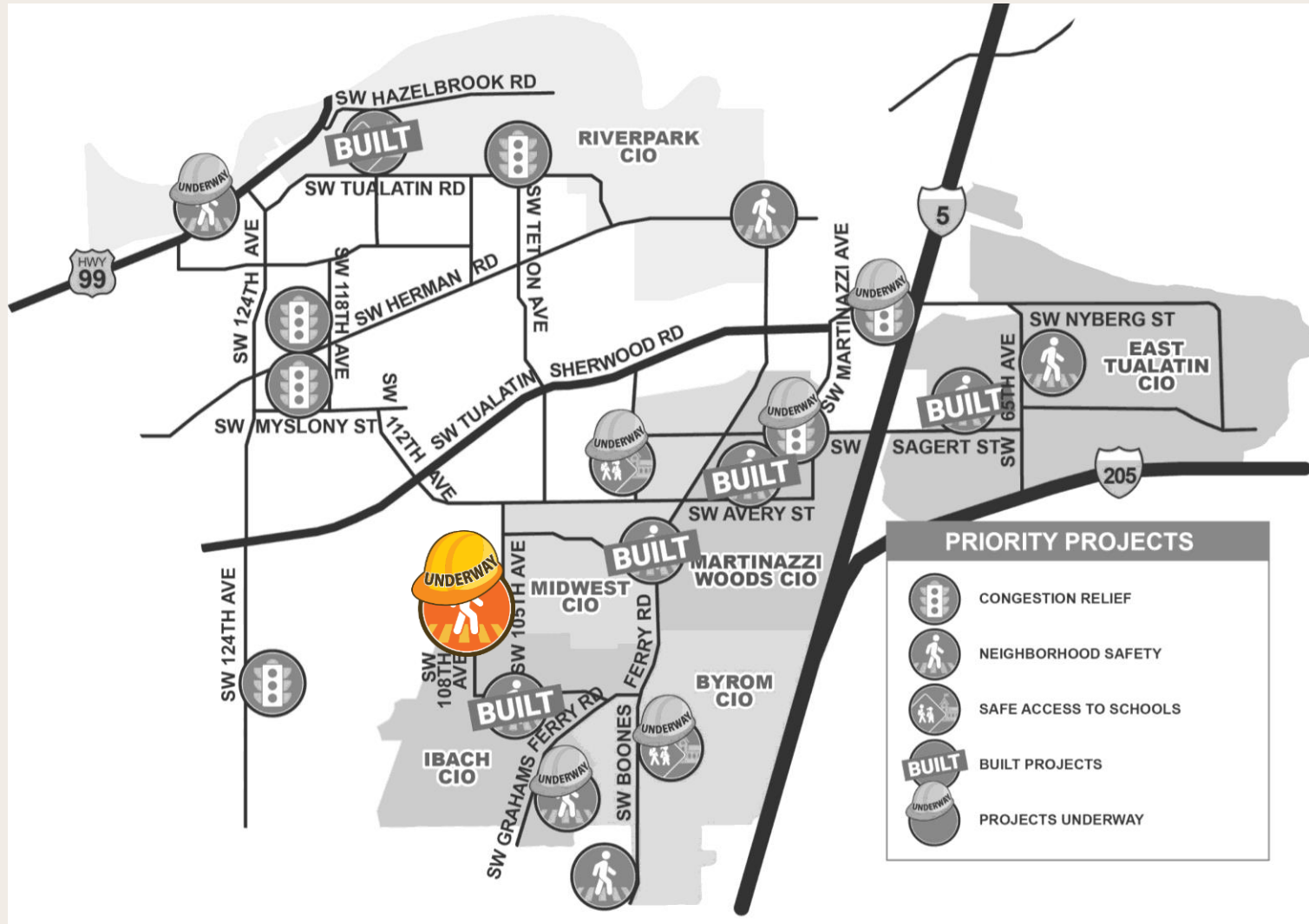

Garden Corner Curves (Summer 2020)

- ✓ Significant safety improvement
- ✓ 105th, Blake, 108th
- ✓ New shared use path, flashing beacons at Moratoc and Blake/108th, raised crossing, driver feedback sign, visual speed reduction
- ✓ Permits in-hand!
- ✓ Property purchase underway
- ✓ Construction documents complete
- ✓ *Almost Ready for Construction*



Project Update – Boones Ferry at Tualatin High School

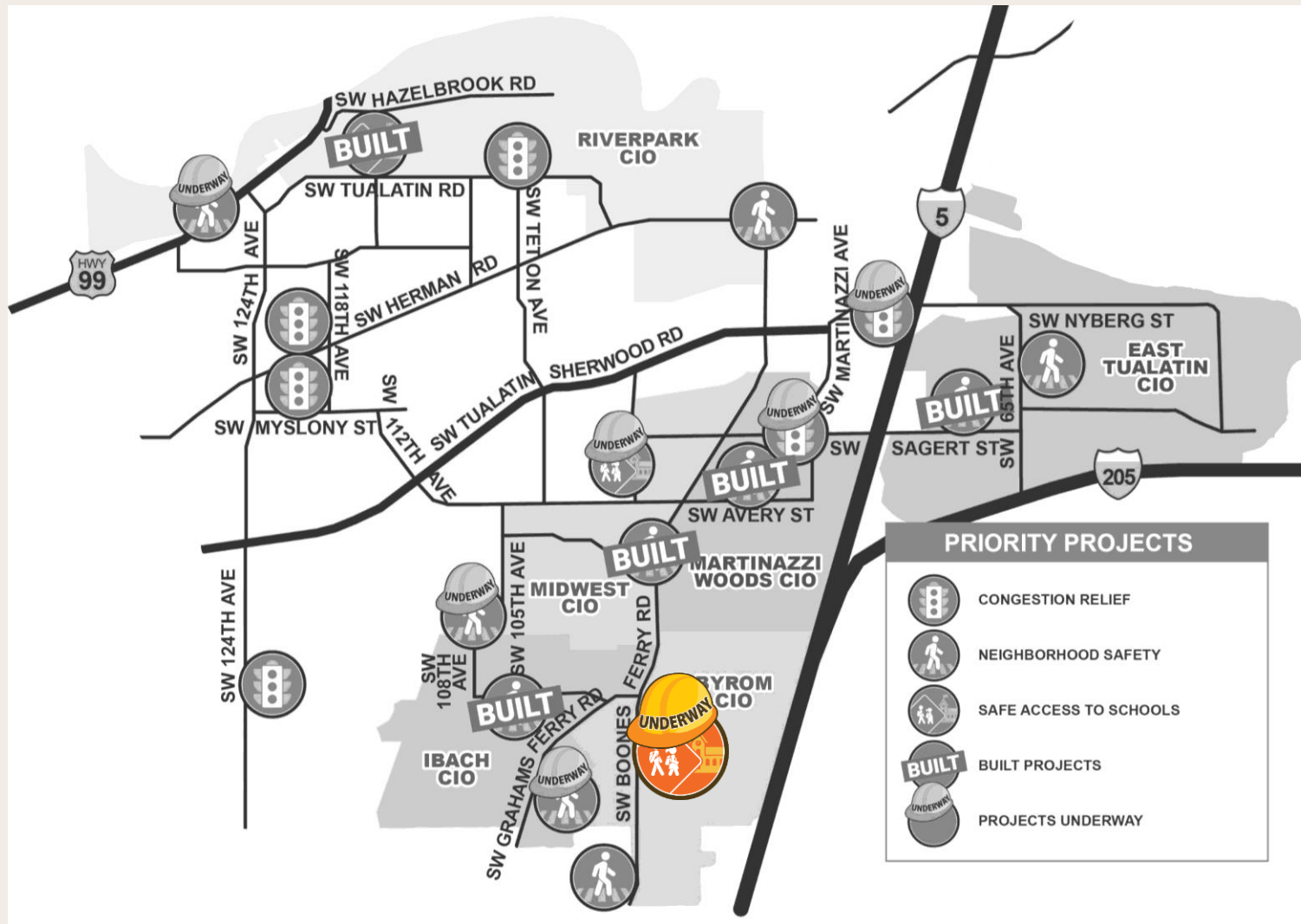

Boones Ferry at Tualatin High School (Summer 2020)

- ✓ Improve safe access to the high school
- ✓ New mid-block crosswalk with flashing beacons at Alabama
- ✓ Sidewalk infill along west side of Boones Ferry; bike lanes extended southbound
- ✓ Stormwater improvements
- ✓ Signal interval lanes for pedestrians at Ibach and Boones Ferry



Project Update – Grahams Ferry Road at Dogwood Street

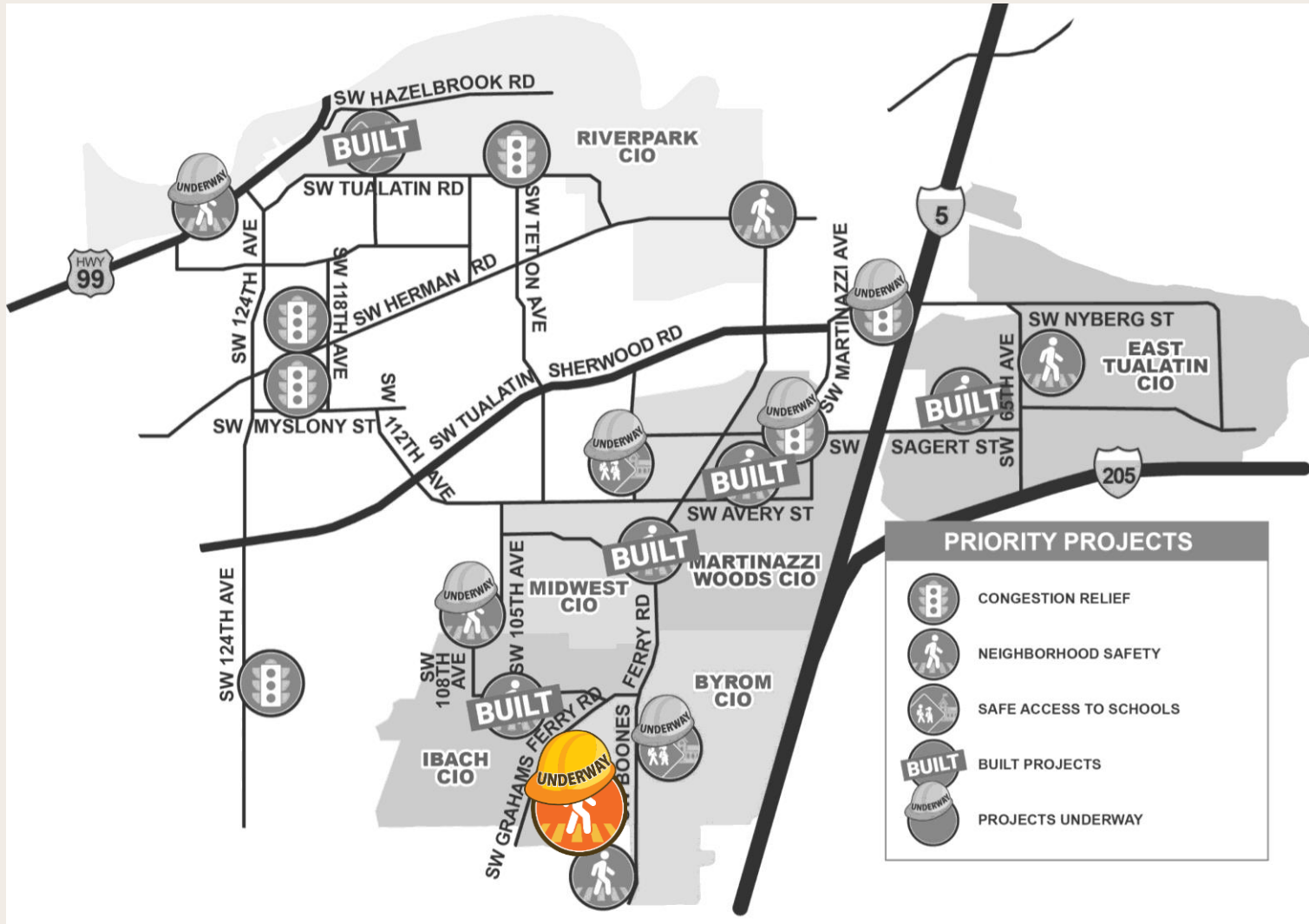

Grahams Ferry Road at Dogwood Street (Summer 2020)

- ✓ New pedestrian crossing to improve safety on County road
- ✓ New crosswalk, pedestrian-activated signal with flashing beacons, improved street lighting at crosswalk, and ADA improvements
- ✓ *Ready for Construction!* 
- ✓ Washington County approval
- ✓ Pre-ordered pedestrian-activated signal with flashing beacons to save time



Have a traffic safety problem in your neighborhood?

We may have solutions...



Safe crosswalks



Traffic calming



Bicycle safety

Let the City know by June 30 to be considered.
Go to www.tualatinmovingforward.com



Now

- ü Mailings Electronic Surveys
- ü Email Updates
- ü Webinars
- ü Virtual Neighborhood Meetings
- ü Social Media
- ü Yard Signs
- ü *Tualatin Today*
- ü Quarterly Report Card/ Council Updates
- ü CIO Contacts
- ü Phone Calls

Earlier/Later

- Kitchen Table Meetings
- Door Hangers
- Open Houses
- Community Meetings
- In-Person Meetings

- ✓ Sidewalk Art Contest – *Extended to June 1*
- ✓ Call for Projects – now through June 30
- ✓ **Summer construction!** 
- ✓ Continue Project Design and Permitting
- ✓ Start Design/Permitting for:
 - Sidewalks on Boones Ferry Road from Warm Springs to South City Limits
 - 65th and Sagert Crossing
 - Nyberg Lane at 57th
 - Next Round of Neighborhood Traffic Safety Projects



Enter Our Sidewalk
Art Contest!

Sugerir un proyecto 

Suggest a Project 

**STAY HOME
STAY SAFE!**

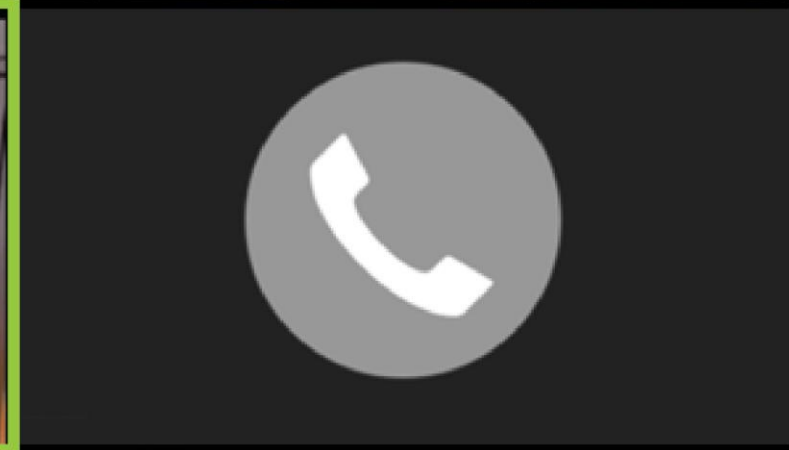

Visit us Online: TualatinMovingForward.com

Questions, Comments, Suggestions?





The Tualatin Historical Society 2019/20 in review

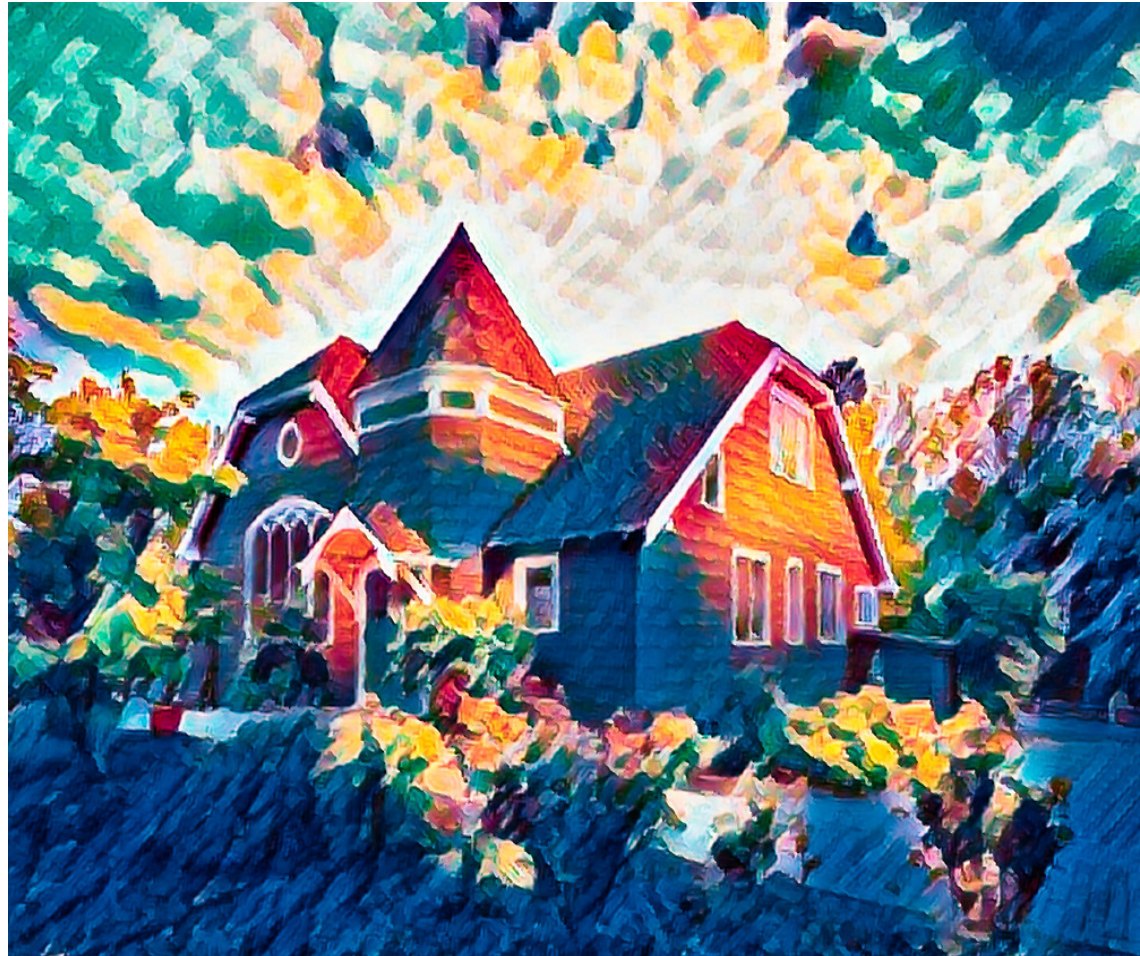



At a Glance: Projects and Traditions



- **New exhibits, displays and archives**
- Ongoing oral history interviews
- Mask and Mirror Community Theater
- **Annual Scholarship (now \$3000!)**
- Added another weekly art class
- **Pioneer Days**
- 4th of July Picnic
- **¡Viva Tualatin!**
- Revamped Tualatin Heritage Evening
- **Galbreath Wagon on display at Lee Farms**
- Long lasting Bricks were sourced and sales restarted
- **Native plants added to patio planters**



At a Glance: Programs



- “The Great Bonneville Megaflood”
- “How to Identify Raptors”
- Lynn Bertelsen: 4 Decades as a Vet in Tualatin
- **“A Geological Tour of the Columbia Gorge”**
- **Linda Moholt and History of Business in Tualatin**
- Ice age Mammals
- **Troubled life of Oregon pioneer Peter Burnett**
- Willamette Falls and Landings Heritage Area
- A Geology Lesson: The Ground Under Your House
- **Joe Meek and his colorful role in Oregon history**
- Rick Thompson: Ice Age Glacial Erratics in Our Region and the Impact on Farming Due to Soils Left Behind
- **Scott Burns: “Dynamic Geology of Iceland—Its connections to similar geology of Tualatin”**
- **Loyce Martinazzi “Tualatin 101” and game show**
- **Gulzar Ahmed “From Pakistan to Tualatin: An immigrant success story”**
- Special Christmas program with TuHS Chorus and local Barbershop groups plus mangers from around the world.

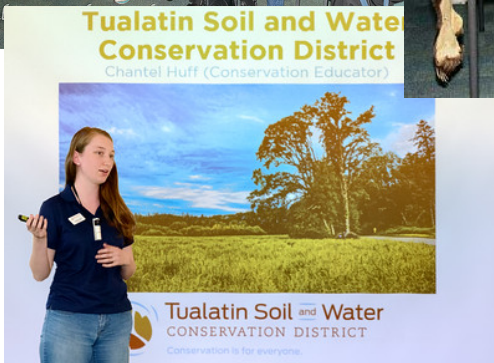



At a Glance: People

Membership stable. Nice increase in multi-year members.

Need to change to online renewals—including payment with credit card.

- TOTAL MEMBERS: 238
- Family Memberships 72
- Deceased 6
- Senior members (over 90) 23
- Lifetime members 19
- Honorary (~20% convert) 36
- 20 multi-year members in our Founders Club and Heritage circle. (15 last year)
- Per Operating agreement with City we are open 10-2 weekdays.
 - **~10,000 visitors over past 12 months.**
 - **Approximately 170 volunteer hours per month.**





Revenue and Expenses thru 3/28/20 For *FY 2019-20



Revenue

	<u>FY Budget 19/20</u>	<u>Actual % Budget FYTD</u>
Donations & Memorials	\$10,000.00	26.35%
Rentals	\$17,000.00	83.80%
Fund Raising	\$13,515.00	108.54%
Membership	\$5,000.00	85.93%
Product Sales	\$500.00	31.00%
Scholarship	\$3,000.00	51.50%
Total	\$49,015.00	67.76%

Expenses

	<u>FY Budget 19/20</u>	<u>Actual % Budget FYTD</u>
Payroll	\$25,372.50	53.46%
Professional Services	\$1,500.00	76.60%
Fund Raising Expense	\$6,700.00	97.17%
100 print Tua From the Beginning	\$2,000.00	0.00%
Programs - Speakers	\$500.00	0.00%
Operations	\$1,500.00	65.88%
Newsletters	\$1,000.00	79.23%
Telephone & Internet	\$1,500.00	58.98%
Membership	\$610.00	45.93%
Equipment Purchased & Rental	\$2,350.00	34.04%
Alarm System	\$300.00	75.00%
Insurance	\$3,000.00	68.80%
Building & Grounds Maintenance	\$650.00	0.00%
Purchases for Resale	\$700.00	56.07%
Scholarship	\$3,000.00	100.00%
Monitoring & Rentals	\$1,250.00	46.84%
Business Fees	\$50.00	0.00%
Community Contributions	\$600.00	75.00%
Credit Card Fees	\$300.00	93.40%
Awards & Gifts	\$100.00	0.00%
Total	\$52,982.50	57.93%

*some items roll over from prior period and are truly reflected by year's end



Savings as of 3/28/20



- Checking: \$1,959.30
- Money market account: \$51,541.5
- Certificate of Deposit: \$29,518.50
- Funds are held in part for future exhibits, \$3000 for 2020 scholarship and capital outlays as the Board of Directors determines
- Major outlays under consideration:
 - Galbreath Wagon Shelter
 - Share cost of new chairs
 - Web page upgrade
 - Printing 3rd edition “Tualatin from the Beginning”



The Ice Age Floods Institute



- **THS works with the Ice Age Floods Institute.** Currently hosting programs and eventually working to share archives now housed at THS.
 - Visiting scientists
 - Research projects and symposia
 - Operate in conjunction with colleges and universities.
 - The Tualatin Chamber of Commerce is now receiving donations for this new nonprofit. THS members Robert Kellogg, Linda Moholt, Rick Thompson and Yvonne Addington play key roles in this initiative.



In 2019 THS bestowed our highest honors on: Norm Parker and Sandra Lafky Carlson



© Al Stewart Photography



© Al Stewart Photography



Covid-19: THS is following the City's lead with closures. We are reaching out in other ways.



Historical plants we have:

Robbins Rose
Lafky Iris
JRC Thompson Hydrangea
Itel Roses
Cimino Hops
Camas

Historical plants coming

Nettie Jurgens Martinazzi King Alfred daffodils
Kay Nyberg Snow Drops
Art Sasaki Tree Peony

- Challenged **school age kids** to keep a log including photos and videos of their experiences for placement into our public archives.
- **Walking map** posted on Next Door and will be sent to members.
- **Women's Suffrage video** link sent to members in lieu of program we cancelled on same subject.
- Plan to roll out **survey to members** to harvest information about local vets. This would be in lieu of May program if cancelled.
- Begin new concept of **“plant fostering”** to make sure our most precious historical plants have multiple homes around town.



2020 Board Members

- Ross Baker, President
- Kurt Krause, Vice President
- Sandra Carlson, Historian
- Barbara Stinger, Treasurer
- Cathy Stockwell, Secretary
- Yvonne Addington
- Larry McClure
- Art Sasaki
- Alan Song
- Kristina Wheelock
- And our THC manager, Cindy Frost

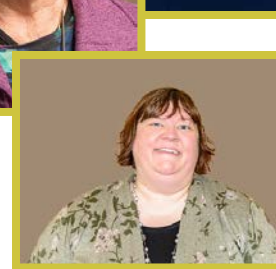
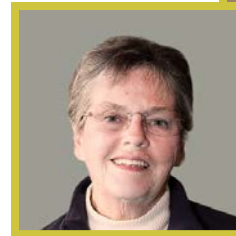



City of Tualatin

**CITY OF TUALATIN
Staff Report**

TO: Honorable Mayor and Members of the City Council

THROUGH: Sherilyn Lombos, City Manager

FROM: Ross Hoover, Parks and Recreation Director
Rich Mueller, Parks Planning and Development Manager

DATE: May 11, 2020

SUBJECT:
Annual Report of the Tualatin Park Advisory Committee

EXECUTIVE SUMMARY:
Beth Dittman, Chair of the Tualatin Park Advisory Committee will present the 2019 Annual Report.

ATTACHMENTS:
PowerPoint Presentation



TUALATIN PARK ADVISORY COMMITTEE

2019 Annual Report



WHO ARE WE?

“We are a group of enthusiastic advocates for the Parks & Recreation system with a focus on the stewardship and enhancement of our community.”

17 Meetings Attended

6 Events Attended

OVER 200 Hours Volunteered

WHO ARE WE?

Current Members

- Beth Dittman, Chair
- Christen Sacco, Vice-Chair
- Nadia Alvarado
- Brandon Gill
- Josh Huffman
- Anthony Warren
- Anh Whitty

Prior Members

- Abbi Feltner-Smith
- Dana Paulino
- Valerie Pratt
- Dennis Wells





WHAT WE DO

- Regular Meetings
- Represent Parks & Recreation to Council & Public
- Attend Activities & Events
- Public Engagement, Involvement & Outreach
- Bee City Facilitation Committee
- Tree City USA Board



WHY IS THIS IMPORTANT?

- Community Engagement
- Service to Council
- Advocates for Parks & Recreation System – the backyard of our city
- Community Connection & Representation



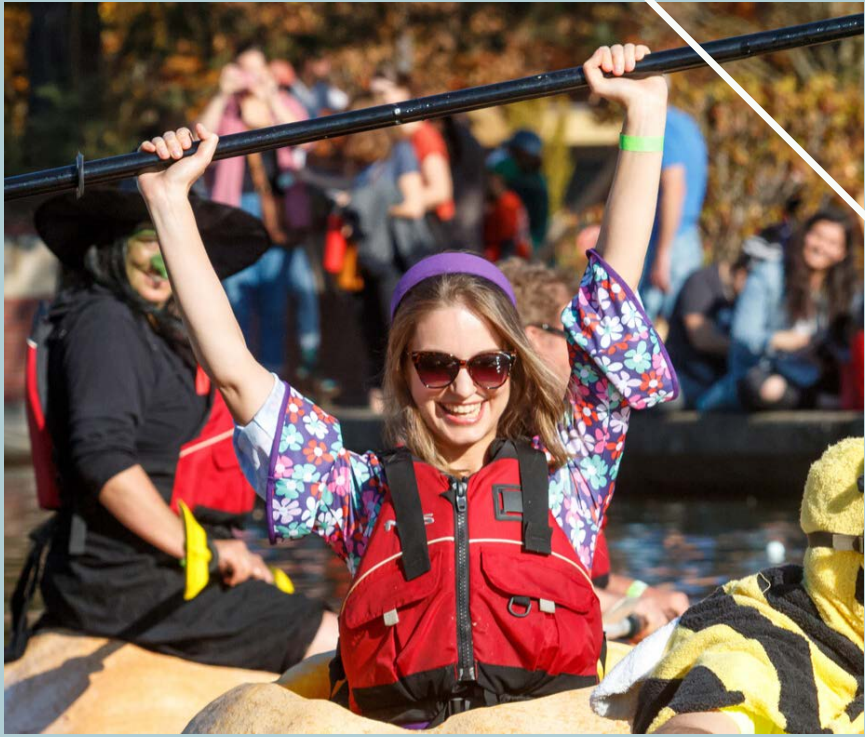

HOW WE'VE CHANGED

- Vision Focused
- Deeper Group Engagement & Involvement
- Seek to be a citizen-lead group and active voice for parks and recreation system

2019 ACCOMPLISHMENTS

- Master Plan State Planning Award
- Park System Development Charge Adoption Recommendation
- Bee City USA Certification
- Joint Meetings & Collaboration with Arts Advisory Committee
- Improvements at Atfalati, Jurgens & Commons Splash Pad
- Ibach Playground Project Renovation
- Ice Age Tonquin Trail Easement Acquisitions

WHERE WE COULD HAVE DONE MORE

Additional funds allocated to actualize master plan goals would help us

- Create a more equitable & accessible community
- Create a more environmentally sustainable community
- Advance active transportation (pedestrian & bike)
- Enhance community gathering places





WHAT ARE OUR 2020 GOALS?

- Community Engagement & Education
- Funding Needs & Opportunities
- Citizen Representatives for Tualatin Parks
- Proactive Committee Ownership
- Master Plan Implementation
- Veteran Memorial Planning Project
- Park Improvements
- Addressing Deferred Maintenance & Planning for the Future

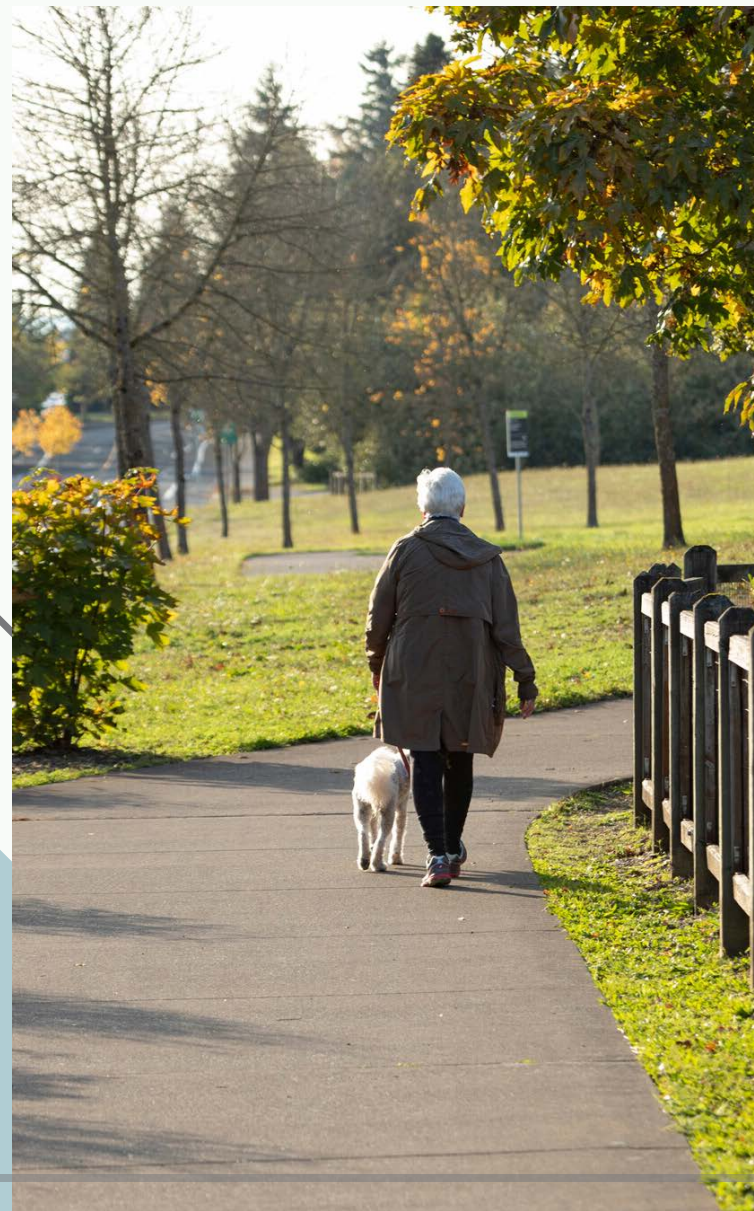

QUESTIONS & COMMENTS

NOW THEREFORE, BE IT RESOLVED BY THE CITY COUNCIL OF THE CITY OF TUALATIN:

Section 1. The Tualatin City Council supports the passage of the Washington County Public Safety Ballot Measure 34-296 on the May 19, 2020 ballot.

Section 2. This resolution is effective upon adoption.

INTRODUCED AND ADOPTED by the City Council at its regular meeting this 11th day of April 2020.

City of Tualatin, Oregon

Mayor

APPROVED AS TO FORM

ATTEST

City Attorney

City Recorder

NOW THEREFORE, BE IT RESOLVED BY THE CITY COUNCIL OF THE CITY OF TUALATIN:

Section 1. The Tualatin City Council supports the passage of the Washington County Ballot Measure 34-297 on the May 19, 2020 ballot.

Section 2. This resolution is effective upon adoption.

INTRODUCED AND ADOPTED by the City Council at its regular meeting this 11th day of April 2020.

City of Tualatin, Oregon

Mayor

APPROVED AS TO FORM

ATTEST

City Attorney

City Recorder