



AGENDA FOR COMMITTEE OF THE WHOLE

A Committee of the Whole meeting will be held on **Monday, October 14, 2024 at 6:30 PM** in the **Council Chambers at City Hall, 819 Superior Avenue, Tomah, WI.**

Join Zoom Meeting:

<https://zoom.us/j/7689466740?pwd=dEdLR2hXK0ZYMk1qNU5vNFJwMzdSZz09>

Meeting ID: 768 946 6740 Password: Tomah2020

Dial by your location +1 312 626 6799 US (Chicago)

CALL TO ORDER – ROLL CALL

- [1.](#) Informational Visit from Dr. Mike Hanson Tomah Area School District

APPROVAL OF THE MINUTES:

- [2.](#) Approval of Minutes from September 16, 2024

REPORTS:

City Clerk

- [3.](#) City Clerk Monthly Report

Parks & Recreation

- [4.](#) Tomah Parks and Recreation Department Program

Public Works & Utilities

- [5.](#) Public Works And Utilities Director Report

Police Department

- [6.](#) Police Department Monthly Report - September 2024

Chamber/Convention & Visitors Bureau

GENERAL:

- [7.](#) Special Beer Permit Application by Queen of the Apostles for Queen of the Apostles Fall Fest on October 20, 2024
- [8.](#) Approval of TID 9 funds for additional street lighting
- [9.](#) Resolution Authorizing Payment of Monthly Bills
- [10.](#) Resolution Declaring Official Intent to Reimburse Expenditures from Proceeds of Borrowing
- [11.](#) Approval of ARPA Funding to 2025 and 2026 Budgets
- [12.](#) Request to Donate Leave
- [13.](#) September 30, 2024 Cash and Investments Schedule

(continued on next page)

Committee of the Whole – October 14, 2024

ADJOURN

NOTICE: It is possible that a quorum of members of other governmental bodies of the municipality may be in attendance at the above-stated meeting to gather information. No action will be taken by any governmental body at the above-stated meeting other than the governmental body specifically referred to above in this notice. Please note that, upon reasonable notice, efforts will be made to accommodate the needs of disabled individuals through appropriate aids and services. For additional information or to request this service, contact Becki Weyer, City Clerk, at 819 Superior Avenue, Tomah, WI 54660.

VOTE NOV. 5



TOMAH
AREA SCHOOL DISTRICT

2024 Referendum

COMMUNITY
INFO SESSION

October 15, 2024

1

VOTE NOV. 5



TOMAH AREA SCHOOL DISTRICT
BACKGROUND

BACKGROUND

District Vision Statement

We will provide excellent academics and co-curricular activities that develop lifelong learning skills for all students preparing them for community and worldwide experience

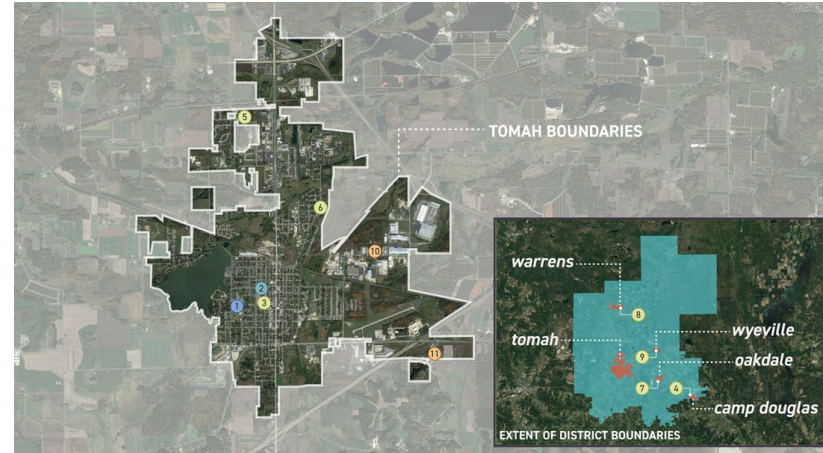

BACKGROUND

We operate the following facilities:

Elementary:

- Camp Douglas Elementary
- La Grange Elementary
- Lemonweir Elementary
- Miller Elementary
- Oakdale Elementary
- Warrens Elementary
- Wyeville Elementary

Tomah Middle School

Tomah High School

Robert Kupper Learning Center

Tomah Area Montessori School

Tomah Area District Office

The Wolf Den

Tomah School District Transportation



Tomah Area School District Student Enrollment Totals

Item 1.

School	2014-2015	2015-2016	2016-2017	2017-2018	2018-2019	2019-2020	2020-2021	2021-2022	2022-2023	2023-2024
Camp Douglas Elementary	43	45	49	45	52	58	60	65	68	66
La Grange Elementary	362	401	429	439	445	459	445	423	415	413
Lemonweir Elementary	305	345	351	279	287	299	271	288	290	276
Miller Elementary	274	265	269	266	269	266	248	258	250	240
Oakdale Elementary	77	65	74	91	88	89	84	91	84	93
Warrens Elementary	137	129	116	131	132	141	129	121	137	150
Wyeville Elementary	120	104	103	127	118	123	110	104	117	106
Timber PUPS	131	46	52	51	46	53	44	38	38	37
Tomah Montessori	0	45	49	58	57	48	52	67	65	64
Tomah Middle School	612	623	643	650	669	675	692	690	673	690
Tomah High School	891	909	900	888	904	859	870	872	867	900
RKLC	59	48	52	52	49	49	46	44	36	52
Totals	3011	3025	3087	3077	3116	3119	3051	3061	3040	3087



BACKGROUND

OPERATIONAL

Used to fund operations such as staffing, technology, instructional materials, transportation, maintenance, utilities, and special education services

(Last operational referendum in April 2023)

CAPITAL (FACILITIES)

Allows a school district to issue debt (take out a loan) to pay for major facility improvements

(Last capital referendum in November 2006)



BACKGROUND

Vote Date	Amount	Referenda Type	Results	Purpose
11/5/2024	\$177,335,000	Issue Debt	Before the Vote Date	For the public purpose of paying the cost of a school building and facility improvement projects.
4/4/2023	\$2,500,000 / Year	NR – 4 Years	Passed	To exceed the revenue limit during the 2023-2024, 2024-2025, 2025-2026, and the 2026-2027 school years.
4/2/2019	\$1,500,000 / Year	NR – 4 Years	Passed	To exceed the revenue limit during the 2019-20, 2020-21, 2021-22 and the 2022-23 school years.
4/5/2016	\$1,500,000 / Year	NR – 3 Years	Passed	To exceed revenue limit for three years for non-recurring purposes
4/1/2014	\$300,000 – 2014-2015 \$750,000 – 2015-2016 \$1,500,000 – 2016-2017	NR – 3 Years	Failed	Sustaining educational programs and to maintain current levels of operational expenses.
11/7/2006	\$1,050,000	Issue Debt	Passed	The addition of air conditioning equipment and installing it in the elementary schools in the District.
11/7/2006	\$4,540,000	Issue Debt	Passed	Finance a school building program consisting of an eight classroom addition at the LaGrange Elementary, constructing a lunchroom addition to and remodeling band and science classrooms at the high school, and the purchasing of Western Technical College building
11/7/2006	\$300,000	RR	Passed	Referendum to exceed revenue limit for additional costs related to school additions and new facilities
9/14/1999	\$980,000	Issue Debt	Passed	Partial demolition of e.s., construct & equip addition & remodel
9/13/1994	\$1,800,000	Issue Debt	Failed	Pool
9/13/1994	\$8,100,000	Issue Debt	Passed	Add to H.S., M.S. Renovation

Source: Department of Public Instruction





TOMAH AREA SCHOOL DISTRICT
PLANNING
PROCESS

PLANNING PROCESS

Item 1.

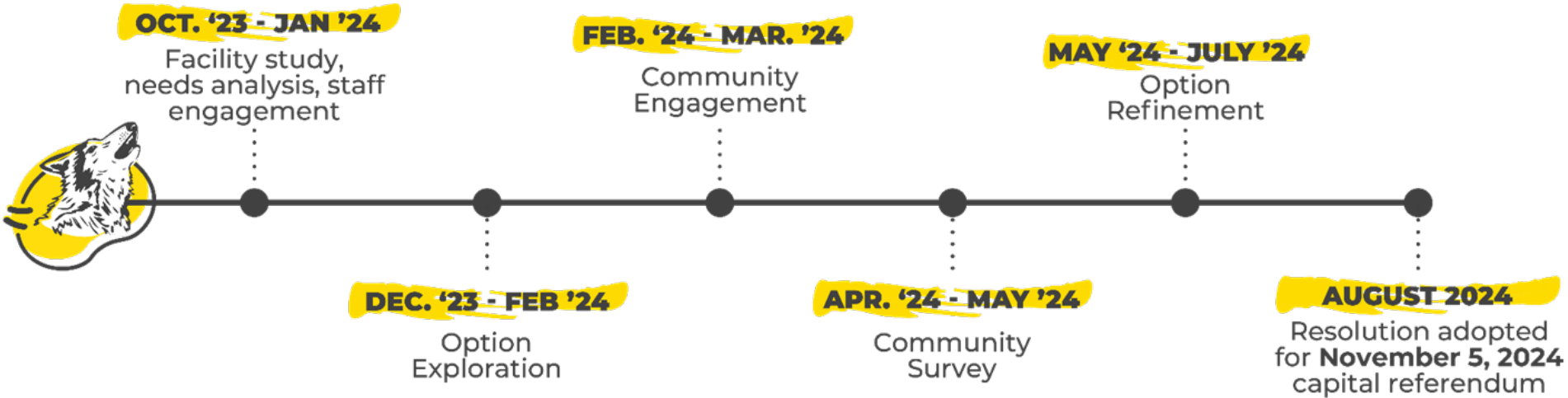

COMMUNITY SURVEY

The May 2024 community survey tested two options:

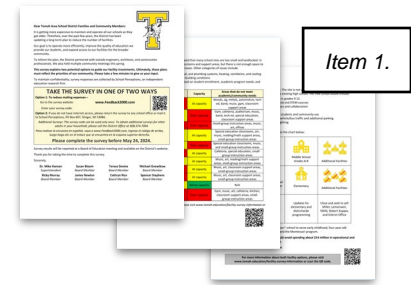

Option #1 - Additions/Renovations to the High School and Middle School

OR

Option #2 - New High School, renovations at the existing high school to convert it to a Middle School, renovations to the existing middle school to convert it to an Elementary School, renovations at La Grange Elementary School for early childhood and Montessori, and closing/seek to sell Lemonweir, Miller, Tomah Area Montessori School, Robert Kupper Learning Center and the district office building



Which option(s) would you support through a referendum? (Residents Only)

Item 1.

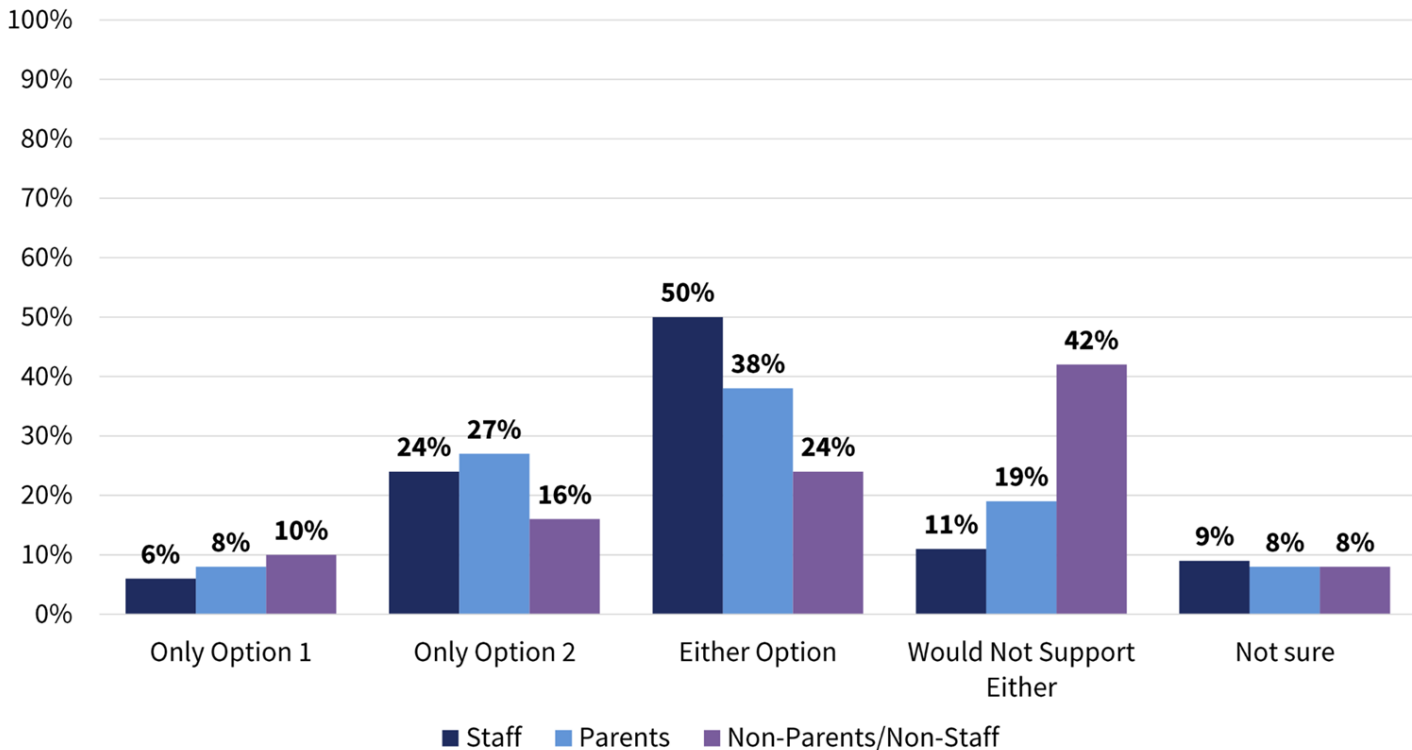

COMMUNITY SURVEY

Item 1.

Additional Analysis: Facility options

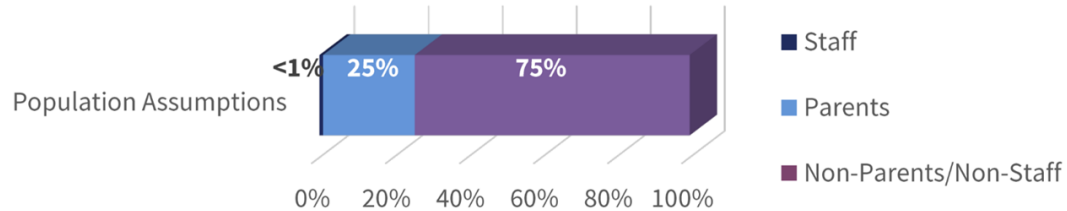

Weighted support for *Definitely yes and Probably yes*:

Option 1: $0.25 (46\%) + 0.75 (34\%) = \underline{\mathbf{37.0\%}}$

Option 2: $0.25 (65\%) + 0.75 (40\%) = \underline{\mathbf{46.3\%}}$



REFERENDUM QUESTION

Item 1.

Shall the Tomah Area School District, Monroe, Juneau and Jackson Counties, Wisconsin be authorized to issue pursuant to Chapter 67 of the Wisconsin Statutes, general obligations bonds in an amount not to exceed \$177,335,000 for the public purpose of paying the cost of a school building and facility improvement project consisting of: acquisition of land for and construction of a new High School building and campus, including an auditorium and site improvements; renovations at the current High School building to convert it to the Middle School; renovation at the current Middle School building to convert it to an Elementary School; renovation at La Grange Elementary School for early childhood education and Montessori classrooms; district-wide capital improvements; acquisition of furnishings, fixtures and equipment; and possible removal of and related sitework at Lemonweir and Miller Elementary Schools, Tomah Area Montessori School, Robert Kupper Learning Center and the district office building?



NO



YES



VOTE NOV. 5



TOMAH AREA SCHOOL DISTRICT
THE NEED

THE NEED

HIGH SCHOOL

The building has served our community as a HIGH SCHOOL since 1964, but WE'VE OUTGROWN THE FOLLOWING SPACES

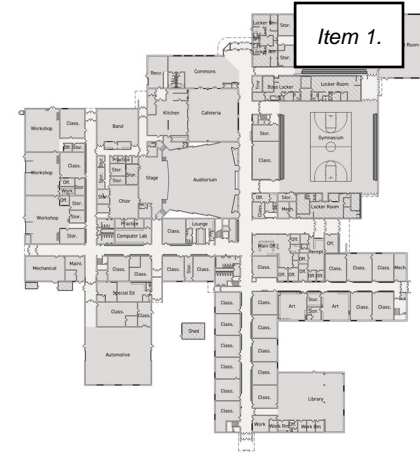

- Fine Arts & Band / Choir
 - Spaces are not large enough for full rehearsals
 - Not enough practice spaces for individual or ensembles
 - Storage space is too small for need
- Technical Education (automotive, manufacturing/welding, construction, woods, STEM/PLTW) and Agriculture
 - Spaces are outdated for today's equipment and instruction
 - Need more flexible space for hands -on learning
- Classrooms
 - Family and Consumer Education needs to be updated to support culinary classes
 - Classrooms do not have opportunities for collaboration or breakout spaces for small group work
- Gymnasium spaces do not serve the demand from the school or community



District Facility Usage for Community and Other Outside Groups (23-24)



COMMUNITY
(For profit)



COMMUNITY
(non profit)



CITY OF TOMAH
(Tomah Parks + Rec)



YOUTH CLUBS



TOTAL HOURS BOOKED
(in a calendar year)



THE NEED

MIDDLE SCHOOL

The building has served our community as a 6th-8th GRADE MIDDLE SCHOOL since 1944, but WE'VE OUTGROWN THE FOLLOWING SPACES

-Cafeteria

- The size of the space affects the number of students we can serve during each lunch period and creates challenges

-Band and Choir

- Spaces are not large enough for full rehearsals
- Not enough practice spaces for individual or ensembles
- Storage space is too small for need

-Classrooms

- Classrooms do not have opportunities for collaboration or breakout spaces for small group work

- Gymnasium spaces do not serve the demand from the school or community

- Building site is small with limited opportunities for growth of parking



THE NEED

ELEMENTARY SCHOOLS

- Building systems at Lemonweir (built in 1959) and Miller Elementary (built in 1957) are in poor condition (plumbing, HVAC, electrical)
- Elementary buildings are at or over capacity
- Limits flexibility of spaces with some buildings lacking special education space, dedicated art/music classrooms, small -group instruction areas.
- Current Lemonweir and Miller sites are limited for future expansion



Miller Elementary



Lemonweir Elementary



THE NEED

OTHER BUILDINGS

- Robert Kupper Learning Center is in good condition, but it is currently underutilized
- Tomah Area Montessori building is in poor condition and it is over capacity. The long term goal would be to grow this program.
- The District Office building is in poor condition. The long term goal would be to move the district office closer to the students



VOTE NOV. 5



TOMAH AREA SCHOOL DISTRICT
THE SOLUTION

THE SOLUTION

Item 1.



NEW HIGH SCHOOL

Modern learning environments to prepare students for career, college and life.
Flexible spaces for student instruction and performances.



OPERATIONAL EFFICIENCIES

Move all students in grades 5 -8 into existing high school, consolidate in -town elementary grades 1-4 into existing middle school, create and in -town 4k -5k center and montessori school at Lagrange Elementary, close five buildings/properties to reduce operational costs.



COLLABORATION + COMMUNITY USE

Design collaborative spaces for students and expand community use of district facilities.



THE SOLUTION

Item 1.

NEW HIGH SCHOOL

The site is not yet finalized. However, the District is searching for potential properties near the existing high school. The new school would include:

- Capacity to serve up to 1,100 students in grades 9-12
- Classrooms and labs for career & tech ed and STEM courses
- Flexible spaces for student performances and collaboration
- Performing arts center
- A three-court gym and fitness area for students and community use
- Proper separation of pedestrians and vehicle/bus traffic and additional parking
- Energy-efficient systems and natural lighting
- Practice fields and track





New Wisconsin High School Examples



THE SOLUTION

Item 1.

PRELIMINARY LAYOUT FOR MIDDLE SCHOOL AT EXISTING HIGH SCHOOL

- Capacity to serve 950 students in grades 5 -8
- The existing high school would offer the following improved spaces for Middle School:
 - Cafeteria
 - Athletics/gymnasium
 - Labs for tech ed and STEM courses
 - Science classrooms
 - Auditorium space
 - Larger site with ample parking and proper separation of pedestrians and vehicle/bus
 - Practice fields and track







THE SOLUTION

Item 1.

PRELIMINARY LAYOUT FOR MIDDLE SCHOOL AT EXISTING HIGH SCHOOL

Legend

-  Classrooms
 -  Elective Classrooms & Spaces
 -  District Maintenance
 -  Shared / Support
- *Preliminary layout

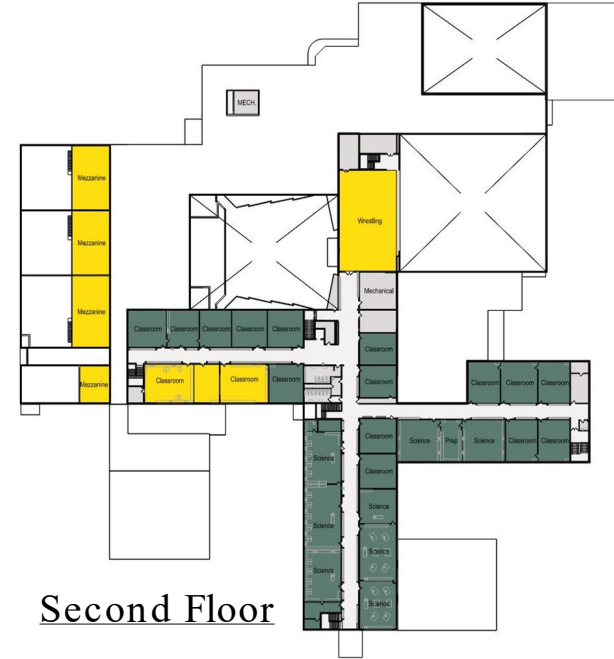
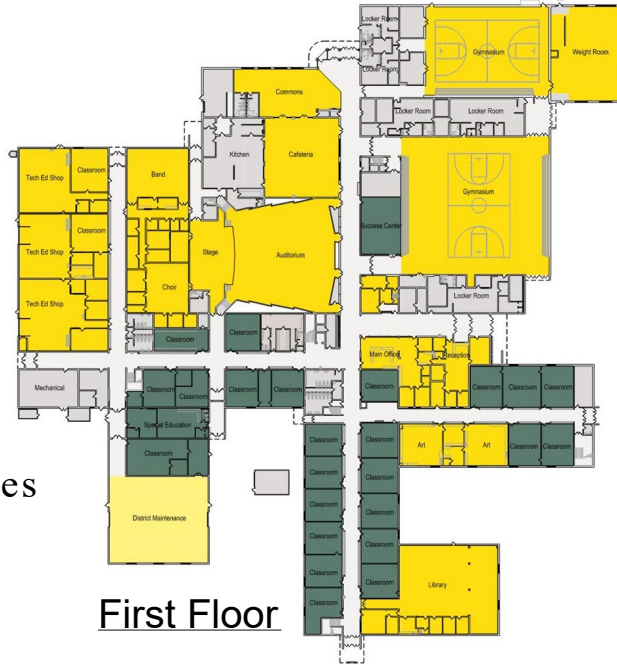

THE SOLUTION

5-8 MIDDLE SCHOOL AT EXISTING HIGH SCHOOL

Educational benefits for 5th grade students in a middle school setting

- Possible future academic exposure could include:
 - Mathematics
 - Music (Band/Orchestra)
 - World Languages
 - Career & Technical Education
 - Family and Consumer Education

A 5-8 grade middle school configuration allows flexible staff collaboration opportunities

- Staff can organize into 5-6 grade and 7-8 grade cohorts for student and professional development



THE SOLUTION

Item 1.

PRELIMINARY LAYOUT FOR ELEMENTARY AT EXISTING MIDDLE SCHOOL

- Capacity to serve 585 students in grades 1 -4
- The existing middle school would offer the following improved spaces for Elementary:
 - Athletics/gymnasium
 - Labs for tech ed and STEM courses
 - Dedicated art classrooms
 - Dedicated music classrooms
- District offices would utilize a portion of the building not needed for elementary

This creates space at the remaining outlying elementary schools across the district



THE SOLUTION

PRELIMINARY LAYOUT FOR TOWN ELEMENTARY SCHOOL

Item 1.

Legend

- Elementary School
- District Office
- District Maintenance
- Shared / Support

*Preliminary layout

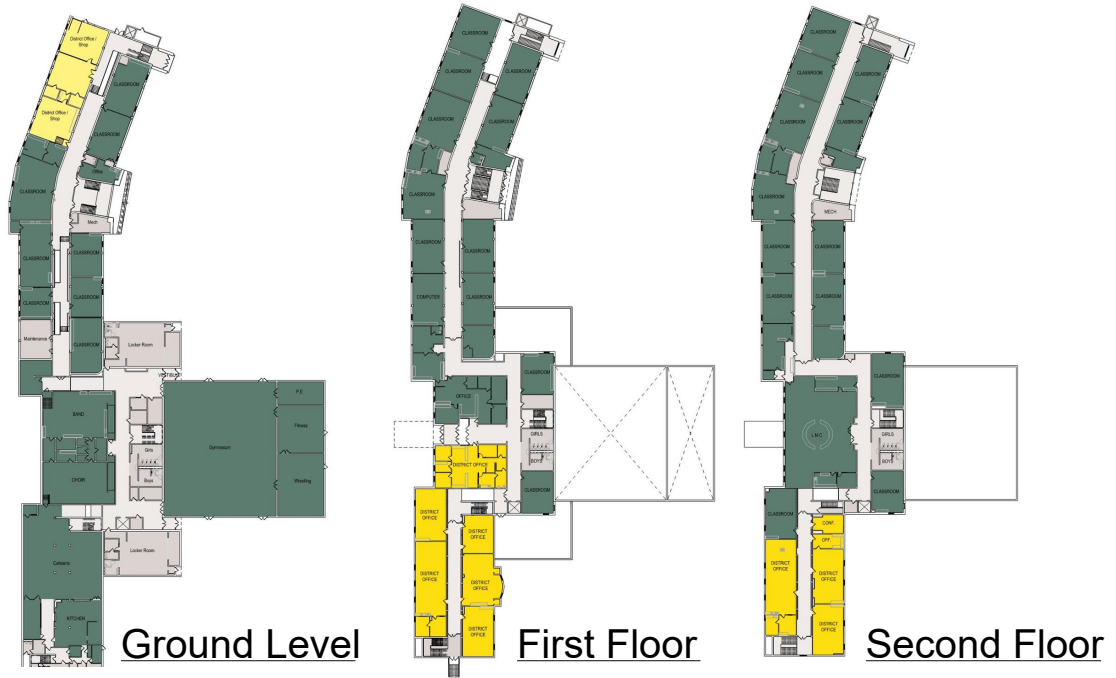

THE SOLUTION

PRELIMINARY LAYOUT FOR MONTESSORI AND TAMS 4K-5K AT LAGRANGE ELEMENTARY



The existing elementary would offer a centralized in-town early childhood center:

- Classrooms for 4K-5K students

The existing elementary would offer the following improved spaces for Montessori:

- Larger classrooms for Montessori program
- Flexibility for growth
- Improved site opportunities

Legend

-  Early Learning Center
-  TAMS Program
-  Shared / Support
- *Preliminary layout



THE SOLUTION

The ten year savings with closing five buildings, in today's dollars is \$13.8M; this is annualized to \$1,375,000 per year by:

- 1- Utility Cost - Compare the actual utility cost for each building to the expected utility cost for the future location.
 - 2 - Operational Efficiencies - Anticipated annual savings related to staffing operational efficiencies by combining (5) buildings in to (2) buildings.
 - 3 - Capital Maintenance - The forecasted 10-year capital maintenance cost avoided at the (5) existing buildings by closing them. These cost are shown on an annualized basis.
- This forecast is based on properties being sold or disposed of (TASD does not continue to condition or maintain vacant buildings).
 - Does not calculate operational cost for additional building square footage being added for middle school or high school.
 - District Office, Robert Kupper, TAMS, and Lemonweir used data from 2018 facility report and TASD current capital improvement tracking. A detailed engineering study would likely result in an increased capital forecast cost.



THE SOLUTION

If the referendum passes, we would operate the following facilities:

La Grange (4K-5K / Montessori)

The Wolf Den Tomah School District

Elementary (Grades 1 -4):

- Camp Douglas Elementary
- Oakdale Elementary
- Warrens Elementary
- Wyeville Elementary
- In-town Elementary

Transportation

Tomah Middle School (Grades 5 -8)

Tomah High School



VOTE NOV. 5



TOMAH AREA SCHOOL DISTRICT
THE INVESTMENT

Historical School Mill Rate vs. Statewide K-12 Average Item 1.

Tomah Area School District's tax rate has been \$1.74 below state average over the last 10 years.
In fact, the district's rate has been \$1.93 below state average over the last 40 years!

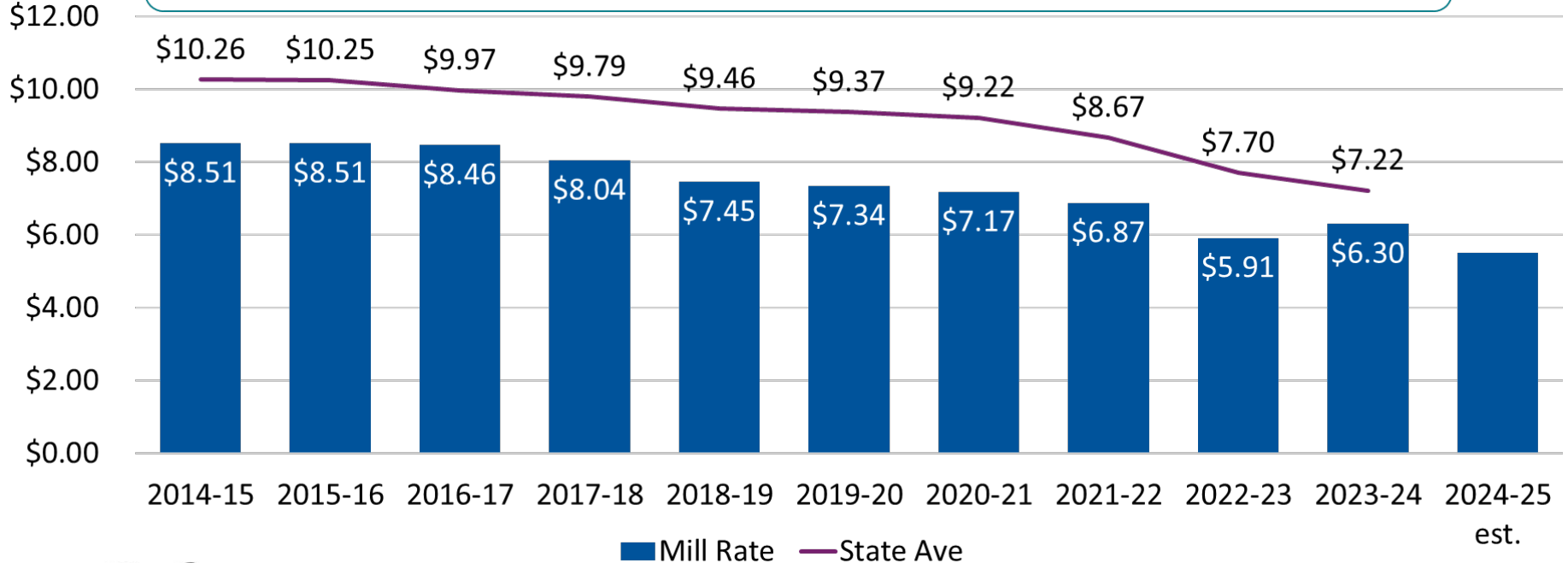

Source: Department of Public Instruction
2024-25 estimate based on district projections as of 9-2024



Tomah Area School District | November 5, 2024 Referendum



2023-24 Mill Rate Comparison

Item 1.

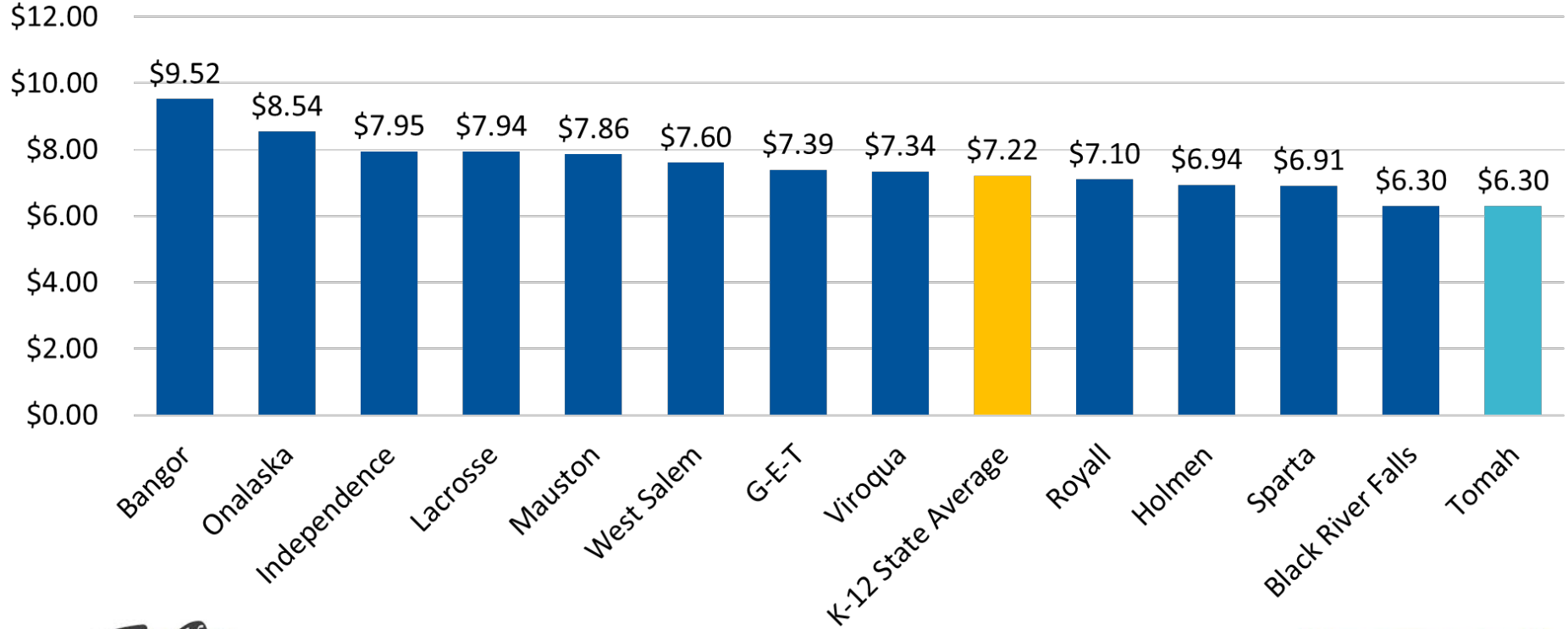

Source: Department of Public Instruction



Tomah Area School District | November 5, 2024 Referendum



Historical Interest Rate Trend

AAA Municipal Market Data (MMD) Index Past 30 Years

Municipal borrowing rates are still near historic lows

Tomah Area School District's current estimated borrowing rate is 3.90% (Sept. 2024)

Lower interest cost = lower estimated taxes

1 YEAR SNAPSHOT



Item 1.



Source: Refinitiv as of September 10, 2024



Tomah Area School District | November 5, 2024 Referendum



Estimated Tax Impact Summary

Item 1.

REFERENDUM AMOUNT **\$177,335,000**

MAXIMUM MILL RATE IMPACT (FIRST IMPACT - 2024-25)
(Per \$1,000 valuation) \$2.59

AVERAGE MILL RATE IMPACT
(Per \$1,000 valuation) \$2.36

TAX IMPACT ON PROPERTY WITH FAIR MARKET VALUE OF:

\$100,000 Property

	Annual	Monthly	Weekly
Maximum Impact	\$259.00	\$21.58	\$4.98
Average Impact	\$236.00	\$19.67	\$4.54

\$200,000 Property

Maximum Impact	\$518.00	\$43.17	\$9.96
Average Impact	\$472.00	\$39.33	\$9.08

\$300,000 Property

Maximum Impact	\$777.00	\$64.75	\$14.94
Average Impact	\$708.00	\$59.00	\$13.62

Maximum estimated impact is \$259 per \$100,000 property (average impact: \$236)

This equates to \$4.54 to \$4.98 weekly for a \$100,000 property

Tomah Area School District will receive over 30% of this project reimbursed by state aid

Please refer to website for more information on financing plan assumptions



Mill Rate with Hypothetical Referendum Tax Impact

Item 1.

Tomah Area School District's tax rate will remain below 2016-17 (the year the district paid off its debt)

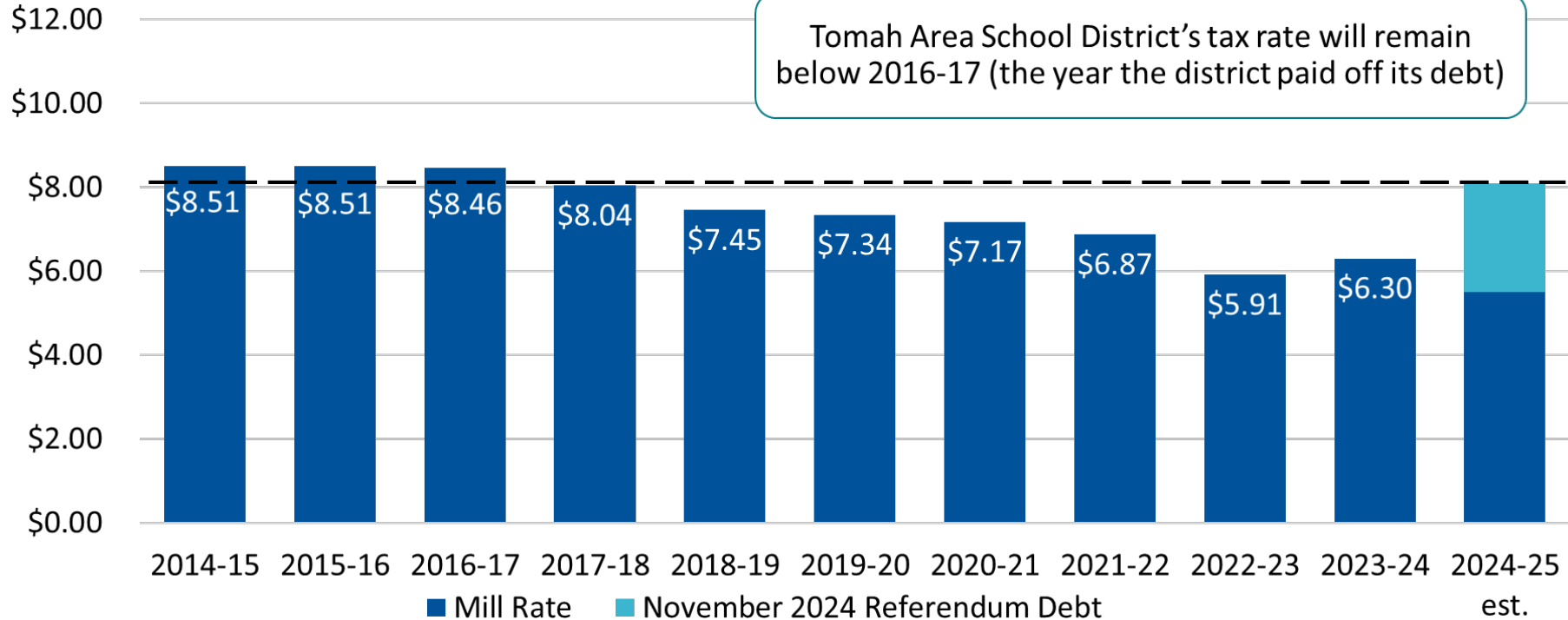

Historical Mill Rate Source: Department of Public Instruction; 2024-25 mill rate estimate based on district projections as of 9-2024. Please refer to website for more information on financing plan assumptions.



Tomah Area School District | November 5, 2024 Referendum



FOR MORE INFORMATION

Item 1.



(608) 374-7004



referendum@tomah.education



www.tomah.education

JOIN A COMMUNITY INFO SESSION:
All sessions will be held from 6pm-8pm

SEPTEMBER 24 TOMAH MIDDLE SCHOOL

OCTOBER 15 TOMAH HIGH SCHOOL

OCTOBER 22 TOMAH HIGH SCHOOL

OCTOBER 23 TOMAH HIGH SCHOOL



Tomah Area School District | November 5, 2024 Referendum



MINUTES FOR COMMITTEE OF THE WHOLE SEPTEMBER 16, 2024

CALL TO ORDER – ROLL CALL

John Glynn called the meeting to order at 6:30 p.m. Present: John Glynn, Paul Dwyer, Travis Scholze, Richard Yarrington, Patrick Devine, Nellie Pater, and Dean Peterson. Absent: Shawn Zabinski and Nicole Hart. Also Present: Becki Weyer, Molly Powell, Joe Protz, Kirk Arity, and Eric Pedersen. The meeting was recorded by Hagen Sports Network and available via Zoom. All motions are unanimously approved unless otherwise notated.

Financial Audit Presentation by Clifton Larson Allen

Brock Geyen from Clifton Larson Allen gave remotely a presentation of the financial audit summary to the committee.

Ehlers Financial Management Plan Presentation

Dave Ferris from Ehlers Financial Management gave an updated version of the city's financial plan.

Approval of Minutes from August 19, 2024

Motion by Scholze, second by Peterson, to approve the minutes from August 19, 2024. Motion carried.

City Clerk Monthly Report

Weyer provided a monthly written report and gave an update to the Council. In person absentee voting will start on October 22, 2024 and will go through November 1, 2024. There are currently 14 applications for the Economic Development/Zoning Director, and they are being routed for review by the recruiter.

September 2024 Treasurer's Report

Powell provided a monthly written report. The Treasurer is meeting with Department Heads to determine budget needs for 2025. Budget work will continue over the next month.

August 31, 2024 Revenue and Expenditures with Comparison to Budget

Powell provided a written report for review.

Tomah Parks and Recreation Program Report

Protz provided a monthly written report and covered the highlights with the committee. He went over the upcoming recreation programs and events at Recreation Park.

Public Works And Utilities Director Report

Street: The May Street project is complete. The Glendale bridge deck has been resurfaced under warranty from Fahrner Asphalt. The asphalt parking area for the Tomah Public Housing Authority is complete. The W Juneau parking lot is ready to be paved. Sections of the Northbound Lane of the 1100 Block of Superior Ave have been repaired. The flagpole base has been poured and the flagpole should be set the week of 8/12.

2) Sewer Department Operations are normal. The mechanical upgrades to the fermentation tank and clarifiers are on schedule for completion in August. Sludge has been hauled out with the help of the street department. Preparation for the budget process has begun. 3) Water Department Operations are normal. The exception to this is well # 10 is down for scheduled repairs. Lead service inventory is still the focus. Of the original 3,459 services there are 5 services that have not been identified. This is exceptional work by the water department. 4) Lake Committee The Lake Committee's next meeting is 9/19/24 @ 5:00pm. A lightning strike occurred around 8/5/24 at the dam control house. We are still evaluating the damage. The tainter and roller gates are operational manually. There will be a free e-recycling event at the Aquatic Center parking lot this Saturday from

August 2024 Police Department Monthly Report

Chief Holum provided a monthly written report.

Special Beer and Wine License Application by the Tomah Lions Club for Downtown Thursday Nights in July and August 2025

Motion by Scholze, second by Yarrington, to recommend the Council approve the special beer and wine license for the Tomah Lions Club for Downtown Thursday Nights for July and August 2025. Motion carried.

Special Event Outdoor Cabaret License for the Greater Tomah Area Chamber of Commerce for the 800 and 900 blocks of Superior Avenue for six “Downtown Thursday Nights” concert events in July and August of 2025.

Motion by Scholze, second by Peterson, to recommend the Council approve the cabaret license for the Tomah Chamber of Commerce for the 800 and 900 blocks of Superior Avenue for six Downtown Thursday Night concert events in July and August of 2025. Motion carried with one negative vote. (Dwyer)

Tomah K9 Unit Officer Vehicle Policy Change approval

Motion by Scholze, second by Yarrington, to recommend the Council approve the change to the Personnel Policy to remove the fifteen-mile residency restriction for K-9 officers to open the position to all officers. Discussion ensued on changing the 15-mile restriction but not removing it. Motion carried with three negative votes. (Peterson, Yarrington, Dwyer)

K9 Training - Canada

The Police department has entered into an agreement with Working K9 out of Beeton, Ontario, Canada for the next dual-purpose K9. This requires the new K9 handler to drive Working K9 in the early part of 2025 for a week to train with the animal. The City’s personnel manual requires authorization for employees to attend training events out of the state. Motion by Dwyer, second by Peterson, to recommend the Council approve the K-9 training in early 2025. Motion carried.

August 31, 2024 Cash and Investments Schedule

Motion by Yarrington, second by Scholze, to recommend the Council approve the August Cash and Investments Schedule. Motion carried.

Resolution Authorizing Payment of Monthly Bills

Motion by Scholze, second by Peterson, to recommend the Council approve the Resolution Authorizing Payment of Monthly Bills in the amount of \$2,826,141.52. Motion carried.

Discussion on TID 8 Facade Improvement Grant Program

Powell discussed the proposed TID 9 Façade Improvement grant and opened the discussion to the Committee for additional ideas before finalizing the plan. Motion by Dwyer, second by Peterson, to recommend the Council approve moving to the Planning Commission for approval. Carried with one negative vote (Yarrington.)

Special Beer Permit Application by Tomah Firefighters Association for Hunters Night Out on November 2, 2024

Motion by Peterson, second by Pater, to recommend the Council approve the special beer permit for the Tomah Firefighters Association for Hunter’s Night out on November 2, 2024. Motion carried.

Ordinance Re-Zoning Property Parcel #286-02651-5301

Motion by Glynn, second by Yarrington, to recommend the Council adopt the ordinance rezoning parcel #286-02651-5301 from A-1 Agricultural to R-3 Multifamily Residential district. Motion carried.

Ordinance to Create Ordinance Committee

Atty. Precour provided an updated ordinance to the Committee of the Whole for the proposed Ordinance Committee including the changes they requested last month. Motion by Yarrington, second by Dwyer, to recommend the Council adopt the Ordinance to Create the Ordinance Committee as submitted. Motion carried.

ADJOURN:

Motion by Peterson, second by Dwyer, to adjourn. The meeting was adjourned at 8:12 p.m.

Committee of the Whole – September 16, 2024

Respectfully submitted,

Rebecca Weyer

To be approved October 14, 2024

CITY CLERK – MONTHLY REPORT OCTOBER 2024

Elections

- As of 10/09/2024, the city has sent out about 500 ballots to absentee voters.
- In-Person absentee voting (also known as “early voting” will start on October 22nd 2024 and run through Friday, November 1 at 4:30 p.m.
- The public test is scheduled at Recreation Park (Fairgrounds) on Tuesday, October 29 at 9:00 a.m. The clerk’s office will also conduct a pre-lat test to ensure machine cartridges are accurate, but we have not yet received the cartridges from the county.
- Poll worker training is scheduled for October 17, 2024 at the Public Safety building. We anticipate a high turnout of workers for this election.

Other clerk Info

- In addition to hiring and elections, the Clerk’s office is working on airport contract renewals and mobile food license renewals along with the day-to-day licensing needs across the city.

HR Related

- Open enrollment is now in full swing. Employees are required to submit benefits paperwork by October 25. The Clerk’s office is tracking all areas and sending out weekly reminders to management to ensure all employees are covered.
- Have been busy with individual meetings for benefits enrollment, phone and in-person interviews for the Treasurer and Economic Development Director, and meetings with the recruiter.



City Clerk, October 9, 2024

Other Parks

- Maintenance on equipment and buildings
- Park clean ups, bathrooms are open with high usage, and mowing
- Held Disc Golf Course open house on October 5th.
- Recreation Station continues grow with rentals and activities

RECREATION PROGRAMS

- Youth Football began on Sept. 7th with over 200 participants
- Youth Volleyball began on Sept. 14th with over 50 participants
- Co Rec Softball continues with 7 teams
- Co Rec Volleyball began on Sept. 15th
- Open Gyms to begin on September 23rd
- Recreation Station Pre-School Open gym continues
- Look for special events this fall
- Working on 2025 Activity Guide

AQUATIC CENTER

- Fall Maintenance and cleaning

RECREATION PARK

- Sept. 7 wedding, Sept 13-14 Rotary Fundraiser, Sept 21 wedding.
- Oct. 11-12 LARPA, Oct. 25-27 Gun Show, October 31st Halloween, Nov. Fire Dept Night Out, Nov. 7-9 Glen Miller Auction, Nov. 23rd Senior Center Craft Fair
- General upkeep and maintenance on buildings
- Midway project to be completed this fall
- Ice addition construction has been completed
- Tomah Youth Hockey and Woodsmen Hockey continues with activities at the Ice Center

Joe Protz

Joe Protz
Director Tomah Parks and Recreation

Director of Public Works and Utilities Report

September 2024

1) Street Department

The surface course of asphalt is scheduled for placement for 10/14 on the West Veterans Project. Staff has been cleaning drainage ditches on Straw St, South Hollister, and at Recreational Park parking lot. The recycling event netted just under 19,000 pounds of e waste. The leaf vac should be going out starting next week, weather dependent.

2) Sewer Department

Operations are normal. We have been dealing with another upset at the WWTF. We are working with a local company on adjusting their cleaning process.

3) Water Department

Operations are normal. The semi-annual flushing will start on 10/14/24 and continue the entire week. Operations will start on the South end of the city and progress to the North. After mains have been flushed, it is suggested that the cold water tap in the house be opened wide to flush out any colored water that may be in the service line.

4) Lake Committee

The Lake Committee's next meeting is 11/21/24 @ 5:00pm.

Respectfully Submitted

Kirk Arity

Director of Public Works and Utilities

Tomah Public Works and Utilities Employees

City Hall

Director – Kirk Arity

Office Manager – Samantha Linehan

Bookkeepers – Patricia Marten

Custodian – Scott Donovan

Water Department

Supervisor – Jeff Marten

Licensed Operators – Dennis Baldwin, Derek Nofsinger, Nathan Waege

Unlicensed Maintenance Worker – Andrew Strait

Sewer Department

Supervisor-Brandy Leis

Licensed Operators - Michael Linehan, Tom Bemis, Chad Richmond, Craig Dechant, Tony Newcomb

Unlicensed Maintenance Worker –

Public Works

Supervisor – Joe Kube

Mechanic – Mark Dixon

Equipment Operators – Lance Larson, Justin Randall, Corey Clay, Brad Rewey

Truck Drivers – Steve Schultz, Jason Burkhalter, Trey Rapp, Justin King, David McGarry, Dillon Clay-Kruger, Marvin Poff.

TOMAH POLICE DEPARTMENT

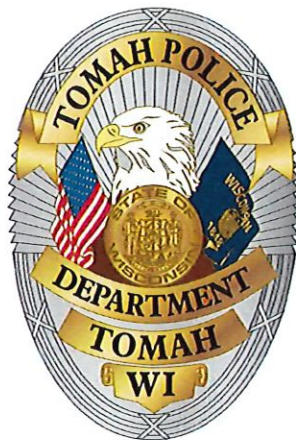

"Serving the Community"

September 2024 Report

K-9 REPORT

The Tomah Police K-9 Unit consists of Officer Adam Perkins and his partner K-9 Viktor. Officer Perkins has been employed with the Tomah Police Department since September 2011 and was selected to be the K-9 handler in late 2016.

In March 2017, Officer Perkins traveled to the Jessiffany Canine Services LLC Kennel in Iron Ridge, Wisconsin to select a K-9 partner. Officer Perkins met with the head trainer and looked at numerous dogs, ultimately selecting K-9 Viktor. K-9 Viktor is a Czech Shepherd from the Czech Republic. Officer Perkins and K-9 Viktor trained for 5 weeks at Jessiffany Canine Services and certified through Jessiffany and the American Police Canine Association (APCA) in early April.

Officer Perkins and K-9 Viktor primarily work 3rd shift but are available off duty in an on-call capacity. Officer Perkins and Viktor are also members of the Monroe County Combined Tactical Unit (CTU). K-9 Viktor is a “dual purpose” patrol dog meaning patrol work and narcotics detection. “Patrol work” encompasses handler protection, criminal apprehension, tracking, building searches, and area searches. For narcotics detection, Viktor is trained to alert on the odors of Marijuana, Methamphetamine, Cocaine/Crack Cocaine, Heroin and MDMA.

Officer Perkins and K-9 Viktor train on a frequent basis to stay proficient in the numerous tasks Viktor is trained in.

UTILIZATIONS OF IMPORTANCE

Training – Attended one 8-hour training day in Holmen, Wisconsin with other area K-9 teams. The training consisted of tracking, article searches, building drug searches, and civil building searches.

Training – Attended one 8-hour training day in West Salem, Wisconsin with other area K-9 teams. The training consisted of tracks, article searches, obedience/aggression control, outdoor area search for man, outdoor area search for drugs, apprehension in a pull behind camper, and numerous vehicle searches for drugs.

Assist – The Wisconsin State Patrol received a complaint of a semi driver flashing a pistol at another truck driver. A Trooper located the semi on Hwy 12/16 and then WB onto I-90. A high-risk traffic stop was conducted near the 39 WB mile marker. Viktor was utilized as a show of force when the driver exited. Viktor was given bark commands to further deter the driver from resisting or fleeing. The driver complied and was taken into custody without incident.

Alarm – Officers received a burglary alarm at Tractor Supply. Viktor was utilized in assisting with checking the exterior of the building. All doors/windows were secure and nothing suspicious was observed.

Assist – Monroe County Deputies were in contact with a female in Oakdale. We were off duty and responded for a vehicle sniff. A positive indication was obtained, and a search of the vehicle yielded a THC vape. All charges/arrest decision was through the Sheriff's Office.

Assist – The Town of Wilton Police Chief was investigating a parking complaint on two suspicious vehicles. We were off duty and were requested for a vehicle sniff on two vehicles. A positive indication was obtained on both vehicles. One of the vehicles had an odor of THC, but nothing was located.

Community Service – Viktor was utilized numerous times with children throughout the shifts that we worked. During the utilizations, Viktor would let the children pet him while his abilities were explained to them.

INVESTIGATIONS

Agency Assist

The Wisconsin State Patrol received a complaint about a semi driver showing a gun to another driver near Oakdale, Wisconsin. A Wisconsin State Patrol Trooper located the semi traveling Westbound on Hwy 12/16. The semi later entered I-90 Westbound at the 43-mile marker on ramp. Tomah officers responded to assist. Once officers were in place, a high-risk traffic stop was conducted near the 39 Westbound mile marker. The driver exited his semi, upon request, and was taken into custody without further incident. The case is being investigated by the Wisconsin State Patrol.

DC / Physical Abuse to Elder / Obstructing / Probation Hold

Tomah officers were dispatched to Kwik Trip South for a report of a disturbance. Officers arrived and found several witnesses standing around a 67-year-old victim, who was seated on the pavement. Witnesses stated a vehicle quickly backed out of a parking stall and accelerated through the parking lot, squealing the tires. The victim was pulling into a parking stall and honked at the driver of the speeding vehicle. The victim parked his vehicle and exited. The suspect also stopped his vehicle and approached the victim. The suspect then punched the victim in the face/head before fleeing in his vehicle. The victim fell to the pavement and struck his head. A license plate was obtained from store surveillance video and contact was made at the registered owner address. The suspect was at the residence and was taken into custody. The suspect was on Probation and Probation placed a hold on the suspect.

Battery-DVA / DC-DVA

Tomah officers were dispatched to a residence for a disturbance. Officers arrived and spoke with the involved parties. The victim stated she had come home from the store and found her boyfriend in a bad mood. The boyfriend would not calm down and slapped the female and assaulted the female, leaving bruises. The male was arrested without incident and transported to the jail.

OWI 1st / Operating After Suspension / Possession of MJ / Obstructing / Resisting / DC / Felony Bail jumping

A Tomah officer was on routine patrol and observed a vehicle commit a moving violation. The suspect vehicle turned and accelerated from an intersection. The officer turned and did not immediately see the vehicle. The vehicle was located shortly after when the officer observed brake lights distinguishing in an alleyway. The officer conducted a traffic stop on the vehicle that was occupied by a lone male in the driver's seat. The officer contacted the driver but was met with hostility from the driver. The driver refused to identify himself and refused to keep the window rolled down. While conducting the stop, the officer could smell an odor of marijuana coming from the vehicle. The officer attempted to have the driver exit the vehicle, but the driver refused. Another officer arrived on scene to assist. The driver was contacted several more times and eventually exited the vehicle, but the driver stated he would be walking into the house he was parked behind. The driver began walking toward the house and officers had to physically restrain him from continuing. A struggle ensued as the driver refused to comply with the officers demands. The driver was placed into handcuffs. The driver complained of a cut to his hand, and medical attention was provided. After medical clearance, the subject was transported jail. A search of the vehicle yielded THC associated products and paraphernalia.

Fire

Tomah officers, along with the Tomah Fire Department, were dispatched to an address for a garage fire. The caller stated the garage was fully engulfed and that the main resident was burned. Officers arrived and found the garage and residence to be engulfed in flames. As officers were approaching the residence a propane tank exploded, sending the tank up in the air. The residents had to be restrained from entering the residence to rescue two dogs, because the fire was too large and dangerous. The Tomah Fire Department arrived and began their extinguishing efforts. The male resident later advised the fire was accidentally started by the moped he was working on.

OWI 2nd

A Tomah officer was on routine patrol and observed a vehicle with a malfunctioning light. A traffic stop was conducted, and the officer contacted the driver. The driver indicated he knew about the light. During the contact with the driver, the officer observed several signs of impairment from the driver and smelled intoxicants coming from the vehicle. The driver admitted to only consuming one alcoholic beverage. The officer had the driver exit the vehicle to perform Standardized Field Sobriety Tests. The driver completed the tests, and the officer observed further clues of intoxication. The driver was subsequently placed under arrest. The driver refused a Preliminary Breath Test and the legal blood draw. A search warrant was completed and later granted by a Monroe County Circuit Court Judge. Once the search warrant was signed, the driver read it and advised he would comply. The blood draw was facilitated. The driver was later issued citations and was released to a responsible party.

PERSONNEL COMPLAINTS

September Complaints = 0 Year-To-Date Personnel Complaints = 2

EMPLOYEE LISTING BY DATE OF HIRE**September 30, 2024**

Admin. Asst. Rhonda Culpitt	12/12/1994
Chief Scott Holum	05/02/1999
Officer Melanie Marshall	05/28/2000
Lieutenant Paul Sloan	05/13/2001
Investigator Brittney Westpfahl	01/16/2005
Assistant Chief Eric Pedersen	07/09/2005
Officer Steven Keller	08/14/2005
Lieutenant Jarrod Furlano	01/13/2008
Sergeant Adam Perkins	09/04/2011
Sergeant Brandon Kuhn	10/12/2015
Sergeant Wilbert Steinborn	08/19/2018
Sergeant Cody Paulson	09/24/2018
Police Clerk Ashley Bankhead	03/11/2019
Police Clerk DeAnn Batten	06/17/2019
Officer Alexander Brueggeman	12/08/2019
Investigator Lindsey Stoughtenger	01/24/2021
Officer Jayden Olson	07/11/2021
Evidence Tech Mark Nicholson	08/08/2021
Officer Justice Blackhawk	10/10/2021
Officer Audra Gomez	06/01/2022
Officer John Reigel	06/12/2022
Officer Ethan Pedersen	01/01/2023
Officer Brandon Bellacero	01/01/2024
Officer Bradley Hoffman	06/03/2024

2024 OPERATING WHILE INTOXICATED STATISTICS

CASE #	AGE	SEX	1ST	2ND	3RD	4TH	5TH	6TH	7TH	8TH	9TH	10TH	BAC	RSC	REFUSAL	ACCIDENT	REST SUBSTANCE TYPE
#24-0001	27	M	X										0.124				
#24-0002	36	F	X										0.160				
#24-0029	26	M	X										0.295				
#24-0120	40	M			X								0.133		X		
#24-0165	26	M	X										0.184				
#24-0166	21	M	X										0.116				
#24-0176	38	M	X										0.021				Pending
#24-0196	30	F	X										0.152				
#24-0255	43	F			X								0.344		X	X	
#24-0290	69	M	X										0.078		X		
#24-0326	40	M			X								0.203				
#24-0338	33	M			X								0.243				
#24-0370	33	F		X									0.112				
#24-0386	26	M	X										0.188				
#24-0398	31	F			X								0.000		X		
#24-0417	23	M	X										0.238		X		
#24-0481	37	M			X								0.262		X		
#24-0593	45	M				X							0.210		X		
#24-0627	40	F	X										0.295			X	
#24-0629	41	M					X						0.181				
#24-0794	42	M	X										0.176				
#24-0800	17	M	X										0.000		X		
#24-0821	36	F		X									0.114			X	
#24-0860	49	M	X										0.287				
#24-0893	37	F	X										0.110		X		
#24-0915	23	M	X										0.184				
#24-0957	56	F	X										0.235				
#24-0990	36	M	X										0.148			X	
#24-0991	27	M	X										0.113				
#24-1005	44	M	X										0.157				
#24-1018	37	M				X							0.188		X		
#24-1035	42	M	X										0.157				
#24-1036	26	M	X										0.188				
#24-1042	39	M	X										0.188		X		
#24-1054	55	M											0.188		X		
#24-1091	48	F		X									0.188		X		

Passenger Under 16, Pending

Pending

Pending



TOPD Monthly Report

Printed on October 1, 2024

: Total: 2**911 : 911 CHECK Total: 11****911HANG : 911 ABANDONED Total: 15****911OPEN : 911 OPEN LINE Total: 18****ACC PD : ACCIDENT WITH PROPERTY DAMAGE Total: 29****ACC PI : ACCIDENT WITH INJURIES Total: 2****ACC UNK : ACCIDENT UNKNOWN INJURIES Total: 2****ALARM : ALARM - HOLDUP OR BURGLARY Total: 11****AMBULANCE : AMBULANCE CALL Total: 53****ANIMAL : ANIMAL COMPLAINT/NOT A BITE Total: 38****ASSIST : ASSIST OTHER AGENCY Total: 9****ATL : ATTEMPT TO LOCATE Total: 9****BATTERY : BATTERY/ASSAULT Total: 1****BIKE : ABANDONED/FOUND BICYCLE Total: 4****BITE : ANIMAL BITE Total: 2****BUILD CHK : BUILDING CHECK Total: 2****CHILD : CHILD ABUSE/NEGLECT Total: 3****CIT ASST : CITIZEN ASSIST Total: 61****COMMITMENT : INVOLUNTARY COMMITMENT/CHAPTER Total: 1****COMMUNITY RELATIONS : COMMUNITY RELATIONS Total: 7****COURT ORDER : VIOLATION OF COURT ORDER Total: 6****CROSS GUARD : CROSSING GUARD DUTY BY OFFICER Total: 5****CUSTODY : CHILD CUSTODY ISSUE Total: 6****DAMAGE : DAMAGE TO PROPERTY Total: 11****DEATH : DECEASED SUBJECT Total: 3**

DISTURB : DISTURBANCE Total: 10
DOMESTIC : DOMESTIC DISTURBANCE Total: 1
DRUG : DRUG INFO/COMPLAINTS Total: 14
ENTRY : ENTRY TO VEH OR DWELLING Total: 4
ESCORT : ESCORT Total: 3
EXTRA : EXTRA PATROL Total: 34
FIGHT : FIGHT Total: 6
FIRE ALARM : FIRE ALARM Total: 1
FIRE : FIRE Total: 4
FOLLOWUP : FOLLOWUP/INTERVIEW TO PREVIOUSLY INCIDENT Total: 53
FRAUD : FRAUD Total: 10
HARASS : HARASSMENT Total: 12
INFO : GENERAL INFORMATION CALL Total: 6
LITTERING : LITTERING OR UNLAWFUL DUMPING Total: 2
MISSING : MISSING PERSON Total: 4
MOTOR ASSIST : MOTORIST ASSIST Total: 17
NOISE : NOISE OR LOUD PARTY COMPLAINT Total: 9
ODOR : NATURAL GAS OR OTHER ODOR Total: 3
ORD VIO : ORDINANCE VIOLATION Total: 1
OWP : OUT WITH PARTY Total: 69
PAPER : PAPER SERVICE Total: 8
PARKING : PARKING COMPLAINT Total: 18
PHONE CALL : MAKE/RECEIVE PHONE CALL Total: 90
PROPERTY : FOUND/LOST/RECOVERED PROPERTY Total: 31
PUBWKS : DPW/STREETS/SEWER/UTILITIES CALLS Total: 1
REPO : VEHICLE REPOSESSION Total: 1
RUNAWAY : JUVENILE RUNAWAY Total: 1
SEX OFFENSE : SEX OFFENSE Total: 5
SHOTS : POSSIBLE SHOTS FIRED Total: 2

SIGN/SIGNAL : ROAD SIGN/SIGNAL DOWN OR NEEDS REPAIR Total: 3
STANDBY : STANDBY Total: 1
SUSPICIOUS : SUSPICIOUS ACTIVITY Total: 58
THEFT : THEFT Total: 19
THREATS : THREATS COMPLAINT Total: 8
TRAFFIC CNTL : BLOCKING/DIRECTING TRAFFIC Total: 2
TRAFFIC COMP : TRAFFIC/DRIVING COMPLAINT Total: 19
TRAFFIC HZRD : TRAFFIC HAZARD Total: 10
TRAFFIC STOP : TRAFFIC STOP Total: 161
TRESPASS : TRESPASSING Total: 19
TRUANCY : TRUANCY COMPLAINT Total: 6
TWJ : TROUBLE WITH JUVENILE Total: 22
TWP : TROUBLE WITH PARTY Total: 56
UNDERAGE : UNDERAGE PARTY/DRINK/TOBACCO Total: 4
VEH STOLEN : STOLEN VEHICLE Total: 3
WELFARE : WELFARE CHECK Total: 82
Total Records: 1204

STAFF COMMITTEE PREPARATION REPORT

Agenda Item:

Special Beer Permit Application by Queen of the Apostles for Queen of the Apostles Fall Fest on October 20, 2024.

Summary and Background Information:

(Appropriate Documentation Attached)

Queen of the Apostles has applied for a Temporary Class “B” License to sell fermented malt beverages at its event being held at Queen of the Apostles’ school gym located at 315 W Monroe Street in Tomah on Sunday, October 20, 2024.

Fiscal Note:

The revenue generated to the City of Tomah by issuance of this license is \$10.

Recommendation:

It is requested that the Committee of the Whole review the application and make a recommendation for the Common Council to approve the Special Beer Permit.

Respectfully submitted by:

Nicole E. Jacobs

Committee: Committee of the Whole & Common Council

Meeting Date: October 14 & 15, 2024

Application for Temporary Class "B" / "Class B" Retailer's License

See Additional Information on reverse side. Contact the municipal clerk if you have questions.

FEE \$10.00

Application Date: 10/02/2024

Town Village City of Tomah

County of Monroe

The named organization applies for: (check appropriate box(es).)

- A Temporary Class "B" license to sell fermented malt beverages at picnics or similar gatherings under s. 125.26(6), Wis. Stats.
- A Temporary "Class B" license to sell wine at picnics or similar gatherings under s. 125.51(10), Wis. Stats.

at the premises described below during a special event beginning 10/20/2024 and ending 10/20/2024 and agrees to comply with all laws, resolutions, ordinances and regulations (state, federal or local) affecting the sale of fermented malt beverages and/or wine if the license is granted.

- 1. Organization** (check appropriate box) →
- Bona fide Club
 - Church
 - Lodge/Society
 - Veteran's Organization
 - Fair Association or Agricultural Society
 - Chamber of Commerce or similar Civic or Trade Organization organized under ch. 181, Wis. Stats.

(a) Name Queen of the Apostles

(b) Address 303 W. Monore, Tomah WI 54660
(Street) Town Village City

(c) Date organized 07/01/2015

(d) If corporation, give date of incorporation 07/01/2015

(e) If the named organization is not required to hold a Wisconsin seller's permit pursuant to s. 77.54 (7m), Wis. Stats., check this box:

(f) Names and addresses of all officers:

President Rev. Ethan Hokamp, Pastor 303 W. Monroe, Tomah WI 54660

Vice President _____

Secretary Ryan Bliznik 419 Nicholas St., Tomah WI 54660

Treasurer Debra Welch 1845 Grumann, Tomah WI 54660

(g) Name and address of manager or person in charge of affair: Cindy Bailey 303 W. Monroe, Tomah Wi 54660

2. Location of Premises Where Beer and/or Wine Will Be Sold, Served, Consumed, or Stored, and Areas Where Alcohol Beverage Records Will be Stored:

(a) Street number 315 W. Monroe, Tomah Wi 54660

(b) Lot _____ Block _____

(c) Do premises occupy all or part of building? Part

(d) If part of building, describe fully all premises covered under this application, which floor or floors, or room or rooms, license is to cover: School Gym

3. Name of Event

(a) List name of the event Queen of the Apostles Fall Fest.

(b) Dates of event 10/20/2024

DECLARATION

An officer of the organization, declares under penalties of law that the information provided in this application is true and correct to the best of his/her knowledge and belief. Any person who knowingly provides materially false information in an application for a license may be required to forfeit not more than \$1,000.

Officer Rev. Ethan Hokamp 10/2/24
(Signature / Date)

Queen of the Apostles
(Name of Organization)

Date Filed with Clerk 10/2/2024

Date Reported to Council or Board 10/15/2024

Date Granted by Council _____

License No. _____

STAFF COMMITTEE PREPARATION REPORT

Agenda Item: Approval of TID 9 funds for additional street lighting

Summary and Background Information: Attached

Recommendation From: Public Works and Utilities Commission

Minutes Attached:

Yes No

Budget Account: 17-57331-8553

Fiscal Impact: \$16,203.95 – TID eligible expense

Staff Responsible for implementation: Director of Public Works and Utilities

Economic Impact: n/a

Zoning/Rezoning Issues: n/a

Supports Organizational Goals:

Yes No

Questions from SET:

Grants Pursued/Opportunity Pursued: n/a

Recommendation: The Public Works and Utilities Commission recommends the addition of street lights as requested by Wal Mart DC.

Molly Pines
SET

10/08/2024
Date

[Signature]
Department Director

10/8/24
Date

Committee: Committee of the Whole and/or Common Council
Meeting Date(s):

STAFF COMMITTEE PREPARATION REPORT

Agenda Item:

Approval Request for Additional Street Lighting for Industrial Ave.

**Summary and background information:
(Appropriate documents attached)**

Wal-Mart DC has requested additional street lighting along Industrial Ave for the two entrances and Rusch/Industrial Ave. intersection. A recent bicycle and vehicle accident has brought heightened awareness to this area. Wal-Mart has approx. 850 employees and bimodal transportation has become more prevalent in this area.

Fiscal Note:

\$16,203.95 – TIF funding available

Recommendation:

I recommend approval of the installation of solar street lighting including the Rusch/Industrial Ave. intersection and coverage for the Wal-Mart DC entrances along Industrial Ave. Funding would be from TID dollars and installation by Alliant Energy.



Public Works Director
Kirk Arity

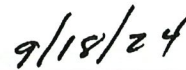

Date



525 Industrail Ave
Tomah, WI, 54660
(608) 374-8500
Travis.Scholze@Walmart.com

9/10/2024

Kirk Arity
City of Tomah
819 Superior Ave
Tomah, WI, 54660

I hope this email finds you well. As a senior leader at Walmart, I am writing to respectfully request that streetlights be installed in front of the Walmart Distribution Center located at 525 Industrial Avenue. Our commitment to ensuring the safety and well-being of our associates and drivers is of utmost importance, and I believe that the installation of streetlights will significantly contribute to achieving this goal.

The current lack of proper lighting in the area has been a concern for us, particularly during evening hours when the facility is open 24/7. The dimly lit conditions can create challenges for associates and drivers navigating the street, as well as for those using alternative transportation to and from the facility. Moreover, the darkness can potentially increase the risk of accidents and criminal activity.

By installing streetlights in front of the DC, we can significantly improve the overall safety and security of the area, which aligns with Walmart's commitment to providing a safe and welcoming environment for our customers and associates. The improved lighting will not only enhance the aesthetic appeal of the area but also contribute to the overall quality of life for the community.

We understand that the installation process may require coordination and planning, and we are more than willing to collaborate closely with your team to ensure a seamless and successful installation. We believe that the benefits of improved lighting far outweigh any potential costs or inconvenience, and we are confident that the installation of streetlights will have a positive impact on the community.

We would greatly appreciate the opportunity to discuss this matter further and work together to improve the safety and well-being of our customers and associates. Please let us know if there are any questions or concerns, and we look forward to hearing from you soon.

Thank you for your time and consideration.

Sincerely,

Travis Scholze
Assistant General Manager
Walmart DC 6085

Kirk Arity

From: Fritz, Peter <PeterFritz@alliantenergy.com>
Sent: Wednesday, September 18, 2024 7:29 AM
To: Kirk Arity
Subject: Light near Walmart DC
Attachments: CITY TOMAH LIGHTING OPTIONS.pdf; MS1 LIGHT INFO.pdf

Hey Kirk,

Good seeing you the other day. Below I have provided an over all quote to run lighting to 5 new concrete structures near Walmart DC. Attached I have an overview map showing the pole locations (these can be moved from the locations shown). The red circles are the new concrete poles and light. The red dashed line is the duplex cable we would bury.

UPFRONT COST

5 concrete poles @ \$1778.23 X 5 = \$8891.15
1430' Duplex cable – 750 free footage → 680' billable X \$0.96/ft = \$652.80
1180' Trench/plow – 750' free footage → 430' billable X \$6.75/ft = \$2902.50
250' Directional drill Road and Walmart Driveway X \$16.93/ft = \$4232.50
-\$95 Light Allowance X 5 = - \$475.00
TOTAL = \$16,203.95

Yearly cost

Fixture Charge = \$40.50-\$43.00 per year depending on size light picked
Concrete Pole = \$67.20 per year

If you have any questions please let me know.

Thank you,

Peter Fritz
Engineering Technician
Cell: 608-963-5676



From: Kirk Arity <karity@TOMAHWI.GOV>
Sent: Thursday, September 12, 2024 12:56 PM
To: Fritz, Peter <PeterFritz@alliantenergy.com>
Subject: [EXTERNAL] RE: street lights

Sounds good. See you then.



800 ft

Legend

- Feature 1

ITEM 6. CITY TOMH LIGHTING BY WALMART

Write a description for your map.

EXISTING LIGHT, UPSIZE LIGHT TO CATEGORY C



Cardinal IG Plant #1 shipping

Google Earth

© 2024 Airbus

RESOLUTION NO : _____

RESOLUTION AUTHORIZING
PAYMENT OF MONTHLY BILLS

Be it resolved by the Common Council of the City of Tomah that the Committee of the Whole has reviewed the monthly bills and recommends the City Council approve said bills as follows:

1. Pre-Paid Checks:	2024	\$1,895,581.64	Check #'s:	145445	145461
				145491	145601
2. Payroll:		\$301,378.94	Dir Dep #'s:	9303867	9304100
3. Wire/ACH Transfers:		\$478,202.87			
4. Invoices:		\$28,846.27			
Total:		<u><u>\$2,704,009.72</u></u>			

Mayor

Clerk

Requested by: Finance Department

Submitted by: Committee of the Whole

October 14, 2024

GL Period	Check Issue Date	Check Number	Vendor Number	Payee	Invoice Number	Invoice Sequence	Invoice GL Account	Discount Taken	Invoice Amount	Check Amount
145380										
10/24	10/03/2024	145380	11	ACE HARDWARE (PUBLIC WOR	625236	1	01-51600-3500	.00	28.77	28.77
10/24	10/03/2024	145380	11	ACE HARDWARE (PUBLIC WOR	625290	1	01-53311-3512	.00	35.17	35.17
10/24	10/03/2024	145380	11	ACE HARDWARE (PUBLIC WOR	625307	1	01-53311-3405	.00	22.07	22.07
10/24	10/03/2024	145380	11	ACE HARDWARE (PUBLIC WOR	625370	1	01-51600-3500	.00	4.59	4.59
10/24	10/03/2024	145380	11	ACE HARDWARE (PUBLIC WOR	625454	1	01-53311-3408	.00	53.34	53.34
10/24	10/03/2024	145380	11	ACE HARDWARE (PUBLIC WOR	625577	1	01-53311-3408	.00	49.29	49.29
10/24	10/03/2024	145380	11	ACE HARDWARE (PUBLIC WOR	625598	1	01-53311-3508	.00	11.99	11.99
10/24	10/03/2024	145380	11	ACE HARDWARE (PUBLIC WOR	625674	1	01-53311-3508	.00	8.59	8.59
10/24	10/03/2024	145380	11	ACE HARDWARE (PUBLIC WOR	625710	1	01-53311-3508	.00	49.94	49.94
10/24	10/03/2024	145380	11	ACE HARDWARE (PUBLIC WOR	625798	1	01-53311-3508	.00	10.99	10.99
10/24	10/03/2024	145380	11	ACE HARDWARE (PUBLIC WOR	625837	1	01-53311-3508	.00	199.99	199.99
10/24	10/03/2024	145380	11	ACE HARDWARE (PUBLIC WOR	625840	1	01-53311-3508	.00	3.58	3.58
10/24	10/03/2024	145380	11	ACE HARDWARE (PUBLIC WOR	625848	1	01-53311-3508	.00	74.75	74.75
10/24	10/03/2024	145380	11	ACE HARDWARE (PUBLIC WOR	625858	1	01-53311-3405	.00	19.98	19.98
10/24	10/03/2024	145380	11	ACE HARDWARE (PUBLIC WOR	625913	1	01-51600-3500	.00	5.99	5.99
10/24	10/03/2024	145380	11	ACE HARDWARE (PUBLIC WOR	625940	1	01-53311-3508	.00	19.95	19.95
Total 145380:								.00		598.98
145381										
10/24	10/03/2024	145381	27	ALL AMERICAN DO-IT CENTER	67052/3	1	01-53311-3508	.00	1.99	1.99
Total 145381:								.00		1.99
145382										
10/24	10/03/2024	145382	34	ALLSTATE PETERBILT OF TOM	5203123103	1	01-53635-3500	.00	3,512.77	3,512.77
10/24	10/03/2024	145382	34	ALLSTATE PETERBILT OF TOM	5204225279	1	01-53620-3500	.00	320.66	320.66
Total 145382:								.00		3,833.43
145383										
10/24	10/03/2024	145383	2403	ASSOCIATED APPRAISAL CON	176703	1	01-51530-2100	.00	3,877.03	3,877.03
Total 145383:								.00		3,877.03
145384										
10/24	10/03/2024	145384	1960	AT&T MOBILITY - PUBLIC WOR	2873030559	1	01-15610	.00	496.69	496.69
10/24	10/03/2024	145384	1960	AT&T MOBILITY - PUBLIC WOR	2873030559	2	01-15620	.00	146.49	146.49

M = Manual Check, V = Void Check

GL Period	Check Issue Date	Check Number	Vendor Number	Payee	Invoice Number	Invoice Sequence	Invoice GL Account	Discount Taken	Invoice Amount	Check Amount
10/24	10/03/2024	145384	1960	AT&T MOBILITY - PUBLIC WOR	2873030559	3	01-51600-2230	.00	36.53	36.53
10/24	10/03/2024	145384	1960	AT&T MOBILITY - PUBLIC WOR	2873030559	4	01-53311-2230	.00	36.53	36.53
10/24	10/03/2024	145384	1960	AT&T MOBILITY - PUBLIC WOR	2873030559	5	01-53311-2230	.00	32.53	32.53
10/24	10/03/2024	145384	1960	AT&T MOBILITY - PUBLIC WOR	2873030559	6	01-52200-2230	.00	32.53	32.53
10/24	10/03/2024	145384	1960	AT&T MOBILITY - PUBLIC WOR	2873030559	7	01-52200-2230	.00	8.03	8.03
10/24	10/03/2024	145384	1960	AT&T MOBILITY - PUBLIC WOR	2873030559	8	01-53100-2230	.00	24.69	24.69
10/24	10/03/2024	145384	1960	AT&T MOBILITY - PUBLIC WOR	2873030559	9	01-53100-2230	.00	12.18	12.18
10/24	10/03/2024	145384	1960	AT&T MOBILITY - PUBLIC WOR	2873030559	10	01-51415-2230	.00	41.53	41.53
10/24	10/03/2024	145384	1960	AT&T MOBILITY - PUBLIC WOR	2873030559	11	01-51415-2230	.00	36.53	36.53
10/24	10/03/2024	145384	1960	AT&T MOBILITY - PUBLIC WOR	2873030559	12	01-51415-2230	.00	36.53	36.53
10/24	10/03/2024	145384	1960	AT&T MOBILITY - PUBLIC WOR	2873030559	13	01-52400-2230	.00	41.53	41.53
10/24	10/03/2024	145384	1960	AT&T MOBILITY - PUBLIC WOR	2873030559	14	01-52400-2230	.00	32.53	32.53
10/24	10/03/2024	145384	1960	AT&T MOBILITY - PUBLIC WOR	2873030559	15	01-52400-2230	.00	36.53	36.53
10/24	10/03/2024	145384	1960	AT&T MOBILITY - PUBLIC WOR	2873030559	16	01-55200-2230	.00	36.53	36.53
10/24	10/03/2024	145384	1960	AT&T MOBILITY - PUBLIC WOR	2873030559	17	01-55200-2230	.00	32.51	32.51
10/24	10/03/2024	145384	1960	AT&T MOBILITY - PUBLIC WOR	2873030559	18	01-55200-2230	.00	32.51	32.51
Total 145384:								.00		1,152.93
145385										
10/24	10/03/2024	145385	2341	AUTO VALUE TOMAH (STREET)	522227850	1	01-53311-3512	.00	163.80	163.80
10/24	10/03/2024	145385	2341	AUTO VALUE TOMAH (STREET)	5222279140	1	01-53311-3402	.00	17.99	17.99
10/24	10/03/2024	145385	2341	AUTO VALUE TOMAH (STREET)	522276292	1	01-53311-3405	.00	12.99	12.99
10/24	10/03/2024	145385	2341	AUTO VALUE TOMAH (STREET)	522277041	1	01-53311-3408	.00	118.86	118.86
10/24	10/03/2024	145385	2341	AUTO VALUE TOMAH (STREET)	522277092	1	01-53311-3408	.00	9.99	9.99
10/24	10/03/2024	145385	2341	AUTO VALUE TOMAH (STREET)	522277439	1	01-53311-3408	.00	4.99	4.99
10/24	10/03/2024	145385	2341	AUTO VALUE TOMAH (STREET)	522277440	1	01-53311-3408	.00	2.49	2.49
10/24	10/03/2024	145385	2341	AUTO VALUE TOMAH (STREET)	522277818	1	01-53311-3512	.00	19.36	19.36
10/24	10/03/2024	145385	2341	AUTO VALUE TOMAH (STREET)	522277897	1	01-53311-3502	.00	14.51	14.51
10/24	10/03/2024	145385	2341	AUTO VALUE TOMAH (STREET)	522278279	1	01-53620-3400	.00	599.99	599.99
10/24	10/03/2024	145385	2341	AUTO VALUE TOMAH (STREET)	522278603	1	01-53311-3512	.00	83.80	83.80
10/24	10/03/2024	145385	2341	AUTO VALUE TOMAH (STREET)	522278652	1	01-53311-3512	.00	15.24	15.24
10/24	10/03/2024	145385	2341	AUTO VALUE TOMAH (STREET)	522278670	1	01-53311-3512	.00	28.66	28.66
10/24	10/03/2024	145385	2341	AUTO VALUE TOMAH (STREET)	522278974	1	01-53311-3408	.00	19.98	19.98
10/24	10/03/2024	145385	2341	AUTO VALUE TOMAH (STREET)	522279089	1	01-53311-3402	.00	3,303.00	3,303.00
10/24	10/03/2024	145385	2341	AUTO VALUE TOMAH (STREET)	522279217	1	01-53311-3402	.00	12.99	12.99
10/24	10/03/2024	145385	2341	AUTO VALUE TOMAH (STREET)	522279284	1	01-53311-3402	.00	4.49	4.49
10/24	10/03/2024	145385	2341	AUTO VALUE TOMAH (STREET)	522279293	1	01-53311-3402	.00	770.39	770.39
10/24	10/03/2024	145385	2341	AUTO VALUE TOMAH (STREET)	522279387	1	01-53620-3400	.00	24.99	24.99

M = Manual Check, V = Void Check

GL Period	Check Issue Date	Check Number	Vendor Number	Payee	Invoice Number	Invoice Sequence	Invoice GL Account	Discount Taken	Invoice Amount	Check Amount
Total 145385:								.00		5,228.51
145386										
10/24	10/03/2024	145386	218	BAUMGART, EMIL	OCT 2024	1	01-52400-2100	.00	500.00	500.00
10/24	10/03/2024	145386	218	BAUMGART, EMIL	SEPT 2024	1	01-52400-2100	.00	500.00	500.00
Total 145386:								.00		1,000.00
145387										
10/24	10/03/2024	145387	2501	BEHRLY CREATIVE LLC	09.30.2024	1	01-51440-3400	.00	871.00	871.00
Total 145387:								.00		871.00
145388										
10/24	10/03/2024	145388	2177	BOGIE ENTERPRISES INC	24-0024244	1	01-53620-3500	.00	2,627.22	2,627.22
10/24	10/03/2024	145388	2177	BOGIE ENTERPRISES INC	24-0024297	1	01-53620-3500	.00	1,165.70	1,165.70
Total 145388:								.00		3,792.92
145389										
10/24	10/03/2024	145389	96	BOUND TREE MEDICAL LLC	85495056	1	03-52300-3402	.00	66.52	66.52
10/24	10/03/2024	145389	96	BOUND TREE MEDICAL LLC	85496667	1	03-52300-3402	.00	2,112.51	2,112.51
Total 145389:								.00		2,179.03
145390										
10/24	10/03/2024	145390	2365	Brightspeed	301313471 1	1	01-53510-2230	.00	34.29	34.29
10/24	10/03/2024	145390	2365	Brightspeed	301313476 1	1	02-56910-2230	.00	68.58	68.58
10/24	10/03/2024	145390	2365	Brightspeed	301313477 1	1	01-53311-2230	.00	171.21	171.21
Total 145390:								.00		274.08
145391										
10/24	10/03/2024	145391	2287	CANON FINANCIAL SERVICES I	35271757	1	01-51420-3100	.00	49.86	49.86
Total 145391:								.00		49.86

M = Manual Check, V = Void Check

GL Period	Check Issue Date	Check Number	Vendor Number	Payee	Invoice Number	Invoice Sequence	Invoice GL Account	Discount Taken	Invoice Amount	Check Amount
145392										
10/24	10/03/2024	145392	132	CHASING DAYLIGHT ANIMAL S	SEPT 24	1	01-52100-3400	.00	500.00	500.00
Total 145392:								.00		500.00
145393										
10/24	10/03/2024	145393	2054	CLIFTON LARSON ALLEN LLP	L241633995	1	01-51540-2100	.00	900.07	900.07
10/24	10/03/2024	145393	2054	CLIFTON LARSON ALLEN LLP	L241633995	2	01-15610	.00	480.53	480.53
10/24	10/03/2024	145393	2054	CLIFTON LARSON ALLEN LLP	L241633995	3	01-15620	.00	295.94	295.94
Total 145393:								.00		1,676.54
145394										
10/24	10/03/2024	145394	2364	Column Software PBC	SEPT 30,202	1	01-51440-3200	.00	112.66	112.66
10/24	10/03/2024	145394	2364	Column Software PBC	SEPT 30,202	2	01-51100-3200	.00	601.56	601.56
10/24	10/03/2024	145394	2364	Column Software PBC	SEPT 30,202	3	01-51420-3200	.00	67.91	67.91
Total 145394:								.00		782.13
145395										
10/24	10/03/2024	145395	436	CONSOLIDATED ENERGY COM	2887719	1	01-53311-3401	.00	45.16	45.16
10/24	10/03/2024	145395	436	CONSOLIDATED ENERGY COM	2887720	1	01-53311-3401	.00	32.23	32.23
Total 145395:								.00		77.39
145396										
10/24	10/03/2024	145396	2100	DAVID JOHNSON	066525	1	01-53635-3400	.00	1,000.00	1,000.00
Total 145396:								.00		1,000.00
145397										
10/24	10/03/2024	145397	2664	DOBBERSTEIN LAW FIRM LLC	PP #20 KER	1	01-21590	.00	62.99	62.99
Total 145397:								.00		62.99
145398										
10/24	10/03/2024	145398	220	EO JOHNSON CO	#1618944	1	01-52100-2900	.00	259.00	259.00

M = Manual Check, V = Void Check

GL Period	Check Issue Date	Check Number	Vendor Number	Payee	Invoice Number	Invoice Sequence	Invoice GL Account	Discount Taken	Invoice Amount	Check Amount
Total 145398:								.00		259.00
145399										
10/24	10/03/2024	145399	223	ESS BROTHERS & SONS INC	EE7678	1	01-53311-3405	.00	280.00	280.00
Total 145399:								.00		280.00
145400										
10/24	10/03/2024	145400	226	EVEREST EMERGENCY VEHICL	P07468	1	03-52300-3500	.00	200.05	200.05
Total 145400:								.00		200.05
145401										
10/24	10/03/2024	145401	255	FIRST SUPPLY LLC-LA CROSSE	3587712-00	1	01-55200-3400	.00	184.00	184.00
Total 145401:								.00		184.00
145402										
10/24	10/03/2024	145402	2194	GOODYEAR COMMERCIAL TIR	128-1157554	1	01-53311-3501	.00	1,401.08	1,401.08
Total 145402:								.00		1,401.08
145403										
10/24	10/03/2024	145403	299	HAGEN SPORTS NETWORK	OCTOBER 2	1	01-51100-3200	.00	375.00	375.00
Total 145403:								.00		375.00
145404										
10/24	10/03/2024	145404	349	J-J'S FLORAL SHOP LLC	1000034836	1	01-51100-3400	.00	69.95	69.95
Total 145404:								.00		69.95
145405										
10/24	10/03/2024	145405	396	LEXISNEXIS RISK DATA MANAG	1378284-202	1	01-52100-2900	.00	204.50	204.50
Total 145405:								.00		204.50

M = Manual Check, V = Void Check

GL Period	Check Issue Date	Check Number	Vendor Number	Payee	Invoice Number	Invoice Sequence	Invoice GL Account	Discount Taken	Invoice Amount	Check Amount
145406										
10/24	10/03/2024	145406	2328	LYNXX NETWORKS	631700 10.2	1	01-53510-2240	.00	100.59	100.59
10/24	10/03/2024	145406	2328	LYNXX NETWORKS	802300 10.2	1	03-52300-2230	.00	669.21	669.21
10/24	10/03/2024	145406	2328	LYNXX NETWORKS	809500 10.2	1	01-53311-2230	.00	100.59	100.59
Total 145406:								.00		870.39
145407										
10/24	10/03/2024	145407	416	MATHY CONSTRUCTION COMP	5200023772	1	01-53311-3405	.00	2,648.40	2,648.40
Total 145407:								.00		2,648.40
145408										
10/24	10/03/2024	145408	442	MISSISSIPPI WELDERS SUPPL	1812548	1	03-52300-3400	.00	12.60	12.60
10/24	10/03/2024	145408	442	MISSISSIPPI WELDERS SUPPL	509970	1	03-52300-3400	.00	138.68	138.68
Total 145408:								.00		151.28
145409										
10/24	10/03/2024	145409	454	MONROE CO TREASURER	SEPT 24 CO	1	01-24300	.00	1,388.50	1,388.50
Total 145409:								.00		1,388.50
145410										
10/24	10/03/2024	145410	466	MOTOROLA SOLUTIONS INC	#828198899	1	08-57210-8400	.00	5,228.00	5,228.00
Total 145410:								.00		5,228.00
145411										
10/24	10/03/2024	145411	858	NICHOLSON, JANICE	CONF MEAL	1	01-51200-3300	.00	71.78	71.78
10/24	10/03/2024	145411	858	NICHOLSON, JANICE	MILAGE WIS	1	01-51200-3300	.00	67.00	67.00
Total 145411:								.00		138.78
145412										
10/24	10/03/2024	145412	2280	OLSON, JAYDEN	IUNCH 9-17-	1	01-52100-3350	.00	14.56	14.56
Total 145412:								.00		14.56

M = Manual Check, V = Void Check

GL Period	Check Issue Date	Check Number	Vendor Number	Payee	Invoice Number	Invoice Sequence	Invoice GL Account	Discount Taken	Invoice Amount	Check Amount
145413										
10/24	10/03/2024	145413	2117	PAUL SLOAN	Ed Reimb Su	1	01-52100-3360	.00	646.12	646.12
Total 145413:								.00		646.12
145414										
10/24	10/03/2024	145414	469	PENNY J. PRECOUR ATTORNE	OCT 2024	1	01-51300-2100	.00	2,700.00	2,700.00
Total 145414:								.00		2,700.00
145415										
10/24	10/03/2024	145415	2607	POINT C HEALTH	PCH1033063	1	03-52300-1340	.00	5.50	5.50
10/24	10/03/2024	145415	2607	POINT C HEALTH	PCH1033063	2	03-52300-1340	.00	5.50	5.50
10/24	10/03/2024	145415	2607	POINT C HEALTH	PCH1033063	3	03-52300-1340	.00	5.50	5.50
10/24	10/03/2024	145415	2607	POINT C HEALTH	PCH1033063	4	03-52300-1340	.00	5.50	5.50
10/24	10/03/2024	145415	2607	POINT C HEALTH	PCH1033063	5	03-52300-1340	.00	5.50	5.50
10/24	10/03/2024	145415	2607	POINT C HEALTH	PCH1033063	6	03-52300-1340	.00	5.50	5.50
10/24	10/03/2024	145415	2607	POINT C HEALTH	PCH1033063	7	01-53100-1340	.00	5.50	5.50
10/24	10/03/2024	145415	2607	POINT C HEALTH	PCH1033063	8	01-51200-1340	.00	5.50	5.50
10/24	10/03/2024	145415	2607	POINT C HEALTH	PCH1033063	9	10-55110-1340	.00	5.50	5.50
10/24	10/03/2024	145415	2607	POINT C HEALTH	PCH1033063	10	01-52100-1340	.00	5.50	5.50
10/24	10/03/2024	145415	2607	POINT C HEALTH	PCH1033063	11	01-52100-1340	.00	5.50	5.50
10/24	10/03/2024	145415	2607	POINT C HEALTH	PCH1033063	12	01-52100-1340	.00	5.50	5.50
10/24	10/03/2024	145415	2607	POINT C HEALTH	PCH1033063	13	01-15620	.00	5.50	5.50
10/24	10/03/2024	145415	2607	POINT C HEALTH	PCH1033063	14	12-55500-1340	.00	5.50	5.50
10/24	10/03/2024	145415	2607	POINT C HEALTH	PCH1033063	15	01-51520-1340	.00	5.50	5.50
10/24	10/03/2024	145415	2607	POINT C HEALTH	PCH1033063	16	01-15610	.00	5.50	5.50
10/24	10/03/2024	145415	2607	POINT C HEALTH	PCH1033063	17	01-15610	.00	5.50	5.50
10/24	10/03/2024	145415	2607	POINT C HEALTH	PCH1033063	18	01-52100-1340	.00	5.50	5.50
Total 145415:								.00		99.00
145416										
10/24	10/03/2024	145416	1776	PRIME MEDIA	#253976-IN	1	01-52100-3100	.00	171.12	171.12
Total 145416:								.00		171.12
145417										
10/24	10/03/2024	145417	547	REGISTRATION FEE TRUST	REG RENE	1	01-52100-3500	.00	212.00	212.00

M = Manual Check, V = Void Check

GL Period	Check Issue Date	Check Number	Vendor Number	Payee	Invoice Number	Invoice Sequence	Invoice GL Account	Discount Taken	Invoice Amount	Check Amount
Total 145417:								.00		212.00
145418										
10/24	10/03/2024	145418	550	REINDERS INC	6058525-00	1	01-55200-3500	.00	1,024.30	1,024.30
Total 145418:								.00		1,024.30
145419										
10/24	10/03/2024	145419	599	STATE OF WISCONSIN-COURT	SEPT 2024 C	1	01-24240	.00	2,692.54	2,692.54
Total 145419:								.00		2,692.54
145420										
10/24	10/03/2024	145420	603	STREICHERS INC	#11719992	1	01-52100-1390	.00	288.00	288.00
10/24	10/03/2024	145420	603	STREICHERS INC	#11720151	1	01-52100-1390	.00	11.99	11.99
10/24	10/03/2024	145420	603	STREICHERS INC	#11720833	1	01-52100-1390	.00	55.00	55.00
Total 145420:								.00		354.99
145421										
10/24	10/03/2024	145421	653	TOMAH SEWER UTILITY	AUGUST - 2	1	08-57331-8500	.00	9,706.78	9,706.78
10/24	10/03/2024	145421	653	TOMAH SEWER UTILITY	JULY - 2024	1	08-57331-8500	.00	143,479.13	143,479.13
Total 145421:								.00		153,185.91
145422										
10/24	10/03/2024	145422	658	TOMAH WATER & SEWER UTILI	1751.00 10.2	1	01-55200-2220	.00	53.27	53.27
10/24	10/03/2024	145422	658	TOMAH WATER & SEWER UTILI	1917.05 10.2	1	01-55401-2220	.00	8.22	8.22
10/24	10/03/2024	145422	658	TOMAH WATER & SEWER UTILI	1945.00 10.2	1	01-55200-2220	.00	74.31	74.31
10/24	10/03/2024	145422	658	TOMAH WATER & SEWER UTILI	2049.01 10.2	1	01-55200-2220	.00	35.06	35.06
10/24	10/03/2024	145422	658	TOMAH WATER & SEWER UTILI	2064.00 10.2	1	01-55401-2220	.00	447.77	447.77
10/24	10/03/2024	145422	658	TOMAH WATER & SEWER UTILI	2196.01 10.2	1	01-55401-2220	.00	74.31	74.31
10/24	10/03/2024	145422	658	TOMAH WATER & SEWER UTILI	2289.00 10.2	1	01-55200-2220	.00	88.43	88.43
10/24	10/03/2024	145422	658	TOMAH WATER & SEWER UTILI	2289.01 10.2	1	01-55200-2220	.00	53.27	53.27
10/24	10/03/2024	145422	658	TOMAH WATER & SEWER UTILI	2547.00 10.2	1	01-55200-2220	.00	24.54	24.54
10/24	10/03/2024	145422	658	TOMAH WATER & SEWER UTILI	2943.01 10.2	1	01-55200-2220	.00	53.27	53.27
10/24	10/03/2024	145422	658	TOMAH WATER & SEWER UTILI	2967.00 10.2	1	01-55401-2220	.00	195.29	195.29
10/24	10/03/2024	145422	658	TOMAH WATER & SEWER UTILI	3114.00 10.2	1	01-55200-2220	.00	2,037.04	2,037.04

M = Manual Check, V = Void Check

GL Period	Check Issue Date	Check Number	Vendor Number	Payee	Invoice Number	Invoice Sequence	Invoice GL Account	Discount Taken	Invoice Amount	Check Amount
10/24	10/03/2024	145422	658	TOMAH WATER & SEWER UTILI	3255.00 10.2	1	01-55401-2220	.00	721.03	721.03
10/24	10/03/2024	145422	658	TOMAH WATER & SEWER UTILI	3304.00 10.2	1	01-55402-2220	.00	507.40	507.40
10/24	10/03/2024	145422	658	TOMAH WATER & SEWER UTILI	3353.00 10.2	1	01-55200-2220	.00	94.94	94.94
10/24	10/03/2024	145422	658	TOMAH WATER & SEWER UTILI	3439.00 10.2	1	01-55401-2220	.00	204.15	204.15
10/24	10/03/2024	145422	658	TOMAH WATER & SEWER UTILI	3521.00 10.2	1	01-55402-2220	.00	65.08	65.08
10/24	10/03/2024	145422	658	TOMAH WATER & SEWER UTILI	3582.00 10.2	1	01-55200-2220	.00	77.14	77.14
10/24	10/03/2024	145422	658	TOMAH WATER & SEWER UTILI	360201.00 1	1	01-55200-2220	.00	17.17	17.17
10/24	10/03/2024	145422	658	TOMAH WATER & SEWER UTILI	809.05 10.24	1	01-55200-2220	.00	53.27	53.27
10/24	10/03/2024	145422	658	TOMAH WATER & SEWER UTILI	854.00 10.24	1	01-55200-2220	.00	81.60	81.60
Total 145422:								.00		4,966.56
145423										
10/24	10/03/2024	145423	2315	VANDEWALLE & ASSOCIATES	202409013	1	06-56700-2100	.00	45.00	45.00
10/24	10/03/2024	145423	2315	VANDEWALLE & ASSOCIATES	202409013	2	06-56700-2100	.00	420.00	420.00
10/24	10/03/2024	145423	2315	VANDEWALLE & ASSOCIATES	202409013	3	06-56700-2100	.00	300.00	300.00
10/24	10/03/2024	145423	2315	VANDEWALLE & ASSOCIATES	202409013	4	06-56700-2100	.00	60.00	60.00
10/24	10/03/2024	145423	2315	VANDEWALLE & ASSOCIATES	202409013	5	17-56700-2100	.00	372.50	372.50
10/24	10/03/2024	145423	2315	VANDEWALLE & ASSOCIATES	202409013	6	14-56700-2100	.00	372.50	372.50
10/24	10/03/2024	145423	2315	VANDEWALLE & ASSOCIATES	202409013	7	20-56700-2100	.00	372.50	372.50
10/24	10/03/2024	145423	2315	VANDEWALLE & ASSOCIATES	202409013	8	18-56700-2100	.00	372.50	372.50
10/24	10/03/2024	145423	2315	VANDEWALLE & ASSOCIATES	202409013	9	06-56700-2100	.00	270.00	270.00
Total 145423:								.00		2,585.00
145602										
09/24	09/17/2024	145602	11	ACE HARDWARE (PUBLIC WOR	624408	1	01-51600-3500	.00	11.99	11.99
09/24	09/17/2024	145602	11	ACE HARDWARE (PUBLIC WOR	624412	1	01-53311-3508	.00	14.17	14.17
09/24	09/17/2024	145602	11	ACE HARDWARE (PUBLIC WOR	624413	1	01-53311-3508	.00	71.97	71.97
09/24	09/17/2024	145602	11	ACE HARDWARE (PUBLIC WOR	624461	1	01-53311-3408	.00	39.27	39.27
09/24	09/17/2024	145602	11	ACE HARDWARE (PUBLIC WOR	624526	1	01-53311-3408	.00	55.98	55.98
09/24	09/17/2024	145602	11	ACE HARDWARE (PUBLIC WOR	624543	1	01-53311-3408	.00	14.99	14.99
09/24	09/17/2024	145602	11	ACE HARDWARE (PUBLIC WOR	624834	1	01-53311-3408	.00	7.16	7.16
09/24	09/17/2024	145602	11	ACE HARDWARE (PUBLIC WOR	624889	1	01-51600-3400	.00	37.99	37.99
09/24	09/17/2024	145602	11	ACE HARDWARE (PUBLIC WOR	624893	1	01-53311-3408	.00	28.99	28.99
09/24	09/17/2024	145602	11	ACE HARDWARE (PUBLIC WOR	624909	1	01-53311-3409	.00	44.99	44.99
09/24	09/17/2024	145602	11	ACE HARDWARE (PUBLIC WOR	624937	1	01-51600-3500	.00	29.99	29.99
09/24	09/17/2024	145602	11	ACE HARDWARE (PUBLIC WOR	624947	1	01-53311-3408	.00	26.57	26.57
09/24	09/17/2024	145602	11	ACE HARDWARE (PUBLIC WOR	625063	1	01-53311-3408	.00	16.58	16.58

M = Manual Check, V = Void Check

GL Period	Check Issue Date	Check Number	Vendor Number	Payee	Invoice Number	Invoice Sequence	Invoice GL Account	Discount Taken	Invoice Amount	Check Amount
09/24	09/17/2024	145602	11	ACE HARDWARE (PUBLIC WOR	625104	1	01-53311-3508	.00	2.59	2.59
09/24	09/17/2024	145602	11	ACE HARDWARE (PUBLIC WOR	625132	1	01-53311-3508	.00	31.92	31.92
09/24	09/17/2024	145602	11	ACE HARDWARE (PUBLIC WOR	625164	1	01-53311-3408	.00	26.95	26.95
Total 145602:								.00		462.10
145603										
09/24	09/17/2024	145603	30	ALLIANT ENERGY/WPL	2822167112	1	03-52300-2210	.00	2,023.18	2,023.18
09/24	09/17/2024	145603	30	ALLIANT ENERGY/WPL	2822167112	2	01-52200-2210	.00	867.08	867.08
Total 145603:								.00		2,890.26
145604										
09/24	09/17/2024	145604	2444	AT&T - POLICE DEPT.	#287299452	1	01-52100-2230	.00	978.06	978.06
Total 145604:								.00		978.06
145605										
09/24	09/17/2024	145605	1145	AXON ENTERPRISE INC	#INUS27716	1	01-52100-2100	.00	1,558.76	1,558.76
Total 145605:								.00		1,558.76
145606										
09/24	09/17/2024	145606	2365	Brightspeed	301313485 0	1	12-55500-2230	.00	78.37	78.37
Total 145606:								.00		78.37
145607										
09/24	09/17/2024	145607	132	CHASING DAYLIGHT ANIMAL S	aUGUST 202	1	01-52100-3400	.00	100.00	100.00
Total 145607:								.00		100.00
145608										
09/24	09/17/2024	145608	436	CONSOLIDATED ENERGY COM	119 09.24	1	01-55200-3400	.00	219.14	219.14
Total 145608:								.00		219.14
145609										
09/24	09/17/2024	145609	29	CULLIGAN	588-1001809	1	01-55402-3400	.00	13.55	13.55

M = Manual Check, V = Void Check

GL Period	Check Issue Date	Check Number	Vendor Number	Payee	Invoice Number	Invoice Sequence	Invoice GL Account	Discount Taken	Invoice Amount	Check Amount
Total 145609:								.00		13.55
145610										
09/24	09/17/2024	145610	2664	DOBBERSTEIN LAW FIRM LLC	PP#18 KERR	1	01-21590	.00	108.46	108.46
Total 145610:								.00		108.46
145611										
09/24	09/17/2024	145611	205	DON'S PLUMBING SERVICE INC	116755	1	01-51600-3500	.00	409.98	409.98
Total 145611:								.00		409.98
145612										
09/24	09/17/2024	145612	255	FIRST SUPPLY LLC-LA CROSSE	3640836-01	1	01-53311-3508	.00	151.77	151.77
09/24	09/17/2024	145612	255	FIRST SUPPLY LLC-LA CROSSE	3640936-00	1	01-53311-3508	.00	253.65	253.65
09/24	09/17/2024	145612	255	FIRST SUPPLY LLC-LA CROSSE	90724-99	1	01-55200-3400	.00	5.00	5.00
Total 145612:								.00		410.42
145613										
09/24	09/17/2024	145613	287	GRAY ELECTRIC LLC	14096	1	02-56910-3500	.00	255.50	255.50
Total 145613:								.00		255.50
145614										
09/24	09/17/2024	145614	2538	HEATHER MINOR	AUG 2024	1	10-55110-2900	.00	752.00	752.00
Total 145614:								.00		752.00
145615										
09/24	09/17/2024	145615	375	KWIK TRIP CREDIT DEPT	00349111 09.	1	01-55200-3400	.00	669.24	669.24
09/24	09/17/2024	145615	375	KWIK TRIP CREDIT DEPT	00474557 08	1	01-52200-3400	.00	410.21	410.21
09/24	09/17/2024	145615	375	KWIK TRIP CREDIT DEPT	August 2024	1	01-52100-3400	.00	3,272.26	3,272.26
Total 145615:								.00		4,351.71
145616										
09/24	09/17/2024	145616	2328	LYNX NETWORKS	809500 09.2	1	01-53311-2230	.00	100.59	100.59

M = Manual Check, V = Void Check

GL Period	Check Issue Date	Check Number	Vendor Number	Payee	Invoice Number	Invoice Sequence	Invoice GL Account	Discount Taken	Invoice Amount	Check Amount
09/24	09/17/2024	145616	2328	LYNXX NETWORKS	897700 09.2	1	12-55500-2230	.00	18.06	18.06
Total 145616:								.00		118.65
145617										
09/24	09/17/2024	145617	441	MINUTEMAN PRESS OF TOMAH	32000	1	12-55500-3200	.00	350.38	350.38
Total 145617:								.00		350.38
145618										
09/24	09/17/2024	145618	444	MODERN DISPOSAL SYSTEMS	500,168828	1	01-53635-2900	.00	5,061.41	5,061.41
Total 145618:								.00		5,061.41
145619										
09/24	09/17/2024	145619	2386	Monroe County Herald	2 YR SUBSC	1	12-55500-3200	.00	120.00	120.00
Total 145619:								.00		120.00
145620										
09/24	09/17/2024	145620	1815	MULTIMEDIA SALES & MARKETI	1070974	1	12-55500-3200	.00	180.00	180.00
Total 145620:								.00		180.00
145621										
09/24	09/17/2024	145621	499	OAKDALE ELECTRIC COOPERA	30198001 09	1	01-53420-2900	.00	333.00	333.00
09/24	09/17/2024	145621	499	OAKDALE ELECTRIC COOPERA	30198002 09	1	01-53420-2900	.00	45.00	45.00
Total 145621:								.00		378.00
145622										
09/24	09/17/2024	145622	550	REINDERS INC	1964704-00	1	01-55200-3500	.00	488.98	488.98
09/24	09/17/2024	145622	550	REINDERS INC	6054730-00	1	01-55200-3500	.00	120.31	120.31
09/24	09/17/2024	145622	550	REINDERS INC	6055754-00	1	01-55200-3500	.00	83.34	83.34
09/24	09/17/2024	145622	550	REINDERS INC	6055754-02	1	01-55200-3500	.00	177.68	177.68
09/24	09/17/2024	145622	550	REINDERS INC	6056434-00	1	01-55200-3500	.00	54.27	54.27
09/24	09/17/2024	145622	550	REINDERS INC	6056728-00	1	01-55200-3500	.00	54.27-	54.27-
09/24	09/17/2024	145622	550	REINDERS INC	6060013-00	1	01-55200-3500	.00	140.14	140.14
09/24	09/17/2024	145622	550	REINDERS INC	6087096-00	1	01-55200-3500	.00	1,298.41	1,298.41

M = Manual Check, V = Void Check

GL Period	Check Issue Date	Check Number	Vendor Number	Payee	Invoice Number	Invoice Sequence	Invoice GL Account	Discount Taken	Invoice Amount	Check Amount
Total 145622:								.00		2,308.86
145623										
09/24	09/17/2024	145623	2692	SANDRA NEILLAND	REFUND	1	01-44100	.00	43.00	43.00
Total 145623:								.00		43.00
145624										
09/24	09/17/2024	145624	2690	TATU WINDOW CLEANING LLC	8-29-24	1	01-52100-3550	.00	570.00	570.00
Total 145624:								.00		570.00
145625										
09/24	09/17/2024	145625	2350	TK ELEVATOR CORPORATION	#300807073	1	01-52100-3550	.00	633.10	633.10
Total 145625:								.00		633.10
145626										
09/24	09/17/2024	145626	660	TOMAH WELDING & STEEL SUP	23802	1	01-53311-3405	.00	165.00	165.00
Total 145626:								.00		165.00
145627										
09/24	09/17/2024	145627	665	TRACTOR SUPPLY CREDIT PLA	6035301207	1	08-57331-8500	.00	167.94	167.94
09/24	09/17/2024	145627	665	TRACTOR SUPPLY CREDIT PLA	6035301207	2	08-57331-8500	.00	89.97	89.97
Total 145627:								.00		257.91
145650										
09/24	09/19/2024	145650	2131	3RT NETWORKS	CW36309	1	01-51450-2900	.00	750.00	750.00
09/24	09/19/2024	145650	2131	3RT NETWORKS	CW36309	2	01-51450-2900	.00	1,050.00	1,050.00
09/24	09/19/2024	145650	2131	3RT NETWORKS	CW36309	3	01-51450-2900	.00	150.00	150.00
09/24	09/19/2024	145650	2131	3RT NETWORKS	CW36309	4	01-51450-2900	.00	1,080.00	1,080.00
09/24	09/19/2024	145650	2131	3RT NETWORKS	CW36309	5	01-51450-2900	.00	1,350.00	1,350.00
09/24	09/19/2024	145650	2131	3RT NETWORKS	CW36309	6	01-51450-2900	.00	84.00	84.00
09/24	09/19/2024	145650	2131	3RT NETWORKS	CW36309	7	01-51450-2900	.00	96.25	96.25
09/24	09/19/2024	145650	2131	3RT NETWORKS	CW36310	1	10-55111-2900	.00	1,766.25	1,766.25
09/24	09/19/2024	145650	2131	3RT NETWORKS	CW36311	1	01-51450-2900	.00	150.00	150.00

M = Manual Check, V = Void Check

GL Period	Check Issue Date	Check Number	Vendor Number	Payee	Invoice Number	Invoice Sequence	Invoice GL Account	Discount Taken	Invoice Amount	Check Amount
09/24	09/19/2024	145650	2131	3RT NETWORKS	CW36311	2	01-51450-2900	.00	600.00	600.00
09/24	09/19/2024	145650	2131	3RT NETWORKS	CW36311	3	01-51450-2900	.00	540.00	540.00
09/24	09/19/2024	145650	2131	3RT NETWORKS	CW36311	4	01-51450-2900	.00	2,148.00	2,148.00
09/24	09/19/2024	145650	2131	3RT NETWORKS	CW36343	1	01-51450-2900	.00	1,559.67	1,559.67
09/24	09/19/2024	145650	2131	3RT NETWORKS	CW36343	2	01-51450-2900	.00	68.18	68.18
09/24	09/19/2024	145650	2131	3RT NETWORKS	CW36344	1	01-51450-2900	.00	1,145.00	1,145.00
Total 145650:								.00		12,537.35
145651										
09/24	09/19/2024	145651	2410	ACE HARDWARE (AMBULANCE	625341	1	03-52300-3400	.00	17.99	17.99
09/24	09/19/2024	145651	2410	ACE HARDWARE (AMBULANCE	625441	1	03-52300-3400	.00	9.59	9.59
Total 145651:								.00		27.58
145652										
09/24	09/19/2024	145652	2340	ACE HARDWARE (PARKS)	625237	1	01-55200-3400	.00	26.97	26.97
09/24	09/19/2024	145652	2340	ACE HARDWARE (PARKS)	625327	1	01-55401-3500	.00	12.76	12.76
09/24	09/19/2024	145652	2340	ACE HARDWARE (PARKS)	625401	1	01-55401-3500	.00	10.57	10.57
09/24	09/19/2024	145652	2340	ACE HARDWARE (PARKS)	625473	1	01-55200-3400	.00	13.98	13.98
09/24	09/19/2024	145652	2340	ACE HARDWARE (PARKS)	625503	1	01-55401-3400	.00	63.94	63.94
Total 145652:								.00		128.22
145653										
09/24	09/19/2024	145653	24	AIRGAS USA LLC	551011548	1	01-53311-2900	.00	146.06	146.06
Total 145653:								.00		146.06
145654										
09/24	09/19/2024	145654	2694	ALEXA MARTEN	SECURITY D	1	01-46721	.00	250.00	250.00
Total 145654:								.00		250.00
145655										
09/24	09/19/2024	145655	34	ALLSTATE PETERBILT OF TOM	204223067	1	01-53620-3500	.00	70.00-	70.00-
09/24	09/23/2024	145655	34	ALLSTATE PETERBILT OF TOM	204223067	1	01-53620-3500	.00	70.00	70.00 V
09/24	09/19/2024	145655	34	ALLSTATE PETERBILT OF TOM	5204223067	1	01-53620-3500	.00	70.00-	70.00-
09/24	09/23/2024	145655	34	ALLSTATE PETERBILT OF TOM	5204223067	1	01-53620-3500	.00	70.00	70.00 V

M = Manual Check, V = Void Check

GL Period	Check Issue Date	Check Number	Vendor Number	Payee	Invoice Number	Invoice Sequence	Invoice GL Account	Discount Taken	Invoice Amount	Check Amount
09/24	09/19/2024	145655	34	ALLSTATE PETERBILT OF TOM	5204334668	1	01-53620-3500	.00	440.93	440.93
09/24	09/23/2024	145655	34	ALLSTATE PETERBILT OF TOM	5204334668	1	01-53620-3500	.00	440.93-	440.93- V
Total 145655:								.00		.00
145656										
09/24	09/19/2024	145656	2693	ASHLEY BOOHER	OVERPAYM	1	01-23301	.00	25.90	25.90
Total 145656:								.00		25.90
145657										
09/24	09/19/2024	145657	2430	AT&T MOBILITY - AMBULANCE	2873036156	1	03-52300-2230	.00	382.37	382.37
Total 145657:								.00		382.37
145658										
09/24	09/19/2024	145658	2431	AT&T MOBILITY - FIRE DEPT.	2873030555	1	01-52200-2230	.00	197.02	197.02
Total 145658:								.00		197.02
145659										
09/24	09/19/2024	145659	2343	AUTO VALUE TOMAH (PARKS)	522277790	1	01-55200-3400	.00	60.99	60.99
09/24	09/19/2024	145659	2343	AUTO VALUE TOMAH (PARKS)	522278518	1	01-55200-3400	.00	9.99	9.99
Total 145659:								.00		70.98
145660										
09/24	09/19/2024	145660	69	BAKER & TAYLOR LLC	2038501860	1	10-55110-3420	.00	217.75	217.75
09/24	09/19/2024	145660	69	BAKER & TAYLOR LLC	2038501860	2	10-55110-3460	.00	115.41	115.41
09/24	09/19/2024	145660	69	BAKER & TAYLOR LLC	2038519679	1	10-55110-3420	.00	309.25	309.25
Total 145660:								.00		642.41
145661										
09/24	09/19/2024	145661	95	BOND TRUST SERVICES CORP	90748 90749	1	07-58290-6562	.00	400.00	400.00
09/24	09/19/2024	145661	95	BOND TRUST SERVICES CORP	90748 90749	2	07-58290-6563	.00	400.00	400.00
09/24	09/19/2024	145661	95	BOND TRUST SERVICES CORP	90748 90749	3	07-58290-6564	.00	400.00	400.00

M = Manual Check, V = Void Check

GL Period	Check Issue Date	Check Number	Vendor Number	Payee	Invoice Number	Invoice Sequence	Invoice GL Account	Discount Taken	Invoice Amount	Check Amount
Total 145661:								.00		1,200.00
145662										
09/24	09/19/2024	145662	96	BOUND TREE MEDICAL LLC	85471294	1	03-52300-3402	.00	73.19	73.19
09/24	09/19/2024	145662	96	BOUND TREE MEDICAL LLC	85476857	1	03-52300-3402	.00	1,699.96	1,699.96
09/24	09/19/2024	145662	96	BOUND TREE MEDICAL LLC	85485526	1	03-52300-3402	.00	245.91	245.91
Total 145662:								.00		2,019.06
145663										
09/24	09/19/2024	145663	2565	CAREY'S SEAMLESS GUTTERS	15166	1	01-52200-3500	.00	2,737.46	2,737.46
Total 145663:								.00		2,737.46
145664										
09/24	09/19/2024	145664	1666	CBS SQUARED INC	14207	1	01-52400-2100	.00	1,390.00	1,390.00
Total 145664:								.00		1,390.00
145665										
09/24	09/19/2024	145665	2301	CIVICPLUS	299838	1	01-51450-2900	.00	4,228.45	4,228.45
Total 145665:								.00		4,228.45
145666										
09/24	09/19/2024	145666	2493	CONFIDENTIAL RECORDS, INC.	0002411	1	01-51420-2100	.00	447.05	447.05
Total 145666:								.00		447.05
145667										
09/24	09/19/2024	145667	29	CULLIGAN	588-0975581	1	01-51600-3400	.00	20.20	20.20
09/24	09/19/2024	145667	29	CULLIGAN	588-1001476	1	01-51600-3400	.00	16.95	16.95
Total 145667:								.00		37.15
145668										
09/24	09/19/2024	145668	1777	DELTA DENTAL	2220591	1	01-21597	.00	1,451.00	1,451.00
09/24	09/19/2024	145668	1777	DELTA DENTAL	2223442	1	01-21596	.00	675.96	675.96

M = Manual Check, V = Void Check

GL Period	Check Issue Date	Check Number	Vendor Number	Payee	Invoice Number	Invoice Sequence	Invoice GL Account	Discount Taken	Invoice Amount	Check Amount
Total 145668:								.00		2,126.96
145669										
09/24	09/19/2024	145669	1280	DIRECTV	013901916X	1	01-55401-3400	.00	62.74	62.74
Total 145669:								.00		62.74
145670										
09/24	09/19/2024	145670	2664	DOBBERSTEIN LAW FIRM LLC	PP #19 KER	1	01-21590	.00	157.70	157.70
Total 145670:								.00		157.70
145671										
09/24	09/19/2024	145671	220	EO JOHNSON CO	INV1501481	1	10-55110-2900	.00	86.00	86.00
09/24	09/19/2024	145671	220	EO JOHNSON CO	INV1539093	1	10-55110-2900	.00	86.00	86.00
Total 145671:								.00		172.00
145672										
09/24	09/19/2024	145672	226	EVEREST EMERGENCY VEHICL	P07436	1	03-52300-3500	.00	67.71	67.71
Total 145672:								.00		67.71
145673										
09/24	09/19/2024	145673	2483	FOAMfrat	1481	1	03-52300-3350	.00	2,799.82	2,799.82
Total 145673:								.00		2,799.82
145674										
09/24	09/19/2024	145674	274	GERKE EXCAVATING INC	68738 APP. #	1	08-57620-8200	.00	76,156.10	76,156.10
Total 145674:								.00		76,156.10
145675										
09/24	09/19/2024	145675	634	GREATER TOMAH AREA CHAM	JULY 2024	1	16-21101	.00	37,376.02	37,376.02
Total 145675:								.00		37,376.02

M = Manual Check, V = Void Check

GL Period	Check Issue Date	Check Number	Vendor Number	Payee	Invoice Number	Invoice Sequence	Invoice GL Account	Discount Taken	Invoice Amount	Check Amount
145676										
09/24	09/19/2024	145676	2677	JOHN FABICK TRACTOR COMP	PILC010235	1	01-53311-3502	.00	80.96	80.96
09/24	09/19/2024	145676	2677	JOHN FABICK TRACTOR COMP	PILC010235	1	01-53311-3502	.00	89.87	89.87
09/24	09/19/2024	145676	2677	JOHN FABICK TRACTOR COMP	PILC010235	1	01-53311-3502	.00	14.30	14.30
Total 145676:								.00		185.13
145677										
09/24	09/19/2024	145677	366	KELLER INC	PROJECT 80	1	08-57620-8200	.00	326,959.31	326,959.31
Total 145677:								.00		326,959.31
145678										
09/24	09/19/2024	145678	387	LARKIN'S GMC INC	87476	1	03-52300-3500	.00	217.51	217.51
09/24	09/19/2024	145678	387	LARKIN'S GMC INC	87499	1	03-52300-3500	.00	876.91	876.91
09/24	09/19/2024	145678	387	LARKIN'S GMC INC	87539	1	03-52300-3500	.00	272.14	272.14
09/24	09/19/2024	145678	387	LARKIN'S GMC INC	87542	1	03-52300-3500	.00	129.05	129.05
09/24	09/19/2024	145678	387	LARKIN'S GMC INC	87549	1	03-52300-3500	.00	97.25	97.25
09/24	09/19/2024	145678	387	LARKIN'S GMC INC	87563	1	03-52300-3500	.00	87.10	87.10
Total 145678:								.00		1,679.96
145679										
09/24	09/19/2024	145679	1696	LEE DOOR AND HARDWARE	2188	1	08-57621-8300	.00	19,630.00	19,630.00
Total 145679:								.00		19,630.00
145680										
09/24	09/19/2024	145680	396	LEXISNEXIS RISK DATA MANAG	1679640-202	1	03-52300-2900	.00	100.00	100.00
09/24	09/19/2024	145680	396	LEXISNEXIS RISK DATA MANAG	1679640-202	2	01-52100-2900	.00	100.00	100.00
09/24	09/19/2024	145680	396	LEXISNEXIS RISK DATA MANAG	1679640-202	3	03-52300-2900	.00	100.00	100.00
09/24	09/19/2024	145680	396	LEXISNEXIS RISK DATA MANAG	1679640-202	4	01-52100-2900	.00	100.00	100.00
Total 145680:								.00		400.00
145681										
09/24	09/19/2024	145681	1391	LOFFLER COMPANIES	4800796	1	01-51420-2900	.00	43.34	43.34

M = Manual Check, V = Void Check

GL Period	Check Issue Date	Check Number	Vendor Number	Payee	Invoice Number	Invoice Sequence	Invoice GL Account	Discount Taken	Invoice Amount	Check Amount
Total 145681:								.00		43.34
145682										
09/24	09/19/2024	145682	2328	LYNXX NETWORKS	842100 09.2	1	10-55110-2230	.00	123.73	123.73
09/24	09/19/2024	145682	2328	LYNXX NETWORKS	842100 09.2	2	10-55110-2900	.00	79.95	79.95
Total 145682:								.00		203.68
145683										
09/24	09/19/2024	145683	416	MATHY CONSTRUCTION COMP	5200023675	1	01-48200	.00	3,836.64	3,836.64
09/24	09/19/2024	145683	416	MATHY CONSTRUCTION COMP	5700007261	1	14-57331-8553	.00	18,498.40	18,498.40
09/24	09/19/2024	145683	416	MATHY CONSTRUCTION COMP	5700007261	2	01-48200	.00	13,142.25	13,142.25
09/24	09/19/2024	145683	416	MATHY CONSTRUCTION COMP	5700007261	3	01-48200	.00	11,245.50	11,245.50
Total 145683:								.00		46,722.79
145684										
09/24	09/19/2024	145684	441	MINUTEMAN PRESS OF TOMAH	32055	1	01-52200-3100	.00	39.95	39.95
Total 145684:								.00		39.95
145685										
09/24	09/19/2024	145685	447	MONROE CO CLERK OF COUR	WARRANT C	1	01-23300	.00	1,000.00	1,000.00
Total 145685:								.00		1,000.00
145686										
09/24	09/19/2024	145686	454	MONROE CO TREASURER	TAXES	1	09-12100	.00	2,284.31	2,284.31
Total 145686:								.00		2,284.31
145687										
09/24	09/19/2024	145687	1610	OPTUM	0001629802	1	01-51420-3200	.00	70.00	70.00
09/24	09/19/2024	145687	1610	OPTUM	0001641731	1	01-51420-3200	.00	70.00	70.00
Total 145687:								.00		140.00

M = Manual Check, V = Void Check

GL Period	Check Issue Date	Check Number	Vendor Number	Payee	Invoice Number	Invoice Sequence	Invoice GL Account	Discount Taken	Invoice Amount	Check Amount
145688										
09/24	09/19/2024	145688	469	PENNY J. PRECOUR ATTORNE	6382	1	01-51300-2100	.00	927.50	927.50
09/24	09/19/2024	145688	469	PENNY J. PRECOUR ATTORNE	6383	1	03-52300-2100	.00	122.50	122.50
09/24	09/19/2024	145688	469	PENNY J. PRECOUR ATTORNE	6384	1	01-51300-2100	.00	52.50	52.50
09/24	09/19/2024	145688	469	PENNY J. PRECOUR ATTORNE	6385	1	01-51300-2100	.00	52.50	52.50
09/24	09/19/2024	145688	469	PENNY J. PRECOUR ATTORNE	6386	1	01-51300-2100	.00	17.50	17.50
09/24	09/19/2024	145688	469	PENNY J. PRECOUR ATTORNE	6387	1	01-51300-2100	.00	175.00	175.00
09/24	09/19/2024	145688	469	PENNY J. PRECOUR ATTORNE	6419	1	01-51300-2100	.00	105.00	105.00
09/24	09/19/2024	145688	469	PENNY J. PRECOUR ATTORNE	6420	1	01-51300-2100	.00	542.50	542.50
Total 145688:								.00	1,995.00	1,995.00
145689										
09/24	09/19/2024	145689	538	QUILL CORPORATION	40295104	1	03-52300-3100	.00	27.18	27.18
09/24	09/19/2024	145689	538	QUILL CORPORATION	40295104	2	03-52300-3400	.00	89.98	89.98
09/24	09/19/2024	145689	538	QUILL CORPORATION	40360456	1	03-52300-3400	.00	29.99	29.99
Total 145689:								.00	147.15	147.15
145690										
09/24	09/19/2024	145690	2069	REBECCA WEYER	REIMBURSE	1	01-51440-3100	.00	21.82	21.82
Total 145690:								.00	21.82	21.82
145691										
09/24	09/19/2024	145691	2691	SAFE RESTRAINTS	CH091224TP	1	08-57210-8400	.00	1,637.12	1,637.12
Total 145691:								.00	1,637.12	1,637.12
145692										
09/24	09/19/2024	145692	577	SECURIAN FINANCIAL GROUP I	002832L 10.2	1	01-21530	.00	2,779.29	2,779.29
09/24	09/19/2024	145692	577	SECURIAN FINANCIAL GROUP I	76038 9.24	1	01-21530	.00	287.54	287.54
Total 145692:								.00	3,066.83	3,066.83
145693										
09/24	09/19/2024	145693	603	STREICHERS INC	#11718576	1	01-52100-1390	.00	508.99	508.99
09/24	09/19/2024	145693	603	STREICHERS INC	#11718672	1	01-52100-1390	.00	111.00	111.00

M = Manual Check, V = Void Check

GL Period	Check Issue Date	Check Number	Vendor Number	Payee	Invoice Number	Invoice Sequence	Invoice GL Account	Discount Taken	Invoice Amount	Check Amount
Total 145693:								.00		619.99
145694										
09/24	09/19/2024	145694	859	THE O'BRION AGENCY LLC	93813	1	01-51420-3100	.00	168.00	168.00
Total 145694:								.00		168.00
145695										
09/24	09/19/2024	145695	637	TOMAH AREA SCHOOL DISTRIC	AUG 2024 P	1	01-24600	.00	1,787.32	1,787.32
Total 145695:								.00		1,787.32
145696										
09/24	09/19/2024	145696	1744	TOMAH HEALTH	August 2024	1	01-52100-3400	.00	45.75	45.75
Total 145696:								.00		45.75
145697										
09/24	09/19/2024	145697	658	TOMAH WATER & SEWER UTILI	2189.00 09.2	1	10-55110-2220	.00	174.25	174.25
09/24	09/19/2024	145697	658	TOMAH WATER & SEWER UTILI	3581.00 08.2	1	03-52300-2220	.00	152.15	152.15
09/24	09/19/2024	145697	658	TOMAH WATER & SEWER UTILI	3581.00 08.2	2	01-52200-2220	.00	38.04	38.04
Total 145697:								.00		364.44
145698										
09/24	09/19/2024	145698	660	TOMAH WELDING & STEEL SUP	23804	1	01-53311-3502	.00	365.00	365.00
Total 145698:								.00		365.00
145699										
09/24	09/19/2024	145699	672	TRI-STATE BUSINESS MACHINE	609760	1	01-55300-3400	.00	34.80	34.80
09/24	09/19/2024	145699	672	TRI-STATE BUSINESS MACHINE	609932	1	03-52300-2900	.00	95.52	95.52
Total 145699:								.00		130.32
145700										
09/24	09/19/2024	145700	758	WIRE PRO ELECTRIC LLC	22002	1	08-57140-8200	.00	2,562.37	2,562.37

M = Manual Check, V = Void Check

GL Period	Check Issue Date	Check Number	Vendor Number	Payee	Invoice Number	Invoice Sequence	Invoice GL Account	Discount Taken	Invoice Amount	Check Amount
Total 145700:								.00		2,562.37
145701										
09/24	09/19/2024	145701	770	WOLF CONCRETE & CONSTRU	2024-10	1	01-48200	.00	15,780.50	15,780.50
09/24	09/19/2024	145701	770	WOLF CONCRETE & CONSTRU	2024-11	1	01-53311-3406	.00	2,207.25	2,207.25
Total 145701:								.00		17,987.75
145702										
09/24	09/19/2024	145702	779	ZARNOTH BRUSH WORKS INC	0199379-IN	1	01-53311-3502	.00	388.20	388.20
Total 145702:								.00		388.20
145703										
09/24	09/19/2024	145703	782	ZINGLER MARKETING LLC	9374	1	01-52200-3350	.00	235.00	235.00
Total 145703:								.00		235.00
145704										
09/24	09/19/2024	145704	783	ZOLL MEDICAL CORPORATION	4041507	1	03-52300-3400	.00	453.46	453.46
09/24	09/19/2024	145704	783	ZOLL MEDICAL CORPORATION	4044993	1	03-52300-3402	.00	113.43	113.43
09/24	09/19/2024	145704	783	ZOLL MEDICAL CORPORATION	4045862	1	03-52300-3402	.00	1,461.46	1,461.46
09/24	09/19/2024	145704	783	ZOLL MEDICAL CORPORATION	90103955	1	03-52300-2900	.00	8,298.00	8,298.00
Total 145704:								.00		10,326.35
145705										
09/24	09/26/2024	145705	2346	ACE HARDWARE (FIRE)	625281	1	01-52200-3400	.00	10.59	10.59
09/24	09/26/2024	145705	2346	ACE HARDWARE (FIRE)	625700	1	01-52200-3400	.00	25.99	25.99
Total 145705:								.00		36.58
145706										
09/24	09/26/2024	145706	2339	ACE HARDWARE (SENIOR)	625605	1	12-55500-3500	.00	1.99	1.99
Total 145706:								.00		1.99

M = Manual Check, V = Void Check

GL Period	Check Issue Date	Check Number	Vendor Number	Payee	Invoice Number	Invoice Sequence	Invoice GL Account	Discount Taken	Invoice Amount	Check Amount
145707										
09/24	09/26/2024	145707	27	ALL AMERICAN DO-IT CENTER	462347/3	1	03-52300-3400	.00	179.94	179.94
Total 145707:								.00		179.94
145708										
09/24	09/26/2024	145708	30	ALLIANT ENERGY/WPL	3966840000	1	01-55401-2210	.00	297.92	297.92
09/24	09/26/2024	145708	30	ALLIANT ENERGY/WPL	5096920000	1	01-55401-2210	.00	55.61	55.61
09/24	09/26/2024	145708	30	ALLIANT ENERGY/WPL	5276700000	1	01-55401-2210	.00	49.89	49.89
09/24	09/26/2024	145708	30	ALLIANT ENERGY/WPL	5400530000	1	01-55401-2210	.00	29.87	29.87
09/24	09/26/2024	145708	30	ALLIANT ENERGY/WPL	5730840000	1	01-55200-2210	.00	51.39	51.39
09/24	09/26/2024	145708	30	ALLIANT ENERGY/WPL	6301650000	1	01-55200-2210	.00	19.53	19.53
09/24	09/26/2024	145708	30	ALLIANT ENERGY/WPL	7625640000	1	01-55401-2210	.00	17.80	17.80
09/24	09/26/2024	145708	30	ALLIANT ENERGY/WPL	9303554588	1	01-55200-2210	.00	31.04	31.04
Total 145708:								.00		553.05
145709										
09/24	09/26/2024	145709	34	ALLSTATE PETERBILT OF TOM	5204223067	1	01-53620-3500	.00	70.00-	70.00-
09/24	09/26/2024	145709	34	ALLSTATE PETERBILT OF TOM	5204224668	1	01-53620-3500	.00	440.93	440.93
09/24	09/26/2024	145709	34	ALLSTATE PETERBILT OF TOM	5204224955	1	01-53635-3500	.00	198.52	198.52
Total 145709:								.00		569.45
145710										
09/24	09/26/2024	145710	1210	BELCO VEHICLE SOLUTIONS L	#9685	1	08-57210-8400	.00	426.81	426.81
Total 145710:								.00		426.81
145711										
09/24	09/26/2024	145711	84	BEST KEPT PORTABLES LLC	110370	1	01-55200-3400	.00	210.00	210.00
09/24	09/26/2024	145711	84	BEST KEPT PORTABLES LLC	113327	1	01-55200-3400	.00	315.00	315.00
09/24	09/26/2024	145711	84	BEST KEPT PORTABLES LLC	114090	1	01-55200-3400	.00	420.00	420.00
Total 145711:								.00		945.00
145712										
09/24	09/26/2024	145712	2575	BRAVO COMPANY USA INC	#24604	1	01-57210-8300	.00	2,657.04	2,657.04

M = Manual Check, V = Void Check

GL Period	Check Issue Date	Check Number	Vendor Number	Payee	Invoice Number	Invoice Sequence	Invoice GL Account	Discount Taken	Invoice Amount	Check Amount
Total 145712:								.00		2,657.04
145713										
09/24	09/26/2024	145713	2365	Brightspeed	#301310967	1	01-52100-2230	.00	35.00	35.00
Total 145713:								.00		35.00
145714										
09/24	09/26/2024	145714	2287	CANON FINANCIAL SERVICES I	35252274	1	03-52300-2900	.00	73.00	73.00
Total 145714:								.00		73.00
145715										
09/24	09/26/2024	145715	121	CARRICO AQUATIC RESOURCE	20242434	1	01-55402-3400	.00	3,825.00	3,825.00
09/24	09/26/2024	145715	121	CARRICO AQUATIC RESOURCE	20244305	1	01-55402-3400	.00	3,825.00	3,825.00
Total 145715:								.00		7,650.00
145716										
09/24	09/26/2024	145716	2563	CHARTER COMMUNICATIONS	1715396010	1	12-55500-2240	.00	198.23	198.23
Total 145716:								.00		198.23
145717										
09/24	09/26/2024	145717	2302	CINTAS CORPORATION	5230757405	1	01-55200-3400	.00	73.56	73.56
09/24	09/26/2024	145717	2302	CINTAS CORPORATION	5230757408	1	01-53311-2900	.00	104.77	104.77
Total 145717:								.00		178.33
145718										
09/24	09/26/2024	145718	205	DON'S PLUMBING SERVICE INC	#S20940	1	01-52100-3550	.00	243.50	243.50
Total 145718:								.00		243.50
145719										
09/24	09/26/2024	145719	819	HENDRICKS, BARBARA	CONF FEE	1	01-51520-3350	.00	99.00	99.00

M = Manual Check, V = Void Check

GL Period	Check Issue Date	Check Number	Vendor Number	Payee	Invoice Number	Invoice Sequence	Invoice GL Account	Discount Taken	Invoice Amount	Check Amount
Total 145719:								.00		99.00
145720										
09/24	09/26/2024	145720	312	HILLYARD/HUTCHINSON	605546083	1	01-55200-3400	.00	409.80	409.80
09/24	09/26/2024	145720	312	HILLYARD/HUTCHINSON	605608944	1	01-55401-3400	.00	423.46	423.46
Total 145720:								.00		833.26
145721										
09/24	09/26/2024	145721	2677	JOHN FABICK TRACTOR COMP	PILC010256	1	01-53311-3502	.00	765.64	765.64
Total 145721:								.00		765.64
145722										
09/24	09/26/2024	145722	2373	Kathleen M. Roberts	10.4.2024 M	1	12-55500-3410	.00	150.00	150.00
Total 145722:								.00		150.00
145723										
09/24	09/26/2024	145723	366	KELLER INC	APP 4 PROJ	1	08-57620-8200	.00	181,515.19	181,515.19
Total 145723:								.00		181,515.19
145724										
09/24	09/26/2024	145724	1672	KEVIN MATTSON	10.18.2024 1	1	12-55500-3410	.00	100.00	100.00
Total 145724:								.00		100.00
145725										
09/24	09/26/2024	145725	1391	LOFFLER COMPANIES	4811563	1	01-51420-2900	.00	94.78	94.78
Total 145725:								.00		94.78
145726										
09/24	09/26/2024	145726	2328	LYNXX NETWORKS	690500 09.2	1	01-52100-2230	.00	624.14	624.14
09/24	09/26/2024	145726	2328	LYNXX NETWORKS	690500 09.2	2	01-51200-2230	.00	57.82	57.82
09/24	09/26/2024	145726	2328	LYNXX NETWORKS	690500 09.2	3	01-51520-2230	.00	54.85	54.85
09/24	09/26/2024	145726	2328	LYNXX NETWORKS	690500 09.2	4	01-51415-2230	.00	13.22	13.22

M = Manual Check, V = Void Check

GL Period	Check Issue Date	Check Number	Vendor Number	Payee	Invoice Number	Invoice Sequence	Invoice GL Account	Discount Taken	Invoice Amount	Check Amount
09/24	09/26/2024	145726	2328	LYNXX NETWORKS	690500 09.2	5	01-51420-2230	.00	53.80	53.80
09/24	09/26/2024	145726	2328	LYNXX NETWORKS	690500 09.2	6	01-51100-2230	.00	13.22	13.22
09/24	09/26/2024	145726	2328	LYNXX NETWORKS	690500 09.2	7	01-51530-2230	.00	13.22	13.22
09/24	09/26/2024	145726	2328	LYNXX NETWORKS	690500 09.2	8	01-51410-2230	.00	25.95	25.95
09/24	09/26/2024	145726	2328	LYNXX NETWORKS	690500 09.2	9	01-52400-2230	.00	38.28	38.28
09/24	09/26/2024	145726	2328	LYNXX NETWORKS	690500 09.2	10	01-52100-2230	.00	52.94	52.94
09/24	09/26/2024	145726	2328	LYNXX NETWORKS	690500 09.2	11	01-15610	.00	23.99	23.99
09/24	09/26/2024	145726	2328	LYNXX NETWORKS	690500 09.2	12	01-15620	.00	45.45	45.45
09/24	09/26/2024	145726	2328	LYNXX NETWORKS	690500 09.2	13	01-55200-2230	.00	19.01	19.01
09/24	09/26/2024	145726	2328	LYNXX NETWORKS	690500 09.2	14	01-52100-2230	.00	175.00	175.00
09/24	09/26/2024	145726	2328	LYNXX NETWORKS	690500 09.2	15	01-51450-2900	.00	175.00	175.00
09/24	09/26/2024	145726	2328	LYNXX NETWORKS	690500 09.2	16	01-51450-2900	.00	.02	.02
09/24	09/26/2024	145726	2328	LYNXX NETWORKS	690500 09.2	17	01-15610	.00	27.90	27.90
09/24	09/26/2024	145726	2328	LYNXX NETWORKS	690500 09.2	18	01-15610	.00	30.40	30.40
09/24	09/26/2024	145726	2328	LYNXX NETWORKS	690500 09.2	19	01-15610	.00	17.86	17.86
09/24	09/26/2024	145726	2328	LYNXX NETWORKS	721400 09.2	1	01-55200-2230	.00	211.34	211.34
09/24	09/26/2024	145726	2328	LYNXX NETWORKS	721400 09.2	2	01-55401-2230	.00	186.28	186.28
Total 145726:								.00		1,859.69
145727										
09/24	09/26/2024	145727	416	MATHY CONSTRUCTION COMP	5200023728	1	01-53311-3405	.00	793.40	793.40
09/24	09/26/2024	145727	416	MATHY CONSTRUCTION COMP	5700007266	1	20-57331-8200	.00	23,393.25	23,393.25
Total 145727:								.00		24,186.65
145728										
09/24	09/26/2024	145728	442	MISSISSIPPI WELDERS SUPPL	509946	1	03-52300-3400	.00	50.03	50.03
Total 145728:								.00		50.03
145729										
09/24	09/26/2024	145729	475	NAPA - CENTRAL WISCONSIN A	650621	1	03-52300-3500	.00	11.49	11.49
Total 145729:								.00		11.49
145730										
09/24	09/26/2024	145730	2607	POINT C HEALTH	PCH 851391	1	03-52300-1340	.00	5.50	5.50
09/24	09/26/2024	145730	2607	POINT C HEALTH	PCH 851391	2	03-52300-1340	.00	5.50	5.50

M = Manual Check, V = Void Check

GL Period	Check Issue Date	Check Number	Vendor Number	Payee	Invoice Number	Invoice Sequence	Invoice GL Account	Discount Taken	Invoice Amount	Check Amount
09/24	09/26/2024	145730	2607	POINT C HEALTH	PCH 851391	3	03-52300-1340	.00	5.50	5.50
09/24	09/26/2024	145730	2607	POINT C HEALTH	PCH 851391	4	03-52300-1340	.00	5.50	5.50
09/24	09/26/2024	145730	2607	POINT C HEALTH	PCH 851391	5	03-52300-1340	.00	5.50	5.50
09/24	09/26/2024	145730	2607	POINT C HEALTH	PCH 851391	6	03-52300-1340	.00	5.50	5.50
09/24	09/26/2024	145730	2607	POINT C HEALTH	PCH 851391	7	01-53100-1340	.00	5.50	5.50
09/24	09/26/2024	145730	2607	POINT C HEALTH	PCH 851391	8	01-51200-1340	.00	5.50	5.50
09/24	09/26/2024	145730	2607	POINT C HEALTH	PCH 851391	9	10-55110-1340	.00	5.50	5.50
09/24	09/26/2024	145730	2607	POINT C HEALTH	PCH 851391	10	01-52100-1340	.00	5.50	5.50
09/24	09/26/2024	145730	2607	POINT C HEALTH	PCH 851391	11	01-52100-1340	.00	5.50	5.50
09/24	09/26/2024	145730	2607	POINT C HEALTH	PCH 851391	12	01-52100-1340	.00	5.50	5.50
09/24	09/26/2024	145730	2607	POINT C HEALTH	PCH 851391	13	01-15620	.00	5.50	5.50
09/24	09/26/2024	145730	2607	POINT C HEALTH	PCH 851391	14	12-55500-1340	.00	5.50	5.50
09/24	09/26/2024	145730	2607	POINT C HEALTH	PCH 851391	15	01-51520-1340	.00	5.50	5.50
09/24	09/26/2024	145730	2607	POINT C HEALTH	PCH 851391	16	01-15610	.00	5.50	5.50
09/24	09/26/2024	145730	2607	POINT C HEALTH	PCH 851391	17	01-15610	.00	5.50	5.50
09/24	09/26/2024	145730	2607	POINT C HEALTH	PCH 851391	18	01-52100-1340	.00	5.50	5.50
09/24	09/26/2024	145730	2607	POINT C HEALTH	PCH 851391	19	01-52400-1340	.00	5.50	5.50
09/24	09/26/2024	145730	2607	POINT C HEALTH	PCH 851391	20	03-52300-1340	.00	3.50	3.50
Total 145730:								.00		108.00
145731										
09/24	09/26/2024	145731	538	QUILL CORPORATION	40491929	1	03-52300-3400	.00	47.98	47.98
09/24	09/26/2024	145731	538	QUILL CORPORATION	40568170	1	03-52300-3400	.00	252.97	252.97
Total 145731:								.00		300.95
145732										
09/24	09/26/2024	145732	550	REINDERS INC	5056088-01	1	01-55200-3500	.00	190.75	190.75
09/24	09/26/2024	145732	550	REINDERS INC	6046630-00	1	08-57620-8300	.00	31,571.09	31,571.09
09/24	09/26/2024	145732	550	REINDERS INC	6055754-01	1	01-55200-3500	.00	207.87	207.87
09/24	09/26/2024	145732	550	REINDERS INC	6055754-03	1	01-55200-3500	.00	551.22	551.22
09/24	09/26/2024	145732	550	REINDERS INC	6056088-00	1	01-55200-3500	.00	16.76	16.76
09/24	09/26/2024	145732	550	REINDERS INC	6056273-00	1	01-55200-3500	.00	420.63	420.63
09/24	09/26/2024	145732	550	REINDERS INC	6057241-00	1	01-55200-3500	.00	1,229.92	1,229.92
09/24	09/26/2024	145732	550	REINDERS INC	6060669-00	1	01-55200-3500	.00	689.66	689.66
09/24	09/26/2024	145732	550	REINDERS INC	6060779-00	1	01-55200-3500	.00	57.02	57.02

M = Manual Check, V = Void Check

GL Period	Check Issue Date	Check Number	Vendor Number	Payee	Invoice Number	Invoice Sequence	Invoice GL Account	Discount Taken	Invoice Amount	Check Amount
Total 145732:								.00		34,934.92
145733										
09/24	09/26/2024	145733	555	RICK'S CERTIFIED AUTO OF TO	81491	1	01-53311-2900	.00	43.18	43.18
Total 145733:								.00		43.18
145734										
09/24	09/26/2024	145734	1708	SCOTT WILCOX	10.25.24	1 H	12-55500-3410	.00	100.00	100.00
Total 145734:								.00		100.00
145735										
09/24	09/26/2024	145735	2643	SUMMIT FIRE PROTECTION	#2552325	1	01-52100-3400	.00	59.75	59.75
Total 145735:								.00		59.75
145736										
09/24	09/26/2024	145736	672	TRI-STATE BUSINESS MACHINE	610802	1	01-51200-2900	.00	23.00	23.00
Total 145736:								.00		23.00
145737										
09/24	09/26/2024	145737	692	USEMCO INC	IN15220	1	02-56910-3500	.00	374.00	374.00
Total 145737:								.00		374.00
145738										
09/24	09/26/2024	145738	2695	VILLAGE OF MOUNT PLEASANT	2023 FORD	1	03-57230-8400	.00	39,851.00	39,851.00
Total 145738:								.00		39,851.00
145739										
09/24	09/26/2024	145739	721	WE ENERGIES	0701377292-	1	01-55200-2200	.00	10.23	10.23
09/24	09/26/2024	145739	721	WE ENERGIES	0701404176-	1	01-53311-2200	.00	10.23	10.23
09/24	09/26/2024	145739	721	WE ENERGIES	0701404176-	1	01-53311-2200	.00	26.35	26.35
09/24	09/26/2024	145739	721	WE ENERGIES	0704935413-	1	01-55401-2200	.00	26.77	26.77
09/24	09/26/2024	145739	721	WE ENERGIES	0706515242-	1	01-52100-2200	.00	331.18	331.18

M = Manual Check, V = Void Check

GL Period	Check Issue Date	Check Number	Vendor Number	Payee	Invoice Number	Invoice Sequence	Invoice GL Account	Discount Taken	Invoice Amount	Check Amount
09/24	09/26/2024	145739	721	WE ENERGIES	0706515242-	1	01-55200-2200	.00	10.23	10.23
09/24	09/26/2024	145739	721	WE ENERGIES	0706723812-	1	12-55500-2200	.00	10.23	10.23
09/24	09/26/2024	145739	721	WE ENERGIES	0707713977-	1	01-55401-2200	.00	10.23	10.23
09/24	09/26/2024	145739	721	WE ENERGIES	0708538032-	1	10-55110-2200	.00	32.51	32.51
09/24	09/26/2024	145739	721	WE ENERGIES	0711622483-	1	01-55200-2200	.00	10.23	10.23
09/24	09/26/2024	145739	721	WE ENERGIES	0714123594-	1	01-51600-2200	.00	156.93	156.93
09/24	09/26/2024	145739	721	WE ENERGIES	0714229616-	1	01-55402-2200	.00	27.55	27.55
09/24	09/26/2024	145739	721	WE ENERGIES	0715711655-	1	01-55401-2200	.00	525.08	525.08
09/24	09/26/2024	145739	721	WE ENERGIES	0715807202-	1	01-55200-2200	.00	10.23	10.23
09/24	09/26/2024	145739	721	WE ENERGIES	0717659443-	1	12-55500-2200	.00	10.23	10.23
09/24	09/26/2024	145739	721	WE ENERGIES	0718128126-	1	01-53311-2200	.00	40.84	40.84
09/24	09/26/2024	145739	721	WE ENERGIES	0718379081-	1	01-55402-2200	.00	333.54	333.54
09/24	09/26/2024	145739	721	WE ENERGIES	071979527-0	1	01-55200-2200	.00	10.23	10.23
09/24	09/26/2024	145739	721	WE ENERGIES	0735582192-	1	03-52300-2200	.00	178.02	178.02
Total 145739:								.00		1,770.84
Grand Totals:								.00		1,119,286.74

M = Manual Check, V = Void Check

Dated: _____

Mayor: _____

Dwyer, Paul

City Council: _____

Glynn, John

Pater, Nellie

Peterson, Dean

Devine, Patrick

Scholze, Travis

Hart, Nicole

Yarrington, Richard

Zabinski, Shawn

Vendor	Vendor Name	Invoice Number	Description	Invoice Date	GL Account and Title	Net Invoice Amount	Date Paid
3RT NETWORKS							
2131	3RT NETWORKS	CW36445	CW36445	10/16/2024	10-55110-2900 LIBRARY SERVICE CO	1,766.25	
Total 3RT NETWORKS:						1,766.25	
ACE HARDWARE (PARKS)							
2340	ACE HARDWARE (PARKS)	625851	625851	10/16/2024	01-55200-3500 OTHER PARKS REPAI	21.99	
2340	ACE HARDWARE (PARKS)	625863	625863	10/16/2024	01-55401-3500 RECREATION PARK R	3.16	
2340	ACE HARDWARE (PARKS)	625919	625919	10/16/2024	01-55200-3400 OTHER PARKS OPER	51.97	
2340	ACE HARDWARE (PARKS)	625928	625928	10/16/2024	01-55200-3400 OTHER PARKS OPER	9.59	
2340	ACE HARDWARE (PARKS)	626037	626037	10/16/2024	01-55200-3400 OTHER PARKS OPER	21.96	
Total ACE HARDWARE (PARKS):						108.67	
ACE HARDWARE (SENIOR)							
2339	ACE HARDWARE (SENIOR)	625923	625923	10/16/2024	12-55500-3500 SR & DISAB REPAIR &	87.97	
Total ACE HARDWARE (SENIOR):						87.97	
ALL AMERICAN DO-IT CENTER							
27	ALL AMERICAN DO-IT CENTER	67364/3	67364/3	10/16/2024	01-53311-3508 HWY/ST MAINT R&M -	95.55	
27	ALL AMERICAN DO-IT CENTER	67371/3	67371/3	10/16/2024	01-53311-3508 HWY/ST MAINT R&M -	423.84	
27	ALL AMERICAN DO-IT CENTER	67487/3	67487/3	10/16/2024	01-53311-3508 HWY/ST MAINT R&M -	153.31	
27	ALL AMERICAN DO-IT CENTER	K67569/3	K67569/3	10/16/2024	01-55401-3500 RECREATION PARK R	99.00	
Total ALL AMERICAN DO-IT CENTER:						771.70	
ALLIED COOPERATIVE							
2621	ALLIED COOPERATIVE	3219005	3219005	10/16/2024	01-53311-2900 HWY/ST MAINT SERVI	30.15	
Total ALLIED COOPERATIVE:						30.15	
BOUND TREE MEDICAL LLC							
96	BOUND TREE MEDICAL LLC	85500041	IV CATHETER 18 GA X 1.25	10/02/2024	03-52300-3402 AMBULANCE OPER -	197.00	
96	BOUND TREE MEDICAL LLC	85500042	IV CATHETER 18 GA X 1.25	10/02/2024	03-52300-3402 AMBULANCE OPER -	197.00	
96	BOUND TREE MEDICAL LLC	85500043	MEDICAL SUPPLIES	10/02/2024	03-52300-3402 AMBULANCE OPER -	148.12	
Total BOUND TREE MEDICAL LLC:						542.12	

Vendor	Vendor Name	Invoice Number	Description	Invoice Date	GL Account and Title	Net Invoice Amount	Date Paid
CONSOLIDATED ENERGY COMPANY							
436	CONSOLIDATED ENERGY COM	119 10.24	119 10/24	10/16/2024	01-55200-3400 OTHER PARKS OPER	146.12	
Total CONSOLIDATED ENERGY COMPANY:						146.12	
CRAM'S COMPUTER CENTER LLC							
173	CRAM'S COMPUTER CENTER L	6269	FAN INSTALL, AMB TOUGHBOOK SET	10/03/2024	03-52300-2100 AMBULANCE PROF SE	247.50	
Total CRAM'S COMPUTER CENTER LLC:						247.50	
EO JOHNSON CO							
220	EO JOHNSON CO	INV1619059	INV1619059	10/16/2024	12-55500-2900 SR & DISAB SERVICE	198.90	
Total EO JOHNSON CO:						198.90	
FIRST SUPPLY LLC-LA CROSSE							
255	FIRST SUPPLY LLC-LA CROSSE	3661098-00	3661098-00	10/16/2024	01-55200-3500 OTHER PARKS REPAI	5.83	
Total FIRST SUPPLY LLC-LA CROSSE:						5.83	
GENERAL ENGINEERING COMPANY							
1254	GENERAL ENGINEERING COMP	AUGUST 2024	AUGUST INSPECTIONS	10/03/2024	01-52400-2100 INSPECTION PROF SE	2,654.56	
Total GENERAL ENGINEERING COMPANY:						2,654.56	
GERKE EXCAVATING INC							
274	GERKE EXCAVATING INC	70138	70138	10/16/2024	01-53311-3407 HWY/ST MAINT OP SU	991.03	
Total GERKE EXCAVATING INC:						991.03	
GOODYEAR COMMERCIAL TIRE & SERVICE CENTE							
2194	GOODYEAR COMMERCIAL TIR	128-1157571	128-1157571	10/16/2024	01-53635-3400 RECYCLING OPERATI	1,080.00	
Total GOODYEAR COMMERCIAL TIRE & SERVICE CENTE:						1,080.00	
JOHN FABICK TRACTOR COMPANY							
2677	JOHN FABICK TRACTOR COMP	PILC0103498	PILC0103498	10/16/2024	01-53311-3502 HWY/ST MAINT R&M -	871.81	
2677	JOHN FABICK TRACTOR COMP	PILC0103499	PILC0103499	10/16/2024	01-53311-3502 HWY/ST MAINT R&M -	60.36	

Vendor	Vendor Name	Invoice Number	Description	Invoice Date	GL Account and Title	Net Invoice Amount	Date Paid
Total JOHN FABICK TRACTOR COMPANY:						932.17	
MONROE CO SOLID WASTE							
461	MONROE CO SOLID WASTE	1188	1188	10/16/2024	01-53630-5300 SOLID WSTE DISP RE	16,630.74	
Total MONROE CO SOLID WASTE:						16,630.74	
RICK'S CERTIFIED AUTO OF TOMAH LLC							
555	RICK'S CERTIFIED AUTO OF TO	81574	81574	10/16/2024	01-55200-3500 OTHER PARKS REPAI	19.92	
Total RICK'S CERTIFIED AUTO OF TOMAH LLC:						19.92	
SAFE-FAST INC							
569	SAFE-FAST INC	INV297488	INV297488	10/16/2024	01-53311-3409 HWY/ST MAINT OP SU	44.50	
569	SAFE-FAST INC	INV297489	INV297489	10/16/2024	01-53311-3409 HWY/ST MAINT OP SU	874.85	
Total SAFE-FAST INC:						919.35	
TK ELEVATOR CORPORATION							
2350	TK ELEVATOR CORPORATION	3008120776	3008120776	10/16/2024	01-51600-2900 GENERAL BLDGS SER	747.41	
Total TK ELEVATOR CORPORATION:						747.41	
TOMAH WATER & SEWER UTILITY							
658	TOMAH WATER & SEWER UTILI	2050.00 10.24	2050.00 10.24	10/16/2024	01-53311-2220 HWY/ST MAINT UTIL-W	126.91	
658	TOMAH WATER & SEWER UTILI	2067.00 10.24	2067.00 10.24	10/16/2024	01-51600-2220 GENERAL BLDGS UTIL	235.25	
658	TOMAH WATER & SEWER UTILI	2189.00 10.24	2189.00 10.24	10/16/2024	10-55110-2220 LIBRARY UTIL-W&S	174.25	
658	TOMAH WATER & SEWER UTILI	2263.01 10.24	2263.01 10.24	10/16/2024	01-53311-2220 HWY/ST MAINT UTIL-W	53.27	
658	TOMAH WATER & SEWER UTILI	2541.00 10.24	2541.00 10.24	10/16/2024	01-53311-2220 HWY/ST MAINT UTIL-W	22.60	
658	TOMAH WATER & SEWER UTILI	2901.02 10.24	2901.02	10/16/2024	01-53510-2220 AIRPORT UTIL-W&S	24.54	
658	TOMAH WATER & SEWER UTILI	3581.00 09.24	WATER & SEWER	10/03/2024	03-52300-2220 AMBULANCE UTIL-W&	163.82	
658	TOMAH WATER & SEWER UTILI	3581.00 09.24	WATER & SEWER	10/03/2024	01-52200-2220 FIRE PROTECTION UT	40.96	
658	TOMAH WATER & SEWER UTILI	5403.01 10.24	5403.01 10.24	10/16/2024	12-55500-2220 SR & DISAB UTIL-W&S	77.14	
658	TOMAH WATER & SEWER UTILI	854.01 10.24	854.01 10.24	10/16/2024	01-53311-2220 HWY/ST MAINT UTIL-W	22.60	
658	TOMAH WATER & SEWER UTILI	967.01 10.24	967.01 10.24	10/16/2024	01-53311-2220 HWY/ST MAINT UTIL-W	24.54	
Total TOMAH WATER & SEWER UTILITY:						965.88	

Vendor	Vendor Name	Invoice Number	Description	Invoice Date	GL Account and Title	Net Invoice Amount	Date Paid
Grand Totals:						<u>28,846.27</u>	

Dated: _____

Mayor: _____ Dwyer, Paul

City Council: _____ Glynn, John

_____ Pater, Nellie

_____ Peterson, Dean

_____ Devine, Patrick

_____ Scholze, Travis

_____ Hart, Nicole

_____ Yarrington, Richard

_____ Zabinski, Shawn

STAFF COMMITTEE PREPARATION REPORT

Agenda Item:

Resolution Declaring Official Intent to Reimburse Expenditures From Proceeds of Borrowing

Summary and Background Information:

As we use bonding or borrowing to fund most of our capital projects, and the timing of the bonding does not always line up with all the expenditure for our capital projects, we pass this resolution to allow us to use the proceeds of our borrowing to reimburse spending that occurs on the approved projects between this date and the date that we receive our bond proceeds.

Recommendation From:

Molly Powell, Treasurer

Minutes Attached:

Yes No

Budget Account:

Capital Projects Funds

Fiscal Impact:

Up to \$2,418,000

Staff Responsible for implementation:

Molly Powell, Treasurer

Economic Impact:

Saves money on borrowing, by allowing us to use tax exempt borrowing

Zoning/Rezoning Issues:

n/a

Supports Organizational Goals:

Yes No

Questions from SET:

Grants Pursued/Opportunity Pursued: n/a

Recommendation: Approve to allow borrowing for approved capital projects.

Becki Weeyer
SET

10/08/24
Date

Molly Powell
Department Director

10/08/24
Date

Committee: Committee of the Whole and/or Common Council

Meeting Date(s):

RESOLUTION NO.

RESOLUTION DECLARING OFFICIAL INTENT
TO REIMBURSE EXPENDITURES
FROM PROCEEDS OF BORROWING

WHEREAS, the City of Tomah, Monroe County, Wisconsin (the "Issuer") plans to finance 2025 capital improvement projects, including those listed in Exhibit A attached hereto (collectively, the "Project");

WHEREAS, the Issuer expects to finance the Project on a long-term basis by issuing tax-exempt bonds or notes (collectively, the "Bonds");

WHEREAS, because the Bonds will not be issued prior to commencement of the Project, the Issuer must provide interim financing to cover costs of the Project incurred prior to receipt of the proceeds of the Bonds; and

WHEREAS, the Common Council (the "Governing Body") of the Issuer deems it to be necessary, desirable, and in the best interests of the Issuer to advance moneys from its funds on hand on an interim basis to pay the costs of the Project until the Bonds are issued.

NOW, THEREFORE, BE IT RESOLVED by the Governing Body of the Issuer that:

Section I. Expenditure of Funds. The Issuer shall make expenditures as needed from its funds on hand to pay the cost of the Project until proceeds of the Bonds become available.

Section 2. Declaration of Official Intent. The Issuer hereby officially declares its intent under Treas. Reg. Section I .150-2 to reimburse said expenditures with proceeds of the Bonds, in an amount not expected to exceed \$2,418,000.

Section 3. Unavailability of Long-Term Funds. No funds for payment of the Project from sources other than the Bonds are, or are reasonably expected to be, reserved, allocated on a long-term basis, or otherwise set aside by the Issuer pursuant to its budget or financial policies.

Section 4. Public Availability of Official Intent Resolution. The Resolution shall be made available for public inspection at the office of the Issuer's Clerk within 30 days after its approval in compliance with applicable State law governing the availability of records of official acts including Subchapter II of Chapter 19, and shall remain available for public inspection until the Bonds are issued.

Section 5. Effective Date. This Resolution shall be effective upon its adoption and approval.

Adopted and recorded _____, 2024

Approved _____, 2024

Paul Dwyer
Mayor

ATTEST:

(SEAL)

Rebecca Weyer
City Clerk

Item 10.

Exhibit A

City of Tomah
2025 Capital Projects - Reimbursement Resolution

DEPARTMENT	DESCRIPTION	COST
CITY HALL	IT EQUIPMENT	25,000.00
FIRE	FIRE TRUCK	1,000,000.00
FIRE	DRONE	30,000.00
FIRE	CHIEF TRUCK	75,000.00
PARKS	FIREMENS PARK UPGRADES	250,000.00
PARKS	FLARE AVENUE UPGRADES	75,000.00
PARKS	FORMER EMS BUILDING UPGRADES	40,000.00
PARKS	REC PARK MIDWAY UPGRADES	200,000.00
POLICE	2 SQUADS WITH UPFITTING	123,000.00
STREETS	SINGLE AXLE PLOW TRUCK	200,000.00
STREETS	PICKUP TRUCK	50,000.00
STREETS	FOAM MACHINE	100,000.00
STREETS	SEAL COATING PROJECTS	<u>250,000.00</u>
		2,418,000.00

104

STAFF COMMITTEE PREPARATION REPORT

Agenda Item:

Approval of the Application of Remaining ARPA funds

Summary and Background Information:

The City received \$983,570.41 in funding from the American Rescue Plan Act of 2020. These funds have been used for a variety of projects, as approved by Council.

The remaining \$279,832.13 must be assigned before 12/31/2024.

As approved at the budget workshop, we would like to assign the remaining balance as follows:

- 74,000 – 2025 Senior Center Operations
- 122,000 – 2026 General Fund – IT Expenditures
- 83,832 – 2026 General Fund – IT Expenditures

Recommendation From:

Molly Powell, Treasurer

Minutes Attached:

Yes No

Budget Account:

ARPA Fund 19

Fiscal Impact:

\$279,832.13

Staff Responsible for implementation:

Molly Powell, Treasurer

Economic Impact:

Frees up levy that would otherwise be used for operating expenses

Zoning/Rezoning Issues:

n/a

Supports Organizational Goals:

Yes No

Questions from SET:

Grants Pursued/Opportunity Pursued: n/a

Recommendation: Approve as proposed.

Becki Wayne
SET

10/08/2024
Date

Molly Powell
Department Director

10/08/2024
Date

Committee: Committee of the Whole and/or Common Council

Meeting Date(s):

STAFF COMMITTEE PREPARATION REPORT

Agenda Item:

Request for Approval of Leave Donation

Summary and Background Information:

The city offers a sick leave donation program, where employees who are short on medical leave can request donations from city employees for major illness or procedures. The leave policy requires that the donating employee cannot go below a balance of 80 hours AFTER the donation.

As I am leaving, and do not need my leave, I am requesting approval to donate 40 hours of my sick leave to a City employee with an open leave donation request.

Recommendation From:

Molly Powell, Treasurer

Minutes Attached:

Yes No

Budget Account:

Fiscal Impact:

Staff Responsible for implementation:

Molly Powell, Treasurer

Economic Impact:

This would allow the employee to use leave for time away for surgery. This leave will otherwise disappear.

Zoning/Rezoning Issues:

n/a

Supports Organizational Goals:

Yes No

Questions from SET:

Grants Pursued/Opportunity Pursued: n/a

Recommendation: Approve as proposed.

SET

10/08/2024
Date

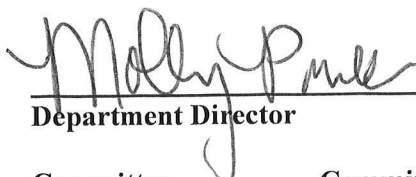
Department Director

10/08/2024
Date

Committee: Committee of the Whole and/or Common Council

Meeting Date(s):

**City of Tomah
Cash and Investments
September 30, 2024**

Fund 01 - General Fund						
Investment Description	Investment Type	C/D Rate	C/D Due	Beginning Balance 8/31/2024	Ending Balance 9/30/2024	
Pershing	Spokane Teachers CU	C/D	5.00	11/25/24	115,000.00	115,000.00
Pershing	State Bank of India NY	C/D	1.05	06/10/25	245,000.00	245,000.00
Pershing	Global Fed Anchorage	C/D	5.20	06/16/25	120,000.00	120,000.00
Pershing	Texas Exchange Bk Crowley	C/D	1.00	06/19/25	155,000.00	155,000.00
Pershing	Texas Exchange Bk	C/D	0.85	04/10/22	200,000.00	200,000.00
Pershing	Alliant CR Chicago	C/D	5.00	01/30/26	103,000.00	103,000.00
Pershing	Live Oak Bk	C/D	0.60	10/08/26	100,000.00	100,000.00
Pershing	Rollstone Bank & Trust	C/D	3.55	08/23/27	165,000.00	165,000.00
Pershing	Bridgewater Bk	C/D	0.55	09/20/27	60,000.00	60,000.00
Pershing	Toyota Fin Svgs Bank	C/D	0.90	11/30/27	100,000.00	100,000.00
Pershing	Morgan Stanley Pvt Bank	C/D	0.75	01/27/28	70,000.00	70,000.00
Pershing	Frazer Bk Okla	C/D	1.10	06/26/28	50,000.00	50,000.00
Pershing	US Treasury Bills	C/D		10/03/24	129,000.00	129,000.00
Pershing	Federal Farm Credit	C/D	1.54	11/30/26	300,000.00	300,000.00
Pershing	Federal Farm Credit Bank	C/D	2.45	02/23/28	145,000.00	145,000.00
Pershing	Michigan State Hsg Dev Auth	Muni Bond	4.98	12/01/28	235,000.00	235,000.00
Pershing	US Govt MM Fund	MM			9,690.10	11,357.68
FMB	x706	C/D	0.40	01/15/22	119,856.06	119,856.06
LGIP	01	TF			6,570.27	6,598.45
Bank First	X6465	M/M	2.96		814,026.52	315,472.06
Bank First	ED X1194	M/M			180,943.78	183,229.57
CCF	ICS MM ACCOUNT	M/M			743,967.10	745,497.30
CCF	X768	M/M	0.10		28,390.58	28,450.85
TOTAL					4,195,444.41	3,702,461.97

Fund 02 - Lake						
Investment Description	Investment Type	C/D Rate	C/D Due	Beginning Balance 8/31/2024	Ending Balance 9/30/2024	
RIA	4337420053	C/D	1.85	03/03/21	15,757.95	15,790.24
LGIP	03	TF			30,121.98	30,251.17
RIA	44374202	M/M			207,699.90	207,904.19
TOTAL					253,579.83	253,945.60

Fund 04 - CDBG						
Investment Description	Investment Type	Beginning Balance 8/31/2024	Ending Balance 9/30/2024			
TACU	CK	2,871.60	2,871.71			
TACU	SAVINGS	792.02	892.05			
Bank First	CK	873.55	873.55			
Bank First	X0822 SAVINGS	280,477.71	281,501.95			
TOTAL					285,014.88	286,139.26

**City of Tomah
Cash and Investments
September 30, 2024**

Fund 07 - Debt						
		Investment Description	Investment Type		Beginning Balance 8/31/2024	Ending Balance 9/30/2024
LGIP	06		T/F		8,281.72	8,317.24
Bank First	X6465		M/M	2.96	381,029.49	382,783.46
TOTAL					389,311.21	391,100.70

Fund 08 - Capital						
		Investment Description	Investment Type		Beginning Balance 8/31/2024	Ending Balance 9/30/2024
LGIP	02		T/F		92,148.36	92,543.57
Pershing	2022A		M/M		1,216,260.53	1,220,738.59
Pershing	2023A - Morgan Stanley		C/D		-	50,000.00
Pershing	2023A		M/M		2,677,888.83	1,333,158.11
Pershing	2024A - US TREASURY BILLS		C/D		-	1,756,000.00
Pershing	2024A		M/M		1,836,764.68	88,673.22
Bank First	X6465		M/M	2.96	87,987.00	88,392.02
CCF	X768		M/M	0.10	26,512.26	26,568.56
TOTAL					5,937,561.66	4,656,074.07

Fund 10 - Library						
		Investment Description	Investment Type		Beginning Balance 8/31/2024	Ending Balance 9/30/2024
TrustPoint			MM		1,139,244.48	1,160,039.54
TOTAL					1,139,244.48	1,160,039.54

Sewer Department							
		Investment Description	Investment Type	C/D Rate	C/D Due	Beginning Balance 8/31/2024	Ending Balance 9/30/2024
Pershing		Oregon Cmnty CU	C/D	4.45	08/21/25	249,000.00	249,000.00
Pershing		United Roosevelt	C/D	0.55	03/12/26	245,000.00	245,000.00
Pershing		First Natl Bk Amer East Lansing	C/D	0.75	04/30/26	155,000.00	155,000.00
Pershing		Sallie Mae Murray UTAH	C/D	0.90	06/30/26	180,000.00	180,000.00
Pershing		US Treasury Bonds	C/D		07/23/24	-	219,000.00
Pershing		Pershing MM	M/M			216,900.10	1,191.71
LGIP	04		T/F			599,342.81	601,913.29
CCF	XX8352		M/M			419,344.62	420,235.01
CCF	ICS Sweep		M/M			272,583.90	273,144.61
Bank First	X6341		M/M			1,431,761.75	886,680.25
Bank First	CLEARING ACCT		M/M			543,358.72	758,039.95
TOTAL						4,312,291.90	3,989,204.82

**City of Tomah
Cash and Investments
September 30, 2024**

Water Department						
Investment Description	Investment Type	C/D Rate	C/D Due	Beginning Balance 8/31/2024	Ending Balance 9/30/2024	
Pershing	Pacific Western	C/D	5.50	09/30/24	245,000.00	-
Pershing	Affinity Fed CU	C/D	5.80	10/24/24	200,000.00	200,000.00
Pershing	Centris Fed CR	C/D	5.65	03/24/25	130,000.00	130,000.00
Pershing	Mid American CU	C/D	5.25	07/03/25	248,000.00	248,000.00
Pershing	Connexus CU Wausau	C/D	5.25	07/18/25	248,000.00	248,000.00
Pershing	Technology CU San Jose	C/D	5.25	07/23/25	248,000.00	248,000.00
Pershing	California CU Glendale	C/D	5.65	10/27/25	200,000.00	200,000.00
Pershing	Texas Exchange	C/D	0.60	12/18/25	90,000.00	90,000.00
Pershing	Sunwest Bk Irvine	C/D	0.70	04/30/26	45,000.00	45,000.00
Pershing	US Bank Salt Lake City	C/D	0.95	09/22/26	100,000.00	100,000.00
Pershing	Toyota Fin Svgs Bank	C/D	0.90	11/30/27	145,000.00	145,000.00
Pershing	Fed Home Loan Bank	C/D	0.75%	08/26/25	260,000.00	260,000.00
Pershing	Pershing MM	M/M			5,173.01	261,814.68
LGIP	05	TF			11,255.41	11,303.68
CCF	x659	M/M			215,613.50	70,290.10
CCF	ISC SWEEP ACCOUNT 659	M/M			413,899.59	414,750.87
Bank First	CLEARING ACCT	M/M			431,379.87	682,544.33
TOTAL					3,236,321.38	3,354,703.66

TOTAL BY INSTITUTION		
	8/31/2024	9/30/2024
Bank First	4,151,838.39	3,579,517.14
Pershing	11,242,677.25	9,976,933.99
Trust Point	1,139,244.48	1,160,039.54
CCF	2,120,311.55	1,978,937.30
Farmers & Merchants Bank Kendall	119,856.06	119,856.06
Local Government Investment Pool	747,720.55	750,927.40
RIA Federal Credit Union	223,457.85	223,694.43
Tomah Area Credit Union	3,663.62	3,763.76
TOTAL		19,748,769.75
		17,793,669.62