



BOARD OF MARINA, PARKS & FORESTRY AGENDA

May 03, 2022 at 4:15 PM

**Municipal Service Building - Training Room, 2026 New Jersey
Avenue**

It is possible that a quorum (or a reverse quorum) of the Sheboygan Common Council or any other City committees/boards/commissions may be in attendance, thus requiring a notice pursuant to State ex rel. Badke v. Greendale Village Board, 173 Wis. 2d 553, 494 N.W.2d 408 (1993).

Persons with disabilities who need accommodations to attend this meeting should contact the Department of Public Works, (920) 459-3440. Persons other than commission, committee, and board members who wish to participate remotely shall provide notice to the Public Works Department at 920-459-3440 at least 24 hours before the meeting so that the person may be provided a remote link for that purpose.

OPENING OF MEETING

1. Call to Order
2. Roll Call
3. Pledge of Allegiance
4. Public Input (3 minute limit per individual)

MINUTES

- [5.](#) Approval of Minutes: February 1, 2022

ITEMS FOR DISCUSSION AND POSSIBLE ACTION

6. Election of Officers, Chair and Vice Chair
- [7.](#) IMBA Proposal for Evergreen and Jaycee Park Trails Assessment and Planning (J. Kerlin)
8. Formation of Friends of Sheboygan Disc Golf (D. Wield)
- [9.](#) Marina Report (M. Rentmeester)
- [10.](#) Maywood Report (S. Lammers)
- [11.](#) Park and Forestry Report (J. Kerlin, T. Bull)

NEXT MEETING DATE

12. Next regular meeting date: August 2, 2022

ADJOURN

13. Motion to Adjourn

In compliance with Wisconsin's Open Meetings Law, this agenda was posted in the following locations more than 24 hours prior to the time of the meeting:

*City Hall • Mead Public Library
Sheboygan County Administration Building • City's website*

CITY OF SHEBOYGAN**BOARD OF MARINA, PARKS & FORESTRY****TUESDAY, FEBRUARY 1, 2022**

Vice-Chair Dennis Wield called the meeting to order at 4:15 p.m. The Pledge of Allegiance followed.

COMMISSION MEMBERS PRESENT: Vice-Chair Dennis Wield, Rebecca Clarke, Alderperson Dean Dekker, Superintendent of Parks and Forestry Joe Kerlin (remote), Marilyn Montemayor, Travis Gross, and Sarah Schwefel (remote).

COMMISSION MEMBERS EXCUSED: Chair Mike Froh, John Koehler, and Marge Mattern.

STAFF/OFFICIALS PRESENT: Business Manager Dawn Sokolowski, City Forester Tim Bull, Sergeant Timothy Patton, Graham Vervelde, and Rachel Kerlin.

MINUTES

Motion by Marilyn Montemayor, seconded by Travis Gross to approve the minutes of November 2, 2021.
Motion carried.

REPORTS

3.1 Marina Report (M. Rentmeester, R. Kerlin, G. Vervelde)

3.2 Maywood Report (S. Lammers)

3.3 Park and Forestry Report (J. Kerlin, T. Bull)

NEXT REGULAR MEETING DATE

May 3, 2022

ADJOURN

Motion by Rebecca Clarke, seconded by Marilyn Montemayor to adjourn at 4:55 p.m. Motion carried.



Evergreen Park Site Visit Memo

Site visit took place over two days in August 2020.

Conditions were hot and humid following a couple days of heavy rain.

Assessment-Observations

- Evergreen Park is a traditional park with a loop road leading to shelters, playgrounds, restrooms, and parking.
- Signage is limited to entry feature, loop road navigation, shelters, parking, and winter trails (snowshoe and XC ski). Winter trail signage does not seem to be complete or is in disrepair.

Shared Use Trails

- No shared use trail signage or bike trail specific signage.
- A preferred MTB route is not identifiable Shared use trails are traditional singletrack network throughout the park. Spiderweb of trails making it confusing to navigate.
- Trails look to have evolved organically over the years.
- Many "social" lines and options have developed.
- Singular experience of initially narrow tread, natural, roots, disjointed flow.
- Bridge structures spanning drainages are in disrepair.

Note, a first-time visitor MTB rider came out of the woods not knowing where he was and talked about how difficult it was to navigate the trails without the reassurance of signage and wayfinding. Mentioned he usually rides around Cable and Kettle Moraine.

Trail Conditions

- Trail tread is cupped throughout the system.
- Lack of drainage management.
- Tread creep and widening throughout the park.
- "Social lines" created when trails fail.
- Fall line trails are present when slopes gain grade.
- Trails that set in low lying wet areas are likely unrideable most of the year, especially in the spring.
- Lack of modern bike-optimization.





Cupped trail leading to low lying area



Trail widening and braiding



Parallel treads and widening in wet area

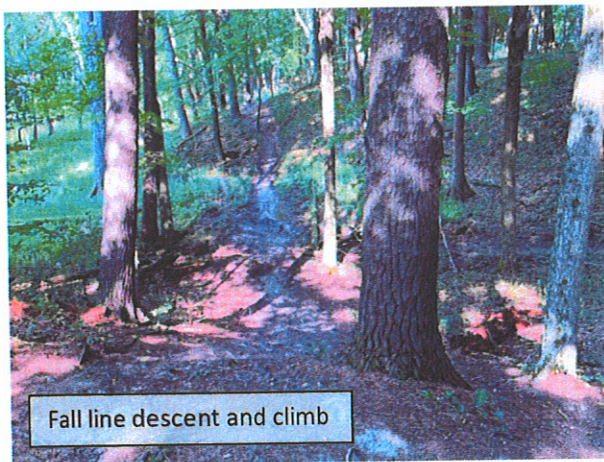

Fall line descent and climb



Bridge in disrepair

Evergreen Park Site Visit Memo – October 15, 2020



Recommendations and Concepts.

Trail Network

- Develop a shared use trail signage plan.
- Perform a detailed trail-by-trail segment assessment of conditions and experience intent. *(beyond our current scope of work)*
- Make recommendations for realignments, drainage improvements, new segments, and closures.
- Identify Primary MTB trail alignments with preferred direction and signage.

Bike - Optimized Facilities

- Create a plan that serves beginners, skills development, and engaging for intermediate/advanced riders. See following map graphic.

Skills Development (light green zone)

- Beginner loop or Bicycle Playground with low/wide rideable features
- Low-intermediate loop(s) with progressing rideable features.

Pumptrack set in natural setting. (red zone)

- Can be constructed out of dirt or asphalt.
- More of a linear pump trail than an enclosed pumptrack.

Pumptrack Options (bright green zones)

- Asphalt tot track and/or pumptrack with progression built into it.

Flow and Jump (blue zone)

- Terrain and slopes are ideal for flow trail(s) development with optional lines and jump features.

Technical Trails (purple zone)

- Terrain with slopes allow for short techy climbs and rough descents.
- Presence of existing rock, import more rock, for trail tread.
- Make better use of elevation changes than existing trails.

"Shred Sidewalk"

- Similar to Bentonville's A-Street "Shred to School" trail.
- Crushed limestone or chip seal for durability and reduced maintenance.
- Wide with rollable and jump/tech features.
- "Sessionable" beginner flow lines and advanced bump and jump trails.

Next Steps

- City/Client to provide initial feedback on these observations and recommendation.
- IMBA TS refines concept and writes draft concept plan document.
- City/Client reviews draft document.
- IMBA TS finalizes document for City to use as a framework for next steps in gaining support, funding, and discussions about phasing/implementation.

Evergreen Park Site Visit Memo – October 15, 2020



INTERNATIONAL MOUNTAIN BICYCLING ASSOCIATION



Evergreen and Quarry Parks
Sheboygan, WI

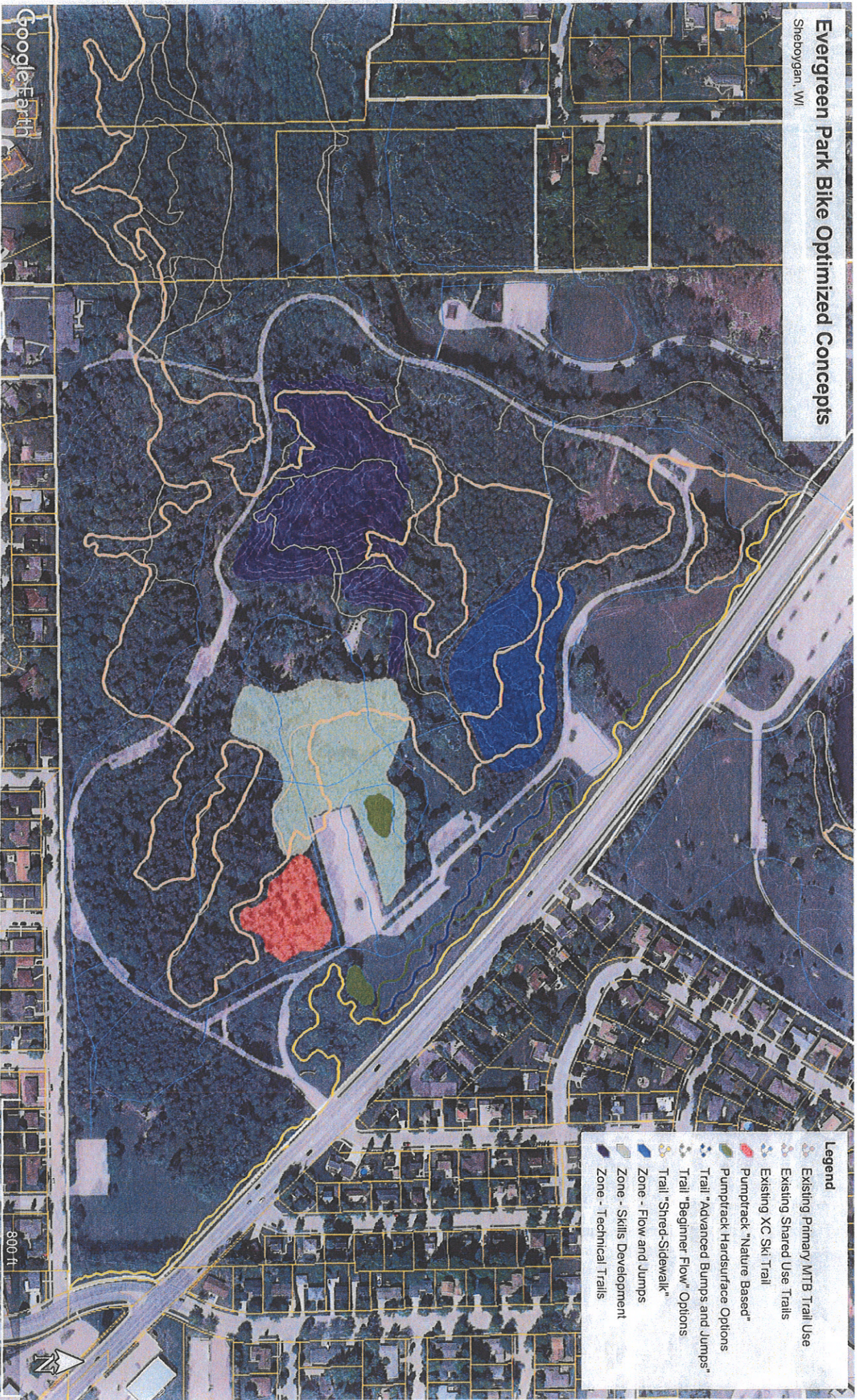

Evergreen Park Trails Concept Plan Sheboygan, WI

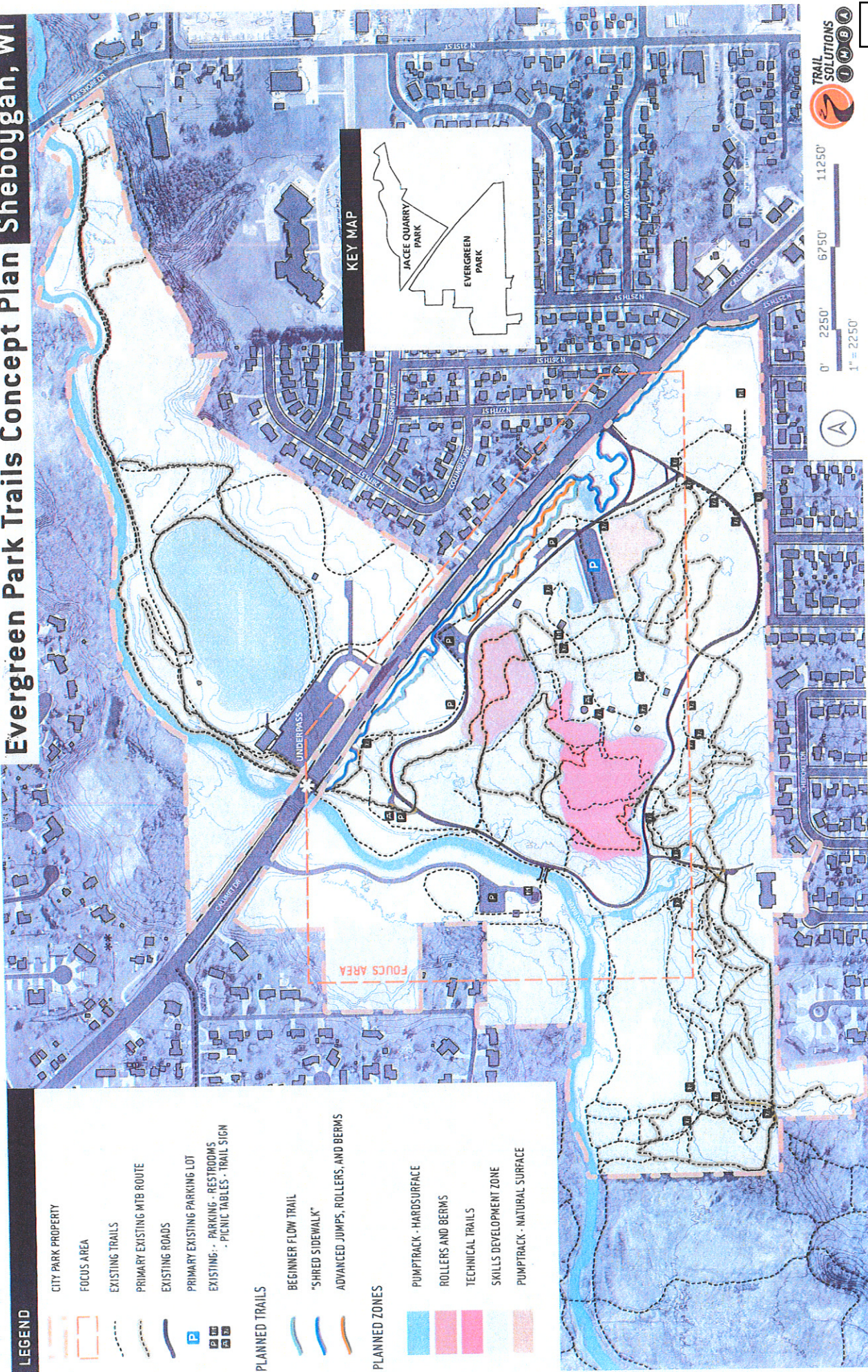

Item 7.



Joe Kerlin
Superintendent of Parks and Forestry
City of Sheboygan, WI – DPW
2026 New Jersey Ave, Sheboygan, WI 53081

Via: Joe.kerlin@sheboyganwi.gov

February 28, 2022

Mr. Kerlin,

Thank you for the opportunity to submit the following proposal to complete a trails assessment and trail improvement planning exercise for Evergreen and Quarry Parks in Sheboygan, WI.

As the international leader in developing natural surface trails, IMBA Trail Solutions has partnered extensively with NGO's while working alongside state, county, and federal land management agencies, and has deep experience in ensuring trail projects meet our clients' goals. Our staff excels at planning, design, and construction of natural surface trail facilities and bike parks that provide unique and high-quality experiences for visitors of all ages and ability levels.

If you agree with the attached proposal, please sign, scan, and return it to me.
Do not hesitate to contact me if you have any questions on the following scope of work and fee estimate.

Sincerely,

MICHAEL D. REPYAK

Michael Repyak, Trail Solutions Director of Planning and Design
International Mountain Bicycling Association
Mike.Repyak@imba.com





Qualifications and Experience

IMBA Trail Solutions (TS) is the international leader in developing singletrack trails, with experience in over 750 projects in the North America, Europe, and Asia. Our staff excels at planning, design, and construction of trail systems that provide high-quality experiences for local riders and destination visitors while simultaneously minimizing environmental impacts.

TS is a fee-for-service based arm of the International Mountain Bicycling Association (IMBA), a 501(c)3 non-profit organization. IMBA's mission is to create, enhance, and protect great places to ride mountain bikes. TS employs approximately twenty professional trail planners and builders. In addition to being industry professionals and exceptional mountain bike riders, TS staff hold a broad base of applicable skills and knowledge from planning, landscape architecture, environmental sciences to GIS systems, AutoCAD, and graphic design.

Our wealth of experience has allowed us to develop the gold standard guidelines for creation of both sustainable and enjoyable singletrack trails. These guidelines have influenced all major federal land management agencies and many state and local parks departments. We pride ourselves on the positive experiences we have provided to the millions of active trail users around the world, and in the economic independence that communities have achieved through the development of destination trail systems.



Evergreen Park and Quarry Park Trails Assessment and Improvement Planning – Sheboygan, WI



INTERNATIONAL MOUNTAIN BICYCLING ASSOCIATION



Project Approach

IMBA Trail Solutions (TS) proposes a collaborative process of assessment and planning. City of Sheboygan staff and appropriate stakeholders will be engaged and informed throughout the assessment and planning process. By doing so, all involved will have opportunities to review our assessment reporting, recommendations on trail improvements, comment on deliverables, and set the stage for future implementation of a successful project.

To kick off the project, TS will meet with City of Sheboygan staff and appropriate stakeholders to discuss the goals for improving trails, the range of users to plan for, the desired trail experiences to be offered, and the existing operations and management of the parks.

TS staff will then review the project area to inventory the landscape and existing trails. TS staff will review each trail, sanctioned and unsanctioned, by foot and bicycle to determine sustainability and appropriateness. Special attention is paid to natural resources, soil types, slopes, and the purpose of the trail within the larger system. This site visit will inform the tasks to complete a Trails Assessment Plan, considerations that will guide the next steps of detailed design and implementation.

Trail Solutions assessment and planning practices will set a framework that advises the eventual development of trail management objectives, recommended implementation methods, updated cost estimates and phasing recommendations. Those details can be used during subsequent steps in the design and implementation process.

The following Scope of Work and Fee Estimate outlines the proposed assessment and planning. Once these tasks are complete, Trail Solutions will have detailed information that will allow us to recommend an appropriate list of next steps.

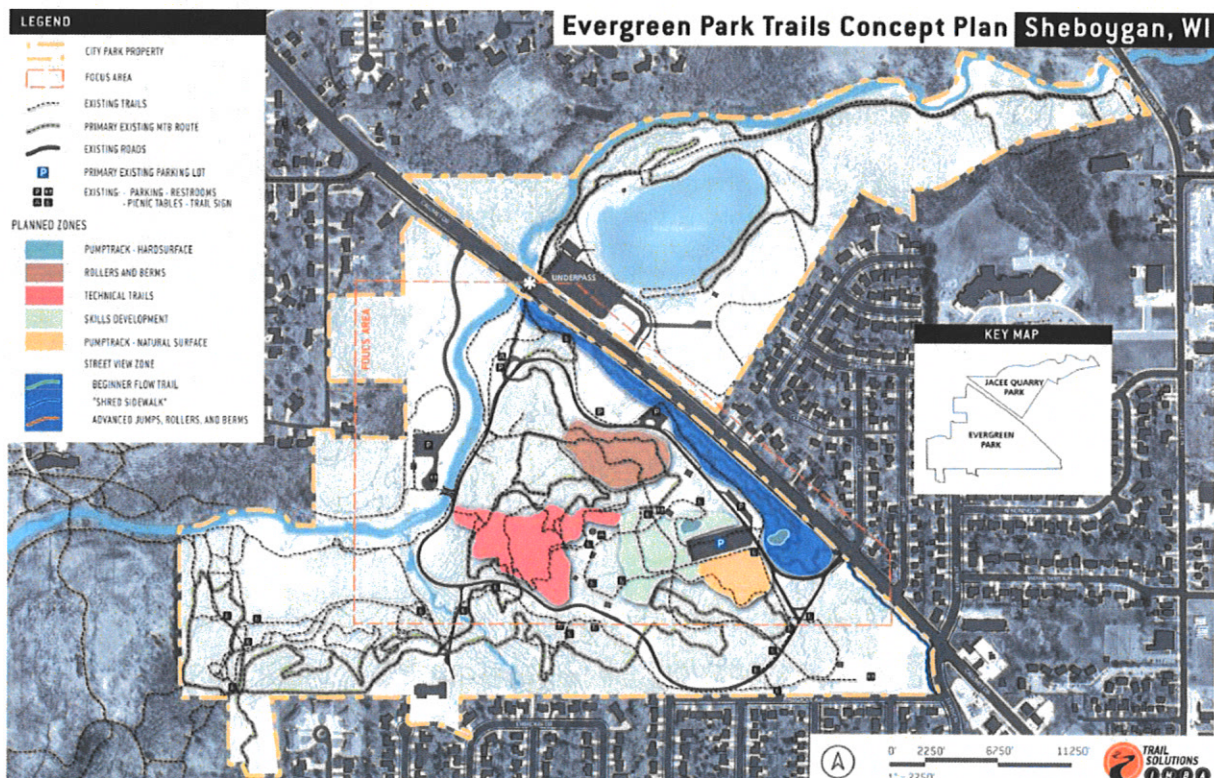



Scope of Work

TASK 1 – Project Preparation

- Discuss project goals and objectives with City of Sheboygan staff and stakeholders.
- Ongoing project management and coordination via phone calls, emails, and video conferences as needed to ensure a successful project, budget, and timeline.
- Update current mapping data as needed.
- Update base map to be used for assessment, planning, and site visit. The map will be complete with area of interest, existing conditions (*roads, buildings, boundaries, land ownership, infrastructure, hydrology, vegetation*), topographic contour information, and orthophotography.

Deliverables – Project understanding, ongoing management, and updated base mapping

TASK 2 – Assessment and Planning Fieldwork

- TS staff will travel to Sheboygan, WI.
- Review the project area, surrounding landscape, and existing trails. During the site visit special attention will be made to inventory and assess existing trails for sustainability, natural resource impacts, and experience goals. Focus on determining suitability of existing trails for the terrain, management goals, and trail system experiences. Areas will be observed and assessed for trail reroutes, improvements, or additions to meet the management and community goals.

Deliverables – Field assessment and observations, KML data

TASK 3 – Client and Stakeholder Meetings

- Meet with City of Sheboygan staff and appropriate stakeholders to discuss existing property, project goals/objectives, important ecological areas, desired trail experiences, trail user demographics, and implementation strategies.
- Meet with local trail users to discuss their desires and experience objectives from the existing trail systems while informing them of the ongoing assessment and planning process.

Deliverables – Client and stakeholder feedback and support

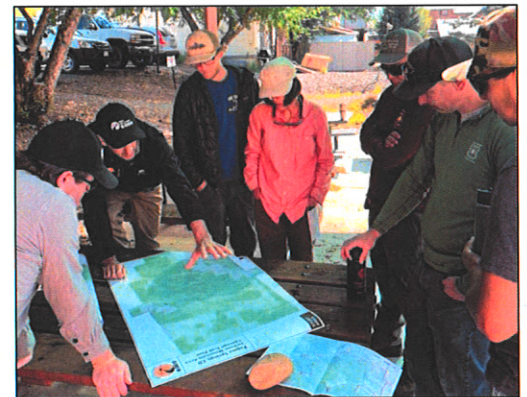

Evergreen Park and Quarry Park Trails Assessment and Improvement Planning – Sheboygan, WI



TASK 4 – Trails Assessment Deliverable

- The Trails Assessment Plan, to the extent possible based on the site visit, will recommend a variety of actions for the existing trail network. Trail improvements, relocations, and closures will be identified within the plan. The plan will outline a priority of implementation based upon management goals, financial burden, and timelines.
- A draft Trails Assessment Graphic showing all inventoried trails and their current status, as well as recommended actions, will be produced to help illustrate the Trails Assessment Plan.
- Upon review of the graphic, TS will compile a Trails Assessment Report detailing our field findings, assessment, and concept plan as shown in the graphic. The report will include sections on trail benefits, management goals, experience objectives, recommended trail actions, permitting considerations, implementation approach, phasing considerations, and preliminary development/construction cost opinion.
- TS will provide a draft graphic and report for review by City of Sheboygan staff and any appropriate stakeholders. One review is anticipated which will provide TS with succinct and concise comments and edits. Once all comments have been received, TS will edit and finalize the report.

Deliverables – Trails Assessment Graphic and Report

OPTIONAL TASK – Public Engagement

TS can create a project specific GIS Storymap that informs the public throughout the trails planning process and can be a portal to solicit public input.

- During Task 1, setup GIS Storymap with project narratives
- During Task 1, create a public engagement survey to gather input on existing trail experience and trail improvements, additions, share-use trails, single-use trails, etc.
- At the beginning of Task 2, review and report on engagement feedback to client and stakeholders
- Update Storymap with assessment findings and draft trails improvement plan graphic from Task 4.3
- Upon completion of Task 4.4, update Storymap with final assessment and trail improvement plan document.

Example Storymap from the MadBAT feasibility and planning project in Madison, WI

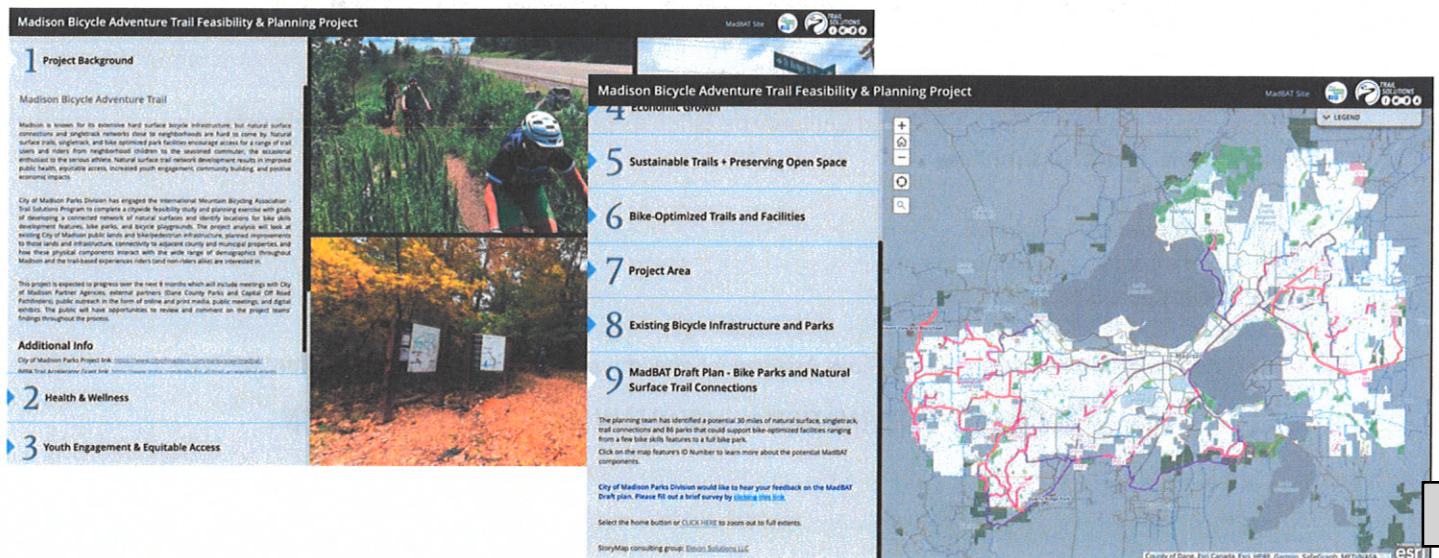



Fee Estimate

Evergreen Park and Quarry Park Trails Assessment and Planning - Sheboygan,		
	Expenses	Fee
TASK 1 - PROJECT PREPARATION		
1.1 Project kick off call with client and stakeholders		\$ 310
1.2 Project management and coordination		\$ 760
1.3 Base mapping update		\$ 570
1.4 Field assessment map set up		\$ 760
TASK 1 SUBTOTAL		\$ 2,400
TASK 2 - ASSESSMENT AND PLANNING FIELDWORK (2 staff, 3 days)		
2.1 Travel to/from Sheboygan, WI		\$ 2,330
2.2 On site assessment and planning		\$ 4,840
TASK 2 SUBTOTAL		\$ 7,170
TASK 2 EXPENSES		\$ 3,950
TASK 3 - CLIENT AND STAKEHOLDER MEETINGS		
3.1 On site meeting with city staff and key stakeholders		\$ 605
3.2 Meeting with local trail users		\$ 605
TASK 3 SUBTOTAL		\$ 1,210
TASK 4 - TRAILS ASSESSMENT DELIVERABLE		
4.1 Create trails assessment map graphic		\$ 1,760
4.2 Review and revise trails assessment graphic based on client comments		\$ 595
4.3 Draft trails assessment document		\$ 1,950
4.4 Review and finalize trails assessment document based on client comments		\$ 785
TASK 4 SUBTOTAL		\$ 5,090
OPTIONAL TASK - PUBLIC ENGAGEMENT CONTENT		
5.1 GIS Storymap setup with introduction of project and survey link		\$ 3,090
5.2 Create public engagement online-survey		\$ 785
5.3 Review and report on engagement feedback		\$ 595
5.4 Update Storymap with assessment findings and trail improvement plan graphic		\$ 380
5.5 Review and report on public feedback regarding assessment and improvement graphic		\$ 595
5.6 Update Storymap with final deliverables		\$ 380
TASK 5 SUBTOTAL		\$ 5,825
TASKS 1-4 LABOR COSTS		\$ 15,870
ESTIMATED EXPENSES		\$ 3,950
TASKS 1-4 PROJECT COSTS		\$ 19,820
OPTIONAL TASK LABOR COSTS		\$ 5,825
OPTIONAL TASK ESTIMATED EXPENSES		
OPTIONAL TASK COSTS		\$ 5,825
TOTAL PROJECT COSTS		\$ 25,645

TS will bill this project on a lump sum by task.

Expenses are estimated to be \$3,950 and will only be billed as incurred; this includes travel costs, lodging, meals, and field supplies.

Tasks 1-4 Project Costs \$19,820

Optional Task Costs \$5,825

Total Project Costs \$25,645

Evergreen Park and Quarry Park Trails Assessment and Improvement Planning – Sheboygan, WI



INTERNATIONAL MOUNTAIN BICYCLING ASSOCIATION



MARINA

821 Broughton Drive Sheboygan, WI 53081

Tuesday May 3rd 2022

MPF COMMITTEE REPORT**Seasonal Slips**

Size	Available	2021 Occ.	YTD	2021 (%)	2022 Occ.	YTD	2021 (%)	Variance (%)	Revenue 2021	Revenue 2022	Variance	2022 Budget	Variance
Sport Ports	10	8	80%	6	60%	-20%	\$ 5,230.00	\$ 2,224.00	\$ (3,006.00)	\$ 7,000.00	\$ (4,776.00)		
Kayak Space	32	0	0%	0	0%	0%	\$ -		\$ -	\$ -	\$ -		
30'	71	38	54%	46	65%	11%	\$ 78,120.00	\$ 97,540.78	\$ 19,420.78	\$ 102,000.00	\$ (4,459.22)		
35'	100	62	62%	71	71%	9%	\$ 139,017.49	\$ 162,411.61	\$ 23,394.12	\$ 160,000.00	\$ 2,411.61		
40'	43	23	53%	20	47%	-7%	\$ 55,815.00	\$ 79,687.03	\$ 23,872.03	\$ 70,000.00	\$ 9,687.03		
45'	13	13	100%	18	138%	38%	\$ 40,509.76	\$ 47,416.14	\$ 6,906.38	\$ 60,000.00	\$ (12,583.86)		
50'	5	10	200%	1	20%	-180%	\$ 41,755.41	\$ 4,325.50	\$ (37,429.91)	\$ 45,000.00	\$ (40,674.50)		
T-Docks	4	3	75%	4	100%	25%	\$ 14,960.00	\$ 15,671.58	\$ 711.58	\$ 16,000.00	\$ (328.42)		
Total	278	157	56%	166	60%	3%	\$ 375,407.66	\$ 409,276.64	\$ 33,868.98	\$ 460,000.00	\$ (31,852.73)		

	2021	%	2022	%
New Tenants	49	31%	30	18%
Returning Tenants	142	90%	136	82%

	2021 LYTD	2022 YTD
Deposits for Next Season	N/A	N/A

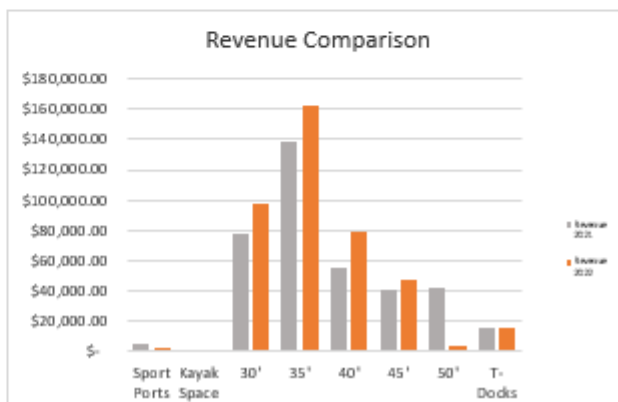
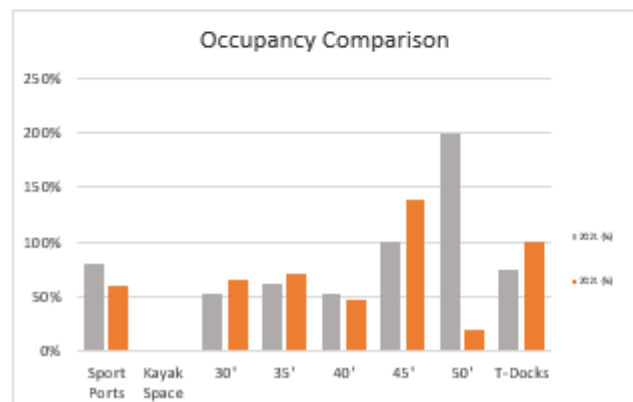
**Winter Storage**

YTD	LYTD	LYTD	Variance To	Variance to
Units	YTD Revenue	Units	Last Year	Budget
48	\$41,457.33	49	\$ 43,587.33	\$ 28,000.00
			\$ (2,130.00)	\$ 13,457.33



MARINA

821 Broughton Drive Sheboygan, WI 53081

Tuesday May 3rd 2022

MPF COMMITTEE REPORT**Marketing and Sales**

The marina is officially open! The store has seen an increase in traffic since the marina opened, launch ramps are selling ahead of budget. The store is now open everyday 8am-9pm which has led to more food sales. This year we added harbor club to our early sign-up incentive instead of offering a discounted slip rate. As boaters are checking in for the season, we are hearing positive feedback about the this program and have already had multiple customers take advantage of it by ordering special boat parts through us. Currently we have 166 slip tenants with 30 of those being new to the marina. We did loose a few boaters because of the G dock being down. We are on track to still be busy with transient traffic and still have groups come from other marinas, we plan on using the south pier for any bigger vessels we may get.

Maintenance and Operations

Even though the marina is open we are still working on repairs. Flotation docking system came in and repaired what they could in the time they had. They repaired the G dock ramp and E and F dock, these were the most crucial areas. Chappa is currently finishing the repairs to the rest of the system. They are about halfway done on C dock and then will start on A. The A dock ramp still needs to be repaired as well as the marginal between C and E. We have bandaged what we could in the time being to make the dock useable. C dock can now start to take boats and we have been filling in those slips. Water is currently on as of April 28th. Currently the wifi is also being repaired as well as our key fob system on the G dock ramp. We are set for May 23rd to have they key fob system working on the G dock gate. We have also begun our launch season, plans for the yard to be down before Memorial Day weekend is on track.

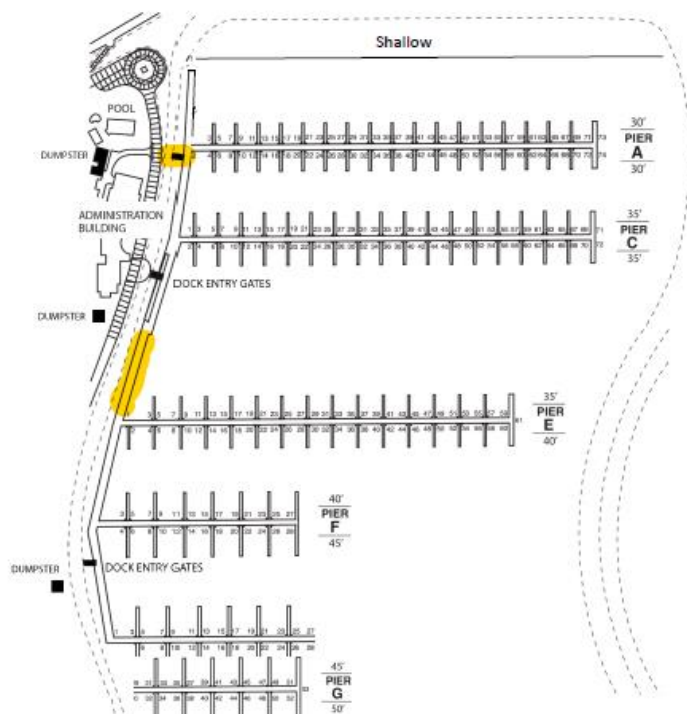



MARINA

821 Broughton Drive Sheboygan, WI 53081

MPF COMMITTEE REPORT

Tuesday May 3rd 2022

Bar 43

Bar hours are now Wednesday-Thursday 4pm-9pm, Friday and Saturday 1pm-11pm, and Sundays 11am-6pm. We have happy hour on Thursdays and Fridays and a Bloody Mary bar on Sundays. Bar 43 hosted its first wedding reception which put the bar sales slightly ahead of budget for the week. The bar has secured 12 rentals so far for the season with inquiries coming almost daily. Most of these events being wedding receptions. All bar events have been set for the year, many include collaborations with Three Sheeps.



Recent Customer Feedback and Review

Facebook

Teresa Paul  recommends Harbor Centre Marina.April 15 at 5:20 PM · 

Great bar, great views of the marina and Lake Michigan!



Like



Comment



Share



Comment as Harbor Centre Marina



Marina, Parks, and Forestry Update
 May 2022
 Maywood: Samantha Lammers

Building/Property Maintenance

- Sheboygan County trees ordered for Earth Day
- 1/29/2022: Ecology Center landscape meeting
- 2/1/2022: Steam hood installed in Sugar Shack
- 2/1/2022: Marina, Parks and Forestry update
- 2/3/2022: Fan switch moved in Sugar Shack
- 2/3 & 2/4: Stantec woody clearing
- 2/6/2022: Jacob S: Eagle Scout project assembled
- Hired a new custodian: Donna Pantel
 - Additional daily cleaning duties added to Maywood staff responsibilities until 3/14/2022
- **Maple Sugaring Season:**
 - 3/30/2022 huge push of sap: 700 gallons collected in 7 days
 - Donations from John Nelson
 - Boiled on 4/1, 4/2, 4/4, 4/6
 - 4/6/2022: Fire at Sugar Shack house
- 3/26/2022: Ecology Center Landscape Final Meeting
 - \$600 donations from local nurseries
 - Initial planting on 3/23/2022
- 4/6/2022: Stantec started final phase of Arboretum work: Planted 107 Trees 5-6'. Will return in fall 2022 to plant 115 more.
- 4/10/2022: Took down Maple Forest sap production
- 4/11/2022: Started cleaning the evaporator (THANK YOU MIKE AND JIM!)
- Dealing with reoccurring electrical burning smell from furnace. City and heat are aware of the issue and are troubleshooting.

Programming

- Weekly OWLS programming
- Flapjack Day (modified) March 20, 2022
- 2/9/2022: Nature @ Noon: property stewardship update
- Assist w/ Warriner programming: Scat and Tracks
- Lifelong Learning Institute (UWGB) programming beginning in March
- 3/09/2022 Plymouth Rotary Maywood presentation
- 3/10/2022 Assist with Warriner High School programming: Scat and Tracks
- Lifelong Learning Institute (UWGB) programming beginning 4/4/2022
- Summer program planning
- 3/22/2022 decontaminate, clean, and reset Honeybee Observation Hive
- 4/4/2022: Lifelong Learning Institute started monthly programming
- 4/7/2022: Pizza with a Purpose at Nourish Farms: Earth Day Every Day presentation

- 4/11/2022: Cub Scout group #3831 Habitat Hike
- 4/20/2022: Black River Advancement Association Presentation: Invasive Species
- 4/22/2022 & 4/23/2022: EARTH DAY activities
- 4/29/2022 & 4/30/2022: ARBOR DAY activities

Additional Park Activities

- Haley Stuckmann Internship Spring 2022
- Innovator Fellowship (Emily Fisher): Storybook Trail creation
- 1/28/2022: Trail Restoration Plan (TAP Grant): DOT /City applied (\$60,000)
- Custodian Resignation
- Coming up: 2/258/2022 NEWNA meeting (Virtual)
- 2/18/2022: 2021 Syrup filtering complete
- 2/28/2022: Bird and Bat Observatory grant completed with Jennifer Phillips-Vanderberg
jpv@wglbbo.org
- **3/20/2022 FLAPJACK DAY!**
- Week of 4/17/2022: 3 Eagle Scout projects initiated

Parks & Forestry Report

May 3, 2022

Parks

It's that time of year again. Tennis/pickleball court nets are up, fish cleaning stations are open, docks are in, Evergreen Park is open, beaches and parks are clean and park restrooms are set to be open May 16.

- Evergreen Park gates open May 2.
- Park staff have done a great job picking up garbage and tree branches in the parks and getting beaches all cleaned up for the summer season.





The Uptown Parklet provided by the City of Sheboygan Department of Public Works and Planning & Development departments will be open by May 13th for its second year. The parklet is located on a portion of St. Clair Avenue between 8th and 9th Streets. The parklet was well used last year and there are already planned events for the summer.



Comprehensive Outdoor Recreation Plan (CORP):

On January 26, 2022, the CORP Community Survey was launched. The survey was available until March 1. There were 1445 visits to the survey, 560 survey responses and 87 comments on the Interactive map. The next step will be the scheduling of three community engagement sessions throughout the summer.

The City's CORP is updated every 5 years and is used for budgeting, maintenance and planning annual projects in the City's parks. The city is also eligible for county, state and federal grants with a current approved plan.



photo by Visit Sheboygan

City of Sheboygan Comprehensive Outdoor Recreation Plan Update

Vandalism in the parks have been a problem. Earlier this year Roosevelt Park Pavilion was broken into and two doors were broken beyond repair and spray paint was used extensively on the walls inside. New doors have been installed and DPW Buildings and Grounds will be painting the inside before we open for rentals this summer. DPW reported the vandalism on Nextdoor in hopes that the neighbors will call the police if they see any inappropriate activity.

Last fall an individual using an electric scooter did extensive damage to the Deland Park tennis courts. Many of the marks that you see below are burned into the court by the person holding the accelerator and burning the tire into the court. Warmer weather will be needed to paint over these marks.



The Friends of the Sheboygan Peace Park are hard at work again. They are applying for a County Stewardship Grant and are hoping to complete phase two of the project. I can personally not say enough good things about this group. There is rarely a time that you can drive by the park and not see someone painting the tables, working in the gardens or just enjoying the park. They also continue to hold several gatherings.

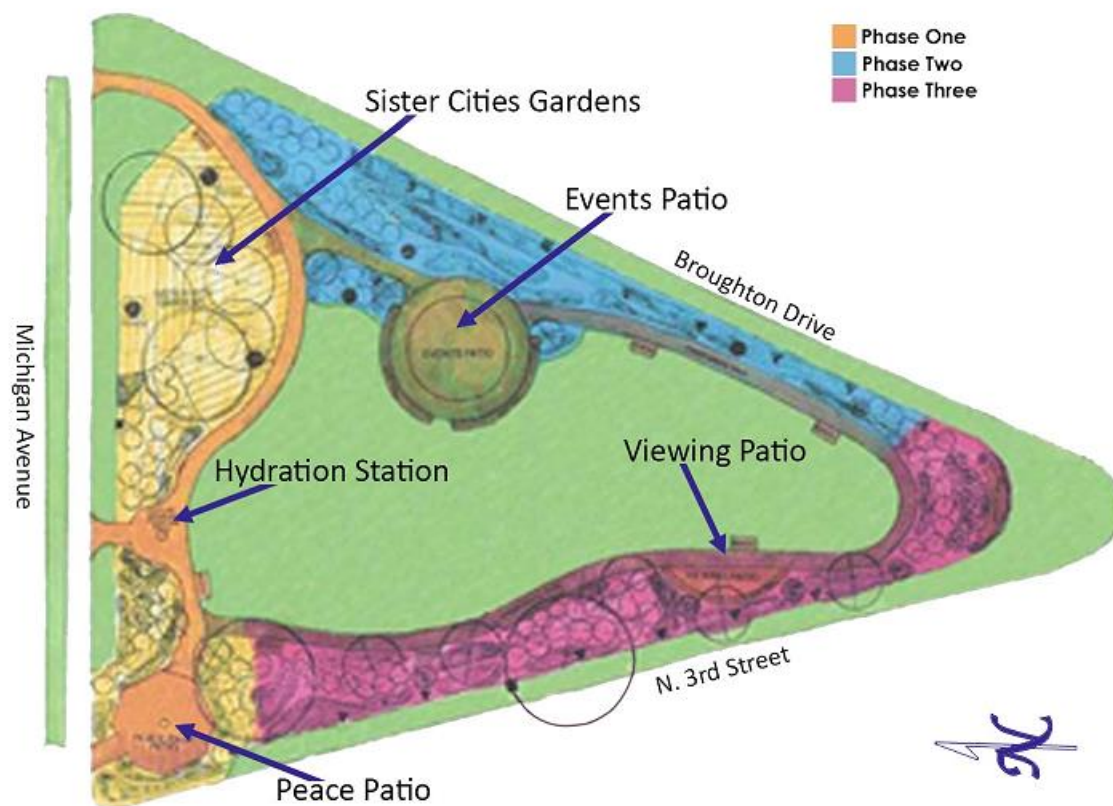

Parks & Forestry Report May 3, 2022 Report

We have had a productive start to the year so far in 2022.

Here's a look at what has been done:

Forestry

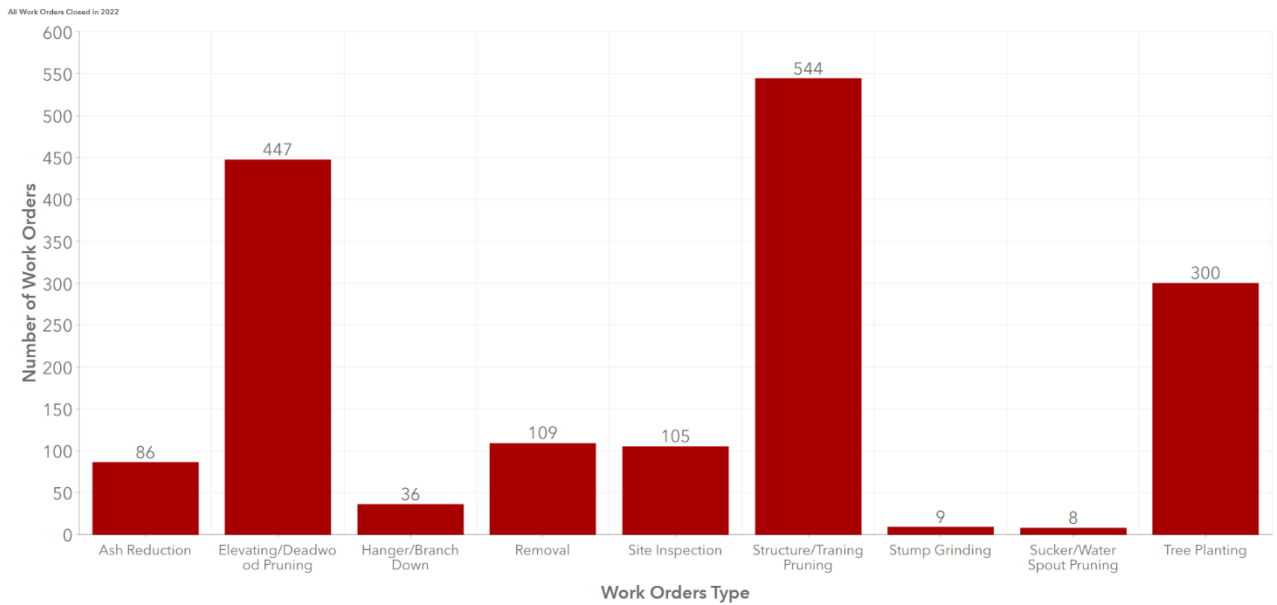

Completed Projects:

300 Spring Trees Planted

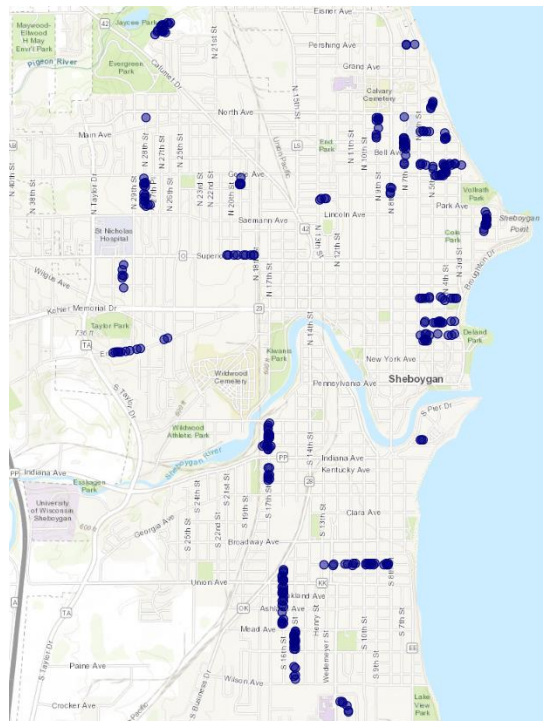

Training Pruning (about 550 trees)



What's Next:

350 stumps to grind in May

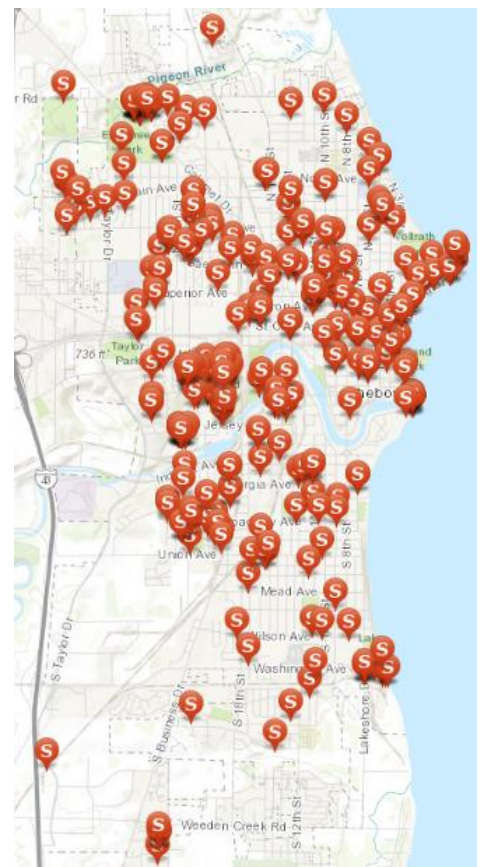

800 Ash trees to retreat



At least 1000 additional trees to prune



350 trees to plant this Fall

