



CITY OF NORMAN, OK CITY COUNCIL BUSINESS & COMMUNITY AFFAIRS COMMITTEE MEETING

Municipal Building, Executive Conference Room, 201 West Gray, Norman,
OK 73069

Thursday, March 02, 2023 at 4:00 PM

AGENDA

It is the policy of the City of Norman that no person or groups of persons shall on the grounds of race, color, religion, ancestry, national origin, age, place of birth, sex, sexual orientation, gender identity or expression, familial status, marital status, including marriage to a person of the same sex, disability, retaliation, or genetic information, be excluded from participation in, be denied the benefits of, or otherwise subjected to discrimination in employment activities or in all programs, services, or activities administered by the City, its recipients, sub-recipients, and contractors. In the event of any comments, complaints, modifications, accommodations, alternative formats, and auxiliary aids and services regarding accessibility or inclusion, please contact the ADA Technician at 405-366-5424, Relay Service: 711. To better serve you, five (5) business days' advance notice is preferred.

CALL TO ORDER

AGENDA ITEMS

1. PRESENTATION FROM ENGAGE LEARNING.

DISCUSSION ITEMS

2. DISCUSSION REGARDING REMOVABLE BOLLARDS IN LIEU OF BARRICADES FOR STREET CLOSURES.

ADJOURNMENT

Encore Commercial Products, Inc.
37525 Interchange Dr., Farmington Hills, MI 48335
Toll Free 1- 866 -737- 8900 Fax 248-354-4095
www.postguard.com

POST GUARD

Title: 6" Removable

Recommended Use:

Core Drilled Base

Specifications:

6"x36" Powder Coated Yellow Bollard

Drawing Number: 1

Date: 3-7-17

Style: Removable

Page: 1 of 1

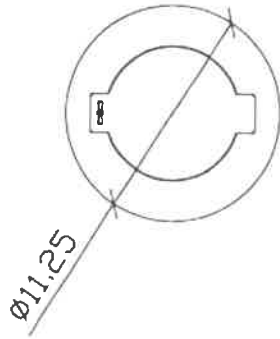
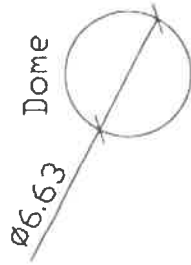

Plan View of
Closed Lid

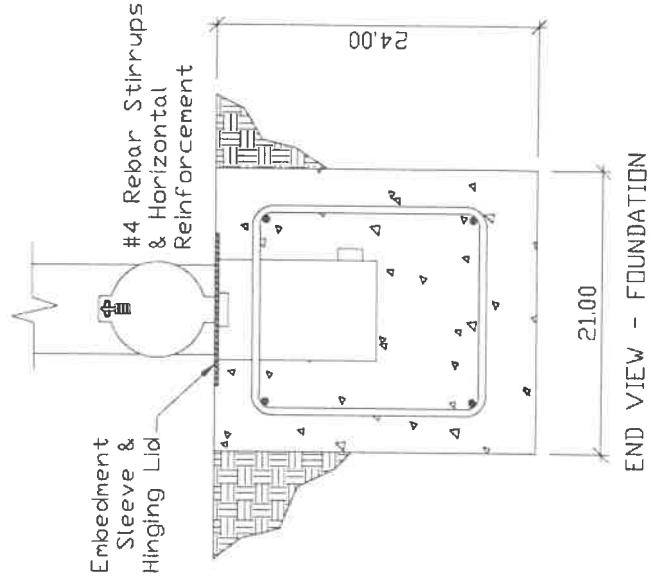
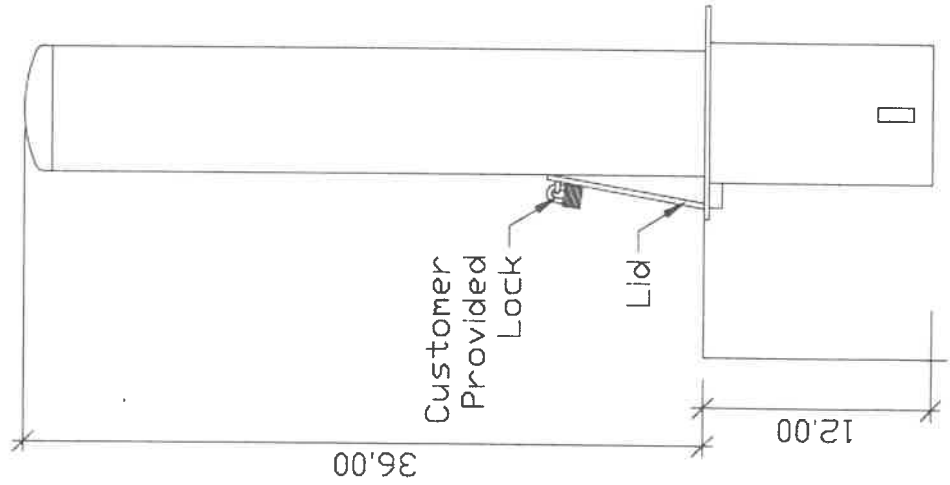

Item 2.

Manual Lift Retractable Bollard w/ Integrated Lifting Handle

CARBON STEEL

Material: Carbon Steel
Color: Black or Yellow
Available with Reflective Tape
Security Level: Low
Diameter: 4 in
Wall Thickness: .157"
Weight: 44 lbs

STAINLESS STEEL

Material: Stainless Steel
Type: 304 or 316
Finish: #4 Polished
Available with Reflective Tape
Security Level: Low
Diameter: 4 in
Wall Thickness: .118"
Weight: 44 lbs

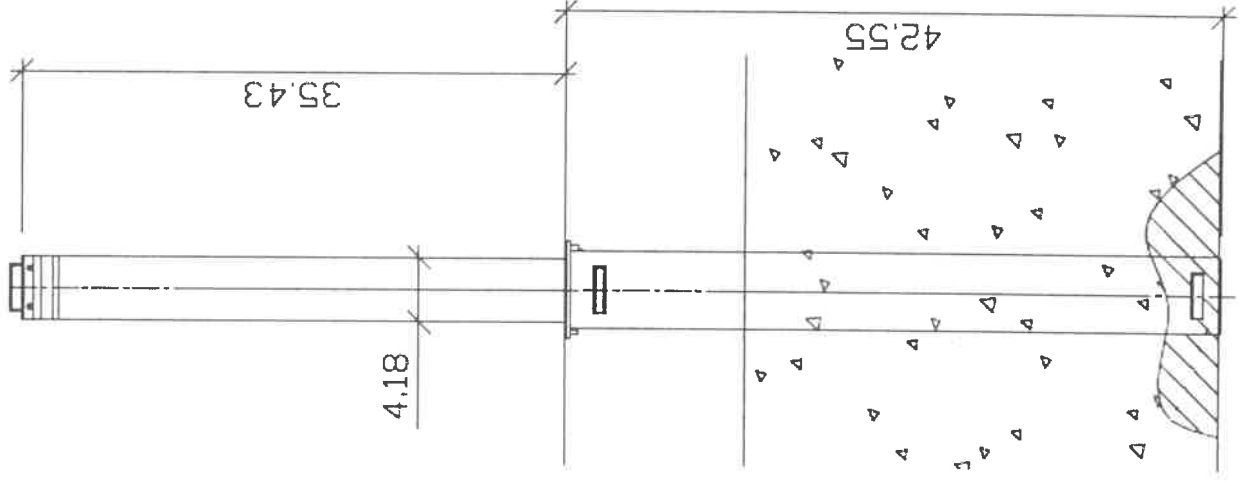



office memorandum

DATE: May 10, 2022

TO: Barbara Andros, Revenue

FROM: Dennis W. Davis, Traffic Control Supervisor *D.W.D.*

SUBJECT: Invoice for Traffic Control – Norman Music Festival

Please send an invoice in the amount of **\$1,265.67** to Norman Music Alliance, Shari Jackson, shari@normanmusicfestival.com, for the use of Traffic Control personnel in support of the Norman Music Festival event April 28 – 30, 2022.

Labor Cost Breakdown

Troy Adams	4.50 hr/s Reg.	@	\$29.77	\$133.97
Mark Agee	4.00 hr/s Reg.	@	\$26.08	\$104.32
Mark Agee	3.00 hr/s OT	@	\$39.12	\$117.36
Clayton Tooley	4.00 hr/s Reg.	@	\$26.08	\$104.32
Clayton Tooley	3.00 hr/s OT	@	\$39.12	\$117.36
Zach Vice	4.50 hr/s Reg.	@	\$19.29	\$86.81
Zach Vice	3.00 hr/s OT	@	\$28.94	\$86.82
CJ Whitaker	5.50 hr/s Reg.	@	\$33.47	\$184.09
CJ Whitaker	3.00 hr/s OT	@	\$50.21	\$150.62

Vehicle Cost Breakdown

Unit # 633	6.00 hr/s	@	\$20.00	\$120.00
Unit # 644	4.00 hr/s	@	\$15.00	\$ 60.00

If reimbursement funds are received, please have them deposited into Acct. No: 010-5023-429.21-12. Should additional information be desired, please advise.

DWD/kc

cc: Jami Short, Traffic Engineer

Detour Plan

Item 2.

Due to T.C. / Zone Type	Road Closure	Due to Project #
Location: Main St. @ Santa Fe Ave.		

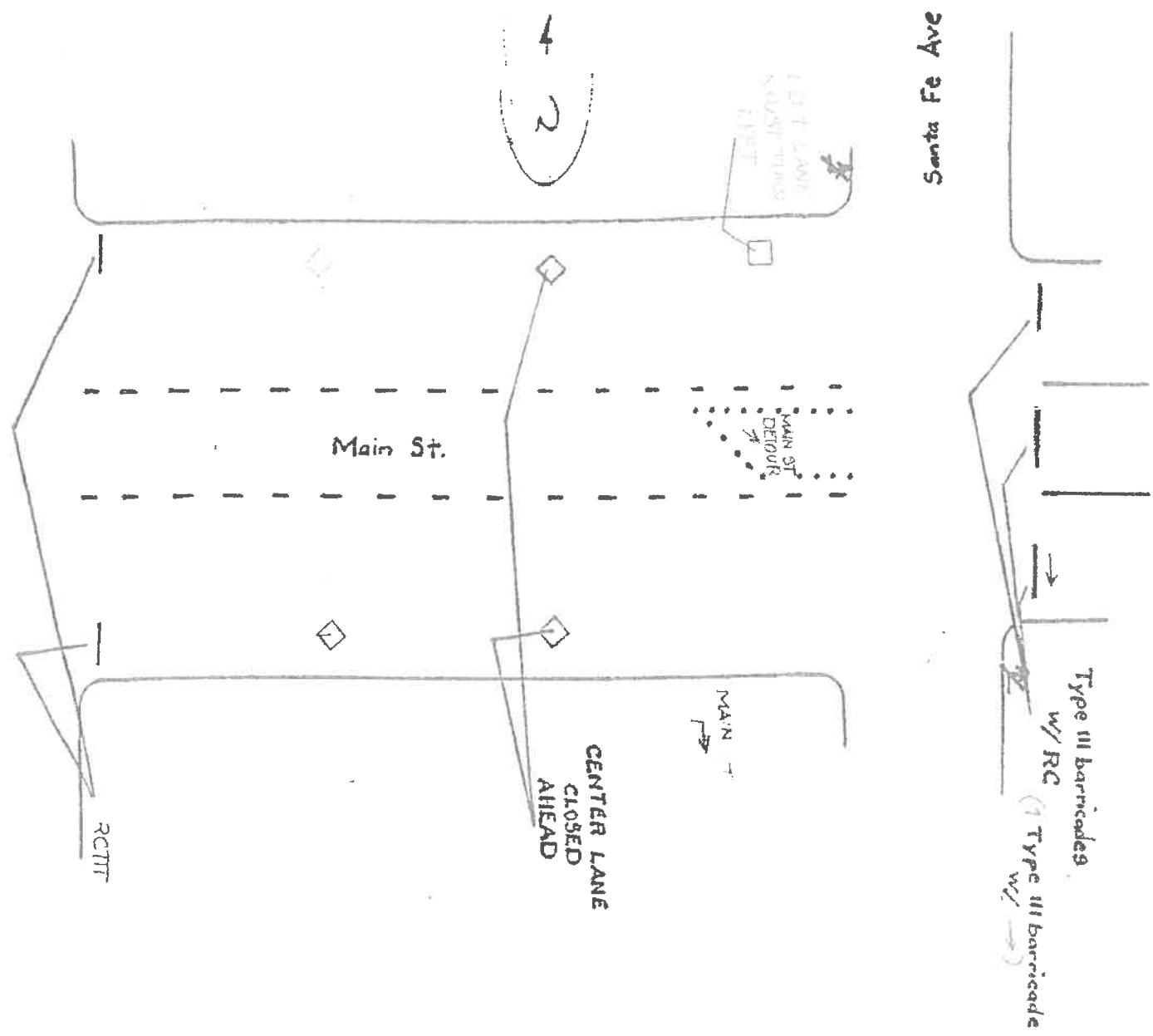

Prepared by: J. J. J. Date: _____

Date Deployed: _____ Time: _____
 Deployed by: _____

+ 2

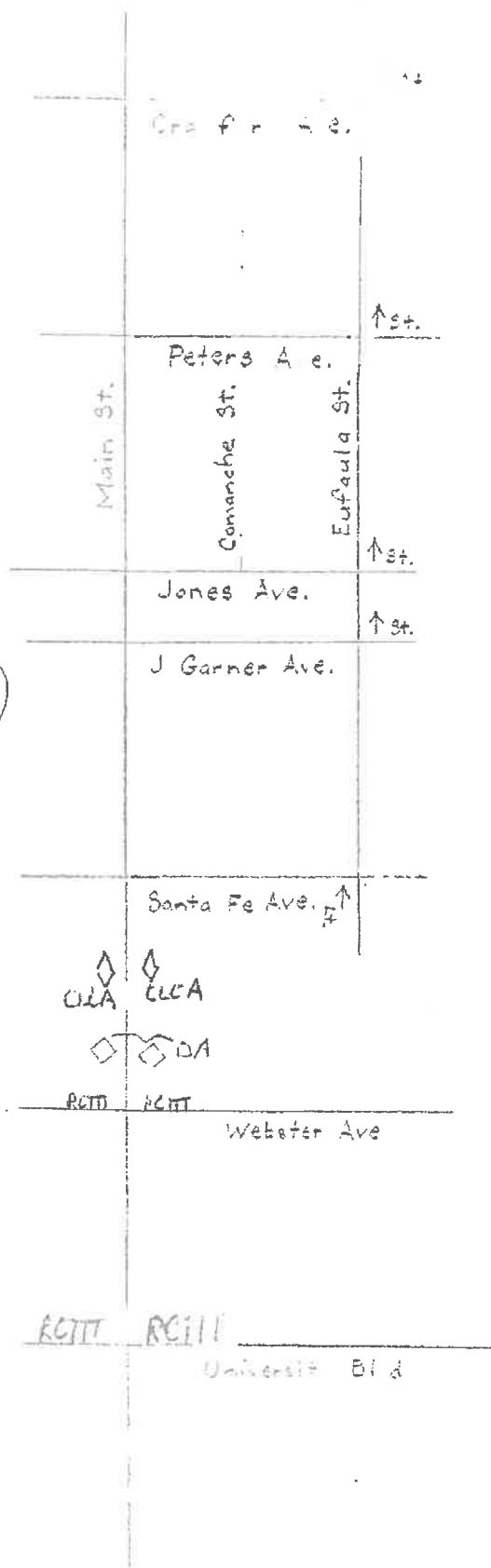

NMF Official Locations

- A Main Stage
 B Patron Finers - NMF Headquarters, J Jack Daniels Stage
 C Artist Hospitality & Press Check-in K Santa Fe Depot - Artist Hospitality
 D Backhouse - NMF Venue
 E Classical Stage - NMF Venue
 F Volunteer Check-in
 G Blackhawk Stage - NMF Venue
 H Dreamer Concepts - NMF Venue
 I Benvenuti's - NMF Venue
 J Wild Prairie Family Stage
 K Gray Owl - NMF Venue
 L Border Music - NMF Venue
 M Opolla - NMF Venue
 N Opolla Outdoor Stage - NMF Venue
 O Bluebonnet - NMF Venue
 P VIP Hospitality Tent
 Q Santa Fe Depot - Artist Hospitality
 R Santa Fe Depot - Artist Hospitality
 S Santa Fe Depot - Artist Hospitality
 T Santa Fe Depot - Artist Hospitality
 U Santa Fe Depot - Artist Hospitality
 V Santa Fe Depot - Artist Hospitality
 W Santa Fe Depot - Artist Hospitality
 X Santa Fe Depot - Artist Hospitality
 Y Santa Fe Depot - Artist Hospitality
 Z Santa Fe Depot - Artist Hospitality

Suggested Parking Locations

- Any City of Norman Parking Lot
 The Wall Low Office, 216 E. Edoula
 William Woodson's Law Office, 307 E Bufaulo
 First American Abstract, 111 E Comanche
 The Cradle, 110 E Towhawa
 Redwine and Curbert, 400 S Crawford
 Courthouse Parking, South end East Lot
 Sankeys Foundation, 530 E Moho
 Able Community Parking, 300 N Crawford
 Pavin Plaza, 126 N Porter
 City Municipal Complex, 210 W Gray
 Longfellow Middle School, 215 N Ponca
 McFarlin Methodist Church, 419 S University
 Saint Joseph's Catholic Church, 421 E Acres

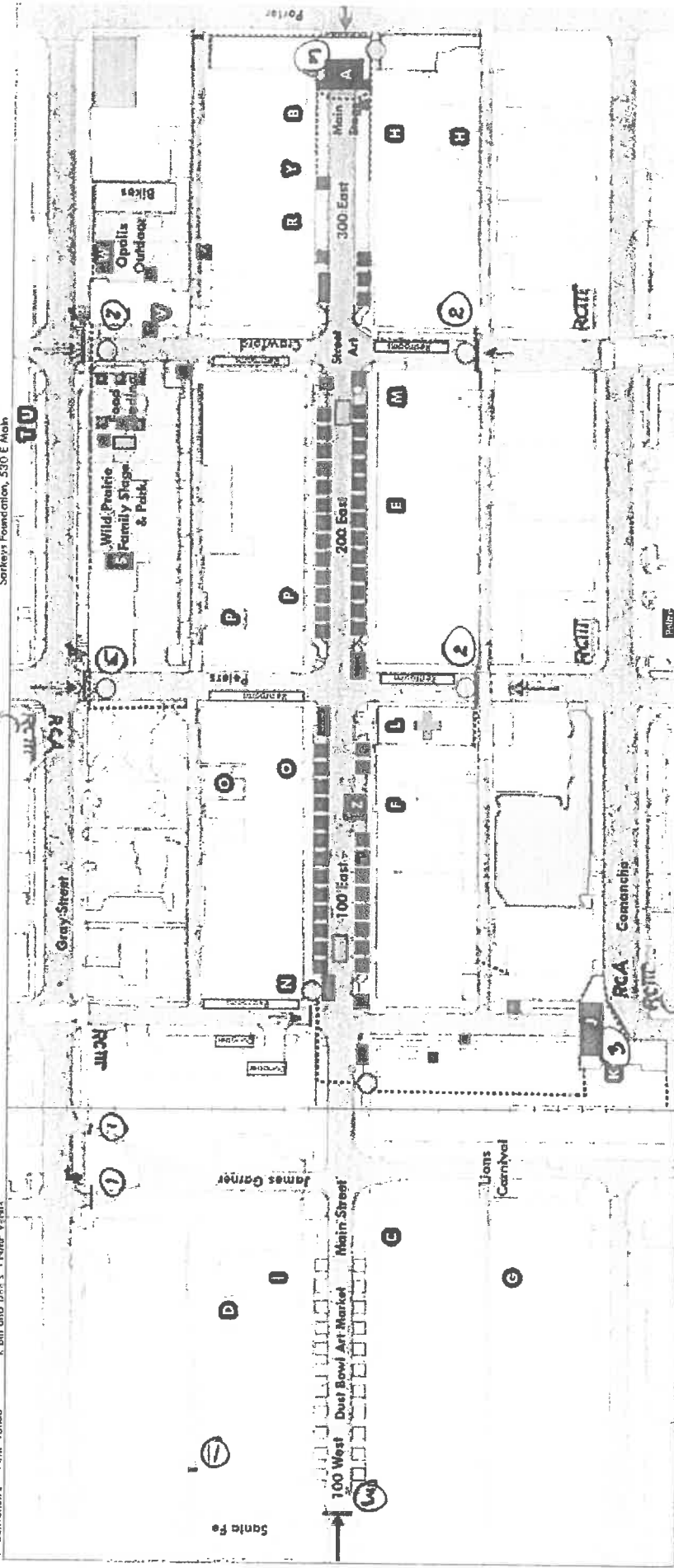

Updated March 16, 2012

0 50 100 200 Feet

☐ Stage
☐ Production
☐ First Aid
☐ Parking
☐ Bike Racks
☐ Restrooms
☐ Street Closure
☐ Fencing
☐ Emergency Entry
☐ Public Entry
☐ Information
☐ Official Merchandise
☐ Beverage Stand
☐ Merchandise Stand
☐ Art Market Booth
☐ Food Stand