



PARKS & RECREATION COMMISSION REGULAR VIDEO MEETING

Thursday, October 6, 2022 at 5:30 PM

COMMISSIONERS:

Chair Jodi McCarthy
Vice Chair Peter Struck
Commissioners: Don Cohen,
Paul Burstein, Sara Marxen,
Rory Westberg, Ashley Hay

LOCATION & CONTACT

Zoom Meeting
Phone: 206.275.7600 | www.mercerisland.gov

In compliance with the Americans with Disabilities Act, those requiring accommodation for meetings should notify the Staff Liaison at least 24 hours prior to the meeting at 206.275.7706.

The virtual meeting will be broadcast live on Zoom and recorded and saved on the City Council's [YouTube Channel](#)

Registering to Speak: Individuals wishing to speak live during Appearances will need to register their request with the staff liaison at **206.275.7600** or [email](#) and leave a message before 4 PM on the day of the Commission meeting. Please reference "Appearances" on your correspondence and state if you would like to speak either in person at Mercer Island Community & Event Center or remotely using Zoom. Each speaker will be allowed three (3) minutes to speak.

Join by Telephone at 5:30 PM: To listen to the meeting via telephone, please call **253.215.8782** and enter Webinar ID **825 9108 6996** and Password **896196** when prompted.

Join by Internet at 5:30 PM: To watch the meeting over the internet via your computer, follow these steps:

- 1) Click [this link](#)
- 2) If the Zoom app is not installed on your computer, you will be prompted to download it.
- 3) If prompted for Webinar ID, enter **825 9108 6996** and Password **896196**

Join in person at Mercer Island Community & Event Center at 5:30 PM: Mercer Island Community & Event Center
8236 SE 24th Street.

CALL TO ORDER & ROLL CALL - 5:30 PM

PUBLIC APPEARANCES

DEPARTMENT REPORT

1. Department Report

REGULAR BUSINESS [HYPERLINK "appIS80d34e03b253455db0ca10b38419e40a"](#)

2. [Approve the minutes of the September 1, 2022 Regular Meeting](#)
Recommended Action: [Approve minutes](#)
3. [Park Improvement, Gift Acceptance and Donor Recognition Policy \(Draft\)](#)
Recommended Action: [Provide input and consensus on policy elements.](#)
4. [Aubrey Davis Park Trail Safety Improvement Project 30% Design Recommendation](#)
Recommended Action: [Approve recommendation memo to City Council and authorize the Chair to transmit it to City Council](#)

OTHER BUSINESS

5. [PRC 2022 Planning Schedule Update](#)
6. [Commissioner Reports](#)

ADJOURN

Mercer Island Parks & Recreation Commission

Item 1.



Department Report
October 6, 2022

South Mercer Playfield Project

- The City and School District are working on joint project. With MISD as the project Manager.
- The project began in early July with completion scheduled for November.
- The project focuses on converting field #3 and field #4 to synthetic turf and installing lights, as well as replacing turf on fields #1 and #2.
- Light poles have been installed and the turf will arrive next week!
- Thank you to all of the user groups for their flexibility as we adjust schedules to meet needs.
- For more info visit:
<https://www.mercerlandschools.org/Page/17468>



Luther Burbank South Shoreline Project



- 2 year project which started in 2022, and will complete in 2023.
- The previous trail connecting the swim beach area and dock area was eroding.
- We had anticipated significant progress this summer, however key staff moved into new positions, leaving this project without field leadership.
- And then the rains came...or will come. During the rainy season we will postpone work until April 2023.
- Significant elements of this project include in-water work to enhance fish habitat, this work will need to take place in the summer during the “fish window”.
- This project is entirely funded by grants and the King County Parks Levy.
- The current trail is still open.

Bike Skills Area Update

- Chair McCarthy, Vice Chair Struck and Commissioner Burstein participated in RFQ interview with staff
- American Ramp Company (ARC) chosen as consultant, great depth of experience in designing bike parks
- ARC is partnering with Board & Vellum, who will lead landscape architecture and public outreach components
- Staff held kickoff meeting with consultant team this week to begin work on project parameters for design and public engagement strategy
- Surveyor has completed topographic and tree survey of Deane's Children's Park; will deliver to City 10/7/22
- **White dots DO NOT indicate a planned removal!** The white dots identify which trees have been surveyed.
- Staff will perform tree inspections once tree survey has been received, to assess health and identify trees that require pruning or removal to mitigate risk.



Volunteer Coordinator- Jordan Fischer

Seasonal position focused on volunteer management in our natural areas (ends this winter).

From June- Sept 2022 hosted **23 events** with **223 volunteers** for a total of **586 hours**.

Has led **2 Forest Steward Orientation** and established **10 new Forest Stewards** at 4 new locations.

Started a **Volunteer Photography** position with **5 active photographers**.

Established Partnerships with over **10 local clubs and organizations** including the Aljoia, Scouts of America, Girl Scouts, Mercer Island Rotary Club, French American School of Puget Sounds, and Seattle University Environmental Studies Department.





Upcoming Restoration Events

- Saturday, October 8, 10am - 1pm
| Mental Health Awareness Week
Planting in Clarke Beach Park
- Wednesday, October 12, 4-6pm | Pioneer Park Planting Party
- Saturday, October 22 | More details to come!
- Thursday, October 27, 3-5pm | Homestead Park Planting and Mulching
- Saturday, November 5, 10am-1pm
| Clarke Beach Park Planting Party
- Saturday, November 12 | More details to come!

Details and info at:
<https://www.mercerisland.gov/parksrec/page/restoration-event>

MICEC Fitness Room Getting a Fresh Look

- Condensation from the A/C unit above the room flooded into the fitness room, significantly damaging the drywall and flooring.
- The damaged drywall has been removed and replaced.
- The flooring removal and re-installation is scheduled for October 24-28, with reinstallation of the fitness equipment scheduled on October 31.
- **Several equipment upgrades are coming!** This includes a new set of dumbbells, a set of barbells, a new chin-up assist machine, a cable crossover strength machine, and many new smaller fitness pieces.
- The anticipated date for re-opening of the Fitness Room is November 1.



MICEC Operating Hours

- In conjunction with the reopening of the Fitness Room, MICEC will expand operating hours at the beginning of November.
- Opening at 9:00am daily (currently 10:00am daily).
- New MICEC Operating hours:
 - Monday thru Thursday - 9:00am-7:00pm
 - Friday/Saturday - 9:00am-5:00pm
 - Sunday closed



Celebrating Art this October

- October is National Arts & Humanities Month!
- We're celebrating Mercer Island's art, culture, heritage, and more all month.
- Follow us on Instagram for a new post every week, and share your own MI art/culture experiences with us!
- To get started, visit <http://instagram.com/cityofmercerisland>



Homecoming Parade

- The Mercer Island High School Homecoming Parade will take place on **Friday, October 7**. The route will start at Northwood Elementary and end at the High School.
- City staff have worked with the High School planning group on permitting, road closures, and police presence.
- Spectators can view the parade on both sides of the sidewalks along the route.
- Viewer parking is available at the Lower Northwood Lot or at Mercer Island High School.



Celebrate Arbor Day

- We're celebrating our 6th year as a Tree City with our annual Arbor Day planting event!
- Join us **Saturday, October 15 from 10am-1pm** and plant trees and shrubs in **Mercerdale Park** to enhance the forest buffer and start the next generation of trees.
- Get your hands in the dirt, work alongside neighbors and friends, and celebrate trees!
- No experience necessary. Gloves and tools provided.
- Visit www.mercerisland.gov/arborday for details and to register.



Rocktober Event for MI Seniors

- The Recreation team is hosting Rocktober, a free event for seniors at MICEC on October 21, from 11:30am – 2pm.
- Rocktober will be an afternoon of learning the Roots of Rock ‘n Roll, boxed lunch, root beer garden, a live band... and Elvis!
- Registration is required. Visit www.mercerisland.gov/calendar for event details.
- Our sincere thanks to Aljoya for sponsoring this event!



ROCKTOBER!

A FREE EVENT FOR OUR SENIOR COMMUNITY!

Presented by The City of Mercer Island & Aljoya

ALJOYA
Where senior living is full of JOY.

Questions?
Contact Larry Almo at 206.230.0150 (Aljoya)
Contact Katie Herzog 206.795.8518 (City of MI)

OCTOBER 21 | 11:30AM - 2PM
MERCER ISLAND COMMUNITY & EVENT CENTER

SPECIAL GUEST SPEAKERS:

JESSI BON
WELCOME FROM THE CITY MANAGER

JOHN JENSEN 12 PM
THE ROOTS OF ROCK 'N ROLL

LARRY ALMO
THE ALJOYA COMMUNITY

SOUL SEARCHING BAND 1 PM
WITH SPECIAL GUESTS!

LIVE MUSIC, BOXED LUNCH*, ROOT BEER GARDEN, ELVIS AND MORE!

*Registration is required! Must be 3 days in advance for lunch

206-275-7609 | COURSE #16566



Hallo-Weekend Events

- **Town Center Trick or Treating**, in partnership with the Chamber of Commerce, will be on Friday, October 28 from 4 – 6pm.
- The **Pumpkin Walk** is on Sunday, October 30 at Mercedale Park from 5 – 8pm.
 - **We need carved pumpkins for the event!**
 - Carved pumpkins can be dropped off from 12-4pm on the day of the event at Mercedale Park.
 - Fun additions this year including food trucks, a professional pumpkin carver, 88.9 The Bridge on-site for tunes, and more!
 - **Special thanks to our sponsors: MI Martial Arts, John L. Scott & Greg Rosenwald Real Estate.**
- Visit www.mercerisland.gov/mihalloweekend for all the details!



Thank You!





PARKS & RECREATION COMMISSION REGULAR MEETING MINUTES September 1, 2022

CALL TO ORDER

Chair McCarthy called the meeting to order at 5:30 pm via Zoom Online meeting.

ROLL CALL

Chair Jodi McCarthy, Vice Chair Peter Struck, and Commissioners Don Cohen, Rory Westberg, Paul Burstein, Sara Marxen, and Ashley Hay were present for the Parks & Recreation Commission.

Councilmember Craig Reynolds was present.

Staff present were Jason Kintner, Alaine Sommargren, Ryan Daly, Paul West, Patrick Yamashita, Clint Morris, Sam Harb, and Raven Gillis.

APPEARANCES

No public appearances.

DEPARTMENT REPORT

Division Manager Ryan Daly reported on the following items:

- Summer Celebration! – Recap
- Boiler Building Stabilization
- Lincoln Landing
- Mercerdale Playground
- South Mercer Playfield Project
- A GREAT Summer!
- How are we combating drought conditions?

REGULAR BUSINESS

1. Approval of Minutes

Minutes from the July 7, 2022 Regular Meeting were presented.

It was moved by Burstein; seconded by Westberg to:

Approve the minutes from the July 7, 2022 meeting

Passed: 7 – 0

2. Public Art Donation Concept – “The Gathering Stacks”

Ryan Daly introduced a potential donation to the City, and Berger Partnership Consultants presented the concept on behalf of the potential donor. Commission asked questions and provided input.

Commissioner Marxen left the meeting at 6:31pm, and had notified the Chair, Vice Chair and staff ahead of the meeting regarding a scheduling conflict.

3. Aubrey Davis Park Trail Safety Improvement Project 30% Design Revisions

Paul West presented. The Commission engaged in discussion and gave consensus to review the draft handoff memo along with revisions and corrections to the 30% Design at the October Regular Meeting.

It was moved by Struck; seconded by Westberg to:

Create a subcommittee consisting of Chair McCarthy, and Commissioners Cohen and Hay to work on the draft handoff memo to go to the City Council for the 30% Design of the Aubrey Davis Trail Safety Improvement Project.

Passed: 6 – 0

4. Bike Skills Area Update

Jason Kintner, Chief of Operations, and Alaine Sommargren, Deputy Public Works Director, provided an update.

OTHER BUSINESS

5. Planning & Meeting Schedule Update

Ryan Daly provided an update.

6. Commissioner Reports / Work Plan Update

Struck reported that it appears that the usage of the MI Library has increased over the summer.

Burstein recognized the Summer Celebration! Fireworks was a tremendous event, and noticed the next day Sam Harb, Parks Operations Manager, and his crew doing a fabulous job cleaning up after the event. Commissioner Burstein also noticed the Shakespeare in the Park events were well attended, coupled with great performances by Wooden O. And all the Mostly Music in the Park events were crowded, and the bands were well received by the audience. Burstein recognized Katie Herzog's efforts to book these bands and noted it was a great summer!

Hay agreed with Burstein in recognizing the Summer Celebration Fireworks show. Hay also shared that MIPA in partnership with the City of MI is hosting another blood drive at the MICEC on Thursday 10/6. Hay appreciated the staff's contributions towards the last successful blood drive and invited everyone to attend.

Chair McCarthy also agreed that Summer Celebration! was great and especially seeing people of all ages lined up for the Touch a Truck / Firetruck hose game. McCarthy also noted she appreciates driving by the Mercedale Train Park and seeing how much usage it is getting after being closed for so long for upgrades.

ADJOURNMENT at 8:10 PM



PARKS & RECREATION COMMISSION STAFF REPORT

Item 3
October 6, 2022
Regular Business

AGENDA ITEM INFORMATION

TITLE: RECOMMENDED ACTION:	Park Improvement, Gift Acceptance and Donor Recognition Policy (Draft)	<input checked="" type="checkbox"/> Discussion Only <input type="checkbox"/> Action Needed: <input type="checkbox"/> Motion <input type="checkbox"/> Ordinance <input type="checkbox"/> Resolution
	Provide input and consensus on policy elements.	

STAFF:	Eleanor Knight- Recreation Coordinator
COUNCIL LIAISON:	Craig Reynolds
EXHIBITS:	<ol style="list-style-type: none"> (Current) Park Improvement, Gift Acceptance and Donor Recognition Policy (Draft) Park Improvement, Gift Acceptance and Donor Recognition Policy

SUMMARY

The City’s *Strategy for the Mercer Island Community and Event Center and Recreation Programs and Services* (also known as the Reset Strategy) calls for updating existing or developing new policies to ensure that Parks and Recreation Department actions are consistent with the Reset Strategy.

The purpose of this staff report is to introduce the current *Park Improvement, Gift Acceptance and Donor Recognition Policy* (Exhibit 1) and a revised version (Exhibit 2), which builds on the foundation of the current policy by clarifying language and purpose, while removing procedural elements. A revised *Park Improvement, Gift Acceptance and Donor Recognition Policy* will provide guidance, criteria, and clarity for the solicitation and acceptance of donations, recognitions, and memorials in Mercer Island parks and facilities. Tonight, staff will seek consensus from the Parks and Recreation Commission on elements for a revised policy.

Background

The City of Mercer Island Parks and Recreation Department has traditionally welcomed and encouraged support from private individuals and entities to support the programs and services the Department provides to the public. Examples of recent and significant contributions from the community have included park item donations (such as benches and works of art), batting cages at South Mercer Playfields and Island Crest Park, synthetic turf projects at Island Crest Park, the original and newly opened Mercerdale Playground and Luther Burbank Playground, as well as countless donations to various programs and special events including Summer Celebration and Illuminate MI.

Currently the Department has a *Park Improvement, Gift Acceptance and Donor Recognition Policy*, however the current version is out of date, includes intermixed and dated procedures, and has been inconsistently implemented with the boards, community, and staff.

During the establishment of the Reset Strategy, the revision of a number of policies was identified as a priority. A revision to the *Park Improvement, Gift Acceptance and Donor Recognition Policy* is a priority for the

Department, as the recent year has seen numerous requests to donate park assets and projects for community and individual benefit. A revision to this policy will establish criteria and guidelines for receiving proposals, gifts, donor recognition projects and other items that modify park property and appearances. This criterion will assist donors and staff alike in the review of proposals and requests.

Discussion

Tonight, staff requests input on policy elements from the Parks and Recreation Commission as staff seeks to update the policy. The draft and current policies have been provided for comparison. Some key suggested elements contained within the draft revised policy include:

1. The City encourages gifts and donations which enhance our park spaces.
2. Prohibits memorial donations in the parks and clarifies how and where donors may be recognized.
3. Informs that no contingencies may be required by a donor other than for a specific activity or programing area.
4. To limit improvements to items that complement the designated location.
5. To limit donor recognitions or improvements which alter the character of a space or detract from the characteristics of our parks.
6. Removal of procedural elements from the policy.
7. Updating language to meet the standards of the Department and to be inclusive of Staff and Commission roles.

To assist in discussion, please consider the following questions:

1. Should the Department accept donations- including monetary, project based, artistic, and/or equipment?
2. Are there donations, gifts, or projects that should be more strongly clarified for rejection within the policy?
3. Do you agree that memorials should be prohibited in parks?
4. Do you agree that corporate donors who have a corporate sponsorship requirement should fall under a separate policy?
5. Does the Commission agree with the policy elements?

Next Steps

1. Staff will consider Commission input tonight and refine an updated draft policy.
2. Staff will present a revised policy at the November 3 meeting for Commission review and endorsement.
3. Once endorsed, Staff will begin development on procedures to accompany the policy.
4. Staff will implement the policy and communicate opportunities for donations and gifts.
5. Staff anticipates developing (in collaboration with the Commission) additional supporting policies such as:
 - a. Facility Dedications and Naming Rights
 - b. Corporate Sponsorships and Recognition

RECOMMENDATION

Provide input and consensus on policy elements.

Mercer Island Policy and Procedure
**PARK IMPROVEMENT, GIFT ACCEPTANCE AND DONOR
RECOGNITION**



Effective Date: 2023	Last Updated: N/A	Approved By:
Code and Statutory Authority: 2.50.020 4.44.010 3.53.020	Related Polices: Strategy for MICEC and Recreation Programs and Services	

Purpose

The City of Mercer Island Parks and Recreation Department welcomes and encourages support from private individuals and entities that support the programs and services the Department and its assigned advisory boards, commissions, councils, and groups provide to the public.

The purpose of this policy is to establish criteria and guidelines for receiving and considering proposals to initiate funded, partially funded, or unfunded capital projects, including gift and donor recognition projects, park asset donations, or to undertake changes to a park property that will in the judgment of the director, modify the property’s use, appearance, or overall aesthetics.

Definitions

- I. Parks and Recreation Department consists of the Park Maintenance Division and Recreation Division within the Public Works Department under the direction of the Chief of Operations (director).
- II. Assigned advisory boards, commissions, councils, or groups are any working or advisory board or committee created by City Council action or initiated by the Mayor or City Manager’s Office and assigned to or administratively supported by the Parks and Recreation Department.
- III. Gifts are all gifts, bequests, or donations to include but not be limited to endowments, real property, structures, or portions of structures; money or negotiable securities; materials; equipment, flora, or fauna; improvements to facilities or land; statues, monuments, sculptures, murals, and other works of art; plaques, graphics and/or signs; or recreation and cultural arts program instruction, equipment, and supplies.
- IV. Donor Recognition Object is a physical object placed in a park to acknowledge a donor.
- V. Donor is a private individual, for-profit company, non-profit organization, or public agency wishing to donate funds or objects to the Department.
- VI. Donor Recognition Project is a proposal and plan for placing a donor recognition object at a park or park facility.
- VII. Gift Needs Inventory is a list of identified Department operational and capital needs which would make appropriate gifts.

- VIII. Memorial Art is any statue, monument, sculpture, mural, memorial, or other structure or landscape feature designed to perpetuate in a permanent manner the memory of a person, group, event, or other significant element of history.
- IX. Park Improvement Proposal may include a funded, partially funded, or unfunded capital project(s) request consisting of real property, structures, or portions of structures; materials; equipment; flora or fauna; improvements to facilities or land and other non-art items.
- X. Park Improvement Proposer is a private individual, for-profit company, non-profit organization, or public agency wishing to initiate a funded, partially, funded, or unfunded capital project(s) consisting of real property, structures, or portions of structures; materials; equipment; flora or fauna; improvements to facilities or land and other non-art items.

Policy

It is the policy of the City of Mercer Island:

- 1.1 To facilitate and solicit publicly and privately funded park improvement proposals and encourage public and private gifts, bequests, and such contributions that enhance, beautify, improve, supplement, support, or otherwise benefit the park and recreation system and community of Mercer Island.
- 1.2 To accept only those gifts, memorial art, park improvements and donor recognition objects that are consistent with the mission, policies, park property restrictions, park master plans and most current Parks, Recreation, and Open Space Plan and associated trails and arts plans of the Mercer Island Parks and Recreation Department and the mission and policies of its assigned advisory boards, commissions, councils, or groups.
- 1.3 To accept only those gifts, memorial art, park improvements and donor recognition objects given with the full understanding that they become the property of the City and are subject to the laws, policies and procedures that govern the Parks and Recreation Department and its assigned advisory boards, commissions, councils, or groups.
- 1.4 To accept gifts of land, from private individuals, for-profit corporations, not-for-profit organizations and public entities when City ownership will further the objectives of the City as identified in the Parks, Recreation, and Open Space Plan and associated trails and arts plans.
- 1.5 To accept gift, memorial art, and park improvement proposals, other than land, from private individuals, for-profit corporations, not-for-profit organizations, and public entities which:
- 1.5.1 Are given with no contingencies other than that they be used for a specific program, activity, or area of programming. (Gifts from corporate donors who have a corporate sponsorship requirement fall under a yet to be developed Corporate Sponsorship Policy);
- 1.5.2 The City is not obligated to replace if the gift or park improvement is stolen, vandalized, worn out, irreparably damaged, or destroyed.

- 1.6 To reject gift, memorial art, and park improvement proposals that, in the judgment of the director, are incompatible with the park or facility location, other facility uses or users.
- 1.7 To prohibit gift, park improvement proposals, and donor recognition object proposals that are memorial in nature (excluding memorial art).
- 1.7.1 The City may elect to recognize a community member, individual, family, group, or organization in the naming of a facility. In these limited and unique scenarios, the donor recognition object may provide memorial recognition as deemed appropriate by the director. Naming rights to facilities will be included in a to be developed policy.
- 1.8 To protect designated open space and green space areas as fundamental aspects of the quality of life on Mercer Island, and to limit gifts and park improvements to those which maintain or enhance the character of the space and/or meet identified objectives within the Parks, Recreation, and Open Space Plan and associated trails and arts plans.
- 1.9 To prohibit donor recognition objects on gifts in designated open space areas.
- 1.10 To limit, as much as possible, plaques and visible recognition objects to areas of a park recognized as “built” environments, i.e., benches, picnic tables, water fountains, buildings, play areas, ballfields, tennis courts, etc.
- 1.11 To limit, as much as possible, all gifts and park improvements to items that complement the proposed location, e.g., murals for buildings; turf/fall surfacing/sand/benches/tables/play equipment for play areas; turf/backstops/bleachers/scoreboards/fences for ballfields; nets/posts for tennis courts; backboards/nets/scoreboards for basketball courts.
- 1.12 To limit, as much as possible, the number of donor recognition projects that involve decorative tiles, pavers, and artwork that require mounting on walls, concrete, or any other surface that detracts from the characteristics of our parks. Such projects may require a verifiable demonstration of community support.
- 1.13 To limit, as much as possible, the number of park improvements that involve installations which detract from characteristics of our parks. Such projects may require a verifiable demonstration of community support.
- 1.14 To maintain and update annually a Gift Needs Inventory document.
- 1.15 To ensure that all park improvement proposals, gifts, memorial art, and donor recognition objects are consistent with all applicable provisions of the City of Mercer Island City Code.

Procedure(s)

Additional procedures will be established and approved, administratively, by the department director and division manager, following approval of the policy.

DRAFT

DEPARTMENT POLICY

City of Mercer Island Parks and Recreation Department PARK IMPROVEMENT, GIFT ACCEPTANCE AND DONOR RECOGNITION

1.0 INTRODUCTION

The City of Mercer Island Parks and Recreation Department welcomes and encourages support from private individuals and entities that support the programs and services the Department and its assigned advisory boards, commissions, councils and groups provide to the public.

2.0 PURPOSE

To establish a policy, criteria, guidelines and procedures for receiving and considering proposals to initiate funded, partially funded or unfunded capital projects, including gift and donor recognition projects or undertake changes to a park property that will in the judgment of the Director, modify the property's use, appearance or overall aesthetics

3.0 POLICY

It is the policy of the City of Mercer Island:

- 3.1 To facilitate publicly and privately funded park improvement proposals and encourage public and private gifts, bequests, and such contributions that enhance, beautify, improve, supplement, support, or otherwise benefit the park and recreation system.
- 3.2 To accept only those gifts, park improvements and donor recognition objects that are consistent with the mission, policies, park property restrictions, park master plans and most current Comprehensive Parks, Recreation, Open Space, Trails and Art Plan of the Mercer Island Parks and Recreation Department and the mission and policies of its assigned advisory boards, commissions, councils or groups.
- 3.3 To accept only those gifts, park improvements and donor recognition objects given with the full understanding that they become the property of the City and are subject to the laws, policies and procedures that govern the Parks and Recreation Department and its assigned advisory boards, commissions, councils or groups.
- 3.4 To encourage the development of park master plans for major park, open space, trail and recreation areas (i.e. Luther Burbank Park, I-90 Lid, Mercerdale Park, Homestead Field, Island Crest Park, South Mercer Playfields, and Pioneer Park), and to update such plans as needed to incorporate significant changes in trends, use patterns, amenities and features, operations and maintenance and/or incorporate adjacent or connecting properties.
- 3.5 To solicit and encourage public comment and involvement in the development of park master plans.
- 3.6 To accept gifts of land, from private individuals, for-profit corporations, not-for-profit organizations and public entities when City ownership will further the objectives of the City as identified in the park and open space evaluation and acquisition

PARK IMPROVEMENT, GIFT ACCEPTANCE AND DONOR RECOGNITION

procedures and current Comprehensive Parks, Recreation, Open Space, Trails and Art Plan.

- 3.7 To accept gift and park improvement proposals, other than land, from private individuals, for-profit corporations, not-for-profit organizations and public entities which:
 - 3.7.1 Are given with no contingencies other than that they be used for a specific program, activity or area of programming. (Gifts from corporate donors who have a corporate sponsorship requirement fall under a yet to be developed Corporate Sponsorship Policy);
 - 3.7.2 The City is not obligated to replace if the gift or park improvement is stolen, vandalized, worn out, irreparably damaged or destroyed.
- 3.8 To strongly discourage gift and park improvement proposals that, in the judgment of the Parks and Recreation Director, are incompatible with the park location, other park uses or users.
- 3.9 To strongly discourage gift, park improvement and donor recognition object proposals that are memorial in nature, to emphasize that the park system exists to meet the varied recreational, social, wellness, and educational needs of park users.
- 3.10 To protect designated open space and green space areas as fundamental aspects of the quality of life on Mercer Island, and to limit gifts and park improvements in those areas to benches, trees or other plant materials. Benches should be placed only where placement is deemed a park or recreational necessity as determined by guidelines developed, monitored, and evaluated by Department staff and designated landscape architects.
- 3.11 To prohibit donor recognition objects on gifts in designated open space and green space areas.
- 3.12 To limit, as much as possible, plaques and visible recognition objects to areas of a park recognized as "built" environments, i.e., benches, picnic tables, water fountains, buildings, play areas, ballfields, tennis courts, etc.
- 3.13 To limit, as much as possible, all gifts and park improvements in "built" environments to items that complement those environments, e.g., murals for buildings; turf/fall surfacing/sand/benches/tables/play equipment for play areas; turf/backstops/bleachers/scoreboards/fences for ballfields; nets/posts for tennis courts; backboards/nets/scoreboards for basketball courts.
- 3.14 To limit, as much as possible, the number of donor recognition projects that involve decorative tiles, pavers, and artwork that require mounting on walls, concrete, or any other surface that enhances the "gray" and detracts from the "green" characteristics of our parks. Such projects may require a verifiable demonstration of community support.

PARK IMPROVEMENT, GIFT ACCEPTANCE AND DONOR RECOGNITION

- 3.15 To limit, as much as possible, the number of park improvements that involve surfaces that enhance the “gray” and detract from the “green” characteristics of our parks. Such projects may require a verifiable demonstration of community support.
- 3.16 To ensure that all donor recognition objects are consistent with design guidelines approved by the City of Mercer Island.

4.0 DEFINITIONS

- 4.1. Assigned advisory boards, commissions, councils or groups are any working or advisory board or committee created by City Council action or initiated by the Mayor or City Manager’s Office and assigned to or administratively supported by the Parks and Recreation Department.
- 4.2. Gifts are all gifts, bequests, or donations to include but not be limited to endowments, real property, structures or portions of structures; money or negotiable securities; materials; equipment, flora, or fauna; improvements to facilities or land; statues, monuments, sculptures, murals and other works of art; plaques, graphics and/or signs; or recreation and cultural arts program instruction, equipment and supplies.
- 4.3. Donor Recognition Object is a physical object placed in a park to acknowledge a gift donor
- 4.4. Donor is a private individual, for-profit company, non-profit organization, or public agency wishing to donate funds or objects to the Department
- 4.5. Donor Recognition Project is a proposal and plan for placing a donor recognition object at a park or park facility
- 4.6. Gift Needs Inventory is a list of identified Department operational and capital needs which would make appropriate gifts.
- 4.7. Memorial Art is any statue, monument, sculpture, mural, memorial, or other structure or landscape feature designed to perpetuate in a permanent manner the memory of a person, group, event or other significant element of history.
- 4.8. Park Improvement Proposal may include a funded, partially funded or unfunded capital project(s) request consisting of real property, structures, or portions of structures; materials; equipment; flora or fauna; improvements to facilities or land and other non-art items.
- 4.9. Park Improvement Proposer is a private individual, for-profit company, non-profit organization, or public agency wishing to initiate a funded, partially, funded or unfunded capital project(s) consisting of real property, structures, or portions of structures; materials; equipment; flora or fauna; improvements to facilities or land and other non-art items.

City of Mercer Island Parks and Recreation Department
PARK IMPROVEMENT, GIFT ACCEPTANCE AND DONOR RECOGNITION

5.0 RESPONSIBILITY

- 5.1. The Parks and Recreation Director, or appointed designee, is responsible for:
 - 5.1.1. Receiving all gift, park improvement and donor recognition proposals, including memorial and non-memorial art, and related donor recognition objects and making an initial decision to either accept or reject.
 - 5.1.2. Determining the appropriateness and compatibility of all details of the proposed gift, park improvement and/or donor recognition object, including but not limited to the location, impact on other park uses or users, the size, scale, color, design, materials, contractor, and construction schedule
 - 5.1.3. Advancing approved gift and park improvement proposals to assigned and applicable advisory boards, commissions, councils or groups for design review and refinement.
 - 5.1.4. Making the final decision on acceptance of all gift, park improvement and donor recognition object proposals, unless determining it appropriate for City Council Park and Recreation Committee consideration or full City Council decision.
 - 5.1.5. Declining proposed gift, park improvement or donor recognition object proposals that are limited by special restrictions, conditions or covenants, which pose extreme budgetary obligations on the City, or which, in the opinion of the Director, may not be in the best interest of the park system and/or citizens of Mercer Island.
 - 5.1.6. Making the final decision on the park, recreation area, trail and open space location for the placement of specific gifts, park improvements and donor recognition objects.
 - 5.1.7. Determining the life expectancy of gifts and park improvements; their appropriateness, usefulness and continued value to the park system and to the City; and their retention, relocation, modification, improvement, return to donor, transfer, sale, donation to other agency, or other disposition in conjunction with the Arts Council policies for art deaccessioning.
 - 5.1.8. Determining anticipated costs associated with ongoing maintenance of gifts, park improvements and donor recognition objects, including statues, monuments, sculptures, murals and other works of memorial and non-memorial art and related donor recognition objects, in conjunction with other advisory boards, commissions, councils or groups as appropriate.
 - 5.1.9. Generating a "Gift Needs Inventory" and reviewing it for currency once a year.
- 5.2. The Donor or Park Improvement Proposer is responsible for:
 - 5.2.1. A portion or all of the financial costs of gifts, park improvements and donor recognition objects, and their installation if determined appropriate by the

Parks and Recreation Director. *(The City is under no obligation to replace stolen, vandalized, irreparably damaged or destroyed recognition objects).*

- 5.2.2. A portion or all of the financial costs associated with ongoing maintenance of gifts, park improvements and donor recognition objects, including statues, monuments, sculptures, murals and other works of art and related donor recognition objects, if determined appropriate by the Parks and Recreation Director, in consultation with applicable advisory councils, commissions, boards or groups as appropriate.
 - 5.2.3. Appearing before the applicable advisory council, commission, board or group to present their gift, park improvement and/or donor recognition object proposal.
- 5.3. The Arts Council is responsible for:
- 5.3.1. Receiving and considering a gift proposal advanced from the Parks and Recreation Director, or designee, that is in the form of a memorial or non-memorial statue, monument, sculpture, mural, and other work of art and associated donor recognition object.
 - 5.3.2. Advancing the gift proposal for memorial or non-memorial art and associated donor recognition object to the Public Art Committee and Parks and Recreation liaison for design review and approval considering applicable Arts Council criteria which may include: artistic merit, aesthetic quality, credentials of the artist, installation methods, maintenance requirements, proposed location, the functional or design contribution to the setting, relationship to circulation and use patterns, quality, scale and character of the art proposal and, and installation methods and refining the proposal as needed.
 - 5.3.3. Receiving the refined gift proposal for memorial or non-memorial art from the Public Art Committee for further refinement as needed and advancing the recommended proposal to the Parks and Recreation Director, or designee, for final approval.
 - 5.3.4. Insuring that public comment and feedback is solicited and considered for all art and associated donor recognition objects by providing for a public comment period which may include neighborhood mailings, workshops, open houses, public meetings, advertisements and notices in local media, postings on the City's website, and other methods appropriate to collect citizen input.
 - 5.3.5. Providing the Parks and Recreation Director the name(s) of recommended park, recreation area, trail and open space locations for the placement of statues, monuments, sculptures, murals and other works of art and associated donor recognition objects.
 - 5.3.6. Determining anticipated costs associated with ongoing maintenance of memorial and non-memorial statues, monuments, sculptures, murals and other works of art and related donor recognition objects, in conjunction with

the Parks and Recreation Director and/or other advisory councils, commissions, boards or groups as appropriate.

5.3.7. Providing an appraisal of memorial and non-memorial statues, monuments, sculptures, murals and other works of art after final acceptance by the Parks and Recreation Director and updating appraisal information as needed consistent with established Arts Council policies and procedures and City insurance requirements.

5.4. The City Council is responsible for:

5.4.1. Reviewing proposals for gifts, park improvements and donor recognition objects referred to it by the Parks and Recreation Director and for making a final acceptance or rejection decision.



Park Improvement, Gift Acceptance and Donor Recognition Policy Recommendations

10/7/2022

Development Process

Current policy was created by Staff in early 2000s.

The Reset Strategy calls for updating existing or developing new policies to ensure that Parks and Recreation Department actions are consistent with the Reset Strategy.

Staff has developed draft revisions and seeks input from the Commission.

Commission input and endorsement of updated policy.



Past Donations



- Financial donations
 - South Mercer Playfields batting cages
 - Island Crest Park synthetic turf
 - Mercerdale Playground
 - Luther Burbank Playground
- Asset donations
 - Works of art
 - Benches/picnic tables
 - Equipment

MICC Chapter 2.50 - Donation to the City

Monetary Donations

- The city manager is authorized to accept donations in any amount.
- If donations are conditioned on how to be spent, the City manager may accept for a city-budgeted expenditure.
- City Council approval is required for any donation with specific terms or conditions outside of the City Budget.

Non-monetary Donations

- The city manager is authorized to determine the appropriateness, usefulness and value to the city of all nonmonetary donations with a fair market value of up to \$10,000.00
- City council approval shall be required for the appropriation, retention, improvement, return to donor, transfer, trade, sale, donation to other agency, or other disposition of all other nonmonetary donations.



Key Policy Elements

1. Encouraging gifts and donations which enhance our park spaces.
2. Prohibits memorial donations in the parks and clarifies how and where donors may be recognized.
3. Informs that no contingencies may be required by a donor other than for a specific activity or programming area.

Key Policy Elements

4. To limit improvements to items that complement the designated location.
5. To limit donor recognitions or improvements which alter the character of a space or detract from the characteristics of our parks.
6. Removal of procedural elements from the policy.
7. Updating language to meet the standards of the Department and to be inclusive of Staff and Commission roles.

Consensus Questions

1. Should the Department accept donations- including monetary, project based, artistic, and/or equipment?
2. Are there donations, gifts, or projects that should be more strongly clarified for rejection within the policy?
3. Do you agree that memorials should be prohibited in parks?
4. Do you agree that corporate donors who have a corporate sponsorship requirement should fall under a separate policy?
5. Does the Commission agree with the policy elements?

Next steps

- Revise policy to reflect Commission input
- Nov. 3 with revised policy review, Commission provide input on procedural elements
- Dec. 1 review and endorse policy (if needed)
- Staff develop procedures based on endorsement and procedural input.
- Implement policy and communicate donor opportunities. (Q1 2023)



PARKS & RECREATION COMMISSION STAFF REPORT

Item 4
October 6, 2022
Regular Business

AGENDA ITEM INFORMATION

TITLE:	Aubrey Davis Park Trail Safety Improvement Project 30% Design Recommendation	<input type="checkbox"/> Discussion Only
RECOMMENDED ACTION:	Approve recommendation memo to City Council and authorize the Chair to transmit it to City Council	<input checked="" type="checkbox"/> Action Needed: <input checked="" type="checkbox"/> Motion <input type="checkbox"/> Ordinance <input type="checkbox"/> Resolution

STAFF:	Paul West, CIP Project Manager
COUNCIL LIAISON:	Craig Reynolds
EXHIBITS:	<ol style="list-style-type: none"> 1. City Council Recommendation Memorandum (revised) 2. Aubrey Davis Trails Safety Improvements 30% Plans 3. Email comments to PRC since the September 1, 2022 meeting

SUMMARY

BACKGROUND

At its [September 1, 2022](#) meeting, the Parks and Recreation Commission (PRC) focused on its goal to send a 30% design recommendation to City Council. The PRC’s discussion led to several outcomes:

- The PRC’s proposed recommendation evolved from recommending a specific 30% design to recommending that the 30% design proceed to 60% design, with PRC review at the conclusion of that design phase.
- Outstanding design issues were enumerated for additional review in the 60% design phase.
- The revision of the draft recommendation memo was turned over to a subcommittee for drafting.
- The PRC would review the revised memo at the October 6, 2022 meeting.

Following the meeting, the subcommittee quickly completed its work and produced the memo presented in Exhibit 1. The 30% design was not revised further and is presented for reference in Exhibit 2. It would be attached to the memo as an exhibit when presented to City Council. PRC received two email comments on the project since the September meeting. These are attached in Exhibit 3.

IMPACTS OF THE RECOMMENDATION

Staff have reviewed the memo and support PRC’s recommendation. The level of community interest in this project warrants additional stewardship by the PRC. A consequence of this direction is that additional costs will be incurred, and construction of the project will be delayed. Originally targeted to begin construction in the spring of 2023, it is anticipated construction will now begin in fall 2023 or spring 2024. It should also be noted, that due to the additional design reviews requested, the design budget is increasing and will be added to the full project cost as part of the Council construction award and appropriation request.

NEXT STEPS

Staff has placed this item on the agenda of the November 1 City Council meeting. If accepted by City Council, City staff will continue to work with the Design Team to develop the 60% design. Staff expect to return to the

PRC in early 2023 for 60% design review. Based on the PRC recommendation, the construction of this project is now expected in fall 2023 or spring 2024.

RECOMMENDED ACTION

Approve the recommendation memo and authorize the Chair to transmit it to the City Council.



**PARKS AND RECREATION COMMISSION
CITY OF MERCER ISLAND, WASHINGTON**

9611 SE 36th Street | Mercer Island, WA 98040-3732
(206) 275-7793 | www.mercerisland.gov

DATE: October 6, 2022

TO: Mercer Island City Council

FROM: Parks and Recreation Commission
Jodi McCarthy, Chair, Peter Struck, Vice Chair, Don Cohen, Paul Burstein, Sara Marxen,
Rory Westberg, Ashley Hay

SUBJECT: Recommendation on Aubrey Davis Park Trail Safety Improvements 30% Design

The Mercer Island Parks and Recreation Commission (PRC) presents our recommendation on the Aubrey Davis Park Trail Safety Improvements 30% Design.

Summary Recommendation:

Our recommendation is to proceed to a 60% Design phase with further review by the Parks and Recreation Commission at the conclusion of that phase.

The PRC commenced review of this matter on April 7, 2022 and discussed the topic over four meetings. The project design team collected public input through a virtual open house held on February 17, 2022 and an online survey conducted from February 17 to March 17, 2022 as well as public comments received via the project page on Let's Talk. The open house was attended by 24 people, and survey responses were received from 86 participants. This input was presented to the PRC for consideration at the outset of its deliberations.

The 30% Design includes a roundabout, low fencing, signage and pavement markings at trail intersections throughout the Lid Park. It also provides additional trail modifications in the ballfield/restroom area that will reduce speeds, channelize cross-trail traffic and alert all users to the "mixing zone" they are entering.

Project Priorities:

The design prioritizes improvements that will directly enhance trail safety and focuses major improvements at the ballfield/restroom area, which is a critical area of concern.

Focus on safety

The PRC initially considered a suite of improvements that were collected from public input. With the limited budget, the PRC chose to prioritize improvements that would directly enhance

safety. The utility of other improvements such as benches, kiosks, and pull-out areas was not as clear.

Focus on the ballfield/restroom area

The initial design included substantial improvements at the West Mercer Way crossing. The PRC concluded that these improvements, while potentially useful, were not as critical to trail safety as the improvements proposed for the ballfield/restroom area. The PRC concluded that the project should focus trail improvements there. Particularly, the importance of a roundabout at the entrance to this area was identified as key to controlling traffic flow before trail users enter the mixing zone at the ballfield. Additional analysis is needed to determine the exact composition and configuration of the roundabout. Using concrete pavement to better define the restroom mixing zone will also further signal the need to be alert to the areas where park users enter the trail. Installation of low-level fencing will channel pedestrians to marked crossings and improve predictability for pedestrians and cyclists.

Stay within the available budget

The Consultant's initial estimate included three schedules totaling nearly \$783,000 for all three schedules. With the refinements noted above, the current estimate for the recommended 30% Design exceeds the available budget of \$350,000 by approximately \$25,000. The PRC is pleased that this 30% Design has incorporated safety elements from multiple schedules. The PRC recommends moving forward with this scope of work, as the design achieves the goals of the project, and the estimate is a planning-level estimate that is likely to change when the project is publicly bid for construction.

Other Considerations:

On June 2, the PRC and the Mercer Island Arts Council held a joint meeting and discussed opportunities to integrate art and/or placemaking elements into the project that would be consistent with the Aubrey Davis Park Master Plan. The PRC understands that placemaking elements incorporated into the trail could foster more considerate behaviors among trail users but also wants any features to be compatible with the park's natural landscape, including employing judicious selection of themes and colors. These recommendations will be transmitted to the Arts Council to further inform their discussions of how to use the project's 1% for Art in Public Places contribution (approximately \$3,500).

Conclusion:

The PRC believes the 30% Design provides much-needed improvements and that some elements of the design require further review in the next phase of design. These elements include:

- Refining the design of the roundabout
- Consider adding lighting in the roundabout area
- Number, placement and wording of signs
- Safety, effectiveness and placement of Thermoplastic striping

We look forward to seeing this project advance to 60% Design and request the opportunity to provide our recommendation at the completion of that phase.



CITY OF MERCER ISLAND

AUBREY DAVIS PARK TRAIL SAFETY IMPROVEMENTS SEPTEMBER 2022

CITY PROJECT NUMBER: XXX

SCHEDULE OF DRAWINGS

<u>SHEET</u>	<u>DRAWINGS</u>
1	COVER SHEET
2-3	SHEET INDEX, SURVEY CONTROL AND ALIGNMENT DATA
4	LEGEND AND ABBREVIATIONS
#-6	TESC AND SITE PREPARATION PLANS
7	TESC AND SITE PREPARATION DETAILS
8-10	TRAIL IMPROVEMENT PLANS
14	TRAIL IMPROVEMENT DETAILS
* 15-17	SITE ELEMENT PLANS
* 18	SITE ELEMENT DETAILS
* 19-21	LANDSCAPE RESTORATION PLANS
* 22-23	LANDSCAPE SCHEDULE AND DETAILS
* 24-26	IRRIGATION RESTORATION PLANS
* 27	IRRIGATION SCHEDULE AND DETAILS
* 28-31	SIGN SCHEDULE AND DETAILS
* THESE SHEETS SCHEDULED FOR 60% SUBMITTAL	

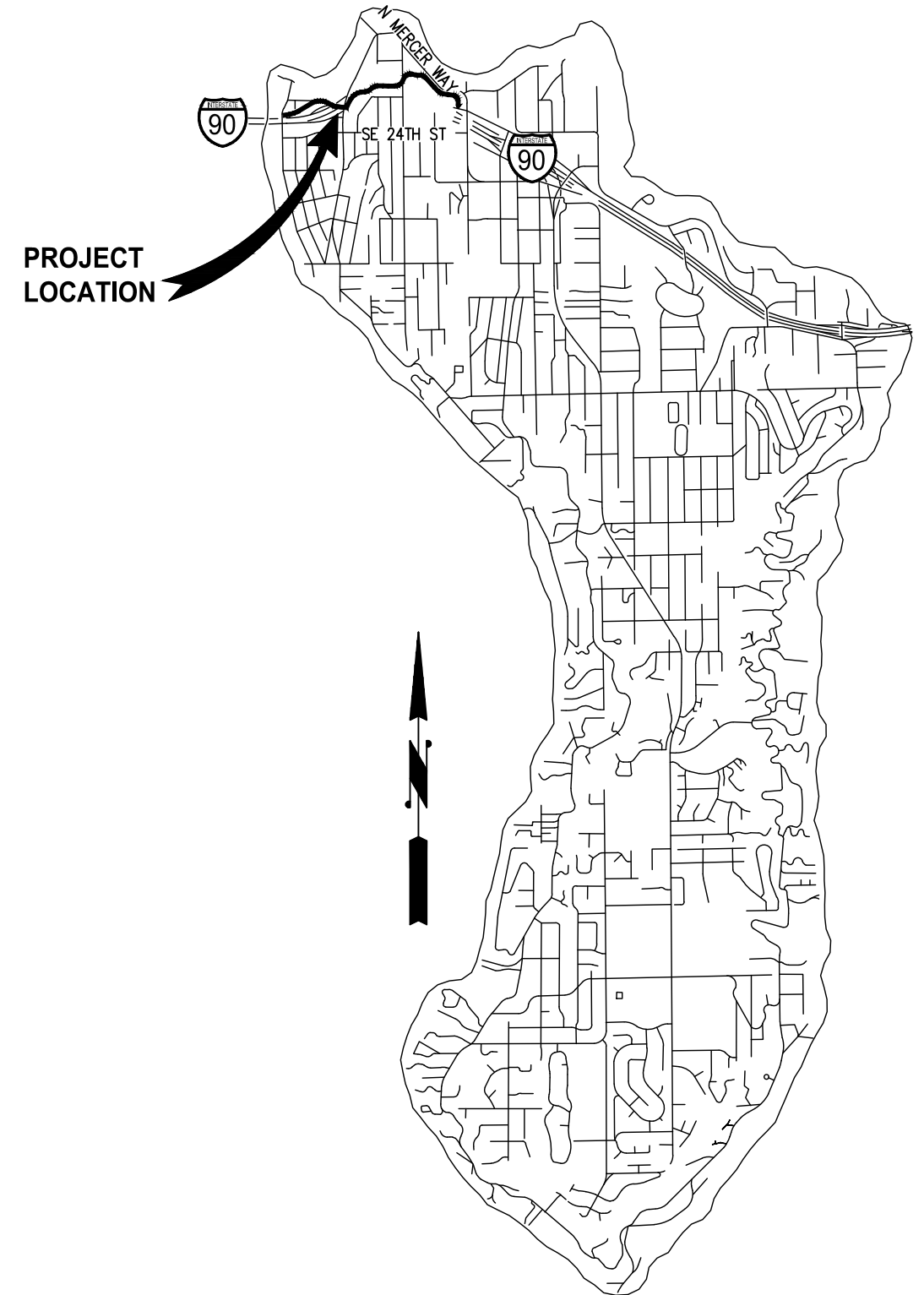

**CALL 2 DAYS
BEFORE YOU DIG
1-800-424-5555**

**30% REVIEW
SUBMITTAL**

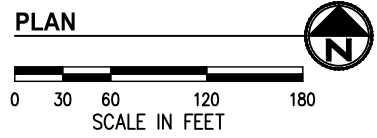
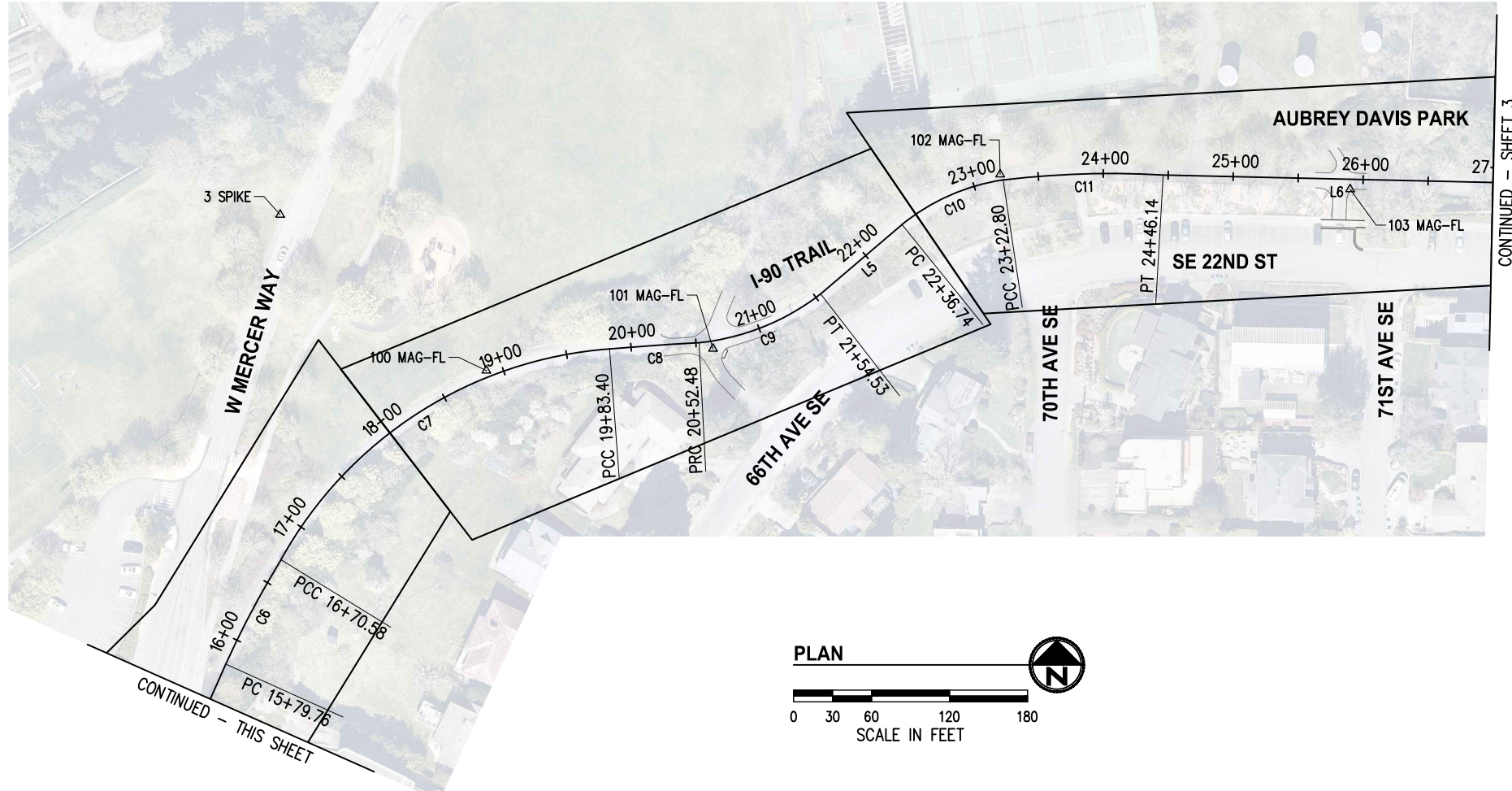
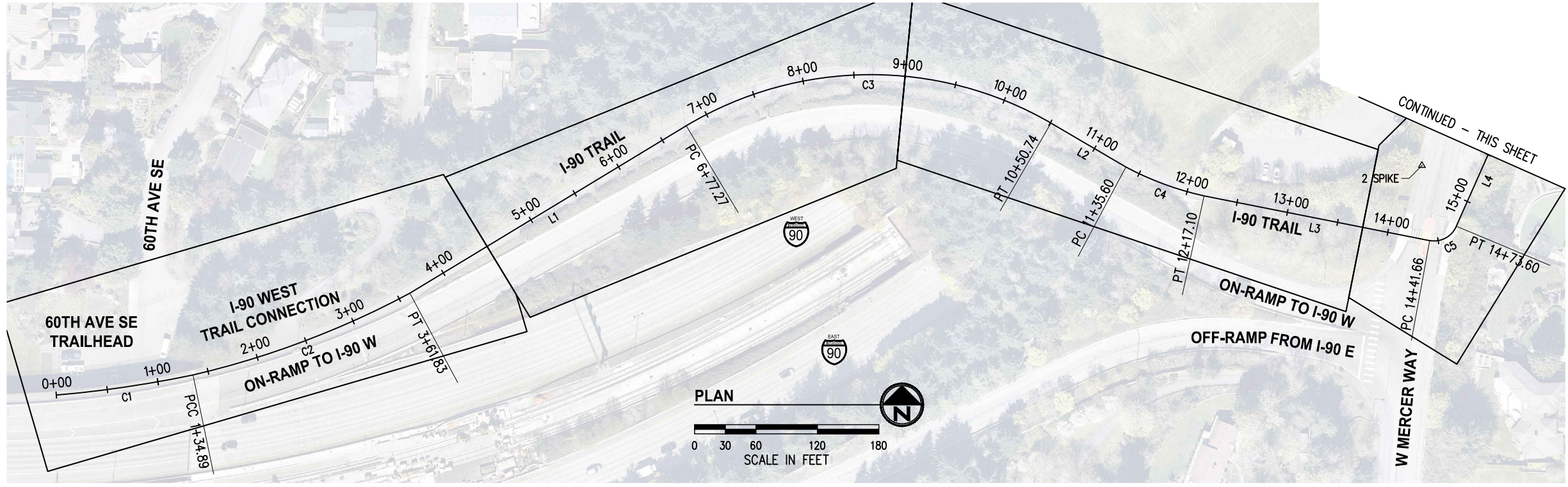

NOTES

- THE PURPOSE OF THIS TOPOGRAPHIC SURVEY IS FOR CIVIL ENGINEERING DESIGN. THIS IS NOT A BOUNDARY SURVEY. SOURCES OF BOUNDARY INFORMATION AS SHOWN INCLUDE FIELD-TIED MONUMENTATION, PLATS, COUNTY RECORDS OF SURVEY, AND AUDITOR INDEXING INFORMATION.
- THE LOCATIONS OF EXISTING UNDERGROUND UTILITY SYSTEMS, AS SHOWN HEREON, ARE TAKEN FROM UTILITY LOCATE PAINT MARKS OR AS-BUILT PLANS AND ARE SHOWN IN AN APPROXIMATE WAY ONLY.

THE CONTRACTOR SHALL DETERMINE THE EXACT LOCATION OF ALL EXISTING UTILITIES BEFORE COMMENCING WORK, AND AGREES TO BE FULLY RESPONSIBLE FOR ANY AND ALL DAMAGES WHICH MIGHT BE OCCASIONED BY THE CONTRACTOR'S FAILURE TO EXACTLY LOCATE AND PRESERVE ANY AND ALL UNDERGROUND UTILITIES. ALL LOCATOR SERVICES SHOULD BE CONTACTED PRIOR TO ANY CONSTRUCTION OR SUBSURFACE EXPLORATION. CALL 1-800-424-5555.
- FIELD SURVEY: KPG, NOVEMBER, 2021. LICENSEE MICHAEL R. BOWEN, P.L.S. NO. 29294/RONALD D. REICHEL, P.L.S. NO. 38015.
- CONTOUR INTERVAL = 1 FOOT, ±0.5 FOOT PER NATIONAL MAPPING STANDARDS. CONTOURS DERIVED FROM DIRECT FIELD OBSERVATIONS.
- STORM AND SEWER CONNECTIONS HAVE BEEN DRAWN FROM CENTER OF LID TO CENTER OF LID.
- THE LOCATIONS AND DIMENSIONS OF UNDERGROUND VAULTS HAVE NOT BEEN VERIFIED AND ARE APPROXIMATE.

HORIZONTAL AND VERTICAL DATUM

HORIZONTAL DATUM: NAD 83/11
 VERTICAL DATUM: NAVD 88
 HORIZONTAL AND VERTICAL DATUMS ESTABLISHED BY RTK GPS OBSERVATION UTILIZING WSRN (WASHINGTON STATE REFERENCE NETWORK) ALSO REFERENCING KPG JOB NUMBER 19033.

I-90 TRAIL			
NUMBER	LENGTH	RADIUS	BRNG/DELTA
C1	134.89	1127.09'	6°51'26"
C2	226.93	866.19'	15°00'39"
C3	373.47	350.67'	61°01'17"
C4	81.50	295.72'	15°47'25"
C5	31.93	23.56'	77°39'24"
C6	90.82	711.38'	7°18'53"
C7	312.82	315.72'	56°46'12"
C8	69.08	1819.45'	2°10'31"
C9	102.05	183.33'	31°53'39"
C10	86.06	161.95'	30°26'44"
C11	123.34	695.38'	10°09'46"
L1	315.442		N 58°46'42" E
L2	84.862		S 59°39'03" E
L3	224.567		S 78°46'35" E
L4	106.165		N 23°55'59" E
L5	82.209		N 49°31'50" E
L6	279.060		S 88°42'08" E

CONTROL POINT LIST				
PT #	DESCRIPTION	NORTHING	EASTING	ELEVATION
2	SPIKE	218611.57	1291363.16	132.74'
3	SPIKE	218994.76	1291481.64	133.62'
100	MAG-FL	218875.02	1291640.28	141.68'
101	MAG-FL	218891.80	1291814.64	154.79'
102	MAG-FL	219025.76	1292035.53	170.72'
103	MAG-FL	219014.32	1292304.75	167.34'
104	MAG-FL	219032.01	1292518.47	151.16'
105	MAG-FL	219215.42	1292658.91	141.86'
106	SPIKE	219249.71	1292560.03	141.51'
107	SPIKE	219295.67	1292715.03	138.94'

ECTS\MERCER IS\21098-Aubrey Davis Park Improvements\DESIGN\Drawings\Contract\21098SURVCTRL.dwg 8/25/2022 3:51 PM

NO.	DATE	BY	APPR.	REVISIONS

Approved By		21098SURVCTRL.dwg
ENGINEERING MANAGER	DATE	DESIGNED BY
PROJECT MANAGER	DATE	DRAWN BY
PROJECT ENGINEER	DATE	CHECKED BY

KPG
 PSOMAS
 Seattle
 3131 Elliott Avenue, Suite 400
 Seattle, WA 98121 206.286.1640
 Tacoma | Wenatchee | KPG.com

**30% REVIEW
 SUBMITTAL**



CITY OF MERCER ISLAND
 AUBREY DAVIS PARK
 TRAIL SAFETY IMPROVEMENTS

SHEET INDEX, SURVEY CONTROL AND ALIGNMENT DATA - 1	
KPG PROJECT No. 21098	SHT <u>2</u> OF <u>14</u>

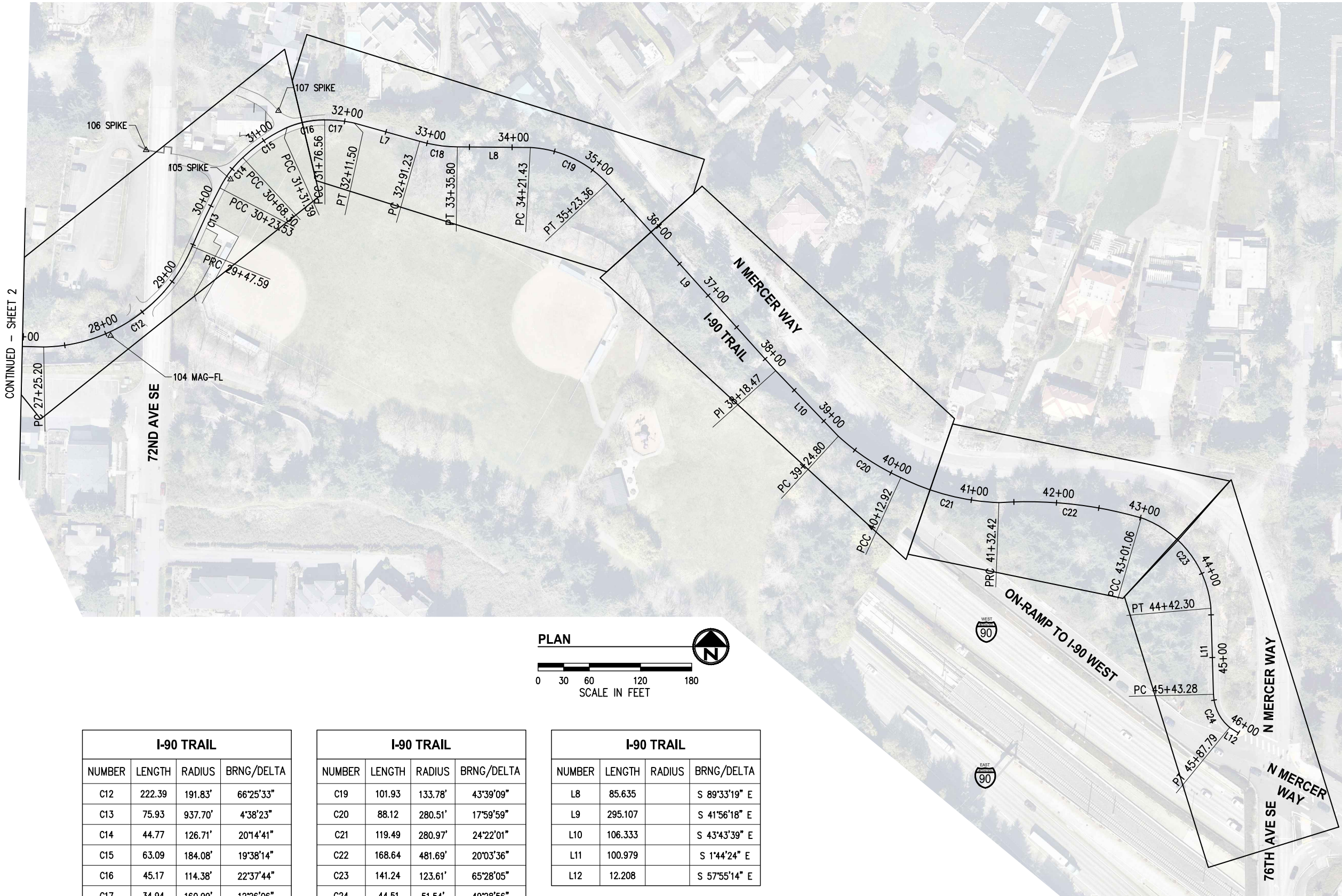

CONTINUED - SHEET 2

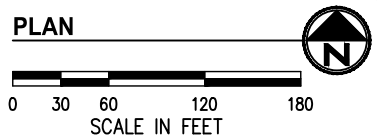

I-90 TRAIL			
NUMBER	LENGTH	RADIUS	BRNG/DELTA
C12	222.39	191.83'	66°25'33"
C13	75.93	937.70'	4°38'23"
C14	44.77	126.71'	20°14'41"
C15	63.09	184.08'	19°38'14"
C16	45.17	114.38'	22°37'44"
C17	34.94	160.99'	12°26'06"
C18	44.57	166.20'	15°21'48"

I-90 TRAIL			
NUMBER	LENGTH	RADIUS	BRNG/DELTA
C19	101.93	133.78'	43°39'09"
C20	88.12	280.51'	17°59'59"
C21	119.49	280.97'	24°22'01"
C22	168.64	481.69'	20°03'36"
C23	141.24	123.61'	65°28'05"
C24	44.51	51.54'	49°28'56"
L7	79.731		S 74°25'05" E

I-90 TRAIL			
NUMBER	LENGTH	RADIUS	BRNG/DELTA
L8	85.635		S 89°33'19" E
L9	295.107		S 41°56'18" E
L10	106.333		S 43°43'39" E
L11	100.979		S 1°44'24" E
L12	12.208		S 57°55'14" E

NOTES

- THE PURPOSE OF THIS TOPOGRAPHIC SURVEY IS FOR CIVIL ENGINEERING DESIGN. THIS IS NOT A BOUNDARY SURVEY. SOURCES OF BOUNDARY INFORMATION AS SHOWN INCLUDE FIELD-TIED MONUMENTATION, PLATS, COUNTY RECORDS OF SURVEY, AND AUDITOR INDEXING INFORMATION.
- THE LOCATIONS OF EXISTING UNDERGROUND UTILITY SYSTEMS, AS SHOWN HEREON, ARE TAKEN FROM UTILITY LOCATE PAINT MARKS OR AS-BUILT PLANS AND ARE SHOWN IN AN APPROXIMATE WAY ONLY.

THE CONTRACTOR SHALL DETERMINE THE EXACT LOCATION OF ALL EXISTING UTILITIES BEFORE COMMENCING WORK, AND AGREES TO BE FULLY RESPONSIBLE FOR ANY AND ALL DAMAGES WHICH MIGHT BE OCCASIONED BY THE CONTRACTOR'S FAILURE TO EXACTLY LOCATE AND PRESERVE ANY AND ALL UNDERGROUND UTILITIES. ALL LOCATOR SERVICES SHOULD BE CONTACTED PRIOR TO ANY CONSTRUCTION OR SUBSURFACE EXPLORATION. CALL 1-800-424-5555.
- FIELD SURVEY: KPG, NOVEMBER, 2021. LICENSEE MICHAEL R. BOWEN, P.L.S. NO. 29294/RONALD D. REICHEL, P.L.S. NO. 38015.
- CONTOUR INTERVAL = 1 FOOT, ±0.5 FOOT PER NATIONAL MAPPING STANDARDS. CONTOURS DERIVED FROM DIRECT FIELD OBSERVATIONS.
- STORM AND SEWER CONNECTIONS HAVE BEEN DRAWN FROM CENTER OF LID TO CENTER OF LID.
- THE LOCATIONS AND DIMENSIONS OF UNDERGROUND VAULTS HAVE NOT BEEN VERIFIED AND ARE APPROXIMATE.

HORIZONTAL AND VERTICAL DATUM

HORIZONTAL DATUM: NAD 83/11
 VERTICAL DATUM: NAVD 88
 HORIZONTAL AND VERTICAL DATUMS ESTABLISHED BY RTK GPS OBSERVATION UTILIZING WSRN (WASHINGTON STATE REFERENCE NETWORK) ALSO REFERENCING KPG JOB NUMBER 19033.

CONTROL POINT LIST

PT #	DESCRIPTION	NORTHING	EASTING	ELEVATION
2	SPIKE	218611.57	1291363.16	132.74'
3	SPIKE	218994.76	1291481.64	133.62'
100	MAG-FL	218875.02	1291640.28	141.68'
101	MAG-FL	218891.80	1291814.64	154.79'
102	MAG-FL	219025.76	1292035.53	170.72'
103	MAG-FL	219014.32	1292304.75	167.34'
104	MAG-FL	219032.01	1292518.47	151.16'
105	MAG-FL	219215.42	1292658.91	141.86'
106	SPIKE	219249.71	1292560.03	141.51'
107	SPIKE	219295.67	1292715.03	138.94'

ECTS\MERCER IS\21098-Aubrey Davis Park Improvements\DESIGN\Drawings\Contract\21098SURVCTRL.dwg 8/25/2022 3:51 PM

NO.	DATE	BY	APPR.	REVISIONS
44				

Approved By		21098SURVCTRL.dwg
ENGINEERING MANAGER	DATE	DESIGNED BY
PROJECT MANAGER	DATE	DRAWN BY
PROJECT ENGINEER	DATE	CHECKED BY



30% REVIEW SUBMITTAL



CITY OF MERCER ISLAND
 AUBREY DAVIS PARK
 TRAIL SAFETY IMPROVEMENTS

SHEET INDEX, SURVEY CONTROL AND ALIGNMENT DATA - 2	
KPG PROJECT No. 21098	SHT 3 OF 14

EXISTING LEGEND

MIC	MONUMENT IN CASE	①	TELEPHONE MANHOLE	— P —	PAINTED POWER
MON	SURFACE MONUMENT	T □	TELEPHONE RISER	— T —	PAINTED TELEPHONE
RC	REBAR & CAP	□	TELEPHONE VAULT LID	— FO —	PAINTED FIBER OPTIC
⊙	SPOT SHOT (DESCRIBED)	⊕	TELEPHONE POLE	— TV —	PAINTED TV
□	CATCH BASIN	TV	TV VAULT LID	— W —	PAINTED WATER
⊙	STORM DRAIN MANHOLE	FO	FIBER OPTIC MANHOLE	— G —	PAINTED GAS
⊕	YARD DRAIN	⊕	GAS VALVE	— SD —	STORM
⊕	DOWNSPOUT	⊕	GAS METER	— S —	SEWER
SD	STORM DRAIN CLEAN-OUT	⊕	WATER VALVE	— X —	FENCE
⊕	SEWER MANHOLE	⊕	WATER METER	~~~~~	HEDGE (HEIGHT NOTED)
SS	SEWER CLEAN-OUT	⊕	WATER MANHOLE	//////	BUILDING
⊕	POWER POLE	⊕	FIRE HYDRANT	————	PAINTED STRIPE
⊕	POWER POLE WITH UG CONNECT	⊕	FIRE DEPARTMENT CONNECT	RAISED-BUTTON SOLID STRIPE
□	POWER VAULT LID	⊕	UTILITY VAULT LID (GENERIC/UNKNOWN)	RAISED-BUTTON SKIP STRIPE
△	POWER TRANSFORMER	U	UTILITY ACCESS (GENERIC/UNKNOWN)	————	EDGE OF PAVEMENT
⊕	POWER METER	●	BORE SITE (WITH FIELD DESCRIPTION)	-----	FLOWLINE
⊕	POWER OUTLET	○	BOULDER	-----	CONTOUR
→	GUY ANCHOR	⊕	SIGN	-----	EXISTING RIGHT-OF-WAY LINE
⊕	TRAFFIC SIGNAL WITH LUMINAIRE	⊕	MAILBOX	-----	PROPERTY LINE
⊕	PEDESTRIAN SIGNAL	⊕	SHRUB	-----	CONCRETE
⊕	JUNCTION BOX TYPE 1, 2, 3	⊕	GRASS	-----	GRAVEL
⊕	TRAFFIC CONTROL CABINET	DT12(3)	DECIDUOUS TREE, DIAM. IN INCHES (# OF TRUNKS)	-----	BRICK
⊕	TRAFFIC SERVICE CABINET	CT12(3)	CONIFEROUS TREE, DIAM. IN INCHES (# OF TRUNKS)	-----	METAL GRATE
⊕	TRAFFIC ATTENUATOR LOOP				
⊕	STREET LIGHT (LUMINAIRE)				
⊕	LOT LIGHT				
⊕	YARD LIGHT				

PROPOSED LEGEND

⊕	WATER METER
⊕	WATER VALVE
⊕	FIRE HYDRANT
⊕	SIGN
— X —	CHAIN LINK FENCE
⊕	DETECTABLE WARNING SURFACE
⊕	HMA CL 1/2" PG 64-22 FOR NEW PAVEMENT
⊕	REMOVE ASPHALT CONC PAVEMENT (ON SITE PREPARATION PLANS)
⊕	CEMENT CONCRETE
⊕	PERVIOUS CEMENT CONCRETE
⊕	RESERVOIR COURSE
⊕	CSTC
⊕	CSBC
⊕	TREE GRATE
⊕	DECORATIVE PEDESTRIAN LUMINAIRES AND POLE
⊕	SIGNAL POLE WITH DECORATIVE LUMINAIRE AND MAST ARM
⊕	SIGNAL CONTROLLER CABINET
⊕	ELECTRICAL SERVICE CABINET
⊕	BATTERY BACKUP POWER SUPPLY
⊕	JUNCTION BOX TYPE 1, 2, 8
⊕	CONDUIT

ABBREVIATIONS

AC	ASPHALT CONCRETE	MIC	MONUMENT IN CASE
ACP	ASPHALT CONCRETE PAVEMENT	MJ	MECHANICAL JOINT
ADA	AMERICANS WITH DISABILITIES ACT	MON	MONUMENT
AP	ANGLE POINT	N	NORTH OR NORTHING
APPROX	APPROXIMATE	NAVD	NORTH AMERICAN VERTICAL DATUM
BLDG	BUILDING	NO	NUMBER
CB	CATCH BASIN	NTS	NOT TO SCALE
CCP	CEMENT CONCRETE PAVEMENT	OC	ON CENTER
CDF	CONTROLLED DENSITY FILL	OD	OUTSIDE DIAMETER
CHLK	CHAINLINK	PC	POINT OF CURVE
CL	CENTERLINE	PCC	POINT OF COMPOUND CURVATURE
CL	CLASS	PCCP	PERVIOUS CEMENT CONCRETE PAVEMENT
CO	CLEANOUT	PI	POINT OF INTERSECTION
COMI	CITY OF MERCER ISLAND	POB	POINT OF BEGINNING
COL	COLUMN CONC CONCRETE	POE	POINT OF ENDING
CSBC	CRUSHED SURFACING BASE COURSE	PRC	POINT OF REVERSE CURVATURE
CSTC	CRUSHED SURFACING TOP COURSE	PT	POINT OF TANGENT
DI	DUCTILE IRON	PVC	POLYVINYL CHLORIDE OR
DIA	DIAMETER		POINT OF VERTICAL CURVATURE
DW	DRIVEWAY	PVT	POINT OF VERTICAL TANGENT
E	EAST OR EASTING	PVI	POINT OF VERTICAL INTERSECTION
EA	EACH	R	RADIUS
ELEV	ELEVATION	ROW	RIGHT OF WAY
EOP	EDGE OF PAVEMENT	RT	RIGHT
EW	EACH WAY	S	SLOPE OR SOUTH
EXIST	EXISTING	SD	STORM DRAIN
FF	FINISHED FLOOR	SDMH	STORM DRAIN MANHOLE
FL	FLOW LINE	SE	SOUTHEAST
FO	FIBER OPTIC	SHT	SHEET
FOC	FACE OF CURB	SQ	SQUARE
HMA	HOT MIX ASPHALT	SS	SANITARY SEWER
HORIZ	HORIZONTAL	SSMH	SANITARY SEWER MANHOLE
HP	HIGH POINT	ST	STREET
ID	INSIDE DIAMETER	STA	STATION
IE	INVERT ELEVATION	STD	STANDARD
IN	INCH/INCHES	STCR	STRUCTURE
JB	JUNCTION BOX	SW	SOUTHWEST
L	LENGTH LT LEFT	TYP	TYPICAL
LF	LINEAR FEET	VERT	VERTICAL
LP	LOW POINT	W	WEST
MAX	MAXIMUM	YD	YARD DRAIN
MIN	MINIMUM		
MH	MANHOLE		

ECTS\MERCER IS\21098-Aubrey Davis Park Improvements\DESIGN\Drawings\Contract\21098LEG-ABBRV.dwg 8/25/2022 3:51 PM

NO.	DATE	BY	APPR.	REVISIONS

Approved By		21098LEG-ABBRV.dwg FILENAME	
ENGINEERING MANAGER	DATE	DESIGNED BY	DATE
PROJECT MANAGER	DATE	DRAWN BY	DATE
PROJECT ENGINEER	DATE	CHECKED BY	DATE

KPG
PSOMAS
Seattle
3131 Elliott Avenue, Suite 400
Seattle, WA 98121 206.286.1640
Tacoma | Wenatchee | KPG.com

**30% REVIEW
SUBMITTAL**



CITY OF MERCER ISLAND
AUBREY DAVIS PARK
TRAIL SAFETY IMPROVEMENTS

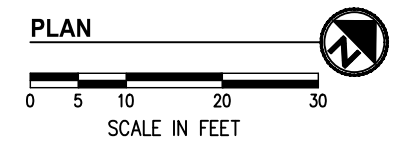
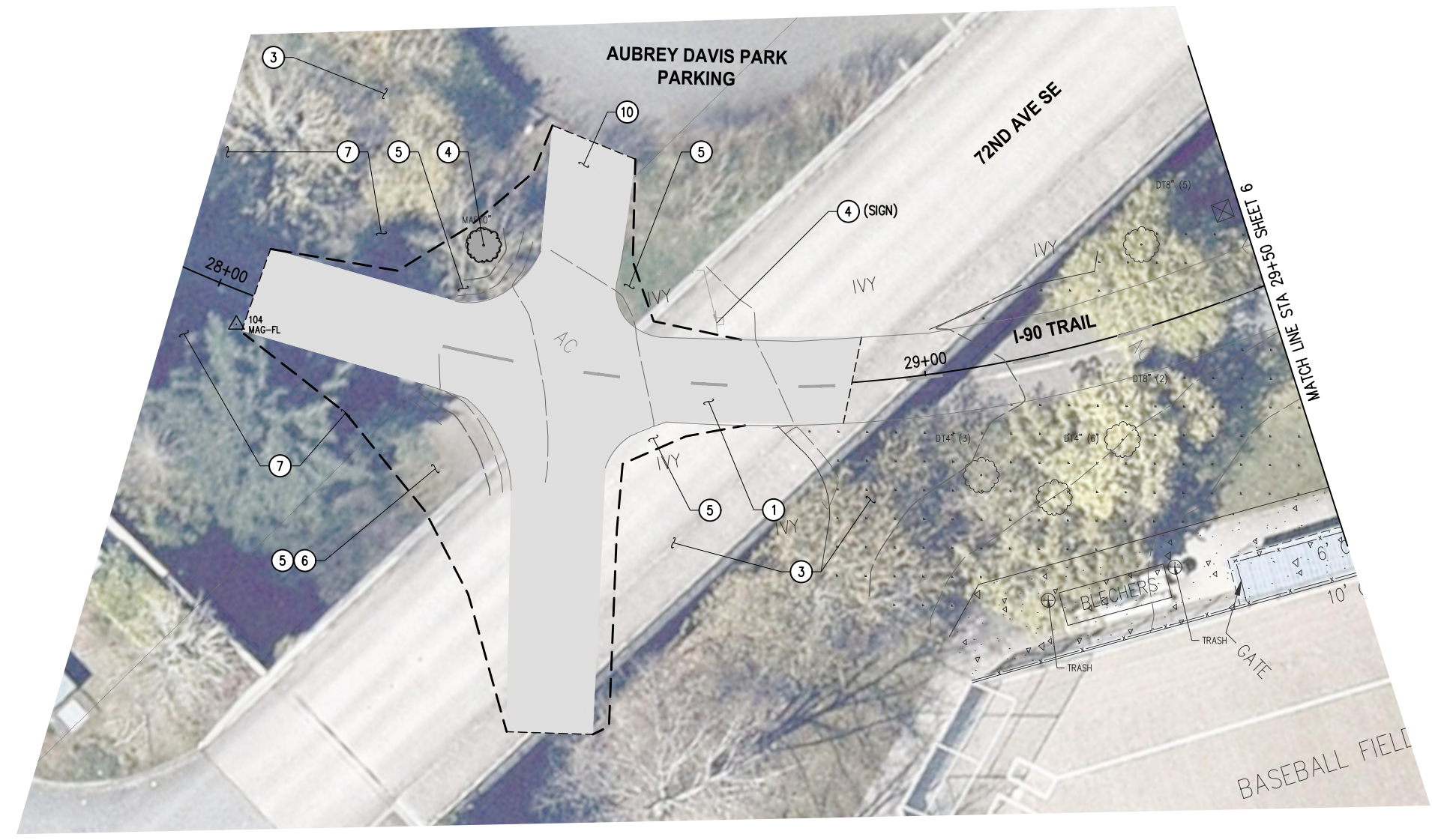

GENERAL NOTES

1. CONTRACTOR SHALL SEQUENCE REMOVAL OF EXISTING FEATURES WITH CONSTRUCTION OF NEW ROADWAY ELEMENTS TO MINIMIZE IMPACTS TO PROPERTY OWNERS, TRAFFIC FLOW, AND THE ENVIRONMENT.
2. CONTRACTOR SHALL PROTECT ALL ABOVE AND BELOW GROUND UTILITIES AND IMPROVEMENTS THAT ARE TO REMAIN.
3. CONTRACTOR SHALL PROTECT ALL PLANT MATERIAL OUTSIDE OF CLEARING LIMITS.
4. CONTRACTOR SHALL MAINTAIN ACCESS FOR ALL ADJACENT PROPERTY OWNERS AND PARK USERS.
5. CONTRACTOR SHALL FURNISH AND INSTALL INLET PROTECTION IN ALL EXISTING AND NEW CATCH BASINS. CONTRACTOR SHALL INSTALL OTHER EROSION CONTROL MEASURES TO MINIMIZE SEDIMENT MIGRATION INTO STREAMS AND STORM DRAINAGE SYSTEMS.

CONSTRUCTION NOTES

- ① SAWCUT AND REMOVE ASPHALT PAVEMENT.
- ③ PRESERVE AND PROTECT.
- ④ REMOVE.
- ⑤ REMOVE GROUNDCOVER WITHIN CLEARING LIMITS AS NECESSARY TO INSTALL PROPOSED IMPROVEMENTS.
- ⑥ REMOVE SHRUB(S) AND BUSH(ES).
- ⑦ TRIM/PRUNE EXISTING TREE(S), BUSH(ES), AND SHRUB(S) PER COMI STD DETAIL UF-4 AS NECESSARY TO INSTALL PROPOSED IMPROVEMENTS. VERIFY AREA OF WORK TO BE PERFORMED IN PRESENCE OF COMI PARKS DEPARTMENT.
- ⑩ REMOVE BOLLARDS.

LEGEND

- REMOVE CEMENT CONC PAVEMENT
- REMOVE ASPHALT PAVEMENT
- REMOVE CURB AND GUTTER
- REMOVE DECIDUOUS TREE
- SAWCUT
- HIGH VISIBILITY FENCE
- CLEARING LIMITS

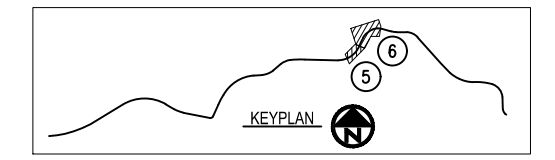

ECTS\MERCER IS\21098-Aubrey Davis Park Improvements\DESIGN\Drawings\Contract\21098TESC-SP.dwg 8/25/2022 3:52 PM

NO.	DATE	BY	APPR.	REVISIONS

Approved By		21098TESC-SP.dwg FILENAME	
ENGINEERING MANAGER	DATE	DESIGNED BY	DATE
PROJECT MANAGER	DATE	DRAWN BY	DATE
PROJECT ENGINEER	DATE	CHECKED BY	DATE

KPG
PSOMAS
Seattle
3131 Elliott Avenue, Suite 400
Seattle, WA 98121 206.286.1640
Tacoma | Wenatchee | KPG.com

**30% REVIEW
SUBMITTAL**



**CITY OF MERCER ISLAND
AUBREY DAVIS PARK
TRAIL SAFETY IMPROVEMENTS**

TESC AND SITE PREPARATION PLANS
STA 28+00 TO STA 29+50
KPG PROJECT No. 21098 SHT 5 OF 14

GENERAL NOTES

1. CONTRACTOR SHALL SEQUENCE REMOVAL OF EXISTING FEATURES WITH CONSTRUCTION OF NEW ROADWAY ELEMENTS TO MINIMIZE IMPACTS TO PROPERTY OWNERS, TRAFFIC FLOW, AND THE ENVIRONMENT.
2. CONTRACTOR SHALL PROTECT ALL ABOVE AND BELOW GROUND UTILITIES AND IMPROVEMENTS THAT ARE TO REMAIN.
3. CONTRACTOR SHALL PROTECT ALL PLANT MATERIAL OUTSIDE OF CLEARING LIMITS.
4. CONTRACTOR SHALL MAINTAIN ACCESS FOR ALL ADJACENT PROPERTY OWNERS AND PARK USERS.
5. CONTRACTOR SHALL FURNISH AND INSTALL INLET PROTECTION IN ALL EXISTING AND NEW CATCH BASINS. CONTRACTOR SHALL INSTALL OTHER EROSION CONTROL MEASURES TO MINIMIZE SEDIMENT MIGRATION INTO STREAMS AND STORM DRAINAGE SYSTEMS.

CONSTRUCTION NOTES

- ① SAWCUT AND REMOVE ASPHALT PAVEMENT.
- ② SAWCUT AND REMOVE CONCRETE PAVEMENT.
- ③ PRESERVE AND PROTECT.
- ④ REMOVE.
- ⑤ REMOVE GROUND COVER WITHIN CLEARING LIMITS AS NECESSARY TO INSTALL PROPOSED IMPROVEMENTS.
- ⑥ REMOVE SHRUB(S) AND BUSH(ES).
TRIM/PRUNE EXISTING TREE(S), BUSH(ES), AND SHRUB(S) PER COMI STD DETAIL UF-4 AS NECESSARY TO INSTALL PROPOSED IMPROVEMENTS. VERIFY AREA OF WORK TO BE PERFORMED IN PRESENCE OF COMI PARKS DEPARTMENT.
- ⑦ REMOVE DRINKING FOUNTAIN. CUT AND CAP SUPPLY LINE. MARK ON SURFACE FOR FUTURE CONNECTION OF NEW DRINKING FOUNTAIN.
- ⑧ REMOVE BENCH. CONTRACTOR SHALL STORE BENCH FOR REINSTALLATION.
- ⑩ REMOVE BOLLARDS.
- ⑪ PRESERVE AND PROTECT PEACE POLE.
- ⑫ REMOVE BIKE RACK. CONTRACTOR SHALL STORE FOR REINSTALLATION.
- ⑬ REMOVE DOG WASTE DISPENSER. CONTRACTOR SHALL STORE FOR REINSTALLATION.
- ⑭ REMOVE TRASH AND RECYCLE CONTAINERS. CONTRACTOR SHALL STORE FOR REINSTALLATION.

LEGEND

- REMOVE CEMENT CONC PAVEMENT
- REMOVE ASPHALT PAVEMENT
- REMOVE CURB AND GUTTER
- REMOVE DECIDUOUS TREE
- SAWCUT
- HIGH VISIBILITY FENCE
- CLEARING LIMITS

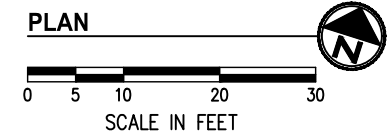
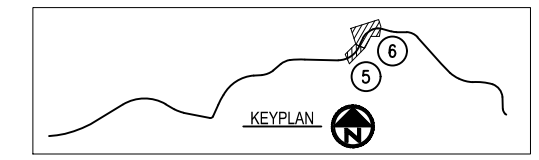

ECTS\MERCER IS\21098-Aubrey Davis Park Improvements\DESIGN\Drawings\Contract\21098TESC-SP.dwg 8/25/2022 3:52 PM

NO.	DATE	BY	APPR.	REVISIONS

Approved By		21098TESC-SP.dwg FILENAME	
ENGINEERING MANAGER	DATE	DESIGNED BY	DATE
PROJECT MANAGER	DATE	DRAWN BY	DATE
PROJECT ENGINEER	DATE	CHECKED BY	DATE

KPG
PSOMAS
Seattle
3131 Elliott Avenue, Suite 400
Seattle, WA 98121 206.286.1640
Tacoma | Wenatchee | KPG.com

**30% REVIEW
SUBMITTAL**



**CITY OF MERCER ISLAND
AUBREY DAVIS PARK
TRAIL SAFETY IMPROVEMENTS**

TESC AND SITE PREPARATION PLANS
STA 29+50 TO STA 32+00
KPG PROJECT No. 21098 SHT 6 OF 14

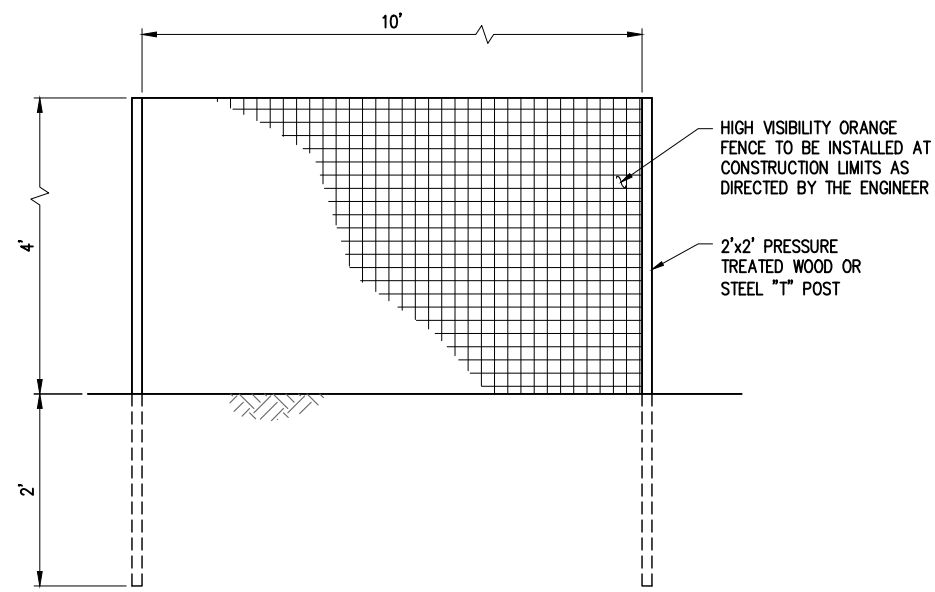

ELEVATION

NOTE:
PLACE AT GRADING LIMITS AND AROUND TREES TO BE PROTECTED WHERE DIRECTED BY THE ENGINEER.

HIGH VISIBILITY ORANGE FENCING
NTS

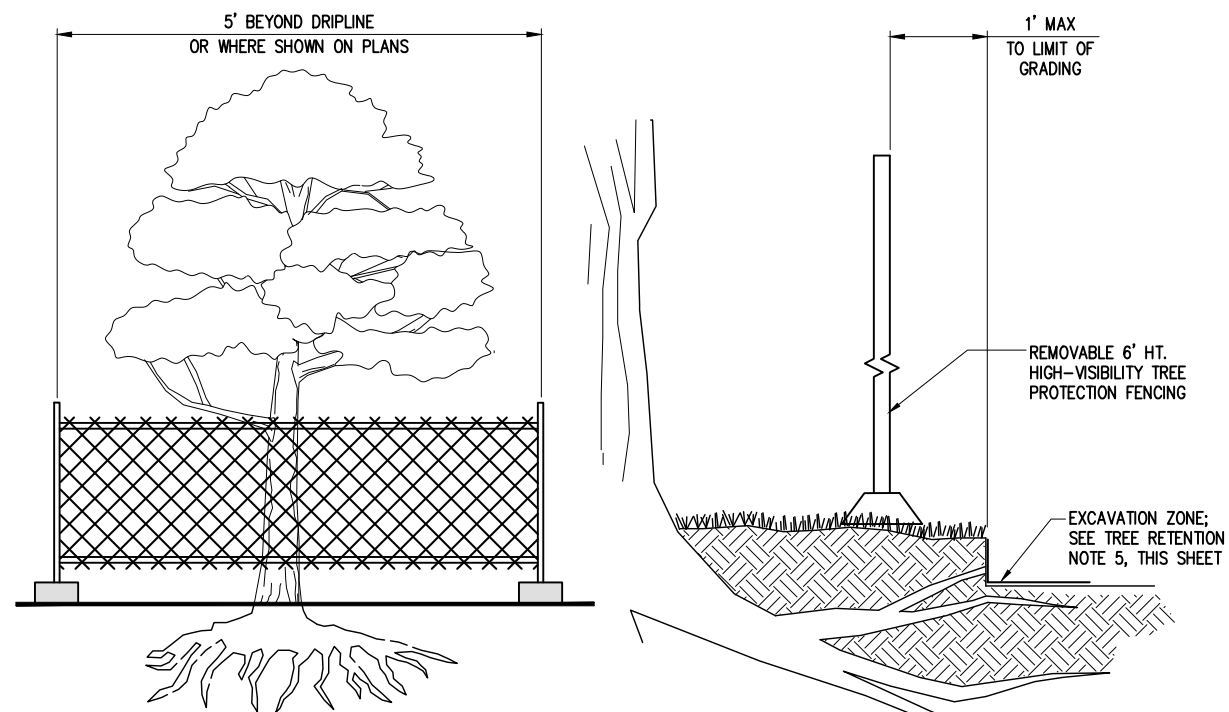

TREE PROTECTION DETAIL
TEMPORARY CHAIN LINK FENCE
NTS

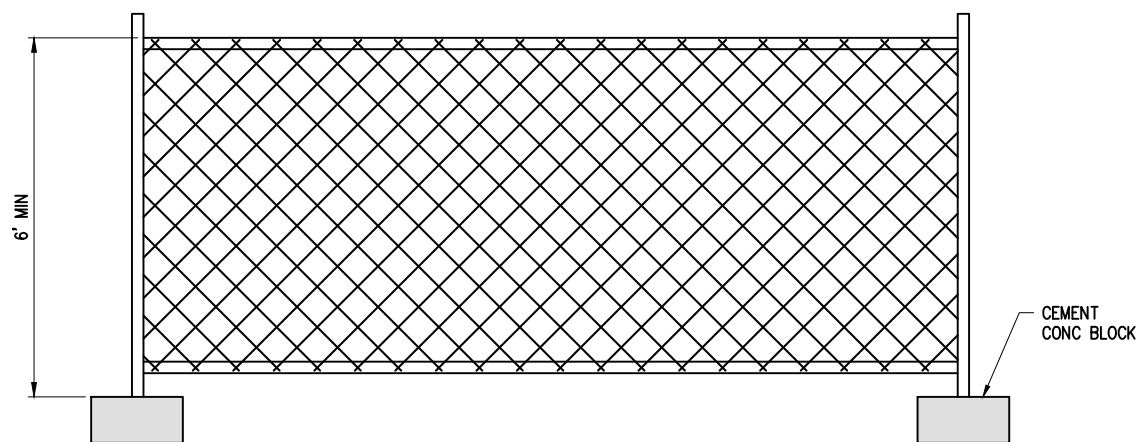

NOTES:

- SIX FOOT HIGH TEMPORARY CHAIN LINK FENCE SHALL BE PLACED WHERE INDICATED ON PLANS. ACCESS GATES TO BE INSTALLED ONLY WHERE INDICATED ON PLANS. INSTALL FENCE POSTS USING CEMENT CONC. BLOCK FOOTINGS ONLY. AVOID DRIVING POSTS OR STAKES INTO EXISTING GROUND SURFACE.

TEMPORARY CHAIN LINK FENCE
NTS

ECTS\MERCER IS\21098-Aubrey Davis Park Improvements\DESIGN\Drawings\Contract\21098TESC-SP-DET.dwg 8/25/2022 3:52 PM

NO.	DATE	BY	APPR.	REVISIONS

Approved By			
ENGINEERING MANAGER	DATE	DESIGNED BY	DATE
PROJECT MANAGER	DATE	DRAWN BY	DATE
PROJECT ENGINEER	DATE	CHECKED BY	DATE

21098TESC-SP-DET.dwg
FILENAME

KPG
PSOMAS

Seattle
3131 Elliott Avenue, Suite 400
Seattle, WA 98121 206.286.1640
Tacoma | Wenatchee | KPG.com

30% REVIEW
SUBMITTAL



CITY OF MERCER ISLAND
AUBREY DAVIS PARK
TRAIL SAFETY IMPROVEMENTS

TESC AND SITE PREPARATION DETAILS

KPG PROJECT No. 21098 SHT 7 OF 14

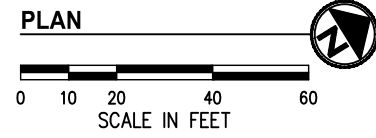
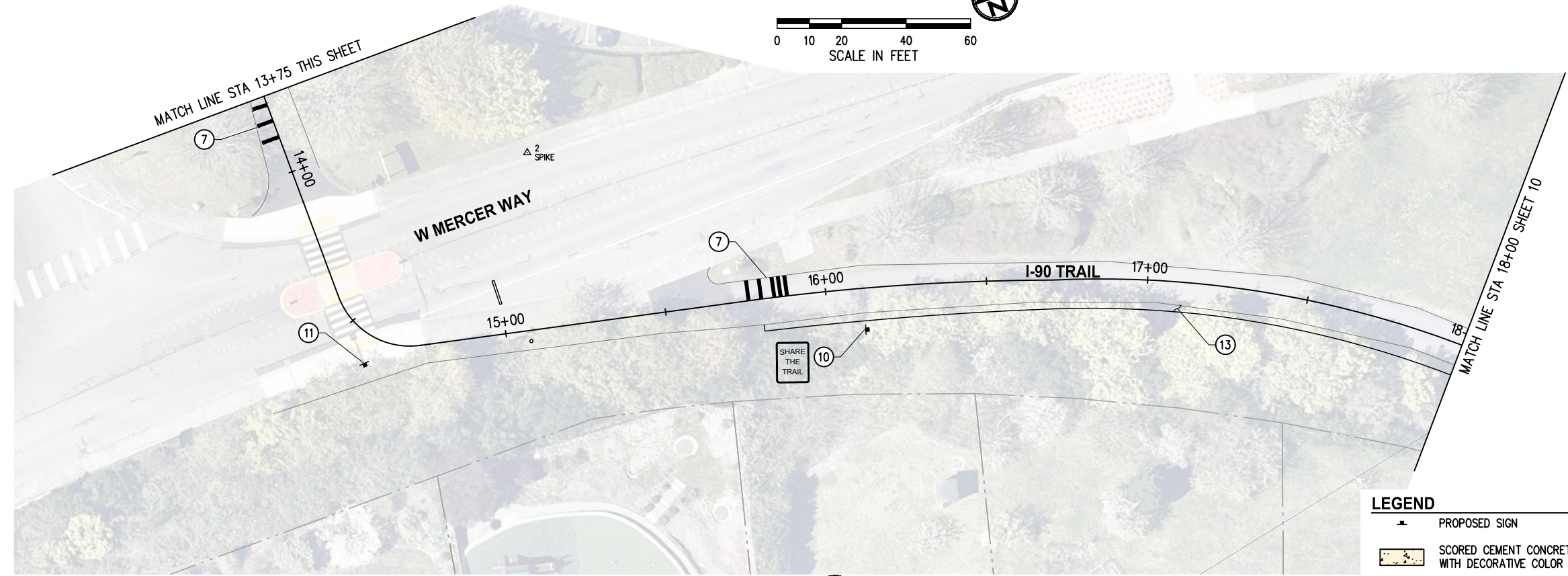
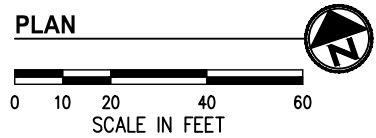
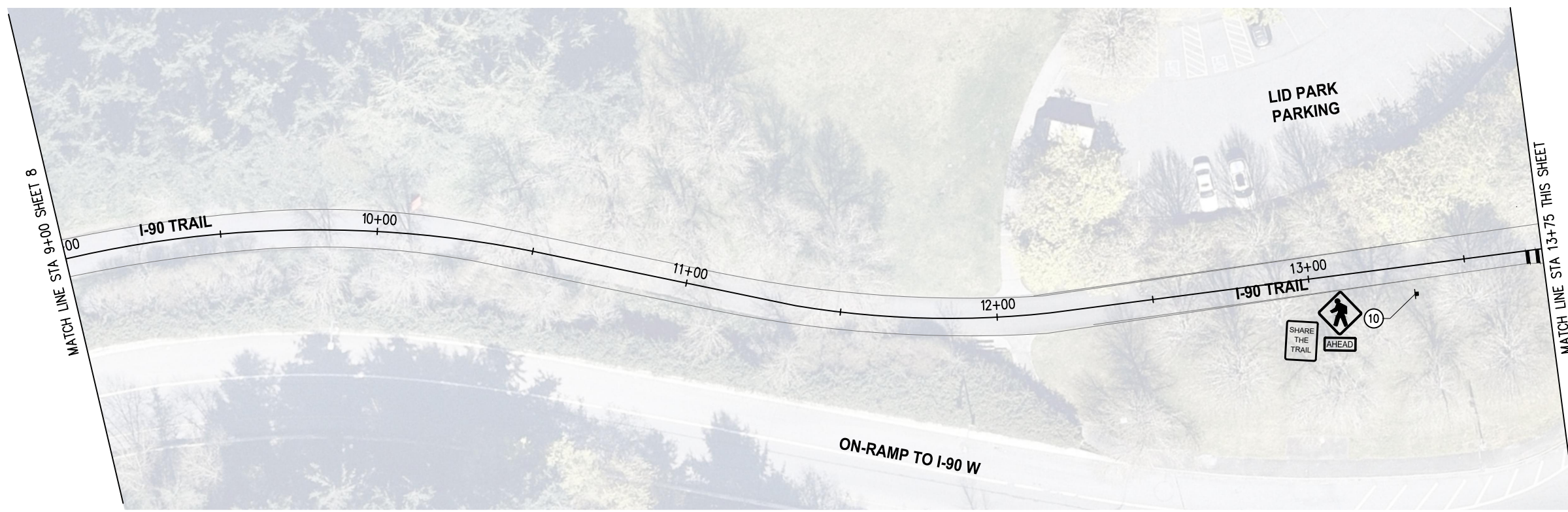

GENERAL NOTES

1. CONTRACTOR SHALL SEQUENCE REMOVAL OF EXISTING FEATURES WITH CONSTRUCTION OF NEW ROADWAY ELEMENTS TO MINIMIZE IMPACTS TO PROPERTY OWNERS, TRAIL USERS, TRAFFIC FLOW, AND THE ENVIRONMENT.
2. CONTRACTOR SHALL PROVIDE AND MAINTAIN TEMPORARY PEDESTRIAN ROUTE AROUND CONSTRUCTION ACTIVITY FOR THE DURATION OF CONSTRUCTION.

CONSTRUCTION NOTES

- ⑦ INSTALL THERMOPLASTIC BAR PER DETAIL, SHEET 14.
- ⑩ INSTALL REGULATORY SIGN.
- ⑪ INSTALL WAYFINDING SIGN.
- ⑫ RESTORE TRAIL SHOULDER, SHEET 14.
- ⑬ LAWN RESTORATION.

NOTE: REGULATORY SIGNS SHOWN ARE PLACE HOLDERS, CONTENT TO BE CONFIRMED BY 60% SUBMITTAL

LEGEND

- PROPOSED SIGN
- SCORED CEMENT CONCRETE TRAIL WITH DECORATIVE COLOR TREATMENT
- HMA TRAIL OR PAVEMENT
- DETECTABLE WARNING SURFACE
- CEMENT CONCRETE TRAIL

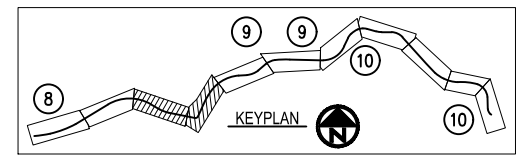

ECTS\MERCER IS\21098-Aubrey Davis Park Improvements\DESIGN\Drawings\Contract\21098TRAIL.dwg 9/1/2022 5:24 PM

NO.	DATE	BY	APPR.	REVISIONS
49				

Approved By		21098TRAIL.dwg
ENGINEERING MANAGER	DATE	DESIGNED BY
PROJECT MANAGER	DATE	DRAWN BY
PROJECT ENGINEER	DATE	CHECKED BY

KPG
PSOMAS
Seattle
3131 Elliott Avenue, Suite 400
Seattle, WA 98121 206.286.1640
Tacoma | Wenatchee | KPG.com

**30% REVIEW
SUBMITTAL**



**CITY OF MERCER ISLAND
AUBREY DAVIS PARK
TRAIL SAFETY IMPROVEMENTS**

**TRAIL IMPROVEMENT PLANS
STA 9+00 TO STA 18+00**
KPG PROJECT No. 21098 SHT 9 OF 14

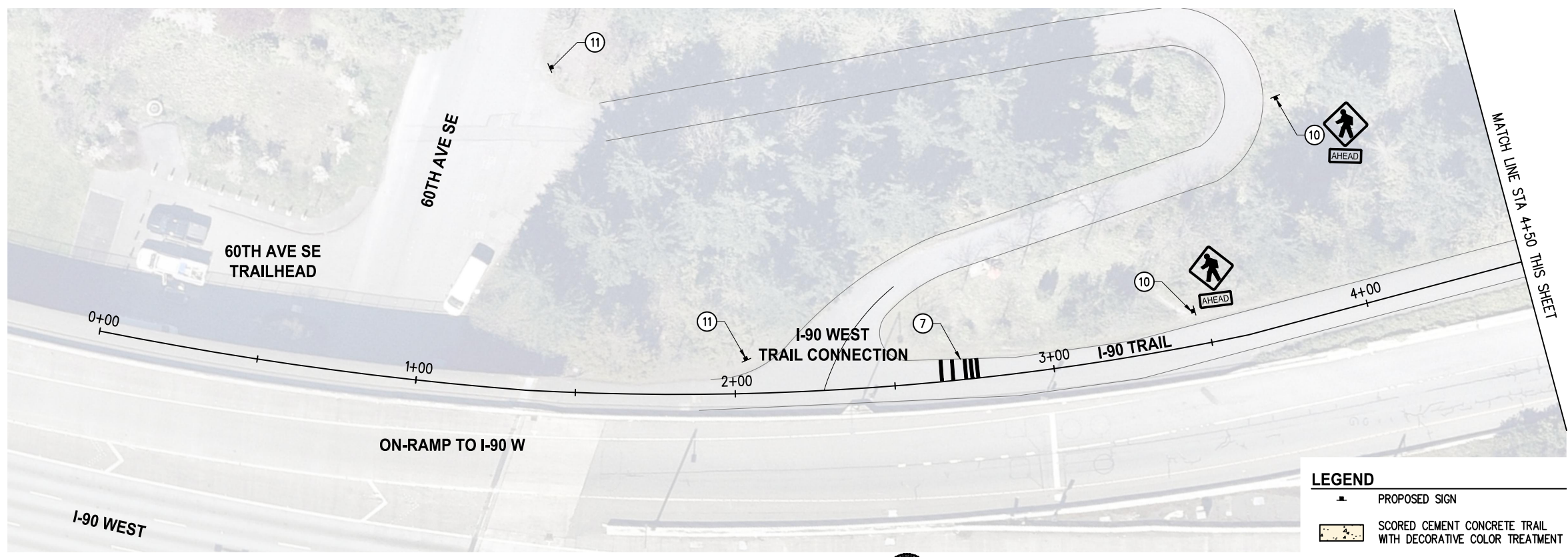

GENERAL NOTES

- CONTRACTOR SHALL SEQUENCE REMOVAL OF EXISTING FEATURES WITH CONSTRUCTION OF NEW ROADWAY ELEMENTS TO MINIMIZE IMPACTS TO PROPERTY OWNERS, TRAIL USERS, TRAFFIC FLOW, AND THE ENVIRONMENT.
- CONTRACTOR SHALL PROVIDE AND MAINTAIN TEMPORARY PEDESTRIAN ROUTE AROUND CONSTRUCTION ACTIVITY FOR THE DURATION OF CONSTRUCTION.

CONSTRUCTION NOTES

- INSTALL THERMOPLASTIC BAR PER DETAIL, SHEET 14.
- INSTALL REGULATORY SIGN.
- INSTALL WAYFINDING SIGN.
- RESTORE TRAIL SHOULDER, SHEET 14.
- LAWN RESTORATION.

NOTE: REGULATORY SIGNS SHOWN ARE PLACE HOLDERS, CONTENT TO BE CONFIRMED BY 60% SUBMITTAL

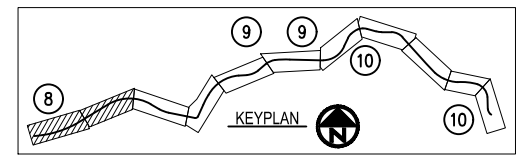
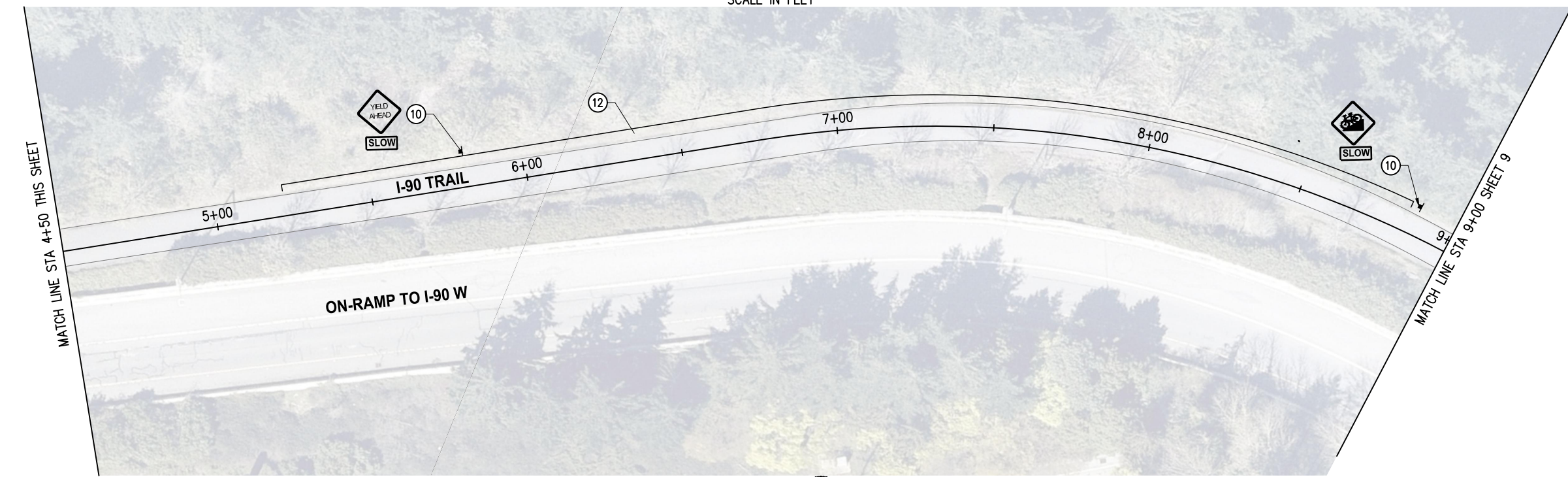

ECTS\MERCER IS\21098-Aubrey Davis Park Improvements\DESIGN\Drawings\Contract\21098TRAIL.dwg 9/1/2022 5:24 PM

NO.	DATE	BY	APPR.	REVISIONS

Approved By		21098TRAIL.dwg
ENGINEERING MANAGER	DATE	FILENAME
PROJECT MANAGER	DATE	DESIGNED BY
PROJECT ENGINEER	DATE	DRAWN BY
		CHECKED BY
		DATE

KPG
PSOMAS
Seattle
3131 Elliott Avenue, Suite 400
Seattle, WA 98121 206.286.1640
Tacoma | Wenatchee | KPG.com

**30% REVIEW
SUBMITTAL**



**CITY OF MERCER ISLAND
AUBREY DAVIS PARK
TRAIL SAFETY IMPROVEMENTS**

TRAIL IMPROVEMENT PLANS
STA 0+00 TO STA 9+00
KPG PROJECT No. 21098 SHT 8 OF 14

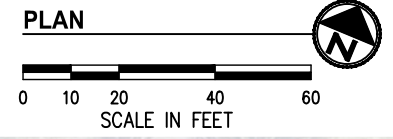
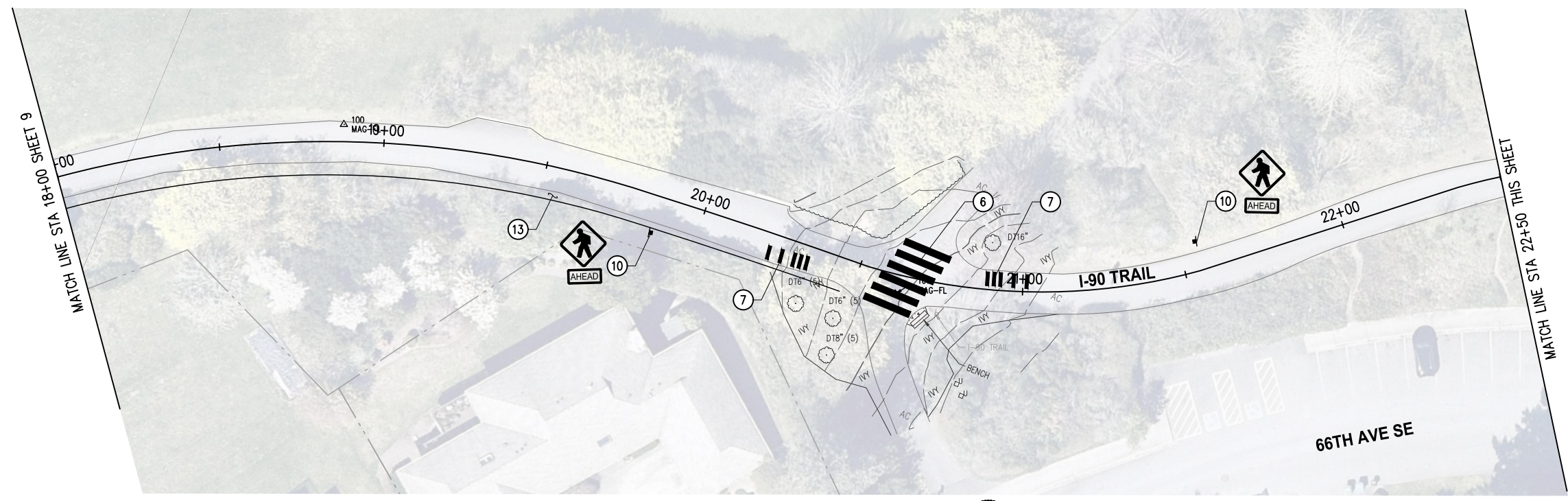

GENERAL NOTES

1. CONTRACTOR SHALL SEQUENCE REMOVAL OF EXISTING FEATURES WITH CONSTRUCTION OF NEW ROADWAY ELEMENTS TO MINIMIZE IMPACTS TO PROPERTY OWNERS, TRAIL USERS, TRAFFIC FLOW, AND THE ENVIRONMENT.
2. CONTRACTOR SHALL PROVIDE AND MAINTAIN TEMPORARY PEDESTRIAN ROUTE AROUND CONSTRUCTION ACTIVITY FOR THE DURATION OF CONSTRUCTION.

CONSTRUCTION NOTES

5. INSTALL HMA CL 1/2" PG58H-22 FOR WALKWAY. SEE TYPICAL SECTIONS, SHEET 14.
6. INSTALL THERMOPLASTIC CROSSWALK PER DETAIL, SHEET 14.
7. INSTALL THERMOPLASTIC BAR PER DETAIL, SHEET 14.
10. INSTALL REGULATORY SIGN.
11. INSTALL WAYFINDING SIGN.
12. RESTORE TRAIL SHOULDER, SHEET 14.
13. LAWN RESTORATION.
16. REMOVE BOLLARDS WITHIN PAVEMENT LIMITS.

NOTE: REGULATORY SIGNS SHOWN ARE PLACE HOLDERS, CONTENT TO BE CONFIRMED BY 60% SUBMITTAL

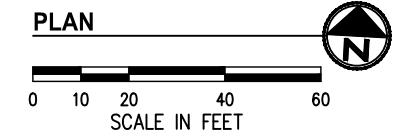
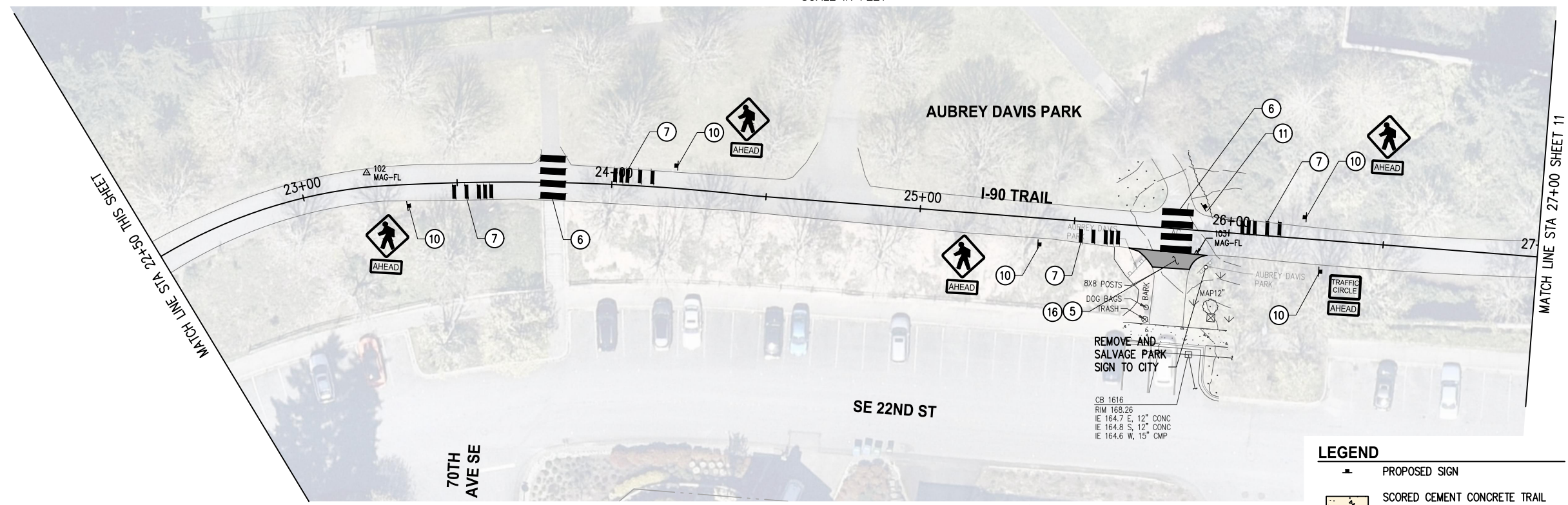

LEGEND

- PROPOSED SIGN
- SCORED CEMENT CONCRETE TRAIL WITH DECORATIVE COLOR TREATMENT
- HMA TRAIL OR PAVEMENT
- DETECTABLE WARNING SURFACE
- CEMENT CONCRETE TRAIL

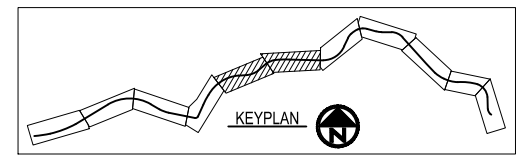

ECTS\MERCER IS\21098-Aubrey Davis Park Improvements\DESIGN\Drawings\Contract\21098TRAIL.dwg 9/1/2022 5:24 PM

NO.	DATE	BY	APPR.	REVISIONS

Approved By		21098TRAIL.dwg
ENGINEERING MANAGER	DATE	FILENAME
DESIGNED BY	DATE	
PROJECT MANAGER	DATE	DRAWN BY
DRAWN BY	DATE	
PROJECT ENGINEER	DATE	CHECKED BY
CHECKED BY	DATE	

KPG
PSOMAS
Seattle
3131 Elliott Avenue, Suite 400
Seattle, WA 98121 206.286.1640
Tacoma | Wenatchee | KPG.com

30% REVIEW SUBMITTAL



**CITY OF MERCER ISLAND
AUBREY DAVIS PARK
TRAIL SAFETY IMPROVEMENTS**

TRAIL IMPROVEMENT PLANS
STA 18+00 TO STA 27+00
KPG PROJECT No. 21098 SHT 10 OF 14

GENERAL NOTES

- CONTRACTOR SHALL SEQUENCE REMOVAL OF EXISTING FEATURES WITH CONSTRUCTION OF NEW ROADWAY ELEMENTS TO MINIMIZE IMPACTS TO PROPERTY OWNERS, TRAIL USERS, TRAFFIC FLOW, AND THE ENVIRONMENT.
- CONTRACTOR SHALL PROVIDE AND MAINTAIN TEMPORARY PEDESTRIAN ROUTE AROUND CONSTRUCTION ACTIVITY FOR THE DURATION OF CONSTRUCTION.

CONSTRUCTION NOTES

- MATCH EXISTING.
- CONSTRUCT CEMENT CONC SIDEWALK. SEE TYPICAL SECTION, SHEET 14.
- INSTALL HMA CL 1/2" PG58H-22 FOR WALKWAY. SEE TYPICAL SECTIONS, SHEET 14.
- INSTALL THERMOPLASTIC BAR PER DETAIL, SHEET 14.
- INSTALL DECORATIVE SCORED CEMENT CONCRETE PLAZA.
- INSTALL 4" WIDE, YELLOW, PAINT LINE.
- INSTALL REGULATORY SIGN.
- REMOVE BOLLARDS WITHIN PAVEMENT LIMITS.
- INSTALL LOW FENCING.
- GRASS PLANTING AREA

NOTE: REGULATORY SIGNS SHOWN ARE PLACE HOLDERS, CONTENT TO BE CONFIRMED BY 60% SUBMITTAL

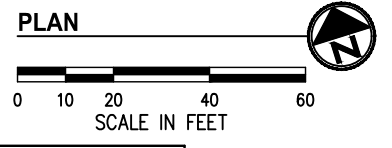
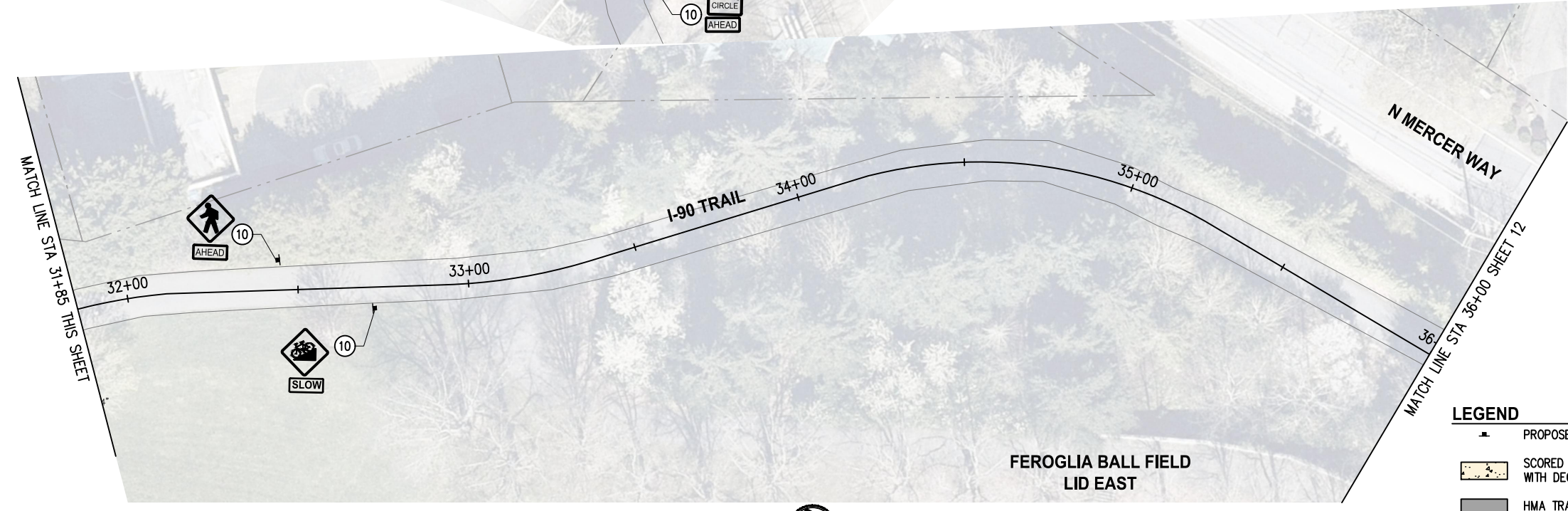
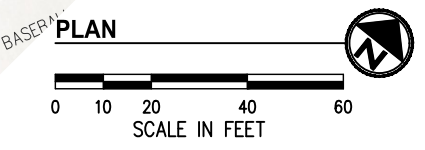
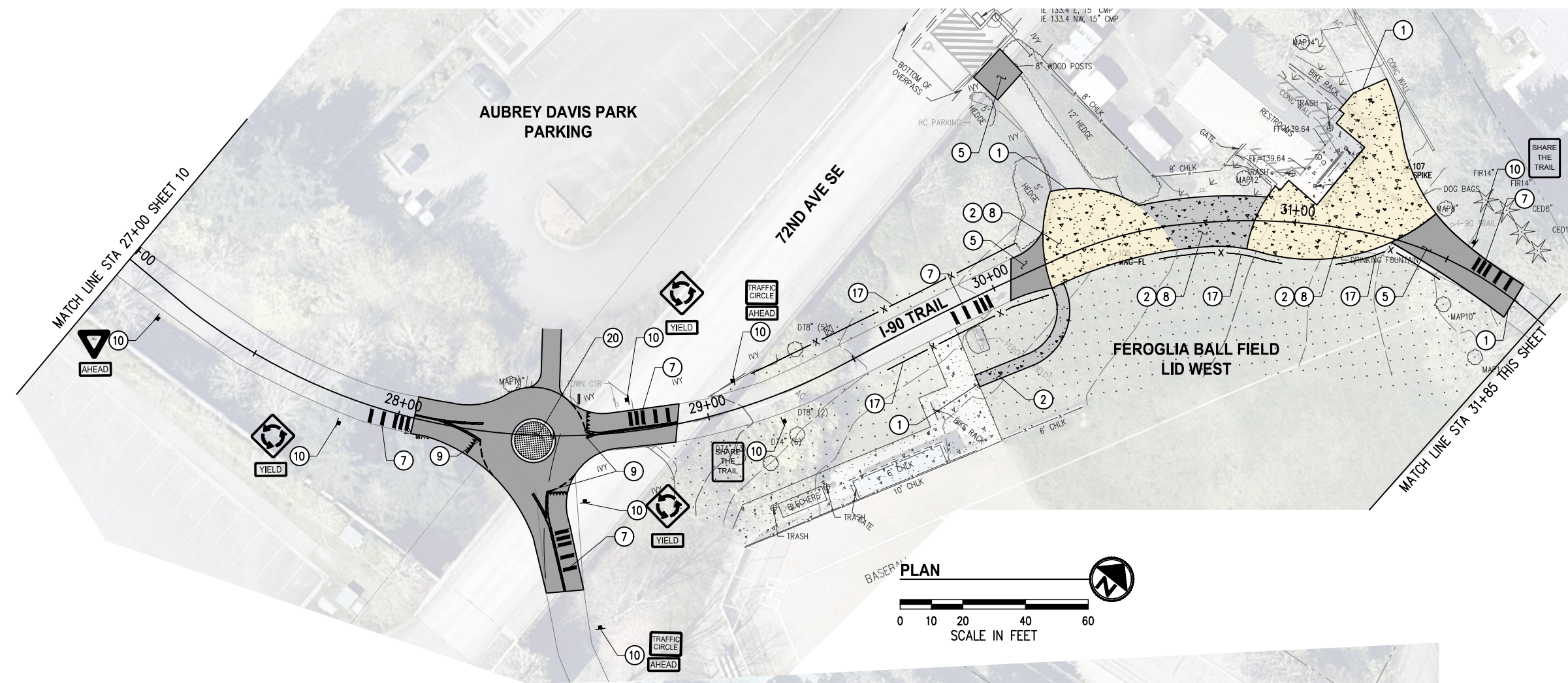

LEGEND

- PROPOSED SIGN
- SCORED CEMENT CONCRETE TRAIL WITH DECORATIVE COLOR TREATMENT
- HMA TRAIL OR PAVEMENT
- DETECTABLE WARNING SURFACE
- CEMENT CONCRETE TRAIL

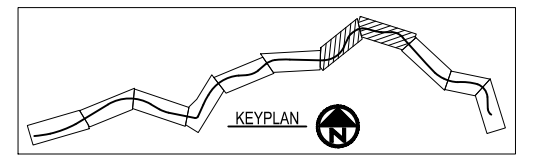

ECTS\MERCER IS\21098-Aubrey Davis Park Improvements\DESIGN\Drawings\Contract\21098TRAIL.dwg 9/1/2022 5:04 PM

NO.	DATE	BY	APPR.	REVISIONS

Approved By		21098TRAIL.dwg
ENGINEERING MANAGER	DATE	FILENAME
PROJECT MANAGER	DATE	DESIGNED BY
PROJECT ENGINEER	DATE	DRAWN BY
		CHECKED BY
		DATE

KPG
PSOMAS
Seattle
3131 Elliott Avenue, Suite 400
Seattle, WA 98121 206.286.1640
Tacoma | Wenatchee | KPG.com

30% REVIEW SUBMITTAL



**CITY OF MERCER ISLAND
AUBREY DAVIS PARK
TRAIL SAFETY IMPROVEMENTS**

**TRAIL IMPROVEMENT PLANS
STA 27+00 TO STA 36+00**
KPG PROJECT No. 21098 SHT 11 OF 14

GENERAL NOTES

1. CONTRACTOR SHALL SEQUENCE REMOVAL OF EXISTING FEATURES WITH CONSTRUCTION OF NEW ROADWAY ELEMENTS TO MINIMIZE IMPACTS TO PROPERTY OWNERS, TRAIL USERS, TRAFFIC FLOW, AND THE ENVIRONMENT.
2. CONTRACTOR SHALL PROVIDE AND MAINTAIN TEMPORARY PEDESTRIAN ROUTE AROUND CONSTRUCTION ACTIVITY FOR THE DURATION OF CONSTRUCTION.

CONSTRUCTION NOTES

10. INSTALL REGULATORY SIGN.
19. LOCATE EXISTING TRAIL CONNECTION. EXISTING VEGETATION SHALL BE TRIMMED, PRUNED, OR CLEARED FOR SIGHT DISTANCES ON I-90 TRAIL PER DIRECTION OF ENGINEER.

NOTE: REGULATORY SIGNS SHOWN ARE PLACE HOLDERS, CONTENT TO BE CONFIRMED BY 60% SUBMITTAL

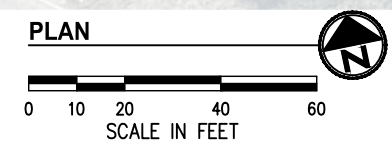
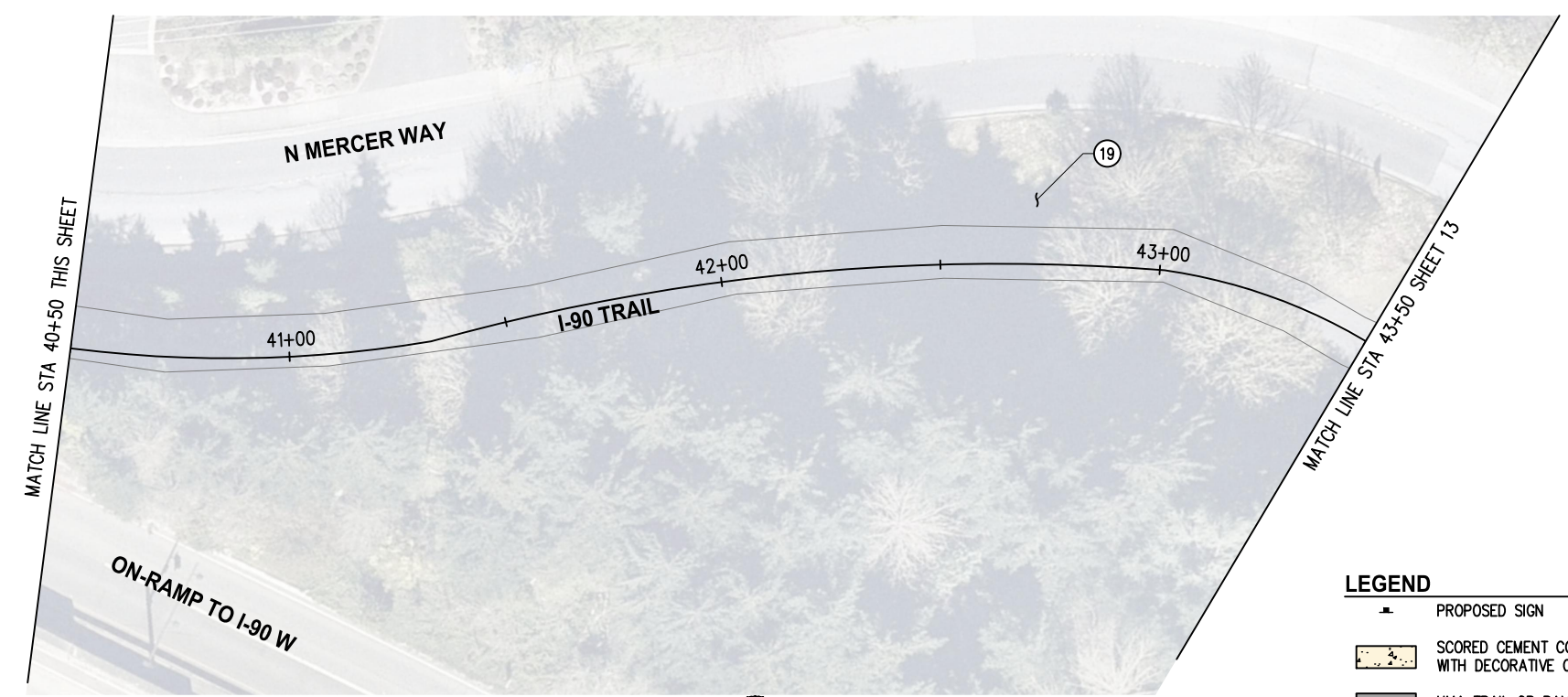
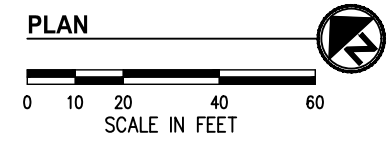
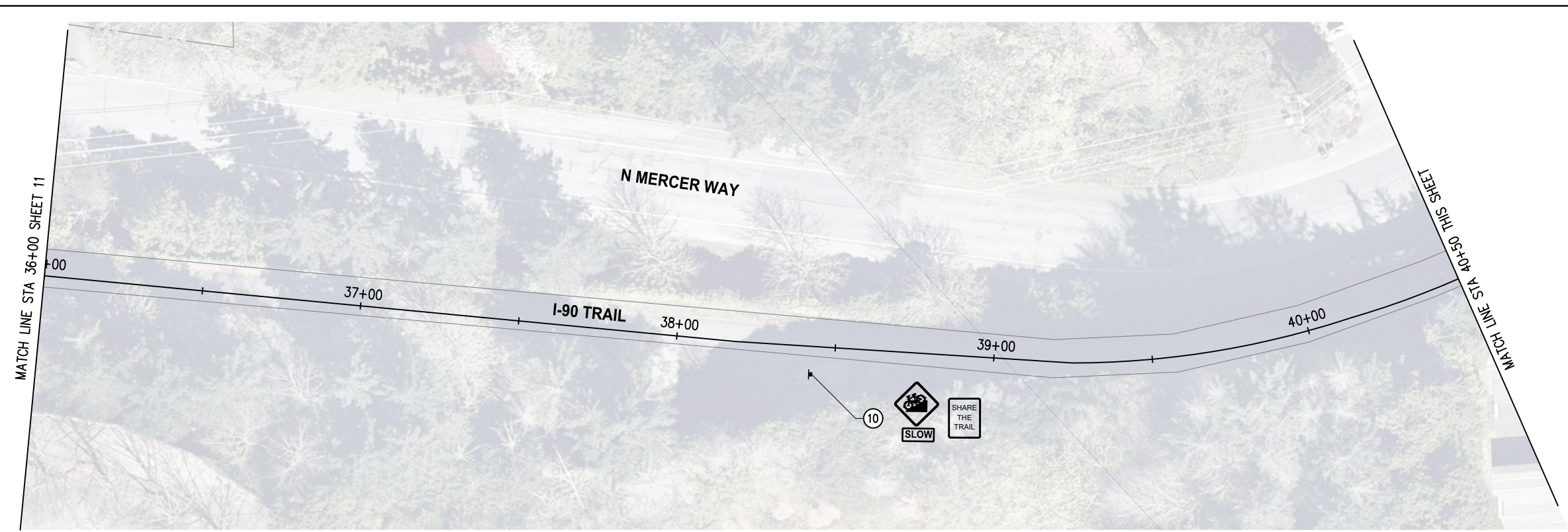

LEGEND

- PROPOSED SIGN
- SCORED CEMENT CONCRETE TRAIL WITH DECORATIVE COLOR TREATMENT
- HMA TRAIL OR PAVEMENT
- DETECTABLE WARNING SURFACE
- CEMENT CONCRETE TRAIL

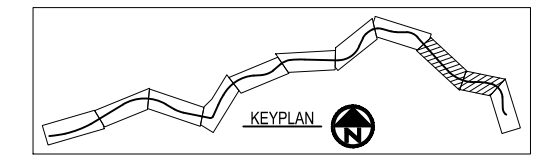

ECTS\MERCER IS\21098-Aubrey Davis Park Improvements\DESIGN\Drawings\Contract\21098TRAIL.dwg 9/1/2022 5:04 PM

NO.	DATE	BY	APPR.	REVISIONS

Approved By		21098TRAIL.dwg FILENAME	
ENGINEERING MANAGER	DATE	DESIGNED BY	DATE
PROJECT MANAGER	DATE	DRAWN BY	DATE
PROJECT ENGINEER	DATE	CHECKED BY	DATE

KPG
PSOMAS
Seattle
3131 Elliott Avenue, Suite 400
Seattle, WA 98121 206.286.1640
Tacoma | Wenatchee | KPG.com

**30% REVIEW
SUBMITTAL**



**CITY OF MERCER ISLAND
AUBREY DAVIS PARK
TRAIL SAFETY IMPROVEMENTS**

TRAIL IMPROVEMENT PLANS STA 36+00 TO STA 43+50	
KPG PROJECT No. 21098	SHT 12 OF 14

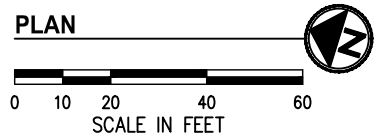
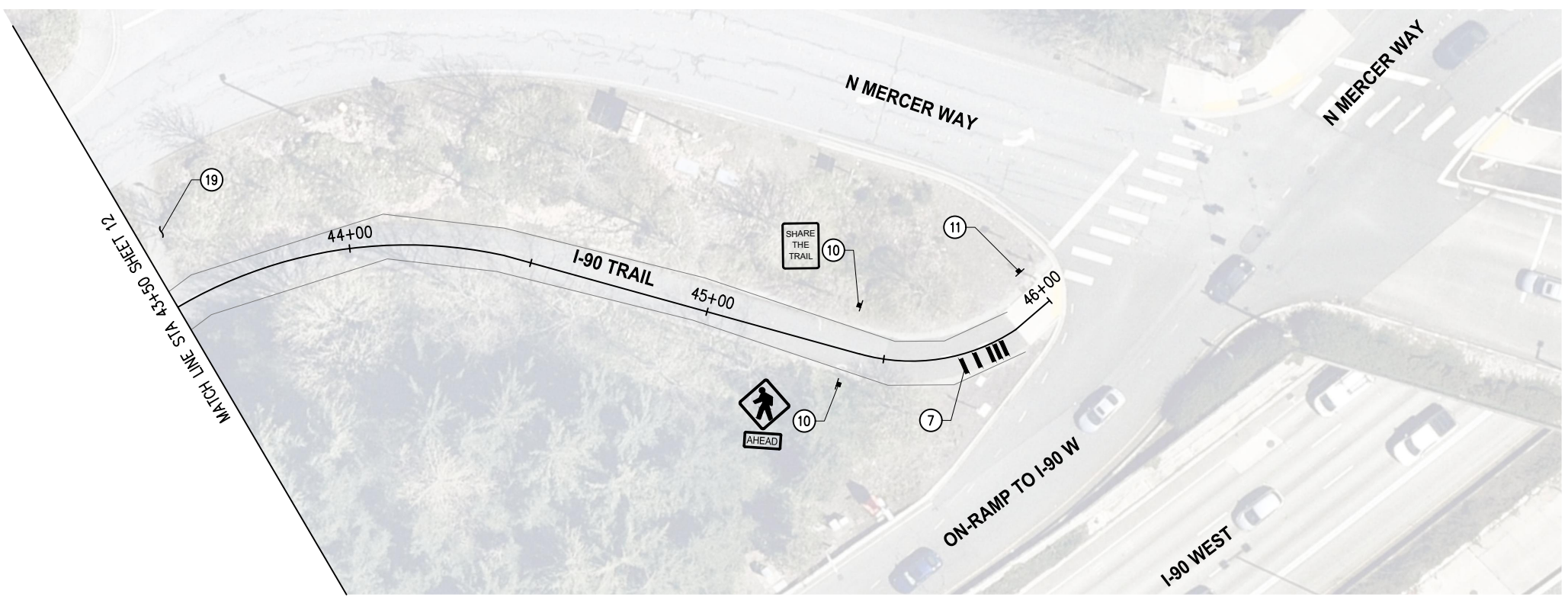

GENERAL NOTES

1. CONTRACTOR SHALL SEQUENCE REMOVAL OF EXISTING FEATURES WITH CONSTRUCTION OF NEW ROADWAY ELEMENTS TO MINIMIZE IMPACTS TO PROPERTY OWNERS, TRAIL USERS, TRAFFIC FLOW, AND THE ENVIRONMENT.
2. CONTRACTOR SHALL PROVIDE AND MAINTAIN TEMPORARY PEDESTRIAN ROUTE AROUND CONSTRUCTION ACTIVITY FOR THE DURATION OF CONSTRUCTION.

CONSTRUCTION NOTES

7. INSTALL THERMOPLASTIC BAR PER DETAIL, SHEET 14.
10. INSTALL REGULATORY SIGN.
11. INSTALL WAYFINDING SIGN.
19. LOCATE EXISTING TRAIL CONNECTION. EXISTING VEGETATION SHALL BE TRIMMED, PRUNED, OR CLEARED FOR SIGHT DISTANCES ON I-90 TRAIL PER DIRECTION OF ENGINEER.

NOTE: REGULATORY SIGNS SHOWN ARE PLACE HOLDERS, CONTENT TO BE CONFIRMED BY 60% SUBMITTAL

LEGEND

- PROPOSED SIGN
- SCORED CEMENT CONCRETE TRAIL WITH DECORATIVE COLOR TREATMENT
- HMA TRAIL OR PAVEMENT
- DETECTABLE WARNING SURFACE
- CEMENT CONCRETE TRAIL

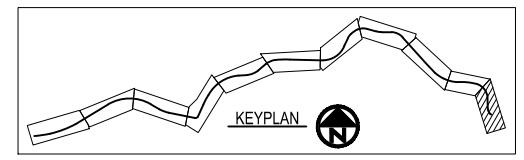

ECTS\MERCER IS\21098-Aubrey Davis Park Improvements\DESIGN\Drawings\Contract\21098TRAIL.dwg 9/1/2022 5:04 PM

NO.	DATE	BY	APPR.	REVISIONS

Approved By		21098TRAIL.dwg FILENAME	
ENGINEERING MANAGER	DATE	DESIGNED BY	DATE
PROJECT MANAGER	DATE	DRAWN BY	DATE
PROJECT ENGINEER	DATE	CHECKED BY	DATE

KPG
PSOMAS
Seattle
3131 Elliott Avenue, Suite 400
Seattle, WA 98121 206.286.1640
Tacoma | Wenatchee | KPG.com

**30% REVIEW
SUBMITTAL**



**CITY OF MERCER ISLAND
AUBREY DAVIS PARK
TRAIL SAFETY IMPROVEMENTS**

TRAIL IMPROVEMENT PLANS STA 43+50 TO STA 46+00	
KPG PROJECT No. 21098	SHT <u>13</u> OF <u>14</u>

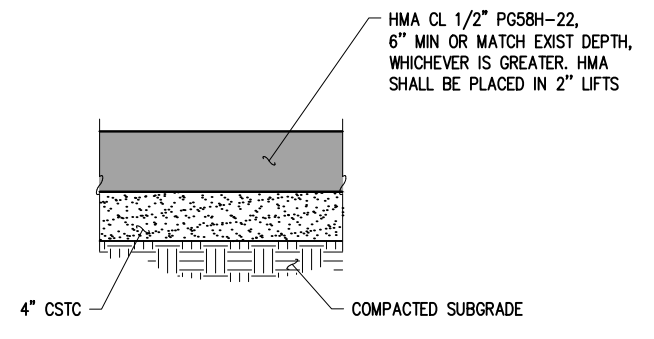

HMA ROADWAY PAVEMENT SECTIONS
NTS

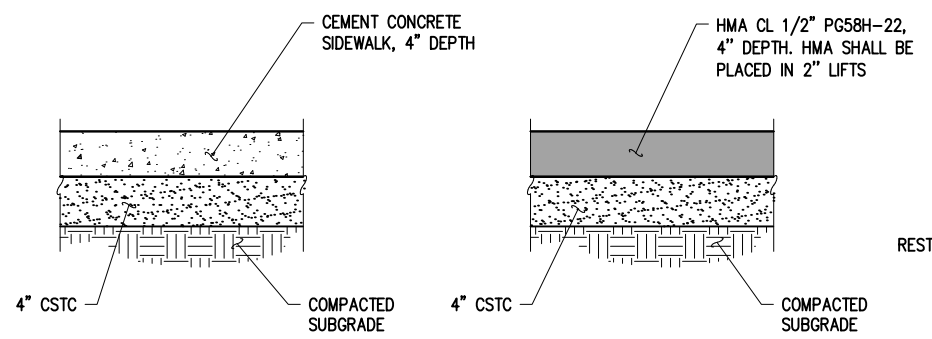

TYPICAL TRAIL SECTIONS
NTS

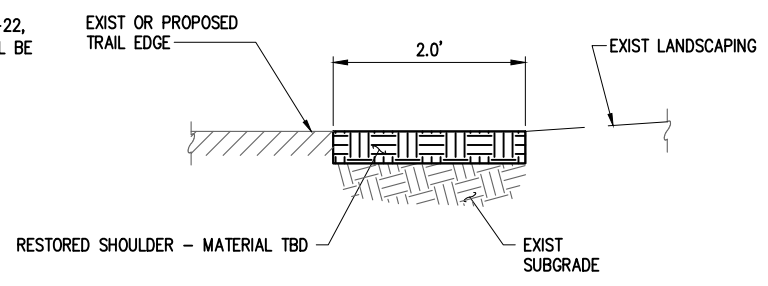

INSTALL WHERE SHOWN ON PLANS
RESTORED SHOULDER SECTION
NTS

TYPICAL SECTION GENERAL NOTES

1. SIDEWALKS SHALL PROVIDE A MINIMUM OF 5.0' CLEAR PEDESTRIAN WALKING ZONE.
2. SUBGRADE PREPARATION SHALL BE IN ACCORDANCE WITH SECTION 2-06 OF THE STANDARD SPECIFICATIONS.
3. ADDITIONAL FILL MATERIAL REQUIRED FOR CONSTRUCTION SHALL BE APPROVED CRUSHED ROCK WHEN REQUIRED BY ENGINEER. FILL MATERIAL SHALL BE COMPACTED TO 95% MODIFIED PROCTOR DENSITY.
4. EMBANKMENTS SHALL BE CONSTRUCTED PER SECTION 2-03 OF THE STANDARD SPECIFICATIONS.
5. IF UNSUITABLE FOUNDATION IS ENCOUNTERED, THE CONTRACTOR SHALL CAREFULLY OVER EXCAVATE TO A MAXIMUM DEPTH OF 1.0' AND REPLACE WITH CRUSHED ROCK AS DIRECTED BY ENGINEER.
6. WHERE EXISTING EDGE OF PAVEMENT IS LESS THAN 2.0' FROM PROPOSED GUTTER PAN, CONTRACTOR SHALL SAWCUT AND REMOVE PAVEMENT AS REQUIRED TO PROVIDE 2.0' MINIMUM CLEARANCE.
7. MAXIMUM COMPACTED HMA LIFT THICKNESS SHALL NOT EXCEED 0.17'.
8. ACCESS TO ADJACENT PROPERTY MUST BE MAINTAINED AT ALL TIMES UNLESS PRIOR ARRANGEMENTS HAVE BEEN MADE AND APPROVED BY ENGINEER.
9. ALL PAVEMENT SHALL BE CUT BY SAW CUTTING FULL DEPTH IN A NEAT VERTICAL LINE PRIOR TO REMOVING. ANY DAMAGE TO ADJACENT PAVEMENT SHALL BE REPAIRED BY THE CONTRACTOR AT NO EXPENSE TO THE OWNER.



SCORED CONCRETE EXAMPLE



SANDBLASTED CONCRETE EXAMPLE



SAWCUT CONCRETE EXAMPLE

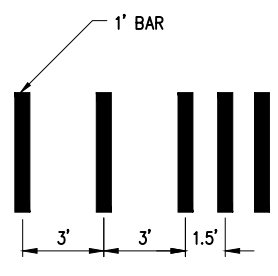

THERMOPLASTIC BARS
NTS

ECTS\MERCER IS\21098-Aubrey Davis Park Improvements\DESIGN\Drawings\Contract\21098TRAIL-DET.dwg 9/1/2022 5:04 PM

NO.	DATE	BY	APPR.	REVISIONS

Approved By		21098TRAIL-DET.dwg
ENGINEERING MANAGER	DATE	DESIGNED BY
PROJECT MANAGER	DATE	DRAWN BY
PROJECT ENGINEER	DATE	CHECKED BY

KPG
PSOMAS

Seattle
3131 Elliott Avenue, Suite 400
Seattle, WA 98121 206.286.1640
Tacoma | Wenatchee | KPG.com

30% REVIEW SUBMITTAL



CITY OF MERCER ISLAND
AUBREY DAVIS PARK
TRAIL SAFETY IMPROVEMENTS

TRAIL IMPROVEMENT DETAILS	
KPG PROJECT No. 21098	SHT 14 OF 14

From: Callie Ridolfi <callieridolfi@gmail.com>
Sent: Wednesday, September 21, 2022 3:31 PM
To: Parks & Rec Commission
Subject: I-90 Trail - please design it for safe bicycling

Commissioners,

As a user of the I-90 trail as a biker and a walker, I oppose the dangerous raised planter bed with a curb in the roundabout at the bottom of the hill near the tennis courts. Please consider that during the fall/winter months, many commuters are using the trail in the dark hours. As I understand it, the trail is a WSDOT shared use trail. Therefore, I respectfully request that you remove this planter bed/obstacle which may likely cause a biker to fall and be injured. Thank you for the opportunity to provide input on the 30% design.

Callie Ridolfi
3432 72nd Avenue SE
206-403-8188

Date: 9/21/22

Subject: 30% design recommendation to improve safety on the I-90 trail portion that runs from West Mercer across the lid and past the ball fields to North Mercer Way

To: Parks and Recreation Commission

I oppose one dangerous element in the design: a raised planter bed with a curb in the middle of a roundabout at the bottom of the hill passing the tennis courts. The raised bed is in a dark, unlit, shaded area with short sightlines which could easily cause a cyclist to fall.

Kind regards,

José Oncina
+1 206 229 2380

Parks & Recreation Commission

2022 Planning Schedule



1st Thursday of Month- Regular Meetings

Updated: Sept. 12, 2022

Meeting Date	Meeting Type	Agenda Item
6-Jan	Regular	Policy: Special Events Policy Considerations
		PROS: Confirm Recommendation/Handoff memo
		Luther Burbank Docks 30% Design- First Reading
18-Jan	Joint w/ City Council	Parks, Recreation, and Open Space Plan: Handoff to Council
3-Feb	Regular	Luther Burbank Docks 30% Design- 2nd Reading
		Policy: Special Events Policy Considerations (cont.)
		Summary of 2021 ARPA deferred planter bed maintenance
3-Mar	Regular	Mercer Island Library- Annual Update
		Policy: Special Events Policy Considerations (cont.)
7-Apr	Regular	First Reading: Aubrey Davis Trail Safety Improvements 30% Design
		KCLS Presentation Review (Discussion)
Apr. 26	Special	Bike Skills Area
5-May	Regular	Policy: Athletic Field Use & Allocation
		2021 Year-End Review/ 2022 Service Update (Moved from March)
2-Jun	Joint w/ AC & Regular Meeting	Aubrey Davis Trail Safety Improvements 30% Design
		Recreation Division Annual Report
		Recreation Division 2022 Services Update
		Bike Skills Area- cont.
7-Jul	Regular	Chair/Vice-Chair Elections
		Aubrey Davis Trail Safety Improvements 30% Design
		Bike Skills Area-cont.
		Bylaws Review
		Donation/Memorials/Recognitions and Naming Rights (policy)
August	No Meetings Summer Break	
1-Sep	Regular	Aubrey Davis Trail Safety Improvement Project 30% Design Revisions
		Public Art Project: Aubrey Davis Park Stacks
		Bike Skills Area Project-Update
		2023/2024 Parks & Recreation Proposed Services
		Donation/Memorials/Recognitions and Naming Rights (policy)
6-Oct	Regular	Donation/Memorials/Recognitions and Naming Rights(policy)
		Aubrey Davis Trail Safety Improvement Project 30% Design Revisions
		MISD Interlocal Agreement
3-Nov	Regular	Donation/Memorials/Recognitions and Naming Rights (policy)
		Recreation Services Scholarship (policy)

		2023/2024 Proposed Services (Memo)
1-Dec	Regular	Check-in update: Facility Allocation and Use Policy
		PRC Year in Review
		2023 PRC Planning Schedule/ Work Plan

Item Type	Items to be scheduled
Policy	Park Code/Rules Updates- signage in parks, appropriate uses of space, etc. (Q4)
Project	Luther Docks Project (TBD)
Other	(various) Master Plan completion updates (Q4)
Annual Agenda Items	
	KCLS- Mercer Island Branch Operations Update (March)
	PROS Plan Goals/Implementation Update (May)
	Annual PRC Chair/Vice-Chair Elections (May)
	PROS Plan Goals/Implementation Update (June)
	Annual Bylaws Review (July)
	Various CIP Recommendations (TBD)