



PARKS & RECREATION COMMISSION REGULAR VIDEO MEETING

Thursday, April 7, 2022 at 5:30 PM

BOARD MEMBERS:

Chair Jodi McCarthy
Vice Chair Peter Struck
Board Members: Don Cohen,
Sara Berkenwald, Paul Burstein,
Sara Marxen, Rory Westberg

LOCATION & CONTACT

Zoom Meeting
Phone: 206.275.7626 | www.mercerisland.gov

In compliance with the Americans with Disabilities Act, those requiring accommodation for meetings should notify the Staff Liaison at least 24 hours prior to the meeting at 206.275.7706.

Virtual Meeting Notice

The virtual meeting will be broadcast live on Zoom and recorded and saved on the City Council's [YouTube Channel](#)

Registering to Speak: Individuals wishing to speak live during Appearances will need to register their request with the staff liaison at **206.275.7870** or [email](#) and leave a message before 4 PM on the day of the Commission meeting. Please reference "Appearances" on your correspondence. Each speaker will be allowed three (3) minutes to speak.

Join by Telephone at 5:30 PM: To listen to the meeting via telephone, please call **253.215.8782** and enter Webinar ID **825 9108 6996** and Password **896196** when prompted.

Join by Internet at 5:30 PM: To watch the meeting over the internet via your computer, follow these steps:

- 1) Click [this link](#)
- 2) If the Zoom app is not installed on your computer, you will be prompted to download it.
- 3) If prompted for Webinar ID, enter **825 9108 6996** and Password **896196**

CALL TO ORDER & ROLL CALL - 5:30 PM

PUBLIC APPEARANCES

DEPARTMENT REPORT

REGULAR BUSINESS [HYPERLINK "appIS80d34e03b253455db0ca10b38419e40a"](#)

1. [Approve the minutes of the March 3, 2022 Regular Meeting](#)
Recommended Action: [Approve minutes](#)
2. [Aubrey Davis Park Trail Safety Improvements – Public Engagement and Design Input](#)
Recommended Action: [Receive presentation, discuss design option](#)
3. [King County Library System- Presentation Review](#)
Recommended Action: [Discuss presentation and provide consensus on follow up questions to KCLS and inform on next steps.](#)

OTHER BUSINESS

4. [PRC 2022 Planning Schedule Update](#)
5. [Commissioner Reports](#)

ADJOURN

Mercer Island Parks & Recreation Commission

Item 1.



Department Report

April 7, 2022

PRC Special Meeting: Bike Skills Area April 26, 2022- 5:30pm

- The Community is encouraged to provide public testimony on the assessment at this meeting to help inform next steps.
- The Commission will review the final report and provide input.
- The final report from Action Sports Design will be posted to Let's Talk for the community to review and also directly to the PRC.

[Letstalk.mercergov.org/bike-skills-area-at-upper-luther-burbank-park](https://letstalk.mercergov.org/bike-skills-area-at-upper-luther-burbank-park)



Mercerdale Playground Update

- Play surface installation needs several days of warmer, dry weather. We were close, but not quite!
- We're crossing our fingers for the perfect combination of warm temperatures and no rain to install the play surface. A week after that work is complete, the playground grass will be installed.
- We anticipate the **concrete flatwork** around the playground will be installed April 19.
- Meanwhile, the plaques for the park benches have arrived and will be installed.
- Visit the project page for information and photos of the installed playground <https://letstalk.mercergov.org/mercerdale-playground>



Boards and Commissions Openings

- Recruitments are open for the following positions:
 - Arts Council (1 position; term expires May 31, 2026)
 - Design Commission (1 position; urban planners are encouraged to apply and will be given priority; term expires May 31, 2026)
 - Open Space Conservancy Trust (2 positions, terms expire May 31, 2026)
 - Parks & Recreation Commission (2 positions, terms expire May 31, 2026)
 - Planning Commission (2 positions; terms expire May 31, 2026)
 - Utility Board (2 positions; terms expire May 31, 2026)
- Apply today! Applications for these vacancies will be taken through May 4, 2022.
- Visit www.mercerisland.gov/bc to apply.



Kirk Robinson Skate Park



- On Tuesday night the City Council voted to pass Resolution No. 1622. This recognized resident Kirk Robinson’s contributions to the Mercer Island Community and renames the skate park at Mercerdale to the “**Kirk Robinson Skate Park**”.
- Kirk graduated from MIHS in 1995 and had community service as a central focus of his life.
- After college Kirk became a Bothell Firefighter and continued his public service- helping tirelessly in whatever he could.
- Kirk was Mercer Island resident, volunteer firefighter, marine Patrol crew member, and Parks and Recreation Commissioner, passing away on October 4, 2019.
- Kirk touched many lives, and the “Kirk Robinson Skate Park” will serve as a lasting tribute to his legacy.
- Signage will be installed this spring, and a recognition event will follow.
- Please review the April 5 ,City Council for more details on Kirks amazing life and contributions.



The Return of Summer Celebration!

- Mark your calendars **Summer Celebration!** returns to Mercer Island on **Saturday, July 9.**
- Staff are working with the community on multiple events throughout the day in Mercerdale and Luther Burbank Parks, including:
 - Live music
 - Merchant Walk
 - Food Trucks
 - MIVAL Art Show
 - Fireworks
 - And more!
- Stay up-to-date with the latest Summer Celebration! information at www.mercerisland.gov/summercelebration

Supporting Summer Celebration!

- Event sponsorship opportunities are available to businesses, organizations, and individuals including these opportunities:
 - Presenting (\$20,000)
 - Site (\$10,000)
 - Entertainment (\$5,000)
 - Supporter (\$2,500-1,000)
- More information about sponsoring Summer Celebration! can be found at www.mercerisland.gov/summercelebration



MIPA Circus is Back!

- The City is partnering with the Mercer Island Preschool Association to host their annual Circus.
- Mark your calendars for **Saturday, April 30** from 10am-2pm at the MICEC.
- For more information and to purchase tickets visit: <https://mipreschoolassociation.membershiptoolkit.com/circus>



Spring Cleaning Underway

- Crews are pressure washing hard surfaces including tennis courts.
 - Luther Burbank tennis court, pictured, is in rough shape and must be cleaned carefully.
 - We do have a capital project in the queue to resurface the courts in the future.
- Planter beds, particularly around parks signs are being cleaned up and replanted.
- Fertilizing and other turf maintenance (seeding, sanding etc.) is ongoing on sports fields.

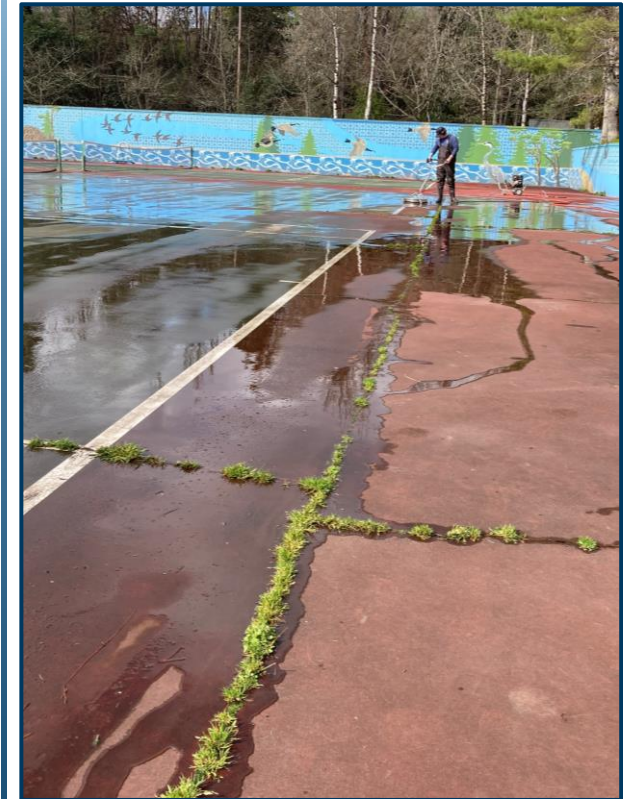

Community Center

- Rental tours and requests continue to flow in. Marketing efforts have been focused at the community level and toward mid-week corporate usages.
- Today we hosted a rental that included a photo and video shoot occupying much of the facility.
 - This was a large-scale production and highlights the diverse opportunities our facility can host.
- In May we are currently scheduled for 13 large scale private events. This is a great start to our full-scale operations.

Current hours:

M-Th: 10am-7pm

Fri/Sat: 10am -5pm



Thank You!





PARKS & RECREATION COMMISSION REGULAR MEETING MINUTES March 3, 2022

CALL TO ORDER

Chair McCarthy called the meeting to order at 5:30 pm via Zoom Online meeting.

ROLL CALL

Commissioners Don Cohen, Jodi McCarthy, Rory Westberg, Sara Marxen, Sara Berkenwald, Paul Burstein and Peter Struck were present.

Councilmember Craig Reynolds was present.

Emily Moon, Consultant, was present.

King County Library System staff Lisa Rosenblum, Executive Director, and Angie Miraflor, Deputy Director for Public Services, were present

Staff present were Ryan Daly, Katie Herzog and Raven Gillis.

APPEARANCES

1. Meg Lippert provided input on the Mercer Island Library.
2. Ira Appleman provided input on the Mercer Island Library.
3. Sue Stewart provided input on the Special Event policy, and the Bike Skills Area.
4. Robin Russell provided input on the Mercer Island Library.
5. Anthony Hargreaves provided input on the Bike Skills Area.
6. Rachel Holloway provided input on the Bike Skills Area.
7. Ronan Holloway-Lamb provided input on the Bike Skills Area.

DEPARTMENT REPORT

Ryan Daly presented. Vice Chair Struck was invited to provide the Commissioners with updates on the City Council meeting's approval of the Luther Burbank Docks 30% design.

REGULAR BUSINESS

1. Approval of Minutes

Minutes from the February 3, 2022 Regular Meeting were presented.

Staff noted the minutes will be updated to show Commissioner Berkenwald attended the meeting.

MOTION:

Cohen moved to amend the minutes for the discussion related to the Luther Burbank Docks 30% Design to "The Commission engaged in discussion. This included, among other things, the timing of recommending the 30% design to Council prior to resolution of certain issues on which staff would be working with a specialized consultant and requested the hand-off memo include further

explanation on the purpose of the mats at Cobble Beach, passive recreation, and what constitutes a small power boat.”

Motion passed unanimously

2. Mercer Island Library – Annual Update

King County Library System staff Lisa Rosenblum, Executive Director, and Angie Mirafior, Deputy Director for Public Services, presented. Commissioners asked questions and engaged in discussion with much of the discussion focused on the scheduling of operating hours, as well as community engagement.

3. Endorsement of Special Events Sponsorship Policy and Other Special Events Recommendations

Katie Herzog and Emily Moon presented.

Chair McCarthy was dropped from the meeting at 6:50pm due to technical difficulties with her computer. Vice Chair Struck resumed meeting.

MOTION:

Westberg moved to endorse the Special Events Sponsorship Policy and recommend for City Council approval. Burstein seconded the motion.

Motion passed unanimously (Chair McCarthy absent)

Herzog presented Other Special Events Recommendations. Commissioners engaged in discussion on the use of the word “endorse” when motioning to support staff’s recommendations.

MOTION:

Westberg moved to support the following Staff recommendations concerning special events and to share those recommendations with City Council.

- Continue to encourage Neighborhood Block Parties by limiting permitting requirements
- Establish a First amendment or Free Speech event notification form and related practices
- Create three categories of special events (apart from the block parties & First Amendment events)
- Codify the sponsorship program and establish that there are a finite number of City-organized and City-run special events (as delineated in the budget each year).
- Staff’s commitment to report back to the Commission and Council on the results of implementing these actions.

Chair McCarthy rejoined the meeting at 7:07pm
Chair McCarthy seconded the motion.

Motion passed unanimously

OTHER BUSINESS

4. Planning & Meeting Schedule Update

Daly presented updates to the schedule.

5. Commissioner Reports / Work Plan Update

No reports or updates

ADJOURNMENT at 7:12 PM



PARKS & RECREATION COMMISSION STAFF REPORT

Item 2
April 7, 2022
Regular Business

AGENDA ITEM INFORMATION

TITLE:	Aubrey Davis Park Trail Safety Improvement Project Public Engagement and Design Input	<input checked="" type="checkbox"/> Discussion Only
RECOMMENDED ACTION:	Receive the report on public engagement and provide the design team input on the design as presented	<input type="checkbox"/> Action Needed: <input type="checkbox"/> Motion <input type="checkbox"/> Ordinance <input type="checkbox"/> Resolution

STAFF:	Paul West, CIP Project Manager Liz Gibson, KPG Psomas Principal Phuong Nguyen, KPG Psomas
COUNCIL LIAISON:	Craig Reynolds
EXHIBITS:	1. Conceptual Design Approach 2. Public Engagement Summary

SUMMARY

BACKGROUND

Mercer Island City Council charged the PRC with developing a recommendation for the 30% design of the Aubrey Davis Trail Safety Improvements Project at its March 2, 2021 meeting. See [Agenda Bill 5819](#). The Public Works Department developed a Request for Qualifications and interviewed qualified firms with participation from the PRC chair. KPG Psomas Inc. was selected to provide design services on this project.

Design work began in Fall 2021. The Design Team developed a Conceptual Design Approach (See Exhibit 1). **Baseline Treatments**, such as pavement markings and signage would form the backbone of the improvements and be installed at several locations in the project area. In selected locations, the **Baseline Treatments** would also include redefining the mixing zones to improve traffic flow. Some of these mixing zones would receive a second level of improvements. **Placemaking Elements** would be added to communicate a change in use and cue trail users to pay attention to their surroundings.

Three critical mixing zones were identified as **Prioritized Improvement Areas** for more extensive design consideration:

1. West Mercer Way Trail Crossing
2. 72nd Ave SE Overpass
3. Restroom-Playfield Node

These three areas were the primary focus of the public engagement process led by the Design Team starting on January 31 and ending on March 17, 2022. The process gathered public input through an online Open House event, an online public survey and commentary on the [Let's Talk project page](#). Exhibit 2 summarizes the results of that process.

The PRC will consider the Design Team's recommendation on the first two **Prioritized Improvement Areas** and discuss in detail the third area between the restroom and Feroglia Fields. The Design Team hopes to receive

sufficient input from PRC so it can complete a recommended 30% design for presentation at the May 5 PRC meeting.

RECOMMENDED ACTION

Receive the Design Team's presentation and discuss the designs for the three *Prioritized Improvement Areas*. Provide input to the design team for development of a draft 30% design product.

BASELINE TREATMENTS

PLACEMAKING ELEMENTS

PRIORITIZED IMPROVEMENTS

treatment TOOL KIT

-  **Pavement Changes & Markings**
-  **Wayfinding & Signage**
-  **Sight Distance & Vegetation Management**
-  **Redefined Mixing Zones**

Provide the necessary improvements to modify user behaviors.



- Pavement Art**
Glow-in-the-dark pavement
Patterned pavement surfacing
Attention-grabbing 3D paint
- Fun Signage**
Engaging phrases
Pop art inspired
Burma-shave signs
Seasonally changed
- Sensory Play**
Kinetic
Audible
Tactile
Visual
- Distinctive Spaces**
Stamped or colored pavement treatments
Textured pavement
Artistic vertical "fencing"

Create a playful and unique park experience



Safe, Accessible, & Fun Trail Experiences



Baseline Improvement Areas



○ BASELINE IMPROVEMENT AREAS

↔ TRAIL



Baseline Treatments

PAVEMENT MARKINGS



"LOOK" crosswalk markings



Centerline delineated striping



"SLOW" crosswalk markings

WAYFINDING & SIGNAGE



Advance slow zone signage

Rules of the trail signage



Standard wayfinding signage

VEGETATION MANAGEMENT

Limbed lower tree branches



Adequate sight distance



Clear shoulders

REDEFINED MIXING ZONES



Scored pavement treatment



Low walls



Open fencing

Placemaking Elements

PAVEMENT ART



Glow-in-the-dark pavement surfacing



Patterned pavement surfacing



Attention-grabbing 3D pavement paint

FUN SIGNAGE



Eye-catching signage



Directional wayfinding



Burma-shave signage

SENSORY PLAY

Vertical dynamic screen



Kinetic moving elements



Audible wind pipes



Ephemeral light displays

DISTINCTIVE SPACES



Stamped or colored pavement treatments



Textured pavement



Artistic vertical "fencing"

OVERVIEW

The first milestone of this project is the completion of a 30% design that the Parks and Recreation Commission (PRC) recommends to the Mercer Island City Council. City Council expects PRC to develop this product with public input. The Design Team, KPG-Psomas, developed a public engagement plan to guide that process. The Design Team launched a public engagement campaign starting January 31, 2022 which included several email notifications, Let’s Talk updates, and ten information sandwich boards set outdoors around the City of Mercer Island. The various campaigning methods were used to promote public feedback and attendance to the Community Virtual Open House on February 17th at 5:30pm.

The Open House was attended by 24 participants. The discussion centered on three focus areas, including 2 alternative designs each, that were considered high priority. Polling during the meeting initiated discussions of public preferences for design elements on the project. The project page on the Let’s Talk social media platform was updated with the meeting materials and link to the online survey. Immediately after the Open House, the Design Team launched an online survey which ran until March 17, 2022. Eighty-six participants provided opinions about the design alternatives for the three focus areas.

Results from the Open House, Online Survey, and comments on Let’s Talk (LT) were collected, analyzed, and discussed internally among the Design Team and City staff. The compiled findings and feedback have been summarized below.

PUBLIC ENGAGEMENT PROFILE

There were a good mix of people of all ages contributing feedback during the Online Open House and Online Survey. Most of the public say they come to Aubrey Davis Park for general recreation (34% Open House and 50.6% Survey) as well as commute (22% Open House/9.4% Survey) and live (11% Open House/23.5% Survey) nearby.

Online Survey Responses (84 out of 85)

What is your age?

84 responses

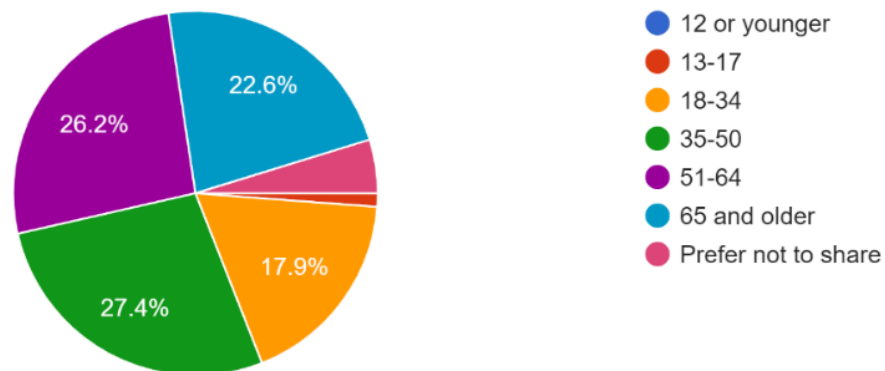

Online Survey Responses (85 out of 85)

What is your primary connection to Aubrey Davis Park?

85 responses

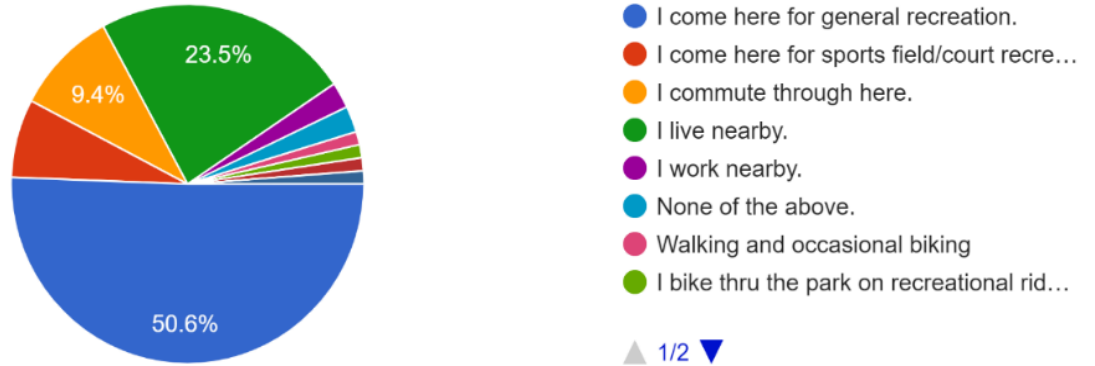

Open House Responses (8 out of 9)

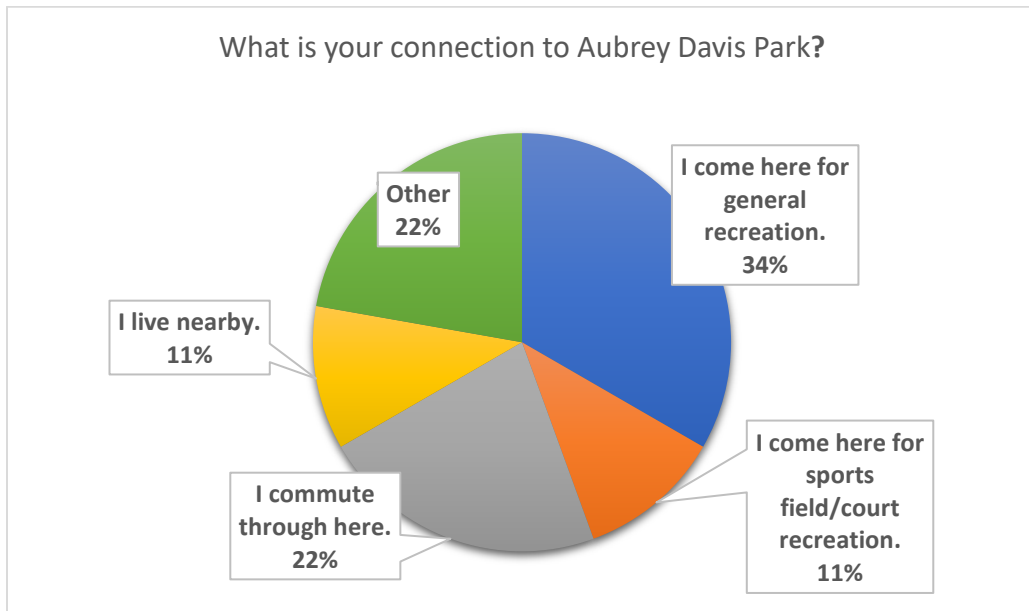

Over half of the public responded that they usually walk through the Aubrey Davis Park and Trail area (57% Open House and 75.3% Survey). Less than half usually bike through the park (43% Open House and 40% Survey).

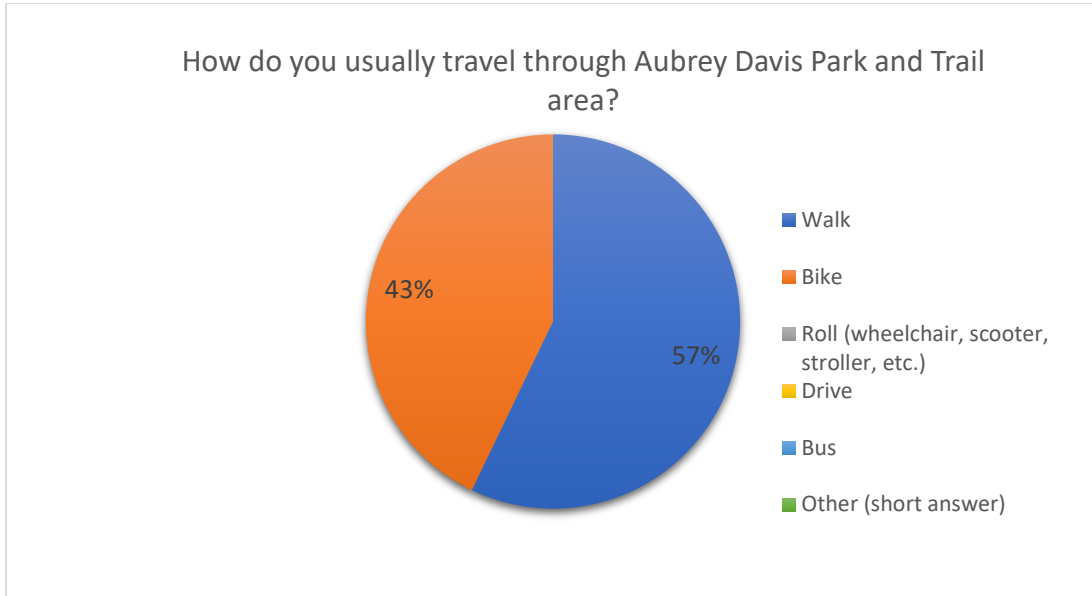

How do you usually travel through the Aubrey Davis Park and Trail area? (Select all that apply)
85 responses

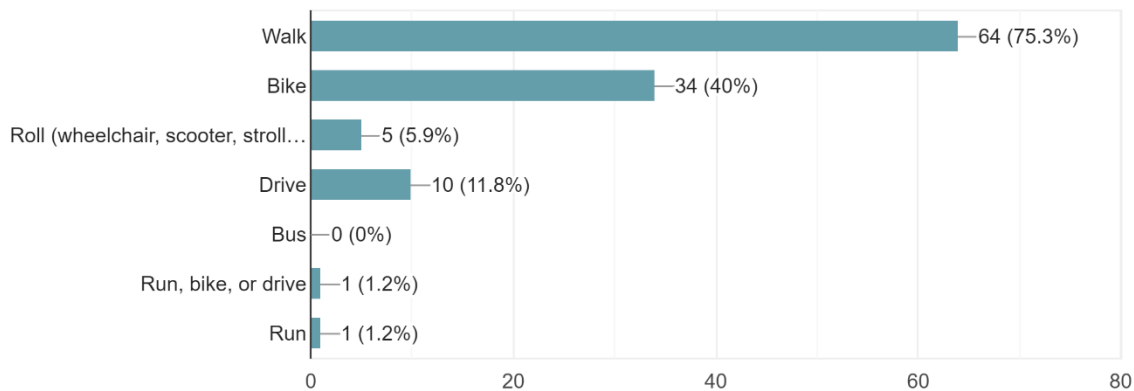

PUBLIC INPUT SUMMARY

Location Map of Prioritized Improvement Areas



Overall Public Comments on General Design

- “...we need to think about the future usage levels” (LT)
- “...goal is still to make the trail safer for all users...” (LT)
- “Greater awareness among ALL users of the park and trail of the OTHER users is key to enhancing enjoyment and safety for ALL.” (survey)
- “None of the “alternatives” alone are the best, but a mix and match of ideas is not bad if some of the park clutter is eliminated..” (survey & LT)
- “Having gravel shoulders for people who wish to be in a pedestrian only right of way, often with dogs on leash.” (LT)
- “Covid has introduced many to walking and with increasing density on the north end, the trail needs to be considered having greater usage over years, not just for today or yesterday.” (LT)
- “Unfortunately, the original shoulders have been allowed to deteriorate which makes the trail narrower, limits sight lines and makes passing more dangerous. There are no warning signs, painted lanes or normal safety elements.” (LT)
- “It makes little sense to add 2' wide gravel shoulders through the lid park instead of the current grass and vegetation shoulders that will simply become vegetated in a few years.” (LT)

AREA 1 | WEST MERCER WAY TRAIL CROSSING

Conceptual Alternative A
A central node



- Potential Improvements:
- Addition of a pocket node with kiosk, bench, and cyclist amenities
 - Provide improved wayfinding
 - Provide improved connectivity to trail across I-90 ramps
 - Remove uncomfortable and under-utilized sidewalk along I-90 ramps

Conceptual Alternative B
Pocket nodes



- Improvements include:
- Three small nodes with kiosks, seating, and cyclist amenities
 - Provide improved wayfinding
 - Provide improved connectivity to trail across I-90 ramps
 - Remove uncomfortable and under-utilized sidewalk along I-90 ramps

Public Comments on General Design for Area 1

- *"The nodes are intended to give riders a resting area and access to bike amenities (pump/bike rack). At present, some cyclists gather in that area to regroup or meet up with other riders before circling the island and the nodes would enhance that option."* (LT)
- *"Remove sidewalk along back of curb. That sidewalk is not used by cyclists (in my experience) and I don't believe cyclists would miss it. Pedestrians may use it when walking down to the bottom of the hill."* (LT)
- *"I'm ambivalent about the "nodes", constructing a kiosk is a good idea. If we had a kiosk there (or near the restrooms as is also an option) the city could post cycling maps and the Island's "Rules of the Road" document."* (LT)

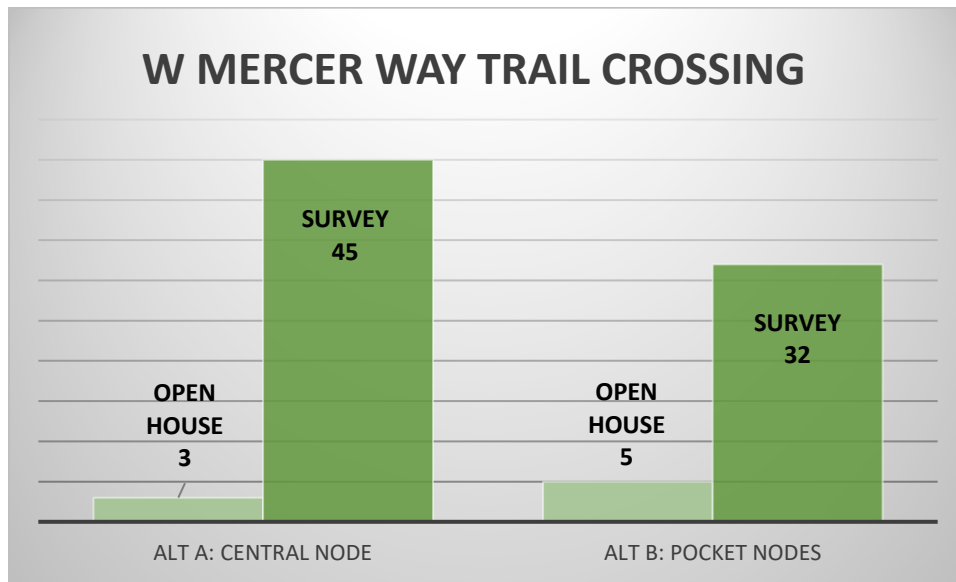

Area 1: Alternative A | Central Node

- “Having a node closer to the streetside would allow for better access for maintenance and can provide more visibility from the road (have more eyes on it).” (City staff)
- “I also don't get the kiosk. Three nodes and a kiosk start to look like park clutter to me.” (LT)
- “I like Alternative A—one [central] node is less busy and the location I think works better for way finding and encouraging the use of the alternative route on West Mercer Way that goes around the park.” (Open House)
- “Seems best for how I see people use that area.” (Open House)

Area 1: Alternative B | Pocket Nodes

- Why can't we do both [alternatives] A and B? (Open House)
 - Design Team responded that the number of alternatives chosen are dependent on budget. The project team is looking for feedback on desired conceptual preferences which will help inform how many improvements can be made.

Placemaking Treatments for Area 1

Out of 85 people, most of the public liked the following top 4 examples of placemaking treatments:

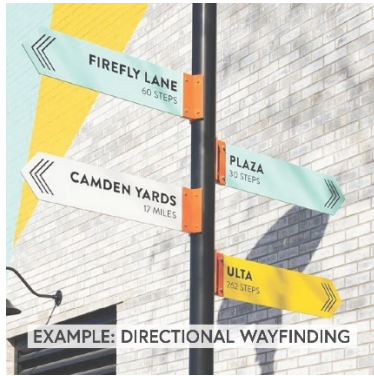

EXAMPLE: DIRECTIONAL WAYFINDING
 48 (58.5%)



EXAMPLE: STAMPED OR COLORED PAVEMENT TREATMENTS
 47 (57.3%)



EXAMPLE: TEXTURED PAVEMENT
 36 (43.9%)



EXAMPLE: PATTERNED PAVEMENT SURFACING
 33 (40.2%)

In your opinion, which additional placemaking treatments would improve the user experience at the West Mercer Way Trail Crossing? (select all th...t actual depictions of the placemaking treatments.
 82 responses

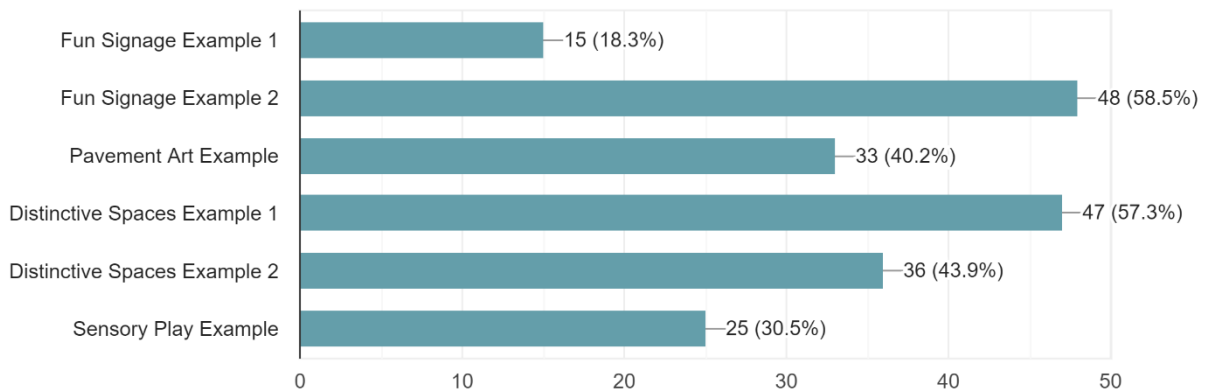

AREA 2 | TRAIL CONNECTION UNDER THE 72ND AVE SE OVERPASS

Conceptual Alternative A

Circulation Mindset

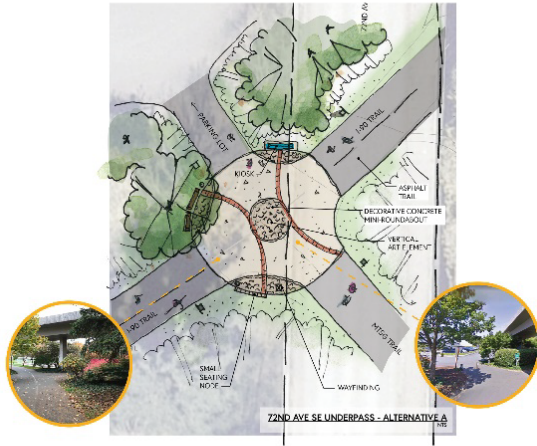

Potential improvements:

- Realign trail from parking lot to improve sight distance for left turn onto I-90 trail
- Create seating node with trail kiosk
- Reduce vegetation on either side of trail from parking lot

Conceptual Alternative B

Realigned mindsets

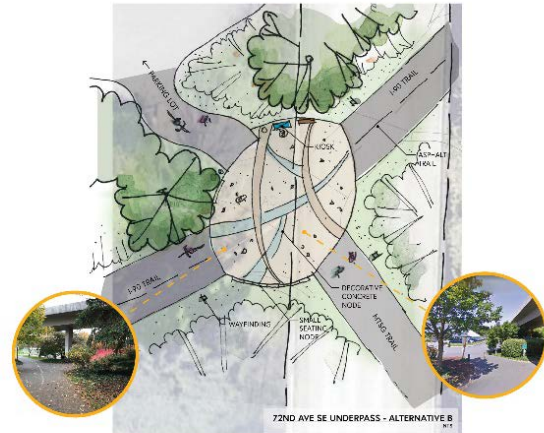

Potential improvements:

- Create two distinct seating nodes
- Add artist treatment in middle that maintains sight lines

Public Comments on General Design for Area 2

- Reduce impervious surface area as well as reduce traffic to this mixing zone by providing better access and provide better connection to ballfield area on the north. (Design Team)
- *"I do think some traffic calming measure will be necessary at the backstop which is the "Y" for both trails going to the town center. If bicycles are slowed at this juncture, I don't think they can create more speed by the bathroom."* (LT)
- *"Or why would you run the path from the parking lot to the roundabout? This is the one area we want to separate slowing bikes and pedestrians, not mix them... And eliminate the current path from the parking lot to where the roundabout will be located, and as noted below route those pedestrians to a marked crossing closer to the bathroom where bike speeds will have slowed."* (LT)

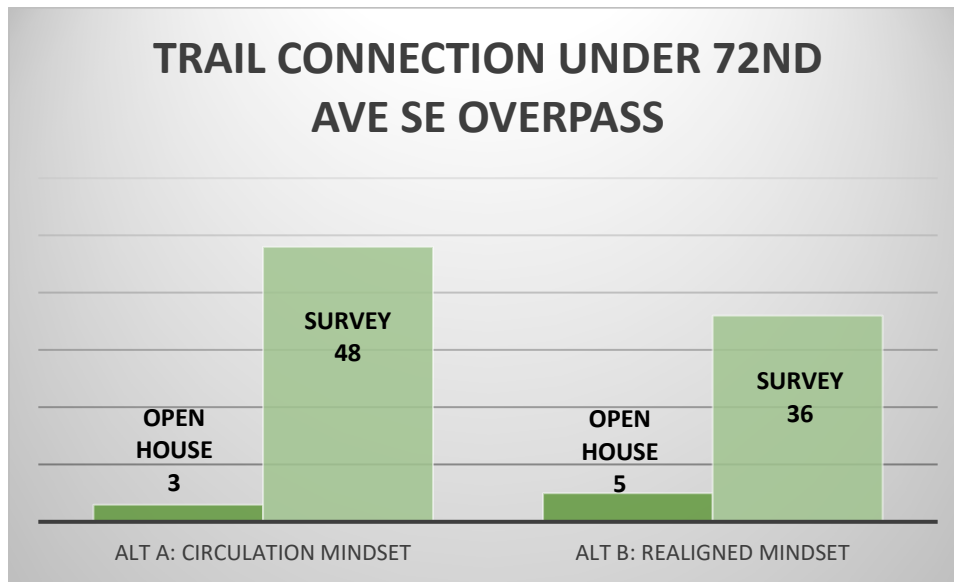

Area 2: Alternative A | Circulation Mindset

- *“I’m a fan of the roundabout option, even if it’s not raised, it could still signal people to pay attention to who has the right of way.” (City staff)*
- *“I like the roundabout. Strollers and dogs tend to wander across the path, and this is the worst sightline area, in my opinion. If installed though, there would have to be some very strong pavement paint to encourage turning short.” (Open House)*
- *“...We want to slow bicyclists...The roundabout has to be designed to allow a bicyclist who did not slow enough earlier to recover...” (LT)*

Area 2: Alternative B | Realigned Mindset

- *“...while roundabouts are often used on streets (and cyclists are familiar with them), they are hardly ever used on trails.... don’t know where pedestrians are supposed to be on the roundabout.” (LT)*
- *“This node should continue to have the striping that separates the sides of the trail, but otherwise this option is fine.” (LT)*
- *“I like Alternative B because it realigns the trail from the parking lot and improves sight lines. That could be accommodated in Alternate A, couldn’t it?” (Open House)*

Placemaking Treatments for Area 1

Out of 85 people, most of the public liked the following top 4 examples of placemaking treatments:

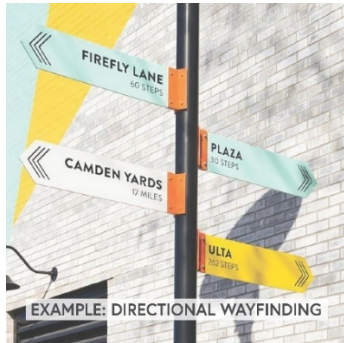

EXAMPLE: DIRECTIONAL WAYFINDING

49 (59%)



EXAMPLE: STAMPED OR COLORED PAVEMENT TREATMENTS

45 (54.2%)



EXAMPLE: GLOW IN THE DARK PAVEMENT SURFACING

45 (54.2%)



EXAMPLE: TEXTURED PAVEMENT

32 (38.6%)

"Some very strong pavement paint to encourage turning short." (Open House)

In your opinion, which additional placemaking treatments would improve the user experience at the Trail Connection under the 72nd Ave SE Overpa...actual depictions of the placemaking treatments.

83 responses

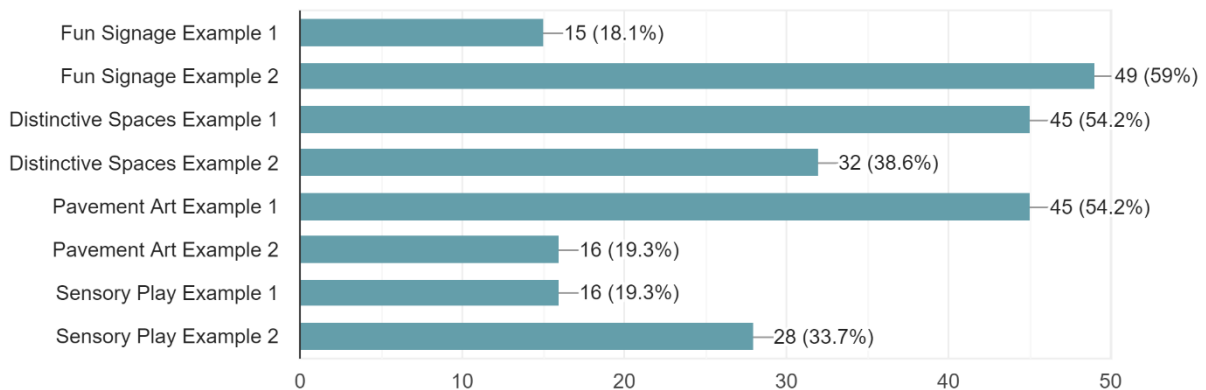

AREA 3 | RESTROOM FACILITIES NEAR FERGOLIA PLAYFIELDS

Conceptual Alternative A
 Trail confluence



- Potential improvements:
- Manage the flow of pedestrians and cyclists around the restroom and ballfield areas
 - Reduce conflict points by combining dugout and parking lot access at a single mixing zone
 - Addition of low fencing between ballfields and restroom area to direct people to predictable mixing zones
 - Create a node surrounding restroom for pedestrian and cyclist amenities

Conceptual Alternative B
 Delineated paths



- Potential improvements:
- Provide separate concrete sidewalk for pedestrians from the dugout to the restrooms
 - Create an enlarged plaza space around the restroom for pedestrian/bicycle amenities and additional maneuvering space
 - Provide distinct nodes at mixing zones with trail/sidewalk in between

Public Comments on General Design for Area 3

- Awareness goes both ways for all users (bikers, walkers, strollers, etc.) (Design Team)
 - *“All users could benefit everyone by being more self-aware of how their actions affect others.” (LT)*
- *“You want them (users) to walk along the grass part of the field to cross closer to the bathroom in a central marked crossing where bike speeds are low, not near the roundabout.” (LT)*
- *“These would funnel pedestrians (and dogs) from the parking lot to a central main crossing in the trail after the roundabout, so bike speeds are slow and this part of the trail crossing is marked. Another (low) ranch style fence along the grass next to the field would funnel pedestrians wanting to use the bathroom or cross the trail away from the roundabout and towards the marked crossing.” (LT)*
- *“In several places the plan calls for ‘informal fencing’ to control where pedestrians can cross the trail. This is an effective, low-tech way, of giving users of the trail predictability as to where pedestrians will cross. That is a good option. I would additionally add raised cross walk markings on the trail in those locations.” (LT)*
- *“I don’t like the plan to expand the gathering area with impervious surfaces that extend into the grass field.” (LT)*

- *“I like the idea of colored concrete there.... My advice to Jessi and the council is this project should still go before the parks commission when a design is selected because the parks commission has never had an opportunity to review the design, and my guess is the council would like to have the parks commission review the design first so there is consensus when it reaches the council.” (LT)*
- *“Instead of two trails at Feroglia just make the area wider so that area of significant use gives users more room to spread out. Widen trails per the preferences expressed in the extensive public process that occurred to develop the Master Plan.” (Survey)*

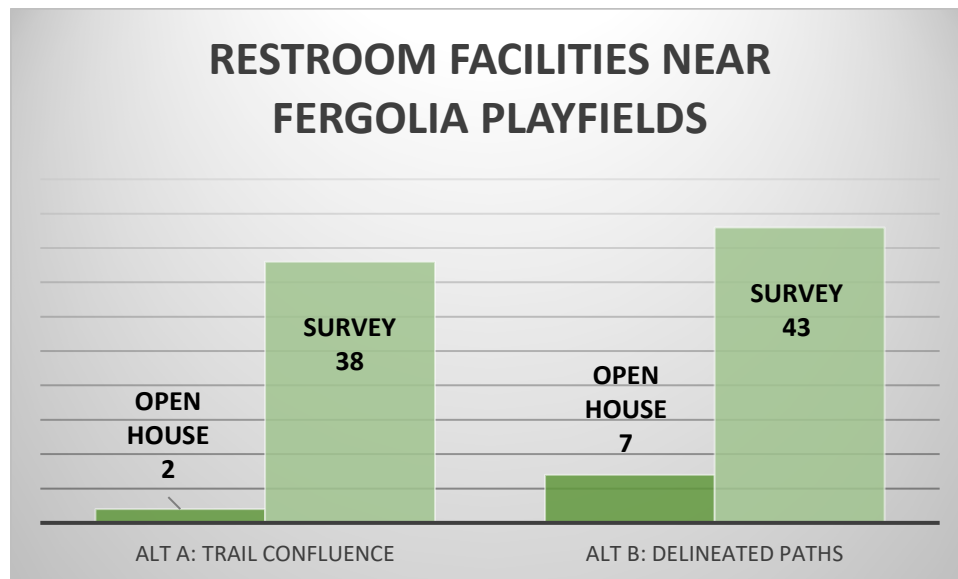

Area 3: Alternative A | Trail Confluence

- There are fewer numbers of mixing zones (compared to Alt B) and minimized points of conflict. (Design Team)
- Alt A is more straightforward and will require less signage than Alt B – providing less park clutter. (Design Team)
- Alt A has no separated landscape buffer and will require less maintenance than Alt B. (Design Team)
- *“Why would a pedestrian cross a paved path from the dugout to reach another path when they can just walk on the main path and have legal priority?” (LT)*
- *“If you need to meet the letter of the law, make a 12' trail through the plaza and then give it a 6' apron. Or call it a plaza. Trail, asphalt. Plaza, concrete. Two different things...The separate trail just means you'll have pedestrians on both trails.” (LT)*
- *“It REQUIRES anyone on the field wanting to use the bathroom to cross the trail to get to the walking trail at all different points, exactly what you don't want to do.” (LT)*

Area 3: Alternative B | Delineated Paths

- People who preferred option B liked it because it provided more space and ultimately the public had a perceived notion that the separated pedestrian and bike paths provide more space. (Design Team)
- *“In constrained areas where widening a single trail is not practical, the multi-use pathway separates into two trails so walkers and bikes can still be separated.” (LT)*

Placemaking Treatments for Area 3

Out of 85 people, most of the public liked the following top 4 examples of placemaking treatments:

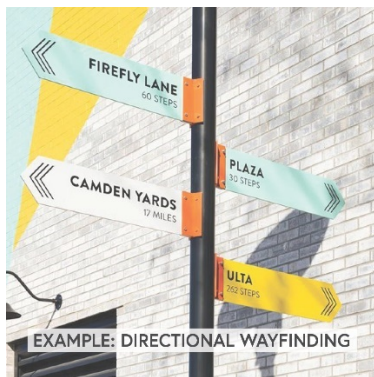

EXAMPLE: DIRECTIONAL WAYFINDING 40 (49.4%)



EXAMPLE: GLOW IN THE DARK PAVEMENT SURFACING 39 (48.1%)



EXAMPLE: ATTENTION GRABBING 3D PAVEMENT PAINT 39 (48.1%)

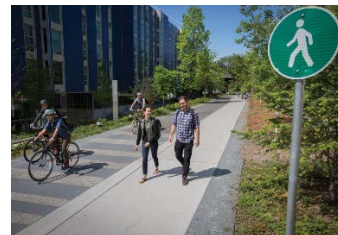

EXAMPLE: STAMPED OR COLORED PAVEMENT TREATMENTS 32 (39.5%)

“Love the 3D paint idea! I’ve ridden over that before and it definitely grabs your attention and makes you slow down.” (Open House)

In your opinion, which additional placemaking treatments would improve the user experience at the area around the Restroom Facilities near the F...t actual depictions of the placemaking treatments.

81 responses

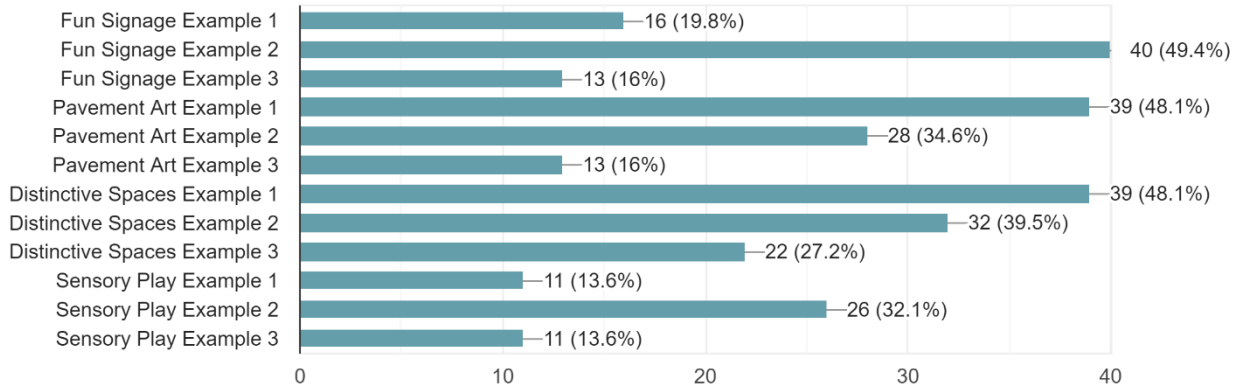

AUBREY DAVIS PARK TRAIL SAFETY IMPROVEMENTS

PARKS & RECREATION COMMISSION MEETING
APRIL 7, 2022



Introductions

City of Mercer Island

- Paul West** **CIP Project Manager**
- Craig Reynolds** **Council Liaison**
- Jodi McCarthy** **Commission Chair**
- Peter Struck** **Commission Vice-Chair**
- Sara Berkenwald** **Commission Member**
- Paul Burstein** **Commission Member**
- Don Cohen** **Commission Member**
- Sara Marxen** **Commission Member**
- Rory Westberg** **Commission Member**

KPG Psomas

- Liz Gibson** **Project Manager**
- Phuong Nguyen** **Public Engagement & Urban Designer**
- Coreen Schmidt** **Multi-Modal Trail Designer**



Project Goals

The goal of this project is to **improve safety** and **create a more enjoyable experience** for **all trail and park users**, while maintaining the existing character of the Aubrey Davis Park. The project improvements will focus primarily on **low-impact approaches** for improvements to a 0.8-mile trail section from 60th Ave SE to 76th Ave SE, along the Mountains to Sound Greenway Trail. One high-priority location for improvements and **placemaking** will be the area near the restrooms, adjacent to the Gary Feroglia playfields.



Overview / Project Scope

- Trail improvements to make pedestrian and bicycle movements safer and more predictable at key locations.
 - Bike traffic-calming measures
 - Removal of existing bollards
- Signage and pavement markings
- Restoring trail shoulders
- Wayfinding signage and markings
 - Signage for bypass routes for high-speed cyclists
- Channeling cross-trail traffic
- Art and placemaking elements
- Vegetation management for sight distance



○ IMPROVEMENT AREAS

↔ TRAIL



Overview / Priority Improvement Areas

- 1** W. Mercer Way Trail Crossing
- 2** Trail Connection under 72nd Ave SE Overpass
- 3** Restroom Facilities & Playfields Node

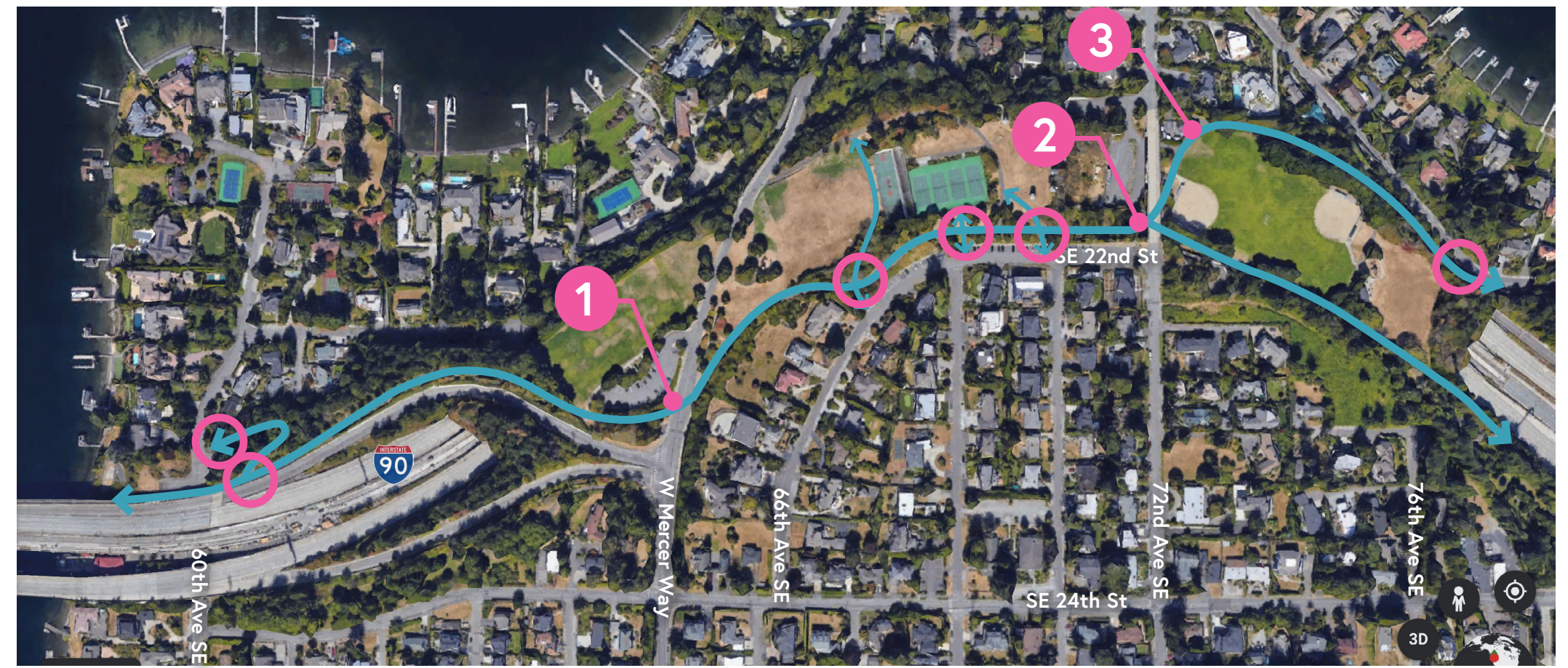

1
2
3
 PRIORITIZED IMPROVEMENT AREAS

IMPROVEMENT AREAS

TRAIL

▲
 N
 ▼

Conceptual Alternatives / W. Mercer Way Trail Crossing

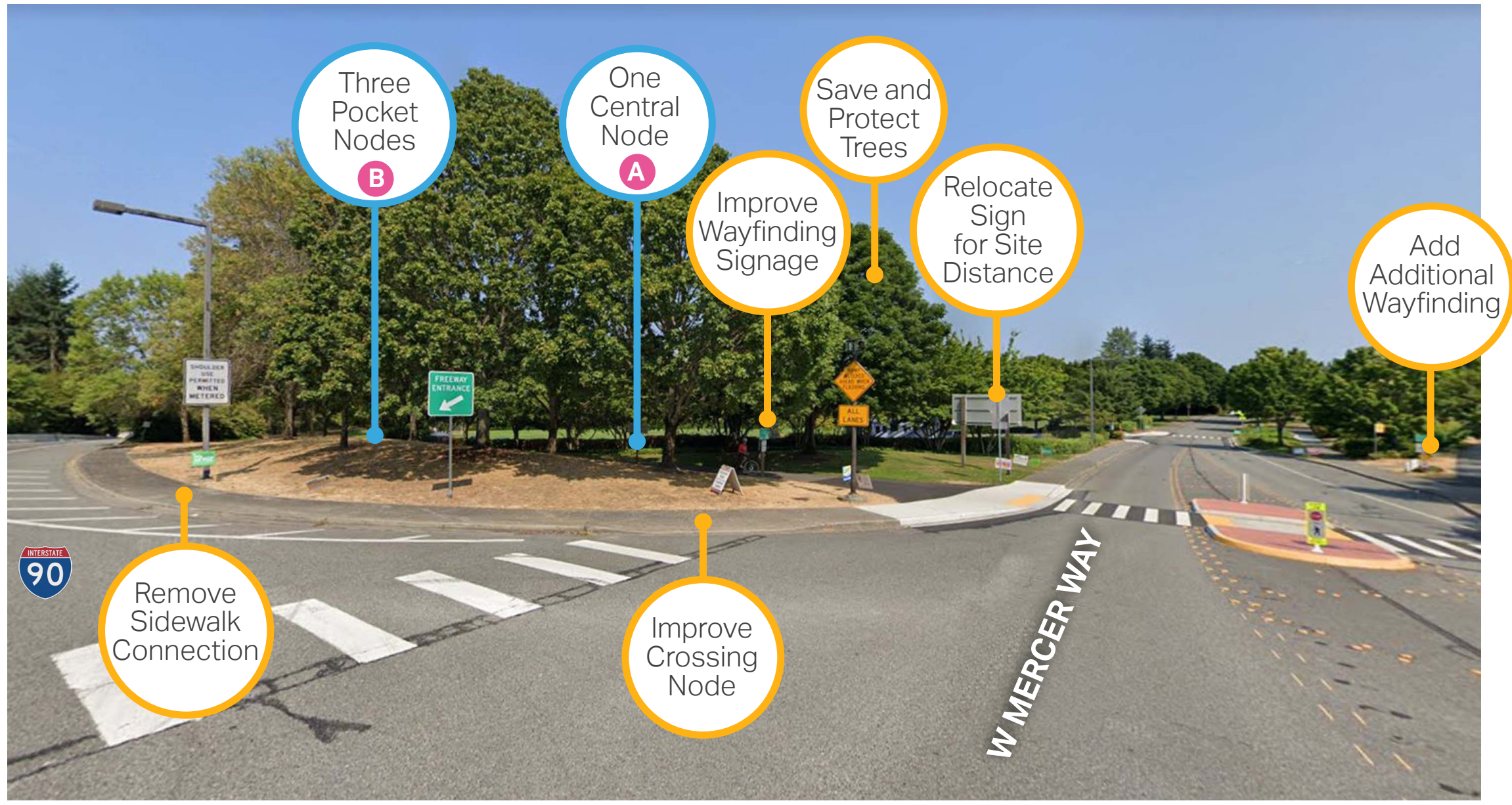

Conceptual Alternatives / W. Mercer Way Trail Crossing

Conceptual Alternative A: "A Central Node"

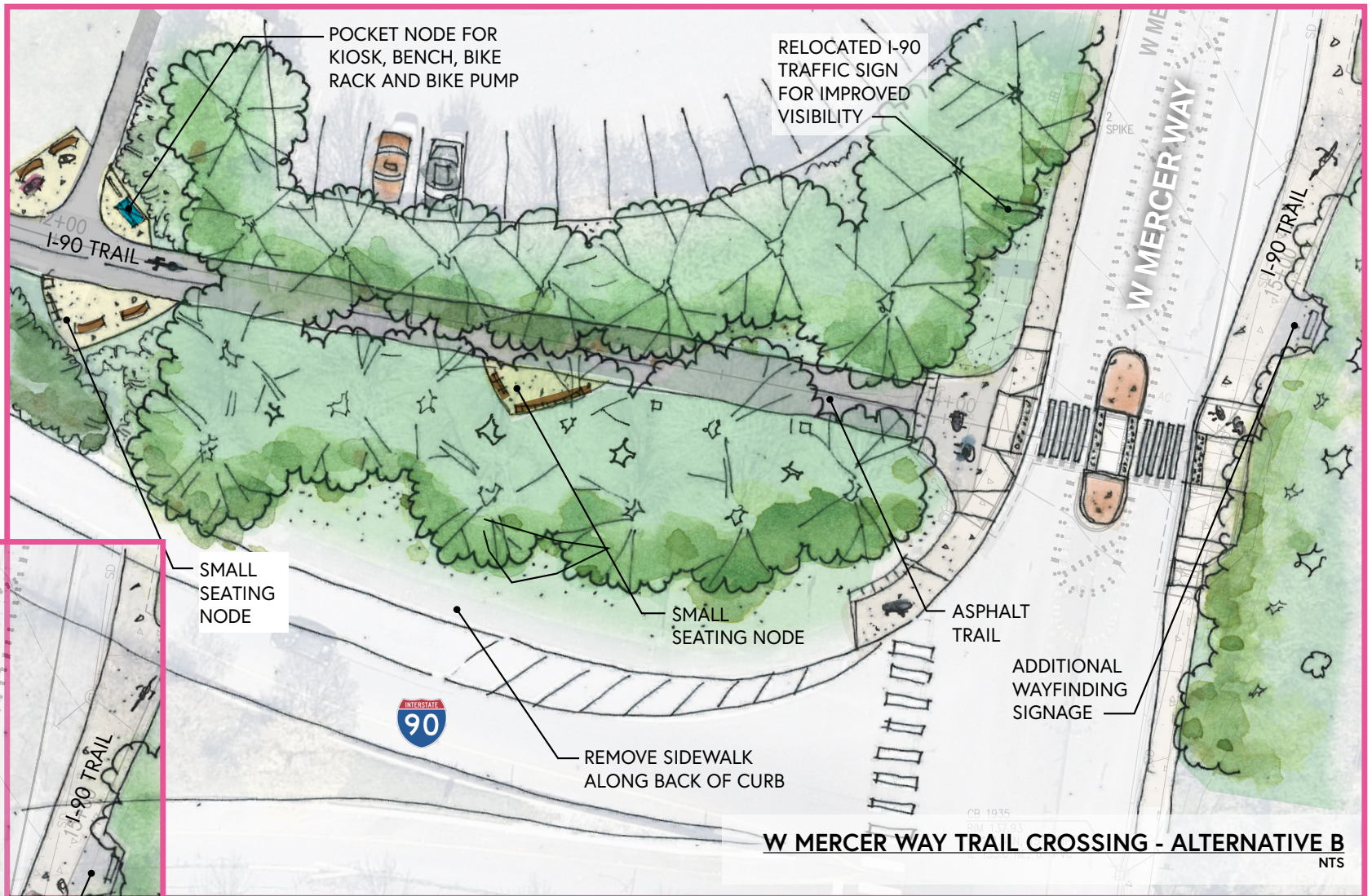
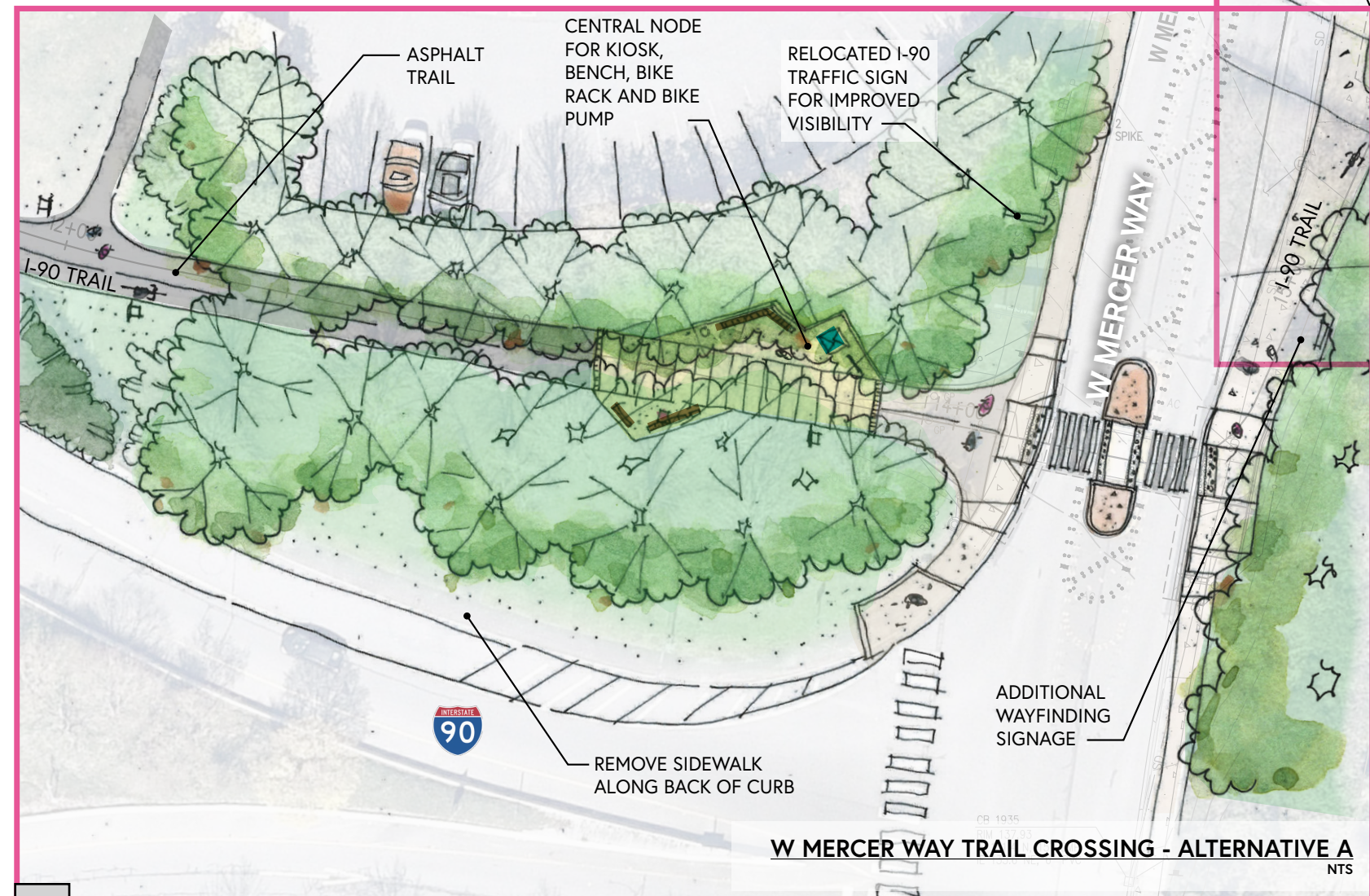

Conceptual Alternative B: "Pocket Nodes"

Conceptual Alternatives / W. Mercer Way Trail Crossing

Conceptual Alternative A: "A Central Node"

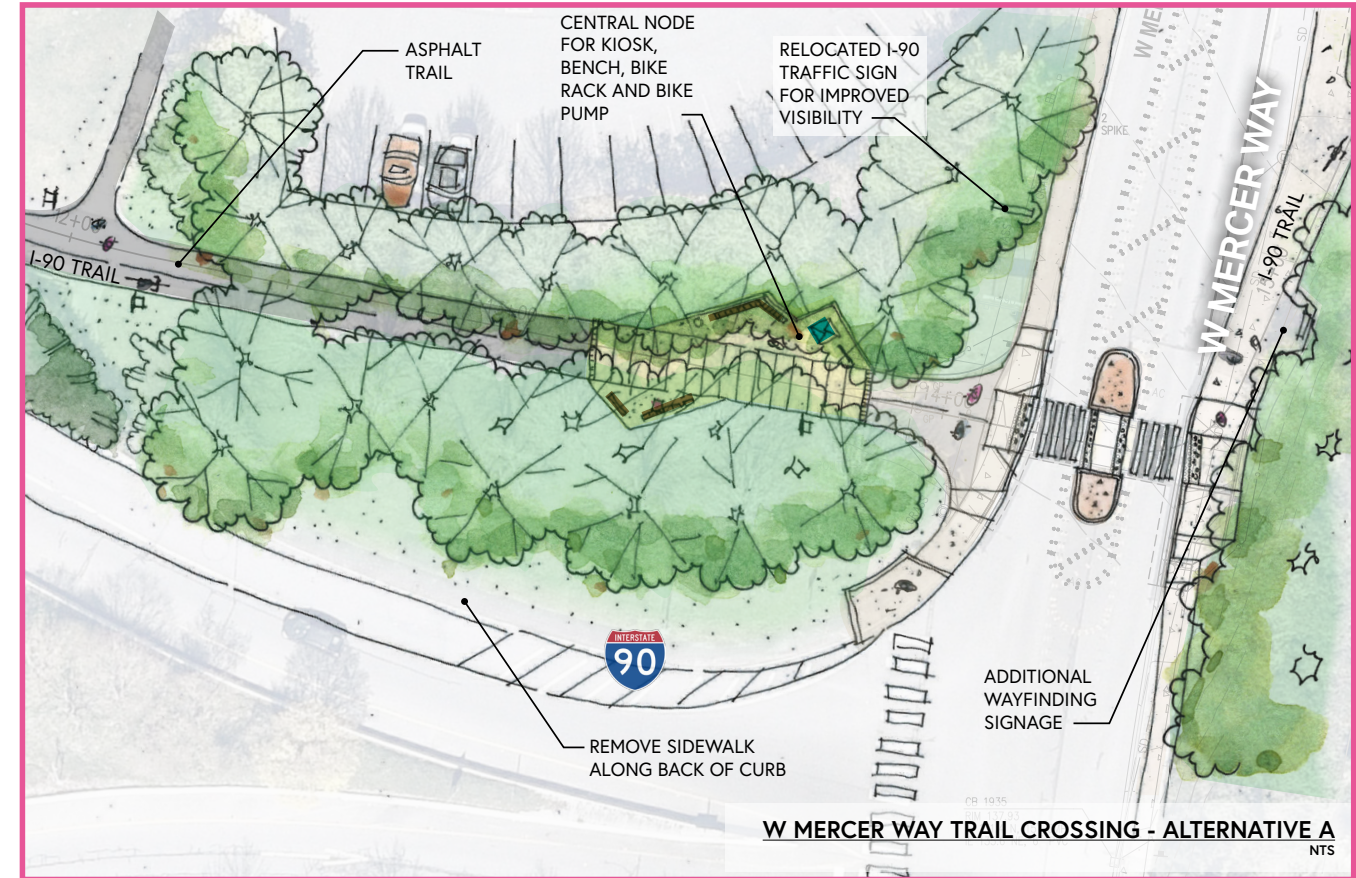

Conceptual Alternative B: "Pocket Nodes"

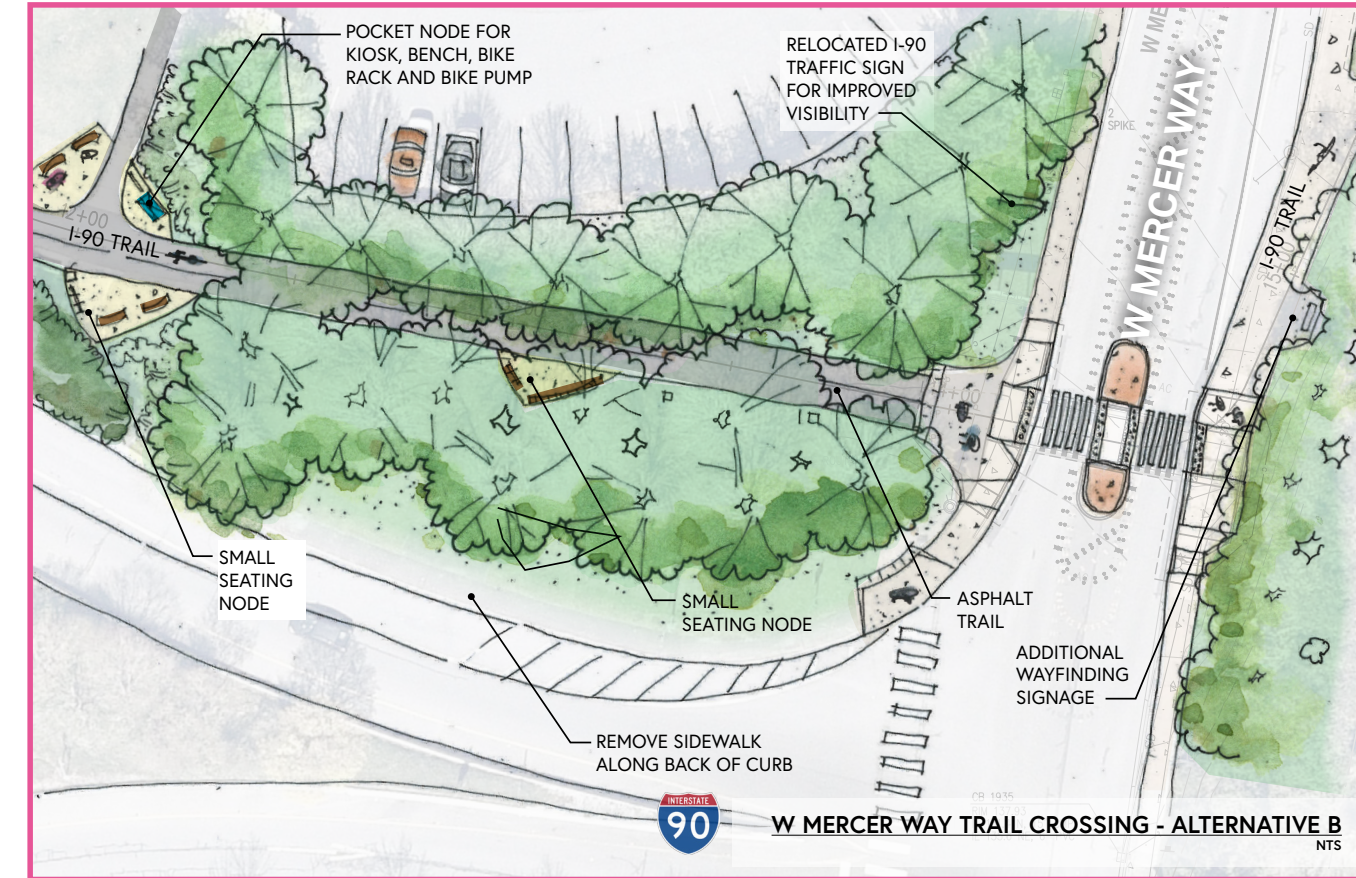

Public Feedback

"The nodes are intended to give riders a resting area and access to bike amenities (pump/bike rack). At present, some **cyclists gather in that area** to regroup or meet up with other riders before circling the island and the nodes would enhance that option." (LT)

"Remove sidewalk along back of curb. That sidewalk is not used by cyclists (in my experience) and I don't believe cyclists would miss it. Pedestrians may use it when walking down to the bottom of the hill." (LT)

"I'm ambivalent about the "nodes," constructing a kiosk is a good idea. If we had a kiosk there (or near the restrooms as is also an option) the city could post cycling maps and the Island's "Rules of the Road" document." (LT)

W MERCER WAY TRAIL CROSSING

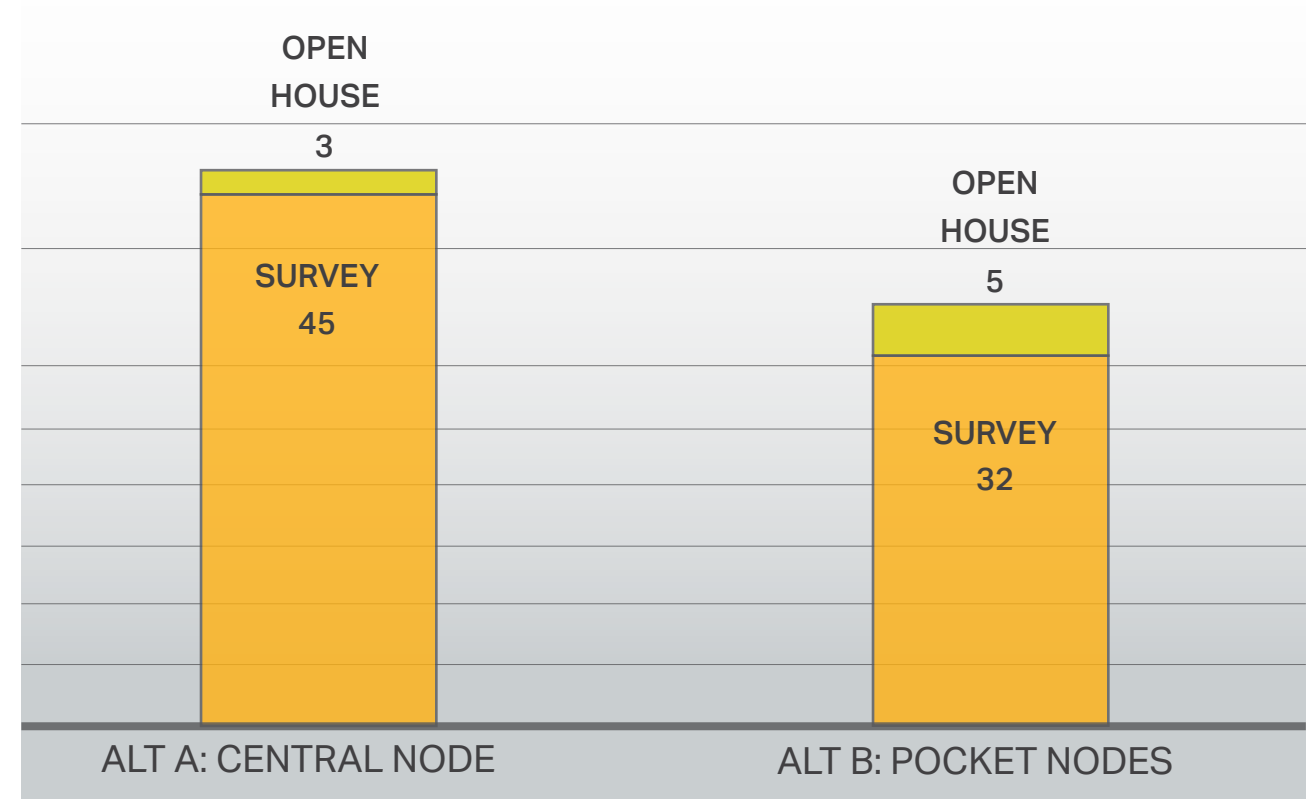

Alternative A: Central Node

Having a node closer to the streetside would allow for **better access for maintenance** and can provide **more visibility** from the road (have more eyes on it). (City Staff)

"I also don't get the kiosk. Three nodes and a kiosk start to look like park clutter to me." (LT)

"I like Alternative A—one [central] node is **less busy** and the location I think works **better for wayfinding** and encouraging the use of the alternative route on West Mercer Way that goes around the park." (Open House)

"Seems best for **how** I see **people use that area.**" (Open House)

Alternative B: Pocket Nodes

Why can't we do both [alternatives] A and B? (Open House)

Design Team responded that *the number of alternatives chosen are **dependent on budget.** The project team is looking for feedback on desired conceptual preferences which will help inform how many improvements can be made.*

W. Mercer Way Trail Crossing / Improvement Matrix

	PROPOSED IMPROVEMENT	CAPACITY	ACCESSIBILITY	SAFETY	AESTHETICS
AREA 1: West Mercer Way Trail Crossing	Provide additional trail striping (channelization)			✓	
	Expand pavement in high traffic areas	✓		✓	✓
	Increase shared-use path width				
	Reestablish 2' shoulders along trail	✓	✓	✓	
	Trim back overgrown vegetation	✓	✓	✓	✓
	Provide defined amenity nodes	✓		✓	✓
	Improve ADA access				
	Improve wayfinding signage			✓	✓
	Add educational signage for lower speed control			✓	
	Improve pedestrian/bicyclist traffic control devices				



Provide Amenity Nodes



Trim Back Overgrown Vegetation

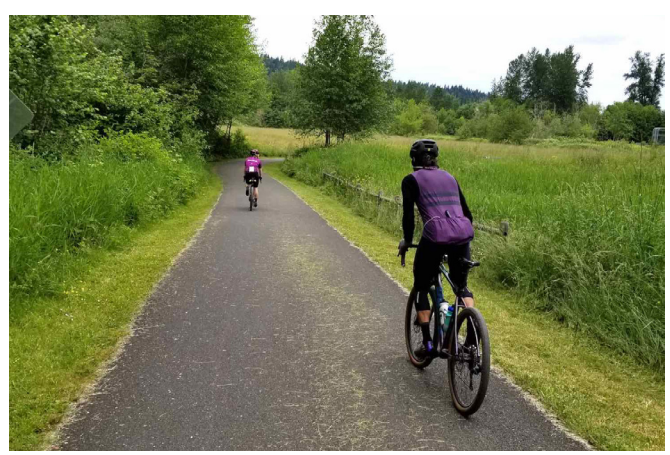

Reestablish 2' Shoulders

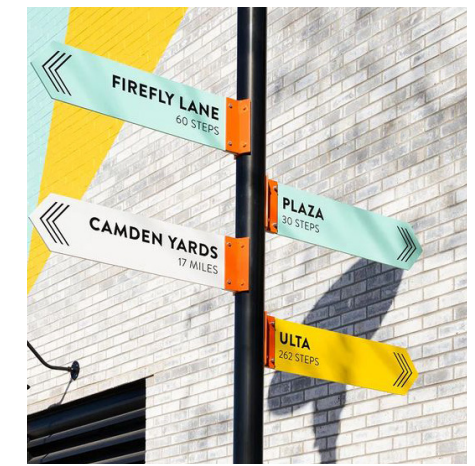

Improve Wayfinding Signage

Conceptual Alternatives / Trail Connection under 72nd Ave SE Overpass



Conceptual Alternatives / Trail Connection under 72nd Ave SE Overpass

Conceptual Alternative A: "Circulation Mindset"

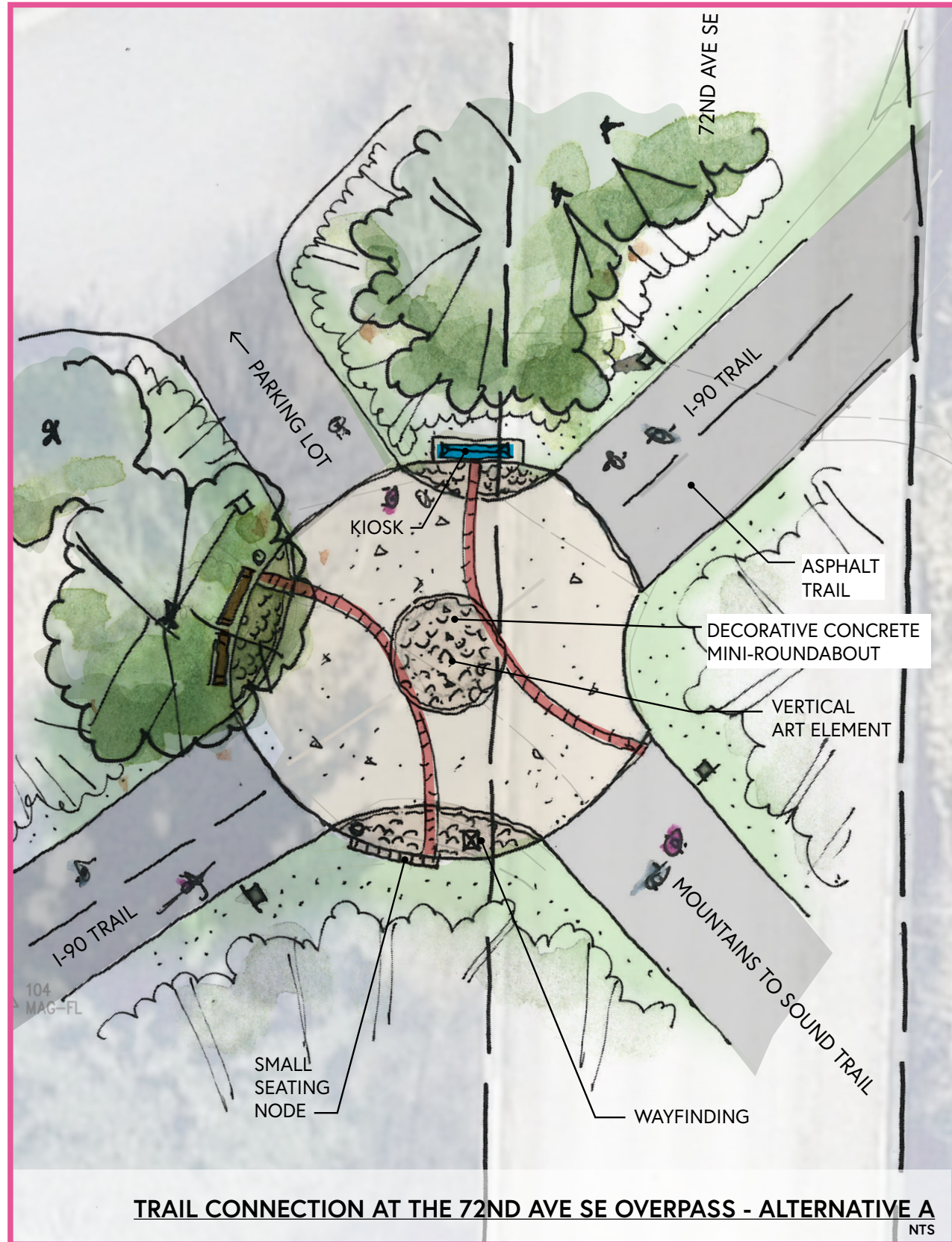

TRAIL CONNECTION AT THE 72ND AVE SE OVERPASS - ALTERNATIVE A
NTS

Conceptual Alternative B: "Realigned Mindset"

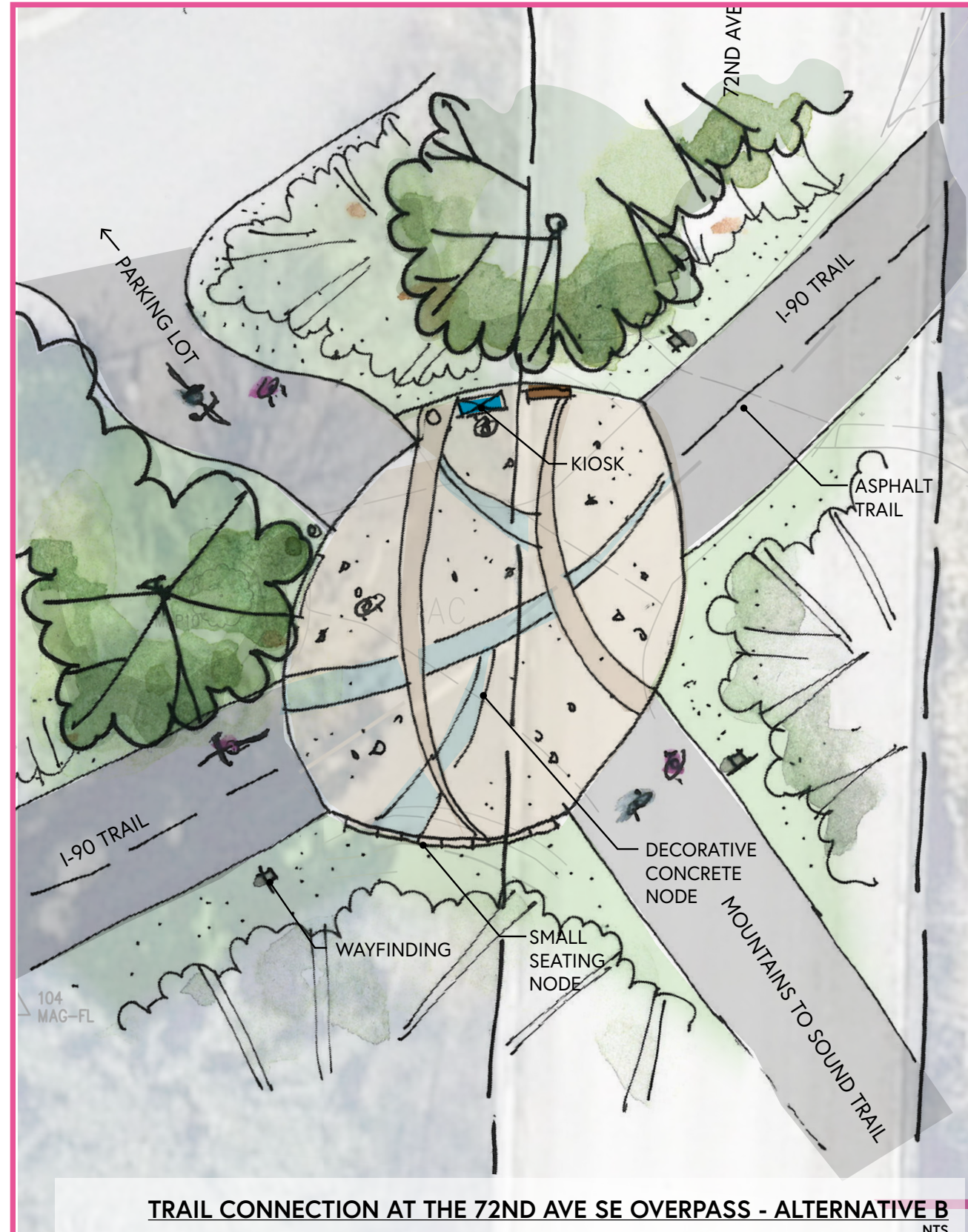

TRAIL CONNECTION AT THE 72ND AVE SE OVERPASS - ALTERNATIVE B
NTS

Conceptual Alternatives / Trail Connection under 72nd Ave SE Overpass

Conceptual Alternative A: "Circulation Mindset"

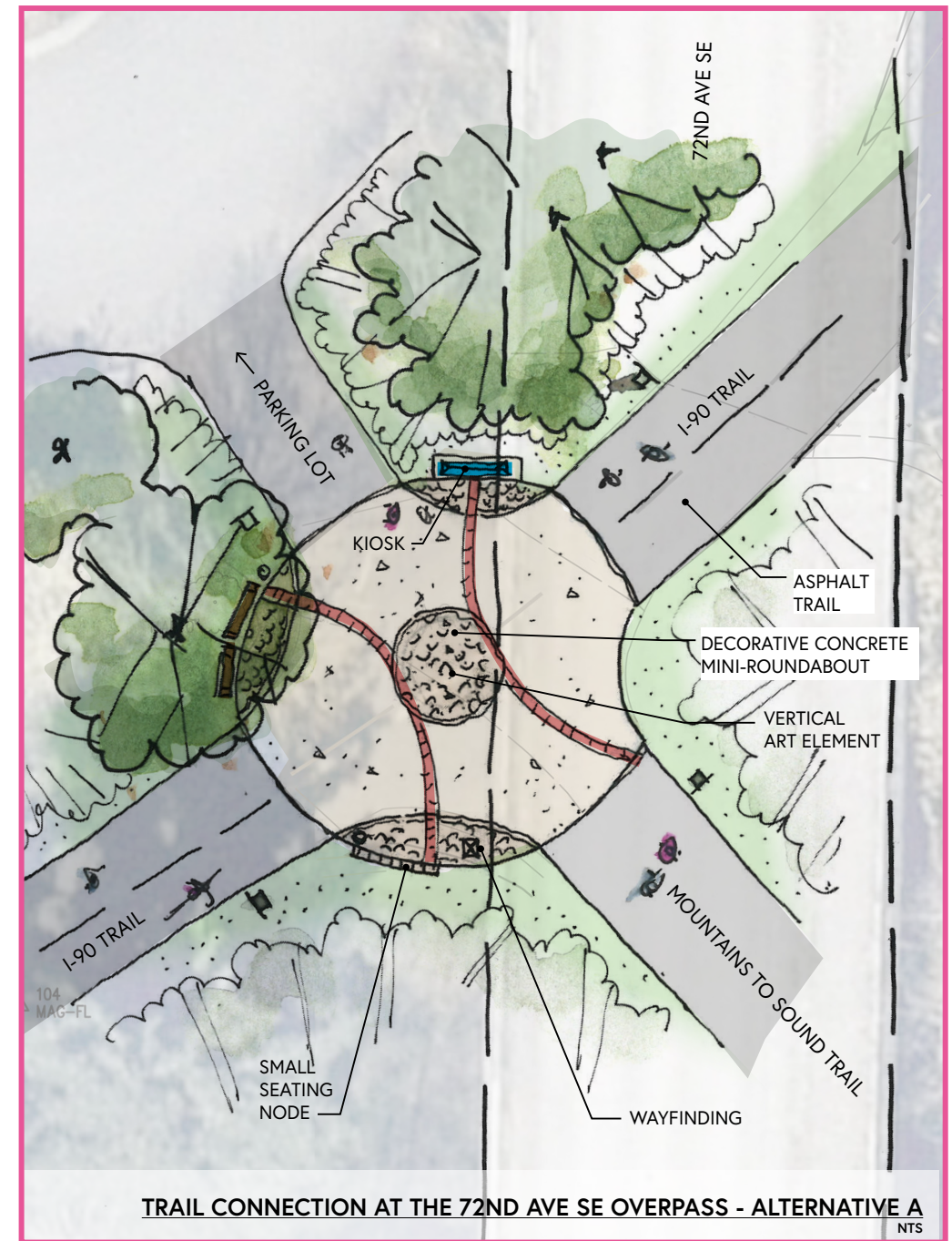

Conceptual Alternative B: "Realigned Mindset"

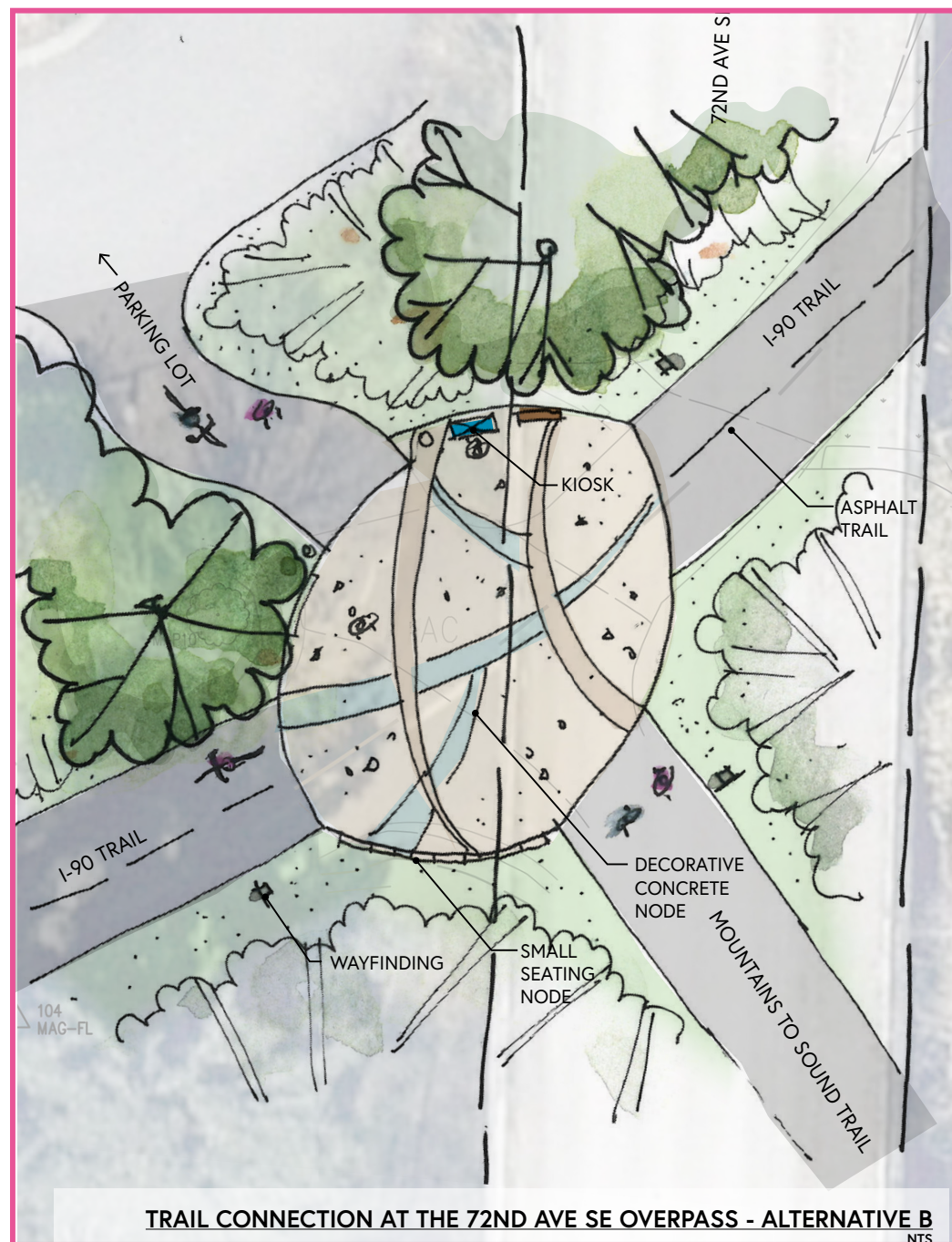

Public Feedback

"I do think some **traffic calming** measure will be necessary at the backstop which is the "Y" for both trails going to the town center. If bicycles are slowed at this juncture, I don't think they can create more speed by the bathroom." (LT)

"Or why would you run the path from the parking lot to the roundabout? This is the one area we want to separate slowing bikes and pedestrians, not mix them... And **eliminate the current path from the parking lot** to where the roundabout will be located, and as noted below route those pedestrians to a marked crossing closer to the bathroom where bike speeds will have slowed." (LT)

Trail Connection under 72nd Ave SE Overpass / Public Feedback

TRAIL CONNECTION UNDER 72ND AVE SE OVERPASS

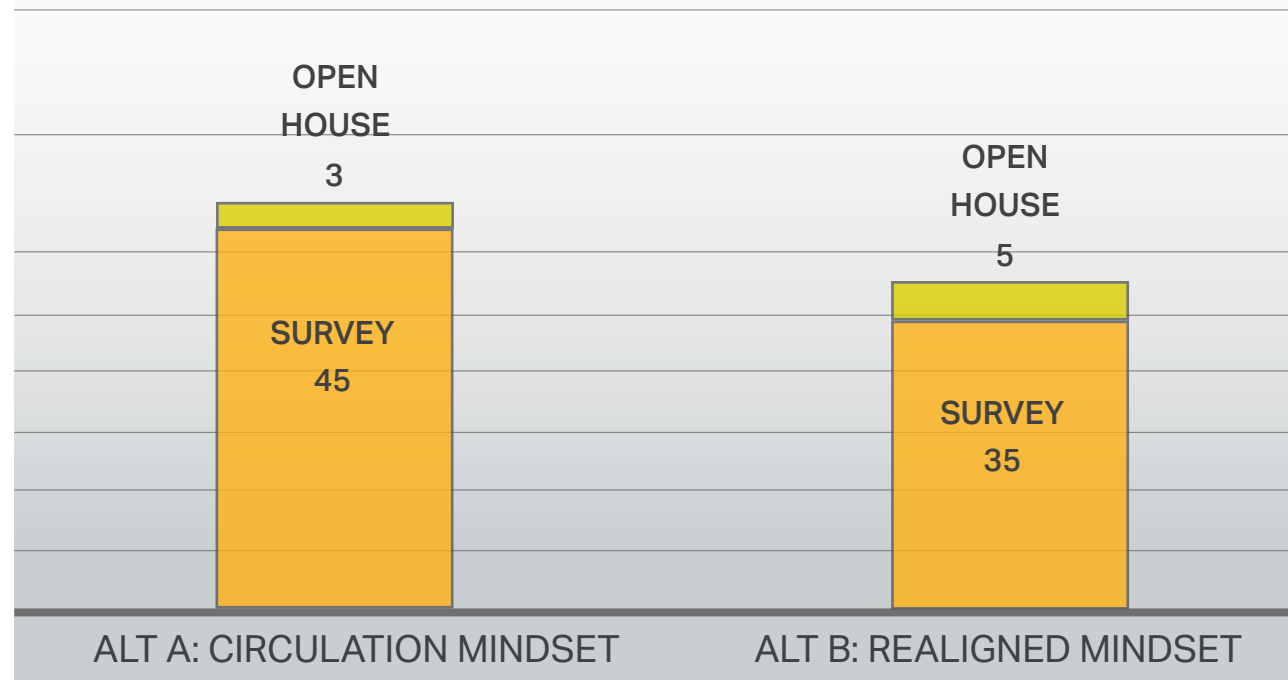

Alternative A | Circulation Mindset

"I like the roundabout. Strollers and dogs tend to wander across the path, and this is the worst sightline area, in my opinion. If installed though, there would have to be some very strong pavement paint to **encourage turning short.**" (Open House)

"...We want to **slow bicyclists**...The roundabout has to be designed to allow a bicyclist who did not slow enough earlier to recover..." (LT)

"I'm a fan of the roundabout option, even if it's not raised, it could still **signal people to pay attention** to who has the right of way." (City Staff)

Alternative B | Realigned Mindset

"...while roundabouts are often used on streets (and cyclists are familiar with them), they are hardly ever used on trails.... **don't know where pedestrians are supposed to be on the roundabout.**" (LT)

"This node should **continue to have the striping that separates** the sides of the trail, but otherwise this option is fine." (LT)

"I like Alternative B because it realigns the trail from the parking lot and **improves sight lines.** That could be accommodated in Alternate A, couldn't it?" (Open House)

Trail Connection under 72nd Ave SE Overpass / Improvement Matrix

	PROPOSED IMPROVEMENT	CAPACITY	ACCESSIBILITY	SAFETY	AESTHETICS
AREA 2: Trail Connection at 72nd Ave SE Overpass	Provide additional trail striping (channelization)		✓	✓	
	Expand pavement in high traffic areas	✓		✓	✓
	Increase shared-use path width				
	Reestablish 2' shoulders along trail	✓	✓	✓	
	Trim back overgrown vegetation				
	Provide defined amenity nodes	✓		✓	✓
	Improve ADA access				
	Improve wayfinding signage		✓		✓
	Add educational signage for lower speed control			✓	
	Improve pedestrian/bicyclist traffic control devices			✓	✓



Pedestrian/Bicyclist Traffic Control Devices

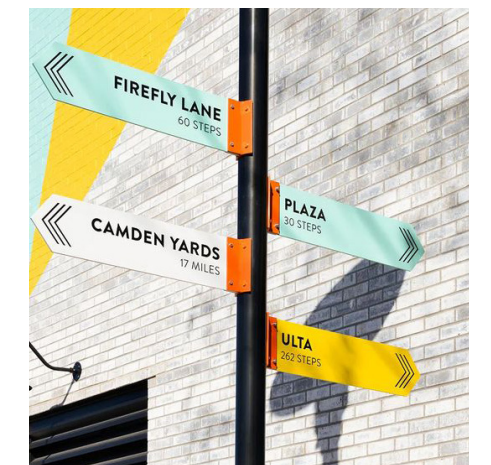

Trim Back Overgrown Vegetation

Improve Wayfinding Signage

Conceptual Alternatives / Restroom Facilities & Playfields Node

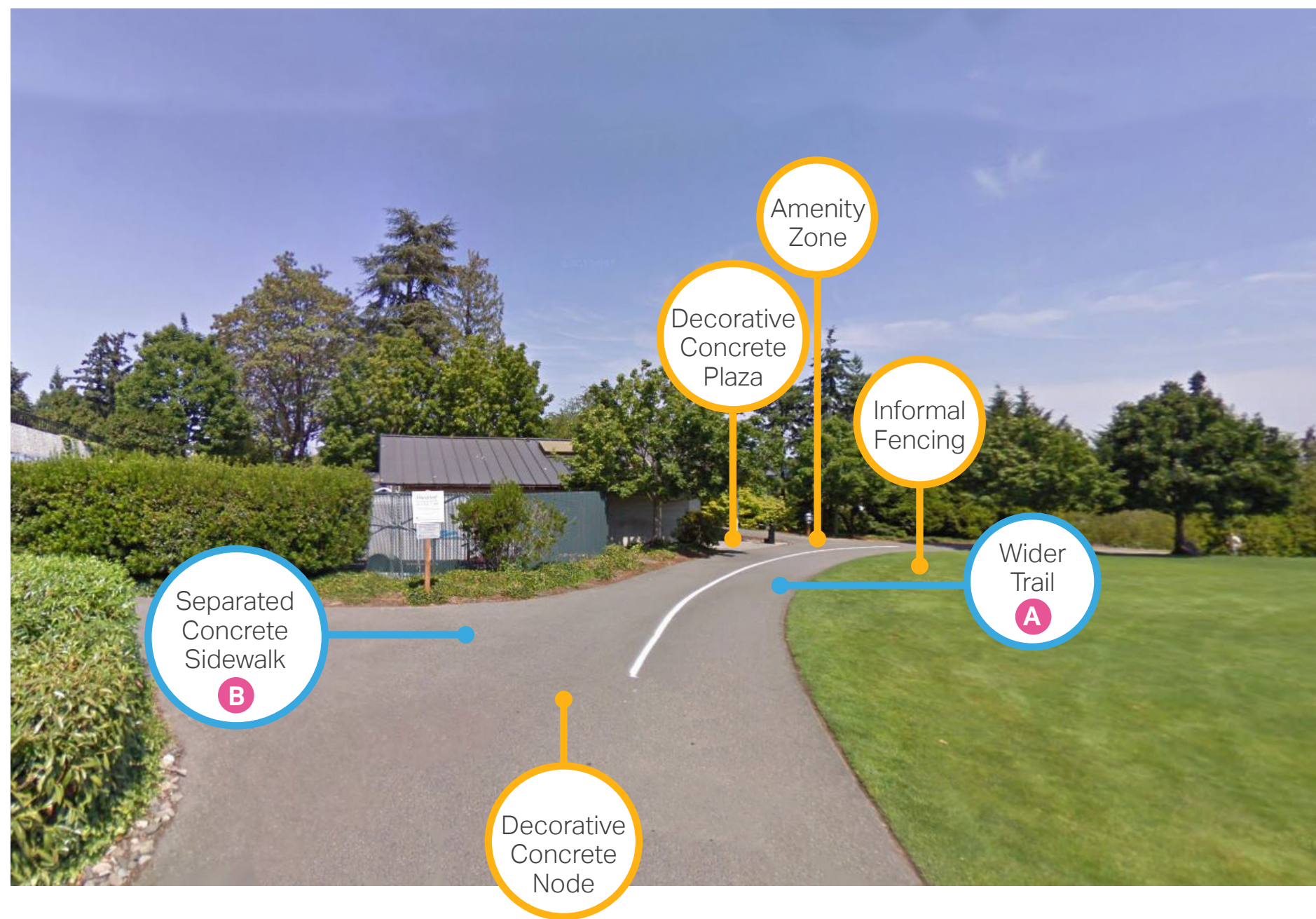

Conceptual Alternatives / Restroom Facilities & Playfields Node

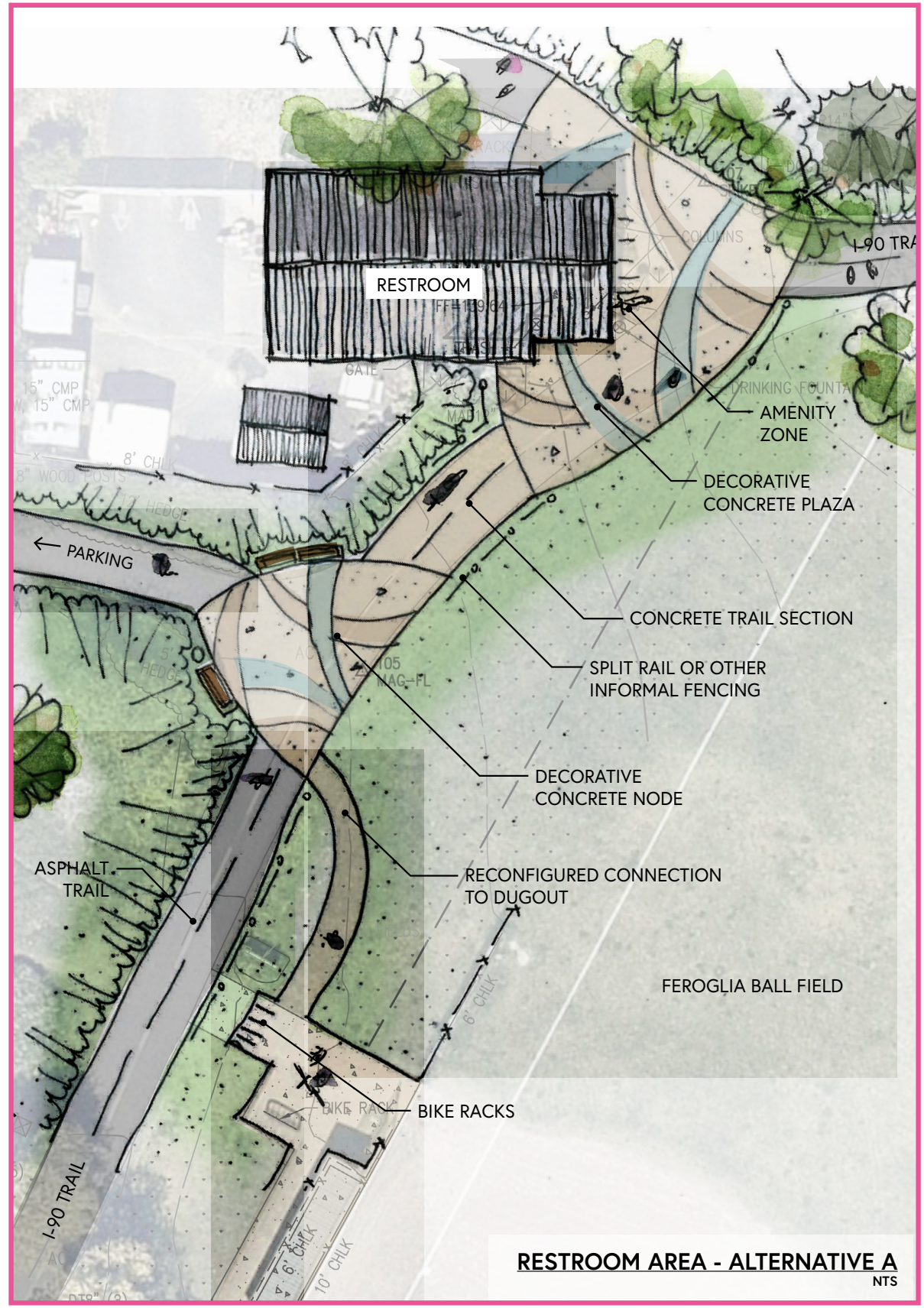

Conceptual Alternative A: "Trail Confluence"

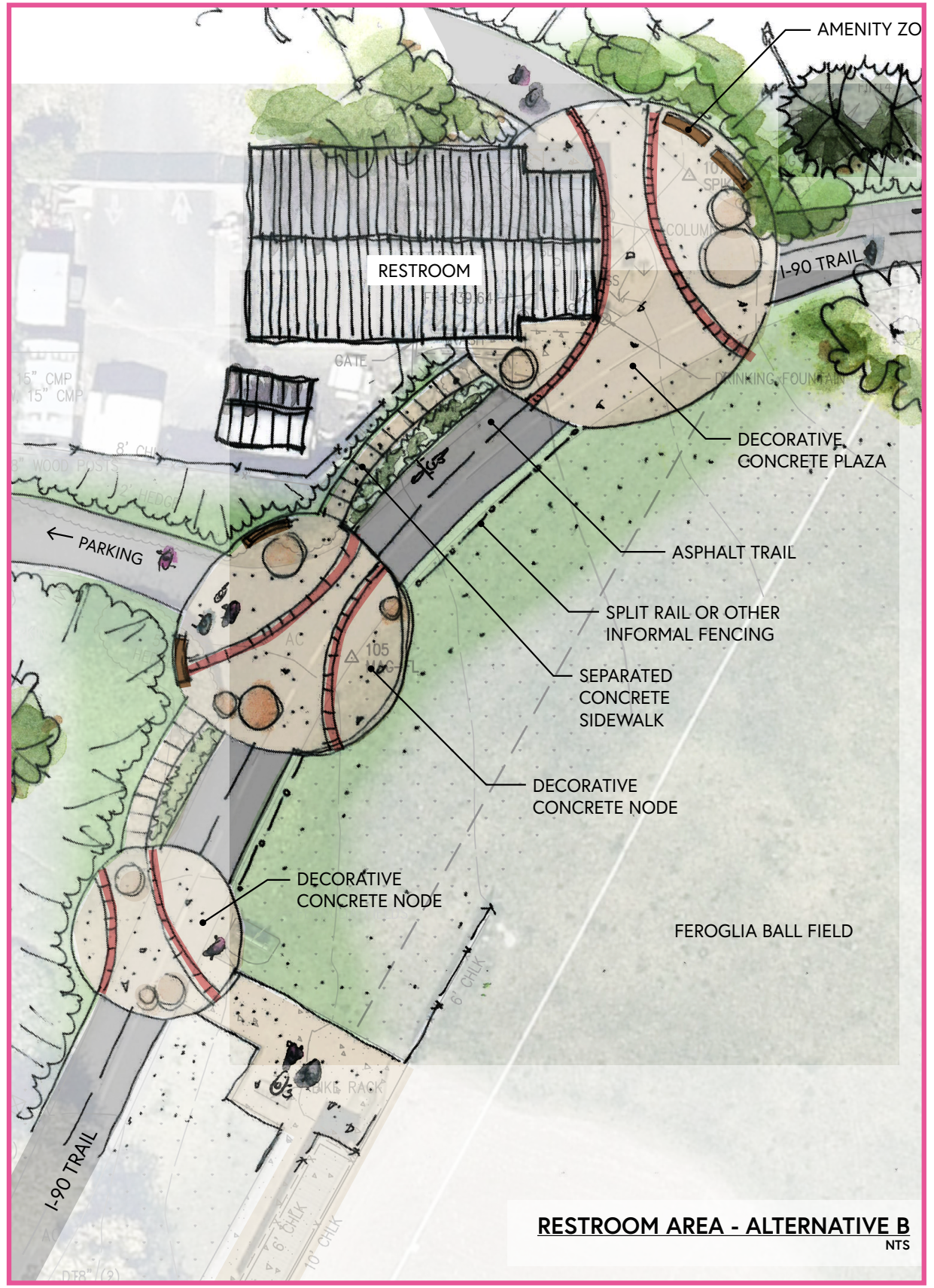

Conceptual Alternative B: "Delineated Paths"

Conceptual Alternatives / Restroom Facilities & Playfields Node

Conceptual Alternative A: "Trail Confluence"

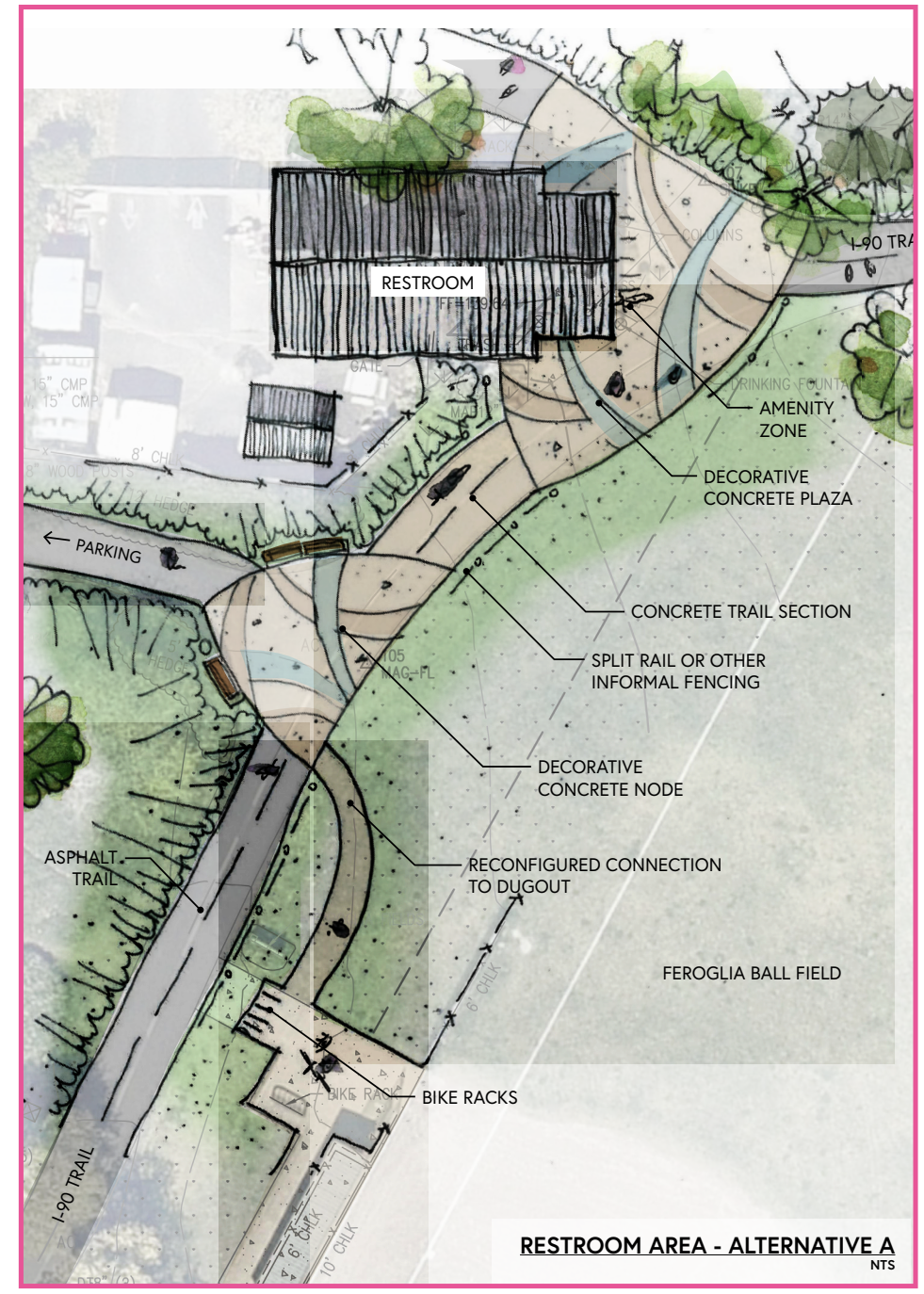

Conceptual Alternative B: "Delineated Paths"

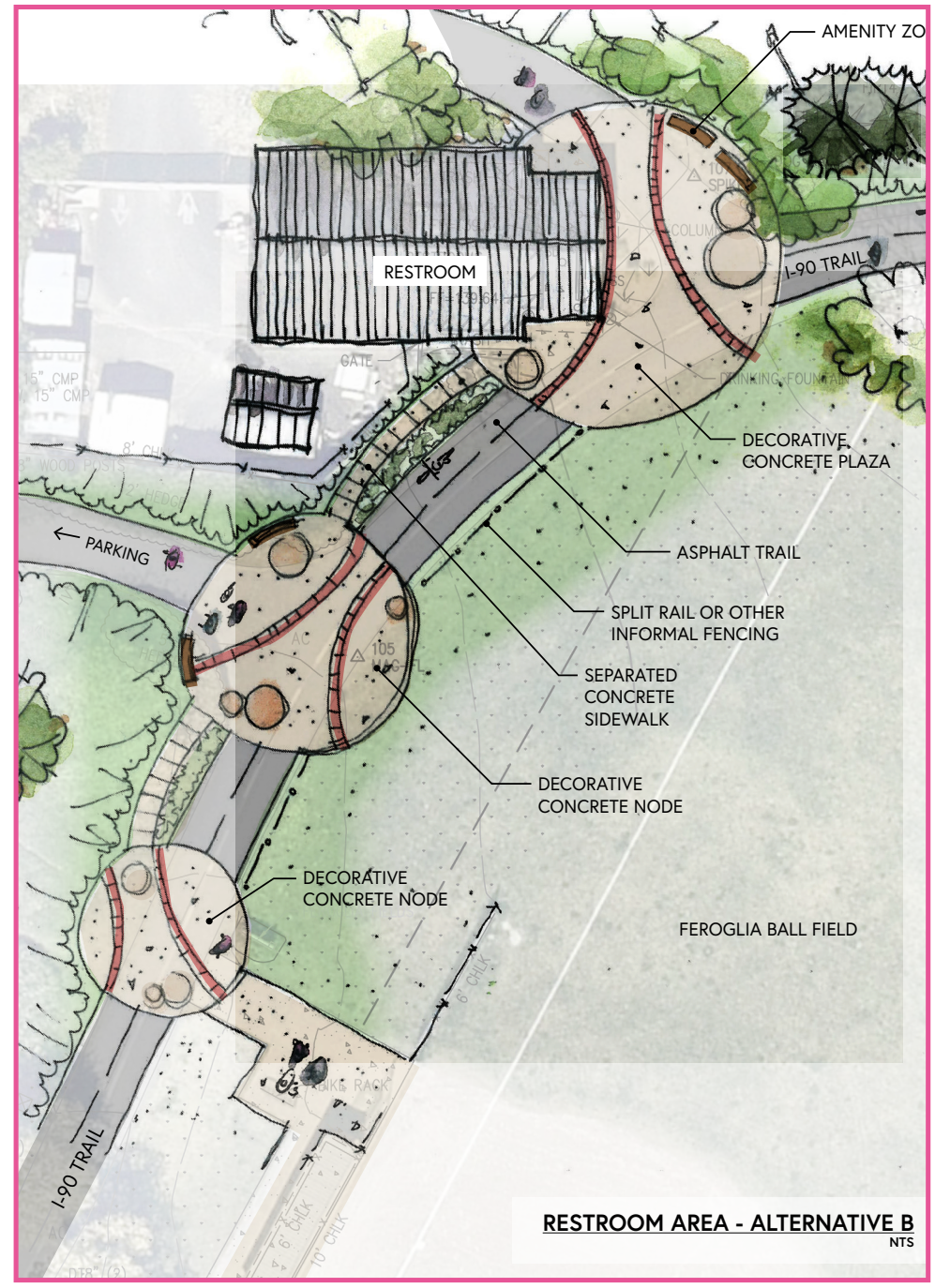

Public Feedback

All users could benefit everyone by **being more self-aware** of how their actions affect others." (LT)

"You want [users] to walk along the **grass** part of the field to cross closer to the bathroom in a central marked crossing where bike speeds are low, not near the roundabout." (LT)

"These would **funnel pedestrians (and dogs)** from the parking lot **to a central main crossing** in the trail after the roundabout so bike speeds are slow and this part of the trail crossing is marked." (LT)

"In several places the plan calls for '**informal fencing**' to control where pedestrians can cross the trail. This is an **effective, low tech way**, of giving users of the **trail predictability** as to where pedestrians will cross.... I would additionally **add raised cross walk markings** on the trail in those locations." (LT)

"I don't like the plan to expand the gathering area with **impervious surfaces** that extend into the grass field." (LT)

Restroom Facilities & Playfields Node / Public Feedback

RESTROOM FACILITIES & PLAYFIELDS NODE

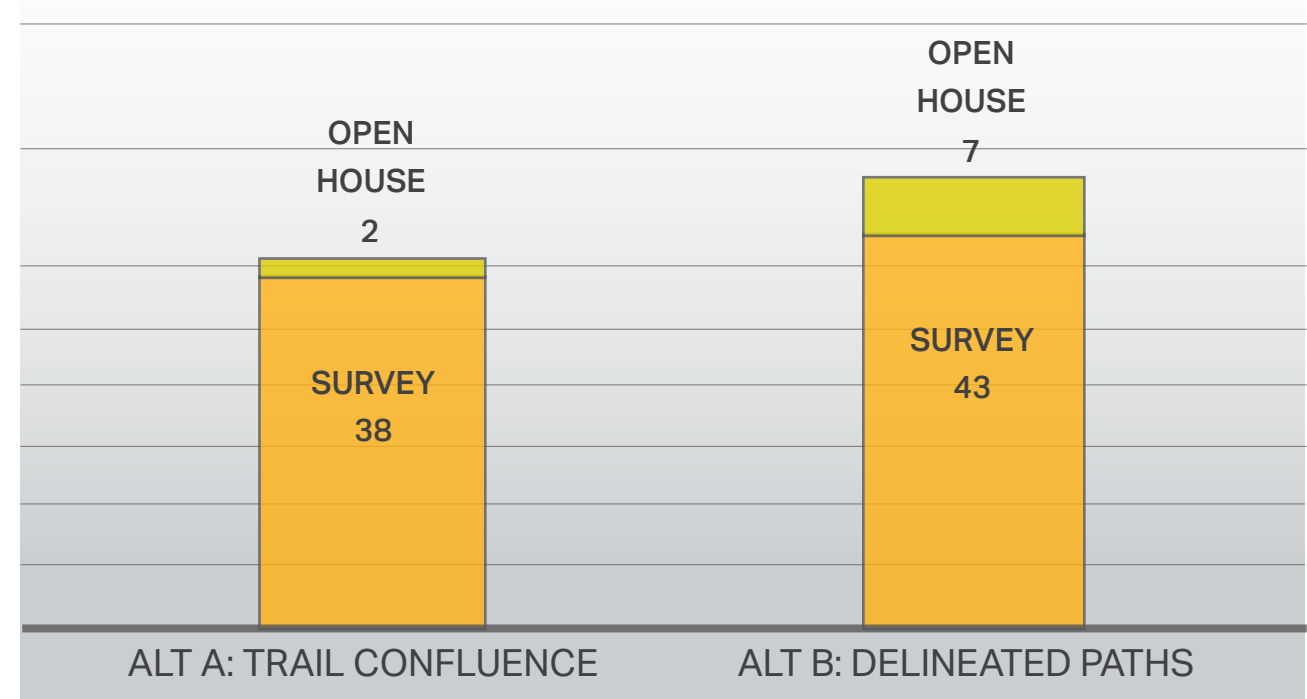

Alternative A | Trail Confluence

Alt A is more straightforward and will require **less signage** than Alt B – providing **less park clutter**. There are fewer numbers of mixing zones (compared to Alt B) and **minimized points of conflict**. (Design Team)

Alt A has no separated landscape buffer and will require **less maintenance** than Alt B. (Design Team)

“Why would a pedestrian cross a paved path from the dugout to reach another path when they can just walk on the main path and have legal priority?” (LT)

“If you need to meet the letter of the law, make a 12’ trail through the plaza and then give it a 6’ apron. Or call it a plaza. Trail, asphalt. Plaza, concrete. Two different things...**the separate trail just means you’ll have pedestrians on both trails.**” (LT)

“It **REQUIRES** anyone on the field wanting to use the bathroom to cross the trail to get to the walking trail at all different points, exactly what you don’t want to do.” (LT)

Alternative B | Delineated Paths

People who preferred option B liked it because it provided more space and ultimately the public had a **perceived notion that the separated pedestrian and bike paths provide more space**. (Design Team)

“In constrained areas **where widening a single trail is not practical**, the multi-use pathway separates into **two trails** so walkers and bikes can still be separated.” (LT)

Restroom Facilities & Playfields Node / Improvement Matrix

	PROPOSED IMPROVEMENT	CAPACITY	ACCESSIBILITY	SAFETY	AESTHETICS
AREA 3: Restroom Facilities near Fergolia Playfields	Provide additional trail striping (channelization)		✓	✓	
	Expand pavement in high traffic areas	✓	✓	✓	✓
	Increase shared-use path width	✓	✓	✓	
	Reestablish 2' shoulders along trail	✓	✓	✓	
	Trim back overgrown vegetation	✓	✓	✓	✓
	Provide defined amenity nodes	✓	✓	✓	
	Improve ADA access		✓	✓	
	Improve wayfinding signage		✓	✓	
	Add educational signage for lower speed control	✓		✓	
	Improve pedestrian/bicyclist traffic control devices				



Channelization

Expand Pavement in High Traffic Areas

Low/Informal Fencing

Educational Signage for Speed Control

Project / Phasing



○ IMPROVEMENT AREAS

↔ TRAIL



- Trail improvements to make pedestrian and bicycle movements safer and more predictable at key locations.
 - Bike traffic-calming measures
 - Removal of existing bollards
- Signage and pavement markings
- Restoring trail shoulders
- Wayfinding signage and markings
 - Signage for bypass routes for high-speed cyclists
- Channeling cross-trail traffic
- Art and placemaking elements
- Vegetation management for sight distance





PARKS & RECREATION COMMISSION STAFF REPORT

Item 3
April 7, 2022
Regular Business

AGENDA ITEM INFORMATION

TITLE:	King County Library System- Presentation Review	<input checked="" type="checkbox"/> Discussion Only <input type="checkbox"/> Action Needed: <input type="checkbox"/> Motion <input type="checkbox"/> Ordinance <input type="checkbox"/> Resolution
RECOMMENDED ACTION:	Discuss presentation and provide consensus on follow up questions to KCLS and inform on next steps.	

STAFF:	Ryan Daly
COUNCIL LIAISON:	Craig Reynolds
EXHIBITS:	1. KCLS- Mercer Island Branch Foot Traffic

SUMMARY

During the [March 3](#) Parks and Recreation Commission Meeting, King County Library System (KCLS) Executive Director Lisa Rosenblum (and KCLS staff) provided a presentation on the operational status of KCLS. This presentation also informed on pandemic associated impacts to KCLS and the current schedule for the Mercer Island Branch.

Commissioners discussed, with KCLS staff, the current schedule and operational changes. Commissioners demonstrated an interest in receiving additional information on how and why operational hours and days were established and what community input was solicited. Following the meeting KCLS provided to the PRC a spreadsheet depicting foot traffic by day of the week for years 2018, 2019, and 2020 up until the pandemic-related closure (Exhibit 1).

Tonight, Commissioners will discuss the presentation, and if desired, request staff obtain additional information from KCLS.

RECOMMENDATION

Discuss KCLS presentation, provide consensus on follow up questions to KCLS staff and inform on next steps.

KCLS- Mercer Island Branch Foot Traffic
Data Developed by KCLS

	Sun.	Mon.	Tues.	Wed.	Thur.	Fri.	Sat.
2020	2564	2992	3818	4335	5082	3638	4397
JAN	1287	1470	1902	2153	2806	2048	1916
FEB	1277	1522	1916	2182	2276	1590	2481
2019	17548	27598	29650	32175	28401	21608	23803
JAN	1576	1749	2320	3179	2836	1726	2069
FEB	1026	519	1331	1979	2097	1488	1412
MAR	1828	2254	2469	2510	2403	2211	2589
APR	1340	2950	3350	2575	2268	1716	1841
MAY	1353	1827	2726	3489	3033	1960	1843
JUN	1666	2783	2476	2797	2359	1755	2431
JUL	1177	3725	3176	3397	1805	1787	1671
AUG	1254	2657	2510	2613	3003	2189	1980
SEP	1804	2436	2453	2571	2229	1765	1986
OCT	1484	2247	2799	3022	2772	1667	1883
NOV	1547	1896	2197	2227	1571	1809	2257
DEC	1493	2555	1843	1816	2025	1535	1841
2018	18451	30352	32546	35117	30470	23877	25171
JAN	1692	1920	3196	3440	2307	1763	2084
FEB	1351	1970	2221	2552	2304	1732	1730
MAR	1646	2681	2623	2798	2991	2161	2427
APR	1709	3343	2441	2602	2627	1878	1999
MAY	1238	2047	3338	3993	3132	1839	1846
JUN	1385	2948	2608	3111	2335	2721	2614
JUL	1714	3847	3241	2121	2697	2155	1884
AUG	1265	2670	2587	3570	3017	2468	1728
SEP	2214	1944	2773	2865	2367	1805	2640
OCT	1450	3077	3247	3159	2293	1755	1892
NOV	1119	2150	2542	2591	2482	2050	1867
DEC	1668	1755	1729	2315	1918	1550	2460

Parks & Recreation Commission

2022 Planning Schedule

1st Thursday of Month- Regular Meetings



Updated: March 31, 2022

Meeting Date	Meeting Type	Agenda Item
7-Apr	Regular	First Reading: Aubrey Davis Trail Safety Improvements 30% Design KCLS Presentation Review (Discussion)
Apr. TBD	Special	Bike Skills Area
5-May	Regular	Chair/Vice Chair Elections-
		Policy: Athletic Field Use & Allocation
		Second Reading: Aubrey Davis Trail Safety Improvements 30% Design
		2021 Year-End Review/ 2022 Service Update (Moved from March)
2-Jun	Joint Mtg w/ AC	2022 Mid-year service update-
		Chair/Vice Chair Elections
		2023/2024 Parks & Recreation Proposed Services
		Climate Action Plan Update
		Policy: Athletic Field Use & Allocation (Cont. if needed)
7-Jul	Regular	Bylaws Review
August	No Meetings Summer Break	
1-Sep	Regular	2023/2024 Parks & Recreation Proposed Services (cont.)-
6-Oct	Regular	
3-Nov	Regular	
1-Dec	Regular	Check-in update: Facility Allocation and Use Policy
		PRC Year in Review
		2023 PRC Planning Schedule/ Work Plan

Item Type	Items to be scheduled
Policy	MISD Interlocal Agreement (Q3 or Q4)
Policy	Park Asset Donations and recognition: Benches, tables, plaques (Q4)
Policy	Special Usage of Parks (Q4)
Policy	Park Code/Rules Updates- signage in parks, appropriate uses of space, etc. (Q4)
Project	Luther Docks Project (TBD)
Other	(various) Master Plan completion updates (Q4)

Other	Potential levy renewal discussion (Q3/Q4)
Annual Agenda Items	
KCLS- Mercer Island Branch Operations Update (March)	
PROS Plan Goals/Implementation Update (May)	
Annual PRC Chair/Vice-Chair Elections (May)	
PROS Plan Goals/Implementation Update (June)	
Annual Bylaws Review (July)	
Various CIP Recommendations (TBD)	