



Agenda

Special Mangum Utility Authority Meeting

April 10, 2026

4:30 PM, or immediately following City Commission Meeting
City Administration Building at 130 N Oklahoma Ave.

In accordance with the Americans with Disabilities Act, persons who need accommodation in order to attend or participate in this meeting should contact City Hall at 580-782-2250 no less than 48 hours prior to the meeting in order to request such assistance.

The Trustees of the Mangum Utility Authority will meet in special session on April 10, 2026, immediately following the City of Mangum Commission meeting for such business as shall come before said Trustees.

CALL TO ORDER

ROLL CALL AND DECLARATION OF QUORUM

CONSENT AGENDA

The following items are considered to be routine and will be enacted by one motion. There will be no separate discussion of these items unless a Board member (or a community member through a Board member) so requests, in which case the item will be removed from the Consent Agenda and considered separately. If any item involves a potential conflict of interest, Board members should so note before adoption of the Consent Agenda.

1. Approve March 3, 2026, meeting minutes as presented
2. Approve February 2026 financials for all funds
3. Approve March 2026 claims
4. Approve March 2026 Bills
5. Approve April 2026 estimated payroll

FURTHER DISCUSSION

REMARKS

Remarks or inquiries by the audience not pertaining to any item on the agenda.

ORDINANCES & RESOLUTIONS

6. Discussion and possible action to approve Resolution No 2026-0410-01 amending the FY 2026 budget for Wastewater Miscellaneous in the amount of \$7,385.00 for Hope Automation to install a remote monitoring, control, alarm, and data logging system to the wastewater pump controls to stay compliant with DEQ. (Steve Kyle)

OTHER ITEMS

7. Discussion and possible action to review and accept the best and most responsible quote in regard to replacing the chain link fence around the water tower. To be paid out of already budgeted funds. (Steve Kyle)

8. Discussion and possible action to approve invoice #226013-2 to Myers Engineering for the Electric System Replacement Project in the amount of \$5,910.00.
9. Discussion and possible action to approve reimbursement payment via direct deposit made to The City of Mangum by ODOT in the amount of \$6,831.50 for the payment of invoice #224031-6 to Myers Engineering for Powerline/ Relocation on SH-283.
10. Discussion and possible action to approve reimbursement payment via direct deposit made to The City of Mangum by ODOT in the amount of \$2,125.50 for the payment of invoice #224016-12 to Myers Engineering for the Waterline/ Relocation on SH-283.

STAFF AND BOARD REMARKS

Remarks or inquiries by the governing body members, City Manager, City Attorney or City Employees

ADJOURN

Motion to Adjourn

Duly filed and posted at 4:00 p.m. on April 8, 2026, by the City Clerk.

Brittany McClintock, Interim City Clerk



Mangum Utility Authority Meeting

March 03, 2026 at 6:00 PM, or immediately following City Commission City Administration Building at 130 N Oklahoma Ave.

Record of Minutes

The Trustees of the Mangum Utility Authority will meet in regular session on March 3, 2026, immediately following the City of Mangum Commission meeting for such business as shall come before said Trustees.

CALL TO ORDER

Chairman Scott called the meeting to order at 9:05 p.m.

ROLL CALL AND DECLARATION OF QUORUM

PRESENT

Trustee Dirk Hamon
Trustee Michelle Huckabay
Chairman Mary Jane Scott
Trustee Cooper Earls

CONSENT AGENDA

The following items are considered to be routine and will be enacted by one motion. There will be no separate discussion of these items unless a Board member (or a community member through a Board member) so requests, in which case the item will be removed from the Consent Agenda and considered separately. If any item involves a potential conflict of interest, Board members should so note before adoption of the Consent Agenda.

Motion to approve consent agenda as presented.

Motion made by Trustee Hamon, Seconded by Trustee Huckabay.

Voting Yea: Trustee Hamon, Trustee Huckabay, Chairman Scott, Trustee Earls

1. Approve January 6, 2026, meeting minutes as presented
2. Approve January 2026 financials for all funds
3. Approve February 2026 claims
4. Approve February 2026 Bills
5. Approve March 2026 estimated payroll

FURTHER DISCUSSION

No further discussion.

REMARKS

Remarks or inquiries by the audience not pertaining to any item on the agenda.

No public remarks.

ORDINANCES & RESOLUTIONS

6. Discussion and possible action to approve Resolution No. 2026-0303-01 for The City of Mangum to hold a special election on June 16, 2026.

Motion to approve Resolution No. 2026-0303-01.

Motion made by Trustee Hamon, Seconded by Trustee Earls.

Voting Yea: Trustee Hamon, Trustee Huckabay, Chairman Scott, Trustee Earls

7. Discussion and possible action to approve Resolution No. 2026-0303-02 adding Mary Jane Scott to the bank accounts.

Motion to approve Resolution No. 2026-0303-02.

Motion made by Trustee Hamon, Seconded by Trustee Earls.

Voting Yea: Trustee Hamon, Trustee Huckabay, Chairman Scott, Trustee Earls

OTHER ITEMS

8. Discussion and possible action to approve an Electric Meter System Replacement project with review of funding options.

Motion to approve same decision made in City Commission Meeting.

Motion made by Trustee Hamon, Seconded by Trustee Huckabay.

Voting Yea: Trustee Hamon, Trustee Huckabay, Chairman Scott, Trustee Earls

9. Discussion and possible action to approve Myers Engineering Contract for the Electric System Replacement Project.

Motion to approve.

Motion made by Trustee Huckabay, Seconded by Trustee Earls.

Voting Yea: Trustee Hamon, Trustee Huckabay, Chairman Scott, Trustee Earls

10. DISCUSSION AND POSSIBLE ACTION WITH RESPECT TO A RESOLUTION OF THE MANGUM UTILITIES AUTHORITY (THE "BORROWER") APPROVING AND AUTHORIZING A CLEAN WATER SRF LOAN FROM THE OKLAHOMA WATER RESOURCES BOARD IN THE TOTAL AGGREGATE PRINCIPAL AMOUNT OF NOT-TO-EXCEED \$999,999.00; APPROVING THE ISSUANCE OF ITS CLEAN WATER SRF PROMISSORY NOTE IN THE TOTAL AGGREGATE PRINCIPAL AMOUNT OF NOT-TO-EXCEED \$999,999.00, SECURED BY A PLEDGE OF REVENUES AND AUTHORIZING ITS EXECUTION; APPROVING AND AUTHORIZING THE EXECUTION OF A LOAN AGREEMENT FOR CLEAN WATER SRF LOAN OR IN THE ALTERNATIVE A FUNDING AGREEMENT; DESIGNATING A LOCAL TRUSTEE AND APPROVING AND AUTHORIZING THE EXECUTION OF A TRUST AGREEMENT IF REPAYMENT IS REQUIRED; APPROVING AND AUTHORIZING THE EXECUTION OF A MORTGAGE WITH POWER OF SALE AND SECURITY AGREEMENT IF PAYMENT IS REQUIRED;

RATIFYING AND CONFIRMING AND/OR AUTHORIZING AND APPROVING A LEASE AGREEMENT BETWEEN THE CITY OF MANGUM, OKLAHOMA (THE "CITY") AND THE BORROWER RELATED TO THE CITY'S UTILITY SYSTEMS; APPROVING VARIOUS COVENANTS; APPROVING AND AUTHORIZING APPLICATION TO THE OKLAHOMA WATER RESOURCES BOARD; APPROVING AND AUTHORIZING PROFESSIONAL SERVICES AGREEMENTS; APPROVING AND AUTHORIZING THE ESTABLISHMENT OF A PROJECT COSTS DISBURSEMENT ACCOUNT AND THE PAYMENT OF FEES AND EXPENSES.

Motion to approve.

Motion made by Trustee Hamon, Seconded by Trustee Huckabay.

Voting Yea: Trustee Hamon, Trustee Huckabay, Chairman Scott, Trustee Earls

11. Discussion and possible action to renew the Interlocal Agreement for the Operation of Emergency Medical Services between the City of Mangum and the Greer County Special Ambulance Service District.

Motion to renew with no amendments.

Motion made by Trustee Hamon, Seconded by Trustee Earls.

Voting Yea: Trustee Hamon, Trustee Huckabay, Chairman Scott, Trustee Earls

12. Discussion and Possible Action to approve Adams Equipment Company Proposal No. 13252 to complete a turnkey demo of 6 power plant engines by removing a concrete wall and replacing it when done with a steel structure to re-enclose the wall and paying the City of Mangum a sum of \$20,000.00 for the engines.

Motion to approve proposal number 13252.

Motion made by Trustee Hamon, Seconded by Trustee Huckabay.

Voting Yea: Trustee Hamon, Trustee Huckabay, Chairman Scott, Trustee Earls

STAFF AND BOARD REMARKS

Remarks or inquiries by the governing body members, City Manager, City Attorney or City Employees

No remarks.

NEW BUSINESS

Discussion and possible action on any new business which has arisen since the posting of the Agenda that could not have been reasonably foreseen prior to the time of the posting (25 O.S. 311-10)

No new business.

ADJOURN

Motion to Adjourn

Motion to adjourn at 9:13 p.m.

Motion made by Trustee Huckabay, Seconded by Trustee Earls.

Voting Yea: Trustee Hamon, Trustee Huckabay, Chairman Scott, Trustee Earls

Duly filed and posted at 3:00 p.m. on March 2, 2026, by the City Clerk.

Mary Jane Scott, Chairman

Brittany McClintock, Secretary

CITY OF MANGUM
 FINANCIAL STATEMENT (UNAUDITED)
 AS OF: FEBRUARY 28TH, 2026

Item 2.

01 -GENERAL FUND

66.67% OF YEAR COMPLETED

| ACCOUNT NO# | ACCOUNT NAME | ANNUAL BUDGET | CURRENT PERIOD | Y-T-D ACTUAL | % OF BUDGET | Y-T-D ENCUMB. | BUDGET BALANCE |
|----------------------------|---------------------------------------|---------------|----------------|--------------|-------------|---------------|----------------|
| REVENUE SUMMARY | | | | | | | |
| | ALL REVENUE | 2,330,926.05 | 220,669.47 | 2,280,422.63 | 97.83 | 0.00 | 50,503.42 |
| | *** TOTAL REVENUES *** | 2,330,926.05 | 220,669.47 | 2,280,422.63 | 97.83 | 0.00 | 50,503.42 |
| EXPENDITURE SUMMARY | | | | | | | |
| | 01-CITY COMMISSION | 11,485.00 | 525.82 | 7,661.66 | 66.71 | 0.00 | 3,823.34 |
| | 02-ADMINISTRATION | 352,562.00 | 232,293.61 | 400,745.39 | 113.70 | 109.25 | (48,292.64) |
| | 03-CITY ATTORNEY | 28,950.00 | 3,007.01 | 19,704.47 | 68.06 | 0.00 | 9,245.53 |
| | 04-MUNICIPAL JUDGE | 3,260.00 | 0.00 | 0.00 | 0.00 | 0.00 | 3,260.00 |
| | 05-POLICE DEPARTMENT | 551,655.00 | 32,729.14 | 333,468.53 | 60.59 | 780.62 | 217,405.85 |
| | 06-FIRE DEPARTMENT | 432,750.00 | 32,007.32 | 384,006.16 | 88.74 | 0.00 | 48,743.84 |
| | 07-STREET DEPARTMENT | 193,625.00 | 11,335.95 | 86,764.21 | 44.81 | 7.50 | 106,853.29 |
| | 08-PARK DEPARTMENT | 201,375.00 | 31,208.07 | 135,821.09 | 67.45 | 0.00 | 65,553.91 |
| | 09-CEMETERY | 2,470.00 | 71.66 | 1,152.85 | 46.67 | 0.00 | 1,317.15 |
| | 11-LIBRARY | 134,969.00 | 11,447.32 | 116,423.14 | 86.26 | 0.00 | 18,545.86 |
| | 12-COMMUNITY SERVICES DEP | 79,360.00 | 89,862.42 | 240,190.24 | 305.43 | 2,200.00 | (163,030.24) |
| | 13-AIRPORT | 0.00 | 99,969.03 | 99,969.03 | 0.00 | 0.00 | (99,969.03) |
| | 14-SWIMMING POOL | 0.00 | 28,944.02 | 28,944.02 | 0.00 | 0.00 | (28,944.02) |
| | 16-CODE ENFORCEMENT OFFI | 96,205.00 | 9,733.46 | 42,795.46 | 44.55 | 60.00 | 53,349.54 |
| | 17-INFORMATION TECHNOLOGY | 120,745.00 | 6,161.85 | 86,003.66 | 71.23 | 0.00 | 34,741.34 |
| | 18-ANIMAL CONTROL | 56,505.00 | 4,602.46 | 15,741.95 | 28.04 | 103.50 | 40,659.55 |
| | 19-SHOP MAINTENANCE | 64,605.00 | 6,013.19 | 38,273.22 | 60.20 | 619.00 | 25,712.78 |
| | 20-CUSTOMER SERVICE | 0.00 | 0.00 | 0.00 | 0.00 | 0.00 | 0.00 |
| | *** TOTAL EXPENDITURES *** | 2,330,521.00 | 599,912.33 | 2,037,665.08 | 87.60 | 3,879.87 | 288,976.05 |
| | *** REVENUE OVER/(UNDER) EXPENDITURES | 405.05 | (379,242.86) | 242,757.55 | 974.86 | (3,879.87) | (238,472.63) |

CITY OF MANGUM
 FINANCIAL STATEMENT (UNAUDITED)
 AS OF: FEBRUARY 28TH, 2026

Item 2.

02 -MANGUM UTILITY AUTHORITY

66.67% OF YEAR COMPLETED

| ACCOUNT NO# | ACCOUNT NAME | ANNUAL BUDGET | CURRENT PERIOD | Y-T-D ACTUAL | % OF BUDGET | Y-T-D ENCUMB. | BUDGET BALANCE |
|----------------------------|---------------------------------------|---------------------|-------------------|---------------------|--------------|---------------|-------------------|
| REVENUE SUMMARY | | | | | | | |
| | ALL REVENUE | <u>4,687,933.50</u> | <u>329,693.72</u> | <u>3,827,787.86</u> | <u>81.65</u> | <u>0.00</u> | <u>860,145.64</u> |
| | *** TOTAL REVENUES *** | 4,687,933.50 | 329,693.72 | 3,827,787.86 | 81.65 | 0.00 | 860,145.64 |
| EXPENDITURE SUMMARY | | | | | | | |
| | 21-WATER DEPARTMENT | 510,240.00 | 43,632.93 | 595,421.87 | 116.69 | 0.00 (| 85,181.87) |
| | 22-ELECTRIC DEPARTMENT | 3,033,994.00 | 251,321.95 | 1,860,227.97 | 61.31 | 0.00 | 1,173,766.03 |
| | 23-SANITATION DEPARTMENT | 664,275.00 | 62,239.10 | 406,246.16 | 61.16 | 0.00 | 258,028.84 |
| | 24-GENERAL MANAGER | 140,505.00 | 10,683.68 | 87,463.57 | 62.25 | 0.00 | 53,041.43 |
| | 25-WASTE WATER TREATMENT | 209,230.00 | 36,311.02 | 137,765.86 | 65.84 | 0.00 | 71,464.14 |
| | 26-PENALTY & CREDITS | 0.00 | 0.00 (| 9.75) | 0.00 | 0.00 | 9.75 |
| | 27-PUBLIC WORKS | 108,795.00 | 10,098.83 | 62,570.46 | 57.51 | 0.00 | 46,224.54 |
| | 28-POWER PLANT | 15,000.00 | 53,061.62 | 67,752.38 | 451.68 | 0.00 (| 52,752.38) |
| | 29-FUND APPLIC TRANSFERS | <u>5,000.00</u> | <u>416.67</u> | <u>3,333.32</u> | <u>66.67</u> | <u>0.00</u> | <u>1,666.68</u> |
| | *** TOTAL EXPENDITURES *** | 4,687,039.00 | 467,765.80 | 3,220,771.84 | 68.72 | 0.00 | 1,466,267.16 |
| | *** REVENUE OVER/(UNDER) EXPENDITURES | 894.50 | (138,072.08) | 607,016.02 | 860.93 | 0.00 (| 606,121.52) |

Item 3.

| P.O.# | VENDOR # | NAME | SUMMARY DESCRIPTION | DATE | INVOICE | AMOUNT |
|-------------------|----------|--|---------------------|--------|-----------|----------|
| DEPARTMENT: 02 | | ADMINISTRATION | | | | |
| 25-0402 | 99-3170 | OKLA MUNICIPAL LEAGUE | MC&T TRAINING | 3/2026 | 200009020 | 75.00 |
| 25-0449 | 99-34979 | AMAZON CAPITAL SERVICES | RETIREMENT PLAQUE | 3/2026 | 0326 | 111.01 |
| 25-0424 | 99-5060 | MANGUM STAR | LEGAL NOTICE | 3/2026 | 8182 | 189.80 |
| DEPARTMENT TOTAL: | | | | | | 375.81 |
| DEPARTMENT: 05 | | POLICE DEPARTMENT | | | | |
| 25-0357 | 99-34979 | AMAZON CAPITAL SERVICES | UNIFORMS | 3/2026 | 326 | 780.62 |
| 25-0390 | 99-34979 | AMAZON CAPITAL SERVICES | TACTICAL PANTS | 3/2026 | 326 | 1,910.70 |
| 25-0446 | 99-38917 | FIELDS OUTDOOR ADVENTURES | DAMMO | 3/2026 | 28788 | 1,602.00 |
| DEPARTMENT TOTAL: | | | | | | 4,293.32 |
| DEPARTMENT: 06 | | FIRE DEPARTMENT | | | | |
| 25-0458 | 99-1410 | O'REILLY AUTOMOTIVE, INC. | BATTERIES | 3/2026 | 8249 | 518.43 |
| 25-0410 | 99-15000 | JIM GALLAGHER dba GALLAGHERDOOR REPAIR | | 3/2026 | FIRE | 403.95 |
| 25-0450 | 99-2390 | MANGUM ACE HOME CENTER | STATEMENT | 3/2026 | 0326 | 148.45 |
| DEPARTMENT TOTAL: | | | | | | 1,070.83 |
| DEPARTMENT: 07 | | STREET DEPARTMENT | | | | |
| 25-0451 | 99-1800 | C L BOYD COMPANY, INC | CLAMPS | 3/2026 | 9367 | 20.44 |
| DEPARTMENT TOTAL: | | | | | | 20.44 |
| DEPARTMENT: 08 | | PARK DEPARTMENT | | | | |
| 25-0461 | 99-1410 | O'REILLY AUTOMOTIVE, INC. | STATEMENT | 3/2026 | 032026 | 79.91 |
| 25-0450 | 99-2390 | MANGUM ACE HOME CENTER | STATEMENT | 3/2026 | 0326 | 199.35 |
| 25-0422 | 99-34979 | AMAZON CAPITAL SERVICES | CLUTCH DRUM KIT | 3/2026 | 030326 | 15.95 |
| 25-0419 | 99-36200 | WESTERN EQUIPMENT LLC | FORCED RE-GEN | 3/2026 | 4275 | 552.66 |
| 25-0453 | 99-36200 | WESTERN EQUIPMENT LLC | SOCKET & FITTING | 3/2026 | 5532 | 12.28 |
| 25-0408 | 99-5040 | HELENA CHEMICAL CO | CHEMICALS | 3/2026 | 12048764 | 405.00 |
| DEPARTMENT TOTAL: | | | | | | 1,265.15 |

Item 3.

| P.O.# | VENDOR # | NAME | SUMMARY DESCRIPTION | DATE | INVOICE | AMOUNT |
|----------------|----------|---------------------------|---------------------|--------|---------|-------------------|
| DEPARTMENT: 16 | | | | | | |
| 25-0461 | 99-1410 | O'REILLY AUTOMOTIVE, INC. | STATEMENT | 3/2026 | 032026 | 13.98 |
| | | | | | | DEPARTMENT TOTAL: |
| | | | | | | 13.98 |
| DEPARTMENT: 17 | | | | | | |
| 25-0443 | 99-34979 | AMAZON CAPITAL SERVICES | MONITORS | 3/2026 | 030326 | 1,499.97 |
| | | | | | | DEPARTMENT TOTAL: |
| | | | | | | 1,499.97 |
| DEPARTMENT: 18 | | | | | | |
| 25-0329 | 99-37674 | ARK VET CLINIC | DOG EUTH | 3/2026 | 34777 | 53.00 |
| 25-0467 | 99-37674 | ARK VET CLINIC | DOG EUTH | 3/2026 | 35417 | 28.50 |
| | | | | | | DEPARTMENT TOTAL: |
| | | | | | | 81.50 |
| DEPARTMENT: 19 | | | | | | |
| 25-0450 | 99-2390 | MANGUM ACE HOME CENTER | STATEMENT | 3/2026 | 0326 | 26.12 |
| 25-0375 | 99-34979 | AMAZON CAPITAL SERVICES | DIAGNOSTIC TOOL | 3/2026 | 032026 | 619.00 |
| 25-0414 | 99-34979 | AMAZON CAPITAL SERVICES | SHOP TOOL | 3/2026 | 74H7 | 16.13 |
| | | | | | | DEPARTMENT TOTAL: |
| | | | | | | 661.25 |
| | | | | | | FUND TOTAL: |
| | | | | | | 9,282.25 |

Item 3.

| P.O.# | VENDOR # | NAME | SUMMARY DESCRIPTION | DATE | INVOICE | AMOUNT |
|-------------------|----------|----------------------------|-----------------------|--------|----------|-----------|
| DEPARTMENT: 21 | | WATER DEPARTMENT | | | | |
| 25-0428 | 99-1410 | O'REILLY AUTOMOTIVE, INC. | BRAKE PARTS | 3/2026 | 396128 | 271.00 |
| 25-0461 | 99-1410 | O'REILLY AUTOMOTIVE, INC. | STATEMENT | 3/2026 | 032026 | 128.27 |
| 25-0421 | 99-22250 | BLAIR TIRE & FEED, LLC | TIRE REPAIR | 3/2026 | 16935 | 225.00 |
| 25-0450 | 99-2390 | MANGUM ACE HOME CENTER | STATEMENT | 3/2026 | 0326 | 195.87 |
| 25-0396 | 99-38433 | TULSA WINWATER CO | 12" BELL REPAIR CLAMP | 3/2026 | 03417401 | 4,393.68 |
| 25-0418 | 99-38433 | TULSA WINWATER CO | WATER LEAK PARTS | 3/2026 | 03417501 | 4,211.53 |
| 25-0393 | 99-38829 | CONSOLIDATED PIPE & SUPPLY | REPAIR CLAMP | 3/2026 | 2053507 | 1,403.76 |
| 25-0409 | 99-38829 | CONSOLIDATED PIPE & SUPPLY | SOCKET SET | 3/2026 | 2053581 | 402.41 |
| 25-0423 | 99-38829 | CONSOLIDATED PIPE & SUPPLY | REPAIR CLAMPS | 3/2026 | 2053654 | 4,432.94 |
| 25-0388 | 99-6420 | DITCH WITCH OF OKLAHOMA | NOZZLE & VALVE | 3/2026 | 96481 | 363.46 |
| DEPARTMENT TOTAL: | | | | | | 16,027.92 |
| DEPARTMENT: 22 | | ELECTRIC DEPARTMENT | | | | |
| 25-0461 | 99-1410 | O'REILLY AUTOMOTIVE, INC. | STATEMENT | 3/2026 | 032026 | 73.71 |
| 25-0450 | 99-2390 | MANGUM ACE HOME CENTER | STATEMENT | 3/2026 | 0326 | 78.63 |
| 25-0391 | 99-38862 | PALFINGER USA LLC | BUCKET TRUCK REPAIR | 3/2026 | 950464 | 1,480.81 |
| 25-0465 | 99-38928 | DANNY'S SERVICE CENTER | AC RECHARGE | 3/2026 | 740742 | 712.59 |
| DEPARTMENT TOTAL: | | | | | | 2,345.74 |
| DEPARTMENT: 23 | | SANITATION | | | | |
| 25-0406 | 99-21870 | FAIRBANKS SCALES | SCALE CALIBRATION | 3/2026 | 1761891 | 1,460.00 |
| 25-0450 | 99-2390 | MANGUM ACE HOME CENTER | STATEMENT | 3/2026 | 0326 | 11.68 |
| 25-0403 | 99-6850 | CITY OF ALTUS | LANDFILL FEB 26 | 3/2026 | 90744 | 1,445.90 |
| 25-0466 | 99-6850 | CITY OF ALTUS | LANDFILL FEES | 3/2026 | 90829 | 1,971.10 |
| DEPARTMENT TOTAL: | | | | | | 4,888.68 |
| DEPARTMENT: 24 | | CITY MANAGER | | | | |
| 25-0413 | 99-36618 | BIG DOG CUSTOM SPORTSWEAR | UNIFORMS | 3/2026 | 29155 | 127.00 |
| DEPARTMENT TOTAL: | | | | | | 127.00 |

Item 3.

| P.O.# | VENDOR # | NAME | SUMMARY DESCRIPTION | DATE | INVOICE | AMOUNT |
|-------------------|----------|---------------------------|---|--------|---------|-----------|
| DEPARTMENT: 25 | | | | | | |
| 25-0429 | 99-2460 | J SYSTEMS | WASTE WATER TREATMENT WASTE WATER SUPPLIES | 3/2026 | 127247 | 717.00 |
| DEPARTMENT TOTAL: | | | | | | 717.00 |
| DEPARTMENT: 27 | | | | | | |
| 25-0461 | 99-1410 | O'REILLY AUTOMOTIVE, INC. | CITY SUPERINTENDENT STATEMENT | 3/2026 | 032026 | 42.42 |
| DEPARTMENT TOTAL: | | | | | | 42.42 |
| FUND TOTAL: | | | | | | 24,148.76 |

Item 3.

| P.O.# | VENDOR # | NAME | SUMMARY DESCRIPTION | DATE | INVOICE | AMOUNT |
|------------------------------------|----------|----------------------------------|---------------------|--------|---------|----------|
| DEPARTMENT: 45 STREET & ALLEY | | | | | | |
| 25-0381 | 99-2340 | RONNIE MADDOX | CLAY | 3/2026 | 194402 | 600.00 |
| 25-0450 | 99-2390 | MANGUM ACE HOME CENTER | STATEMENT | 3/2026 | 0326 | 60.60 |
| 25-0380 | 99-33923 | LOGAN COUNTY ASPHALT CO | ASPHALT | 3/2026 | 27719 | 525.00 |
| 25-0365 | 99-37454 | OROSCO CONCRETE & CONSTRUCTLABOR | | 3/2026 | 89 | 1,000.00 |
| DEPARTMENT TOTAL: | | | | | | 2,185.60 |
| FUND TOTAL: | | | | | | 2,185.60 |

Item 3.

| P.O.# | VENDOR # | NAME | SUMMARY DESCRIPTION | DATE | INVOICE | AMOUNT |
|--------------------------------|----------|------------------------|---------------------|--------|---------|----------|
| DEPARTMENT: 60 FIRE DEPT GRANT | | | | | | |
| 25-0430 | 99-22250 | BLAIR TIRE & FEED, LLC | TIRES | 3/2026 | 17115 | 1,487.40 |
| DEPARTMENT TOTAL: | | | | | | 1,487.40 |
| FUND TOTAL: | | | | | | 1,487.40 |

Item 3.

| P.O.# | VENDOR # | NAME | SUMMARY DESCRIPTION | DATE | INVOICE | AMOUNT |
|--|----------|------------------------|---------------------|--------|---------|--------|
| DEPARTMENT: 13 AIRPORT OPERATIONS FUND | | | | | | |
| 25-0450 | 99-2390 | MANGUM ACE HOME CENTER | STATEMENT | 3/2026 | 0326 | 90.53 |
| DEPARTMENT TOTAL: | | | | | | 90.53 |
| FUND TOTAL: | | | | | | 90.53 |

Item 3.

| P.O.# | VENDOR # | NAME | SUMMARY DESCRIPTION | DATE | INVOICE | AMOUNT |
|------------------------------------|----------|-------------------------|---------------------|--------|---------|-----------|
| DEPARTMENT: 14 MUNICIPAL POOL | | | | | | |
| 25-0450 | 99-2390 | MANGUM ACE HOME CENTER | STATEMENT | 3/2026 | 0326 | 239.21 |
| 25-0385 | 99-3230 | KAY ELECTRIC | SLIDE PUMP REPAIR | 3/2026 | 108789 | 1,746.44 |
| 25-0432 | 99-34979 | AMAZON CAPITAL SERVICES | MISC POOL SUPPLIES | 3/2026 | 030126 | 146.74 |
| DEPARTMENT TOTAL: | | | | | | 2,132.39 |
| FUND TOTAL: | | | | | | 2,132.39 |
| GRAND TOTAL: | | | | | | 39,326.93 |

G / L R E C A P

Item 3.

| PERIOD | G/L | ACCOUNT | NAME | AMOUNT | TOTAL |
|-----------------------|-----|----------|----------------------------|-----------|-----------|
| 3/2026 | 01 | 502-9101 | TRAINING | 75.00 | |
| 3/2026 | 01 | 502-9104 | MATERIALS & SUPPLIES | 111.01 | |
| 3/2026 | 01 | 502-9129 | PROFESSIONAL FEES | 189.80 | |
| 3/2026 | 01 | 505-9103 | AMMO | 1,602.00 | |
| 3/2026 | 01 | 505-9113 | GRANT EXPENSE | 2,691.32 | |
| 3/2026 | 01 | 506-9102 | REPAIRS & REPLACEMENTS | 1,070.83 | |
| 3/2026 | 01 | 507-9104 | MATERIALS & SUPPLIES | 20.44 | |
| 3/2026 | 01 | 508-9102 | REPAIRS & REPLACEMENTS | 28.23 | |
| 3/2026 | 01 | 508-9104 | MATERIALS & SUPPLIES | 604.35 | |
| 3/2026 | 01 | 508-9106 | FUEL & OIL | 71.98 | |
| 3/2026 | 01 | 508-9108 | VEHICLE MAINTENANCE | 560.59 | |
| 3/2026 | 01 | 516-9108 | VEHICLE MAINTENANCE | 13.98 | |
| 3/2026 | 01 | 517-9111 | CAPITAL IMPROVEMENTS | 1,499.97 | |
| 3/2026 | 01 | 518-9102 | REPAIRS & REPLACEMENTS | 28.50 | |
| 3/2026 | 01 | 518-9104 | MATERIALS & SUPPLIES | 53.00 | |
| 3/2026 | 01 | 519-9105 | TOOLS | 635.13 | |
| 3/2026 | 01 | 519-9200 | Other Services/Charges | 26.12 | 9,282.25 |
| 3/2026 | 02 | 521-9102 | REPAIRS & REPLACEMENTS | 859.46 | |
| 3/2026 | 02 | 521-9104 | MATERIALS & SUPPLIES | 15,040.19 | |
| 3/2026 | 02 | 521-9106 | FUEL & OIL | 73.98 | |
| 3/2026 | 02 | 521-9108 | VEHICLE MAINTENANCE | 54.29 | |
| 3/2026 | 02 | 522-9102 | REPAIRS & REPLACEMENT | 2,031.59 | |
| 3/2026 | 02 | 522-9104 | MATERIALS & SUPPLIES | 58.89 | |
| 3/2026 | 02 | 522-9106 | FUEL & OIL | 67.98 | |
| 3/2026 | 02 | 522-9108 | VEHICLE MAINTENANCE | 187.28 | |
| 3/2026 | 02 | 523-9129 | PROFESSIONAL FEES | 1,460.00 | |
| 3/2026 | 02 | 523-9163 | IESI PAYMENT | 1,971.10 | |
| 3/2026 | 02 | 523-9165 | LANDFILL EXPENSE | 1,445.90 | |
| 3/2026 | 02 | 523-9201 | Other Services/Charges | 11.68 | |
| 3/2026 | 02 | 524-9104 | MATERIALS & SUPPLIES | 127.00 | |
| 3/2026 | 02 | 525-9104 | MATERIALS & SUPPLIES | 717.00 | |
| 3/2026 | 02 | 527-9108 | VEHICLE MAINTENANCE | 42.42 | 24,148.76 |
| 3/2026 | 18 | 545-9110 | MISCELLANEOUS | 2,185.60 | 2,185.60 |
| 3/2026 | 19 | 560-9910 | OPERATIONAL GRANT EXPENSES | 1,487.40 | 1,487.40 |
| 3/2026 | 24 | 513-9200 | Other Services/Charges | 90.53 | 90.53 |
| 3/2026 | 40 | 514-9104 | MATERIALS & SUPPLIES | 146.74 | |
| 3/2026 | 40 | 514-9111 | CAPITAL IMPROVEMENTS | 1,746.44 | |
| 3/2026 | 40 | 514-9200 | Other Services/Charges | 239.21 | 2,132.39 |
| GRAND TOTAL ESTIMATE: | | | | 0.00 | |
| GRAND TOTAL ACTUAL: | | | | 39,326.93 | |
| REPORT TOTAL: | | | | 39,326.93 | |

Item 4.

| DEPARTMENT | FUND | VENDOR NAME | DESCRIPTION | AMOUNT | | |
|-----------------------------|------------------|--|--|----------------------------|----------------|-----------|
| NON-DEPARTMENTAL | GENERAL FUND | GREAT PLAINS BANK | FEDERAL WITHHOLDING | 1,442.16 | | |
| | | | FEDERAL WITHHOLDING | 1,412.31 | | |
| | | | FICA TAXES | 1,651.73 | | |
| | | | FICA TAXES | 1,735.18 | | |
| | | | MEDICARE TAXES | 456.53 | | |
| | | | MEDICARE TAXES | 472.96 | | |
| | | OKLAHOMA TAX COMM - SIT | STATE INCOME TAX WITHHELD | 752.00 | | |
| | | | STATE INCOME TAX WITHHELD | 745.00 | | |
| | | OKLA PUBLIC EMP RET SYS | OKLAHOMA RETIREMENT | 386.04 | | |
| | | | OKLAHOMA RETIREMENT | 386.04 | | |
| | | | OKLAHOMA RETIREMENT | 717.93 | | |
| | | | OKLAHOMA RETIREMENT | 717.82 | | |
| | | OK POLICE PENSION | POLICE PENSION | 783.70 | | |
| | | | POLICE PENSION | 783.09 | | |
| | | OSBI | AFIS FEB 2026 | 69.44 | | |
| | | | FORENSIC FEB 2026 | 66.50 | | |
| | | AFLAC ADMINISTRATIVE SER. | AFLAC INSURANCE PRE TAX | 48.84 | | |
| | | | AFLAC INSURANCE PRE TAX | 48.84 | | |
| | | MANGUM UTILITY AUTHORITY | EMPLOYEE UTILITY BILLS | 932.68 | | |
| | | | EMPLOYEE UTILITY BILLS | 932.69 | | |
| | | OKLAHOMA UNIFORM BUILDING CODE COMMISS | OKLAHOMA UNIFORM BUILDING | 4.00 | | |
| | | | OKLA FIRE FIGHTERS PENSION & RETIREMEN | FIREMAN'S PENSION | 731.88 | |
| | | | FIREMAN'S PENSION | 723.67 | | |
| | | | CITY OF MANGUM MISC | CABLE REIMBURSEMENTS | 11.04 | |
| | | CLEET | PENALTY FEE FEB 2026 | 69.44 | | |
| | | | AMERICAN FIDELITY ASSURANCE | AMERICAN FIDELITY PRE TAX | 46.75 | |
| | | AMERICAN FIDELITY PRE TAX | | 46.75 | | |
| | | | AMERICAN FIDELITY | 112.49 | | |
| | | | AMERICAN FIDELITY | 112.49 | | |
| | | SPARKLIGHT | SPARKLIGHT | 11.03 | | |
| | | | OSEEGIB | EMPLOYEE'S MEDICAL INSURAN | 599.76 | |
| | | EMPLOYEE'S MEDICAL INSURAN | | 2,207.92 | | |
| | | | | | TOTAL: | 19,218.70 |
| | | CITY COMMISSION | GENERAL FUND | GREAT PLAINS BANK | FICA TAXES | 37.20 |
| | | | | | MEDICARE TAXES | 8.72 |
| GREER COUNTY ELECTION BOARD | ELECTION EXPENSE | | | 358.80 | | |
| | TOTAL: | | | 404.72 | | |
| ADMINISTRATION | GENERAL FUND | GREAT PLAINS BANK | FICA TAXES | 237.73 | | |
| | | | FICA TAXES | 260.56 | | |
| | | | MEDICARE TAXES | 55.60 | | |
| | | | MEDICARE TAXES | 60.94 | | |
| | | OKLA PUBLIC EMP RET SYS | OKLAHOMA RETIREMENT | 531.90 | | |
| | | | OKLAHOMA RETIREMENT | 531.90 | | |
| | | SUMMIT UTILITIES | SUMMIT UTILITIES | 547.79 | | |
| | | | BUGMASTER INC | 31.72 | | |
| | | TYLER TECHNOLOGIES, INC | INCODE 4/1/26-6/30/26 | 8,720.44 | | |
| | | | PITNEY BOWES GLOBAL FINANCIAL SERVICES | POSTAGE | 200.00 | |
| | | PERMIT POSTAGE | | 939.82 | | |
| | | CITY OF MANGUM -CASH | EOY XMAS PARTY | 100.00 | | |
| | | | TREERING WORKFORCE SOLUTIONS INC | TIMECLOCK | 4.40 | |
| | | | TIMECLOCK | 4.40 | | |
| | | | SOONER SECURITY SERVICE | SOONER SECURITY SERVICE | 39.77 | |
| | | MYERS ENGINEERING, CONSULTING | CADD LEVEL 2 | 75.00 | | |
| | | | INTERM | 75.00 | | |

| DEPARTMENT | FUND | VENDOR NAME | DESCRIPTION | AMOUNT |
|-------------------|--------------|--|-----------------------|------------|
| | | | | Item 4. |
| | | | PROJECT MANAGER | 1,125.00 |
| | | VISA | POSTAGE FOR RETURN | 109.25 |
| | | NEXT PHASE ROOFING AND CONSTRUCTION | ROOF REPLACEMENT | 106,403.83 |
| | | OSEEGIB | MEDICAL INSURANCE | 1,141.17 |
| | | | MEDICAL INSURANCE | 1,141.17 |
| | | | TOTAL: | 122,337.39 |
| CITY ATTORNEY | GENERAL FUND | GREAT PLAINS BANK | FICA TAXES | 34.63 |
| | | | MEDICARE TAXES | 8.10 |
| | | OSEEGIB | MEDICAL INSURANCE | 760.78 |
| | | | TOTAL: | 803.51 |
| POLICE DEPARTMENT | GENERAL FUND | GREAT PLAINS BANK | FICA TAXES | 512.16 |
| | | | FICA TAXES | 475.74 |
| | | | MEDICARE TAXES | 119.77 |
| | | | MEDICARE TAXES | 111.27 |
| | | OK POLICE PENSION | POLICE PENSION | 1,219.09 |
| | | | POLICE PENSION | 1,218.13 |
| | | BUGMASTER INC | BUGMASTER INC | 31.72 |
| | | TREERING WORKFORCE SOLUTIONS INC | TIMECLOCK | 8.80 |
| | | | TIMECLOCK | 8.80 |
| | | AT&T MOBILITY | CELL PHONE/MIFI X4 | 214.61 |
| | | VISA | POSTAGE | 17.20 |
| | | | FUEL | 395.02 |
| | | | FUEL | 171.47 |
| | | STACYS AUTO AND WELDING SERVICES | ENGINE OIL COOLER | 117.85 |
| | | | RADIATOR FAN ASSEMBLY | 802.60 |
| | | | OIL FILTER | 6.01 |
| | | | ENGINE OIL | 102.13 |
| | | | SHOP FEES | 15.00 |
| | | | LABOR | 1,040.00 |
| | | OSEEGIB | MEDICAL INSURANCE | 2,494.20 |
| | | | MEDICAL INSURANCE | 2,494.20 |
| | | | TOTAL: | 11,575.77 |
| FIRE DEPARTMENT | GENERAL FUND | GREAT PLAINS BANK | FICA TAXES | 157.38 |
| | | | FICA TAXES | 155.24 |
| | | | MEDICARE TAXES | 107.05 |
| | | | MEDICARE TAXES | 103.42 |
| | | SUMMIT UTILITIES | SUMMIT UTILITIES | 1,110.21 |
| | | BUGMASTER INC | BUGMASTER INC | 31.72 |
| | | OKLA FIRE FIGHTERS PENSION & RETIREMEN | FIREMAN'S PENSION | 1,138.46 |
| | | | FIREMAN'S PENSION | 1,125.70 |
| | | AT&T | AT&T | 118.26 |
| | | AT&T MOBILITY | CELL PHONE | 47.40 |
| | | VISA | STD SWAGE | 27.56 |
| | | | STD TBE NIPPLE | 3.40 |
| | | | STEEL 45 ELBOW | 22.22 |
| | | | NPT XH SWAGE | 28.76 |
| | | | FUEL | 225.65 |
| | | OSEEGIB | MEDICAL INSURANCE | 1,901.95 |
| | | | MEDICAL INSURANCE | 1,901.95 |
| | | | TOTAL: | 8,206.33 |
| STREET DEPARTMENT | GENERAL FUND | GREAT PLAINS BANK | FICA TAXES | 31.92 |
| | | | FICA TAXES | 64.48 |

| DEPARTMENT | FUND | VENDOR NAME | DESCRIPTION | AMOUNT |
|------------------------|--------------|----------------------------------|----------------------------|----------|
| | | | | Item 4. |
| | | | MEDICARE TAXES | 7.46 |
| | | | MEDICARE TAXES | 15.08 |
| | | SUMMIT UTILITIES | SUMMIT UTILITIES | 127.23 |
| | | TREERING WORKFORCE SOLUTIONS INC | TIMECLOCK | 4.40 |
| | | | TIMECLOCK | 4.40 |
| | | MANGUM REGIONAL MEDICAL CENTER | MANGUM REGIONAL MEDICAL CE | 214.00 |
| | | AT&T MOBILITY | CELL PHONE | 47.40 |
| | | VISA | STAIN REMOVER | 7.50 |
| | | | FUEL | 28.04 |
| | | | FUEL | 300.36 |
| | | | TOTAL: | 852.27 |
| PARK DEPARTMENT | GENERAL FUND | GREAT PLAINS BANK | FICA TAXES | 236.73 |
| | | | FICA TAXES | 231.63 |
| | | | MEDICARE TAXES | 55.37 |
| | | | MEDICARE TAXES | 54.18 |
| | | OKLA PUBLIC EMP RET SYS | OKLAHOMA RETIREMENT | 153.90 |
| | | | OKLAHOMA RETIREMENT | 153.90 |
| | | | OKLAHOMA RETIREMENT | 317.30 |
| | | | OKLAHOMA RETIREMENT | 317.30 |
| | | SUMMIT UTILITIES | SUMMIT UTILITIES | 190.63 |
| | | TREERING WORKFORCE SOLUTIONS INC | TIMECLOCK | 8.80 |
| | | | TIMECLOCK | 8.80 |
| | | AT&T MOBILITY | CELL PHONE | 47.40 |
| | | VISA | FUEL | 282.26 |
| | | OSEEGIB | MEDICAL INSURANCE | 1,141.17 |
| | | | MEDICAL INSURANCE | 1,141.17 |
| | | | TOTAL: | 4,340.54 |
| CEMETERY | GENERAL FUND | HARMON ELECTRIC ASSOC INC | RIVERSIDE | 2.10 |
| | | | ROSELAWN | 70.90 |
| | | CITY OF MANGUM -CASH | CEMETERY PLOT REGISTER X4 | 72.00 |
| | | | TOTAL: | 145.00 |
| LIBRARY | GENERAL FUND | GREAT PLAINS BANK | FICA TAXES | 174.95 |
| | | | FICA TAXES | 174.84 |
| | | | MEDICARE TAXES | 40.92 |
| | | | MEDICARE TAXES | 40.89 |
| | | OKLA PUBLIC EMP RET SYS | OKLAHOMA RETIREMENT | 274.37 |
| | | | OKLAHOMA RETIREMENT | 274.37 |
| | | | OKLAHOMA RETIREMENT | 106.84 |
| | | | OKLAHOMA RETIREMENT | 106.61 |
| | | SUMMIT UTILITIES | SUMMIT UTILITIES | 379.13 |
| | | BUGMASTER INC | BUGMASTER INC | 31.72 |
| | | TREERING WORKFORCE SOLUTIONS INC | TIMECLOCK | 4.40 |
| | | | TIMECLOCK | 4.40 |
| | | OSEEGIB | MEDICAL INSURANCE | 950.98 |
| | | | MEDICAL INSURANCE | 950.98 |
| | | | TOTAL: | 3,515.40 |
| COMMUNITY SERVICES DEP | GENERAL FUND | SUMMIT UTILITIES | SUMMIT UTILITIES 210100140 | 55.72 |
| | | BUGMASTER INC | BUGMASTER INC | 31.70 |
| | | | TOTAL: | 87.42 |
| CODE SAFETY ENFORCEMNT | GENERAL FUND | GREAT PLAINS BANK | FICA TAXES | 107.28 |
| | | | FICA TAXES | 107.28 |

| DEPARTMENT | FUND | VENDOR NAME | DESCRIPTION | AMOUNT |
|-------------------------------------|--------------|----------------------------------|---------------------------|----------|
| | | | | Item 4. |
| | | | MEDICARE TAXES | 25.09 |
| | | | MEDICARE TAXES | 25.09 |
| | | OKLA PUBLIC EMP RET SYS | OKLAHOMA RETIREMENT | 237.60 |
| | | | OKLAHOMA RETIREMENT | 237.60 |
| | | CITY OF MANGUM -CASH | DOG FOOD | 157.20 |
| | | AT&T MOBILITY | CELL PHONE | 47.40 |
| | | VISA | DOC VISIT | 30.00 |
| | | | UC VISIT | 30.00 |
| | | OSEEGIB | MEDICAL INSURANCE | 380.39 |
| | | | MEDICAL INSURANCE | 380.39 |
| | | | TOTAL: | 1,765.32 |
| INFORMATION TECHNOLOGY GENERAL FUND | | GREAT PLAINS BANK | FICA TAXES | 57.52 |
| | | | FICA TAXES | 57.52 |
| | | | MEDICARE TAXES | 13.45 |
| | | | MEDICARE TAXES | 13.45 |
| | | OKLA PUBLIC EMP RET SYS | OKLAHOMA RETIREMENT | 125.55 |
| | | | OKLAHOMA RETIREMENT | 125.55 |
| | | TYLER TECHNOLOGIES, INC | INCODE 4/1/26-6/30/26 | 4,053.00 |
| | | AT&T | AT&T 8310012830690 | 1,053.84 |
| | | STANDLEY SYSTEMS | STANDLEY SYSTEMS | 1,241.00 |
| | | AT&T MOBILITY | CELL PHONE | 47.40 |
| | | VISA | MICROSOFT | 212.50 |
| | | DOBSON FIBER | DOBSON FIBER | 175.64 |
| | | OSEEGIB | MEDICAL INSURANCE | 190.19 |
| | | | MEDICAL INSURANCE | 190.19 |
| | | | TOTAL: | 7,556.80 |
| ANIMAL CONTROL | GENERAL FUND | GREAT PLAINS BANK | FICA TAXES | 64.21 |
| | | | FICA TAXES | 64.21 |
| | | | MEDICARE TAXES | 15.02 |
| | | | MEDICARE TAXES | 15.02 |
| | | OKLA PUBLIC EMP RET SYS | OKLAHOMA RETIREMENT | 140.40 |
| | | | OKLAHOMA RETIREMENT | 140.40 |
| | | HARMON ELECTRIC ASSOC INC | HARMON ELECTRIC ASSOC INC | 85.00 |
| | | CITY OF MANGUM -CASH | DOG FOOD | 17.51 |
| | | TREERING WORKFORCE SOLUTIONS INC | TIMECLOCK | 2.20 |
| | | | TIMECLOCK | 2.20 |
| | | VISA | FUEL | 105.68 |
| | | | FUEL | 62.10 |
| | | | DOG FOOD | 41.40 |
| | | | DOG FOOD | 41.40 |
| | | OSEEGIB | MEDICAL INSURANCE | 380.39 |
| | | | MEDICAL INSURANCE | 380.39 |
| | | | TOTAL: | 1,557.53 |
| SHOP | GENERAL FUND | GREAT PLAINS BANK | FICA TAXES | 71.85 |
| | | | FICA TAXES | 71.85 |
| | | | MEDICARE TAXES | 16.80 |
| | | | MEDICARE TAXES | 16.80 |
| | | OKLA PUBLIC EMP RET SYS | OKLAHOMA RETIREMENT | 157.03 |
| | | | OKLAHOMA RETIREMENT | 157.03 |
| | | SUMMIT UTILITIES | SUMMIT UTILITIES | 156.52 |
| | | BUGMASTER INC | BUGMASTER INC | 31.72 |
| | | TREERING WORKFORCE SOLUTIONS INC | TIMECLOCK | 2.20 |
| | | | TIMECLOCK | 2.20 |

Item 4.

| DEPARTMENT | FUND | VENDOR NAME | DESCRIPTION | AMOUNT |
|---------------------|--------------------|--|----------------------------|-----------|
| | | VISA | FUEL | 124.40 |
| | | CONSUMER TEXTILE CORP (CTC) | SHOP TOWELS | 115.00 |
| | | OSEEGIB | MEDICAL INSURANCE | 380.39 |
| | | | MEDICAL INSURANCE | 380.39 |
| | | | TOTAL: | 1,684.18 |
| NON-DEPARTMENTAL | MANGUM UTILITY AUT | GREAT PLAINS BANK | FEDERAL WITHHOLDING | 953.05 |
| | | | FEDERAL WITHHOLDING | 1,129.84 |
| | | | FICA TAXES | 1,152.46 |
| | | | FICA TAXES | 1,186.19 |
| | | | MEDICARE TAXES | 269.52 |
| | | | MEDICARE TAXES | 277.43 |
| | | OKLAHOMA TAX COMM - SIT | STATE INCOME TAX WITHHELD | 579.00 |
| | | | STATE INCOME TAX WITHHELD | 584.00 |
| | | GREER COUNTY AMBULANCE | EMS FEB 2026 | 12,197.45 |
| | | OKLA PUBLIC EMP RET SYS | OKLAHOMA RETIREMENT | 1,203.11 |
| | | | OKLAHOMA RETIREMENT | 1,217.42 |
| | | AFLAC ADMINISTRATIVE SER. | AFLAC INSURANCE POST TAX | 19.92 |
| | | | AFLAC INSURANCE POST TAX | 19.92 |
| | | MANGUM UTILITY AUTHORITY | EMPLOYEE UTILITY BILLS | 313.16 |
| | | | EMPLOYEE UTILITY BILLS | 313.17 |
| | | CITY OF MANGUM MISC | EMPLOYEE REIMBURSE CITY | 50.00 |
| | | | EMPLOYEE REIMBURSE CITY | 50.00 |
| | | AMERICAN FIDELITY ASSURANCE | AMERICAN FIDELITY PRE TAX | 55.53 |
| | | | AMERICAN FIDELITY PRE TAX | 55.53 |
| | | CONTINENTAL GENERAL INS CO | EMPLOYEE CONTRIBUTIONS | 46.36 |
| | | OSEEGIB | EMPLOYEE'S MEDICAL INSURAN | 141.60 |
| | | | EMPLOYEE'S MEDICAL INSURAN | 141.60 |
| | | | TOTAL: | 21,956.26 |
| WATER DEPARTMENT | MANGUM UTILITY AUT | GREAT PLAINS BANK | FICA TAXES | 160.75 |
| | | | FICA TAXES | 153.22 |
| | | | MEDICARE TAXES | 37.59 |
| | | | MEDICARE TAXES | 35.84 |
| | | OKLA PUBLIC EMP RET SYS | OKLAHOMA RETIREMENT | 326.70 |
| | | | OKLAHOMA RETIREMENT | 334.80 |
| | | SUMMIT UTILITIES | SUMMIT UTILITIES | 190.63 |
| | | OK WATER RESOURCES BOARD | OK WATER RESOURCES BOARD | 175.00 |
| | | ENVIRONMENTAL RESOURCE TECHNOLOGIES LL | ENVIRONMENTAL RESOURCE TEC | 45.00 |
| | | TREERING WORKFORCE SOLUTIONS INC | TIMECLOCK | 4.40 |
| | | | TIMECLOCK | 4.40 |
| | | AT&T MOBILITY | CELL PHONE/METER READ | 182.74 |
| | | SOUTHERN PLAINS ENV LABS, LLC | SOUTHERN PLAINS ENV LABS, | 105.00 |
| | | | BACT FEB 2026 MG2602 | 105.00 |
| | | VISA | FUEL | 731.23 |
| | | OSEEGIB | MEDICAL INSURANCE | 760.78 |
| | | | MEDICAL INSURANCE | 760.78 |
| | | | TOTAL: | 4,113.86 |
| ELECTRIC DEPARTMENT | MANGUM UTILITY AUT | GREAT PLAINS BANK | FICA TAXES | 375.03 |
| | | | FICA TAXES | 369.16 |
| | | | MEDICARE TAXES | 87.71 |
| | | | MEDICARE TAXES | 86.34 |
| | | OKLA PUBLIC EMP RET SYS | OKLAHOMA RETIREMENT | 812.70 |
| | | | OKLAHOMA RETIREMENT | 812.70 |
| | | SUMMIT UTILITIES | SUMMIT UTILITIES | 346.01 |

| DEPARTMENT | FUND | VENDOR NAME | DESCRIPTION | AMOUNT |
|-----------------------|--------------------|--------------------------------------|--------------------------|------------|
| | | | | Item 4. |
| | | ALTEC | WIRE ROPE FREIGHT | 77.50 |
| | | TREERING WORKFORCE SOLUTIONS INC | TIMECLOCK | 6.60 |
| | | | TIMECLOCK | 6.60 |
| | | AT&T MOBILITY | CELL PHONE/METER READ | 189.60 |
| | | OTA-PLATE PAY | OTA-PLATE PAY | 11.94 |
| | | | OTA-PLATE PAY | 11.70 |
| | | VISA | WIRE CONNECTOR | 9.74 |
| | | | FUEL | 531.68 |
| | | OSEEGIB | MEDICAL INSURANCE | 1,521.56 |
| | | | MEDICAL INSURANCE | 1,521.56 |
| | | O M P A | ELECTRIC FEB 26 | 129,007.24 |
| | | | 4TH QTR SUB INSPECT | 1,201.75 |
| | | | TOTAL: | 136,987.12 |
| SANITATION | MANGUM UTILITY AUT | GREAT PLAINS BANK | FICA TAXES | 170.77 |
| | | | FICA TAXES | 180.70 |
| | | | MEDICARE TAXES | 39.93 |
| | | | MEDICARE TAXES | 42.26 |
| | | OKLA PUBLIC EMP RET SYS | OKLAHOMA RETIREMENT | 383.59 |
| | | | OKLAHOMA RETIREMENT | 405.22 |
| | | WASTE CONNECTIONS | TRASH SERVICE FEB 2026 | 34,300.49 |
| | | TREERING WORKFORCE SOLUTIONS INC | TIMECLOCK | 6.60 |
| | | | TIMECLOCK | 6.60 |
| | | VISA | FUEL | 273.51 |
| | | | FUEL | 108.22 |
| | | OSEEGIB | MEDICAL INSURANCE | 1,141.17 |
| | | | MEDICAL INSURANCE | 1,141.17 |
| | | | TOTAL: | 38,200.23 |
| CITY MANAGER | MANGUM UTILITY AUT | GREAT PLAINS BANK | FICA TAXES | 203.64 |
| | | | FICA TAXES | 240.84 |
| | | | MEDICARE TAXES | 47.63 |
| | | | MEDICARE TAXES | 56.33 |
| | | OKLA PUBLIC EMP RET SYS | OKLAHOMA RETIREMENT | 443.99 |
| | | | OKLAHOMA RETIREMENT | 443.99 |
| | | AT&T MOBILITY | CELL PHONE/HOTSPOT/IPAD | 128.48 |
| | | OSEEGIB | MEDICAL INSURANCE | 380.39 |
| | | | MEDICAL INSURANCE | 380.39 |
| | | OKLAHOMA MUNICIPAL COURT CLERKS ASSN | OMCCA WORKSHOP | 50.00 |
| | | | TOTAL: | 2,375.68 |
| WASTE WATER TREATMENT | MANGUM UTILITY AUT | GREAT PLAINS BANK | FICA TAXES | 94.35 |
| | | | FICA TAXES | 94.35 |
| | | | MEDICARE TAXES | 22.07 |
| | | | MEDICARE TAXES | 22.07 |
| | | OKLA PUBLIC EMP RET SYS | OKLAHOMA RETIREMENT | 207.79 |
| | | | OKLAHOMA RETIREMENT | 207.79 |
| | | CITY OF MANGUM -CASH | WASTE WATER LEASE FILING | 40.00 |
| | | OSEEGIB | MEDICAL INSURANCE | 380.39 |
| | | | MEDICAL INSURANCE | 380.39 |
| | | | TOTAL: | 1,449.20 |
| CITY SUPERINTENDENT | MANGUM UTILITY AUT | GREAT PLAINS BANK | FICA TAXES | 147.92 |
| | | | FICA TAXES | 147.92 |
| | | | MEDICARE TAXES | 34.59 |
| | | | MEDICARE TAXES | 34.59 |

Item 4.

| DEPARTMENT | FUND | VENDOR NAME | DESCRIPTION | AMOUNT |
|------------------------|--------------------|------------------------------|----------------------------|-----------|
| | | OKLA PUBLIC EMP RET SYS | OKLAHOMA RETIREMENT | 324.00 |
| | | | OKLAHOMA RETIREMENT | 324.00 |
| | | AT&T MOBILITY | CELL PHONE | 47.40 |
| | | VISA | FUEL | 131.85 |
| | | OSEEGIB | MEDICAL INSURANCE | 380.39 |
| | | | MEDICAL INSURANCE | 380.39 |
| | | | TOTAL: | 1,953.05 |
| HOSPITAL RENT & UTILIT | HOSPITAL RENT & UT | COONTZ ROOFING INC | PAY APP #3 | 58,900.00 |
| | | | TOTAL: | 58,900.00 |
| AIRPORT OPERATIONS FUN | AIRPORT OPERATIONS | BUGMASTER INC | BUGMASTER INC | 31.70 |
| | | HARMON ELECTRIC ASSOC INC | HANGER | 56.29 |
| | | | TERMINAL | 737.31 |
| | | | BEACON LIGHT | 146.51 |
| | | | TOTAL: | 971.81 |
| GG CAPITAL IMPROVEMEN | GEN GOV'T CAPITAL | PHIL LONG FORD OF DENVER LLC | 2024 FORD F-150 | 48,795.00 |
| | | | 4% ADD ON (IN STOCK) | 1,951.80 |
| | | | ADMIN BUILD | 16,500.00 |
| | | | TOTAL: | 67,246.80 |
| MUNICIPAL POOL | MUNICIPAL POOL FUN | AT&T MOBILITY | CELL PHONE | 47.40 |
| | | | TOTAL: | 47.40 |
| NON-DEPARTMENTAL | POOLED CASH | CITY OF MANGUM PAYROLL ACCT | CITY OF MANGUM PAYROLL ACC | 39,024.44 |
| | | | CITY OF MANGUM PAYROLL ACC | 40,455.72 |
| | | | TOTAL: | 79,480.16 |

===== FUND TOTALS =====

| | | |
|--------------|---------------------------|------------|
| 01 | GENERAL FUND | 184,050.88 |
| 02 | MANGUM UTILITY AUTHORITY | 207,035.40 |
| 21 | HOSPITAL RENT & UTILITIES | 58,900.00 |
| 24 | AIRPORT OPERATIONS FUND | 971.81 |
| 38 | GEN GOV'T CAPITAL IMP FUN | 67,246.80 |
| 40 | MUNICIPAL POOL FUND | 47.40 |
| 99 | POOLED CASH | 79,480.16 |
| GRAND TOTAL: | | 597,732.45 |

TOTAL PAGES: 7

| DEPARTMENT | FUND | VENDOR NAME | DESCRIPTION | AMOUNT |
|------------|------|-------------|-------------|--------|
|------------|------|-------------|-------------|--------|

Item 4.

APPROVED BY: _____

APPROVED BY: _____

APPROVED BY: _____

APPROVED BY: _____

APPROVED BY: _____

SELECTION CRITERIA

Item 4.

SELECTION OPTIONS

VENDOR SET: 99-CITY OF MANGUM
VENDOR: All
CLASSIFICATION: All
BANK CODE: All
ITEM DATE: 3/01/2026 THRU 3/31/2026
ITEM AMOUNT: 99,999,999.00CR THRU 99,999,999.00
GL POST DATE: 0/00/0000 THRU 99/99/9999
CHECK DATE: 0/00/0000 THRU 99/99/9999

PAYROLL SELECTION

PAYROLL EXPENSES: NO
EXPENSE TYPE: N/A
CHECK DATE: 0/00/0000 THRU 99/99/9999

PRINT OPTIONS

PRINT DATE: None
SEQUENCE: By Department
DESCRIPTION: Distribution
GL ACCTS: NO
REPORT TITLE: Items over 1,500
SIGNATURE LINES: 5

PACKET OPTIONS

INCLUDE REFUNDS: YES
INCLUDE OPEN ITEM:NO

PAYROLL ESTIMATE
APRIL 2026

CITY:

| | |
|--------------|------------|
| Regular Time | \$53328.60 |
| Overtime | \$438.34 |

MUA:

| | |
|--------------|------------|
| Regular Time | \$30348.30 |
| Overtime | \$719.25 |

Approved on:

Sarah Dreyer – Payroll Clerk



200 Naomi Ln.
 Newcastle, OK 73605
 866-HOPE-565
support@hopeautomation.com
www.hopeautomation.com

QUOTE PROPOSAL FOR WORK

Date: April 2, 2026

BILL TO

City of Mangum
 130 North Oklahoma Avenue
 Mangum, OK 73554

LOCATION

City of Mangum
 130 North Oklahoma Avenue
 Mangum, OK 73554

| DESCRIPTION | QTY | UNIT PRICE | TOTAL |
|---|--------|-------------|-------------------|
| HopeAutomation SCADA RAT 100 – Complete remote monitoring, control, alarm, and data logging system including: • Voice call-out alarm notification • Web-based SCADA dashboard for remote monitoring and control • Automated data logging and cloud database historian storage • Local HMI for setpoint configuration and real-time monitoring • Discrete and analog I/O for full pump station monitoring and control | 1 | \$5,100.00 | \$5,100.00 |
| SCADA RAT 100 Installation Labor – On-site installation, wiring, configuration, and commissioning. | 10 hrs | \$150.00/hr | \$1,500.00 |
| Radar Level Transducer – Top-down radar level sensor in stainless steel housing. Continuous level measurement integrated into SCADA RAT 100 for monitoring and pump control. | 1 | \$485.00 | \$485.00 |
| High/Low Level Float Switches (2) – Backup level control floats providing high and low level alarm and pump control redundancy. | 2 | \$150.00 | \$300.00 |
| Quote Total | | | \$7,385.00 |

| Terms & Conditions | |
|---|--|
| Payment Terms: Net 15. Payment in full is due within 15 days of invoice date. | |
| Late Payment Fee: Payments not received by the due date will incur a late fee of 1.5% per month (18% APR) on the outstanding balance, or the maximum amount allowed by law, whichever is less. | |
| Validity: This quote is valid for 30 days from the date of issue (April 2, 2026) unless otherwise agreed in writing. | |
| By signing below, the undersigned acknowledges and accepts the terms, conditions, and pricing outlined in this proposal (Document Number SOW-402) | |
| Accepted by: | |
| Printed Name: | |
| Title: | |
| Date: | |

HOPE AUTOMATION & CONTROLS LLC

Defense in Depth — Security Across Every Layer

OSI Model Cybersecurity Overview | March 2026

How We Think About Security — Layers, Not a Single Wall

A common mistake in industrial cybersecurity is treating security as a single line of defense — a firewall, a password, or a locked door. Hope Automation takes a different approach called Defense in Depth: we apply independent security controls at every layer of the communication stack, so that if one measure is ever bypassed, the next layer is already in place.

The OSI model is the standard seven-layer framework that describes how data moves from physical hardware up through software applications. The table below shows where each threat lives and exactly what we do to address it.

| Layer | Name | What It Is | How Hope Automation Secures It |
|-------|---------------------|--|--|
| 7 | Application | User-facing software and dashboards | View-only dashboard, OTP login, no command capability, HMAC-signed alarms, unique credentials per user and device |
| 6 | Presentation | Data formatting and encryption | TLS 1.2+ on all MQTT and HTTPS; AES-256 on all backups; WireGuard for remote access — no plain-text communications |
| 5 | Session | Managing login sessions and connections | One-time-password login, time-limited engineering sessions, multi-factor authentication, automatic session expiry |
| 4 | Transport | Reliable data delivery between endpoints | Port 8883 (TLS-MQTT) only; all other ports blocked at host firewall; no inbound ports open on field or plant equipment |
| 3 | Network | Routing data between networks | OT and IT networks fully segmented; Tailscale zero-trust VPN for remote access; no direct internet route to PLCs or HMIs |
| 2 | Data Link | Local device-to-device communication | MAC address allowlist on SCADA RAT WiFi; hidden SSID; cellular-only WAN for remote sites; managed switches at plant |
| 1 | Physical | Hardware, cables, and physical access | Locked enclosures on field devices; USB ports disabled on SCADA PC; no physical console access without engineering credentials |

Layer 7 — Application | Who Can Do What in the Software

This is the layer your operators actually interact with — dashboards, logins, and alarm messages. It is also the most commonly targeted layer in water utility attacks because it is the most visible.

How we secure it:

- The operator dashboard is view-only. It has no ability to send commands to field equipment under any circumstances.
- Every user logs in with a one-time password sent to their email address. There is no permanent password to intercept or brute-force.
- Every person and every device has unique credentials. A compromised operator account cannot be used to access engineering tools, and vice versa.
- Outbound alarm messages (phone calls and SMS) include a cryptographic signature (HMAC). This prevents attackers from injecting fake alarm commands into the system.
- All application-level events — logins, alarms, and setpoint changes — are logged with timestamps and user identity.

Layer 6 — Presentation | Keeping Data Unreadable in Transit and at Rest

The Presentation layer is responsible for how data is formatted and encoded before it travels across a network. This is where encryption lives.

How we secure it:

- All MQTT data from field devices is transmitted using TLS 1.2 or higher — the same encryption standard used by banks and financial institutions.
- The operator dashboard and all web-based access require HTTPS. Unencrypted HTTP is not permitted.
- Engineering remote access uses WireGuard, a modern VPN protocol with encryption reviewed and trusted by the security research community.
- Nightly database backups are encrypted with AES-256 before being uploaded to cloud storage. Backup files are unreadable without the key — a ransomware attack on the storage bucket cannot expose your data.
- We do not use any unencrypted protocols — no plain-text MQTT, no plain-text HTTP, no unencrypted remote desktop.

Layer 5 — Session | Managing Who Is Connected and For How Long

The Session layer controls how connections are established, maintained, and terminated. Unmanaged sessions — connections that stay open indefinitely — are a significant risk in industrial environments.

How we secure it:

- Operator dashboard sessions use one-time-password login. Each code expires after use and cannot be replayed.
- Engineering VPN connections require multi-factor authentication. A stolen password alone is not sufficient to connect.
- Remote engineering access is time-limited. There is no permanently open connection to plant equipment. Sessions are terminated after the task is complete.
- Future control-capable sessions will have a hard 20-minute time limit with automatic disconnection and a full audit trail.

Layer 4 — Transport | Controlling Which Traffic Is Allowed

The Transport layer defines which ports and protocols are used to carry data. Open ports are potential entry points — every unnecessary open port is a door that does not need to exist.

How we secure it:

- Field devices and the SCADA PC only use outbound port 8883 (TLS-encrypted MQTT). No inbound ports are open.
- The SCADA PC host firewall explicitly blocks all ports not required for operation — both inbound and outbound.
- The Tailscale VPN used for engineering access does not require any open inbound ports on the plant network. The encrypted tunnel is established outbound, so the plant firewall never needs to accept an incoming connection.
- Remote SCADA RAT units communicate exclusively over cellular. There are no open ports on the cellular connection — only outbound MQTT is permitted.

Layer 3 — Network | Keeping OT and IT Traffic Completely Separated

The Network layer controls how data is routed between different networks. The most important network-level security decision in any industrial control system is keeping the operational technology (OT) network — PLCs, HMIs, field instruments — completely separate from the information technology (IT) network and the internet.

How we secure it:

- At treatment plant installations, the OT network (PLCs, HMIs) has no connection to the internet. It is physically and logically isolated.
- The SCADA PC sits at the boundary. It can read from the OT network and send data outward, but it cannot receive inbound connections from the internet, and it cannot write back to PLCs.
- Firewall rules enforce this boundary at the network level — not just at the software level.
- Engineering remote access uses Tailscale, a zero-trust VPN. Engineers connect to a specific, named device — not to the entire network. Access is scoped to the minimum required.
- For remote SCADA RAT sites (wells, towers, booster stations), each unit connects via its own cellular data connection. Remote sites are never connected to each other through a shared local network.

Layer 2 — Data Link | Controlling Which Devices Can Join the Local Network

The Data Link layer manages direct communication between devices on the same local network — Ethernet, WiFi, and similar connections. At this layer, the question is: which physical devices are allowed to talk to each other at all?

How we secure it:

- Every SCADA RAT field unit provides a local WiFi access point for on-site configuration. This access point enforces a hardware-level (MAC address) allowlist — only devices pre-programmed at the time of manufacture are permitted to connect, regardless of whether they have the password.
- The SCADA RAT WiFi SSID is hidden and does not broadcast. A device cannot discover the network by scanning — it must already know the name.
- Remote SCADA RAT units use cellular modems for all WAN traffic. There is no local Ethernet connection to exploit at unmanned remote sites.
- At treatment plant installations, managed network switches enforce port-level access controls, ensuring only known and authorized devices can communicate on the OT network segment.

Layer 1 — Physical | Protecting the Hardware Itself

Physical security is the foundation of every other layer. No software protection matters if an attacker can walk up to a device and plug something in.

How we secure it:

- All SCADA RAT field enclosures are lockable. Electrical panels housing PLCs and HMIs are secured with keyed locks.
- USB ports on the SCADA PC are disabled at the operating system level on all installations, both Windows and Linux. A USB drive plugged into the machine will not mount — malware cannot be loaded and data cannot be extracted this way.
- The SCADA PC does not have an exposed physical console for general use. The operator account (read-only) is the only account accessible without Hope Automation engineering credentials.
- PLC and HMI devices have unique device-level passwords set at commissioning. Physical access to the device does not grant access to programming or configuration without the correct credentials.
- Default manufacturer passwords are always changed before any system goes live. This closes the single most common physical attack vector documented in water utility incidents.

M. W. D.

A & A FENCE CO.

MANUEL PADILLA
126 W. DOGWOOD
PHONE (580) 726-3079 - (580-530-0347)
HOBART, OKLAHOMA 73651

2/20/21

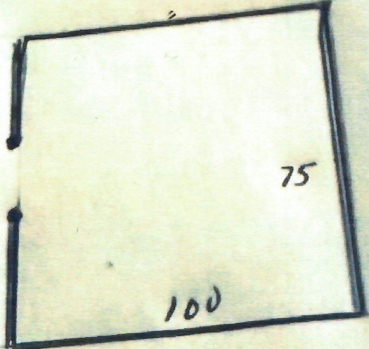

- 234 ft fence 6' high 9 Gauge
- 6 Corner posts 3" x 21
- 23 Line posts 2 3/8 x 8 065
- 1 D.D Gate 16' opening
- 3 bar wire

Labor & material \$ 7234.00

with Sliding Gate

\$8920.00

Thank you

Acceptance of this estimate constitutes a contract to
above described project at the purchase price

of Pages

P.O. Box 851
Blair, OK 73526



CELL PHONE
580-471-8282

HOME PHONE
580-563-9075

| | | | |
|--|---------------|--------------|------|
| PROPOSAL SUBMITTED TO <i>City of Mangum</i> | | PHONE | DATE |
| STREET | | JOB NAME | |
| CITY, STATE AND ZIP CODE <i>Mangum OK</i> | | JOB LOCATION | |
| ARCHITECT | DATE OF PLANS | JOB PHONE | |

We hereby submit specifications and estimates for:

*Approximately 195' 6" tall chainlink
with barbwire on top. Fence will
match fence at north water tower
fence. Post will be concreted in ground
1-10' gate All commercial grade material*

*materials + labor
\$ 8500⁰⁰*

*THANKS
Rocky*

We Propose hereby to furnish material and labor — complete in accordance with above specifications, for the sum of:

Payment to be made as follows: _____ dollars (\$ _____).

All material is guaranteed to be as specified. All work to be completed in a workmanlike manner according to standard practices. Any alteration or deviation from above specifications involving extra costs will be executed only upon written orders, and will become an extra charge over and above the estimate. All agreements contingent upon strikes, accidents or delays beyond our control. Owner to carry fire, tornado and other necessary insurance. Our workers are fully covered by Workmen's Compensation Insurance.

Authorized Signature _____

Note: This proposal may be withdrawn by us if not accepted within _____ days.

Acceptance of Proposal — The above prices, specifications and conditions are satisfactory and are hereby accepted. You are authorized to do the work as specified. Payment will be made as outlined above.

Signature _____

Signature _____

Date of Acceptance: _____



Myers Engineering, Consulting Engineers, Inc.

13911 Quail Pointe Drive
Oklahoma City, OK 73134, United States
Tel: 405-755-5325 Fax: 405-755-5373
www.mecokc.com

Item 8.

City of Mangum
200 N. Oklahoma
Mangum, Oklahoma 73554

INVOICE

INVOICE DATE: 3/31/2026
INVOICE NO: 226013-2
BILLING FROM: 2/23/2026
BILLING TO: 3/30/2026

226013 - Mangum - Electric System Replacement

Managed By: Bill Myers

| DESCRIPTION | CONTRACT AMOUNT | % COMPLETE | BILLED TO DATE | PREVIOUSLY BILLED | CURRENT AMOUNT |
|-----------------------------|--------------------|------------|-------------------|-------------------|-------------------|
| 226013 Engineering Services | \$47,900.00 | 15.00 | \$7,185.00 | \$1,275.00 | \$5,910.00 |
| TOTAL | \$47,900.00 | | \$7,185.00 | \$1,275.00 | \$5,910.00 |

AMOUNT DUE THIS INVOICE \$5,910.00

This invoice is due upon receipt

SECTION 01027

S.A. &I. 427 (1985)

AFFIDAVIT FOR PAYMENTS IN EXCESS OF \$1,000.00

STATE OF OKLAHOMA)
) SS
COUNTY OF OKLAHOMA)

The undersigned (architect, contractor, supplier or engineer), of lawful age, being first duly sworn, on oath says that this invoice or claim is true and correct. Affiant further states that the (work, services or materials) as shown by this invoice or claim have been (completed or supplied) in accordance with the plans, specifications, orders or request furnished the affiant. Affiant further states that (s)he has made no payment directly or indirectly to any elected official, officer or employee of the State of Oklahoma, any county or local subdivision of the state, of money or any other thing of value to obtain payment.

Jon Alexander

(Architect, or Engineer)

Subscribed and sworn to before me this 31st day of March, 2026

Mary Jo Petersen

Notary Public (or Clerk or Judge)



Note:

Copy of this Affidavit must be attached to any invoice submitted by an architect, contractor, Engineer or supplier of material in excess of \$1000.00, as required by 74 O.S. 1984, S. 3109



Myers Engineering, Consulting Engineers, Inc.

13911 Quail Pointe Drive
 Oklahoma City, OK 73134, United States
 Tel: 405-755-5325 Fax: 405-755-5373
 www.mecokc.com

Item 9.

City of Mangum
 200 N. Oklahoma
 Mangum, Oklahoma 73554

INVOICE

INVOICE DATE: 3/31/2026
INVOICE NO: 224031-6
BILLING FROM: 10/28/2025
BILLING TO: 3/30/2026

224031 Mangum - Power Line Relocation on SH-283 J/P 35063(06)

Managed By: Bill Myers

PROFESSIONAL SERVICES

| DATE | EMPLOYEE | DESCRIPTION | HOURS | RATE | AMOUNT |
|-----------------------|-----------------|-------------------------|--------------|----------|-------------------|
| 10/28/2025 | Anne Adkins | Engineering Assistant 3 | 0.40 | \$145.00 | \$58.00 |
| 11/5/2025 | Anne Adkins | Engineering Assistant 3 | 0.30 | \$145.00 | \$43.50 |
| 2/12/2026 | Jon Alexander | CADD Designer Level 2 | 0.50 | \$150.00 | \$75.00 |
| 2/12/2026 | Jonathan Pipkin | Engineering Intern | 2.00 | \$150.00 | \$300.00 |
| 2/18/2026 | Jonathan Pipkin | Engineering Intern | 0.50 | \$150.00 | \$75.00 |
| 3/4/2026 | Jonathan Pipkin | Engineering Intern | 1.00 | \$150.00 | \$150.00 |
| 3/6/2026 | Triet Nguyen | CADD Designer Level 1 | 1.00 | \$115.00 | \$115.00 |
| 3/6/2026 | Jonathan Pipkin | Engineering Intern | 2.00 | \$150.00 | \$300.00 |
| 3/9/2026 | Triet Nguyen | CADD Designer Level 1 | 1.00 | \$115.00 | \$115.00 |
| 3/9/2026 | Jon Alexander | CADD Designer Level 2 | 0.70 | \$150.00 | \$105.00 |
| 3/9/2026 | Jonathan Pipkin | Engineering Intern | 3.00 | \$150.00 | \$450.00 |
| 3/10/2026 | Jonathan Pipkin | Engineering Intern | 6.50 | \$150.00 | \$975.00 |
| 3/13/2026 | Jonathan Pipkin | Engineering Intern | 0.50 | \$150.00 | \$75.00 |
| 3/16/2026 | Jonathan Pipkin | Engineering Intern | 4.00 | \$150.00 | \$600.00 |
| 3/17/2026 | Jonathan Pipkin | Engineering Intern | 4.00 | \$150.00 | \$600.00 |
| 3/18/2026 | Triet Nguyen | CADD Designer Level 1 | 1.00 | \$115.00 | \$115.00 |
| 3/18/2026 | Jonathan Pipkin | Engineering Intern | 4.00 | \$150.00 | \$600.00 |
| 3/19/2026 | Melissa Prado | Engineering Intern | 1.00 | \$150.00 | \$150.00 |
| 3/19/2026 | Jonathan Pipkin | Engineering Intern | 4.00 | \$150.00 | \$600.00 |
| 3/19/2026 | Bill Myers | Principal Engineer | 1.00 | \$315.00 | \$315.00 |
| 3/20/2026 | Triet Nguyen | CADD Designer Level 1 | 1.00 | \$115.00 | \$115.00 |
| 3/20/2026 | Jonathan Pipkin | Engineering Intern | 1.00 | \$150.00 | \$150.00 |
| 3/20/2026 | Jonathan Pipkin | Engineering Intern | 5.00 | \$150.00 | \$750.00 |
| TOTAL SERVICES | | | 45.40 | | \$6,831.50 |

AMOUNT DUE THIS INVOICE \$6,831.50

This invoice is due upon receipt

SECTION 01027

S.A. &I. 427 (1985)

AFFIDAVIT FOR PAYMENTS IN EXCESS OF \$1,000.00

STATE OF OKLAHOMA)
) SS
COUNTY OF OKLAHOMA)

The undersigned (architect, contractor, supplier or engineer), of lawful age, being first duly sworn, on oath says that this invoice or claim is true and correct. Affiant further states that the (work, services or materials) as shown by this invoice or claim have been (completed or supplied) in accordance with the plans, specifications, orders or request furnished the affiant. Affiant further states that (s)he has made no payment directly or indirectly to any elected official, officer or employee of the State of Oklahoma, any county or local subdivision of the state, of money or any other thing of value to obtain payment.

Jon Alexander
(Architect, or Engineer)

Subscribed and sworn to before me this 31st day of March, 2026

Mary Jo Petersen
Notary Public (or Clerk or Judge)



Note:

Copy of this Affidavit must be attached to any invoice submitted by an architect, contractor, Engineer or supplier of material in excess of \$1000.00, as required by 74 O.S. 1984, S. 3109



Myers Engineering, Consulting Engineers, Inc.

13911 Quail Pointe Drive
Oklahoma City, OK 73134, United States
Tel: 405-755-5325 Fax: 405-755-5373
www.mecokc.com

Item 10.

City of Mangum
200 N. Oklahoma
Mangum, Oklahoma 73554

INVOICE

INVOICE DATE: 3/31/2026
INVOICE NO: 224016-12
BILLING FROM: 11/24/2025
BILLING TO: 3/30/2026

224016 Mangum - Waterline Relocation on SH-283 J/P 35063(06)

Managed By: Bill Myers

PROFESSIONAL SERVICES

| DATE | EMPLOYEE | DESCRIPTION | HOURS | RATE | AMOUNT |
|-----------------------|-----------------|-------------------------|--------------|----------|-------------------|
| 11/25/2025 | Anne Adkins | Engineering Assistant 3 | 0.40 | \$145.00 | \$58.00 |
| 12/10/2025 | Anne Adkins | Engineering Assistant 3 | 0.50 | \$145.00 | \$72.50 |
| 2/12/2026 | Jonathan Pipkin | Engineering Intern | 2.00 | \$150.00 | \$300.00 |
| 2/18/2026 | Triet Nguyen | CADD Designer Level 1 | 3.00 | \$115.00 | \$345.00 |
| 2/18/2026 | Jon Alexander | CADD Designer Level 2 | 1.00 | \$150.00 | \$150.00 |
| 2/18/2026 | Jonathan Pipkin | Engineering Intern | 2.50 | \$150.00 | \$375.00 |
| 2/20/2026 | Jon Alexander | CADD Designer Level 2 | 1.00 | \$150.00 | \$150.00 |
| 2/23/2026 | Jonathan Pipkin | Engineering Intern | 0.50 | \$150.00 | \$75.00 |
| 3/5/2026 | Jonathan Pipkin | Engineering Intern | 4.00 | \$150.00 | \$600.00 |
| TOTAL SERVICES | | | 14.90 | | \$2,125.50 |

AMOUNT DUE THIS INVOICE \$2,125.50

This invoice is due upon receipt

SECTION 01027

S.A. &I. 427 (1985)

AFFIDAVIT FOR PAYMENTS IN EXCESS OF \$1,000.00

STATE OF OKLAHOMA)
) SS
COUNTY OF OKLAHOMA)

The undersigned (architect, contractor, supplier or engineer), of lawful age, being first duly sworn, on oath says that this invoice or claim is true and correct. Affiant further states that the (work, services or materials) as shown by this invoice or claim have been (completed or supplied) in accordance with the plans, specifications, orders or request furnished the affiant. Affiant further states that (s)he has made no payment directly or indirectly to any elected official, officer or employee of the State of Oklahoma, any county or local subdivision of the state, of money or any other thing of value to obtain payment.

Jon Alexander

(Architect, or Engineer)

Subscribed and sworn to before me this 31st day of March, 2026

Mary Jo Petersen

Notary Public (or Clerk or Judge)



Note:

Copy of this Affidavit must be attached to any invoice submitted by an architect, contractor, Engineer or supplier of material in excess of \$1000.00, as required by 74 O.S. 1984, S. 3109