



Downtown Development Authority

Friday, February 16, 2024 at 12:00 PM

27400 Southfield Road, Lathrup Village, Michigan 48076

1. **Call to Order**

2. **Roll Call**

3. **Approval of Agenda**

4. **Approval of Minutes**

[A.](#) 2024 01 22 DDA Board of Directors Minutes

5. **Consent Agenda**

[A.](#) January 2024 Financial Reports

[B.](#) Committee Reports

2024 02 01 Economic Vitality

2024 02 05 LV Music Festival

2024 02 12 Beautification

[C.](#) February 2024 Code Enforcement Report

6. **Old Business**

[A.](#) Municipal Park Renovation - Project Update

7. **New Business**

[A.](#) 2024 Alley & Approach - Bid Contract Recommendation

[B.](#) Facade & Site Improvement Grant Application - 28400 Southfield Road (Levy & Associates)

[C.](#) Southfield Road Improvement Project - RAISE Grant

[D.](#) Southfield Area Chamber of Commerce - 2024 State of the City

[E.](#) FY 24/25 DDA Budget (draft v1)

8. **DDA Director Report**

[A.](#) February 2024 CED Report

9. **Public Comment**

10. **Adjourn**

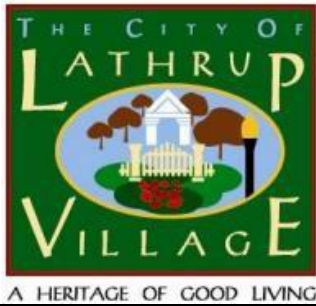

Downtown Development Authority

Monday, January 22, 2024 at 12:00 PM

27400 Southfield Road, Lathrup Village, Michigan 48076

1. Call to Order

12:03 p.m. by Chair Fred Prime

Present: Bruce Kantor (alternate), Scott McKee, Fred Prime, Pamela Shermeyer, Daniel Sugg

Absent: Dr. Patricia Felton, Kelly Garrett, Charlotte Jones, Bryan Ford, Bobbi Lovins

Staff: Brittany Dorsey, Mike Greene, Robert Harris, Susie Stec

It was announced that Mayor Pro-Tem Bruce Kantor was appointed as Mayor Kelly Garrett's alternate, and will serve in her stead when unable to attend.

Motion by Sugg to approve absences of Dr. Patricia Felton, Bryan Ford, Kelly Garrett Charlotte Jones, and Bobbi Lovins. Seconded by Shermeyer. All in favor.

2. Approval of Agenda

Motion by McKee to approve agenda. Seconded by Kantor. All in favor.

3. Approval of Minutes

A. 2023 10 20 DDA Board of Directors Minutes

Motion by Shermeyer to approve October 20, 2023 minutes. Seconded by Kantor. All in favor.

B. 2023 12 15 DDA Board of Directors Workshop Minutes

Motion by Shermeyer to approve workshop minutes. Seconded by Sugg. All in favor.

4. Financial Review

A. October 2023 Financial Reports

Stec shared financial update. Fund balance in good standing. Stec will provide additional information about depreciation items next meeting. Plante Moran will provide financial services until a replacement is hired for Bratschi.

Motion by Sugg to receive and file October 2023 financial reports as presented. Seconded by Kantor. All In favor.

B. November 2023 Financial Reports

Motion by Sugg to receive and file November 2023 financial reports as presented. Seconded by Shermeyer. All In favor.

C. December 2023 Financial Reports

Motion by Sugg to receive and file December 2023 financial reports as presented. Seconded by Kantor. All In favor.

D. FY 22/23 Audit Report

Stec provided an update; DDA is in good standing.

Motion by Kantor to receive and file 22/23 audit report. Seconded by McKee. All in favor.

5. **Committee Reports**

- A. 2023 11 13 Beautification Committee
- B. 2023 11 16 Promotions Committee
- C. 2023 12 11 Beautification Committee
- D. 2023 12 21 Promotions Committee
- E. 2024 01 08 Beautification Committee
- F. 2024 01 18 Promotions Committee

Stec provided updates.

6. **Other Business**

- A. January 2023 Code Enforcement Report
Harris provided an update. Harris administered several violations.
- B. January 2024 CED Report
Stec went over report.
- C. 2023 DDA Annual Report

Stec reviewed annual report. DDA Board has 2 committee members whose term is set to expire February 2024. Council will make appointments to the board in February meeting.

Motion by Shermeyer to accept annual report and forward to Council. Seconded by Sugg. All in favor.

7. Old Business

A. Municipal Park Renovation - Project Update

Stec met with Snyder Recreation and asked for a revised plan that may be phase. Revised design is anticipated later this week. Stec continues to meet with Main Street Oakland County. They anticipate getting out grant information in February/March. DDA submitted an application to GM match on Main grant for \$50,000. We should have answers by the end of February. Other funding sources that will be pursued are T-Mobile Hometown, DNR Recreation Passport, and Ralph C Wilson grants.

8. New Business

A. 2024 DDA Board of Directors Meeting Dates

Motion by Kantor to accept 2024 meeting dates with correction to July 19th date. Seconded by McKee. All in favor

B. 2024 Alley & Approach Recommendation

Project was discussed at the December workshop. Bids went out the beginning of January and are due February 8. February 16 meeting, contract will be rewarded.

Motion by Shermeyer to adopt alley and approach recommendations for an estimated cost of \$296,704. Seconded by Kantor. All in favor.

C. Southfield Road Improvement Project - RAISE Grant

City, RCOC, and Southfield were awarded a grant writer by SEMCOG to write the RAISE grant application. A letter of support from the DDA and the City indicating our support and a commitment to fund the project is needed. A draft letter needs to be submitted by February. If successful, construction will take place in 2027. Estimated Lathrup Village match is \$3.5 million; additional support being sought.

D. 2024 National Main Street Conference

Stec shared that Main Street Conference will be May 6-9, 2024 in Birmingham, Alabama.

Motion by Sugg to authorize the DDA Director to proceed with registering and making travel arrangements for the 2024 National Main Street Conference in Birmingham, Alabama. Seconded by Kantor. All in favor.

9. **Public Comment**

Stec introduced new City Administrator Mike Greene.

10. **Adjourn**

Motion by Sugg to adjourn at 1:09 p.m. Seconded by Shermeyer.

DRAFT

User: JESSICA
DB: Lathrup

PERIOD ENDING 01/31/2024

Item 5A.

GL NUMBER	DESCRIPTION	2023-24		YTD BALANCE 01/31/2024 NORM (ABNORM)	ACTIVITY FOR MONTH 01/31/24 INCR (DECR)	AVAILABLE BALANCE NORM (ABNORM)	% BDGT USED
		ORIGINAL BUDGET	2023-24 AMENDED BUDGET				
Fund 494 - DOWNTOWN DEVELOPMENT AUTHORITY							
Revenues							
Dept 000.000							
494-000.000-407.000	TIFA-CAPTURE TAXES	367,901.00	367,901.00	26,761.25	0.00	341,139.75	7.27
494-000.000-410.000	TAX COLLECTED OTHER	37,488.00	37,488.00	7,459.33	0.00	30,028.67	19.90
494-000.000-415.000	MISCELLANEOUS REVENUE	21,974.00	21,974.00	0.00	0.00	21,974.00	0.00
494-000.000-446.000	INVESTMENT INTEREST	10,000.00	10,000.00	23,398.97	0.00	(13,398.97)	233.99
Total Dept 000.000		437,363.00	437,363.00	57,619.55	0.00	379,743.45	13.17
TOTAL REVENUES		437,363.00	437,363.00	57,619.55	0.00	379,743.45	13.17
Expenditures							
Dept 000.000							
494-000.000-701.000	SALARIES FULL-TIME	170,940.00	170,940.00	108,477.25	25,450.33	62,462.75	63.46
494-000.000-702.000	SALARIES PART-TIME	5,000.00	5,000.00	4,525.00	0.00	475.00	90.50
494-000.000-703.000	EMPLOYEE TAXES & BENEFITS	34,000.00	34,000.00	38,975.15	4,500.10	(4,975.15)	114.63
494-000.000-722.000	LEGAL SERVICES	900.00	900.00	0.00	0.00	900.00	0.00
494-000.000-726.000	OFFICE SUPPLIES	6,350.00	6,350.00	1,583.86	229.49	4,766.14	24.94
494-000.000-802.000	TAX TRIBUNAL RETURNS	2,000.00	2,000.00	0.00	0.00	2,000.00	0.00
494-000.000-810.000	AUDITING & ACCOUNTING	800.00	800.00	800.00	0.00	0.00	100.00
494-000.000-822.000	TRAINING/MEMBERSHIP	10,050.00	10,050.00	1,789.66	0.00	8,260.34	17.81
494-000.000-844.000	MAIN STREET PROGRAM	22,500.00	22,500.00	12,829.91	95.65	9,670.09	57.02
494-000.000-845.000	STREETSCAPING	132,000.00	132,000.00	9,732.50	0.00	122,267.50	7.37
494-000.000-882.000	PLANNING/CONSULTING FEES	15,300.00	15,300.00	17,017.03	0.00	(1,717.03)	111.22
494-000.000-900.000	PRINTING/PUBLICATION COSTS	2,000.00	2,000.00	1,806.69	0.00	193.31	90.33
494-000.000-901.000	POSTAGE FEES	200.00	200.00	0.00	0.00	200.00	0.00
494-000.000-933.000	REPAIRS & MAINTENANCE	417,293.00	417,293.00	26,951.20	0.00	390,341.80	6.46
494-000.000-955.000	MISCELLANEOUS EXPENDITURES	53,457.00	53,457.00	1,314.99	0.00	52,142.01	2.46
494-000.000-968.001	DEPRECIATION INFRASTRUCTURE	30,000.00	30,000.00	0.00	0.00	30,000.00	0.00
494-000.000-971.000	SIGN GRANT PROGRAM	10,000.00	10,000.00	0.00	0.00	10,000.00	0.00
494-000.000-971.001	FACADE GRANT PROGRAM	20,000.00	20,000.00	0.00	0.00	20,000.00	0.00
Total Dept 000.000		932,790.00	932,790.00	225,803.24	30,275.57	706,986.76	24.21
TOTAL EXPENDITURES		932,790.00	932,790.00	225,803.24	30,275.57	706,986.76	24.21
Fund 494 - DOWNTOWN DEVELOPMENT AUTHORITY:							
TOTAL REVENUES		437,363.00	437,363.00	57,619.55	0.00	379,743.45	13.17
TOTAL EXPENDITURES		932,790.00	932,790.00	225,803.24	30,275.57	706,986.76	24.21
NET OF REVENUES & EXPENDITURES		(495,427.00)	(495,427.00)	(168,183.69)	(30,275.57)	(327,243.31)	33.95

Item 5A.

JE #	Date	Description	Reference #	OFFSETTING GL	DEBIT	CREDIT
494-000.000-202.000 ACCOUNTS PAYABLE						
Journal AP: AP						
137625	01/12/2024	CARDMEMBER SERVICEVnd: CARDMEM	11.21-12.20.202	Multiple		202.96
137626	01/12/2024	CARDMEMBER SERVICEVnd: CARDMEM	NOV-DEC2023	Multiple		122.18
Journal Totals					0.00	325.14
Journal CD: CD						
137695	01/12/2024	Check: NBDC 48560	48560	Multiple	325.14	
Journal Totals					325.14	0.00
Totals for 494-000.000-202.000					325.14	325.14
Balance 01/01/24:					0.00	
Net Change:					0.00	
Balance 01/31/24:					0.00	

494-000.000-214.101 DUE TO GENERAL FUND						
Journal CD: CD						
137695	01/12/2024	Check: NBDC 48560	48560	Multiple		325.14
Journal Totals					0.00	325.14
Journal GJ: GJ						
138340	01/12/2024	RECLASS HEALTH INSURANCE TO CO	16087	Multiple		2,620.26
137773	01/19/2024	BCN	16062	Multiple		2,195.22
137774	01/19/2024	TO REVERSE MANUAL JOURNAL ENTR	16063	Multiple	2,195.22	
Journal Totals					2,195.22	4,815.48
Journal PR: Payroll						
138334	01/16/2024	PAYROLL REPORT JANUARY	16082	Multiple		27,330.17
Journal Totals					0.00	27,330.17
Totals for 494-000.000-214.101					2,195.22	32,470.79
Balance 01/01/24:					357,705.69	
Net Change:					30,275.57	
Balance 01/31/24:					387,981.26	

494-000.000-701.000 SALARIES FULL-TIME						
Journal PR: Payroll						
138334	01/16/2024	PAYROLL REPORT JANUARY	16082	Multiple	25,450.33	
Journal Totals					25,450.33	0.00
Totals for 494-000.000-701.000					25,450.33	0.00
Balance 01/01/24:					83,026.92	
Net Change:					25,450.33	
Balance 01/31/24:					108,477.25	

494-000.000-703.000 EMPLOYEE TAXES & BENEFITS						
Journal GJ: GJ						
138340	01/12/2024	RECLASS HEALTH INSURANCE TO CO	16087	Multiple	2,620.26	
137773	01/19/2024	BCN	16062	Multiple	2,195.22	
137774	01/19/2024	TO REVERSE MANUAL JOURNAL ENTR	16063	Multiple		2,195.22
Journal Totals					4,815.48	2,195.22
Journal PR: Payroll						
138334	01/16/2024	PAYROLL REPORT JANUARY	16082	Multiple	1,879.84	
Journal Totals					1,879.84	0.00
Totals for 494-000.000-703.000					6,695.32	2,195.22
Balance 01/01/24:					34,475.05	
Net Change:					4,500.10	
Balance 01/31/24:					38,975.15	

494-000.000-726.000 OFFICE SUPPLIES						
Journal AP: AP						
137625	01/12/2024	CARDMEMBER SERVICEOFFICE SUPPL	11.21-12.20.202	Multiple	21.19	
137625	01/12/2024	CARDMEMBER SERVICEOFFICE SUPPL	11.21-12.20.202	Multiple	11.20	
137625	01/12/2024	CARDMEMBER SERVICEOFFICE SUPPL	11.21-12.20.202	Multiple	119.40	
137626	01/12/2024	CARDMEMBER SERVICEOFFICE SUPPL	NOV-DEC2023	Multiple	56.51	
137626	01/12/2024	CARDMEMBER SERVICEOFFICE SUPPL	NOV-DEC2023	Multiple	21.19	
Journal Totals					229.49	0.00

Item 5A.

JE #	Date	Description	Reference #	OFFSETTING GL	DEBIT	CREDIT	
494-000.000-726.000 OFFICE SUPPLIES							
Totals for 494-000.000-726.000						229.49	0.00
		Balance 01/01/24:		1,354.37			
		Net Change:		229.49			
		Balance 01/31/24:		1,583.86			
494-000.000-844.000 MAIN STREET PROGRAM							
Journal AP: AP							
137625	01/12/2024	CARDMEMBER SERVICEMAIN STREET	11.21-12.20.202	Multiple	41.31		
137625	01/12/2024	CARDMEMBER SERVICEMAIN STREET	11.21-12.20.202	Multiple	9.86		
137626	01/12/2024	CARDMEMBER SERVICEMAIN STREET	NOV-DEC2023	Multiple	36.00		
137626	01/12/2024	CARDMEMBER SERVICEMAIN STREET	NOV-DEC2023	Multiple	8.48		
Journal Totals						95.65	0.00
Totals for 494-000.000-844.000						95.65	0.00
		Balance 01/01/24:		12,734.26			
		Net Change:		95.65			
		Balance 01/31/24:		12,829.91			

Item 5A.

Fund 494 DOWNTOWN DEVELOPMENT AUTHORITY

GL Number	Description	PERIOD ENDED 01/31/2023	PERIOD ENDED 01/31/2024
*** Assets ***			
494-000.000-010.000	TRUST ACCOUNT-GENERAL	1,381,606.87	1,123,421.77
494-000.000-028.096	TAXES RECEIVABLE-PERSONAL PROP	23,503.93	19,543.46
494-000.000-084.101	DUE FROM GENERAL FUND	79,706.19	471,611.32
494-000.000-141.001	INFRASTRUCTURE	360,289.69	360,289.69
494-000.000-177.001	DEPRECIABLE ASSETS	25,243.25	25,243.25
494-000.000-193.000	ACCUMULATED DEPRECIATION	(199,302.22)	(229,016.22)
Total Assets		1,671,047.71	1,771,093.27
*** Liabilities ***			
494-000.000-214.101	DUE TO GENERAL FUND	351,358.87	387,981.26
494-000.000-214.202	DUE TO MAJOR ROADS	0.00	133,801.50
494-000.000-214.203	DUE TO LOCAL ROADS	0.00	133,801.50
Total Liabilities		351,358.87	655,584.26
*** Fund Balance ***			
494-000.000-390.000	FUND BALANCE	1,417,080.33	1,283,692.70
Total Fund Balance		1,417,080.33	1,283,692.70
Beginning Fund Balance		1,417,080.33	1,284,693.70
Net of Revenues VS Expenditures		(97,391.49)	(168,183.69)
Fund Balance Adjustments		0.00	(1,001.00)
Ending Fund Balance		1,319,688.84	1,115,509.01
Total Liabilities And Fund Balance		1,671,047.71	1,771,093.27



Economic Vitality Agenda

February 1, 2024 at 12:00 PM
Virtual Meeting

1. Call to Order 12:05 p.m.

Attendees: Bryan Ford, Fred Prime

Staff: Brittany Dorsey, Susie Stec

2. Old Business

A. DDA Website

Stec shared standalone website update. Website will go live in early 2024.

B. DDA Newsletter

Newsletter format has been updated and will go out bi-weekly beginning February 5, 2024.

C. Southfield Rd. Resurfacing 2024

Road resurfacing will begin in April 2024 and is expected to end in July.

3. New Business

A. Tri-City Workshops 2024

LVDDA will host a Time Management Workshop on February 22, 2024, in the City Hall Community Room. Lathrup Village, Oak Park, and Southfield will host 4 business workshops, 2 business mixers, and virtual workshops in 2024.

B. Business Mini Grant Revamp

Committee discussed how to revamp the Business Mini Grant for 2024.

C. 2024 EV Committee Workplan Review and Update

Workplans have been updated but not finalized. Committees will finalize in next meeting.

4. Other Items

None

5. Adjourn 1:05 p.m.



Beautification Committee

Minutes

Monday, February 12, 2024 at 1:00 PM
27400 Southfield Road, Lathrup Village, Michigan 48076

1. Call to Order 1:10

Present: Reed Boskey, Pamela Shermeyer, Mark Watts, Shawanna Watts

Staff: Brittany Dorsey, Susie Stec

2. Old Business

A. Tree Order Selections

Reed shared tree selection updates/information. Pam suggested avoiding Kentucky Coffee Tree as it can be messy. Committee has one quote from Wildtype and will obtain 2 additional quotes.

B. Flower Order Selections

Pam gave flower selection presentation. Committee finalized flower selections for hanging pots, standing pots and porch pots.

C. Finalize Workplan

Committee reviewed and discussed workplan. Will finalize in March.

3. New Business

None

4. Other Items

A. RFP Update

RFP for LV landscaping will go out the week of February 12, 2024

5. Adjourn 2:45 PM



Lathrup Village Music Festival Minutes

February 5, 2024 at 12:00 PM
Virtual Meeting

1. Call to Order 12:05 p.m.

Attendees: Lauren Beras, Jason Hammond, Adam Laurie

Absent: Bob Beras

Staff: Brittany Dorsey, Susie Stec

2. New Business

A. LVMF 2024 Event Date

LVDDA will host LVMF on Saturday, August 10, 2024, 12 PM-9 PM; rain date is the following day.

B. LVMF Event Map

Committee discussed having a similar layout as last year's LVMF with a slightly larger fenced in area for alcohol consumption. Committee agreed to revisit the idea of extending the event to the front of City Hall, or inside of the Community Room in the next meeting.

C. LVMF Sponsorships

Committee will develop sponsorship packet.

3. Other Items

Committee discussed needing better lighting for the event. A "Call for Artist" will be included in the newsletter; all would like Cast Iron Cornbread return. Bob is updating the logo.

4. Adjourn 1:10 p.m.



27400 Southfield Rd
 Lathrup Village, MI 48076
 (248) 557 - 2600
 www.lathrupvillage.org

To: DDA Board of Directors
 From: Susie Stec, Director – Community & Economic Development /DDA Director
 RE: Municipal Park Renovation – Project Update
 Date: February 13, 2024

As discussed at the January meeting, a revised play structure plan was being sought. Since that time, Snider Recreation has provided a revised design which can be broken into three (3) phases. The plan is somewhat less elaborate than the original; however, it still remains fully accessible. See enclosed plans.

Overall, there was not a significant cost decrease in total project cost; however, phasing the play structure portion of the project provides greater flexibility. First, it allows the DDA to accomplish the initial goal of providing a safe, fun, and accessible play structure in the near term. Second, it provides leverage for other funding opportunities which is important because there remains a shortfall in either scenario detailed below.

Original Estimated Project Cost		Revised Estimated Project Cost	
Landscaping	\$ 29,284	Landscaping	\$ 29,284
Parking Lot Reconstruction	\$ 386,355	Parking Lot Reconstruction	\$ 357,617
Play Structure	\$ 422,703	Play Structure - All Phases	\$ 420,363
<i>Original Total</i>	<i>\$ 838,342</i>	Phase 1	\$ 193,574
		Phase 2	\$ 114,884
		Phase 3	\$ 111,905
		<i>Revised Total</i>	<i>\$ 807,264</i>
		<i>Revised Project w/Phase 1 Only</i>	<i>\$ 580,475</i>

Project Split 60/40 with MSOC - Total Project		Project Split 60/40 with MSOC - Phase 1 Only	
DDA/City (60%)	\$ 484,358	DDA/City (60%)	\$ 348,285
MSOC (40%)	\$ 322,906	MSOC (40%)	\$ 232,190
Total Funds Secured	\$ 529,996	Total Funds Secured	\$ 439,281
<i>Funding GAP</i>	<i>\$ 277,268</i>	<i>Funding Gap</i>	<i>\$ 141,194</i>

There will be a meeting with MSOC at the end of the month to discuss our budgets and begin rolling out grant agreements with participating communities. It remains uncertain how far a project can be scaled back before being considered ineligible for funding. While investment into each component of the proposed Municipal Park Renovation is needed, the board should discuss how it wants to proceed.



10139 Royalton Rd Suite K
 N. Royalton, OH 44133
 800-888-2889
www.cvsnyder.com

Date	Estimate #
2/1/2024	Q 020124-1
LATHRUP VLG MUNICIP. PARK	

Name / Address
Lathrup Village Susie Stec 27400 Southfield Rd. Lathrup Village, MI 48076

PROJECT - SHIP TO
PROJECT: Municipal Park - Lathrup Village
SHIP TO: TBD

Terms	Rep	Customer Phone	Customer Email	County
Due On Receipt	VC	(248) 557-2600 ext. 223	sstec@lathrupvillage.org	OAKLAND

Item	Description	Qty	Rate	Total
127-179508	NEW PLAYGROUND FOR 5-12, 2-5, WITH ACCESSIBILITY			
PHASE 1	5-12 PLAY STRUCTURE		\$177,574	\$177,574
DISCOUNT	PROGRAM DISCOUNT		-\$42,000	-\$42,000
FREIGHT	SHIPPING CHARGES		\$5,000	\$5,000
MBE/INSTALL	INSTALLATION OF EQUIPMENT PHASE 1		\$53,000	\$53,000
SURFACING	TBD			
		TOTAL EQUIPMENT PHASE 1		\$193,574
PHASE 2	2-5 PLAY STRUCTURE		\$145,384	\$145,384
DISCOUNT	PROGRAM DISCOUNT		-\$35,000	-\$35,000
FREIGHT	SHIPPING CHARGES		\$4,500	\$4,500
MBE/INSTALL	INSTALLATION OF EQUIPMENT PHASE 2			
SURFACING	TBD			
		TOTAL EQUIPMENT PHASE 2		\$114,884
PHASE 3	FREESTANDING PIECES & ADDITIONAL ACTIVITIES FOR 5-12 AND 2 - 5 STRUCTURES (CRUISER, NOVO TABLES & BENCH CLIMBERS 5-12 CENTER EKO CLIMBER CLUSTER 2-5)		\$91,405	\$91,405
DISCOUNT	PROGRAM DISCOUNT		-\$12,000	-\$12,000
FREIGHT	SHIPPING CHARGES		\$4,500	\$4,500
MBE/INSTALL	INSTALLATION OF EQUIPMENT PHASE 3		\$28,000	\$28,000
SURFACING	TBD			
		TOTAL EQUIPMENT PHASE 3		\$111,905

1/2 down with order, balance upon completion with approved credit.
 If tax exempt certificate is not provided, appropriate sales tax will be charged. Quote valid for 30 days.
 Acceptance of this quote assumes acceptance of Snider insurance.
 Freight subject to fuel charge. Payment via credit card will incur an additional 3% administrative fee.

Subtotal	
Sales Tax (6.0%)	N/A
Total	

Signed _____ Date _____
 Name/Title _____

Quoted By:
 V. Crawford Snider Recreation, Inc.



Item 6A.



Item 6A.

PROPOSAL #: 127-179508-1

MUNICIPAL PARK

Burke
PLAY THAT MOVES YOU.
BCBURKE.COM • 800.266.1250



3D Designer: [unreadable]

Item 6A.



Snider Recreation, Inc.

10139 Royalton Road Suite K | North Royalton, OH 44133 | 440-877-9151

Proposal 127-179508-1 | 1/19/2024



Snider Recreation
800-888-2889
www.cvsnyder.com

27400 Southfield Rd | Lathrup Village, MI 48076-3412

January 19, 2024

Susie Stec
Lathrup Village
27400 Southfield Rd.
Lathrup Village, MI 48076
Phone: 2484312796

Dear Susie Stec:

Snider Recreation, Inc. is delighted to provide Lathrup Village with this playground equipment proposal.

This design was developed with your specific needs in mind, and we look forward to discussing this project further with you to ensure your complete satisfaction. Snider Recreation, Inc. is confident that this proposal will satisfy Lathrup Village's functional, environmental, and safety requirements -- and most importantly -- bring joy and excitement to the children and families directly benefiting from your new playground.

You have our personal commitment to support this project and your organization in every manner possible, and we look forward to developing a long-standing relationship with Lathrup Village. We appreciate your consideration and value this opportunity to earn your business.

Sincerely,

Vicki Crawford
Sales Representative

Snider Recreation, Inc.
10139 Royalton Road Suite K
North Royalton, OH 44133
www.cvsnyder.com
www.bciburke.com

Phone: 440-877-9151
Fax: 440-877-9159
vcrawford@cvsnyder.com; alison@cvsnyder.com

COOPERATIVE PURCHASING OPTIONS

PLAYGROUNDS WITHOUT ALL THE PAPERWORK

Purchasing with contracts may sound intimidating, but getting your community playspace doesn't need to be a painful process of writing specifications, issuing RFP's and jumping through hoops – it can be simplified – we promise! As you continue planning for your new playground, review the Purchasing Contracts offered through our partners.

EQUALIS GROUP

Equalis is an innovative cooperative purchasing organization that believes in the power of partnership and that when you work together you achieve more. The basic premise of the Equalis cooperative purchasing organization is to leverage the combined buying power of all members for better pricing and favorable contract terms. Equalis Group uses the lead agency model for competitively bid contracts, provides our participants the savings they expect and offers efficiencies and peace of mind within the procurement process. It is our mission to continuously improve the measurable and meaningful impact of cooperative services for everyone throughout the supply chain.

GOVMVMT

GOVMVMT is a non-profit group purchasing organization that meets the highest industry standards while putting the public's interest at the forefront of everything they do. Each one of GOVMVMT's first-class suppliers has consciously joined their mission to create the most credible, ethical, and public agency-focused non-profit cooperative purchasing program in the country.

GSA

Federal parks, child development programs, military bases and other agencies are a major priority for BCI Burke, and agencies can purchase Burke playgrounds through Burke's GSA contract for installation virtually anywhere in the world.

OMNIA PARTNERS

OMNIA Partners, Public Sector (Subsidiary National IPA) is the largest and most experienced organization in purchasing and supply chain management. Comprised of participants and suppliers in the public sector, we bring together industry-leading buying power and world-class suppliers to offer an extensive portfolio of competitively solicited and publicly awarded contracts and partnerships. OMNIA Partners is proud to offer more value and resources to state and local government, higher education, K-12 education and non-profits.

SOURCEWELL

As a leader in cooperative purchasing, Sourcewell is passionate about helping members fulfill their public service missions. Sourcewell builds strong relationships with members and vendors to develop practical solutions together.

The easiest way to Join Our Movement is to call your local Representative at 800.266.1250 or visit bciburke.com/rep. Our passion is bringing play to communities like yours and we can't wait to help you get started!



DESIGN SUMMARY

Snider Recreation, Inc. is very pleased to present this Proposal for consideration for the Municipal Park located in Lathrup Village. BCI Burke Company, LLC has been providing recreational playground equipment for over 100 years and has developed the right mix of world-class capabilities to meet the initial and continuing needs of Lathrup Village. We believe our proposal will meet or exceed your project's requirements and will deliver the greatest value to you.

The following is a summary of some of the key elements of our Proposal:

- Project Name: Municipal Park
- Project Number: 127-179508-1
- User Capacity: 537
- Age Groups: 5 to 12, 2 to 5, 2 to 12
- Dimensions: 109' 7"x87' 5"
- Designer Name: Hunter Mielke

Snider Recreation, Inc. has developed a custom playground configuration based on the requirements as they have been presented for the Municipal Park playground project. Our custom design will provide a safe and affordable playground environment that is aesthetically pleasing, full of fun for all users and uniquely satisfies your specific requirements. In addition, proposal # 127-179508-1 has been designed with a focus on safety, and is fully compliant with ASTM F1487 and CPSC playground safety standards.

We invite you to review this proposal for the Municipal Park playground project and to contact us with any questions that you may have.

Thank you in advance for giving us the opportunity to make this project a success.

BLUE BOUNDARY IS PHASE 1

AQUA BOUNDARY IS PHASE 2

RED CIRCLED ITEMS ARE PHASE 3

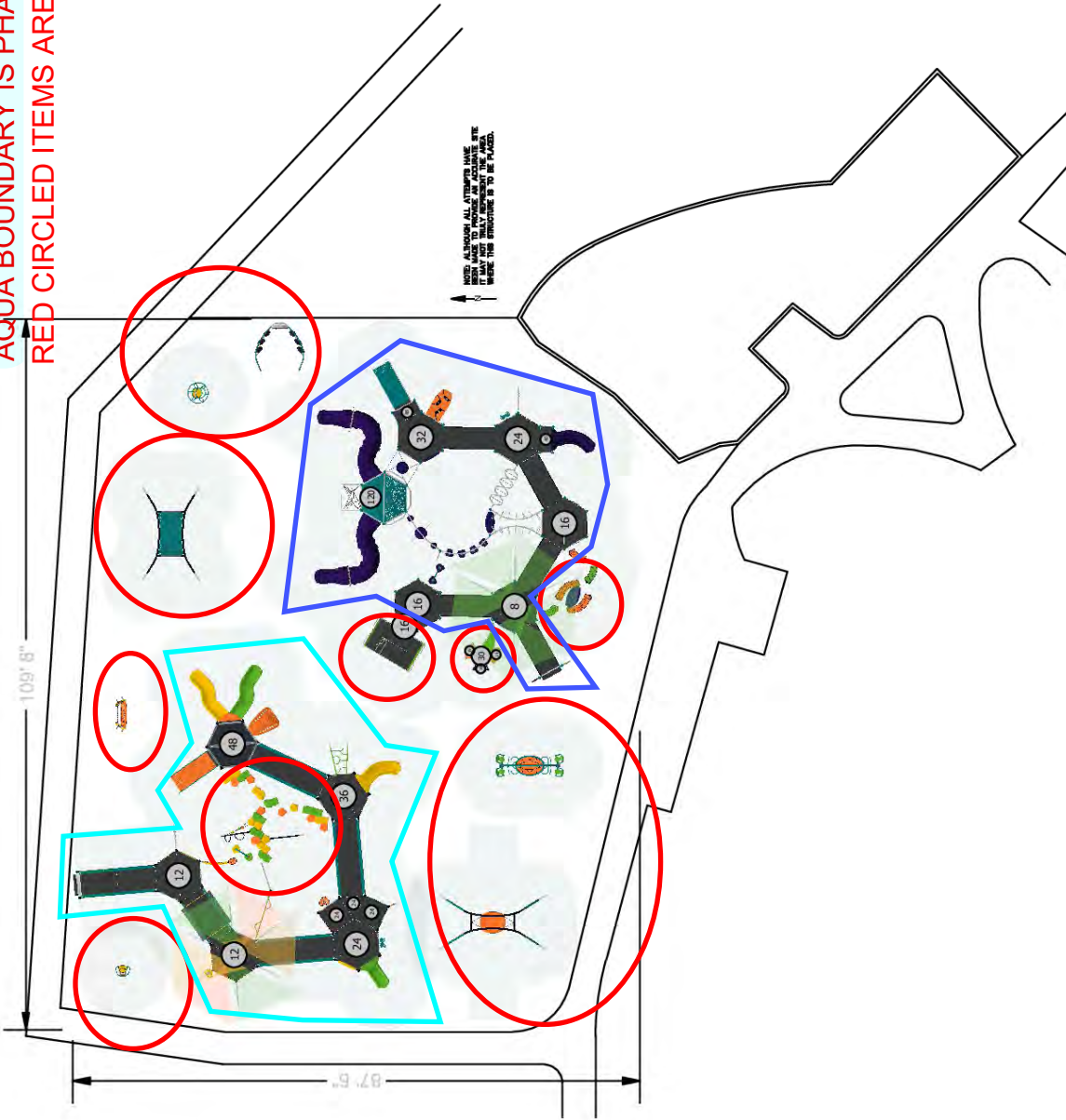

OVERALL BOUNDING OF USE ZONES
 **The space requirements shown here are to ASTM standards. Requirements for other standards may be different.
 Area: 9586.3 sq.ft.
 Perimeter: 394.1 ft.
STRUCTURE SIZE: 6"x109' 8"
POST SIZE(S):

PLAYGROUND ACCESSIBILITY (Provided/Required)			
TOTAL ELEVATED EVENTS	TRANSFER ACCESSIBLE EVENTS	RAMP ACCESSIBLE EVENTS	GROUND EVENTS
92	49 / 25	36 / 13	43 / 0
			11 / 0

The use and layout of play components identified in this plan conform to the CPSC guidelines. U.S. CPSC recommends the separation of age groups in playground layouts.

Warning: Accessible safety surfacing material is required beneath and around this equipment that is compliant with ASTM, CPSC, and ADAAG requirements.

SERIES Burke Basics | Nucleus | Intensity

SITE PLAN VIEW

GROUP:
5-12 Structure|2-5 Structure|Freestanding

Municipal Park
Lathrup Village, MI 48076-3412

01/19/2024

DESIGNED FOR AGES:
5 to 12, 2 to 5, 2 to 12



Snider Recreation, Inc.
127-179508-1

Designer: Hunter Mielke

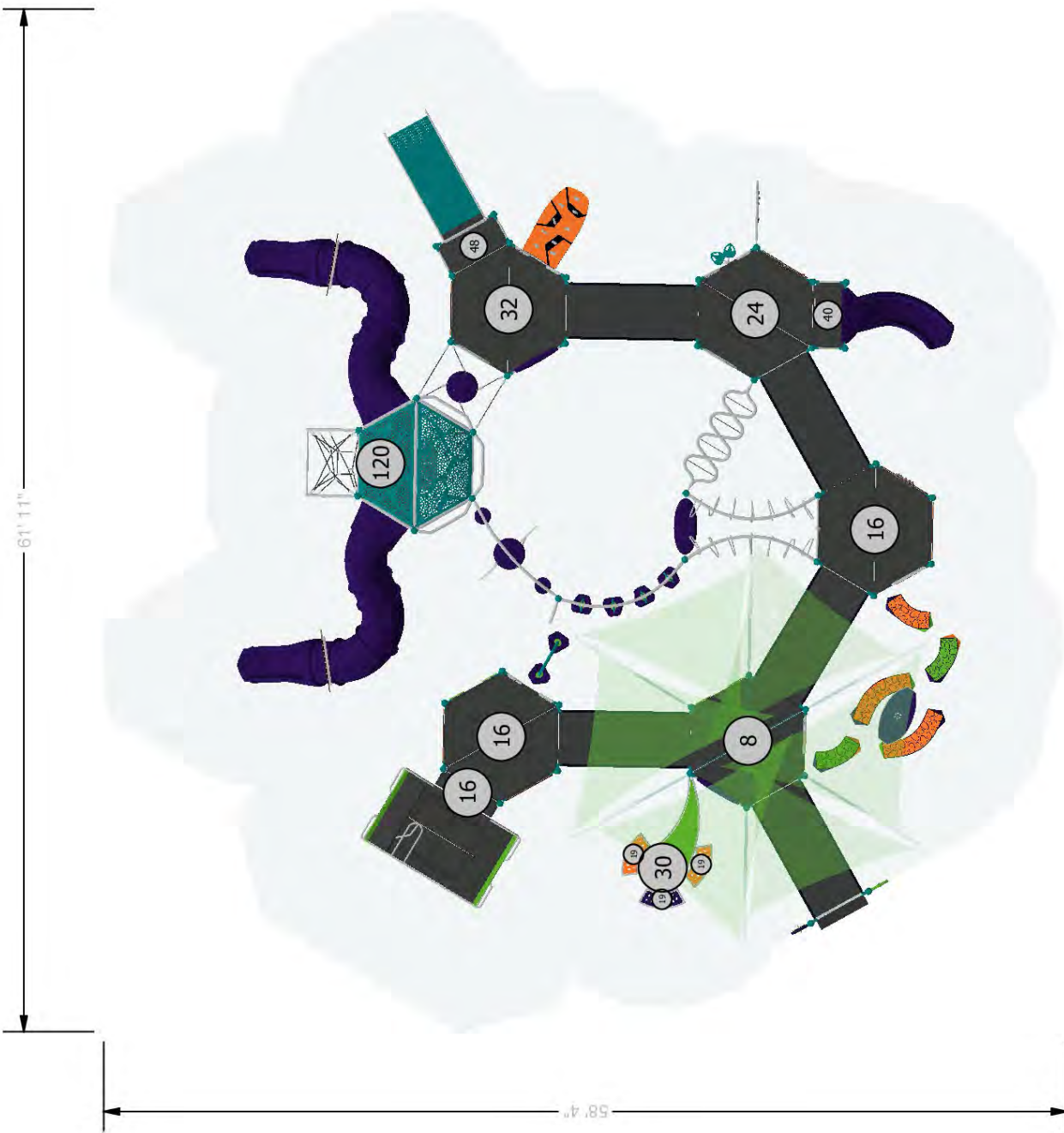

The use and layout of play components identified in this plan conform to the CPSC guidelines. U.S. CPSC recommends the separation of age groups in playground layouts.

PLAYGROUND ACCESSIBILITY (Provided/Required)			
TOTAL ELEVATED EVENTS	TRANSFER ACCESSIBLE ELEMENTS	RAMP ACCESSIBLE ELEMENTS	TYPES OF GROUND EVENTS
92	2 / 12	36 / 13	43 / 0
			11 / 0

OVERALL BOUNDING OF USE ZONES
 **The space requirements shown here are to ASTM standards. Requirements for other standards may be different.
 Area: 9586.3 sq.ft.
 Perimeter: 394.1 ft.
STRUCTURE SIZE: 6" x 109' 8"
POST SIZE(S):

Warning: Accessible safety surfacing material is required beneath and around this equipment that is compliant with ASTM, CPSC, and ADAAG requirements.

SERIES Nucleus Burke Basics Intensity	SITE PLAN VIEW
GROUP: 5-12 Structure	Municipal Park Lathrup Village, MI 48076-3412
DESIGNED FOR AGES: 5 to 12	Burke PLAY THAT MOVES YOU.
	Snider Recreation, Inc. 127-179508-1 Designer: Hunter Mielke

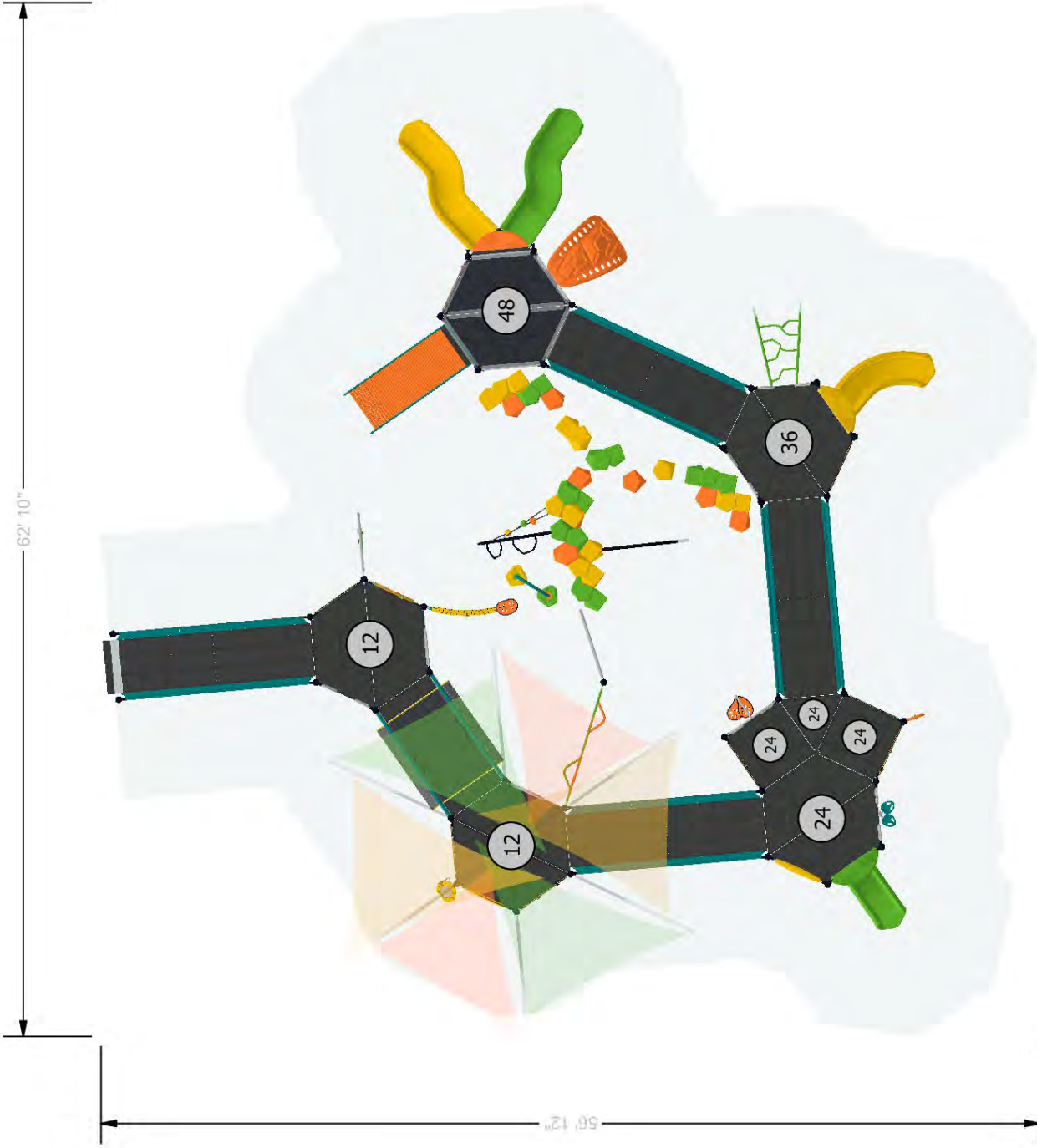

The use and layout of play components identified in this plan conform to the CPSC guidelines. U.S. CPSC recommends the separation of age groups in playground layouts.

PLAYGROUND ACCESSIBILITY (Provided/Required)			
TOTAL ELEVATED EVENTS	TRANSFER ACCESSIBLE ELEMENTS	RAMP ACCESSIBLE ELEMENTS	TYPES OF GROUND EVENTS
49 / 25	2 / 12	36 / 13	43 / 0
92			11 / 0

OVERALL BOUNDING OF USE ZONES
 **The space requirements shown here are to ASTM standards. Requirements for other standards may be different.
 Area: 9586.3 sq.ft.
 Perimeter: 394.1 ft.
STRUCTURE SIZE: 6" x 109' 8"
POST SIZE(S):

Warning: Accessible safety surfacing material is required beneath and around this equipment that is compliant with ASTM, CPSC, and ADAAG requirements.

SERIES Nucleus Intensity Burke Basics	Municipal Park Lathrup Village, MI 48076-3412	SITE PLAN VIEW 01/19/2024
GROUP: 2-5 Structure		Snider Recreation, Inc. 127-179508-1
DESIGNED FOR AGES: 2 to 5	Burke PLAY THAT MOVES YOU.	Designer: Hunter Mielke

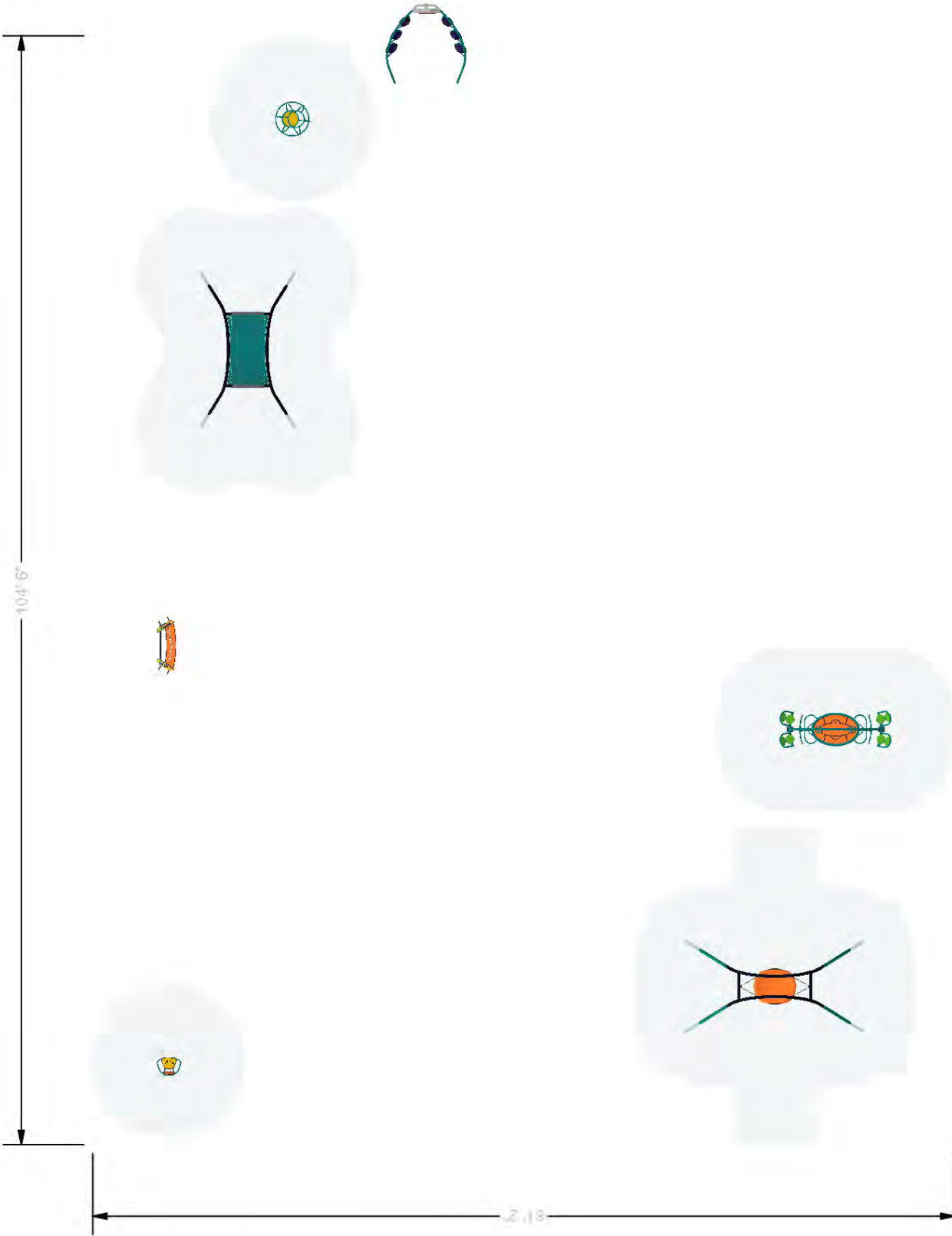

The use and layout of play components identified in this plan conform to the CPSC guidelines. U.S. CPSC recommends the separation of age groups in playground layouts.

PLAYGROUND ACCESSIBILITY (Provided/Required)			
TOTAL ELEVATED EVENTS	TRANSFER ACCESSIBLE ELEMENTS	RAMP ACCESSIBLE ELEMENTS	TYPES OF GROUND EVENTS
92	2 / 12	36 / 13	43 / 0
			11 / 0

OVERALL BOUNDING OF USE ZONES **The space requirements shown here are to ASTM standards. Requirements for other standards may be different.

Area: 9586.3 sq.ft.
 Perimeter: 394.1 ft.
STRUCTURE SIZE: 6" x 109' 8"
POST SIZE(S):

Warning: Accessible safety surfacing material is required beneath and around this equipment that is compliant with ASTM, CPSC, and ADAAG requirements.

SERIES Burke Basics	Municipal Park Lathrup Village, MI 48076-3412	SITE PLAN VIEW 01/19/2024
GROUP: Freestanding	Burke PLAY THAT MOVES YOU.	Snider Recreation, Inc. 127-179508-1
DESIGNED FOR AGES: 2 to 12		Designer: Hunter Mielke

ITEM	COMP.	DESCRIPTION
1	270-0131	HEXAGONAL PLATFORM SSP
2	580-1319	NOVO TEARDROP COUNTER CLIMBER
3	580-1312	NOVO ARC BENCH
4	570-0798	WAVER PANEL, ABOVE PLATFORM
5	270-0223	8" RISE ENTRANCE RAMP W/ GUARDRAILS
6	570-0716	CLICKER ACTIVITY PANEL
7	570-0718	HYPNO ACTIVITY PANEL
8	270-0122	EVOLUTION OFFSET ENCLOSURE
9	270-0221	8" RISE RAMP W/ GUARDRAILS
10	370-1675	STRAIGHT OVERHEAD, NUCLEUS
11	470-0128	FLYLOW POD
12	370-0223	PURSUIT CLIMBER 16"-40"
13	570-2669	MAZE ACCESSIBLE REACH PANEL
14	570-0622	PLATFORM ROLL GUARD
15	570-1863	RAIN WHEEL PANEL
16	570-0814	PROPELLER RING PANEL
17	370-0808	TWISTING TRAVERSE
18	270-0291	HALF PLATFORM W/SUPPORT
19	570-0072	EVOLUTION HALF BARRIER
20	470-0802	MONACO SLIDE, 32"-40"
21	470-0967	SLIDE HOOD, LOW SIDE WALL
22	270-0300	ABSTRACT PLATFORM LADDER 16"
23	370-0016	GRAB BAR ASSEMBLY
24	570-1816	JET PANEL
25	370-0087	LEAF CLIMBER 16" - 24"
26	270-0120	EVOLUTION UNITARY ENCLOSURE
27	570-0797	CHARADE PANEL, ABOVE PLATFORM
28	370-0042	ASCEND ROCK CLIMBER, 32"-40"
29	270-0290	HALF PLATFORM
30	470-0756	ROLLER SLIDE 48"-56"
31	570-2737	PINBALL PANEL
32	370-1622	TAKTIKS TRAIL TOWER
33	270-0292	EVOLUTION CENTER MOUNT ENCLOSURE
34	570-1865	HDPE UNITARY ENCLOSURE, NUCLEUS
35	570-0848	SIGNING 2-SIDED PLAY PANEL
36	560-0563	CRUISER WITH ADAPTER
37	570-1858	3-IN-A-ROW PANEL, ABOVE PLATFORM
38	470-0678	ARA HEX SHADE CANOPY
39	560-2736	EKO CIRCA
40	560-2738	EKO TABLE
41	370-1706	NUCLEUS CORE CLIMBER, 10"
42	370-1703	NUCLEUS CORE CROSS SUPPORT
43	370-1718	TAKTIKS BOW CLIMBER
44	370-0854	VERTO CLIMBER 1
45	470-0014	EVOLUTION HEX ROOF
46	470-0006	EVOLUTION BOTTOM ROOF SUPPORT, SINGLE
47	470-0008	EVOLUTION SIDE ROOF SUPPORT, LEFT
48	470-0009	EVOLUTION SIDE ROOF SUPPORT, RIGHT
49	270-0132	HALF HEXAGON PLATFORM
50	470-0112	COBRA SLIDE CURVED 120"
51	370-1702	NUCLEUS CORE ARCH CLIMBER
52	560-2734	HOOP CLIMBER

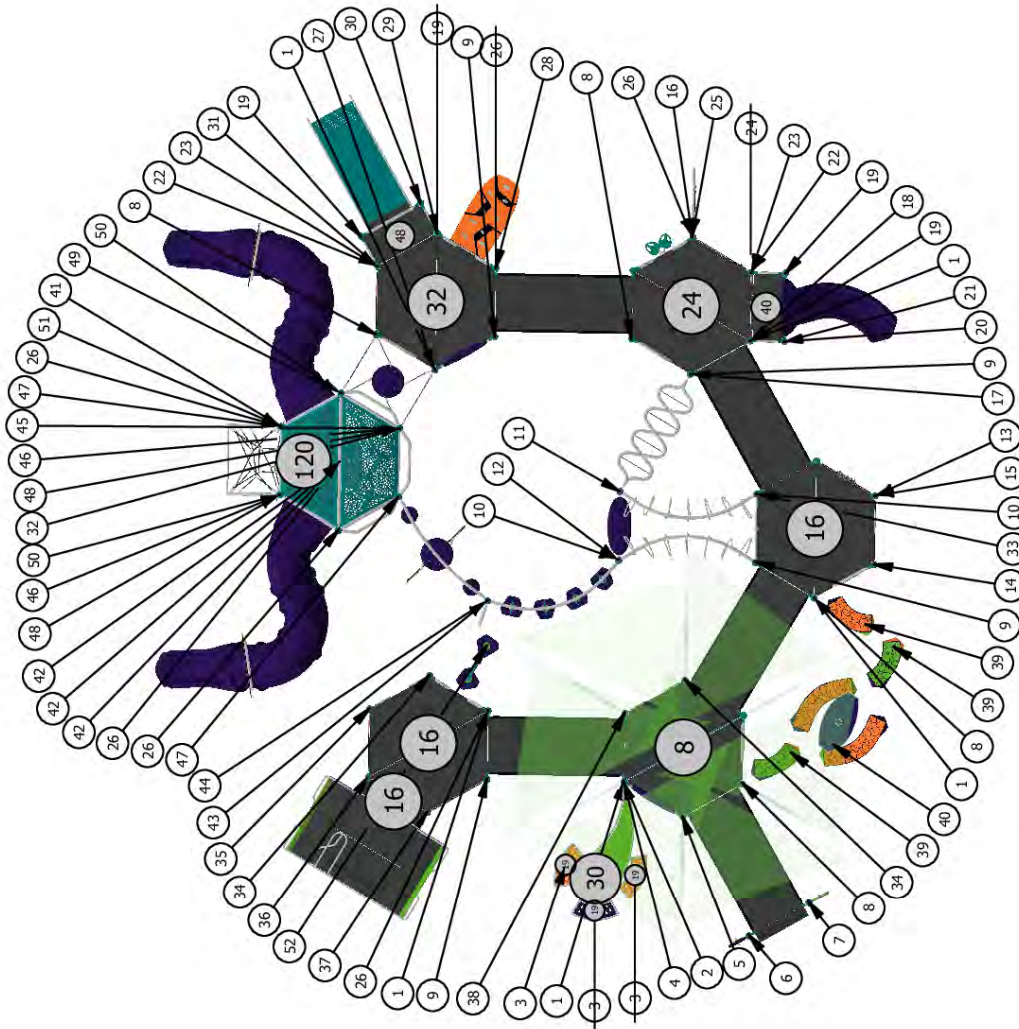

SERIES Nucleus Burke Basics Intensity		COMPONENT VIEW	
GROUP: 5-12 Structure		Municipal Park Lathrup Village, MI 48076-3412	
DESIGNED FOR AGES: 5 to 12		01/19/2024 Snider Recreation, Inc. 127-179508-1 Designer: Hunter Mielke	
BCI BURKE COMPANY, LLC PO BOX 549 FOND DU LAC, WI 54936-0549 920.921.9220 BCIBURKE.COM			

ITEM	COMP.	DESCRIPTION
1	270-0131	HEXAGONAL PLATFORM SSP
2	570-2729	CLASSIC GAME RING PANEL
3	370-1720	LIL NOVO BALANCE BEAM LINK
4	570-0811	BRAILLE PANEL
5	270-0016	12' ADAAG ENTRANCE RAMP W/GUARDRAIL
6	270-0120	EVOLUTION UNITARY ENCLOSURE
7	570-0102	INNOVA BRIDGE
8	570-2732	PLAYENSEMBLE BABEL DRUM
9	370-0031	POWER PIPES CLIMBER 2-5
10	370-0842	APEX HOLE CLIMBER 2-5
11	570-0846	SPANISH 2-SIDED PLAY PANEL
12	570-1851	CHIMES PANEL
13	570-2667	BEE ACCESSIBLE REACH PANEL
14	570-0622	PLATFORM ROLL GUARD
15	270-0012	12' ADAAG RAMP W/GUARDRAIL
16	570-2701	COLLISION PANEL, ABOVE PLATFORM
17	470-0836	ROCK'N ROLL SLIDE, 24-32 W/O HOOD
18	470-0967	SLIDE HOOD, LOW SIDE WALL
19	370-0087	LEAF CLIMBER 16" - 24"
20	270-0130	SQUARE PLATFORM
21	570-0718	HYPNO ACTIVITY PANEL
22	570-1683	PARATROOP PANEL, ABOVE PLATFORM
23	570-0578	NAME THE STATES PANEL
24	270-0129	TRIANGLE PLATFORM
25	570-1858	3-IN-A-ROW PANEL, ABOVE PLATFORM
26	470-0802	MONACO SLIDE, 32"-40"
27	370-1680	BETA CLIMBER 32"-40"
28	270-0014	12' ADAAG RAMP W/BARRIER
29	370-1645	MANITOU CLIMBER 48"
30	470-0569	VIPER II SS 48-56
31	570-2666	CAR PANEL
32	470-0756	ROLLER SLIDE 48"-56"
33	470-0813	EVOLUTION HEX ROOF
34	470-0808	EVOLUTION ROOF BOTTOM EDGE
35	370-1670	PETAL STEP CLIMBER 16"-24"
36	270-0121	EVOLUTION STANGHION
37	570-2678	CLOCK PANEL
38	270-0122	EVOLUTION OFFSET ENCLOSURE
39	470-0678	ARA HEX SHADE CANOPY
40	570-1679	SPROCKET PANEL, ABOVE PLATFORM
41	560-2715	EKO ULTIMATE
42	560-2707	EKO DUAL
43	560-2709	EKO BUNDLE
44	560-2705	EKO SOLO

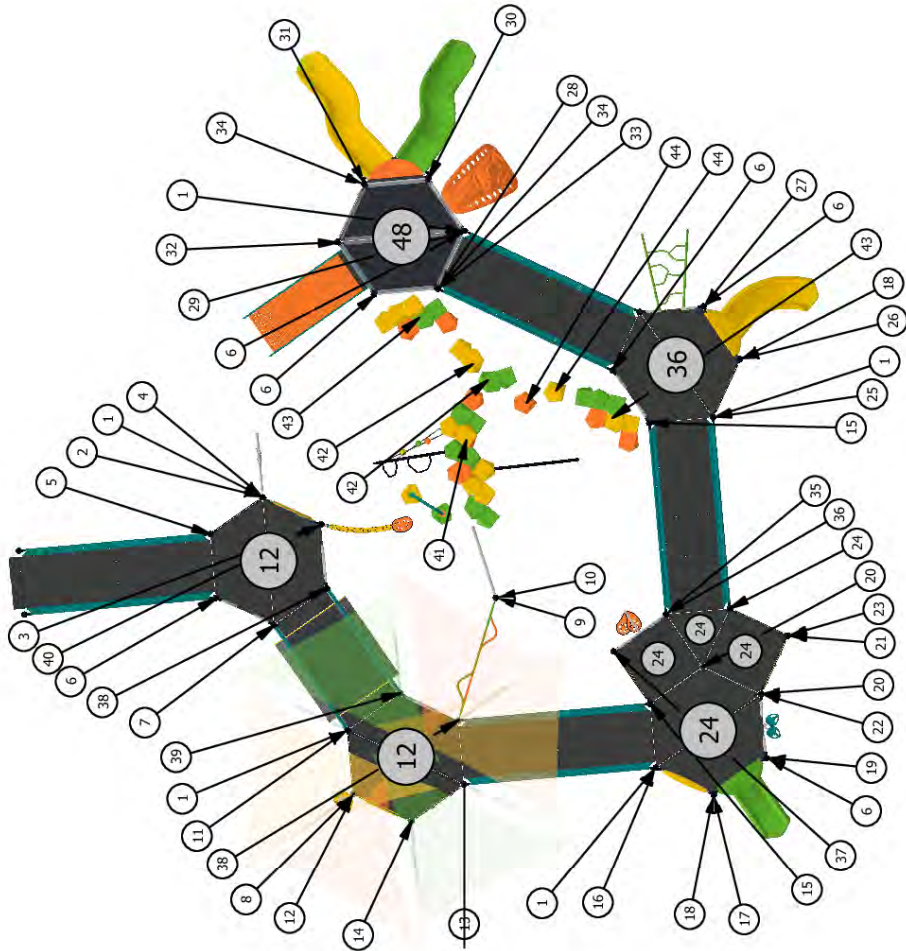

SERIES Nucleus Intensity Burke Basics		COMPONENT VIEW	
GROUP: 2-5 Structure		01/19/2024	
DESIGNED FOR AGES: 2 to 5		Municipal Park Lathrup Village, MI 48076-3412	
		Snider Recreation, Inc. 127-179508-1	
		Designer: Hunter Mielke	
BCI BURKE COMPANY, LLC PO BOX 549 FOND DU LAC, WI 54936-0549 920.921.9220 BCIBURKE.COM			

ITEM	COMP.	DESCRIPTION
1	550-9118	BRAVA UNIVERSAL SWING
2	560-2586	COMET I
3	560-2625	MOVMMT INCLUSIVE, FREESTANDING
4	560-2735	ARO SPINNING CHAIR
5	580-1410	STEM PLAYFUL BENCH
6	550-0225	CIRRUS SWING
7	550-0186	VOLLITO
	-END	
8	570-2745	ORB ROCKER
9	570-2727	ORB ROCKER FOOTER

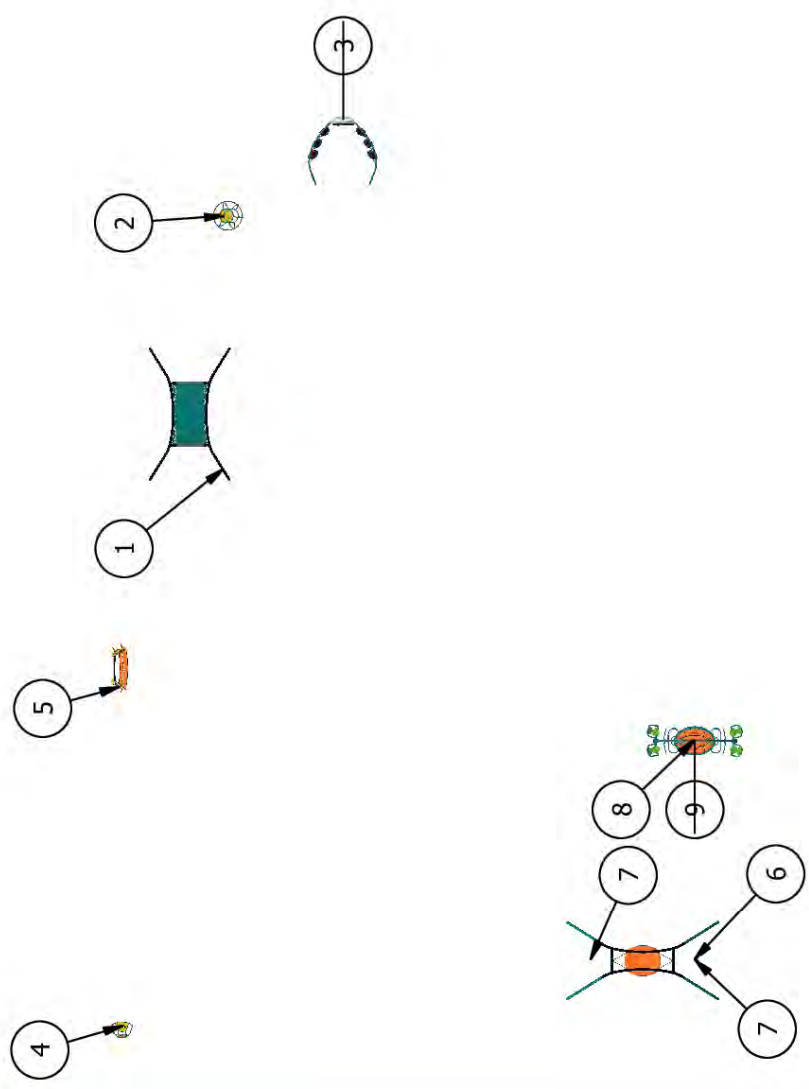

SERIES Burke Basics **COMPONENT VIEW**

GROUP: Freestanding 01/19/2024

DESIGNED FOR AGES: 2 to 12 **Municipal Park**

Lathrup Village, MI 48076-3412

Burke
PLAY THAT MOVES YOU

Snider Recreation, Inc.
127-179508-1
Designer: Hunter Mielke

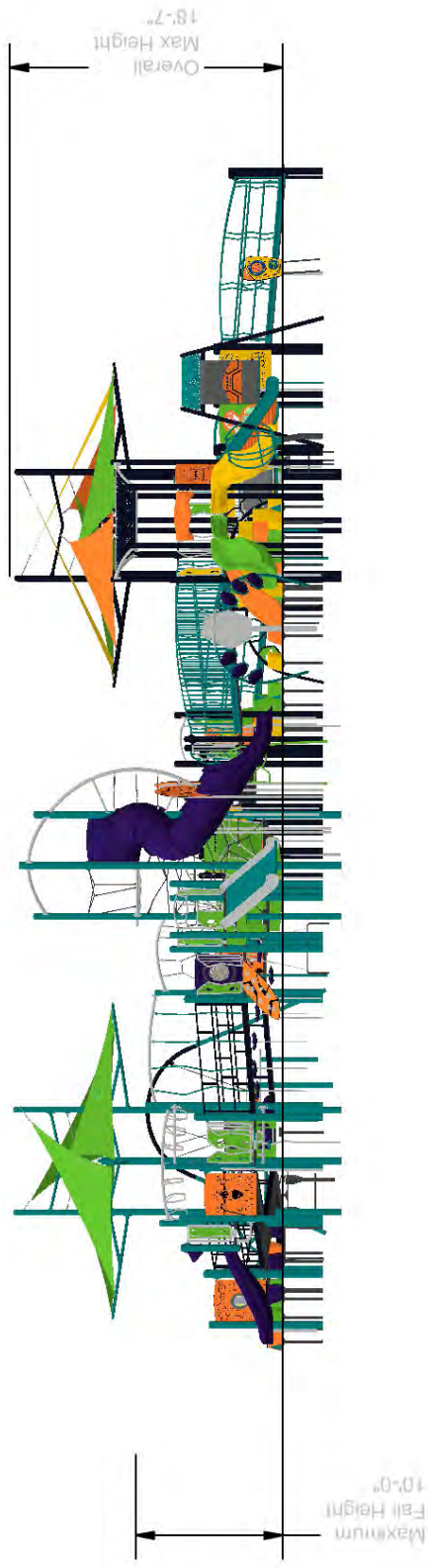

SERIES Burke Basics | Nucleus | Intensity **ELEVATION VIEW**

GROUP:
5-12 Structure|2-5 Structure|Freestanding

Municipal Park
Lathrup Village, MI 48076-3412

01/19/2024

DESIGNED FOR AGES:
5 to 12, 2 to 5, 2 to 12



Snider Recreation, Inc.
127-179508-1

Designer: Hunter Mielke

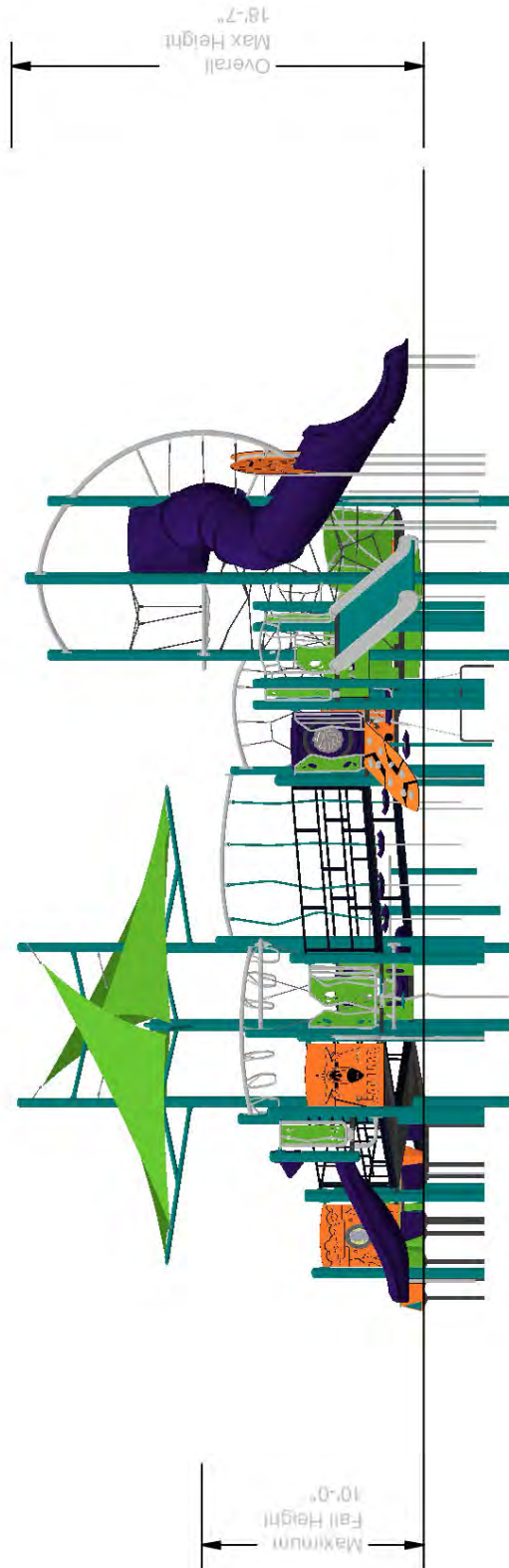

SERIES Nucleus | Burke Basics | Intensity **ELEVATION VIEW**

<p>GROUP: 5-12 Structure</p> <p>DESIGNED FOR AGES: 5 to 12</p>	<p>Municipal Park Lathrup Village, MI 48076-3412</p> <p>Burke PLAY THAT MOVES YOU</p>	<p>01/19/2024</p> <p>Snider Recreation, Inc. 127-179508-1</p> <p>Designer: Hunter Mielke</p>
--	---	--



SERIES Nucleus | Intensity | Burke Basics **ELEVATION VIEW**

<p>GROUP: 2-5 Structure</p> <p>DESIGNED FOR AGES: 2 to 5</p>	<p>Municipal Park Lathrup Village, MI 48076-3412</p> <p>Burke PLAY THAT MOVES YOU</p>	<p>01/19/2024</p> <p>Snider Recreation, Inc. 127-179508-1</p> <p>Designer: Hunter Mielke</p>
--	---	--

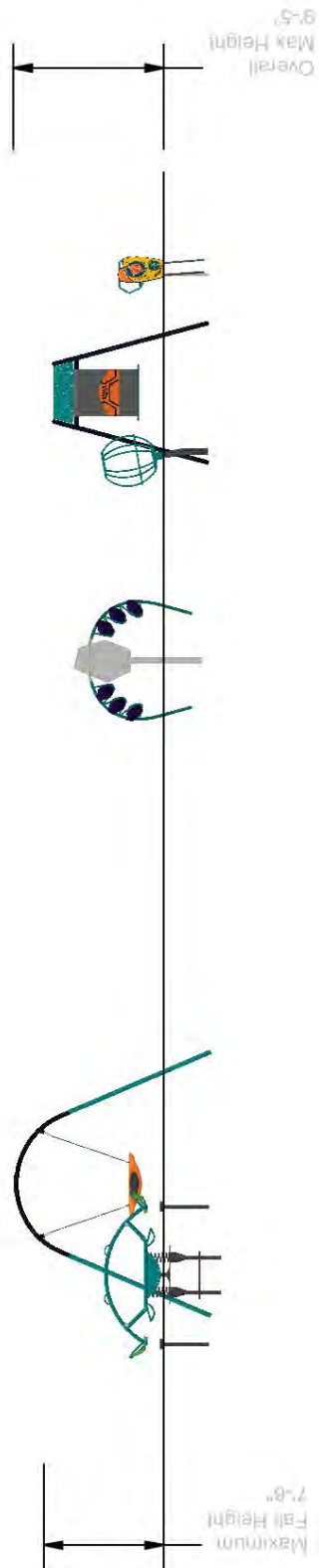

SERIES Burke Basics **ELEVATION VIEW**

GROUP:
Freestanding

DESIGNED FOR AGES:
2 to 12

Municipal Park
Lathrup Village, MI 48076-3412

Burke
PLAY THAT MOVES YOU

01/19/2024

Snider Recreation, Inc.
127-179508-1
Designer: Hunter Mielke



SERIES Burke Basics Nucleus Intensity		ISOMETRIC VIEW
GROUP: 5-12 Structure 2-5 Structure Freestanding	Municipal Park Lathrup Village, MI 48076-3412	01/19/2024
DESIGNED FOR AGES: 5 to 12, 2 to 5, 2 to 12	Burke PLAY THAT MOVES YOU	Snider Recreation, Inc. 127-179508-1 Designer: Hunter Mielke
BCI BURKE COMPANY, LLC PO BOX 549 FOND DU LAC, WI 54936-0549 920.921.9220 BCIBURKE.COM		



SERIES Nucleus | Burke Basics | Intensity **ISOMETRIC VIEW**

GROUP:
5-12 Structure

DESIGNED FOR AGES:
5 to 12

Municipal Park
Lathrup Village, MI 48076-3412

Burke
PLAY THAT MOVES YOU

01/19/2024

Snider Recreation, Inc.
127-179508-1

Designer: Hunter Mielke



<p>SERIES Nucleus Intensity Burke Basics</p>	<p>Municipal Park</p>	<p>ISOMETRIC VIEW</p>
<p>GROUP: 2-5 Structure</p>	<p>Lathrup Village, MI 48076-3412</p>	<p>01/19/2024</p>
<p>DESIGNED FOR AGES: 2 to 5</p>		<p>Snider Recreation, Inc. 127-179508-1 Designer: Hunter Mielke</p>



SERIES Burke Basics		ISOMETRIC VIEW
GROUP: Freestanding	Municipal Park Lathrup Village, MI 48076-3412	01/19/2024 Snider Recreation, Inc.
DESIGNED FOR AGES: 2 to 12	Burke PLAY THAT MOVES YOU	127-179508-1 Designer: Hunter Mielke

The play components identified in this proposal are IPEMA certified. The use and layout of these components conform to the requirements of ASTM F1487. To verify product certification, visit www.ipema.org.



The space requirements shown in this proposal are to ASTM standards. Requirements for other standards may be different.

Component No.	Description	Qty	User Cap	Ext. User Cap	Weight	Ext. Weight
---------------	-------------	-----	----------	---------------	--------	-------------

5-12 Structure

Nucleus

072-0500-100C	5" OD X 100" CAPPED POST	1	0	0	53	53
072-0500-104C	5" OD X 104" CAPPED POST	2	0	0	55	110
072-0500-112C	5" OD X 112" CAPPED POST	3	0	0	59	177
072-0500-116C	5" OD X 116" CAPPED POST	2	0	0	61	122
072-0500-120C	5" OD X 120" CAPPED POST	1	0	0	63	63
072-0500-124C	5" OD X 124" CAPPED POST	4	0	0	65	260
072-0500-128C	5" OD X 128" CAPPED POST	1	0	0	67	67
072-0500-132C	5" OD X 132" CAPPED POST	3	0	0	69	207
072-0500-136C	5" OD X 136" CAPPED POST	1	0	0	71	71
072-0500-144C	5" OD X 144" CAPPED POST	1	0	0	76	76
072-0500-196C	5" OD X 196" CAPPED POST	1	0	0	103	103
072-0500-80C	5" OD X 80" CAPPED POST	2	0	0	42	84
072-0500-92C	5" OD X 92" CAPPED POST	6	0	0	48	288
072-0500-96C	5" OD X 96" CAPPED POST	4	0	0	51	204
072-0502-168S	5" OD X 168" SWAGED POST	6	0	0	88	528
072-0502-216S	5" OD X 216" SWAGED POST	6	0	0	113	678
072-5503-24T	5" OD X 24" TOP ALUMINUM CAPP...	4	0	0	6	24
072-5503-36T	5" OD X 36" TOP ALUMINUM CAPP...	2	0	0	8	16
270-0120	EVOLUTION UNITARY ENCLOSURE	6	0	0	34	204
270-0122	EVOLUTION OFFSET ENCLOSURE	4	0	0	34	136
270-0131	HEXAGONAL PLATFORM S5P	5	12	60	287	1435
270-0132	HALF HEXAGON PLATFORM	1	6	6	144	144
270-0221	8" RISE RAMP W/ GUARDRAILS	4	10	40	356	1424
270-0223	8" RISE ENTRANCE RAMP W/ GUAR...	1	10	10	377	377
270-0290	HALF PLATFORM	1	3	3	57	57
270-0291	HALF PLATFORM W/SUPPORT	1	3	3	69	69
270-0292	EVOLUTION CENTER MOUNT ENCLOSURE	1	0	0	40	40
270-0300	ABSTRACT PLATFORM LADDER 16"	2	1	2	17	34
370-0016	GRAB BAR ASSEMBLY	2	0	0	6	12
370-0042	ASCEND ROCK CLIMBER, 32"-40"	1	2	2	100	100
370-0087	LEAF CLIMBER 16" - 24"	1	2	2	25	25
370-0223	PURSUIT CLIMBER 16"-40"	1	4	4	127	127
370-1622	TAKTIKS TRAIL TOWER	1	5	5	52	52
370-1702	NUCLEUS CORE ARCH CLIMBER	1	7	7	265	265
370-1703	NUCLEUS CORE CROSS SUPPORT	3	0	0	32	96
370-1706	NUCLEUS CORE CLIMBER, 10'	1	14	14	194	194
470-0006	EVOLUTION BOTTOM ROOF SUPPORT...	2	0	0	13	26
470-0008	EVOLUTION SIDE ROOF SUPPORT, ...	2	0	0	18	36
470-0009	EVOLUTION SIDE ROOF SUPPORT, ...	2	0	0	18	36
470-0014	EVOLUTION HEX ROOF	1	0	0	106	106

470-0112	COBRA SLIDE CURVED 120"	2	3	6	407	814
470-0128	FLYLOW POD	1	2	2	27	27
470-0678	ARA HEX SHADE CANOPY	1	0	0	575.864	575.864
470-0756	ROLLER SLIDE 48"-56"	1	3	3	721	721
470-0802	MONACO SLIDE, 32"-40"	1	2	2	70.6	70.6
470-0967	SLIDE HOOD, LOW SIDE WALL	1	0	0	37	37
570-0072	EVOLUTION HALF BARRIER	4	0	0	26.6	106.4
570-0622	PLATFORM ROLL GUARD	1	0	0	8	8
570-0716	CLICKER ACTIVITY PANEL	1	2	2	10	10
570-0718	HYPNO ACTIVITY PANEL	1	2	2	9	9
570-0797	CHARADE PANEL, ABOVE PLATFORM	1	2	2	61	61
570-0798	WAVER PANEL, ABOVE PLATFORM	1	2	2	61	61
570-0848	SIGNING 2-SIDED PLAY PANEL	1	2	2	44	44
570-1816	JET PANEL	1	2	2	48	48
570-1858	3-IN-A-ROW PANEL, ABOVE PLATFORM	1	2	2	45	45
570-1863	RAIN WHEEL PANEL	1	2	2	59	59
570-1865	HDPE UNITARY ENCLOSURE, NUCLEUS	2	1	2	26	52
570-2669	MAZE ACCESSIBLE REACH PANEL	1	2	2	16	16
570-2737	PINBALL PANEL	1	1	1	53	53
600-0104	NPPS SUPERVISION SAFETY KIT	1	0	0	3	3
660-0103	MAINTENANCE KIT, STRUCTURE	1	0	0	7	7
660-0104	INSTALLATION KIT, STRUCTURE	1	0	0	5	5
670-0422	HALF DECK UPPER POST 5" OD	2	0	0	26	52
670-0427	5" OD X 11 GA POST EXTENSION	6	0	0	10	60

Item 6A.

5-12 Structure

Burke Basics

560-0563	CRUISER WITH ADAPTER	1	12	12	1361	1361
560-2734	HOOP CLIMBER	1	2	2	55	55
560-2736	EKO CIRCA	3	1	3	60	180
560-2738	EKO TABLE	1	4	4	183	183
580-1312	NOVO ARC BENCH	3	2	6	43	129
580-1319	NOVO TEARDROP COUNTER CLIMBER	1	5	5	124	124

5-12 Structure

Intensity

370-0808	TWISTING TRAVERSE	1	5	5	103	103
370-0854	VERTO CLIMBER 1	1	1	1	35	35
370-1675	STRAIGHT OVERHEAD, NUCLEUS	2	6	12	53	106
370-1718	TAKTIKS BOW CLIMBER	1	7	7	103	103
570-0814	PROPELLER RING PANEL	1	2	2	66	66

Total User Capacity: 251
 Total Weight: 13518 lbs.
 Total Price: \$203,988

Freestanding

Burke Basics

550-0225	CIRRUS SWING	1	0	0	437	437
550-9118	BRAVA UNIVERSAL SWING	1	6	6	530	530
560-2586	COMET I	1	6	6	154	154
560-2625	MOVMT INCLUSIVE, FREESTANDING	1	2	2	328	328
560-2735	ARO SPINNING CHAIR	1	1	1	42	42
570-2727	ORB ROCKER FOOTER	1	0	0	93	93

570-2745	ORB ROCKER	1	8	8	540.9	540.9
580-1410	STEM PLAYFUL BENCH	1	2	2	122	122
660-0101	INSTALL KIT, BURKE BASICS - P...	1	0	0	2	2

Item 6A.

Total User Capacity: 25
Total Weight: 2249 lbs.
Total Price: \$50,001

2-5 Structure

Nucleus

072-0500-100C	5" OD X 100" CAPPED POST	7	0	0	53	371
072-0500-112C	5" OD X 112" CAPPED POST	6	0	0	59	354
072-0500-120C	5" OD X 120" CAPPED POST	2	0	0	63	126
072-0500-160C	5" OD X 160" CAPPED POST	4	0	0	84	336
072-0500-172C	5" OD X 172" CAPPED POST	2	0	0	90	180
072-0500-76C	5" OD X 76" CAPPED POST	2	0	0	40	80
072-0500-84C	5" OD X 84" CAPPED POST	1	0	0	44	44
072-0500-88C	5" OD X 88" CAPPED POST	6	0	0	46	276
072-0502-168S	5" OD X 168" SWAGED POST	6	0	0	88	528
072-0502-52S	5" OD X 52" SWAGED POST	1	0	0	28	28
072-0504-10B	5" OD X 10" STUBBY POST	1	0	0	6	6
270-0012	12' ADAAG RAMP W/GUARDRAIL	2	18	36	516	1032
270-0014	12' ADAAG RAMP W/BARRIER	1	18	18	761	761
270-0016	12' ADAAG ENTRANCE RAMP W/GUA...	1	18	18	548	548
270-0120	EVOLUTION UNITARY ENCLOSURE	6	0	0	34	204
270-0121	EVOLUTION STANCHION	1	0	0	43	43
270-0122	EVOLUTION OFFSET ENCLOSURE	2	0	0	34	68
270-0129	TRIANGLE PLATFORM	1	2	2	48	48
270-0130	SQUARE PLATFORM	2	6	12	106	212
270-0131	HEXAGONAL PLATFORM S5P	5	12	60	287	1435
370-0087	LEAF CLIMBER 16" - 24"	1	2	2	25	25
370-1645	MANITOU CLIMBER 48"	1	4	4	87	87
370-1670	PETAL STEP CLIMBER 16"-24"	1	1	1	30	30
370-1680	BETA CLIMBER 32"-40"	1	1	1	71	71
370-1720	LIL NOVO BALANCE BEAM LINK	1	3	3	58	58
470-0569	VIPER II SS 48-56	1	4	4	307	307
470-0678	ARA HEX SHADE CANOPY	1	0	0	575.864	575.864
470-0756	ROLLER SLIDE 48"-56"	1	3	3	721	721
470-0802	MONACO SLIDE, 32"-40"	1	2	2	70.6	70.6
470-0808	EVOLUTION ROOF BOTTOM EDGE	2	0	0	13	26
470-0813	EVOLUTION HEX ROOF	1	0	0	211	211
470-0836	ROCK'N ROLL SLIDE, 24-32 W/O ...	1	1	1	50	50
470-0967	SLIDE HOOD, LOW SIDE WALL	2	0	0	37	74
570-0102	INNOVA BRIDGE	1	18	18	847	847
570-0578	NAME THE STATES PANEL	1	4	4	46	46
570-0622	PLATFORM ROLL GUARD	1	0	0	8	8
570-0718	HYPNO ACTIVITY PANEL	1	2	2	9	9
570-0811	BRAILLE PANEL	1	4	4	55	55
570-0846	SPANISH 2-SIDED PLAY PANEL	1	2	2	44	44
570-1679	SPROCKET PANEL, ABOVE PLATFORM	1	2	2	64	64
570-1683	PARATROOP PANEL, ABOVE PLATFORM	1	3	3	54	54
570-1851	CHIMES PANEL	1	4	4	56	56
570-1858	3-IN-A-ROW PANEL, ABOVE PLATFORM	1	2	2	45	45
570-2666	CAR PANEL	1	2	2	53	53
570-2667	BEE ACCESSIBLE REACH PANEL	1	2	2	16	16
570-2678	CLOCK PANEL	1	1	1	50	50
570-2701	COLLISION PANEL, ABOVE PLATFORM	1	1	1	55	55
570-2729	CLASSIC GAME RING PANEL	1	2	2	80	80

570-2732	PLAYENSEMBLE BABEL DRUM	1	1	1	14	14
670-0425	5" OD STUBBY POST CAP	1	0	0	1	1

Item 6A.

2-5 Structure

Intensity

370-0031	POWER PIPES CLIMBER 2-5	1	6	6	33	33
370-0842	APEX HOLE CLIMBER 2-5	1	2	2	55	55

2-5 Structure

Burke Basics

560-2705	EKO SOLO	2	1	2	24	48
560-2707	EKO DUAL	2	2	4	47	94
560-2709	EKO BUNDLE	2	6	12	148	296
560-2715	EKO ULTIMATE	1	18	18	505	505

Total User Capacity: 261
 Total Weight: 11515 lbs.
 Total Price: \$160,274

Special Notes:

Prices do not include freight, unloading, material storage, site excavation/preparation, removal of existing equipment, removal of excess soil from footing holes, site security, safety surfacing, installation, or sales tax (if applicable). Prices are based on standard colors per CURRENT YEAR BCI Burke Catalog. Custom colors, where available, would be an extra charge. **Pricing is valid for 30 days from the date of this proposal.**

COLOR SELECTION LIST | PlaygroundColorOption:1

GROUP 1 (Freestanding)

Acc: Aqua
 Panel: Orange-Black-Orange | Yellow-Black-Yellow | Purple-Gray-Purple | Lime-Black-Lime | Blue-Yellow-Blue
 Post: Navy | Silver | Aqua
 Flat: Yellow | Lime
 Plastic: Purple | Orange

GROUP 2 (2-5 Structure)

Deck: Gray
 Acc: Silver | Aqua | Lime | Orange
 Flat: Lime | Yellow | Orange
 Panel: Orange-Black-Orange | Yellow-Black-Yellow | Lime-Black-Lime
 Post: Navy | Aqua | Orange
 Plastic: Yellow | Lime | Orange
 Canopy: Yellow | Orange | Lime

GROUP 3 (5-12 Structure)

Deck: Gray
 Flat: Lime | Orange | Purple
 Post: Aqua
 Acc: Silver | Navy | Aqua
 Plastic: Purple | Lime | Orange
 Panel: Orange-Black-Orange | Lime-Black-Lime | Purple-Gray-Purple
 Canopy: Lime

COLORS THAT MOVE YOU

POWDER COAT PAINT



SOLIS HUE TOPPERS

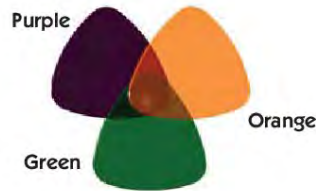

ROCKIT CLIMBERS



PLATFORMS



HDPE PLASTIC PANELS

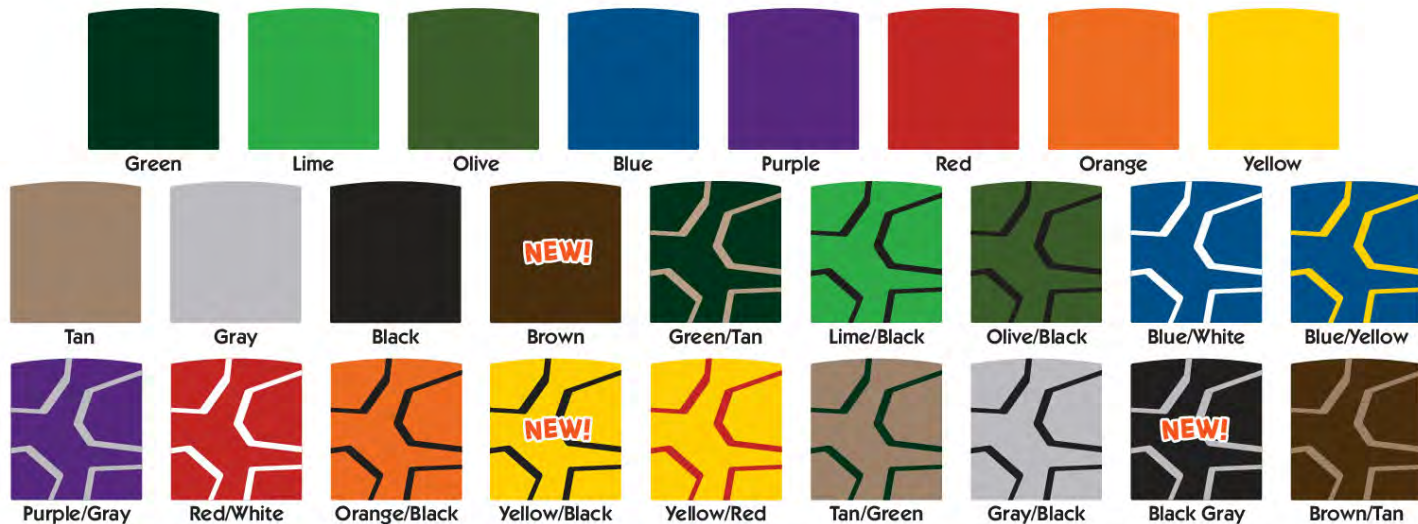

SHADE CANOPIES

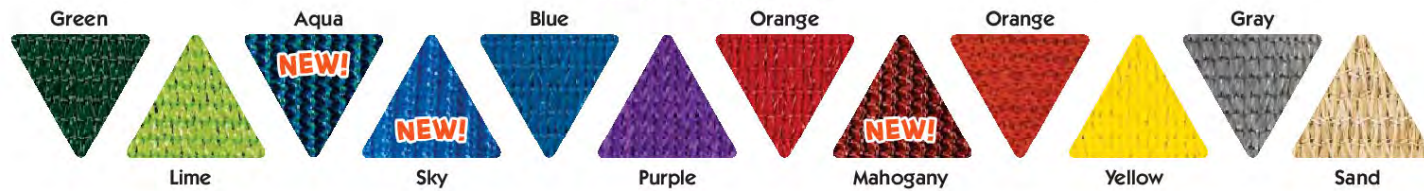

ROTOMOLD PLASTIC

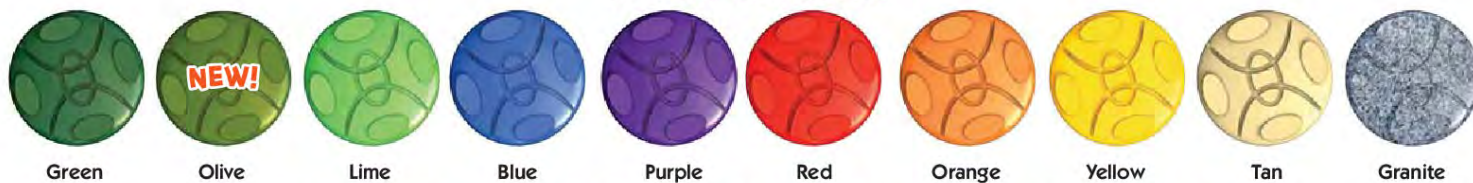

VISIT BCIBURKE.COM/COLOR TO CUSTOMIZE YOUR PLAYGROUND COLORS!

Volito Swing

Safety Standards & Guidelines - Reference Information

The Volito Swing was designed to allow multiple children to swing and engage together. For many years the only swings available for kids to use together were tire swings, which are fun and challenging but presented opportunities for improvement. Tire swings are able to rotate and pivot in all directions, often in an unpredictable manner and, because they aren't easy to propel while sitting on them, other children often have to push the swing to gain and maintain motion. The Volito Swing, along with many similar swings in this growing market trend, provides a multi-user swing that moves in a single axis to-and-fro motion.

The Volito Swing is IPEMA Certified and meets or exceeds the requirements of ASTM F1487-17, which is recognized as the standard of care in the playground industry. This ASTM public playground safety standard is revised every two to three years to remain current with innovation and market trends.

The CPSC Public Playground Safety Handbook hasn't been revised since 2008 and doesn't include new product categories that have been innovated in recent years. There are a couple of points to note when deciding to purchase a multi-user swing:

- Multi-user swings are innovative and CPSC Public Playground Safety Handbook doesn't have a standard that specifically covers them.
- CPSC 5.3.8.3.1 – CPSC recommends that belt swing seats should be designed to accommodate no more than one user at any time. While the Volito Swing is a single axis swing, it is clearly not a belt seat.
- CPSC 2.3.1 – CPSC says that swings intended for more than one user are not recommended because of their greater mass, as compared to single occupancy swings, presents a risk of impact injury.
- The ASTM safety standard, F1487, was revised in 2011 to add maximum impact requirements for swings and the Volito Swing has been tested and is compliant with ASTM impact requirements.
- CPSC has written a letter stating that “the swing impact test in F1487-11 is a reasonable approach to address the concerns posed by unoccupied, heavy, multiple occupancy swings.”
- CPSC has always included an exemption to both recommendations listed above for tire swings, which are multiple occupancy swings that are suspended from a single pivot and permit swinging in any direction.
- CPSC also emphasizes that their Handbook provides recommendations, not requirements. If a jurisdiction adopts the Handbook's recommendations as mandatory requirements, that jurisdiction would need to determine how the requirements should be applied in any particular instance.

BURKE GENERATIONS WARRANTY®

The Longest and Strongest warranty in the industry

BCI Burke Company, LLC ("Burke") warrants that all standard products are warranted to be free from defects in materials and workmanship, under normal use and service, for a period of one (1) year from the date of shipment.

We stand behind our products. In addition, the following products are warranted, under normal use and service from the date of shipment as follows:

- One Hundred (100) Year Limited Warranty on aluminum and steel upright posts (including Intensity®, Synergy™, Nucleus®, Voltage®, Little Buddies®, ELEVATE®, ACTIVATE®, INVIGORATE™) against structural failure due to corrosion, deterioration or workmanship.
- One Hundred (100) Year Limited Warranty on KoreKornect® clamps against structural failure due to corrosion, deterioration or workmanship.
- One Hundred (100) Year Limited Warranty on Hardware (nuts, bolts, washers)
- One Hundred (100) Year Limited Warranty on bolt-through fastening and clamp systems (Synergy™, Intensity®, Nucleus®, Voltage®, Little Buddies®, ELEVATE®).
- Twenty-Five (25) Year Limited Warranty on spring assemblies and aluminum cast animals.
- Fifteen (15) Year Limited Warranty on structure platforms and decks, metal roofs, table tops, bench tops, railings and barriers against structural failure due to materials or workmanship.
- Fifteen (15) Year Limited Warranty on all plastic components including StoneBorders against structural failure due to materials or workmanship.
- Ten (10) Year Limited Warranty on ShadePlay Canopies fabric, threads, and cables against degradation, cracking or material breakdown resulting from ultra-violet exposure, natural deterioration or manufacturing defects. This warranty is limited to the design loads as stated in the specifications.
- Ten (10) Year Limited Warranty on NaturePlay® Boulders and GFRC products against structural failure due to natural deterioration or workmanship. Natural wear, which may occur with any concrete product with age, is excluded from this warranty.
- Ten (10) Year Limited Warranty on Full Color Custom Signage against manufacturing defects that cause delamination or degradation of the sign. Full Color Custom Signs also carry a two (2) year warranty against premature fading of the print and graphics on the signs.
- Five (5) Year Limited Warranty on Intensity® and RopeVenture® cables and LEVEL X® flex bridge against premature wear due to natural deterioration or manufacturing defects. Determination of premature wear will be at the manufacturer's discretion.
- Five (5) Year Limited Warranty on moving parts, including swing components, against structural failure due to materials or workmanship.
- Five (5) Year Limited Warranty on PlayEnsemble® cables and mallets against defects in materials and workmanship.
- Three (3) Year Limited Warranty on electronic panel speakers, sound chips and circuit boards against electronic failure caused by manufacturing defects.

The warranty stated above is valid only if the equipment is erected in conformity with the layout plan and/or installation instructions furnished by BCI Burke Company, LLC using approved parts; have been maintained and inspected in accordance with BCI Burke Company, LLC instructions. Burke's liability and your exclusive remedy hereunder will be limited to repair or replacement of those parts found in Burke's reasonable judgment to be defective. Any claim made within the above stated warranty periods must be made promptly after discovery of the defect. A part is covered only for the original warranty period of the applicable part. Replacement parts carry the applicable warranty from the date of shipment of the replacement from Burke. After the expiration of the warranty period, you must pay for all parts, transportation and service charges.

Burke reserves the right to accept or reject any claim in whole or in part. Burke will not accept the return of any product without its prior written approval. Burke will assume transportation charges for shipment of the returned product if it is returned in strict compliance with Burke's written instructions.

THE FOREGOING WARRANTIES ARE EXCLUSIVE AND IN LIEU OF ANY OTHER WARRANTY, EXPRESS OR IMPLIED, INCLUDING BUT NOT LIMITED TO ANY IMPLIED WARRANTY OR MERCHANTABILITY OR FITNESS FOR A PARTICULAR PURPOSE. IF THE FOREGOING DISCLAIMER OF ADDITIONAL WARRANTIES IS NOT GIVEN FULL FORCE AND EFFECT, ANY RESULTING ADDITIONAL WARRANTY SHALL BE LIMITED IN DURATION TO THE EXPRESS WARRANTIES AND BE OTHERWISE SUBJECT TO AND LIMITED BY THE TERMS OF BURKE'S PRODUCT WARRANTY. SOME STATES DO NOT ALLOW THE EXCLUSION OF CERTAIN IMPLIED WARRANTIES, SO THE ABOVE LIMITATION MAY NOT APPLY TO YOU.

Warranty Exclusions: The above stated warranties do not cover: "cosmetic" defects, such as scratches, dents, marring, or fading; damage due to incorrect installation, vandalism, misuse, accident, wear and tear from normal use, exposure to extreme weather; immersion in salt or chlorine water, unauthorized repair or modification, abnormal use, lack of maintenance, or other cause not within Burke's control; and

Limitation of Remedies: Burke is not liable for consequential or incidental damages, including but not limited to labor costs or lost profits resulting from the use of or inability to use the products or from the products being incorporated in or becoming a component of any other product. If, after a reasonable number of repeated efforts, Burke is unable to repair or replace a defective or nonconforming product, Burke shall have the option to accept return of the product, or part thereof, if such does not substantially impair its value, and return the purchase price as the buyer's entire and exclusive remedy. Without limiting the generality of the foregoing, Burke will not be responsible for labor costs involved in the removal of products or the installation of replacement products. Some states do not allow the exclusion of incidental damages, so the above exclusion may not apply to you.

The environment near a saltwater coast can be extremely corrosive. Some corrosion and/or deterioration is considered "normal wear" in this environment. Product installed within 500 yards of a saltwater shoreline will only be covered for half the period of the standard product warranty, up to a maximum of five years, for defects caused by corrosion. Products installed in direct contact with saltwater or that are subjected to salt spray are not covered by the standard warranty for any defects caused by corrosion.

Contact your local Burke Representative for warranty information regarding Burke Turf® and Burke Tile products.

Terms of Sale

Pricing: Prices published in this catalog are in USD, are approximate and do not include shipping & handling, surfacing, installation nor applicable taxes. All prices are subject to change without notice. Contact your Burke representative for current pricing. Payments are to be made in USD.

Weights: Weights are approximate and may vary with actual orders.

Installation: All equipment is shipped unassembled. For a list of factory-certified installers in your area, please contact your Burke representative.

Specifications: Product specifications in this catalog were correct at the time of publication. However, product improvements are ongoing at Burke, and we reserve the right to change or discontinue specifications without notice.

Loss or Damage in Transit: A signed bill of lading is our receipt from a carrier that our shipment to you was complete and in good condition upon arrival. Before you sign, please check the Bill of Lading carefully when the shipment arrives to make sure nothing is missing and there are no damages. Once the shipment leaves our plant, we are no longer responsible for any damage, loss or shortage.

For more information regarding the warranty, call Customer Service at 920-921-9220 or 1-800-356-2070.

01/2021



February 09, 2024

Job # 18736.24

BID RECOMMENDATION

City of Lathrup Village DDA
27400 Southfield Road
Lathrup Village, MI, 48076
ATTN: Susie Stec, DDA Director

RE: 2024 Alley Reconstruction Project, Contract LV24-01

Dear Mrs. Stec,

Bids for the 2024 Alley Reconstruction project were received on February 8th, 2024 at 2:00 p.m. and were opened publicly and read aloud.

A total of eleven (11) bids were received ranging from a low of \$234,012.00 to \$390,805.00. The low bid was submitted by L. Anthony Construction Co., 12185 East Ridge Dr, Bruce Twp, MI 48065, (586) 634-6908. The second low bid was submitted by Great Lakes Contracting Solutions at \$249,743.70.

L. Anthony has been in business for over 20 years. We have reviewed their references and find them positive. L. Anthony has also performed work for other municipalities we represent and has performed well.

Based on positive references, past work performed, and their low bid submittal, we recommend that the contract be awarded to L. Anthony Construction at the base bid of \$234,012.00. Final cost will vary based on field-measured final quantities of work.

Contract documents will be submitted to you upon execution by the contractor.

Respectfully,

A handwritten signature in black ink, appearing to read "Scott A. Ringler".

Scott A. Ringler, PE
Partner Emeritus

Cc: Mike Greene, City Administrator
Brittany Dorsey, DDA and Special Projects Manager

Encl: Bid Tabulation



2024 Alley Reconstruction, Contract LV24-01

City of Lathrup Village, Oakland County, Michigan
Bids opened on 02/08/2024 at 2:00 pm

A. Construction			Engineer's Opinion of Cost Giffels Webster 1025 E. Maple Road, Suite 100 Birmingham, MI 48009		Lowest Bidder L. Anthony Construction 12185 East Ridge Dr. Bruce Twp., MI 48065		Second Bidder Great Lakes Contracting Solutions 2300 Edinburgh Rd. Waterford, MI 48328	
Item	Description	Quantity Unit	Unit Price	Amount	Unit Price	Amount	Unit Price	Amount
1	Mobilization, Max 5%	1 Ls	\$ 12,500.00	\$ 12,500.00	\$ 5,000.00	\$ 5,000.00	\$ 11,000.00	\$ 11,000.00
2	Traffic Control, Max 3%	1 Ls	\$ 7,500.00	\$ 7,500.00	\$ 4,000.00	\$ 4,000.00	\$ 6,900.00	\$ 6,900.00
3	Reimbursed Permit Fees	1,000 Dir	\$ 1.00	\$ 1,000.00	\$ 1.00	\$ 1,000.00	\$ 1.00	\$ 1,000.00
4	Culv, Rem, Less than 24 Inch Dia	1 Ea	\$ 400.00	\$ 400.00	\$ 50.00	\$ 50.00	\$ 675.00	\$ 675.00
5	Pavt, Rem	145 Syd	\$ 18.00	\$ 2,610.00	\$ 20.00	\$ 2,900.00	\$ 13.65	\$ 1,979.25
6	Sidewalk, Rem	53 Syd	\$ 18.00	\$ 954.00	\$ 10.00	\$ 530.00	\$ 13.65	\$ 723.45
7	Excavation, Earth, Lincoln West	1 Ls	\$ 13,000.00	\$ 13,000.00	\$ 6,000.00	\$ 6,000.00	\$ 9,700.00	\$ 9,700.00
8	Excavation, Earth, Lincoln East	1 Ls	\$ 13,750.00	\$ 13,750.00	\$ 5,000.00	\$ 5,000.00	\$ 8,600.00	\$ 8,600.00
9	Excavation, Earth, Ramsgate	1 Ls	\$ 8,250.00	\$ 8,250.00	\$ 1,500.00	\$ 1,500.00	\$ 2,400.00	\$ 2,400.00
10	Excavation, Earth, Margate	1 Ls	\$ 1,000.00	\$ 1,000.00	\$ 1,000.00	\$ 1,000.00	\$ 450.00	\$ 450.00
11	Subgrade Undercutting, 21AA	60 Cyd	\$ 65.00	\$ 3,900.00	\$ 50.00	\$ 3,000.00	\$ 65.00	\$ 3,900.00
12	Erosion Control Inlet Filter Drop Cloth	9 Ea	\$ 150.00	\$ 1,350.00	\$ 50.00	\$ 450.00	\$ 175.00	\$ 1,575.00
13	Aggregate Base, 4 Inch, 21AA	64 Syd	\$ 18.00	\$ 1,152.00	\$ 12.00	\$ 768.00	\$ 13.75	\$ 880.00
14	Aggregate Base, 6 Inch, 21AA	1,775 Syd	\$ 16.00	\$ 28,400.00	\$ 12.00	\$ 21,300.00	\$ 15.00	\$ 26,625.00
15	Geotextile, Seperator, Non-Woven, CSI N400E	1,775 Syd	\$ 2.50	\$ 4,437.50	\$ 3.00	\$ 5,325.00	\$ 4.75	\$ 8,431.25
16	Dr Structure Cover, Adj, Case I	7 Ea	\$ 900.00	\$ 6,300.00	\$ 250.00	\$ 1,750.00	\$ 475.00	\$ 3,325.00
17	Culv, CI F, 8 Inch, CMP	30 Ft	\$ 70.00	\$ 2,100.00	\$ 50.00	\$ 1,500.00	\$ 65.00	\$ 1,950.00
18	HMA Surface, Rem	1,705 Syd	\$ 8.00	\$ 13,640.00	\$ 10.00	\$ 17,050.00	\$ 10.50	\$ 17,902.50
19	Edge Trimming	690 Ft	\$ 4.00	\$ 2,760.00	\$ 1.50	\$ 1,035.00	\$ 4.50	\$ 3,105.00
20	Hand Patching	21 Ton	\$ 200.00	\$ 4,200.00	\$ 300.00	\$ 6,300.00	\$ 375.00	\$ 7,875.00
21	Conc Pavt with Integral Curb, Nonreinf, 7 Inch	479 Syd	\$ 80.00	\$ 38,320.00	\$ 76.00	\$ 36,404.00	\$ 62.00	\$ 29,698.00
22	Conc Pavt, Nonreinf, 7 Inch	1,297 Syd	\$ 70.00	\$ 90,790.00	\$ 76.00	\$ 98,572.00	\$ 62.00	\$ 80,414.00
23	Joint, Plane of Weakness, W	1,404 Ft	\$ 4.00	\$ 5,616.00	\$ 1.00	\$ 1,404.00	\$ 1.90	\$ 2,667.60
24	Joint, Longitudinal Lane Tie, D	747 Ft	\$ 5.00	\$ 3,735.00	\$ 1.00	\$ 747.00	\$ 4.50	\$ 3,361.50
25	Detectable Warning Surface	5 Ft	\$ 75.00	\$ 375.00	\$ 50.00	\$ 250.00	\$ 60.00	\$ 300.00
26	Sidewalk Ramp, Conc, 6 Inch	91 Sft	\$ 10.00	\$ 910.00	\$ 8.00	\$ 728.00	\$ 9.40	\$ 855.40
27	Sidewalk, Conc, 4 Inch	396 Sft	\$ 8.00	\$ 3,168.00	\$ 7.00	\$ 2,772.00	\$ 7.25	\$ 2,871.00
28	Sidewalk, Conc, 7 Inch	754 Sft	\$ 10.00	\$ 7,540.00	\$ 8.00	\$ 6,032.00	\$ 8.75	\$ 6,597.50
29	Landscape Restoration	279 Syd	\$ 12.00	\$ 3,348.00	\$ 5.00	\$ 1,395.00	\$ 12.75	\$ 3,557.25
30	Water, Sodding / Seeding	5 Unit	\$ 100.00	\$ 500.00	\$ 50.00	\$ 250.00	\$ 85.00	\$ 425.00
A. Subtotal Construction:				\$ 283,505.50		\$ 234,012.00		\$ 249,743.70
Total Construction:				\$ 283,505.50		\$ 234,012.00		\$ 249,743.70

Bids opened on 2/8/2024 at 2:00 pm
by S. Ringler and M. Greene

Other Bidders:

- Luigi Ferdinandi & Son Cement Co., Inc. \$255,941.03
- GM & Sons, Inc. \$262,776.00
- Metropolitan Concrete Corp. \$267,208.00
- Hartwell Cement Company \$285,147.50
- Lacaria Concrete Construction **\$296,698.00**
- D. Macro Contractors Inc. \$308,416.96
- Koala-T Construction Inc. \$308,779.85
- Warren Contractors & Development Inc. \$343,705.50
- Audia Concrete Construction Inc. \$390,805.00

Corrected By Engineer



27400 Southfield Rd
Lathrup Village, MI 48076
(248) 557 - 2600
www.lathrupvillage.org

To: DDA Board of Directors

From: Susie Stec, Director – Community & Economic Development /DDA Director

RE: Façade & Site Improvement Grant – 28400 Southfield Road

Date: February 13, 2024

A Façade & Site Improvement Grant application was submitted by Levy & Associates, Inc. on January 23, 2024. They are planning to replace the twenty-two (22) existing windows on their building. This is an eligible project under the Façade & Site Improvement Program Guidelines. Levy & Associates, Inc. has received estimates for the work ranging from \$19,500 – \$21,870. Enclosed is their application packet.

Suggested Motion: To award a DDA Façade and Site Improvement Grant in the amount of \$9,750 to the property owner of 28400 Southfield Road to be reimbursed upon final approval by the Building Official and inspection by the Director – Community & Economic Development/DDA.

LAWRENCE B. LEVY*Δ
DAVID A. KROPP, C.P.A.+
BIANCA ASMAR, ESQ.**
E. DAVID BROCKMAN, ESQ.†
DANIELLE BEYDA, ESQ.***

LEVY & ASSOCIATES, INC.
28400 SOUTHFIELD ROAD
LATHRUP VILLAGE, MI 48076
TEL (248) 557-4048 FACSIMILE (248) 443-1642

+MEMBER
MICHIGAN ASSOCIATION OF
CERTIFIED PUBLIC ACCOUNTANTS
*MEMBER
NATIONAL SOCIETY OF ACCOUNTANTS
**MEMBER
MICHIGAN BAR ASSOCIATION
‡ MEMBER
MICHIGAN BAR ASSOCIATION
Licensed to Practice in
US Tax Court and Pennsylvania
***MEMBER
FLORIDA BAR ASSOCIATION
•MEMBER
CALIFORNIA BAR ASSOCIATION
◇MEMBER
AMERICAN BAR ASSOCIATION
ΔAMERICAN SOCIETY OF TAX
PROBLEM SOLVERS
∞FORMER IRS REVENUE OFFICER
⊞FORMER IRS APPEALS OFFICER
† FORMER MICHIGAN
ASSISTANT ATTORNEY GENERAL

CLAIRE COFFEY, E.A.∞
ANNA MACE, EA∞
GREG MAHAFFEY, E.A.∞
DANIEL MARINE, E.A.
LAURA ROCA, EA
MARCELO SCHILLER, E.A.
RICHARD SCHUNNEMAN, EA∞
GREGORY WERT, EA□

January 23, 2024

Dear City of Lathrup Village,

We are excited to apply for the grant. We have been a long standing business in the city of Lathrup Village and we are looking to replace the windows in the building with this grant. Thank you so much for this consideration.

Sincerely,

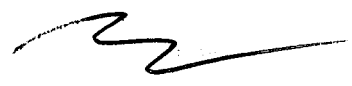

Lawrence Levy
Levy & Associates, Inc.

FAÇADE IMPROVEMENT & SITE BEAUTIFICATION GRANT PROGRAM APPLICATION FORM

PROPERTY INFORMATION

Property Address:	28400 Southfield Rd. Lathrup Village, MI 48076
Parcel ID Number:	
Current Zoning:	

BUSINESS INFORMATION

Business Name:	Levy & Associates, Inc
Business Owner Name:	Lawrence Levy
Mailing Address (if different):	
Phone Number:	248 228-2122
Email:	Ltobia@levytaxpro.com
Project Description:	Window Replacement

PROPERTY OWNER INFORMATION

Property Owner Name:	Lawrence Levy
Property Owner Address:	28400 Southfield Rd. Lathrup Village, MI 48076
Property Owner Phone:	248 228-2122
Property Owner Email:	Ltobia@levytaxpro.com

Applications must include the following attachments to be considered for funding. Incomplete applications will not be accepted or considered for funding:

- Current digital photos of all building façades visible from the public right-of-way which will receive improvements
- A schematic drawing with enough detail to depict the proposed improvements. For landscaping projects, a complete list of plant species and quantities
- Signed bids from two (2) licensed contractors with detailed costs for each improvement (excluding ineligible portions of improvements, e.g. lettering on awnings), with the right to request additional proposals, if necessary
- For tenants, building owner's consent for improvements is required
- Completed IRS Form W-9 Request for Taxpayer Identification Number and Certification
- Project description of proposed façade and/or site beautification work, including information about the proposed building/planting materials and methodology for proposed changes
- Business plan which includes a description of your business and the related industry, as well as credentials and experience of business owner
- Any unusual or expected difficulties or hardships in making the proposed improvements

Completed applications should be returned to:

Lathrup Village DDA
 Attn: Susie Stec
 27400 Southfield Road
 Lathrup Village, MI 48076
sstec@lathrupvillage.org

FAÇADE IMPROVEMENT & SITE BEAUTIFICATION GRANT PROGRAM AFFIRMATION FORM

The undersigned applicant affirms and understands that:

1. The information submitted herein is true and accurate to the best of my knowledge.
2. I have read and understand the Façade Improvement & Site Beautification Grant Program Guidelines, Village Center Design Guidelines, Section 5.13 Off-Street Parking, and Section 5.15 Landscaping Regulations and agree to abide by these conditions, as applicable to the proposed project.
3. I understand that any changes made to the approved design without the approval of the DDA may be cause to withdraw the DDA's funding commitment.
4. I understand and agree to the pay back schedule if the business closes or moves from Lathrup Village within three years of being awarded a facade grant.
5. The property owner and business owner shall indemnify, defend, and hold the Downtown Development Authority and the City of Lathrup Village, their affiliates, and their respective officers, directors, council, members, employees, agents, and other representatives harmless from and against all claims, losses, expenses, liabilities, demands, obligations, or damages of every kind and nature (including, without limitation, reasonable attorney fees and expenses) (Losses), arising out of or related to (i) any act or omission of property owner and business owner or (ii) any breach of this Agreement by the property owner and business owner relative to this grant.



1/23/2024

Signature – Business Owner

Date

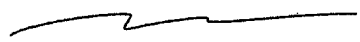

1/23/2024

Signature – Property Owner

Date

Best View Inc

Item 7B.

Job Invoice

SOLD TO		DATE ORDERED	ORDER TAKEN BY
Levy & Associates		PHONE NO.	CUSTOMER ORDER #
28400 Southfield Rd		(248) 4431207	
Lathrup Village, MI 48076		JOB LOCATION	
		JOB PHONE	STARTING DATE
		TERMS	

QTY.	MATERIAL	UNIT	AMOUNT	DESCRIPTION OF WORK
22-	White Vinyl Double Hung Windows All under 100ci			Total Window Removed Total Windows Install
*	All Windows to have 1/2 screens			Lead Certified
*	Frost Bath in Baths			MISCELLANEOUS CHARGES
*	All Windows to rec Foam Installation			
*	All Windows to rec White Alum trim & caulk			
*	All Windows outside install			
*	Replace any rotten wood around window			
TOTAL MATERIALS			19500. ⁰⁰	
				TOTAL LABOR

WORK ORDERED	TOTAL LABOR
DATE ORDERED	TOTAL MATERIALS
DATE COMPLETED	TOTAL MISCELLANEOUS
CUSTOMER APPROVAL SIGNATURE _____	SUBTOTAL
AUTHORIZED SIGNATURE _____	TAX
	GRAND TOTAL

Name	Levy Tax	Date:	1-19-24						
Address	28400 Southfield Road Lathrup Village	Email:							
		Attn:	Lance						
Location	Style	Add ons	Color	Qty	Width	Height	UI	Item Subtotal	Subtotal
Lower	Fixed		white	9	44	34	78	\$1,000.00	\$9,000.00
Lower	Fixed	frosted glass	white	2	28	34	62	\$1,150.00	\$2,300.00
Lower	Fixed		white	1	28	34	62	\$1,000.00	\$1,000.00
Upper	Hung		white	2	28	46	74	\$1,200.00	\$2,400.00
Upper	Hung		white	8	44	54	98	\$1,200.00	\$9,600.00
						60	60	\$0.00	\$0.00
						60	60	\$0.00	\$0.00
						60	60	\$0.00	\$0.00
						60	60	\$0.00	\$0.00
						70	70	\$0.00	\$0.00
						0	0	\$0.00	\$0.00
						0	0	\$0.00	\$0.00
						0	0	\$0.00	\$0.00
						0	0	\$0.00	\$0.00
						0	0	\$0.00	\$0.00
						0	0	\$0.00	\$0.00
						0	0	\$0.00	\$0.00
						0	0	\$0.00	\$0.00
				22				Subtotal:	\$24,300.00
								Discount:	-\$2,430.00
								Total:	\$21,870.00
Price includes Series 700 windows, Cardinal 270 LoE, double strength glass, argon gas.									
For custom painted exterior, add:									
									\$3,280.50



27400 Southfield Rd
 Lathrup Village, MI 48076
 (248) 557 - 2600
www.lathrupvillage.org

February 14, 2024

The Honorable Pete Buttigieg
 Secretary, U.S. Department of Transportation
 1200 New Jersey Ave., SE
 Washington, DC 20590

Re: Rebuilding American Infrastructure with Sustainability and Equity (RAISE) Grant Application

Dear Secretary Buttigieg:

I am writing to support the 2024 RAISE grant application partnership between the Road Commission for Oakland County (RCOC), the City of Lathrup Village and the Suburban Mobility Authority for Regional Transportation (SMART) to support the reconfiguration of the Southfield Road corridor in the City of Lathrup Village in Oakland County, Michigan. All three agencies have identified the need to improve safety, congestion and transit access along the corridor. This project will revitalize an essential thoroughfare, improving mobility, accessibility and comfort for all users utilizing all modes of travel. The total project cost is \$25,908,325 with a federal RAISE grant request of \$20,726,588 and a combined local match of \$5,181,647 from all three agencies. The City of Lathrup is committed to providing a local match of \$1,909,142 to support this project application.

This project begins at Meadowood Avenue and ends at Cambridge Boulevard. The scope of work will transform this section of Southfield Road into a divided boulevard, which will improve access to businesses, residential areas and job centers throughout the region. The scope of work includes reconstruction of the existing roadway into a six-lane roadway (three travel lanes in each direction) with a median, transit and active transportation infrastructure enhancements, signal modernization, pedestrian crosswalk upgrades to comply with the Americans with Disabilities Act (ADA), drainage enhancements, congestion mitigation measures and utility enhancements. SMART will also enhance amenities to bus stops along the corridor by adding shelters, real-time arrival screens, ADA walkways and trash cans.

Southfield Road is a major collector with a daily traffic volume of more than 70,000 vehicles. It serves as an access point for I-696 and the "main street" for Lathrup Village. The corridor is culturally diverse and provides access to a variety of commercial and retail buildings, recreational facilities and a variety of

housing ranging from apartment complexes to single-family homes. The project corridor provides access to adjoining historically disadvantaged communities and areas of persistent poverty.

Southfield Road is one of SMART's most-delayed bus routes, this SMART 420 bus serves 42 bus stops though the City of Southfield to the City of Royal Oak. Although the 420 bus provides key access for healthcare workers and a transit dependent community, congestion in the area has created air quality and travel time reliability issues. SMART bus stop facilities are also in need of upgrades to provide passengers with amenities that provide comfort and accessibility. In addition to serving as the main business corridor for Lathrup Village, this section of Southfield Road is also a main north/south corridor for the region. Southfield Road's condition and level of service must be improved to meet the demand of the region.

I respectfully request the USDOT give full and fair consideration to RCOC's partnership application.

Best Regards,

Fred Prime
DDA Chair

DRAFT



27400 Southfield Rd
Lathrup Village, MI 48076
(248) 557 - 2600
www.lathrupvillage.org

To: DDA Board of Directors

From: Susie Stec, Director – Community & Economic Development /DDA Director

Date: February 14, 2024

RE: FY24/25 DDA Budget – draft v1

The city has adopted a budget calendar which anticipates an approved FY 24/25 Budget in May. In order to meet the city's milestones, a draft budget has been prepared for the DDA Board of Directors to provide comments and feedback. A final budget for the DDA Board of Directors to consider and approve is expected in March/April. The adopted document will then be forwarded to City Council for inclusion in the city's overall budget approval process.

The draft FY 24/25 DDA Budget follows the approved budget from the last two (2) years. The DDA continues to dip into its fund balance for the implementation of significant infrastructure projects. It is worth noting that now that there is greater funding and timeline certainty regarding the HAWK signal installation and Municipal Park Renovations, it is likely these projects will straddle the current and upcoming fiscal year with the greatest portion of expenditures in FY 24/25. As a result, the board should anticipate budget amendments in June 2024.

FY 24/25 DDA Budget Draft (v1)

Item 7E.

REVENUES	ADOPTED 22/23	AMENDED 22/23	ACTUAL 22/23	ADOPTED 23/24	BUDGETED 24/25	INCREASE (DECREASE)
TIFA-CAPTURE TAXES	311,100	400,197	396,236	367,901	410,000	42,099
TAX COLLECTED OTHER	36,676	37,187	37,187	37,488	37,488	-
MISC. REVENUES	6,000	22,364	22,364	21,974	22,000	26
INVESTMENT INTEREST	10,000	29,648	39,300	10,000	20,000	10,000
FEDERAL/STATE GRANTS	-	-	-	-	-	-
Total Revenues	363,776	489,396	495,087	437,364	489,488	52,125

EXPENDITURES	ADOPTED 22/23	AMENDED 22/23	ACTUAL 22/23	ADOPTED 23/34	BUDGETED 24/25	INCREASE (DECREASE)
SALARIES & WAGES	157,595	165,327	162,929	170,940	174,358	3,418
PART TIME SEASONAL CREW	5,000	-	-	5,000	-	(5,000)
EMPLOYEE TAXES & BENEFITS	34,000	58,846	57,701	34,000	34,000	-
LEGAL SERVICES	900	-	-	900	900	-
OFFICE SUPPLIES	3,360	2,000	507	6,350	3,755	(2,595)
TAX TRIBUNAL RETURNS	2,000	2,000	-	2,000	2,000	-
AUDITING & ACCOUNTING	800	800	800	800	800	-
TRAINING/MEMBERSHIP	8,175	9,390	8,575	10,050	8,075	(1,975)
MAIN STREET PROGRAM	22,200	5,000	5,524	22,500	21,500	(1,000)
STREETSCAPING	33,300	12,000	9,047	132,000	117,000	(15,000)
PLANNING/CONSULTING FEES	15,300	15,497	15,497	15,300	15,300	-
PRINTING/PUBLICATION COSTS	2,000	2,000	972	2,000	2,000	-
POSTAGE FEES	200	-	-	200	200	-
REPAIRS & MAINTENANCE	505,624	260,000	335,203	417,293	485,000	67,707
MISCELLANEOUS EXPENDITURES	8,457	2,000	1,007	53,457	8,457	(45,000)
DEPRECIATION INFRASTRUCTURE	-	-	29,714	30,000	30,000	-
SIGN GRANT PROGRAM	10,000	-	-	10,000	10,000	-
FAÇADE GRANT PROGRAM	20,000	-	-	20,000	20,000	-
TOTAL EXPENDITURES	828,911	534,860	627,474	932,790	933,345	555

EXPENDITURES	AMENDED 1/21/2023	BUDGETED 24/25
SALARIES & WAGES	157,595	174,358
DDA Director		83,232
DDA & Special Projects Mgr		46,079
City Administrator & Treasurer		20,400
Code Enforcement		24,647
PART TIME SEASONAL CREW	5,000	-
EMPLOYEE TAXES & BENEFITS	34,000	34,000
LEGAL SERVICES	900	900
OFFICE SUPPLIES	3,360	3,755
Adobe Subscription (SS & BD)		360
DDA Website		375
Technology/Software		
Computers		2,000
Cell Phone		720
Office supplies		300
TAX TRIBUNAL RETURNS	2,000	2,000
AUDITING & ACCOUNTING	800	800
TRAINING/MEMBERSHIP	8,175	8,075
MAP		-
Michigan Downtown Association Membership		250
National Main Street Center Membership		375
National Main Street Conference		2,500
IEDC Trainings		700
MEDA Membership		250
MAP Annual Conference		2,000
misc. trainings		2,000
MAIN STREET PROGRAM	22,200	21,500
Corrdior Cleanup		500
Artisan Market		
Juneteenth		3,000
Branding/Swag		2,000
LVMF		10,000
Tri-City Partnership/Business Mini-Grant		6,000
STREETSCAPING	33,300	117,000
Plants Materials		5,000
Banners		2,000
Holiday Decorations		10,000
Trash Receptacles		
Municipal Park Play Structure Match		100,000
DTE Tree Planting Grant Match		-
PLANNING/CONSULTING FEES	15,497	15,300
PRINTING/PUBLICATION COSTS	2,000	2,000
POSTAGE FEES	200	200

REPAIRS & MAINTENANCE	505,624	485,000
Alleys & Approaches		345,000
Excell (696 Mowing & Snow)		5,000
Landscape Maintenance		25,000
HAWK Pedestrian Signals		100,000
Electric Vehicle Chargers		
Streetlight/DTE		10,000
MISCELLANEOUS EXPENDITURES	8,457	8,457
Meadowbrook Liability Insurance		4,657
misc. expense		500
LTVV -DDA mtg		3,300
DEPRECIATION INFRASTRUCTURE	-	30,000
CAPITAL EXPENDITURE	-	-
SIGN GRANT PROGRAM	10,000	10,000
FAÇADE GRANT PROGRAM	20,000	20,000
TOTAL EXPENDITURES	829,108	933,345



27400 Southfield Rd
 Lathrup Village, MI 48076
 (248) 557 - 2600
 www.lathrupvillage.org

MEMORANDUM

To: LVDDA Board of Directors
 From: Susie Stec, CED/DDA Director
 Date: February 13, 2024
 RE: Department/Director Report

In an effort to provide consistent updates to the DDA Board of Directors, City Administrator, and City Council the following monthly is submitted for your review.

Upcoming DDA Events

- Time Management & Mastery Workshop, February 22nd, 8:30 am – 10:30 am
 * Tri-City Partnership

Commercial Business/Property Updates

- 28901 Southfield Rd (Papa's Pizza & BBQ) – OPEN. Business is seeking signage variance. Working with DDA to setup a ribbon cutting.
- 27300 Southfield Road – Revised plans submitted in January; site plans to be considered at the February PC meeting.
- 27411 Southfield Road (Jay Birds Bar & Grill) – New restaurant seeking to locate in former Salvatore Scallopini space. They are seeking Special Land Use approval to allow for alcohol sales; a public hearing will be held at the February PC meeting with a final decision made by City Council at their upcoming meeting.
- 27777 Southfield Road (Panera Bread) – OPEN. They will be seeking an amendment to the PUD Agreement to allow for the installation of a monument sign.
- 27601 Southfield Road (Surnow LV Center) – Obtained site plan approval by Planning Commission on Sept. 19th. No estimated construction start date yet.

Infrastructure

- Resurfacing of Southfield Road is anticipated to begin mid-April/early-May to July. Staff is working with RCOC to arrange another public meeting with the businesses.
- Alley & approach work is planned from April to mid-June.



27400 Southfield Rd
Lathrup Village, MI 48076
(248) 557 - 2600
www.lathrupvillage.org

Miscellaneous

- Staff is working to develop a standalone website and setup meetings with Board & Committee members to obtain feedback prior to launching. It will be linked to the city's website to ensure users can locate all information.
- Planning Commission is beginning to explore ways to mitigate parking challenges throughout the district. They have expressed an interest in working more closely with the DDA.
- DDA is continuing to collaborate with Oak Park, Southfield, and Southfield Area Chamber of Commerce, and MSOC (Tri-City Partnership) for free/low-cost business workshops. We will be looking for sponsors to defray costs. Planning is underway for 2024 workshops which are intended to include in-person and virtual learning opportunities, as well as networking opportunities.
- DTE Tree Grant has been reissued for planting work in the DDA district. The Beautification Committee has been working over several months to finalize species. Revised quotes are in process.
- MSOC was informed our RAP2.0 grant proposal was not selected for funding. MSOC has secured funding through the OC Board of Commissioners; however, there is still a funding gap to be addressed. A grant application for \$50K was submitted for the GM Match on Main; grant awards will be announced in early 2024. LVDDA staff will continue to explore additional funding streams for the Municipal Park Renovation, as well as refine the project scope as needed.

BERKLEY
 BIRMINGHAM
 AUBURN HILLS
 CLARKSTON
 CLAWSON
 FARMINGTON
 FERNDALE
 FRANKLIN
 GROVELAND
 HAZEL PARK
 HIGHLAND
 HOLLY
 HOLLY TOWNSHIP
 HURON CORRIDOR-PONTIAC
 LAKE ORION
 LATHRUP VILLAGE
 LEONARD
 LYON TOWNSHIP
 MADISON HEIGHTS
 OAK PARK
 ORTONVILLE
 OXFORD
 PONTIAC
 ROCHESTER
 ROYAL OAK
 SOUTH LYON
 WIXOM

Main Street Oakland County BREAKFAST =SUMMIT=

By Invitation Only | In Person

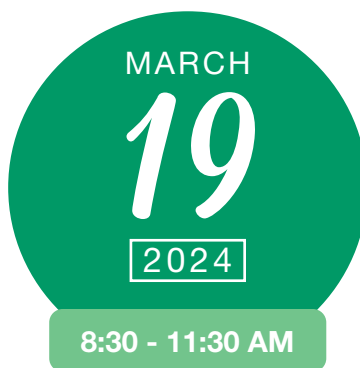

OAKLAND COUNTY
 EXECUTIVE OFFICE BUILDING
Conference Center
 2100 Pontiac Lake Road
 Waterford, MI 48328

RSVP BY MARCH 15 AT
[Advantageoakland.EventBrite.com](https://www.advantageoakland.EventBrite.com)

This year's summit will focus on the role of local leadership and its place in the success of any downtown development effort. Collaboration and communication are key. Your feedback continues to guide and direct the priorities and planning for one of Oakland County's most successful economic development programs for the short and long term. Please come prepared to share your experiences, expectations and ideas that will position your downtowns or historic neighborhood corridors for success. We want to hear from you.

Questions? Contact: John Bry, Administrator, Main Street Oakland County Coordinating Program
bryj@oakgov.com | (248) 858-5444





SUMMIT 2024

Preliminary Agenda

- 8:30 AM** Registration Check-In & Continental Breakfast
- 9:00** Welcome
Oakland County Executive David Coulter
- 9:15** Introductions and Summit Goals
*Moderator: John Bry, Administrator,
Main Street Oakland County Coordinating Program*
- 9:25** Share Community Successes from 2023
—Utilizing the Four Points of Main Street
Organization | Promotion | Design | Economic Vitality
MSOC Directors and Local Leadership
- 10:00** Outline Current Challenges and
What is Needed to Be Successful
o For your district
o For your organization
MSOC Directors and Local Leadership
- 10:30** Stand and Stretch...But Please Don't Leave
- 10:40** Determine 2024-2025 Top Goals for
Main Street Oakland County to Address
MSOC Directors and Local Leadership
- 11:00** Describe What Your District/Organization Needs
from County Leadership to be Successful
MSOC Directors and Local and County Leadership
- 11:20** Closing Thoughts
All Attendees
- 11:30 AM** Adjourn

Main Street America Four-Point Approach for Economic Development OVERVIEW

ORGANIZATION

Community in agreement and working toward common mission, vision and goals—with the resources to do it

PROMOTION

Marketing the district's unique characteristics and assets—to attract and retain residents, businesses, and visitors

DESIGN

Developing and maintaining the physical shape of district—while preserving local character and creating a welcoming and attractive environment

ECONOMIC VITALITY

Supporting local business development, including attracting, strengthening and retaining the right mix of businesses and housing in the district—diversifying the economic base





Awards CATALOG

Recognizing Excellence in Oakland County Downtown Development

**Make Plans Today to Attend
The Main Event Awards Ceremony
June 6, 2024**



**Online Awards Submittal Form:
[Forms.oakgov.com/129](https://forms.oakgov.com/129)**

Deadline: 5 p.m. on April 26, 2024

OAKLAND
COUNTY MICHIGAN
ECONOMIC DEVELOPMENT
DAVID COULTER
OAKLAND COUNTY EXECUTIVE

TABLE OF CONTENTS

Award Descriptions, Eligibility & Judging Criteria

I. Introduction

- The Awards: Recognizing and Leveraging Successes 01
- Submissions 01
- Deadline 01
- No Extensions 02
- Award Judging 02
- Helpful Tips 02

II. Awards: Open to All MSOC Communities

- Spirit of Main Street (Organization) 04
- Achievement in Historic Preservation (Design) 05
- Business Innovation & Entrepreneurship (Economic Vitality) 06
- Community Engagement or Event of the Year (Organization) 07
- Downtown Beautification (Design) 08
- Small Business Retention and Attraction (Economic Vitality) 09
- Volunteer of the Year (Organization) 10
- Mobility on Main Street (Design and/or Promotion) 11
- Main Street Resilience (Organization) 12
- Outstanding Partnership (Organization) 13
- Main Street Leader (Organization) 14

Select Level

- Berkley
- Birmingham
- Clawson
- Farmington
- Ferndale
- Franklin
- Highland
- Holly
- Lake Orion
- Ortonville
- Oxford
- Pontiac
- Rochester
- Royal Oak

Partner (Associate) Level

- Clarkston
- Lathrup Village
- Wixom
- Auburn Hills
- South Lyon

Allied (Affiliate) Level

- Groveland Township
- Hazel Park
- Huron Corridor/Pontiac
- Holly Township
- Leonard
- Lyon Township
- Madison Heights
- Oak Park



INTRODUCTION

Main Street Oakland County Awards

The Awards

Each community has had impactful people, projects and/or events that have shaped their downtown and given it renewed direction over the last year. Whether it be the individual who continues to lead the charge using the Main Street model as the focus of keeping downtown businesses open; the saving of a historic building that the community rallied behind; an event that grew from 10 attendees to 1,000; or a development that improved the long-term economic outlook of the downtown. Each award in this catalog represents the Four Main Street pillars: Design, Economic Vitality, Promotion, and/or Organization.

Winning a MSOC award brings prestige to your downtown and allows your community to take a bow highlighting the value of the work being done. In every category, winners will receive a custom-made plaque with a handcrafted tile from Pewabic Pottery, plus recognition in Oakland County's post award press release and social media.

- Winning could also mean additional dollars for your budget with the Spirit of Main Street Award sponsored by Genisys Credit Union.
- Each award description and eligibility requirements are detailed on the following pages. MSOC may award more than one winner for each category if it is deemed appropriate by the judging committees.
- MSOC designated districts may apply for only one award per category, for a total of 11 possible awards.

Submissions

All submissions will be made to MSOC via an online awards submittal form available at MainStreetOaklandCounty.com

Please enter one nomination per form. Enter community name, nomination name, etc. using this form. Select the award category from the pulldown menu. Nominations for additional categories can be submitted using the same online form/link.

Deadline

All award nominations must be received by Oakland County's Department of Economic Development by 5 p.m., April 26, 2024. If you have any questions regarding the submission process, you may contact John Bry at (248) 858-5444 or by email at bryj@oakgov.com

INTRODUCTION *(cont.)*

Extensions

There are no extensions to the deadline — no exceptions. Late entries will not be accepted, so please start early.

Award Judging

Award judges are professionals and experts in the field but may be from across the state or even out of state. Therefore, it is important to assume the judges are not familiar with your community and/or project so please be thorough and detailed with your submittals.

Helpful Tips

- Do not assume that the judges know your community or project.
- When reviewing the specific award criteria, think of ways that you can communicate why your nominee qualifies for the award.
- Be specific and provide short descriptions or bullet points highlighting the impact the individual or project has had on your Main Street program or community.
- Pictures are worth a thousand words; so, include high-quality photos where available to offer insight on the impact of your nomination/nominee. Good 'before' and 'after' photos are critical for the judges to make better evaluations — especially for physical project submissions such as façades, streetscapes or placemaking.
- Have a third party who is not familiar with the project, program, or individual read and review the content.
- Scan in (vs. using links) press clippings, letters of support, awards or other items that substantiate the reason you have made the specific nomination.

Awards





SPIRIT OF MAIN STREET

A Video Essay sponsored by Genisys Credit Union

Every MSOC community is eligible to enter and compete to win \$2,000 for its local program. Your video must be between 2-3 minutes in length, as one complete edited video. The video will be judged on content and production quality. Videos should be enthusiastic, energetic, and tell your story. The video needs to impart the spirit of your program and district.

Rules & Eligibility

- Video must be between 2-3 minutes in length, as a final edited version.
- Video must be new.
- Video must not be a contracted, professionally produced product.
- Past submitted videos are not eligible.
- Last year's winner is not eligible.

Judging Criteria

- Running time 2-3 minutes total
- Quality of imagery and audio
- Story line and delivery
- Originality and creativity
- People and/or places highlighted
- Excitement and energy conveyed
- Collaboration in production

The Prize

\$2,000 will be presented to the winner by Genisys Credit Union at The Main Event.

Tips

- Decide what your “Spirit of Main Street” story is.
- Develop a story line. It could be all-encompassing or a single, unique event/challenge/accomplishment that demonstrates your district’s spirit.
- Determine who or what will tell the story; get it on video.
- Include images in the video to demonstrate a particular point.
- Give it a title — it helps the viewer understand what they are seeing.
- Music is always good.

Deadline of intent to participate

5 p.m. | April 26, 2024

Notification of intent to participate to:

John Bry, MSOC Program Coordinator
(248) 858-5444 | bryj@oakgov.com

Deadline for video submission:

May 17, 2024

ACHIEVEMENT IN HISTORIC PRESERVATION

The Main Street model has always been rooted in Historic Preservation. This award recognizes a program or project that spotlights a community’s unique history, preserving its past and/or telling the important story of where the community came from. This could be anything from the physical preservation of a building or space, creating awareness of your historical assets, or developing a program designed to ensure your past is preserved for future generations.

Examples: Building renovation/preservation, historical markers, history tours, or establishing a historic district.

Rules & Eligibility

- The nomination is a program or project that was completed in the last year, uses the unique aspects of the community’s history, and reflects the uniqueness of your community.
- The nomination can be for either a public or private entity or effort.

Deadline
5 p.m. | April 26, 2024

Need Help? Contact:
John Bry, MSOC Program Coordinator
(248) 858-5444 | bryj@oakgov.com

Judging Criteria

- Nomination’s contribution toward achieving district goals
- Uniqueness and creativity of the program that addresses a pressing historic preservation need or new opportunity for the Main Street
- Positive impact that can be measured

BUSINESS INNOVATION & ENTREPRENEURSHIP

The Main Street approach is one of the leading Economic Development tools for downtowns throughout the U.S. Having strong businesses and business practices are essential to the Economic Vitality of our communities, and what that looks like in each Main Street can vary greatly. This award recognizes original and/or innovative programs or practices leading to the transformation of your local economy. This award is not an apples-to-apples comparison, think specifically about your Main Street program, the downtown, and what has moved the needle in a positive direction for your local economy over the last year.

Examples: Business training programs on topics like merchandizing and online sales, unique partnerships that add to the sense of place or creates opportunities for business growth, and new and innovative business practices that support entrepreneurship and small business development.

Rules & Eligibility

- Nomination can be a public policy or program, a private business or new private and/or public partnership.
- This can be a public initiative or series of initiatives.
- The nomination must support the overall economic vitality of your Main Street.

Deadline
5 p.m. | April 26, 2024

Need Help? Contact:
John Bry, MSOC Program Coordinator
(248) 858-5444 | bryj@oakgov.com

Judging Criteria

- Relevance to the district’s strategies and goals
- Broad-based involvement and support in the development of the project
- Measurable results or impact upon the district

COMMUNITY ENGAGEMENT OR EVENT OF THE YEAR

This award recognizes an outstanding special event or digital, image, or public relations campaign that advanced new opportunities for your downtown. Getting people downtown to shop, eat and drink, have fun, explore, and live is a goal of all Main Street organizations. This award recognizes efforts that made the downtown more accessible or improved the visiting experience for visitors, businesses, and residents.

Examples can be special events, new platforms for shopping or visiting online, promotion through social media, podcasts, or other methods used to reach the public and promote your downtown.

Rules & Eligibility

- Project can be publicly-developed or a combination of private and public partnership.
- Project can be a reoccurring activity or one-time event.

Judging Criteria

- Nomination’s relevance to the district’s strategies and goals
- Broad-based involvement and support in the development of the project
- Collaborative and innovative partnerships
- Measurable outcomes leading to positive change

Deadline
5 p.m. | April 26, 2024

Need Help? Contact:
John Bry, MSOC Program Coordinator
(248) 858-5444 | bryj@oakgov.com

DOWNTOWN BEAUTIFICATION

Placemaking attracts businesses, customers, and residents to our Main Streets. Downtowns that offer exciting and unique things to do and see are more likely to experience greater investment. This award is for a project that has improved the physical appearance of a district through landscaping/streetscaping, public art, improved public spaces, or new private development.

Examples: Streetscape improvements, public art, new gathering spaces, and building rehabilitation or new construction.

Rules & Eligibility

- Project can be publicly- developed, privately- developed, or a combination.
- Project must contribute to the overall quality of the built environment of your downtown.
- Project must be accessible to all the stakeholders of the downtown district.

Judging Criteria

- Nomination’s relevance to the district’s long-term strategy and transformative goals
- Broad-based involvement and support in the development of the project
- Degree the project transformed the activity within the district

Deadline
5 p.m. | April 26, 2024

Need Help? Contact:
John Bry, MSOC Program Coordinator
(248) 858-5444 | bryj@oakgov.com

SMALL BUSINESS RETENTION AND ATTRACTION

Business retention and attraction are at the heart of economic development within the Main Street approach. A strong local economy is built through the character and unique mix of our businesses. This award recognizes the best program or effort that supported existing businesses or attracted new ones to your Main Street.

Examples: Using data and market analysis to create new strategies and/or programs, new permitting processes that made it easier for a business to locate or expand, or financial incentives such as façade and signage grants.

Rules & Eligibility

- Project can be a public or private initiative.
- Project must contribute to strengthening the district's economic vitality.

Judging Criteria

- Nomination's relevance to the district's long-term strategy and transformative goals
- Broad-based involvement and support in the development of the project
- Collaboration and innovation
- Degree the project transformed the economic vitality of the district
- Measurable results or impact upon the district

Deadline
5 p.m. | April 26, 2024

Need Help? Contact:
John Bry, MSOC Program Coordinator
(248) 858-5444 | bryj@oakgov.com

VOLUNTEER OF THE YEAR

The Main Street model is a grass roots, community-driven program. Good board members and volunteers are the life blood of every local program. The volunteers offer time, talent, and treasure to drive the revitalization or management process.

These volunteers serve on boards and committees, lead projects, lend a helping hand when needed and serve as positive community ambassadors for the district and its ongoing success. This award honors that special individual(s) who has invested considerable personal time and energy to enhance the downtown and organization in the last year. This award is for the individual(s) who has so positively influenced the community that their impact will continue to be felt for many years.

Rules & Eligibility

Nominee no longer needs be active with the Program/Downtown.

Judging Criteria

- Nominee’s contribution toward achieving district goals and assisting with activities
- Extent of the nominee’s participation, the quality and amount of the time donated (e.g., time volunteered, money raised, programs initiated, etc.)
- Degree which nominee’s commitment went above and beyond expectations

Deadline
5 p.m. | April 26, 2024

Need Help? Contact:
John Bry, MSOC Program Coordinator
(248) 858-5444 | bryj@oakgov.com

MOBILITY ON MAIN STREET

Accessibility is a key to the success of our main streets. Downtowns are intended for everyone and adding services and amenities that ensure this are always important. This award recognizes projects and/or programs that have incorporated innovative strategies to enhance mobility, accessibility, and transit options in our communities. These projects/programs are sustainable, providing positive environmental impacts, are effective in creating alternative transit opportunities, and improve overall safety in downtowns.

Examples can be complete streets implementations, improved accessibility and connectivity projects, access to public transit, multi-modal infrastructure improvements, or community engagement programs that promote alternative mobility solutions.

Rules & Eligibility

- Project can be publicly-developed or a combination of private and public partnership.
- Project should demonstrate an impact to accessibility in the main street district.
- Project may be a physical improvement, technological improvement, public education or promotional campaign/event.

Deadline
5 p.m. | April 26, 2024

Need Help? Contact:
John Bry, MSOC Program Coordinator
(248) 858-5444 | bryj@oakgov.com

Judging Criteria

- Nomination’s relevance to the district’s strategies and goals
- Collaboration and innovative partnerships
- Measurable outcomes leading to positive change

MAIN STREET RESILIENCE

The Main Street approach has always been flexible, which is especially important when our downtowns face adversity. This award is for the community, Main Street program, or business that has continued to thrive even in tough times. Whether it be the lingering effects of the pandemic, ongoing staffing challenges, or other disasters where the Main Streets and their businesses have shown resilience.

Examples: Business recruitment/retention programs, business support and/or training programs that give businesses needed tools for success, unique partnerships that create vibrancy and interest in our downtowns, and other new and innovative business practices that support entrepreneurship and small business development.

Rules & Eligibility

- Project can be a public policy or program, a private business or new private and/or public partnership.
- This can be a public initiative or series of initiatives.
- The nominee must support the overall economic vitality of your Main Street.

Deadline
5 p.m. | April 26, 2024

Need Help? Contact:
John Bry, MSOC Program Coordinator
(248) 858-5444 | bryj@oakgov.com

Judging Criteria

- Nomination’s relevance to the district’s strategies and goals
- Broad-based involvement and support in the development of the project
- Measurable results or impact upon the district

OUTSTANDING PARTNERSHIP

Partnerships are vital to the Main Street approach and should be an everyday occurrence in a successful program. This award acknowledges a particularly successful partnership that created a positive impact on your downtown. Whether it be public-public, public-private, or private-private this partnership accomplished something that could not have been done alone.

Examples: Public spaces on private property, city/county/state programs, business to business support and/or events, or joint marketing.

Rules & Eligibility

- Project can be a public policy or program, a private business or new private and/or public partnership.
- This can be a public or private initiative or series of initiatives.
- The nominee must support the overall economic vitality of your Main Street.

Deadline
5 p.m. | April 26, 2024

Need Help? Contact:
John Bry, MSOC Program Coordinator
(248) 858-5444 | bryj@oakgov.com

Judging Criteria

- Nomination’s relevance to the district’s strategies and goals
- Broad-based involvement and support in the development of the project
- Measurable results or impact upon the district

MAIN STREET LEADER

While the Main Street model is volunteer-driven, great staff are equally important. The employees of the Main Street program are the daily faces of the downtown—visiting businesses, offering support, and implementing the program’s vision. Whether it be the Executive Director, the program coordinator, or the part-time assistant, the great work being done daily relies on these people. This award acknowledges the hard work and dedication of the Main Street staff, being there when needed and always remaining positive.

Rules & Eligibility

Nominee no longer needs to be employed by the Program/Downtown.

Judging Criteria

- Nominee’s contribution toward achieving district goals and assisting with activities
- Extent of the nominee’s participation and quality of work done
- Degree which nominee’s commitment went above and beyond expectations

Deadline
5 p.m. | April 26, 2024

Need Help? Contact:
John Bry, MSOC Program Coordinator
(248) 858-5444 | bryj@oakgov.com



Thank You

FOR ALL YOU DO!

If you have any questions regarding the award submissions, contact John Bry:
(248) 858-5444 | bryj@oakgov.com

Online Awards Submittal Form, visit:
Forms.oakgov.com/129