



Third Public Workshop

Park Avenue Lane Reduction (Road Diet) Project

Saturday May 6, 2023, 9:00 AM – 12:00 PM

Commission Chamber, Town Hall, 535 Park Avenue, Lake Park, FL 33403

Roger Michaud	—	Mayor
Kimberly Glas-Castro	—	Vice-Mayor
John Linden	—	Commissioner
Mary Beth Taylor	—	Commissioner
Judith Thomas	—	Commissioner
John D’Agostino	—	Town Manager
Thomas J. Baird, Esq.	—	Town Attorney
Vivian Mendez, MMC	—	Town Clerk

PLEASE TAKE NOTICE AND BE ADVISED, that if any interested person desires to appeal any decision of the Town Commission, with respect to any matter considered at this meeting, such interested person will need a record of the proceedings, and for such purpose, may need to ensure that a verbatim record of the proceedings is made, which record includes the testimony and evidence upon which the appeal is to be based. Persons with disabilities requiring accommodations in order to participate in the meeting should contact the Town Clerk’s office by calling 881-3311 at least 48 hours in advance to request accommodations.

CALL TO ORDER/ROLL CALL

PLEDGE OF ALLEGIANCE

SPECIAL PRESENTATION/REPORT:

1. Third Public Workshop Associated with the Park Avenue Lane Reduction (Road Diet) Project.

PUBLIC COMMENT:

This time is provided for addressing items that do not appear on the Agenda. Please complete a comment card and provide it to the Town Clerk so speakers may be announced. Please remember comments are limited to a TOTAL of three minutes.

CONSENT AGENDA:

All matters listed under this item are considered routine and action will be taken by one motion. There will be no separate discussion of these items unless a Commissioner or person so requests, in which event the item will be removed from the general order of business and considered in its normal sequence on the agenda. Any person wishing to speak on an agenda item is asked to complete a public comment card located on either side of the Chambers and given to the Town Clerk. Cards must be submitted before the item is discussed.

BOARD MEMBER NOMINATION:

QUASI-JUDICIAL PUBLIC HEARING (RESOLUTION):

PUBLIC HEARING(S) - ORDINANCE ON FIRST READING:

PUBLIC HEARING(S) - ORDINANCE ON SECOND READING:

OLD BUSINESS:

NEW BUSINESS:

PUBLIC COMMENT:

This time is provided for addressing items that do not appear on the Agenda. Please complete a comment card and provide it to the Town Clerk so speakers may be announced. Please remember comments are limited to a TOTAL of three minutes.

TOWN ATTORNEY, TOWN MANAGER, COMMISSIONER COMMENTS:

REQUEST FOR FUTURE AGENDA ITEMS:

ADJOURNMENT:

FUTURE MEETING DATE: Next Scheduled Regular Commission Meeting will be held on Month, D, 20YY.



Town of Lake Park Town Commission

Agenda Request Form

Meeting Date: May 6, 2023
Originating Department: Public Works
Agenda Title: Third Public Workshop Associated with the Park Avenue Lane Reduction (Road Diet) Project.

Approved by Town Manager: John D'Agostino Digitally signed by John D'Agostino
DN: cn=John D'Agostino, o=Town of Lake Park,
ou=Town Manager,
email=jdagostino@lakeparkflorida.gov, c=US
Date: 2023.05.02 11:01:02 -04'00' **Date:** _____

Cost of Item: N/A **Funding Source:** N/A
Account Number: N/A **Finance Signature:** N/A

Advertised: N/A
Date: N/A **Newspaper:** N/A

Attachments: 1. Agenda Request Form (ARF)
2. Workshop Agenda
3. PowerPoint Presentation

Please initial one:

MA

Yes, I have notified everyone

Not applicable in this case

Background/Summary Explanation:

On May 6, 2023, the Town will host the third of four planned workshops to inform the public and gather input regarding the proposed Park Avenue Lane Reduction (Road Diet) project design, which is being programmed to improve safety, mobility, and aesthetics on Park Avenue, between 6th Street and US Highway 1.

The project area has historically experienced a high rate of traffic accidents and speeding violations. A radar speeding survey of Park Avenue this road by the Palm Beach County Sheriff's Office (PBSO) reported that more than half of all drivers were five miles per hour or more over the speed limit, and this stretch of road was the scene of 26 motor vehicle accidents between

2016 and 2021. Below you will find additional information provided during the workshop.

- During the workshop, staff will present a 60% design project update, including details about the following planned elements: Wide joint use paths, on-street parking, roadside bioswales to improve stormwater management, and protected crosswalks.
- A traffic study conducted by O'Rourke Engineering found that current service level demands for the project area is and will remain for two-lane road well into the future.
- The project area includes eighty feet of right-of-way; currently the four travel lanes utilize only fifty feet of the right-of-way.
- These design elements will reduce the number of travel lanes from four (two in each direction) to two (one in each direction).
- The Town proposes to complete the safety improvements during calendar years 2025 and 2026 or sooner, utilizing budgeted and grant funding.

Recommended Motion: There is no motion associated with this Agenda item. For discussion only.



Third Public Workshop

Park Avenue Lane Reduction (Road Diet) Project

Saturday May 6, 2023, 9:00 AM – 12:00 PM

Commission Chambers, Town Hall

Meeting Agenda

Facilitator: Roberto Travieso, Director of Public Works

WELCOME/OPENING COMMENTS

ROBERTO TRAVIESO

INTRODUCTIONS

PRESENTATIONS

SUSAN O'ROURKE, P.E.
ADAM SWANEY, P.E.
HAYS HENDERSON, PLA

IMPLEMENTATION TIMELINE/NEXT STEPS

JOHN WILLE

Q&A

ROBERTO TRAVIESO

TABLE DISCUSSION

ROBERTO TRAVIESO
SUSAN O'ROURKE, P.E.
ADAM SWANEY, P.E.
HAYS HENDERSON, PLA
JOHN WILLE

CLOSING COMMENTS

JOHN D'AGOSTINO

Third Public Workshop on the Park Avenue Lane Reduction (Road Diet) Project



Public Works Department
Saturday, May 6, 2023



Project Team



- **Members of the Town Commission**
- **John D'Agostino** – Town Manager
- **Roberto Travieso** – Public Works Director
- **Susan O'Rourke, P.E.** – Lead Engineer
- **Adam Swaney, P.E.** – Civil Engineer
- **Hays Henderson, PLA** – Landscape Architect
- **John Wille** – Capital Projects Manager



Public Workshop Agenda



1. Introductions
2. Project Background
3. What is a Road Diet?
4. Public Input on Design Elements
5. Civil Design Plans
6. Public Input on Landscape
7. Landscape Design Plans
8. Project Illustrations
9. Implementation Timeline and Next Steps
10. Q&A
11. Table Discussions
12. Closing Comments



Project Background

SUSAN O'ROURKE, P.E.

Project Area

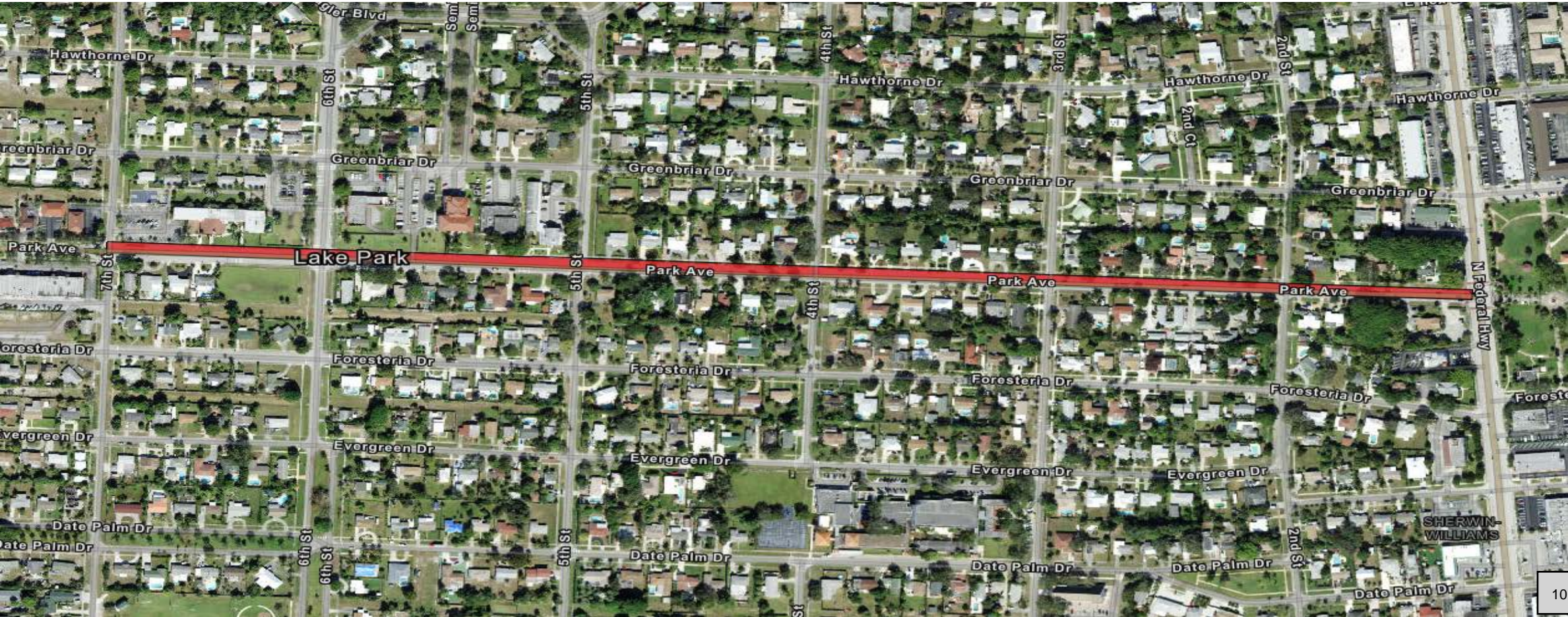



What is a Road Diet?

- Reduction in the travel way
- Enhancement of the Corridor
- Balance of Needs in the Corridor
 - Drainage
 - Beautification
 - Parking
 - Other travel modes





Should Park Avenue be Reduced?

- Park Avenue demand is for two-lane now and in the future
- Speed Limit: 25 MPH, School Zone: 20 MPH
- History of excessive speeds and traffic accidents—requires mitigation



Previous Public Input

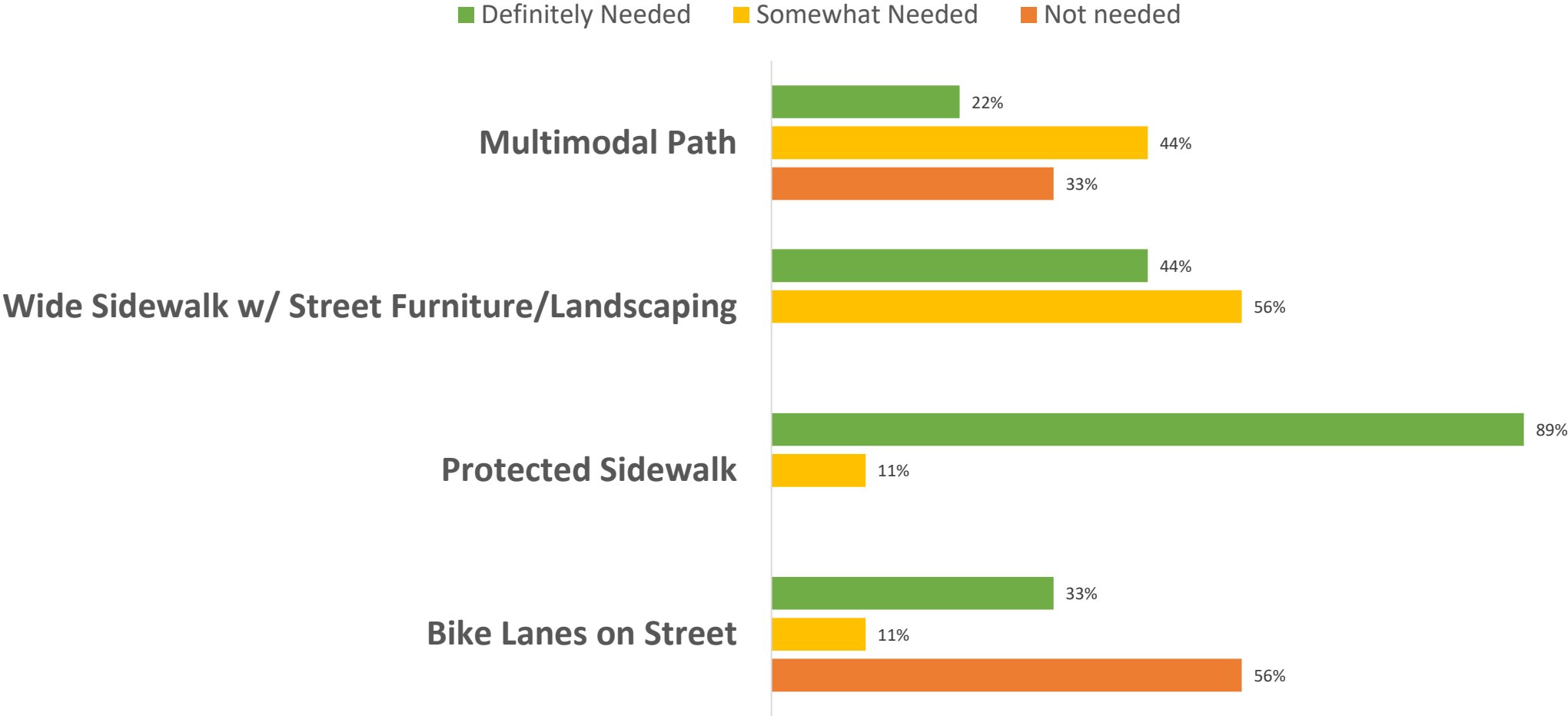

Previous Public Input

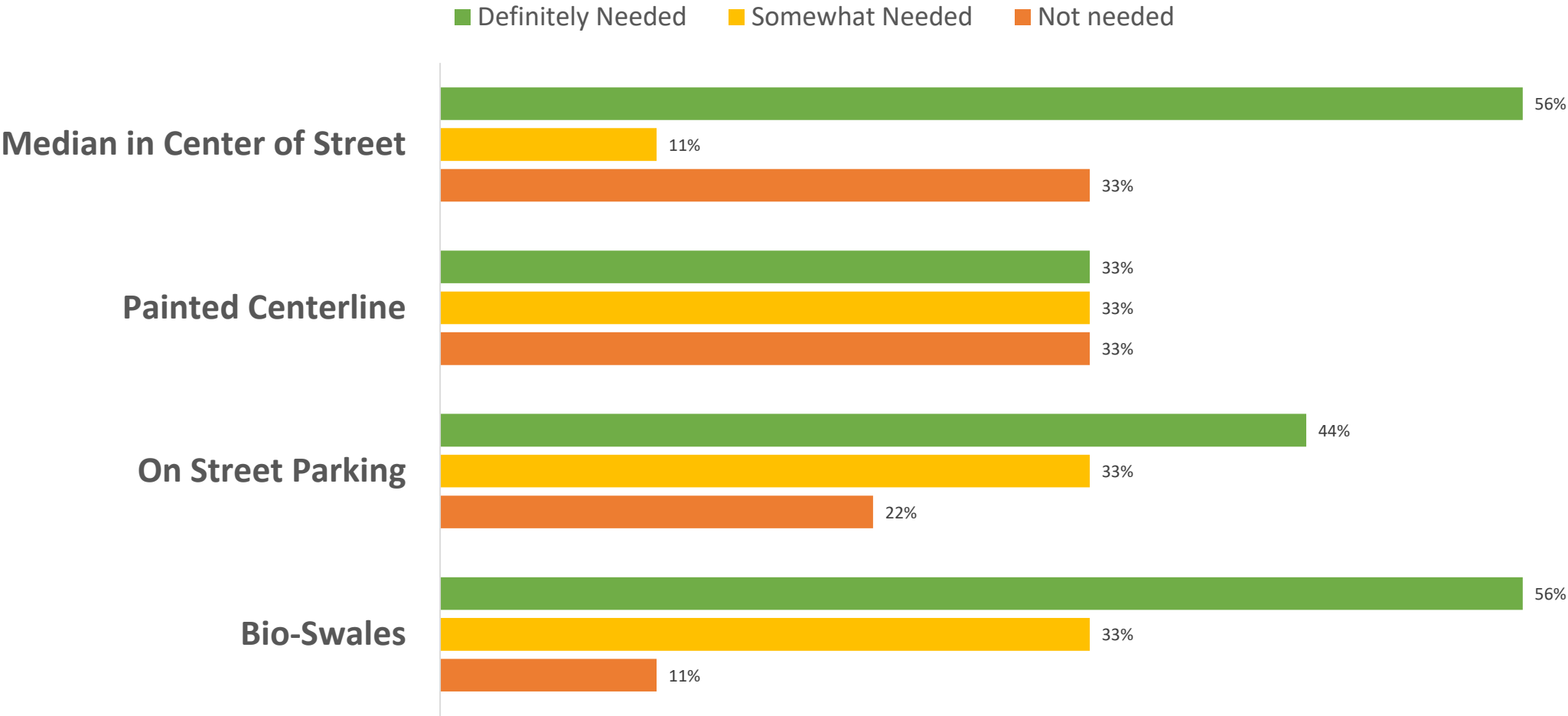



Previous Public Comments

- Consider a phased-in approach to complete project
- Include latest safety and lighting technology; paint new lines
- Do not change the existing lighting
- Add security cameras
- Bike lane should not be between travel lanes and street parking
- Improve school zone markings
- Prefer multi-use path than dedicated bike lanes
- Need protected crosswalks



60% Design Plans (Typical Blocks)

SUSAN O'ROURKE, PE

ADAM SWANEY, PE



GENERAL NOTES:

- ELEVATIONS SHOWN HEREON ARE BASED ON THE NORTH AMERICAN VERTICAL DATUM OF 1988 (NAVD 88) AND ARE REFERENCED TO BENCHMARK "Y 427", ELEVATION=8.45' (NAVD 88).
- TOPOGRAPHIC SURVEY PERFORMED BY ENVIRO GROUP INC. IN AUGUST 4, 2022.
- ALL EXISTING (REMOVE & RECONSTRUCT) MATERIAL TO BE REMOVED FROM THE SITE AND LOCALLY DEPOSED OR.
- ALL CROSSROADS SHALL MEET ADA. NO CROSS SLOPE SHALL EXCEED 2%.
- IF PROPOSED WORK DAMAGE PALM BEACH COUNTY ROADWAY, SIDEWALK AND/OR DRAINAGE SYSTEMS, THEN THEY WILL BE CONSTRUCTED REPAIRED OR REPLACED TO ITS ORIGINAL OR BETTER CONDITION AT NO COST TO THE PALM BEACH COUNTY.
- PAVEMENT MARKINGS AND SIGNS IN PALM BEACH COUNTY NORTH OF RAY, SHALL BE IN ACCORDANCE WITH THE MANUAL OF UNIFORM TRAFFIC CONTROL DEVICES FOR STREETS AND HIGHWAYS AND PALM BEACH COUNTY TYPICAL T-1-21.
- CONTRACTOR SHALL CONTACT PSC TRAFFIC OPERATIONS AT 361-333-3800 FORTY-EIGHT (48) HOURS PRIOR TO CONSTRUCTION IF WORK IS BEING DONE WITHIN 10 FEET OF ANY SIGNAL EQUIPMENT.
- ANY DAMAGE TO SIGNAL EQUIPMENT CAUSED BY THE CONSTRUCTION OF THIS PROJECT MUST BE REPAIRED OR REPLACED TO ORIGINAL OR BETTER CONDITION AT NO COST TO PALM BEACH COUNTY.

ENGINEERING LEGEND:

	PROPOSED 1" MILLING & RESURFACING
	PROPOSED CONCRETE DRIVEWAY
	PROPOSED CONCRETE SIDEWALK
	PROPOSED BIOSWALE
	PROPOSED FULL DEPTH ASPHALT REPLACEMENT
	TRAFFIC FLOW DIRECTION
	DRAINAGE INLET
	DRAINAGE FLOW DIRECTION



LOCATION MAP
N.T.S.

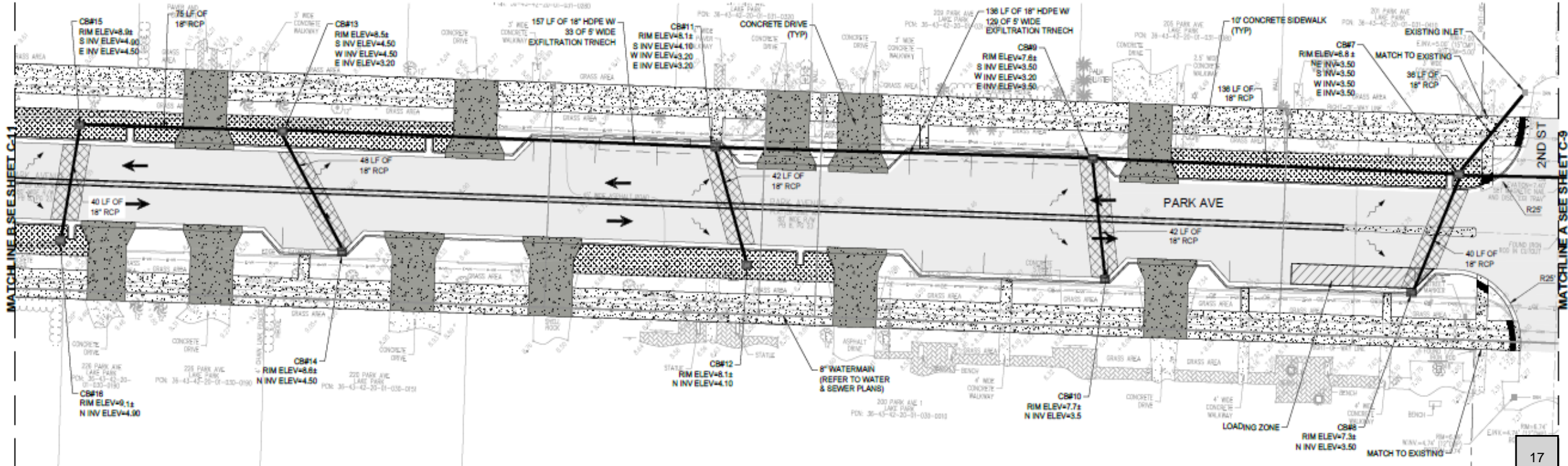
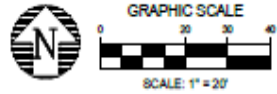



GENERAL NOTES:

- ELEVATIONS SHOWN HEREON ARE BASED ON THE NORTH AMERICAN DATUM OF 1988 (NAVD 88) AND ARE REFERENCED TO BENCHMARK "V 422" ELEVATION=4.45' (NAVD 88).
- TOPOGRAPHIC SURVEY PERFORMED BY CIVILITY GROUP INC. IN AUGUST 4, 2022.
- ALL REMOVED CURBS & EXISTING MATERIAL TO BE REMOVED FROM THE SITE AND LEGALLY DISPOSED OF.
- ALL CROSSINGS SHALL MEET ADA. NO CROSS SLOPE SHALL EXCEED 2%.
- IF PROPOSED WORK DAMAGE PALM BEACH COUNTY ROADWAY, SEWERAGE AND/OR DRAINAGE SYSTEMS, THEY SHALL BE CONSTRUCTED, REPAIRED OR REPLACED TO ITS ORIGINAL OR BETTER CONDITION AT NO COST TO THE PALM BEACH COUNTY.
- PERMITS, MARKINGS AND SIGNS IN PALM BEACH COUNTY RIGHT OF WAY, SHALL BE IN ACCORDANCE WITH THE MANUAL OF UNIFORM TRAFFIC CONTROL DEVICES FOR STREETS AND HIGHWAYS AND PALM BEACH COUNTY TYPICAL T-4-31.
- CONTRACTOR SHALL CONDUCT PRE-THREAT OPERATIONS AT 56-533-3000 FORTY-EIGHT (48) HOURS PRIOR TO CONSTRUCTION IF WORK IS BEING DONE WITHIN 10 FEET OF ANY SIGNAL EQUIPMENT.
- ANY DAMAGE TO SIGNAL EQUIPMENT CAUSED BY THE CONSTRUCTION OF THIS PROJECT MUST BE REPAIRED OR REPLACED TO ORIGINAL OR BETTER CONDITION AT NO COST TO PALM BEACH COUNTY.

ENGINEERING LEGEND:

-
-
-
-
-
-
-
-

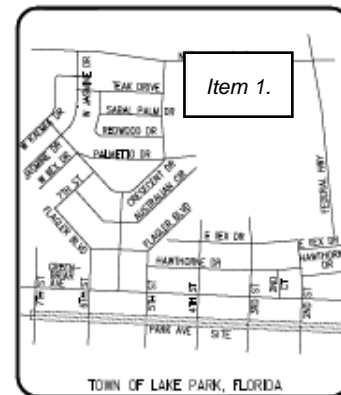

TOWN OF LAKE PARK, FLORIDA

LOCATION MAP
N.T.S.

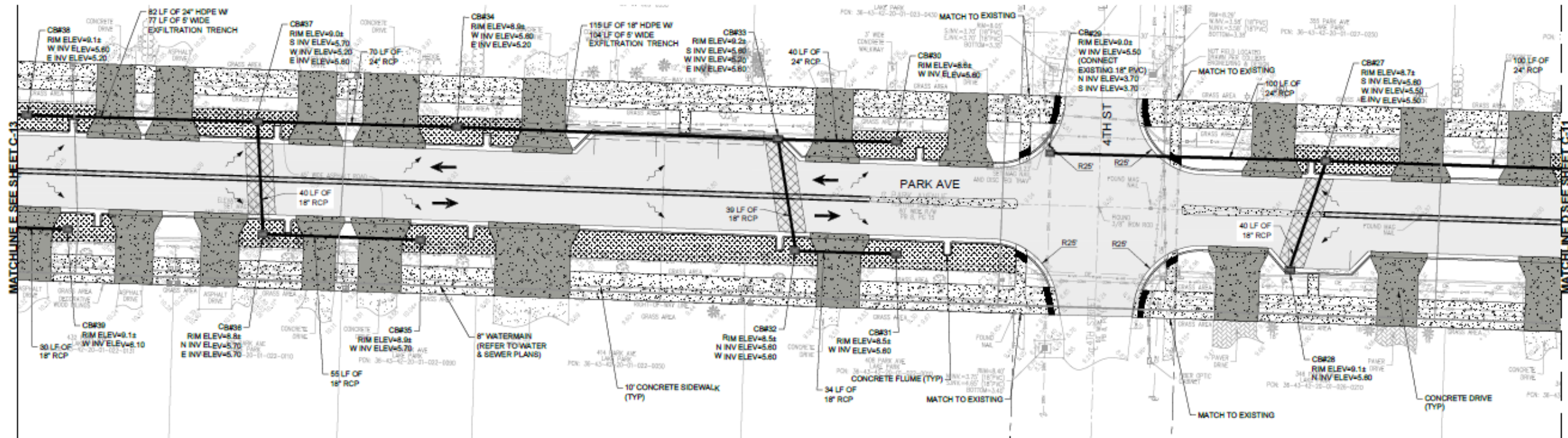
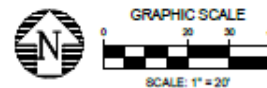



Previous Public Input – Landscape

HAYS HENDERSON, PLA

Previous Public Input – Landscape



CANOPY TREE PREFERENCE

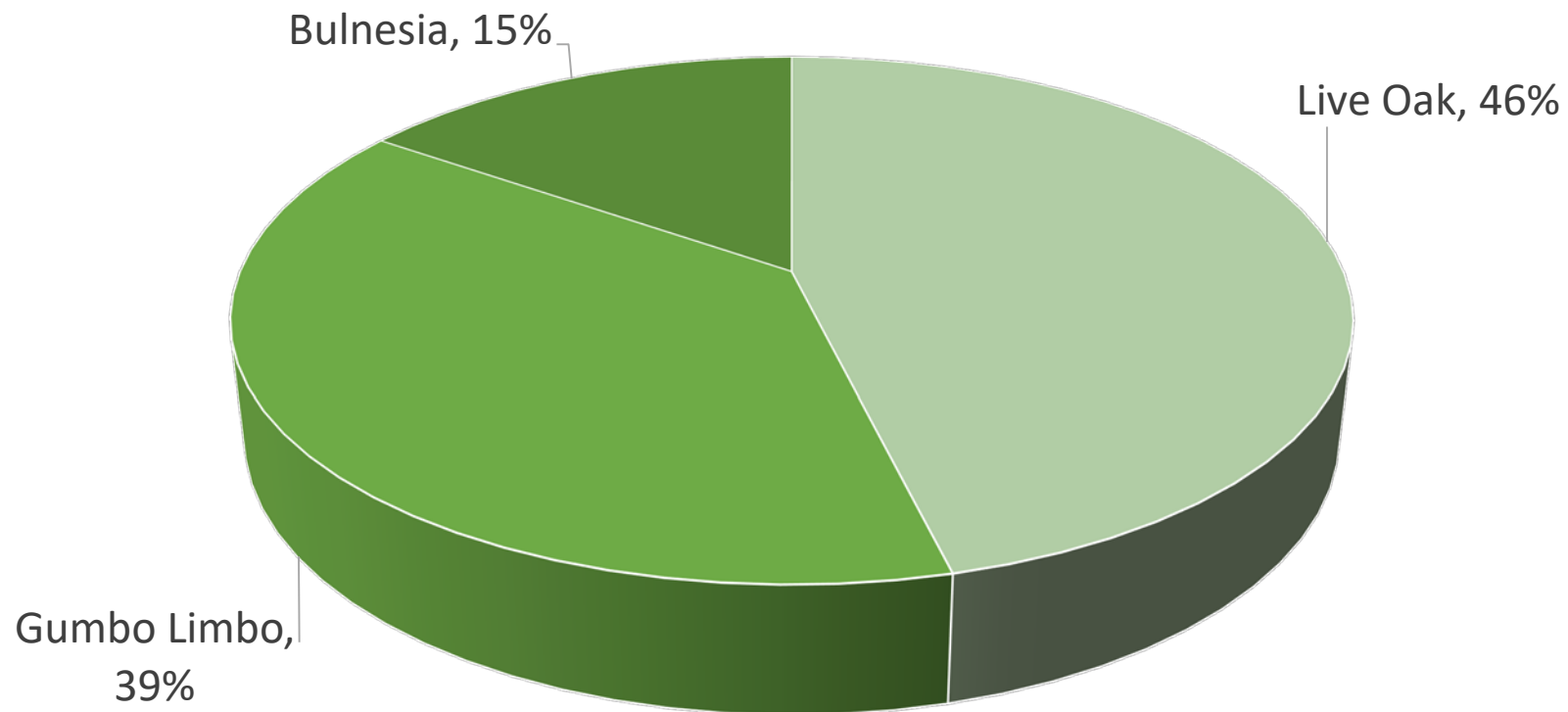

Previous Public Input – Landscape

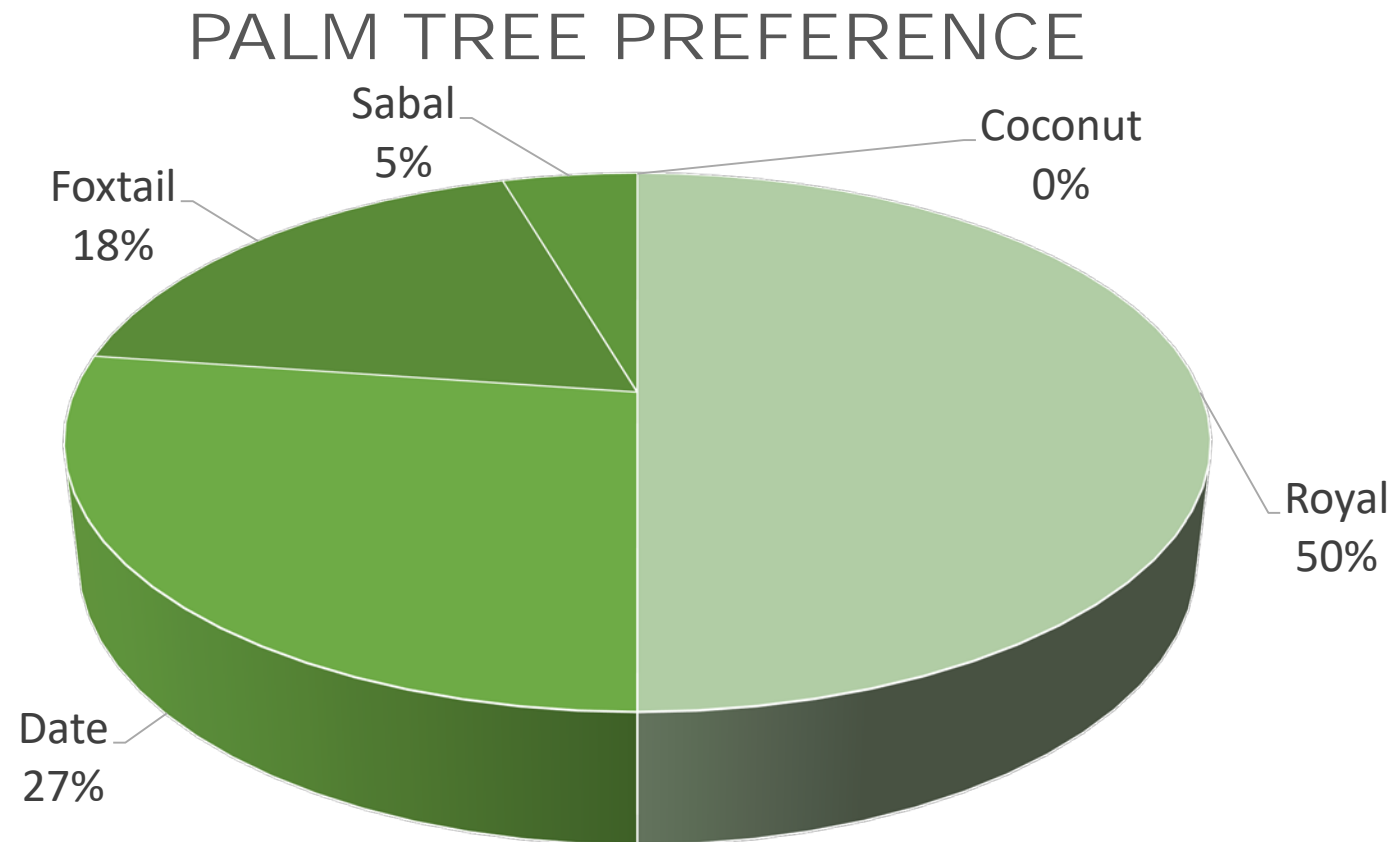



Previous Public Input – Landscape

SMALL TREE PREFERENCE

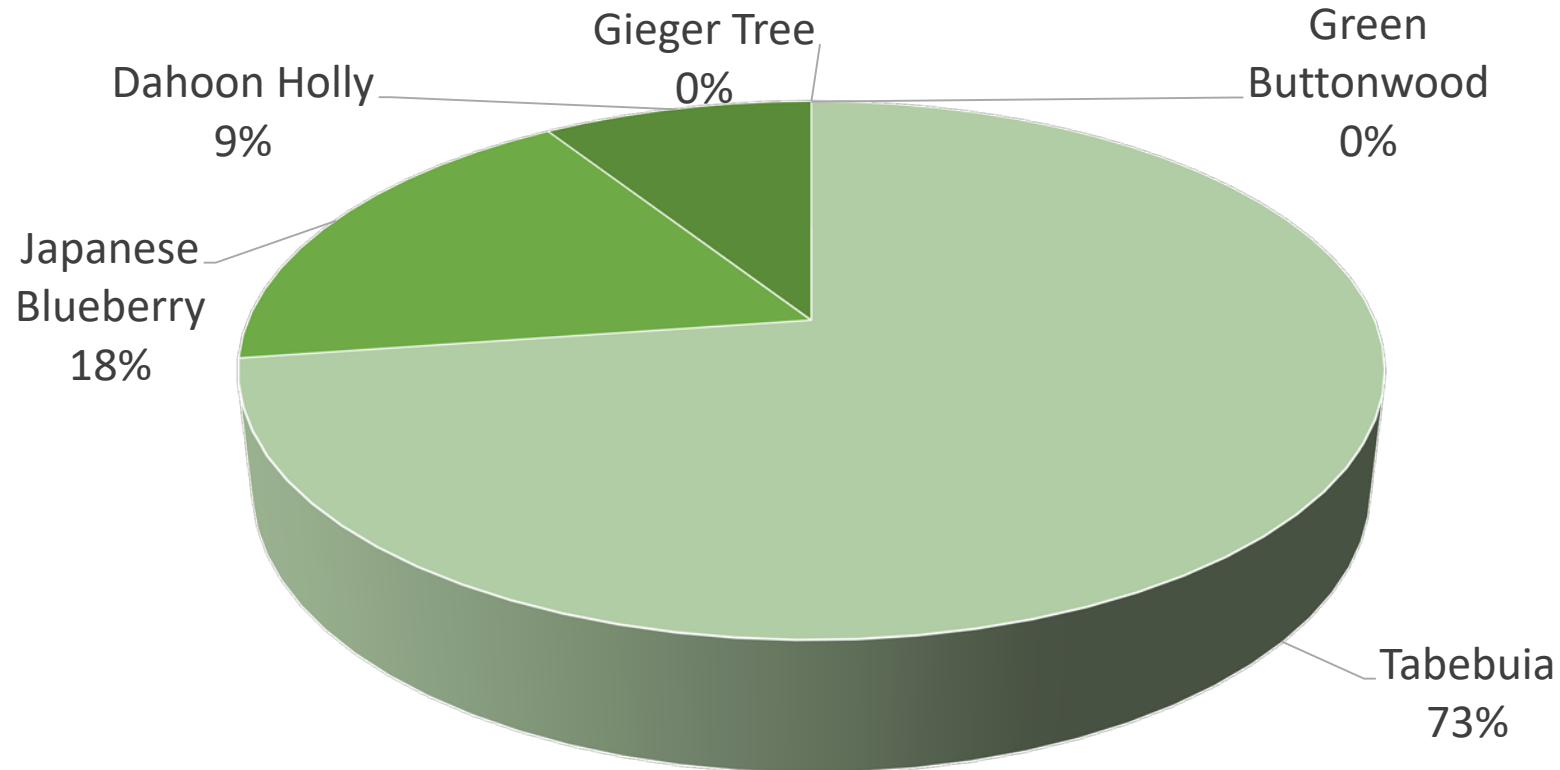



Previous Public Input – Landscape

SHRUBS & GROUND COVER PREFERENCE

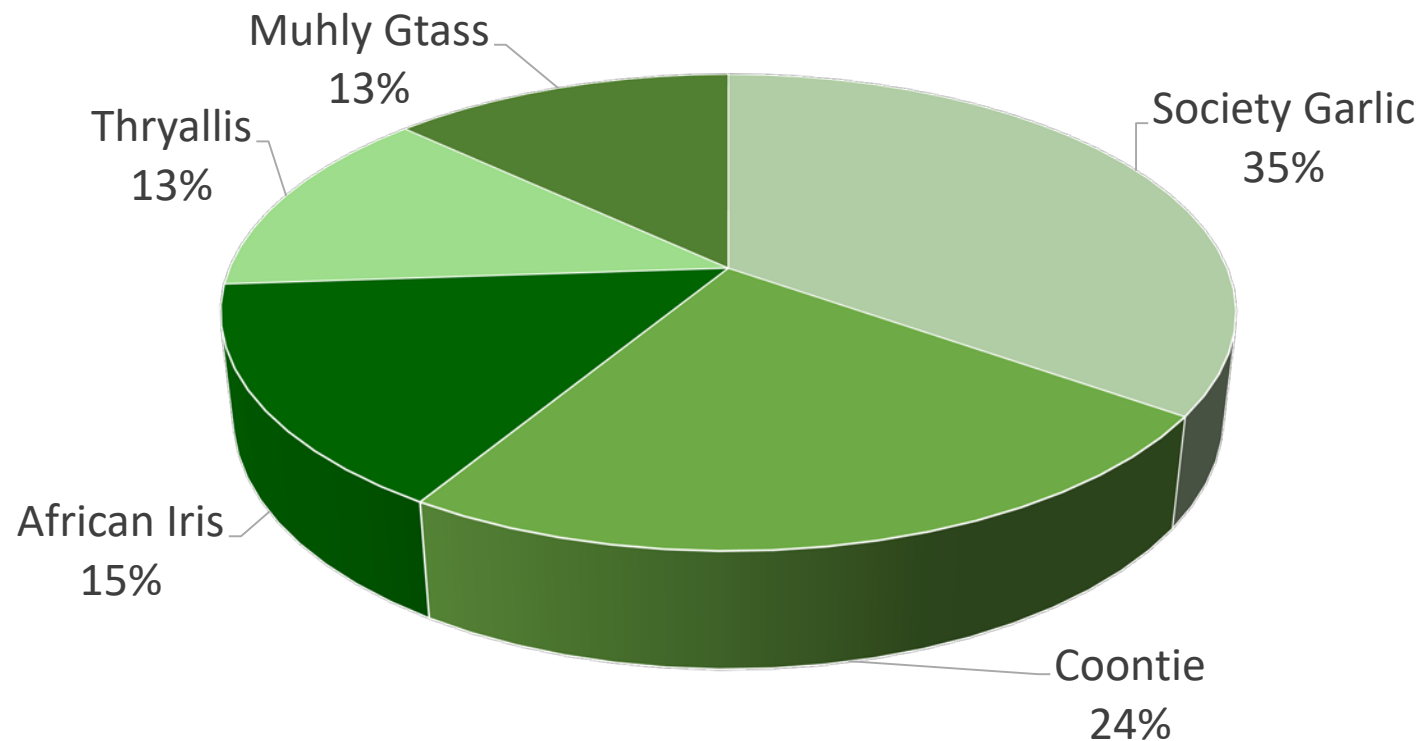

Previous Public Input – Landscape



BIOSWALE PLANTING PREFERENCE

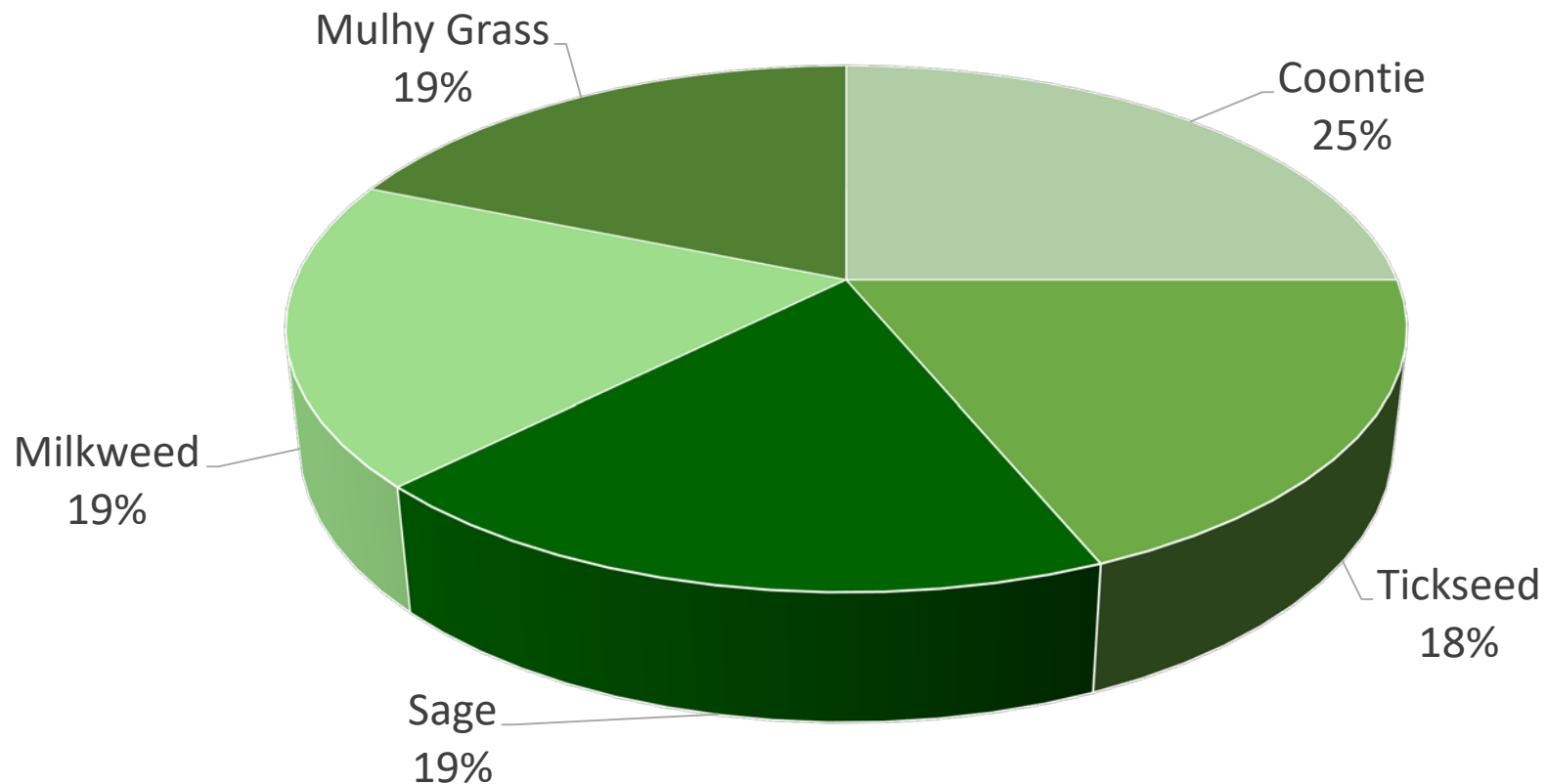



Landscape Design Plans (Typical Blocks)

HAYS HENDERSON, PLA

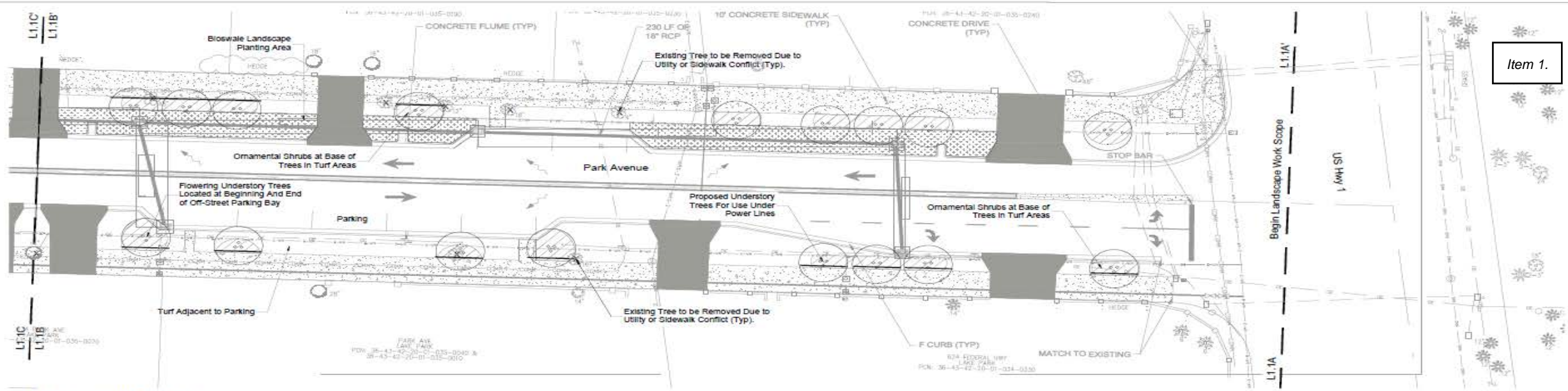

LANDSCAPE SECTION AA'-BB'

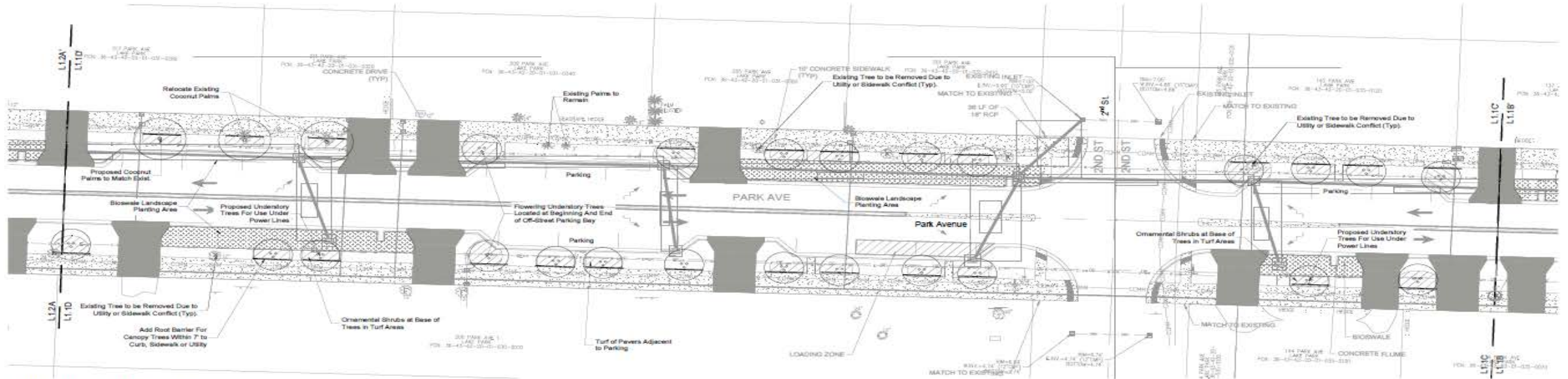

LANDSCAPE SECTION CC'-DD'



PRELIMINARY PLAN

This item has been electronically signed and sealed by Hays P. Henderson on the date and/or time stamp shown using a digital signature. Printed copies of this document are not considered signed and sealed and the signature must be verified on any electronic copies.



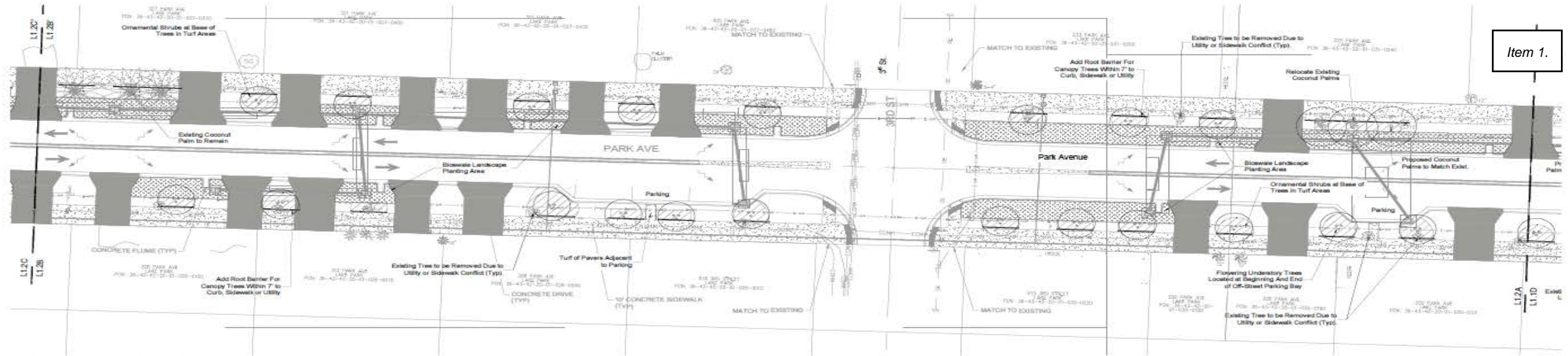

Item 1.



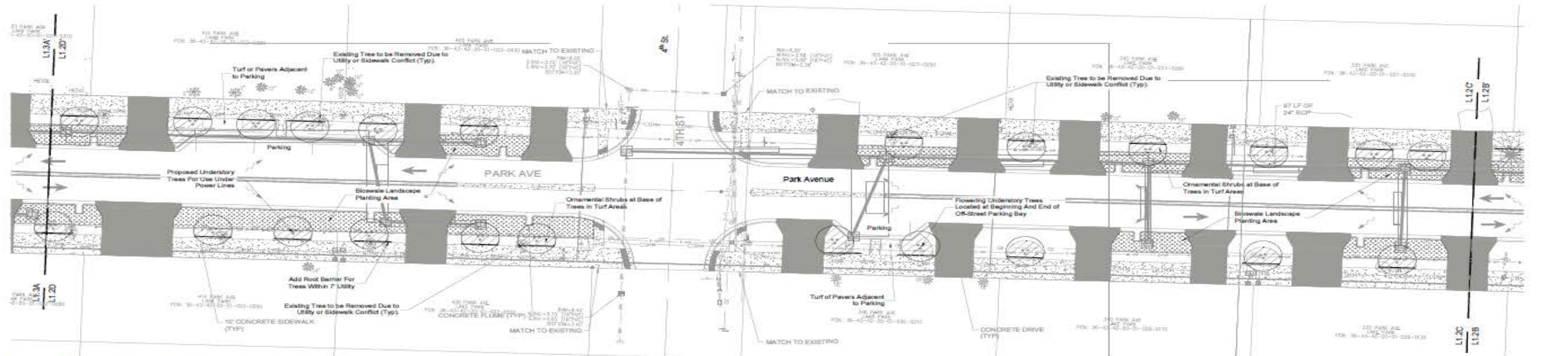

LANDSCAPE SECTION AA'-BB'



LANDSCAPE SECTION CC'-DD'

-  Proposed Canopy Tree or Palm
-  Proposed Understory Tree
-  Proposed Understory Tree

-  Proposed Ornamental Shrub Bed
-  Proposed Bioswale Shrub Bed
-  Proposed Rootbarrier

GRAPHIC LEGEND

PRELIMINARY PLAN

This item has been electronically signed and sealed by Hays P. Henderson on the date and/or time stamp shown using a digital signature. Printed copies of this document are not considered signed and sealed and the signature must be verified on any electronic copies.

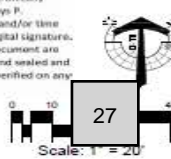

Item 1.



Project Design Illustrations

HAYS HENDERSON, PLA

Park Avenue, between 4th Street and 5th Street (East View)

Item 1.



Park Avenue, between 6th Street and 7th Street (East View)

Item 1.





Implementation Timeline & Next Steps

JOHN WILLE, CAPITAL PROJECTS MANAGER

Implementation Timeline & Next Steps



Project Team will:

- Analyze public input for potential inclusion in project's design
- Develop 90% design plans
- Continue to investigate and leverage grant funding opportunities to support project implementation
- Final Workshop proposed for Spring 2024
- Possible implementation during Calendar Years 2024/2025



Questions & Comments



Table Discussion

DURATION: UP TO 1 HOUR



Table Discussion

1. Discuss available maps/table arrangements
2. Property Owners/Tenants are encouraged to locate their property on the maps and discuss concerns with members of the design team
 - Table 1: Full complete civil plan (driveways, on-street parking, etc.)
 - Table 2: Full Landscape Plan

Connect with Us!



■ New Service Request Portal

- Request Service
- Report Issues



(561) 657-3918



publicworks@lakeparkflorida.gov



SCAN AND
BOOKMARK
ME!

