



# HISTORIC RESOURCES ADVISORY COMMITTEE AGENDA

April 02, 2025 at 5:00 PM

**Downtown Library Large Meeting Room / Zoom Webinar**

<https://juneau.zoom.us/j/82134060200?pwd=bdlfCLd0qND0doRjgeslbs8zsSPLYN.1> or 1-669-900-6833

Webinar ID: 821 3406 0200 Passcode: 572735

**A. CALL TO ORDER**

**B. LAND ACKNOWLEDGEMENT**

We acknowledge the Áak'w Kwaan and T'aakú Kwaan as the original owners and inhabitants of the City & Borough of Juneau. We are grateful to be here in your ancestral homeland as we come to you from areas of Alaska and beyond. We are thankful that you have permitted us to live here and make this land our home. Gunalchées

**C. ROLL CALL**

**D. APPROVAL OF AGENDA**

**E. APPROVAL OF MINUTES**

1. 2025.03.12

**F. PUBLIC PARTICIPATION ON NON-AGENDA ITEMS**

**G. AGENDA TOPICS**

2. Lone Sailor Statue

3. ADOT Review Loop Road Intersection

**H. STAFF REPORTS**

**I. COMMITTEE MEMBER COMMENTS AND QUESTIONS**

**J. NEXT MEETING DATE**

**K. SUPPLEMENTAL MATERIALS**

**L. ADJOURNMENT**

ADA accommodations available upon request: Please contact the Clerk's office 36 hours prior to any meeting so arrangements can be made for closed captioning or sign language interpreter services depending on the meeting format. The Clerk's office telephone number is 586-5278, e-mail: [city.clerk@juneau.gov](mailto:city.clerk@juneau.gov).



(907) 586-0715  
CDD\_Admin@juneau.gov  
www.juneau.org/community-development  
155 Heritage Way • Juneau, AK 99801

**Historic Resources Advisory Committee Agenda**

March 12, 2025 at 5:00pm  
Downtown Library Large Meeting Room  
**MEETING MINUTES**

**A. CALL TO ORDER**

Chair Gillette called the meeting to order at 5:01 PM.

**B. LAND ACKNOWLEDGEMENT**

We acknowledge the Áak'w Kwaan and T'aaku Kwaan as the original owners and inhabitants of the City & Borough of Juneau. We are grateful to be here in your ancestral homeland as we come to you from areas of Alaska and beyond. We are thankful that you have permitted us to live here and make this land our home. Gunalchéesh.

**C. ROLL CALL**

Committee Members Present: Gary Gillette, Dorene Lorenz, Cheryl Jebe, Shannon Crossley, and Steve Winker.

Committee members present via zoom: Robin Brenner

Committee members absent: Jerrick Hope-Lang

Staff present: Scott Ciambor, CDD Planning Manager

Members of the public present: Keith McPencow

**D. APPROVAL OF AGENDA**

Chair Gillette motioned that the agenda be approved after moving item 5. Dotson Landing Cabin before HRAC Ord. to allow member of the public to engage without staying through entire meeting, Ms. Lorenz seconded the motion. Motion approved. 6-0 .

**E. APPROVAL OF MINUTES**

1. January 23, 2025 and February 5, 2025 minutes Vice-Chair Lorenz motioned to be approved with unanimous consent

**F. PUBLIC PARTICIPATION ON NON-AGENDA ITEMS**

None.

**G. AGENDA TOPICS**

**2. New Business:**

1. Committee discussed discovery of one-room cabin on CBJ land by Amalga Harbor by member of the public, Mr. McPencow. The cabin is historic and has been surveyed on the existing plat. Discussed using it as a weekend cabin, signage, light maintenance to maintain longevity of structure. Roof is starting to deteriorate and next few years critical to saving structure. Public member guessed it's about 10'x16' or 8'x12', called the "Little Old Lady Cabin" and may have been on Smith Family property before being transferred to CBJ.



(907) 586-0715  
CDD\_Admin@juneau.gov  
www.juneau.org/community-development  
155 Heritage Way • Juneau, AK 99801

2. Section 106: Alaska Department of Transportation and Public Facilities is conducting a section 106 for a proposed roundabout in the Mendenhall Valley Suburbs. HRAC given opportunity to comment and review work, and committee did not find information in report or the APE boundary we would advise to be addressed.

3. HRAC Ordinance: Chair Gillette discussed the proposed changes to HRAC's charter under Chair Ella Adkison and how the committee is recommending to strike "Cooperating and consulting with the assembly, the historic district commission, the community development department and the state historic commission on matters concerning historical districts and historic, prehistoric and archaeological preservation in the City and Borough;" from the HRAC charter. Members discussed how this is the core of HRAC, and how CBJ Planning Department and the Mayor's Office are not qualified to consult for the Assembly and outside entities on historic preservation matters, and that HRAC has a dedicated group of volunteers that fill that role well. Members also discussed how striking this may effect Juneau's CLG status, potentially eliminating Juneau from qualifying for SOA funding for preservation efforts. (Removing Juneau from the group of Certified Local Governments that work with the State of Alaska on preservation matters.) Secretary Crossley motions for Chair Gillette to write a letter to the assembly to advocate they do not strike HRAC's role to consult and cooperate with the City and Borough Assembly.

#### **H. COMMITTEE MEMBER / LIAISON COMMENTS AND QUESTIONS**

CBJ planning department has assigned Scott Ciambor as our liaison, the department moved Mr. Courtney to long range planning and they are hopefully hiring two more planners in the very near future.

Vice-Chair Lorenz has been appointed the chair of the Alaska State Commission for Human Rights and spoke about a graphic novel and playing cards they have commissioned to highlight stories of Alaskan Civil Rights activism.

#### **I. NEXT MEETING DATE – April 2, 2025**

#### **J. ADJOURNMENT**

Mrs. Brenner motioned that the committee at 6:12 PM adjourn the March 12, 2025, HRAC meeting. Motion approved.

ADA accommodations available upon request: Please contact the Clerk's office 36 hours prior to any meeting so arrangements can be made for closed captioning or sign language interpreter



COMMUNITY DEVELOPMENT

services depending on the meeting format. The Clerk's office telephone number is 586-5278, TDD 586-5351, e-mail: [city.clerk@juneau.org](mailto:city.clerk@juneau.org).

(907) 586-0715  
CDD\_Admin@juneau.gov  
[www.juneau.org/community-development](http://www.juneau.org/community-development)  
155 Heritage Way • Juneau, AK 99801

DRAFT





City and Borough of Juneau  
City & Borough Manager's Office  
155 Heritage Way  
Juneau, Alaska 99801  
Telephone: 586-5240 | Facsimile: 586-5385

---

TO: Chair Hughes-Skandijs  
Public Works and Facilities Committee

DATE: March 6, 2025

FROM: Katie Koester, City Manager

RE: Lone Sailor Statue

The attached memo from Port Director Uchytel forwards a recommendation from the Docks and Harbors Board to endorse installing a "Lone Sailor Statue" along the Seawalk in downtown Juneau. The Pioneers of Alaska are spearheading a fundraising campaign to install this statue as part of the Navy Memorial City Program. The memo recommends placing the statue somewhere along the waterfront between Marine Park and the Taku Dock. However, no final location has been determined.

At this time, the Pioneers of Alaska are requesting CBJ provide a space for the statue. Costs for site preparation and installation will be covered by Pioneers of Alaska. The Pioneers of Alaska need concurrence from the host city to be able to complete their application to the Navy Memorial City Program.

The Public Works and Facilities Committee has a process for public art that involves a recommendation from the committee to the Assembly to accept the art. That recommendation turns into a resolution that outlines the duties and responsibilities of each party and is adopted by the Assembly. The most recent public art acceptance that went through this process was the mural at the Elizabeth Peratrovich Plaza via [Resolution 2961](#).

**Requested Action:** If the Committee supports installing a Lone Sailor statue along the waterfront, I recommend the following motion:

"Move to introduce a Resolution Authorizing the Installation of a Lone Sailor statue along the CBJ waterfront at the time that funding becomes available for a statue and authorize the City Manager to enter into a Memorandum of Agreement with Pioneers of Alaska for Installation and Maintenance of the statue."

Attachments:

1. *Lone Sailor Memorial Docks & Harbors Memo*
2. *Draft Resolution No. 3096*



# Port of Juneau

155 Heritage Way • Juneau, AK 99801  
(907) 586-0292 Phone • (907) 586-0295 Fax

**From:** Carl Uchytel  
Port Director

**To:** Public Works & Facilities Committee

**Thru:** (1) Docks & Harbors Operations-Planning Committee **approved 1/22/245**  
(2) Docks & Harbors Board **Approved 1/30/25**  
(3) City Manager

**Date:** January 22<sup>nd</sup>, 2025

**Re:** LONE SAILOR MEMORIAL

1. At the September 26<sup>th</sup>, 2024 Docks & Harbors Board meeting, members from the Pioneers of Alaska presented a plan to erect a statue of the [Lone Sailor](#) along the Juneau waterfront. The “United States Navy Memorial” oversees the casting of the statue and the authorization of placement. From their website:

*The Lone Sailor statue is the iconic symbol representing the United States Navy Memorial’s mission to Honor, Recognize, and Celebrate the men and women of the Sea Services, past, present, and future; and Inform the public about their service. These meaningful statues provide a reminder to active duty, veterans, and civilians that they serve a grateful nation. The Navy Memorial’s Statue City Program began in 1997 with the placement of a Lone Sailor statue at Recruit Training Command in Great Lakes, IL. There are 19 Lone Sailor Statues around the world, including the original on Navy Memorial Plaza in Washington, DC.*

2. The Pioneers of Alaska have begun the process to acquire the Lone Sailor statue and ask for permission to locate along the downtown Seawalk. The details from the Navy Memorial are outlined below and identification of an appropriate location is paramount to the Pioneers of Alaska to move forward with their civic plans.

**The process for placing a statue begins with a written request to the Navy Memorial identifying location, timeline, and fundraising plan for the project. Once the project is approved and the initial deposit of \$50,000 is raised, the statue is guaranteed upon site preparation and final payment. The Navy Memorial asks to raise at least \$350,000 for the statue, which includes the statue, crating, transportation, a description, a link for fundraising on the Navy Memorial website, a special bronze plaque provided explaining the Lone Sailor, and Navy Memorial leadership attendance at events including fundraisers and the dedication ceremony. The cost of the statue does not include land acquisition, site preparation, or other costs that the local committee may incur. The Lone Sailor statue is 7’ 4” tall and, together with the sea bag, weighs 977 pounds. The Navy Memorial serves as an advisor to the project and, as an IRS-approved 501(c)(3) tax-exempt organization, manages tax-deductible donations to support the project.**

- The most logical choice for the Lone Sailor statue would be in the area denoted in the [Marine Park to Taku Dock Urban Design Plan](#) as “waterfront attraction”.

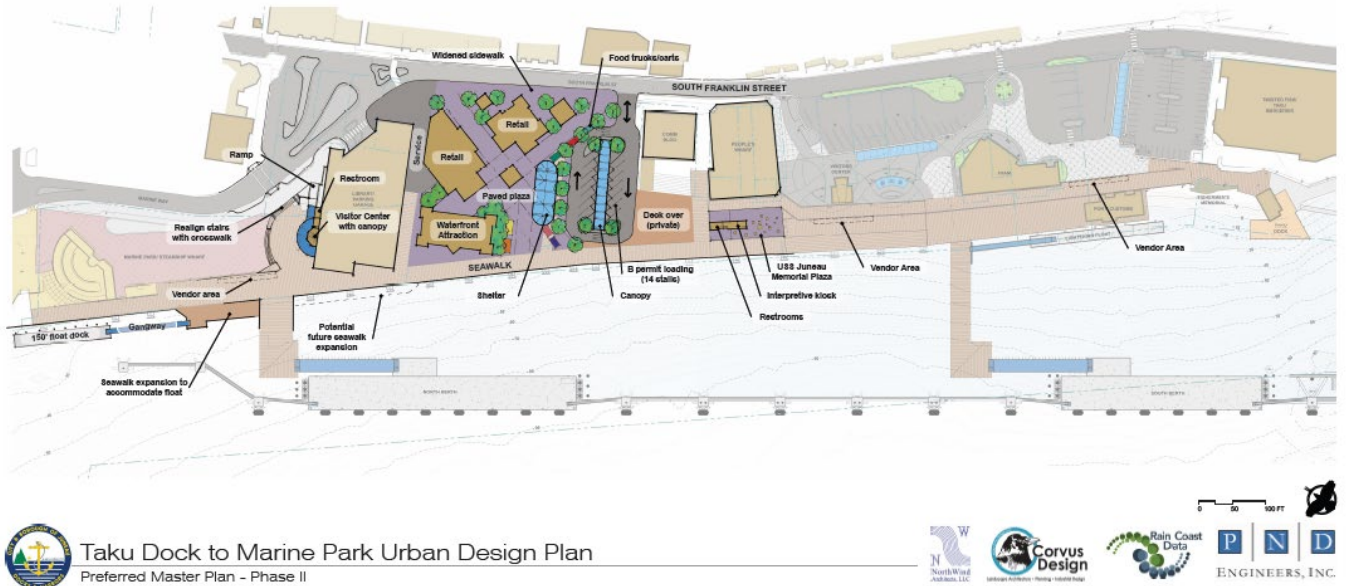

Although there have been several ideas for this area, it seems reasonable that placement of the Lone Sailor statue could reside here until a higher and best use is determined. At that point, there may be other opportunities to relocate the statue to an improved USS JUNEAU Memorial site, the existing USS JUNEAU Memorial site, the potential uplands park at the Huna-Totem Dock or a location to complement the Coast Guard Dock improvements for the STORIS.

- I recommend support of the Pioneers of Alaska (Igloo 6) efforts to place a Lone Sailor statue in the vicinity of the Waterfront Attraction identified in the Marine Park to Taku Dock Urban Design Plan.

#

Encl: (1) Photo of Lone Sailor Statue  
 (2) Documents provided by Pioneer of Alaska at the September 26<sup>th</sup>, 2024 Board Meeting

Copy: Pioneers of Alaska (Igloo 6)  
 Tourism Director





**Lone Sailor Statue at Normandy Beach**

(enclosure 1)





# JUNEQU LONE SAILOR

(enclosure 2)

**USS Juneau Memorial  
Phase One: United States Navy Memorial  
Lone Sailor Project**

**Contact:**

Fred Thorsteinson  
907.321.8868  
fredthorsteinson@gci.net

**Leadership:**

Pioneers of Alaska Igloo No. 6  
Navy League Juneau Council  
Veterans of Foreign Wars Taku Post 5559  
American Legion Auke Bay AK Post 25

**Stakeholders:**

City and Borough of Juneau  
Juneau Arts & Humanities Council  
US Coast Guard Auxiliary Flotilla 1-1, District 17

**Project Description:** The mission of the Lone Sailor United States Navy Memorial is to honor, recognize and celebrate the men and women of the Sea Services, past, present and future; and to inform the public about their service.

Juneau's Lone Sailor bronze statue is Phase One of the planned upgrade and relocation of the USS JUNEAU Memorial to a more prominent location and larger display.

**Estimated Cost:** \$500,000

Initial Deposit: \$50,000  
Site Preparation: \$140,000  
Statue Acquisition/Delivery/Installation: \$300,000  
Unveiling Celebration/Commemorative Mementos: \$10,000

**Naming Rights:** A 48" x 35" bronze plaque on the base of the statue is dedicated to donor naming. Additional opportunities would be available for significant financial support of the greater USS Juneau Memorial.

**Timeline:**

2024 Deposit on Statute  
2025 City and Borough of Juneau Determines Site  
Fundraising  
Site Preparation  
2026 Installation  
October 13 Unveiling of Statue





# Lone Sailor City Statue Timeline

## PROJECT OVERVIEW

The Lone Sailor City Statue Program aligns with the United State Navy Memorial's mission *to Honor, Recognize and Celebrate the men and women of the Sea Service, Past, Present, and Future; and to inform the public about their service.* This document outlines the steps to successfully bring this statue project to fruition.

### PHASE 1: PLANNING, SITE SELECTION AND REGULATORY APPROVALS

- Clarify the purpose and theme of the statue in consultation with stakeholders.
- Identify and finalize the statue's location.
- Conduct thorough historical research and collaborate with artists and designers to create a concept. (Statue Specifications available)
- Check local regulations and obtain necessary permits for statue installation.

### PHASE 2: COMMUNITY ENGAGEMENT

- Engage with the community to gather input and support for the project.
- Host public forums and surveys to collect feedback, incorporating community feedback into the design.

### PHASE 3: FUNDRAISING \*

- Develop a comprehensive fundraising strategy and plan.
- Identify potential donors, sponsors, and partners.
- Execute fundraising activities, events, and donor outreach.

\*U.S. Navy Memorial does not fundraise for city statues.

### PHASE 4: FINANCIAL COMMITMENT AND AGREEMENT

- Review and sign agreements between the project lead and U.S. Navy Memorial.
- Initial deposit of \$50,000 to U.S. Navy Memorial.
- Final payment of \$300,000 must be received before statue is shipped.

### PHASE 5: STATUE AND PLAQUES (4-6 WEEKS)

- Once the deposit has been made, the contract signed and delivery date has been confirmed, the foundry will schedule the patina process based on when the statue is to be shipped. The patina process can take four to six weeks.

### PHASE 6: INSTALLATION PLANNING (TIME DEPENDENT ON RESPECTIVE LOCATION)

- Develop a detailed plan for the installation process.

### PHASE 7: STATUE DELIVERY AND INSTALLATION

- Final payment of \$300,000 due before statue is shipped.
- Packaging and crating take one to two weeks.
- Statue is shipped from the foundry in New York.
- Delivery estimate depends on location and shipping method.

### PHASE 8: DEDICATION CEREMONY

- Work with the U.S. Navy Memorial to plan the Dedication Ceremony

### PHASE 9: POST-IMPLEMENTATION

- Maintenance and Preservation (Ongoing).
- Educational Outreach (Ongoing).

# THE LONE SAILOR

## PLACING A LONE SAILOR STATUE IN CITIES AROUND THE WORLD

[www.NavyMemorial.org](http://www.NavyMemorial.org)



The Lone Sailor has become the iconic symbol of the men and women who have served, are serving or will serve in the Navy. He's called the Lone Sailor, yet he is hardly ever alone. He is about 25 years old, a senior second class petty officer who is fast becoming a seagoing veteran. He has done it all -- fired weapons in war, provided humanitarian assistance in far-away lands, been attacked by the enemy and defended our freedom. He has made liberty calls in great cities and tiny villages where he was a tourist, ambassador, adventurer, friend, and missionary to those less fortunate and representative of our way of life. His shipmates remember him with pride and look up to him with respect.

The Lone Sailor statue was sculpted by Stanley Bleifeld and first dedicated at the U.S. Navy Memorial in Washington, DC on October 13, 1987, as a symbol of the U.S. Navy Memorial's mission to *Honor, Recognize and Celebrate the men and women of the Sea Services, past, present and future; and to Inform the public about their service.*

*The original Lone Sailor statue stands watch in Washington, DC.*

*By placing additional Lone Sailor statues around the world, we honor, recognize and celebrate these men and women wherever they serve. In addition to the original statue in Washington, DC, 17 Lone Sailor statues have been placed around the world.*



*The Lone Sailor statue at the Pearl Harbor Visitor Center in Hawaii, overlooking the USS Arizona.*

### LOCATIONS:

- Adelup Point, Guam
- Baton Rouge, LA
- Bremerton, WA
- Burlington, VT
- Cleveland, OH
- Dallas, TX
- Fort Lauderdale, FL
- Great Lakes, IL
- Long Beach, CA
- Norfolk, VA
- Normandy, France
- North Charleston, SC
- Orlando, FL
- Pearl Harbor, HI
- San Francisco, CA
- Washington, DC
- Waterloo, IA
- West Haven, CT

The process for placing a statue begins with a written request to the Navy Memorial identifying location, timeline, and fundraising plan for the project. Once the project is approved and the initial deposit of \$50,000 is raised, the statue is guaranteed upon site preparation and final payment. The Navy Memorial asks to raise at least \$350,000 for the statue, which includes the statue, crating, transportation, a description, a link for fundraising on the Navy Memorial website, a special bronze plaque provided explaining the Lone Sailor, and Navy Memorial leadership attendance at events including fundraisers and the dedication ceremony. The cost of the statue does not include land acquisition, site preparation, or other costs that the local committee may incur. The Lone Sailor statue is 7' 4" tall and, together with the sea bag, weighs 977 pounds. The Navy Memorial serves as an advisor to the project and, as an IRS-approved 501(c)(3) tax-exempt organization, manages tax-deductible donations to support the project.



For more information regarding the U.S. Navy Memorial's Lone Sailor or the Lone Sailor Statue City Program, please contact Kendra Greenwaters at [kgreenwaters@navymemorial.org](mailto:kgreenwaters@navymemorial.org) or 202-380-0726.





# The Lone Sailor Statue Specifications

## LONE SAILOR STATUE WEIGHT AND DIMENSIONS

Cast in bronze, the dimensions of the "Lone Sailor Statue" which comes in two pieces are:

### Lone Sailor:

88" high x 36" wide x 26" deep

Weight: 633 lbs.

### Seabag and Cleat:

47" high x 44" wide x 24" deep

Weight: 363 lbs.

## LONE SAILOR STATUE INSTALLATION:

Eight 10-inch threaded rods will be provided with the statue. The rods are  $\frac{3}{4}$ "-10, 316 stainless-steel. There are four mountings on the underside of the Lone Sailor and four on the underside of the Seabag and Cleat. Recommended installation:

1. Use the templates provided with the sculpture to mark the mounting hole locations in its desired spot.
2. Drill the marked locations to their desired depth. UAP recommends drilling 8 inches embedment into concrete as well as oversizing the holes by 1/8 inch. (7/8" drilled hole for  $\frac{3}{4}$ " rods)
3. Thread the rods onto each mounting, leaving approximately 8" of rod extending below.
4. Move the sculptures into place and dry fit to their corresponding mounting holes.
5. If this will be a permanent installation, after dry fitting the sculptures to ensure their fit, fill hole  $\frac{1}{4}$  way with industrial epoxy. We recommend the product Hilti Hit-HY 200 or equivalent. (See file HIT-HY-200-200-A-200-R-Product-Data-2016680 for installation specifications)

## BRONZE PLAQUE INFORMATION: (Optional)

The Navy Memorial will provide up to three bronze plaques along with the statue. The following are notional sizes and topics:

**Plaque #1 Who is the Lone Sailor:** 42" H X 32" W. This plaque explains who the Lone Sailor and is and what he represents. The first draft for this plaque is below and can be edited to suit the situation and location of the Sailor.

**Plaque #2 Lone Sailor at XXX Location Description:** 42" H X 32" W This plaque explains "why" the statue is in that location and provides a connection between the Lone Sailor and the area. The group leading the statue project provides the first draft.

**Plaque #3 Donor Plaque:** 48" H X 35" W This plaque acknowledges who is responsible for placing the statue in that area (leaders and donors and contributors.)

**Plaque Base Weight:** The base is dependent upon what materials are used by the location and is the purview of the site designer.

**BRONZE PLAQUE WORDING (First draft for plaque)**

*The Lone Sailor represents the men and women who have served, are serving, or will serve in the United States Navy. He's called the Lone Sailor, yet he is hardly ever alone. He is about 25 years old, a senior second-class petty officer who is fast becoming a seagoing veteran. He has done it all -- fired weapons in war, provided humanitarian assistance in far-away lands, been attacked by the enemy, and defended our freedom. He has made liberty calls in great cities and tiny villages where he was a tourist, ambassador, adventurer, friend, and missionary to those less fortunate. His shipmates remember him with pride and look up to him with respect.*

*The Lone Sailor is an iconic symbol of the Navy Memorial's mission to Honor, Recognize, and Celebrate the men and women of the Sea Services, past, present, and future; and to Inform the public about their service.*

**NOTIONAL DESIGN FOR STATUE BASE (for info only)**

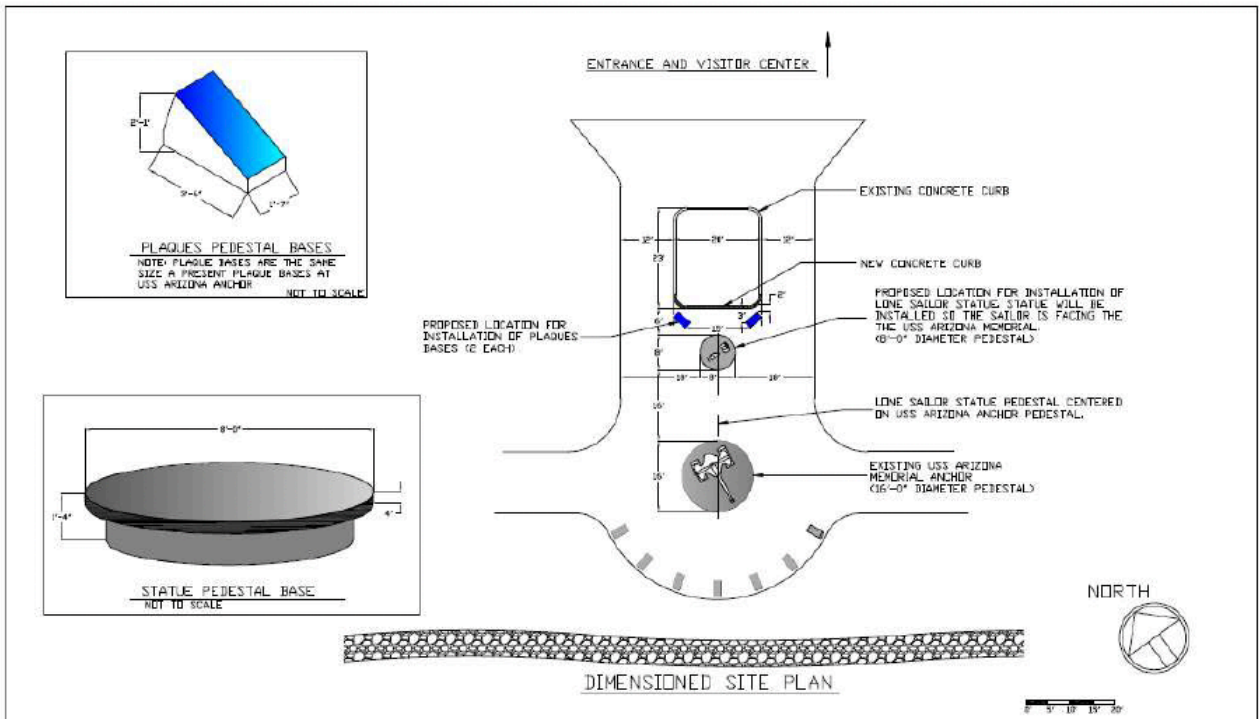

DATE: 06-13-17  
 DRAWN BY: D. T.  
 REV. # 0

WATTS  
 CONSTRUCTORS

US NAVY LONE SAILOR STATUE  
 USS ARIZONA MEMORIAL VISITOR CENTER  
 PEARL HARBOR, HONOLULU, HAWAII

FIELD SKETCH #  
 002

1  
2  
3  
4  
5  
6  
7  
8  
9  
10  
11  
12  
13  
14  
15  
16  
17  
18  
19  
20  
21  
22  
23  
24  
25  
26  
27  
28  
29  
30  
31  
32  
33  
34  
35  
36  
37  
38  
39  
40  
41  
42  
43

Presented by: The Manager  
Presented: 03/17/2025  
Drafted by: Law Department

**RESOLUTION OF THE CITY AND BOROUGH OF JUNEAU, ALASKA**

**Serial No. 3096**

**A Resolution Authorizing the Installation of a Lone Sailor Statue Along the Waterfront and Authorizing the City Manager to Enter into a Memorandum of Agreement with Pioneers of Alaska for Installation and Maintenance of the Statue.**

WHEREAS, the Lone Sailor statue is the iconic symbol representing the United States Navy Memorial’s mission to honor, recognize, and celebrate the men and women of the Sea Services, past, present, and future, and to inform the public about their service; and

WHEREAS, these meaningful statues remind active-duty service members, veterans, and civilians alike that they have served a grateful nation, and the Navy Memorial's Statue City Program, which began in 1997 with the placement of a Lone Sailor statue at Recruit Training Command in Great Lakes, IL, now includes 19 Lone Sailor statues around the world, including the original on Navy Memorial Plaza in Washington, DC; and

WHEREAS, the Pioneers of Alaska have begun the process to acquire the Lone Sailor statue and ask for permission to locate it along the downtown Seawalk; and

WHEREAS, the Docks and Harbors Board of Directors recommended the Assembly allow the statue be placed on the timber deck area between the Alaska Steamship and Cruise Ship Terminal Docks at their January 2025 meeting.

BE IT RESOLVED BY THE ASSEMBLY OF THE CITY AND BOROUGH OF JUNEAU, ALASKA:

**Section 1.** That the Assembly hereby authorizes the installation of a Lone Sailor statue in the timber deck area between the Alaska Steamship Dock and the Cruise Ship Terminal Dock.

**Section 2.** That the Assembly hereby authorizes the City Manager to enter into a Memorandum of Agreement with Pioneers of Alaska for installation and maintenance of the statue.

**Section 3. Effective Date.** This resolution shall be effective immediately after its adoption.

Adopted this \_\_\_\_\_ day of \_\_\_\_\_, 2025.

44  
45  
46  
47  
48  
49  
50  
51

Attest:

\_\_\_\_\_  
Beth A. Weldon, Mayor

\_\_\_\_\_  
Elizabeth J. McEwen, Municipal Clerk

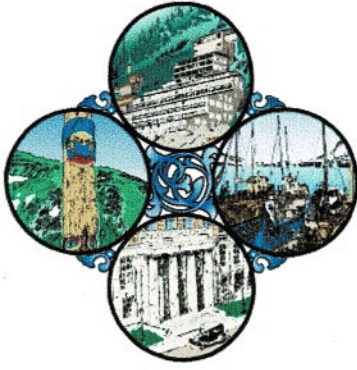

**City and Borough of Juneau, Alaska  
Historic Resources Advisory Committee  
155 Heritage Way, Juneau, Alaska 99801**

March 22, 2025

Amy J.K. Russell  
DOT&PF, Southcoast Region Professionally Qualified Individual – History

Juneau (Mendenhall) Loop Road-Valley Boulevard Intersection Safety Improvement HSIP  
Project No. SFHWY00403/0966030  
Consultation Initiation

Dear Ms. Russell,

The Juneau Historic Resources Advisory Committee (HRAC) held its regular public meeting on March 12, 2025. At the meeting HRAC reviewed the material you provided regarding the proposed safety improvement project referenced above.

HRAC concurs with the identified area of potential effects (APE) and the identification of historic properties within the APE. The Committee is unaware of any additional historic properties in within the APE.

Thank you for including HRAC in the consultation process.

Sincerely,

Gary Gillette, Architect  
HRAC Chair