



PUBLIC NOTICE

Common Council Regular Meeting

Tuesday, July 18, 2023 at 5:30 PM

City Hall Council Chambers, 100 E Fountain St,

Dodgeville, WI

AGENDA

I. CALL TO ORDER AND ROLL CALL

II. CONSENT AGENDA

- [1.](#) Approval of Minutes from July 5, 2023
- [2.](#) Approval of a Temporary Class "B" license to sell fermented malt beverages at the St Joseph's Parish picnic on August 30, 2023.
- [3.](#) Approval of a Street Use Permit for St Joseph's Parish 5K Run/Walk on August 30, 2023.
- [4.](#) Approval of Claims from July 18, 2023

III. PUBLIC COMMENT *Citizen or delegation presentations, requests or comments and discussion of same, pursuant to Wis. Stat. Sec. 19.83 (2) and Sec. 19.84 (2). Ten minute limit except by consent of council. No action will be taken on any item that is not specifically listed on the agenda.*

IV. REPORTS/RECOMMENDATIONS

5. Chamber of Commerce Update
6. Historic Preservation Commission Update

V. NEW BUSINESS

- [7.](#) Discussion and possible action to approve a "Class A" liquor license to sell intoxicating liquor at the following described premises: Design by Lori LLC, doing business as Roots to Branches, 121 N Iowa St, Dodgeville, Wisconsin – Lori Cerutti, Agent
- [8.](#) Discussion and possible action to approve the use of ARPA Funds to outfit the new EMS Command Vehicle.
- [9.](#) Selection of bid for asbestos removal at 105 W Fountain St.
- [10.](#) Selection of bid for brush grinding.
11. Discussion and possible action regarding a claim against the City made by Carolyn Kelley.

VI. ANY OTHER BUSINESS AS ALLOWED BY LAW

VII. ADJOURN

12. Motion to Adjourn

Any person who has a qualifying disability, as defined by the Americans with Disabilities Act, that requires the meeting or material at the meeting to be in an accessible location or format, must contact the City

Clerk at the address listed above or call 930-5228, prior to the meeting so that any necessary arrangements can be made to accommodate each request.



PUBLIC NOTICE

Common Council Regular Meeting

Wednesday, July 05, 2023 at 5:30 PM

City Hall, 100 E Fountain St, Dodgeville, WI

MINUTES

I. CALL TO ORDER AND ROLL CALL

The meeting was called to order by Mayor Novak at 5:30 pm. PRESENT: Roxanne Reynolds-Lair, Tom DeVoss, Jeff Weber, Dan Meuer, Jerry Johnson, Julie Johnson-Solberg, Larry Tremelling ABSENT: Shaun Sersch

II. CONSENT AGENDA

Motion by DeVoss, second by Johnson to approve the following consent agenda:

1. Approval of Minutes from June 20, 2023

2. Approval of Claims from July 5, 2023

General - \$605,371.90, Water - \$23,851.26, Sewer - \$25,901.71 for a Total of \$655,124.87

III. PUBLIC COMMENT *Citizen or delegation presentations, requests or comments and discussion of same, pursuant to Wis. Stat. Sec. 19.83 (2) and Sec. 19.84 (2). Ten minute limit except by consent of council. No action will be taken on any item that is not specifically listed on the agenda.*

Kyle Levetzow, VP with the Ice Wolves Hockey Association introduced himself to the Council members. He also provided stats from the previous year's open skates. There were over 2K skaters.

IV. REPORTS/RECOMMENDATIONS

The new Police Chief Jasica is settling in and getting prepared for upcoming community events.

V. NEW BUSINESS

3. Consideration of a recommendation from the Plan Commission for a Conditional Use Permit for Amanda Gander. The applicant requests a conditional use permit to operate a dog sitting business with up to 11 dogs owned by others on the property at a time. The property is located at 414 East Spring Street with a legal description of Lot 1, CSM 1634-11CS-271. The property is zoned R-1, and is the applicant's place of residence. Pursuant to sec. 17.13(b)(6) of the zoning code, a conditional use permit is required to operate a home occupation within the R-1 district.

This CUP was heard at a prior Plan Commission meeting and was recommended with the following conditions:

Motion by DeVoss, second by Johnson-Solberg to approve a Conditional Use Permit for Amanda Gander to operate a dog sitting business at 414 E Spring St with the conditions outlined at the Plan Commission. Roll call vote. Motion carried 7-0. Voting Yea: Reynolds-Lair, DeVoss, Weber, Meuer, Johnson, Johnson-Solberg, Tremelling

4. Approval of a one year contract with TC Networks for IT Managed Services.

Aulik stated that the City received five proposals for IT Services. A selection committee that consisted of the PW Director, Former Police Chief, Interim Police Chief, EMS Chief and Clerk/Treasurer reviewed all proposals and are making a recommendation to choose TC Networks for a 1 year contract at \$36,000. TC Networks plans to begin a needs assessment and transition in the next few weeks with an anticipated start date of August 1st. It's possible the City will need to incur some additional fees to update software and hardware as needed. Motion by Tremelling, second by Johnson-Solberg to approve a 1-year contract with TC Networks for IT Managed Services. Roll call vote. Motion carried 7-0. Voting Yea: Reynolds-Lair, DeVoss, Weber, Meuer, Johnson, Johnson-Solberg, Tremelling

VI. ANY OTHER BUSINESS AS ALLOWED BY LAW

None

VII. ADJOURN

Motion by Weber, second by Reynolds-Lair to adjourn the meeting. Voice vote. Motion carried 7-0. Voting Yea: Reynolds-Lair, DeVoss, Weber, Meuer, Johnson, Johnson-Solberg, Tremelling

5. Motion to Adjourn

Motion by Weber, second by Reynolds-Lair to adjourn the meeting. Voice vote. Motion carried 7-0.

Any person who has a qualifying disability, as defined by the Americans with Disabilities Act, that requires the meeting or material at the meeting to be in an accessible location or format, must contact the City Clerk at the address listed above or call 930-5228, prior to the meeting so that any necessary arrangements can be made to accommodate each request.

Application for Temporary Class "B" / "Class B" Retailer's License

See Additional Information on reverse side. Contact the municipal clerk if you have questions.

FEE \$ 10.00

Application Date: 06/30/2023

☐ Town ☐ Village ☒ City of Dodgeville

County of Iowa

The named organization applies for: (check appropriate box(es).)

☒ A Temporary Class "B" license to sell fermented malt beverages at picnics or similar gatherings under s. 125.26(6), Wis. Stats.

☐ A Temporary "Class B" license to sell wine at picnics or similar gatherings under s. 125.51(10), Wis. Stats.

at the premises described below during a special event beginning _____ and ending _____ and agrees to comply with all laws, resolutions, ordinances and regulations (state, federal or local) affecting the sale of fermented malt beverages and/or wine if the license is granted.

1. Organization (check appropriate box) →

- ☐ Bona fide Club ☒ Church ☐ Lodge/Society
☐ Veteran's Organization ☐ Fair Association or Agricultural Society
☐ Chamber of Commerce or similar Civic or Trade Organization organized under ch. 181, Wis. Stats.

(a) Name St Joseph Parish

(b) Address 305 E Walnut St Dodgeville
 (Street) ☐ Town ☐ Village ☒ City

(c) Date organized Aug 30, 2023

(d) If corporation, give date of incorporation _____

(e) If the named organization is not required to hold a Wisconsin seller's permit pursuant to s. 77.54 (7m), Wis. Stats., check this box: ☐

(f) Names and addresses of all officers:

President _____

Vice President _____

Secretary _____

Treasurer _____

(g) Name and address of manager or person in charge of affair: Dana Graber

2. Location of Premises Where Beer and/or Wine Will Be Sold, Served, Consumed, or Stored, and Areas Where Alcohol Beverage Records Will be Stored:

(a) Street number 305 E Walnut St Dodgeville WI 53533

(b) Lot _____ Block _____

(c) Do premises occupy all or part of building? yes

(d) If part of building, describe fully all premises covered under this application, which floor or floors, or room or rooms, license is to cover: _____

3. Name of Event

(a) List name of the event St Joseph School

(b) Dates of event Aug 30, 2023

DECLARATION

An officer of the organization, declares under penalties of law that the information provided in this application is true and correct to the best of his/her knowledge and belief. Any person who knowingly provides materially false information in an application for a license may be required to forfeit not more than \$1,000.

Officer Dana Graber 7-10-23 St Joseph School / Parish
 (Signature / Date) (Name of Organization)

Date Filed with Clerk 7-10-2023

Date Reported to Council or Board 7-18-23

Date Granted by Council _____

License No. _____

Applicant/Contact Name: Dana Grabe✓

Email: principal@stjoedodge.org **Telephone:** 608 516 9646

Event Sponsor/Business: St Joseph school & parish

Email: same **Telephone:** _____

Event Information St Joseph 5K Run/Walk
2023

Start date: Aug 30, 2023 **Time:** 5:30 **End Date:** Aug 30, 2023 **Time:** 7:30

Include set-up and tear-down/clean-up time (48 hour notice required if event time changes or is cancelled, if notice is NOT given, costs will be assessed for employee time).

Description of street(s) proposed to be used. Please provide a map with your application.

Route begins S. Ellwood to E. Valley - S. Daratona - E Parry -
South Union Compassion Way - Heritage Ln extends
to Brennan Rd

Street Barricades: Barricades are requested for the following locations:

none

I understand that I may be required to set up barricades at the locations designated by the City and to take down the barricades after the event. Generally, barricades may be set in place no earlier than ½ hour before the start of the event and must be removed immediately following the event and returned to the location designated by the City no more than 1 hour after the conclusion of the event.

Estimated number of persons in attendance: 150

Certificate of Insurance may be required, if attendance exceeds 50 - an additional officer maybe required at applicants expense.

General Event Type:

☐ Parade ☐ Block Party ☒ Sports Event ☐ Other (describe)

State and/or County Approval Required? (for events involving using/crossing state or county trunk highways)

☐ Yes ☒ No

State and/or County Approval Obtained?☐ Yes☒ No

Use of Street(s): *(include a detailed description of all activities such as vending, music, selling of food or alcohol beverages, location and use of tents, stages, or other equipment, and attach a detailed plan for clean-up after the event, steps to be taken to prevent vehicular traffic from going through the area, and steps that will be done to ensure the security of not allowing underage people in the fenced area, if alcohol is to be served):*

If using recording or sound amplification equipment please describe: _____

Designate any public facilities or equipment to be used: *(additional costs may be incurred):* _____

Has notification to all residences and businesses that may be impacted in the area been given?

☒ Yes☐ NoDATE: 7-10-23

Check method used:

☐ Publication☐ Flyers☐ Phone☐ Personal visit

Email

☐ Other (explain) _____

I certify that I have read and understand the City of Dodgeville Ordinance #1296 An Ordinance To Require Street Use Permits, and agree to adhere to all of the rules and requirements outlined in the Ordinance and that all information provided on this application is true and correct.

Dana Grah
Signature

7-10-23
Date

CITY OF DODGEVILLE
INDEMNIFICATION / HOLD HARMLESS

I/We, St Joseph Parish, sponsor(s) and/or co-sponsors
of (name/organization)

St Joseph 5K Run/Walk 2023,
(name of event)

shall indemnify, hold harmless, and defend City of Dodgeville, its officers, agents,
and employees from and against all claims, damages, losses, and expenses,
including attorneys' fees, which arise from or out of the above specified event.

Dana Graber
Responsible officer, event sponsor/co-sponsor

7-10-23
Date

Fr. Tafadzwa
Responsible officer, event sponsor/co-sponsor

7-10-23
Date

Report Criteria:

Report type: Summary

Check.Type = {<>} "Adjustment"

GL Period	Check Issue Date	Check Number	Vendor Number	Payee	Check GL Account	Amount
07/23	07/18/2023	873	1641	DEAN HEALTH PLAN	100-21000-000-000	402.44
07/23	07/18/2023	4242	505	JEWELL ASSOCIATES ENGINEERS INC	160-21000-000-000	6,330.00
07/23	07/18/2023	4243	851	RULE CONSTRUCTION LTD	160-21000-000-000	155,838.69
07/23	07/18/2023	4244	1378	VIERBICHER ASSOCIATES	160-21000-000-000	33,784.00
07/23	07/06/2023	61108	1538	AT&T MOBILITY	100-21000-000-000	981.10
07/23	07/06/2023	61109	389	Galls LLC	100-21000-000-000	324.40
07/23	07/06/2023	61110	668	MHTC-MH	100-21000-000-000	1,729.09
07/23	07/10/2023	61111	89	BAKER & TAYLOR LLC	150-21000-000-000	1,163.23
07/23	07/10/2023	61112	195	CITY OF DODGEVILLE WATER UTILITY	150-21000-000-000	35.54
07/23	07/10/2023	61113	274	DEMCO	150-21000-000-000	103.20
07/23	07/10/2023	61114	1592	DENNIS J MARKLEIN	150-21000-000-000	650.00
07/23	07/10/2023	61115	408	GORDON FLESCH CO INC	150-21000-000-000	91.24
07/23	07/10/2023	61116	668	MHTC-MH	150-21000-000-000	140.57
07/23	07/10/2023	61117	1830	Playaway Products LLC	150-21000-000-000	314.94
07/23	07/10/2023	61118	1044	US CELLULAR	150-21000-000-000	66.86
07/23	07/18/2023	61120	124	BOND TRUST SERVICES CORPORATION	140-21000-000-000	1,500.00
07/23	07/18/2023	61121	781	ADVANTAGE COPY	100-21000-000-000	456.92
07/23	07/18/2023	61122	34	ALLIANT ENERGY/WP&L (UTILITY PAYMENTS)	100-21000-000-000	4,071.90
07/23	07/18/2023	61123	36	AMAZON CAPITAL SERVICES	100-21000-000-000	2,137.56
07/23	07/18/2023	61124	63	APPLIED MICRO	100-21000-000-000	189.00
07/23	07/18/2023	61125	1337	BADGER METER	200-21000-000-000	133.38
07/23	07/18/2023	61126	84	BADGER SWIMPOOLS INC	100-21000-000-000	270.00
07/23	07/18/2023	61127	85	BADGER WELDING SUPPLIES INC	100-21000-000-000	242.67
07/23	07/18/2023	61128	1776	Blain's Farm & Fleet	100-21000-000-000	882.41
07/23	07/18/2023	61129	120	BOARDMAN & CLARK LLP	100-21000-000-000	10,423.00
07/23	07/18/2023	61130	124	BOND TRUST SERVICE CORPORATION	430-21000-000-000	18,050.00
07/23	07/18/2023	61131	124	Bond Trust Services Corporation	430-21000-000-000	10,587.50
07/23	07/18/2023	61132	136	BRIAN BOCKHOP	100-21000-000-000	114.00
07/23	07/18/2023	61133	188	CINTAS CORPORATION #446	100-21000-000-000	35.00
07/23	07/18/2023	61134	195	CITY OF DODGEVILLE WATER UTILITY	100-21000-000-000	5,075.70
07/23	07/18/2023	61135	199	CIVIC SYSTEMS LLC	300-21000-000-000	6,538.00
07/23	07/18/2023	61136	211	COMELEC SERVICES INC	100-21000-000-000	3,600.00
07/23	07/18/2023	61137	976	CVIKOTA COMPANY INC	100-21000-000-000	6,354.43
07/23	07/18/2023	61138	286	DIGGERS HOTLINE INC	200-21000-000-000	160.00
07/23	07/18/2023	61139	311	DONS TIRE INC	100-21000-000-000	1,372.00
07/23	07/18/2023	61140	351	ERIC ROHOWETZ	100-21000-000-000	80.00
07/23	07/18/2023	61141	360	FAHERTY INC	100-21000-000-000	21,521.56
07/23	07/18/2023	61142	393	GENE VAN DYCK	100-21000-000-000	100.00
07/23	07/18/2023	61143	405	GLOBAL INDUSTRIAL	100-21000-000-000	73.58
07/23	07/18/2023	61144	408	GORDON FLESCH CO INC	100-21000-000-000	141.56
07/23	07/18/2023	61145	427	HALLADA MOTORS INC	100-21000-000-000	80.21
07/23	07/18/2023	61146	435	HAWKINS INC	200-21000-000-000	1,552.04
07/23	07/18/2023	61147	440	HENNESSEY IMPLEMENT INC	100-21000-000-000	288.60
07/23	07/18/2023	61148	466	IVERSON CONSTRUCTION	100-21000-000-000	5,224.33
07/23	07/18/2023	61149	565	KIMBALL MIDWEST	100-21000-000-000	305.24
07/23	07/18/2023	61150	1308	KWIK TRIP INC - CREDIT DEPT	200-21000-000-000	5,320.08
07/23	07/18/2023	61151	599	LEAGUE OF WI MUNICIPALITIES	100-21000-000-000	75.00
07/23	07/18/2023	61152	621	LV Labs WW LLC	300-21000-000-000	1,784.50
07/23	07/18/2023	61153	1849	Marcia Murn	100-21000-000-000	100.00
07/23	07/18/2023	61154	640	MARKS AUTO REPAIR	100-21000-000-000	60.77
07/23	07/18/2023	61155	642	MARTELLE WATER TREATMENT INC	200-21000-000-000	2,305.22
07/23	07/18/2023	61156	686	MIDWEST POOL SUPPLY INC	100-21000-000-000	1,130.50
07/23	07/18/2023	61157	1853	Miguel Rivas	100-21000-000-000	100.00

GL Period	Check Issue Date	Check Number	Vendor Number	Payee	Check GL Account	Amount
07/23	07/18/2023	61158	699	MINERAL POINT SWIM TEAM	100-21000-000-000	175.00
07/23	07/18/2023	61159	710	MTAW	100-21000-000-000	60.00
07/23	07/18/2023	61160	746	OREILLY AUTO PARTS	100-21000-000-000	98.10
07/23	07/18/2023	61161	772	PETTY CASH	100-21000-000-000	50.00
07/23	07/18/2023	61162	783	POMASL FIRE EQUIPMENT INC	100-21000-000-000	72.44
07/23	07/18/2023	61163	784	POSITIVE PROMOTIONS INC	100-21000-000-000	722.77
07/23	07/18/2023	61164	851	RULE CONSTRUCTION LTD	100-21000-000-000	1,433.90
07/23	07/18/2023	61165	866	SCHILLING SUPPLY COMPANY	100-21000-000-000	422.33
07/23	07/18/2023	61166	879	SECURIAN FINANCIAL GROUP INC	100-21000-000-000	652.78
07/23	07/18/2023	61167	886	SHANE CROOK ELECTRICAL	100-21000-000-000	153.00
07/23	07/18/2023	61168	901	SINGER LUMBER CO INC	100-21000-000-000	312.59
07/23	07/18/2023	61169	926	STAPLES ADVANTAGE	100-21000-000-000	316.16
07/23	07/18/2023	61170	1851	Tanner Bockhop	100-21000-000-000	114.00
07/23	07/18/2023	61171	1393	TC NETWORKS INC	100-21000-000-000	44.21
07/23	07/18/2023	61172	1033	UNION TECHNOLOGY COOPERATIVE	100-21000-000-000	19.99
07/23	07/18/2023	61173	1040	UPLAND HILLS HEALTH INC	100-21000-000-000	552.32
07/23	07/18/2023	61174	1046	USA BLUEBOOK	200-21000-000-000	895.11
07/23	07/18/2023	61175	1107	WI STATE LABORATORY OF HYGIENE	200-21000-000-000	28.00
07/23	07/18/2023	61176	1109	WIL-KIL PEST CONTROL	100-21000-000-000	109.91
07/23	07/18/2023	61177	1117	WISCONSIN DEPARTMENT OF REVENUE	100-21000-000-000	1,889.99
07/23	07/18/2023	61178	1147	ZOLL MEDICAL CORPORATION	100-21000-000-000	285.00

Grand Totals:

322,799.56

Summary by General Ledger Account Number

GL Account	Debit	Credit	Proof
100-13105-000-000	402.44	.00	402.44
100-21000-000-000	2.64	76,065.19-	76,062.55-
100-21543-000-000	170.03	.00	170.03
100-21552-000-000	482.75	.00	482.75
100-23160-000-000	200.00	.00	200.00
100-24213-000-000	1,889.99	.00	1,889.99
100-51300-000-000	42.31	.00	42.31
100-51300-390-000	91.00	.00	91.00
100-51410-000-000	71.56	.00	71.56
100-51520-220-000	60.00	.00	60.00
100-51520-225-000	75.00	.00	75.00
100-51600-600-000	365.19	.00	365.19
100-51710-200-000	102.87	.00	102.87
100-51710-240-000	2,179.34	.00	2,179.34
100-51710-300-000	196.66	.00	196.66
100-51710-320-000	79.33	.00	79.33
100-52100-000-000	44.21	.00	44.21
100-52100-300-000	516.70	.00	516.70
100-52100-320-000	154.66	.00	154.66
100-52100-410-000	1,347.25	.00	1,347.25
100-52100-520-000	10,521.00	.00	10,521.00
100-52100-600-000	327.80	.00	327.80
100-52200-200-000	20.64	.00	20.64
100-52200-280-000	126.74	.00	126.74
100-52200-300-000	157.05	.00	157.05
100-52200-320-000	110.60	.00	110.60
100-52200-400-000	465.47	.00	465.47

GL Account	Debit	Credit	Proof
100-52200-410-000	464.53	.00	464.53
100-52200-600-000	453.56	.00	453.56
100-52300-175-000	324.40	.00	324.40
100-52300-200-000	670.21	.00	670.21
100-52300-260-000	6,227.69	.00	6,227.69
100-52300-300-000	651.31	.00	651.31
100-52300-320-000	83.57	.00	83.57
100-52300-400-000	197.00	.00	197.00
100-52300-410-000	813.85	.00	813.85
100-52300-500-000	564.10	.00	564.10
100-52300-505-000	3,600.00	.00	3,600.00
100-52300-520-000	55.90	.00	55.90
100-52300-605-000	972.12	.00	972.12
100-52300-700-000	722.77	.00	722.77
100-52300-720-000	92.53	.00	92.53
100-52400-300-000	45.81	.00	45.81
100-53100-300-000	89.39	.00	89.39
100-53230-000-000	705.41	.00	705.41
100-53240-000-000	1,901.05	.00	1,901.05
100-53410-000-000	1,037.97	.00	1,037.97
100-53420-000-000	4,071.90	.00	4,071.90
100-53440-000-000	53.86	.00	53.86
100-53620-000-000	11,723.16	.00	11,723.16
100-53630-000-000	9,798.40	.00	9,798.40
100-54910-300-000	64.99	.00	64.99
100-54910-320-000	285.60	.00	285.60
100-54910-600-000	2,865.26	2.64-	2,862.62
100-55200-300-000	108.54	.00	108.54
100-55200-320-000	679.42	.00	679.42
100-55200-400-000	686.00	.00	686.00
100-55200-410-000	652.67	.00	652.67
100-55200-600-000	76.25	.00	76.25
100-55300-180-000	408.00	.00	408.00
100-55300-300-000	55.15	.00	55.15
100-55420-175-000	29.99	.00	29.99
100-55420-200-000	35.22	.00	35.22
100-55420-300-000	176.89	.00	176.89
100-55420-320-000	2,218.85	.00	2,218.85
100-55420-600-000	332.95	.00	332.95
100-55420-620-000	1,174.70	.00	1,174.70
100-55425-000-000	468.63	.00	468.63
100-55430-000-000	225.00	.00	225.00
140-21000-000-000	.00	1,065.73-	1,065.73-
140-58200-000-000	1,065.73	.00	1,065.73
150-21000-000-000	.00	2,644.92-	2,644.92-
150-55115-222-000	79.34	.00	79.34
150-55115-223-000	140.57	.00	140.57
150-55115-224-000	91.24	.00	91.24
150-55115-311-000	103.20	.00	103.20
150-55115-321-000	1,163.23	.00	1,163.23
150-55115-323-000	314.94	.00	314.94
150-55115-381-000	66.86	.00	66.86
150-55115-391-000	35.54	.00	35.54
150-55115-392-000	650.00	.00	650.00
160-21000-000-000	.00	195,952.69-	195,952.69-
160-57230-240-000	6,330.00	.00	6,330.00
160-57330-000-000	189,622.69	.00	189,622.69

GL Account	Debit	Credit	Proof
200-21000-000-000	1.60	12,425.52-	12,423.92-
200-53700-000-427	393.79	.00	393.79
200-53700-623-000	355.52	.00	355.52
200-53700-631-000	3,857.26	.00	3,857.26
200-53700-632-000	646.60	.00	646.60
200-53700-651-000	4,186.36	.00	4,186.36
200-53700-653-000	133.38	.00	133.38
200-53700-660-000	360.38	.00	360.38
200-53700-681-000	2,492.23	1.60-	2,490.63
300-21000-000-000	.00	6,012.25-	6,012.25-
300-53600-000-427	40.48	.00	40.48
300-53600-000-827	940.10	.00	940.10
300-53600-000-828	378.56	.00	378.56
300-53600-000-834	377.22	.00	377.22
300-53600-000-851	2,491.39	.00	2,491.39
300-53600-000-852	1,784.50	.00	1,784.50
430-21000-000-000	.00	28,637.50-	28,637.50-
430-56702-000-000	28,637.50	.00	28,637.50
Grand Totals:	322,808.04	322,808.04-	.00

Dated: _____

Mayor: _____

City Council: _____

City Recorder: _____

Report Criteria:

Report type: Summary

Check.Type = {<>} "Adjustment"

Original Alcohol Beverage License Application

FOR CL	Section V. Item #7.
Municipality	
License Period	

License(s) Requested

- ☐ Class "A" Beer \$ _____
- ☒ "Class A" Liquor \$ 250
- ☐ Class "B" Beer \$ _____
- ☐ "Class B" Liquor \$ _____
- ☐ "Class C" Wine \$ _____
- ☐ "Class A" Liquor (Cider Only) \$ 0
- ☐ Reserve "Class B" Liquor \$ _____
- ☐ "Class B" (Wine Only) Winery \$ _____

License Fees	\$ <u>250-</u>
Publication Fee	\$ <u>13-</u>
Background Check	\$
Total Fees	\$ <u>263.00</u>

Part A: Premises/Business Information

1. Legal Business Name (registered entity name or individual's name if sole proprietorship) <u>Lori Cerutti Design by Lori LLC</u>		
2. Trade Name or DBA Roots to Branches		
3. Premises Address 121 N Iowa Street		
4. County Iowa	5. Municipality Dodgeville	6. Aldermanic District
7. Mailing Address (if different from premises address) 2290 Survey Rd Dodgeville WI 53533		
8. FEIN [REDACTED]	9. Wisconsin Seller's Permit Number [REDACTED]	
10. Premises Phone (608) 341-9116	11. Premises Email rootstobranche608@gmail.com	
12. Entity Type (check one) <input type="checkbox"/> Sole Proprietor <input type="checkbox"/> Partnership <input checked="" type="checkbox"/> Limited Liability Company <input type="checkbox"/> Corporation <input type="checkbox"/> Nonprofit Organization		
13. Premises Description - Describe the building or buildings where alcohol beverages are to be sold and stored. Describe all rooms including living quarters, if used, for the sales, service, consumption, and/or storage of alcohol beverages and records. Alcohol beverages may be sold and stored ONLY on the premises described in this application. Attach additional sheets if necessary. I would like to sell wine at a local shoppe where we will also have antiques, home decor, crafts and more. The alcohol would be displayed in a designated area of the shoppe for display and sales. Extra supplies would be stored in a room at the back of the store in a locked space.		

Part B: Questions

1. Have the partners, agent, or sole proprietor satisfied the responsible beverage server training requirement for this license period? Submit a copy of Responsible Beverage Server Training Course Certificate ☐ Yes ☒ No
2. Does the applicant business or its partners, officers, directors, managing members, or agent hold a direct or indirect interest in any alcohol beverage wholesaler or producer (e.g., brewer, brewpub, winery, distillery)? ☐ Yes ☒ No
 If yes, please explain using the space below. Attach additional sheets if necessary.

Part C: For Corporate/LLC Applicants Only		
1. State of Registration Wisconsin		2. Date of Registration 07/06/23
3. Is the applicant business owned by another corporation or LLC? If yes, please provide the name and FEIN of the parent company below, include parent company members in Part D, and attach Form AT-103 for all of the parent company's principal members, managers, officers, or directors <input type="checkbox"/> Yes <input checked="" type="checkbox"/> No		
Name of Parent Company		FEIN of Parent Company
4. Does the parent company or any of its officers, directors, managing members, or agent hold any direct or indirect interest in any other alcohol beverage wholesaler or producer (e.g., brewer, brewpub, winery, distillery)? <input type="checkbox"/> Yes <input checked="" type="checkbox"/> No If yes, please explain using the space below. Attach additional sheets if necessary.		
5. Agent's Last Name Cerutti	Agent's First Name Lori	Phone [REDACTED]

Part D: Individual Information
A Supplemental Questionnaire, Form AT-103, must be completed and attached to this application for each person involved in the applicant business and any parent company as indicated in Part C. Persons in the applicant business include: sole proprietor, all officers, directors, and agent of a corporation or nonprofit organization, all partners of a partnership, and all managing members and agent of a limited liability company.

List the full name, title, and phone number for each person below. Attach additional sheets if necessary.

Last Name	First Name	Title	Phone
Cerutti	Lori	Owner	[REDACTED]

Part E: Attestation		
Who must sign this application? • sole proprietor • one general partner of a partnership • one corporate officer • one managing member of an LLC		
READ CAREFULLY BEFORE SIGNING: Under penalty of law, I have answered each of the above questions completely and truthfully. I agree that I am acting solely on behalf of the applicant business and not on behalf of any other individual or entity seeking the license. Further, I agree that the rights and responsibilities conferred by the license(s), if granted, will not be assigned to another individual or entity. I agree to operate this business according to the law, including but not limited to, purchasing alcohol beverages from state authorized wholesalers. I understand that lack of access to any portion of a licensed premises during inspection will be deemed a refusal to allow inspection. Such refusal is a misdemeanor and grounds for revocation of this license. I understand that any license issued contrary to Wis. Stat. Chapter 125 shall be void under penalty of state law. I further understand that I may be prosecuted for submitting false statements and affidavits in connection with this application, and that any person who knowingly provides materially false information on this application may be required to forfeit not more than \$1,000 if convicted.		
Signature Lori Cerutti		Date 07/06/2023
Name (Last, First, M.I.) Cerutti, Lori, L		
Title Owner	Email [REDACTED]	Phone [REDACTED]

Part F: For Clerk Use Only		
Date application was filed with clerk 7-7-23	Date reported to governing body 7-18-23	Date provisional license issued (if applicable)
Date license granted	License number	Date license issued
Signature of Clerk/Deputy Clerk [Signature]		

1918 Neva Road, PO Box 267
Antigo, WI 54409
800.686.6886 or 715.623.7454
fax: 715.627.7504



dan@pomasl.com
kevin@pomasl.com
www.pomasl.com

Section V. Item #8.

June 26, 2023

Dodgeville Area Ambulance
300 W. Spring Street
Dodgeville, WI 53533

Dear Brian,

We are proud to present our **quotation** to **upfit your 2023 F250 truck** for your department. The F250 truck would be supplied by your department and delivered to our office unless other arrangements would be made.

The following items would be supplied by and installed by Pomasl Fire Equipment:

Ranch Hand model PBF201BL1 full height center bull bar including shipping and installation.

- We have installed several Ranch Hand full bumper / grill guar replacements and these are well made and durable.



Amber LED fog lights will be supplied and installed – location to be determined after the bull bar is installed.

Gamber Johnson wide cab console with armrest and cupholders will be installed including the following:

- Gamber Johnson 7160-0597, 6" short interior pocket
- Gamber Johnson MCS-POCKET3, tall interior pocket
- Gamber Johnson 7160-0339, faceplate for Whelen CenCom
- (2) Gamber Johnson #7160-0321, faceplates for APX 8500 mobile radio heads

Prompt, Courteous Service since 1939



1918 Neva Road, PO Box 267
Antigo, WI 54409
800.686.6886 or 715.623.7454
fax: 715.627.7504



dan@pomasl.com
kevin@pomasl.com
www.pomasl.com

Section V. Item #8.

Gamber Johnson filler panels as needed to complete the console box

- (1) round 12vdc power point charging port
- (2) round charging power points that include (1) USB and (1) USB-C connection
- (1) 110vac duplex on the cab console – location to be determined by the customer

RAM® X-Grip® Drill-Down Double Ball Mount for 12" Tablets, the mount will bolt down to the top front flat surface of the Gamber Johnson console. The item includes the mounting arm and the X-Grip holder for the Ipad.



Crew cab under seat storage that fits under the crew cab seats. The mobile radio amplifiers and inverter/charger will be installed in the smaller storage area. The larger storage area would provide secured storage for additional department equipment

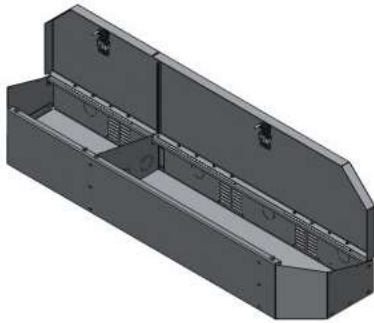

Kussmaul 63-11-2106, 20-amp super auto eject with Deluxe cover with bar graph display will be supplied and installed – location will be determined later.

Prompt, Courteous Service since 1939



1918 Neva Road, PO Box 267
Antigo, WI 54409
800.686.6886 or 715.623.7454
fax: 715.627.7504



dan@pomasl.com
kevin@pomasl.com
www.pomasl.com

Section V. Item #8.



Xantrex 817-02080, XC watt inverter / charger - 2,000-watt inverter with 4,000-watt surge power. Includes Smart charger built in that will charge in bulk mode, steady mode, and trickle mode. The inverter will be wired to the shoreline and 110-vac outlets

A.R.E. truck bed cap / topper or similar brand of equal quality will be supplied and installed. Including storage with hinged door on the left side and right side. A hinged swing up door without a window will be installed on the rear above the tailgate. Includes incoming shipping and installation.

(1) Whelen Legacy, DUO WeCanX light bar will be supplied and installed on the chassis cab roof with hook kit mounting brackets

(10) forward facing red / white LED modules

(4) corner red / white LED modules

(2) side facing white LED Alley lights

(10) rear facing red / amber LED modules

- rear amber LEDs will be programed for arrow stick mode unless the customer requests other programing

Smoked lenses on light bar

(1) Whelen MKAJ94, mounting bracket for the above light bar

Example Picture of light bar. This shows blue on the right side, however your light bar will be red / white on the front and sides and red / amber on the rear.

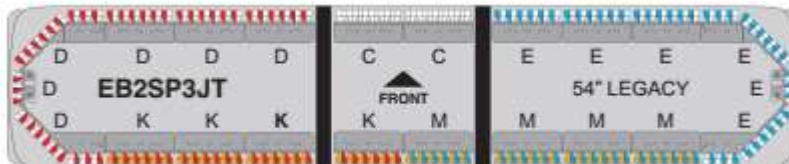

(1) Whelen C399 CenCom Core controller with module with siren amplifier to control warning lights and siren via programable pattern including dimming and DVI

Prompt, Courteous Service since 1939



1918 Neva Road, PO Box 267
Antigo, WI 54409
800.686.6886 or 715.623.7454
fax: 715.627.7504



dan@pomasl.com
kevin@pomasl.com
www.pomasl.com

Section V. Item #8.

(1) Whelen CCTL6, control head to control warning light, scene light, and siren functions. Slide switch for quick activation, dial for siren tones, (8) programable top buttons, (3) lower arrow stick programable buttons

(1) Whelen C399K1, OBDII CanPort installation kit for use with a F350 chassis – allows the Core to communicate with the chassis for advanced programing functions like automatically changing a flash pattern when the vehicle is put in park.

(1) Whelen CV2V, vehicle to vehicle module includes antenna

(2) Whelen CEM16, expansion modules; one front and one rear of the chassis. The C399 Core unit has an ample but limited amount of inputs and outputs. The expansion modules allow additional lights to be connected with less wiring and easy programing.

(2) Whelen SA315P, siren speaker with SAK9 mounting brackets. The siren speakers will be mounted behind the grill on the F350 chassis.

(2) Whelen TCRWX2, Tracer, 2 POD, DUO red / white to be supplied and installed on the front bull bar, overall length of each 2 POD Tracer is 26.16" long

(2) Whelen TCRWXP, primary POD, red/white

(2) Whelen TCRWXSD, secondary POD, red/white

(3) Whelen TCRLBKT, TRACER 'L' brackets

(2) Whelen M4RC, M4 red LED with a clear lens to be installed on the sides of the bull bar facing the left/right side of the vehicle. Whelen M4FB black flanges will be included

Headlights to Wig Wag via programming

(1) Whelen ARGES2, ProFocus with spot / flood light to be supplied and installed on the driver side fender panel

(1) Whelen ARGCH1, control head to be supplied and installed on the cab console

(1) Whelen ARGFM, flat mount bracket for control head

(1) Whelen ARG47BD, F250/350 driver side fender mount

(2) Whelen TCRWX6, Tracer, 6 POD, DUO red / white to be supplied and installed on the chassis running board light, overall length of each 6 POD Tracer is 75.62"

(2) Whelen TCRWXP#, Primary DUO - Position 1

(10) Whelen TCRWXS#, Secondary DUO - Position 2,3,4,5,6

(2) Whelen TCRB47, running board mounting kit

Prompt, Courteous Service since 1939



1918 Neva Road, PO Box 267
Antigo, WI 54409
800.686.6886 or 715.623.7454
fax: 715.627.7504



dan@pomasl.com
kevin@pomasl.com
www.pomasl.com

Section V. Item #8.

(4) Whelen M4RC, M4 red LED with a clear lens to be installed on the sides of the sides of the topper; upper forward and upper rearward. Whelen M4FB black flanges will be included.

(1) Whelen TCRWX3, Tracer, 2 POD, DUO red / white to be supplied and installed inside the topper to face rearward through the glass in the hinged singe up door. White light to turn off when chassis in Park.

- (1) Whelen TCRWXP, primary POD, red/white
- (2) Whelen TCRWXSD, secondary POD, red/white
- (4) Whelen TCRLBKT, TRACER 'L' brackets

(2) Whelen VTX9D, Vertex DUO red / white lights will be supplied and installed on rear above taillights on the truck box. Whelen VTXFB black flanges will be installed. White will be programmed to turn off when the chassis is in Park.

- Note: after considerable issues installing lights inside the taillight housings on the project we are working on, we are declining installing lights inside the Ford taillight assemblies.

(3) Whelen PSD02FCR, Strip-Lite Plus DUO red/white: install on tail gate on the left, center, and right. Each light is 11.11" wide. White lights to steady burn when chassis in Reverse

(2) Whelen TLI2D, ION T-series DUO red / white LED lights: installed on license plate mounting bracket. Whelen TIONBKT2 license plate bracket will be installed for mounting the lights

(2) Tecniq 30 LED, 47.5" long white LED aluminum extrusion light with black housing with perpendicular mounting clips, sealed with TPE end caps for superior protection of LEDs and wiring. The lights will be installed one each side in the side facing storage.

(2) Tecniq 30 LED, 47.5" long white LED aluminum extrusion light with black housing with perpendicular mounting clips, sealed with TPE end caps for superior protection of LEDs and wiring. The lights will be installed inside the topper.

(3) Whelen 60CREGCS, 6" dome lights, red / white to be installed in the cab; one above the inside shoulder of the passenger seat and two in the crew cab

Install (2) CTF dual head mobile radios - Amps to be mounted under crew cab seats in the Havis storage box. The antenna will be provided with the radios

(2) NMO antenna mounts with coax cable

Prompt, Courteous Service since 1939



1918 Neva Road, PO Box 267
Antigo, WI 54409
800.686.6886 or 715.623.7454
fax: 715.627.7504



dan@pomasl.com
kevin@pomasl.com
www.pomasl.com

Section V. Item #8.

(5) Magnetic Mic MMSU-1 mic holders; one for the siren, four for the mobile radio. Location to be determined

Install customer supplied router / Wi-Fi module with antenna

Install Rosco DV-440, dual vision dash cam

(4) TROND 5-place power strips with (3) USB outlets to be installed two each side of the topper; exact locations to be determined

(1) 5 lb. fire extinguisher with vehicle bracket; installed per customer directions

Programming: Flash patterns, Dimming & Variable Intensity
Wire, Lume, hardware, shop supplied to install all the above
Labor to install all the above

Slide-Master 1,000 lb. slide out tray, 6' truck bed, 3/16" tray, Powdercoat Silver, IMS spring lock open/closed

Install by Slide-Master

Command module to be installed on the slide out tray: side access for bags on left side, slide our drawer on right side for laptop/other storage, radio head mounting spots rear upper, white board on rear, location for LCD monitor, other as determined

- (1) 24" monitor with flush mount bracket for installation on the cabinet
- (2) 12 vdc round outlet; location to be determined
- (2) dual USB outlets; USB & USB-C; location to be determined
- (2) Trond 110vac duplex power strips with (3) USB; location to be determined

(4) Tecniq 12 LED, 11.5" long white LED aluminum extrusion light with black housing with perpendicular mounting clips, sealed with TPE end caps for superior protection of LEDs and wiring. The lights will be installed inside the topper.

Graphics: design similar to picture from Brian – White cab forward with orange reflective stripe on white paint. Orange reflective lettering on the cab doors – DODGEVILLE EMS. Large Star of Life mid-body with reflective outline. Orange non-reflective wrap rear of Star of Life. White reflective stripe on orange wrap. Chevrons on rear tailgate. Proof to be provided prior to installation.

Prompt, Courteous Service since 1939



1918 Neva Road, PO Box 267
Antigo, WI 54409
800.686.6886 or 715.623.7454
fax: 715.627.7504



dan@pom
kevin@pomasl.com
www.pomasl.com

Section V. Item #8.

\$ 500.00 Allowance for equipment mounting in the cab for gloves and other items.

- I have not been able to find the ceiling mount glove, speaker, light unit that you sent me the picture. If you can remember where you found that, please pass along the website.
- I was able to find some tactical MOLLE panel mounts. These are black metal tactical/military mounting panels that we could use to mount glove box holders and other items to. If we cannot find the item from the picture, these would probably work.

\$ 64,788.00 Total for all the above including shipping and installation

If you have any questions or concerns, please *reach out to me anytime* via cell phone at **715-610-4210** or at the office at **1-800-686-6886** or via email at kevin@pomasl.com.

Sincerely,

A handwritten signature in black ink that reads "Kevin Pomasl".

Kevin Pomasl
Pomasl Fire Equipment

Prompt, Courteous Service since 1939



CITY OF DODGEVILLE
ASBESTOS REMOVAL
105 W FOUNTAIN ST

Bidder Name and Address	Bid Amount
Dirty Ducts Cleaning & Environmental, Inc 3025 Perry St Madison, WI 53713	\$5,880.00
Robinson Brothers Environmental, Inc 220 Raemisch Road Waunakee, WI 53597	\$8,900.00

CITY OF DODGEVILLE
BRUSH PILE GRINDING

Bidder Name and Address	Bid Amount
Dubuque Hardwoods 10492 Rt 52 S. Dubuque, IA 52003	\$21,250.00

- * Assumes 25 hours of grinding at \$650/hour and 25 loads hauled out at \$200 each
- * Billing will be based on actual hours of grinding. If less than 20 hours, there will be a \$1500 mobilization fee