



Public Safety & Court Committee  
Agenda

Wednesday, March 05, 2025  
1:00 PM

City Hall Annex - 135 W. Ellison,  
Suite 109, Second Floor  
Conference Room  
Burleson, TX 76028

1. **CALL TO ORDER**

2. **CITIZEN APPEARANCES**

Each person in attendance who desires to speak to the Committee on an item NOT posted on the agenda, shall speak during this section. A speaker card must be filled out and turned in to the City Secretary prior to addressing the Committee. Each speaker will be allowed three minutes to speak.

Each person in attendance who desires to speak on an item posted on the agenda shall speak when the item is called forward for consideration.

3. **GENERAL**

A. Consider and take possible action on the minutes from the November 6, 2024 Public Safety & Municipal Court Committee meeting. *(Staff Contact: Lisandra Leal, Assistant City Secretary)*

4. **REPORTS AND PRESENTATIONS**

A. Receive a report and provide possible recommendations regarding the future construction of Fire Station 4. *(Staff Contact: Casey Davis, Fire Chief)*

5. **REQUESTS FOR FUTURE AGENDA ITEMS OR REPORTS**

6. **ADJOURN**

**Casey Davis, Fire Chief**

*Burleson Fire/EMS Department*

*cdavis@burlesontx.com*

*phone: 817.426.9173*

**CERTIFICATE**

I hereby certify that the above agenda was posted on this the 26th of February 2025, by 5:00 p.m., on the official bulletin board at the Burleson City Hall, 141 W. Renfro, Burleson, Texas.



Amanda Campos

City Secretary

**ACCESSIBILITY STATEMENT**

The Burleson City Hall Annex is wheelchair accessible. The entry ramp is located in the front of the building, accessible from Warren St. Accessible parking spaces are also available in the Warren St. parking lot. Sign interpretative services for meetings must be made 48 hours in advance of the meeting. Call the A.D.A. Coordinator at 817-426-9600, or TDD 1-800-735-2989.

## Public Safety & Court Committee

**DEPARTMENT:** City Secretary's Office  
**FROM:** Lisandra Leal, Assistant City Secretary  
**MEETING:** March 5, 2025

---

**SUBJECT:**

Consider and take possible action on the minutes from the November 6, 2024 Public Safety & Municipal Court Committee meeting. *(Staff Contact: Lisandra Leal, Assistant City Secretary)*

**SUMMARY:**

The Public Safety & Municipal Court Committee duly and legally met on November 6, 2024 for a regular meeting.

**OPTIONS:**

- 1) Committee may approve the minutes as presented or approve with amendments.

**RECOMMENDATION:**

Approve.

**PRIOR ACTION/INPUT (Council, Boards, Citizens):**

N/A.

**FISCAL IMPACT:**

N/A.

**STAFF CONTACT:**

Lisandra Leal, TRMC  
Assistant City Secretary  
[lleal@burlesontx.com](mailto:lleal@burlesontx.com)  
817-426-9687

**PUBLIC SAFETY & MUNICIPAL COURT COUNCIL COMMITTEE**  
**NOVEMBER 6, 2024**  
**DRAFT MINUTES**

Council present:

Victoria Johnson, Chair  
 Alexa Boedeker  
 Larry Scott

Council Absent:Staff present via video conference

Tommy Ludwig, City Manager  
 Harlan Jefferson, Deputy City Manager  
 Eric Oscarson, Deputy City Manager  
 Monica Solko, Deputy City Secretary  
 Lisandra Leal, Assistant City Secretary  
 Billy Cordell, Police Chief

**1. CALL TO ORDER – Time: 11:00 am.**

Chair Victoria Johnson called the meeting to order. **Time: 11:00 a.m.**

**2. CITIZEN APPEARANCES**

- None.

**3. REPORTS AND DISCUSSION ITEMS**

**A. Consider approval of the minutes from the July 24, 2024 Public Safety & Municipal Court Committee meeting. (Staff Contact: Monica Solko, Deputy City Secretary)**

Motion made by Larry Scott and seconded by Alexa Boedeker to approve.

Motion passed 3-0.

*Chair Victoria Johnson announced that items 3B and 3C would be presented as one presentation.*

**B. Consider making a recommendation associated with a construction contract with RJM Contractors, Inc., to perform project construction of Fire Station #1 Living Quarters and Administrative Areas for \$4,350,861. Consider approval of owner furnished items for the Living Quarters and Administration Areas for \$458,138. (Staff Contact: Casey Davis, Fire Chief)**

Casey Davis, Fire Chief, presented the construction costs with RJM Contractors, Inc. to perform project construction of Fire Station #1 living quarters and

administrative areas to the committee. Discussion included project over with base proposal and alternatives, competitive bids with contract recommendation, and project funding.

### Base Proposal Includes:

- Living Quarters
- 9 Dorm Rooms and 3 Officer Quarters
- 5 Showers
- 6 Rest rooms
- ICC 500 Space – 182 S.F.
- Dayroom
- Kitchen
- Workout Area
- Patio

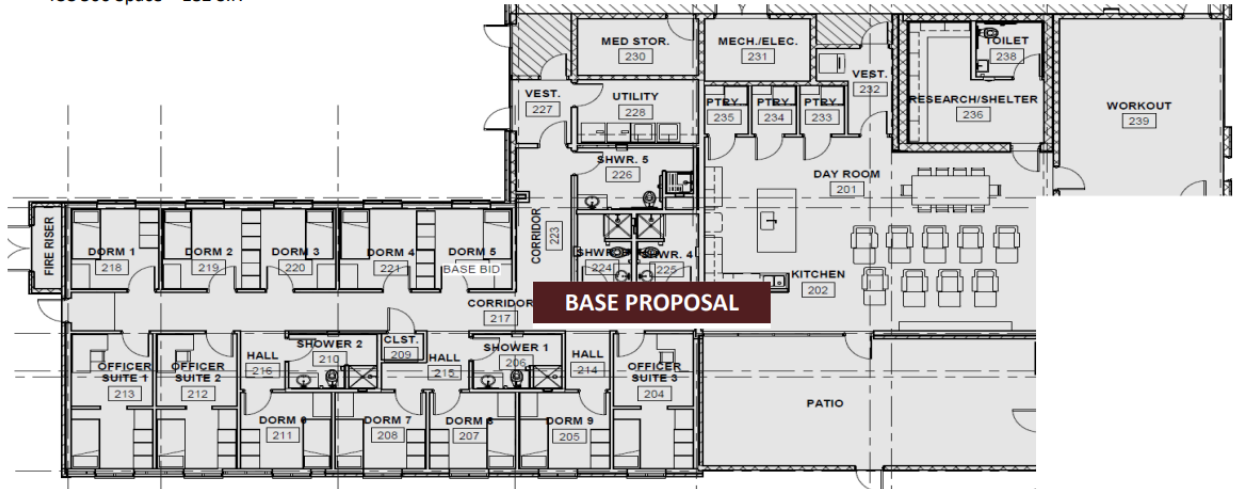

### Alternative #1 Includes:

- Chief's Office
- Assistant Chief Offices (2)
- 2 workspaces
- EMS Office
- Technology Room

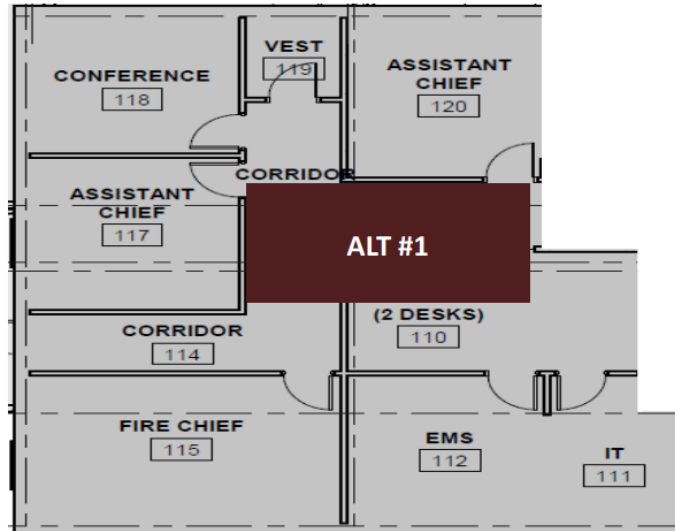

## Alternative #2:

- Fire Marshal
- Reception and Lobby Area
- 4 Workspaces
- Business Operations
- Breakroom
- Training Room
- Storage
- Restrooms

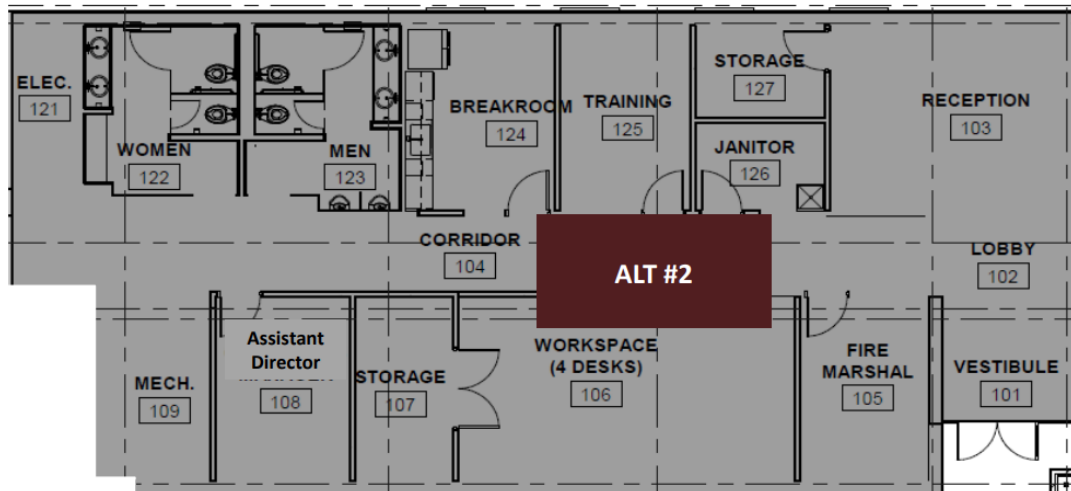

The committee was in favor of the base project to include alternate one and alternate two and asked that the item be brought forward to the full council.

- C. Consider making a recommendation associated with the purchase of two (2) Ford F550 4X4 Horton Type I Ambulances from Southern Emergency & Rescue Vehicle Sales through a cooperative agreement with Buyboard Vendor Contract #650-21 for \$832,660. (Staff Contact: Casey Davis, Fire Chief)**

Casey Davis, Fire Chief, presented the purchase of two (2) Ford F550 4x4 Horton Type I Ambulances to the committee.

The committee was in favor and asked that the item be brought forward to the full council.

### **RECESS AND BACK TO ORDER**

Chair Victoria Johnson recessed for a short break at 12:34 p.m. and called the meeting back to order at 12:43 p.m. with all members present.

*Chair Victoria Johnson announced that Item 3E would be presented ahead of item 3D.*

- E. Provide an update on the new CAD/RMS System, data center construction, and infrastructure enhancements to improve public safety operations. (Staff Contact: James Grommersch, Chief Technology Officer) - *MOVED***

James Grommersch, Chief Technology Officer, gave an update on the new CAD/RMS system, data center construction, and infrastructure enhancements to improve public safety operations. Discussion included timeline for implementation to new Enterprise CAD/RMS system, current work and next steps for the data center construction, and timeline for implementation for infrastructure enhancement for public safety.

The committee was happy with the update.

**D. Receive a report, hold a discussion, and provide staff feedback regarding updates from the Burleson Office of Emergency Management. (Staff Contact: Joe Laster, Emergency Operations Manager) - *MOVED***

Joe Laster, Emergency Operations Manager, gave an update on the Burleson Office of Emergency Management to the committee. Discussion included emergency operations center update, comprehensive emergency management plan update, additional annex development, Burleson ISD partnership, and hazard migration pan update.

The committee was in favor of presenting the report to the full council to help educate the community.

**4. BOARD REQUESTS FOR FUTURE AGENDA ITEMS OR REPORTS**

- None.

**5. EXECUTIVE SESSION**

In accordance with Chapter 551 of the Texas Government Code, the Committee may convene in Executive Session in the City Council Workroom at City Hall to conduct a closed meeting to discuss any item listed on this agenda.

- **Pending or Contemplated Litigation or to Seek the Advice of the City Attorney Pursuant to Section 551.071**

No executive session needed.

**6. ADJOURN**

Motion made by Alexa Boedeker and, seconded by Larry Scott to adjourn.

There being no further business, Chair Victoria Johnson adjourned the meeting. **Time: 1:05 p.m.**

---

Lisandra Leal  
Assistant City Secretary

---

**Public Safety & Court Committee**

**DEPARTMENT:** Fire/EMS

**FROM:** Casey Davis, Fire Chief

**MEETING:** March 5, 2025

---

**SUBJECT:**

Receive a report and provide possible recommendations regarding the future construction of Fire Station 4. (*Staff Contact: Casey Davis, Fire Chief*)

**SUMMARY:**

This memo outlines key considerations related to the projected construction of the Chisholm Summit housing development, the NFPA 1710 assembly and response time requirements, and the challenges associated with meeting these standards on the western side of the city.

As residential growth continues in this area, increased response times and current resource distribution present significant challenges in perusing and complying with NFPA 1710 standards, particularly regarding assembly time for fire suppression incidents and critical EMS calls, such as cardiac arrests. Rapid response from strategically located fire stations is critical to achieving the best possible outcomes, as prolonged travel times significantly increase risks to public safety.

Currently, the City relies on automatic and mutual aid from Johnson County ESD #1 to supplement fire and EMS response in this area. While this partnership is strong, and ESD #1 remains a willing and supportive partner, response times from outside agencies inherently take longer. Given the continued growth and increasing call volume, it is imperative that strategic planning is undertaken to determine the appropriate timing for Fire Station 4's development to ensure self-sufficiency and timely emergency response for both fire and EMS incidents.

This update will provide a comprehensive analysis of these factors and seek committee feedback on strategies to address these challenges while aligning with the City's Capital Improvement Plan (CIP).

**RECOMMENDATION:**

N/A

**PRIOR ACTION/INPUT (Council, Boards, Citizens):**

Bond Election May 7, 2022



**REFERENCE:**

CSO#1976-02-2022, CSO#1977-02-2022

**FISCAL IMPACT:**

N/A

**STAFF CONTACT:**

Casey Davis  
Fire Chief  
[cdavis@burlson.tx.com](mailto:cdavis@burlson.tx.com)  
817-426-9173



# Fire Station #4 Status and Review

---

Presented to: Public Safety Committee  
March 05, 2025

# Presentation Objectives

---

- Provide an **update** on Fire Station 4 planning and development.
- Outline **growth projections** and their impact on emergency response.
- Review **NFPA 1710 standards** and current response challenges.
- Discuss the **staffing, equipment, and infrastructure needs** for Station 4.
- Seek feedback on **timing, funding, and CIP integration** for construction.

**📌 Ensuring timely planning and development of Station 4 is critical to maintaining effective fire and EMS response as Burleson continues to grow.**

# West Side Burleson – Projected Growth

## Projected Growth & Timeline

### Chisholm Summit Development:

- 3,000 new homes planned
- Construction is set to begin with 50 homes in 2026
- Approx. 200 homes added per year there after.

### Impact on Emergency Services:

- Rising Fire/EMS Demand: Call volume increases by 94+ calls per year per 200 homes added. This **does not include** year-over-year percentage growth calculation.
- Longer response times if resources are not expanded.
- More strain on existing stations and resources.
- Increased Unit Hour Utilization (UHU) for both ambulance and fire responses due to the lack of dedicated services in this area.

# Why Station 4 is Critical for Burleson

---

## Key Challenges Without Station 4:

### Delayed Response Times:

- Current drive time: 11-15 minutes to west-side emergencies.

### Call Volume & Dependence on Mutual Aid:

- 160 calls per year in the Station 4 area.
- ESD automatic aid for structure fires but only mutual aid for EMS and all other call types.
- ESD does not desire to respond to Priority 3 EMS calls, leaving gaps in coverage.
- ESD current limit is around 400 calls for automatic/mutual aid a year.
- The ESD would consider a contract for services if annual call volume approaches 400 calls, but further discussions would be required to assess capacity and associated costs.

## How Station 4 Solves These Issues:

- **Cuts drive time significantly**, improving response time for life-threatening emergencies.
- **Increases local coverage**, reducing reliance on mutual aid.
- **Provides full EMS & fire services on the west side of the city.**
- **Ensures faster response to both high-priority EMS & fire incidents.**
- Adding **Station 4** not only enhances **west-side coverage** but also strengthens **NFPA 1710 assembly compliance citywide**, ensuring faster and more effective emergency response across all districts.

# West Side Burleson

---

## Why We Must Plan Now for a Fire Station on the West Side

### Current Target Hazards in the West Side

#### Joshua ISD Schools:

- RC Loflin Middle School
- Caddo Grove Elementary

#### Established Residential & Traffic Risks:

- Blue Bird Meadows Neighborhood
- Chisholm Trail Parkway & CR 1902

# Priority 3 EMS

---

A **Priority 3 EMS call** is a **non-life-threatening medical emergency** that requires an EMS response but does not involve **immediate danger to life or serious injury**. These calls typically include:

- Minor injuries (e.g., sprains, minor cuts, or abrasions)
- Illnesses without severe symptoms (e.g., mild fever, nausea, or minor allergic reactions)
- Welfare checks for non-critical patients
- Assist requests (e.g., lift assists for non-injured individuals)

 **Priority 3 calls are lower-acuity and do not require lights-and-sirens transport or immediate advanced life support (ALS) intervention.**

# Call Volume Projection Steps

---

### New Population:

- New homes × 2.72 (population multiplier)

### Estimated Call Volume:

- New population × 0.173 (calls per person per year)
- Add 160 current annual calls to total

### EMS & Priority 3 Calls:

- Total calls × 75% (EMS proportion)
- EMS calls × 60% (Priority 3 proportion)
- Priority 3 EMS = Burleson Fire/EMS responsibility (JCESD does not respond to P3 EMS)

### JCESD Expected Auto/Mutual Aid Response:

- Total calls minus Priority 3 EMS calls
- This projection does not account for the system's 19% call volume growth over the past five years, meaning actual demand may be even higher.



### 'Burleson Calls Priority 3'

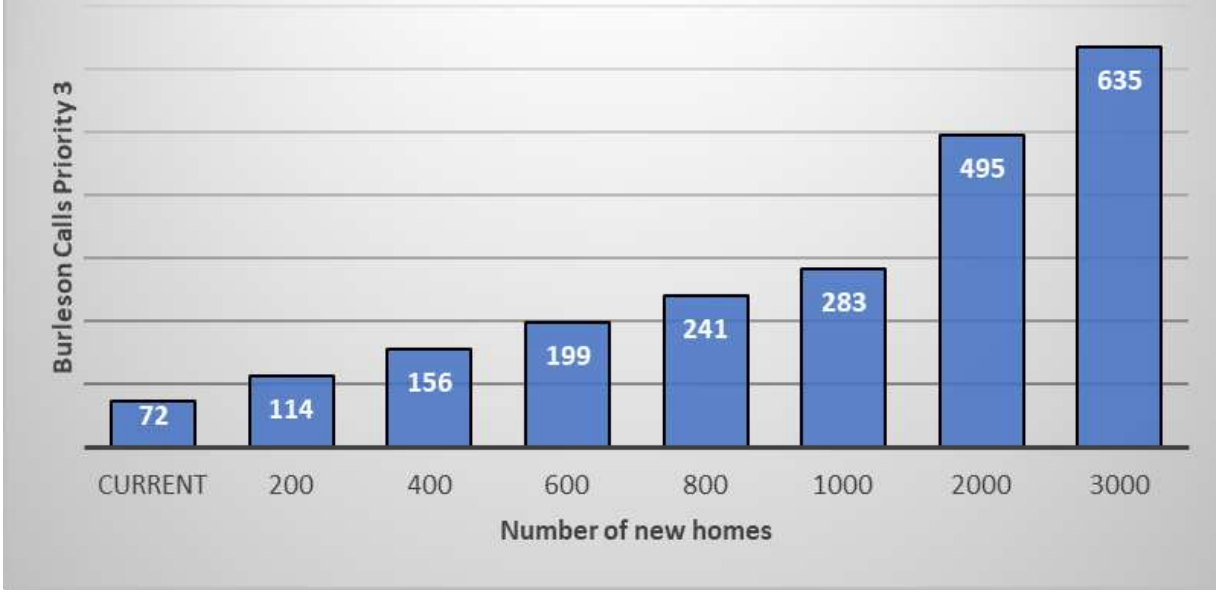

ESD does not desire to respond to Priority 3 EMS calls

### 'JCESD ≥ Priority 3'

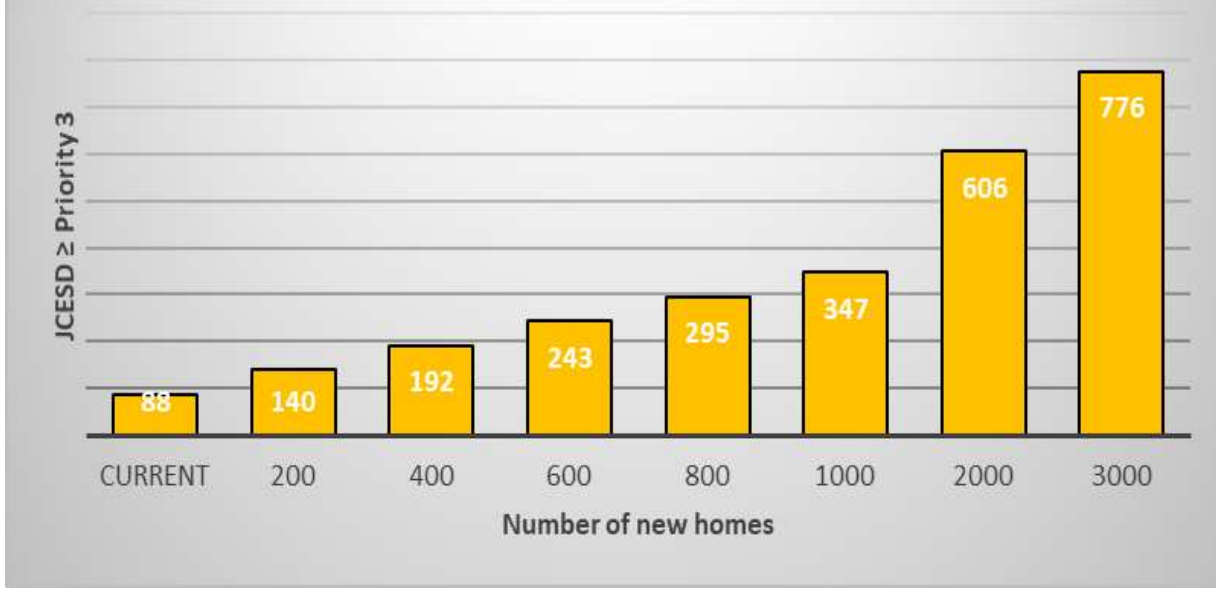

Burleson Fire/EMS will respond to all calls for service, with JCESD serving as the primary first-arriving unit for **Priority 1 and Priority 2** incidents.

# Projected Chisolm Summit Development Doors

This projection does not account for the system's 19% call volume growth over the past five years, meaning actual demand may be even higher.

# Minimum Daily Staffing

---

## Current Staffing & Coverage (Before Station 4 or 4th Ambulance)

- Minimum daily staffing 17 personnel
- Response coverage gap on the west side of the city
- Longer response times to incidents in growing areas
- 💡 Challenge: Limited coverage on the west side increases response time for critical emergencies.

## Deploying a 4th Ambulance Before Station 4 Opens

- Minimum Daily Staffing 19 personnel
- Rising EMS call volume and UHU will strain resources and impact response times before Station 4 is completed.
- 💡 Solution: Adding a 4th ambulance improves citywide response, reduces unit fatigue, and ensures faster, more effective EMS care.

## Improved Staffing & Coverage (After Station 4)

- Minimum daily staffing 23 personnel
- Balanced coverage across the city, including the west side
- Faster response times for Fire & EMS
- Better resource allocation for simultaneous incidents
- 💡 Solution: Station 4 ensures equal emergency services across all areas, improving safety and reducing response times.

# Station 4 Deployment Plan

---

## Initial Station Opening:

- Engine Company – Minimum 4-person staffing
- Brush Truck – Cross-staffed with available personnel
- Reserve Engine Company
- The fourth bay provides housing capacity for the MCI trailer and Heavy Rescue unit, improves long-term apparatus space planning across all stations, and replaces the lost bay at Station 1.

## Full Station Build-Out Plan:

- Engine Company – Minimum 4-person staffing
- Ladder Company – Minimum 4-person staffing
- Ambulance – Minimum 2-person staffing
- Battalion 2 – Minimum 1-person staffing
- Brush Truck – Cross-staffed with existing crews
- Reserve Engine Company

**Ⓜ The phased approach ensures operational readiness at opening, with strategic growth planned to enhance emergency response capabilities.**

## NFPA 1710 Standard for the Organization and Deployment of Fire Suppression Operations, Emergency Medical Operations, and Special Operations to the Public by Career Fire Departments

---

### Engine Companies (5.2.3.1)

- **Primary Functions:**
  - Pump and deliver water.
  - Perform basic firefighting operations.
  - Conduct search and rescue.
- **Minimum Staffing Requirement (5.2.3.1.1):**
  - **4 on-duty members** per engine company.
  - Burleson Fire/EMS staffs a minimum 3 on-duty members per Engine company.

### Ladder/Truck Companies (5.2.3.2)

- **Primary Functions:**
  - Forcible entry
  - Ventilation
  - Search and rescue
  - Aerial operations (water delivery & rescue)
  - Utility control
  - Illumination
  - Overhaul and salvage work
- **Minimum Staffing Requirement (5.2.3.2.1):**
  - **4 on-duty members** per ladder/truck company.
  - Burleson Fire/EMS staffs a minimum 4 on-duty members per Ladder/Truck company.

# NFPA 1710: First-Due Response Objectives

---

- Turnout Time: 80 sec (1 min 20 sec) for fire/special ops, 60 sec (1 min) for EMS
- Fire Response: First engine travel time ≤ 240 sec (4 min), second company travel time ≤ 360 sec (6 min)
- Full Alarm Assignment: ≤ 480 sec (8 min) for non-high-rise, ≤ 610 sec (10 min 10 sec) for high-rise
- EMS Response: First responder (AED/BLS) travel time ≤ 240 sec (4 min), ALS unit (Ambulance) travel time ≤ 480 sec (8 min)

🕒 Meeting NFPA 1710 ensures faster, more effective emergency response.



# NFPA 1710 Full Alarm Assignment for a Structure Fire (5.2.4.1.1)

For a 2,000 sq. ft., two-story single-family dwelling

Item A.

## Incident Command:

- **1 member** dedicated to overall coordination outside the hazard area.

## Water Supply & Application:

- **400 GPM (minimum) uninterrupted water supply** for 30 minutes, maintained by **1 operator**.
- **300 GPM fire attack rate** using **two handlines** (minimum **100 GPM each**), each operated by **2 members (total: 4 members)**.

## Support & Fireground Operations:

- **2 members** for hydrant hookup, hose line deployment, utility control, and forcible entry.
- **2 members** for victim search and rescue.
- **2 members** for ground ladder operations and ventilation.
- **1 aerial operator** (if an aerial device is used).

## Rapid Intervention Crew (RIC):

- Initial IRIC assembled from the first attack crew.
- **Full RIC established** as more resources arrive (**4 members**).

## Total Effective Response Force:

- **Minimum: 16 members**
- **17 members** if an aerial device is used
- **Burleson Fire/EMS Minimum Daily staffing 17 members**

# NFPA 1710 Open-Air Strip Shopping Center – Initial Full Alarm Assignment (5.2.4.2)

## Response Requirements for Structure Fires (13,000 – 196,000 sq. ft.)

**Incident Command & Safety:**

- **2 members** dedicated to overall coordination and safety outside the hazard area.

**Water Supply & Application:**

- **Two uninterrupted water supplies** at a minimum of **500 GPM**, each maintained by **1 operator (2 members)**.
- **500 GPM fire attack rate** using **three handlines** (minimum **150 GPM each**), each operated by **2 members (total: 6 members)**.

**Support & Fireground Operations:**

- **3 members** for hydrant hookup, hose deployment, utility control, and forcible entry.
- **4 members** for **search and rescue** (two teams of two).
- **4 members** for **ground ladder operations & ventilation** (two teams of two).
- **1 aerial operator** (if an aerial device is used).

**Rapid Intervention Crew (RIC):**

- Initial **IRIC from the first attack crew**.
- **Full RIC established** as more resources arrive (**4 members**).

**Emergency Medical Component:**

- **2 members** for immediate on-scene EMS and patient transport.

**Total Effective Response Force:**

- **Minimum: 27 members**
- **28 members** if an aerial device is used
- **Burleson Fire/EMS Minimum Daily staffing 17 members**

# NFPA 1710 Apartment Fire – Initial Full Alarm Assignment (5.2.4.3)

## Response Requirements for a 1,200 sq. ft. Apartment in a Three-Story Garden-Style Building

### Incident Command & Safety:

- **2 members** dedicated to coordination and safety outside the hazard area.

### Water Supply & Application:

- **Two uninterrupted water supplies** at a minimum of **400 GPM**, each maintained by **1 operator (2 members)**.
- **300 GPM fire attack rate** using **three handlines** (minimum **100 GPM each**), each operated by **2 members (total: 6 members)**.

### Support & Fireground Operations:

- **3 members** for hydrant hookup, hose deployment, utility control, and forcible entry.
- **4 members** for **search and rescue** (two teams of two).
- **4 members** for **ground ladder operations & ventilation** (two teams of two).
- **1 aerial operator** (if an aerial device is used).

### Rapid Intervention Crew (RIC):

- Initial IRIC from the first attack crew.
- **Full RIC established** as more resources arrive (**4 members**).

### Emergency Medical Component:

- **2 members** for immediate on-scene EMS and patient transport.



### Total Effective Response Force:

- **Minimum: 27 members**
- **28 members** if an aerial device is used
- **Burleson Fire/EMS Minimum Daily staffing 17 members**





# The Critical 10-Minute Life or Death Window

## Structure Fire Growth (Time vs. Fire Spread)

-  A room igniting and fully engulfed over 10 minutes.
- **0-2 minutes:** A fire starts, small and controllable.
- **3-4 minutes:** Flashover potential begins.
- **5-7 minutes:** Fire spreads rapidly, escape becomes difficult.
- **8-10 minutes:** Flashover occurs, entire room is engulfed, survivability is **near zero**.
-  **Fact: After 10 minutes, survivability in a structure fire is almost nonexistent due to heat, smoke, and oxygen depletion.**

## Cardiac Arrest (Time vs. Survival Rate)

-  A timeline showing survival rates decreasing over time.
- **0-4 minutes: 50-70% survival** with CPR & defibrillation.
- **5-6 minutes: 25-30% survival** if no CPR is started.
- **7-10 minutes: Less than 10% survival** without immediate medical intervention.
-  **Fact: After 10 minutes without defibrillation, survival is nearly zero**

# Burleson Fire/EMS Assembly Objectives

## Burleson's Challenges & Goals Current Challenges:

- **All on-duty personnel must be available** to assemble for a structure fire.
- **High call volume and competing incidents** limit the ability to assemble personnel quickly.
- **Mutual aid is valuable**, but response times from aid partners are longer, delaying assembly in the critical early minutes.

## Burleson Fire/EMS in pursuit of NFPA 1710

- **Goal < 7-minute drive time** for the first unit on scene 90% of incidents.
- **Minimum staffing of 23 to provide Station 4 and a 4th Ambulance with staffing**
- **Proper assembly time** is crucial for a coordinated attack on structure fires and critical medical emergencies.

## Burleson's Strategy for Improvement:

- **Increase minimum staffing** to meet proper assembly times.
- **Strategically locate fire stations** (e.g., Station 4) to improve response coverage.
- **Enhance self-sufficiency** by reducing dependence on mutual aid for initial response.
- **Ensure quicker, more effective fire suppression and EMS Care** within NFPA 1710 standards.

# Current Situation

Item A.

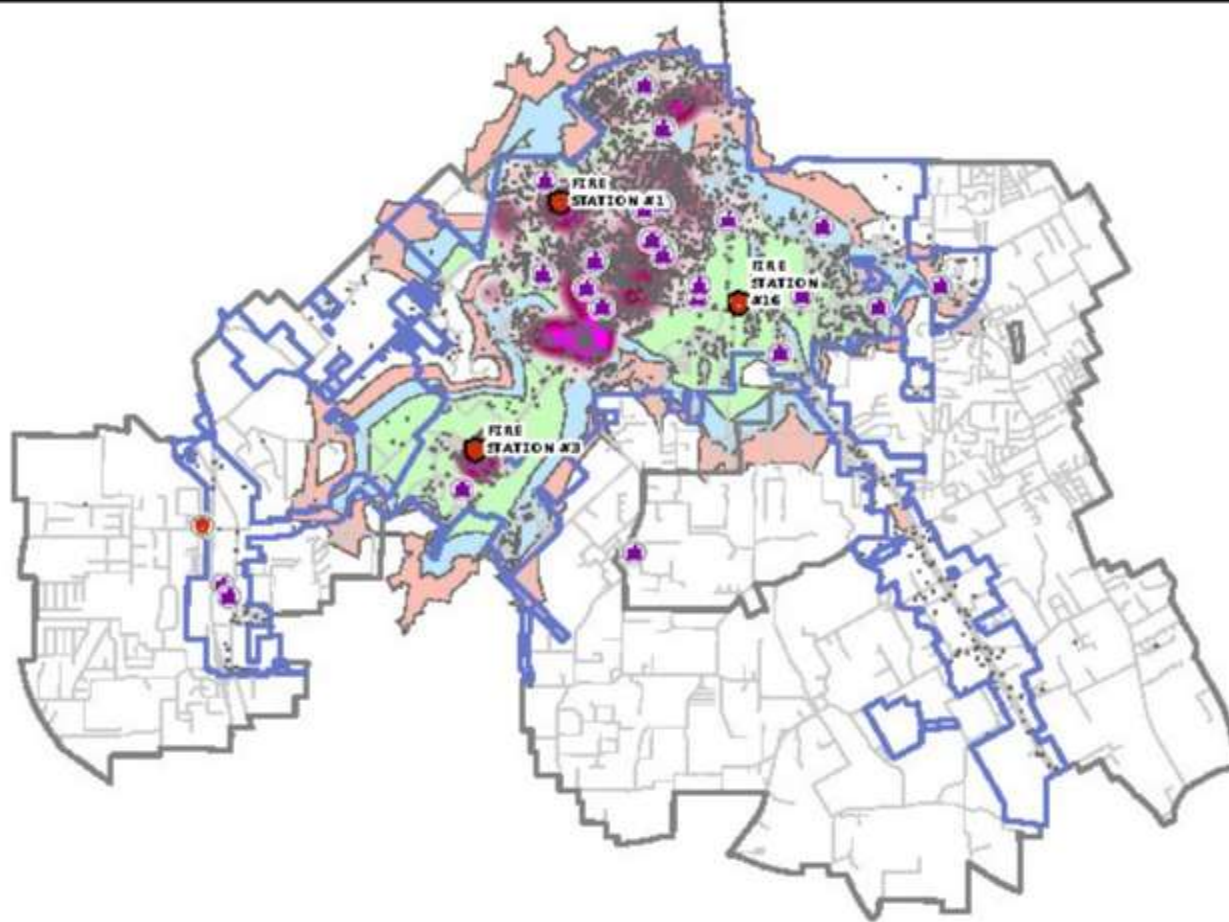

- Existing Fire Stations
- Schools
- Johnson County ESD
- City Limit
- ETJ
- Street Centerline
- All Calls (last 365 days)
- Fire Incidents Heat Map (All calls last 365 days)
  - Sparse
  - Dense
- Current Response Times
  - 0-3 Minutes
  - 3-4 Minutes
  - 4-5 Minutes

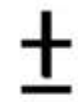

# Fire Station 4 Response Times

Item A.

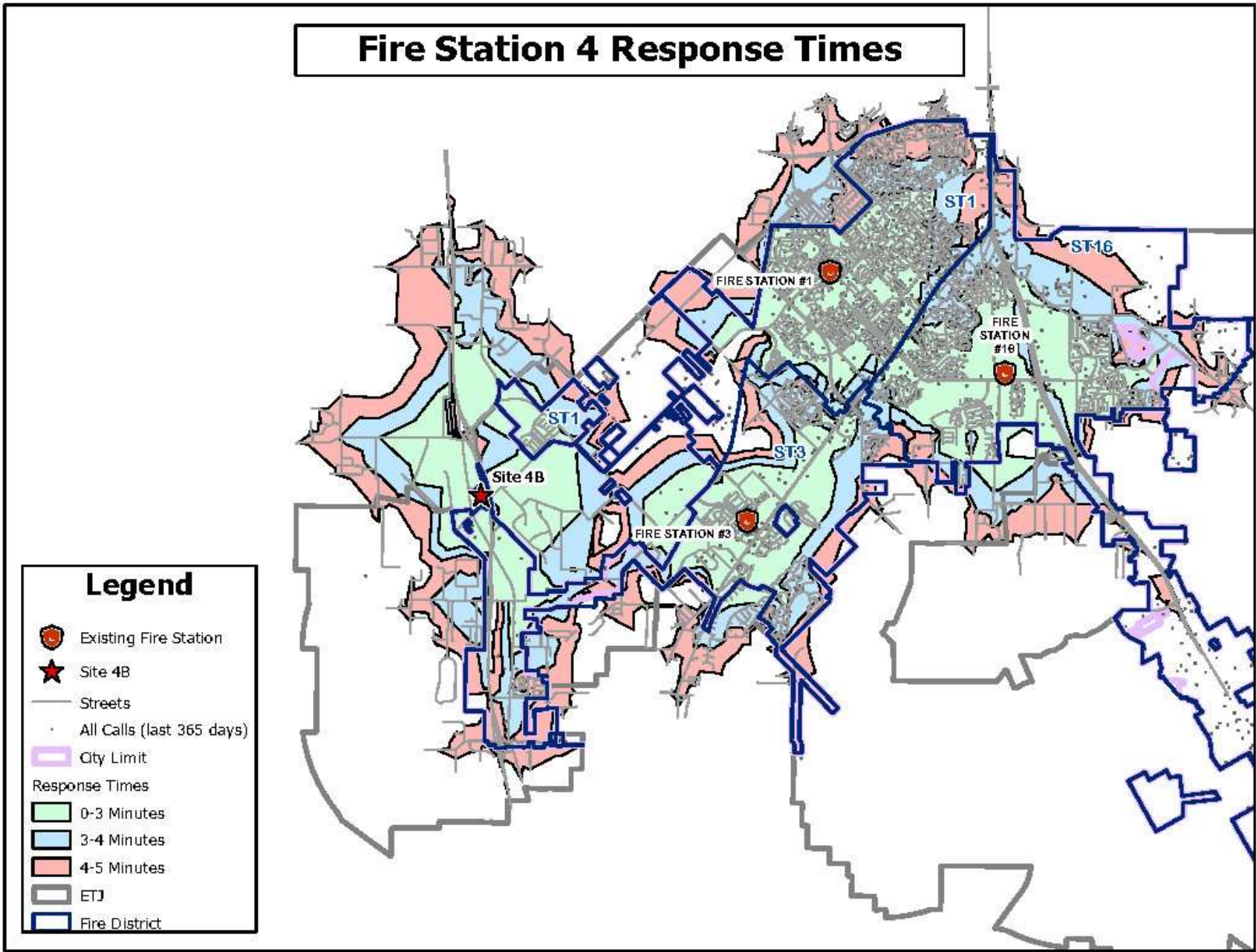

## Public Safety Facilities

Burleson voters approved Proposition B for \$52,360,000 during the May 7 special bond election.  
BRW Station 4 Cost estimation \$15,943,000.00

---

### Fire Station 4 Construction

#### Background

- The city of Burleson currently has three fire stations and none are located on the city's western border.
- The construction of Fire Station 4 would provide fire and emergency medical services to the western portion of the city in a manner that meets safety and response criteria for the citizens and firefighters based on National Fire Protection Association (NFPA), Texas Commission on Fire Protection best practice standards.
- In 2021, a feasibility study was conducted to review fire station needs.
- The Special Citizens Advisory Bond Committee considered fire department needs and options for a new station.
- The committee unanimously recommended the proposed fire station on the 2022 Bond Election ballot.



#### Bond Project

##### Proposed Fire Station 4 consists of:

- Construction of a 18,944 square foot, four-bay fire station on the western portion of Burleson.
- Living quarters for 11 fire personnel.
- Storm Shelter.
- Training room.
- Community engagement space.
- An office for Burleson Police Department.

# Comparative Cities – Citizens per Station

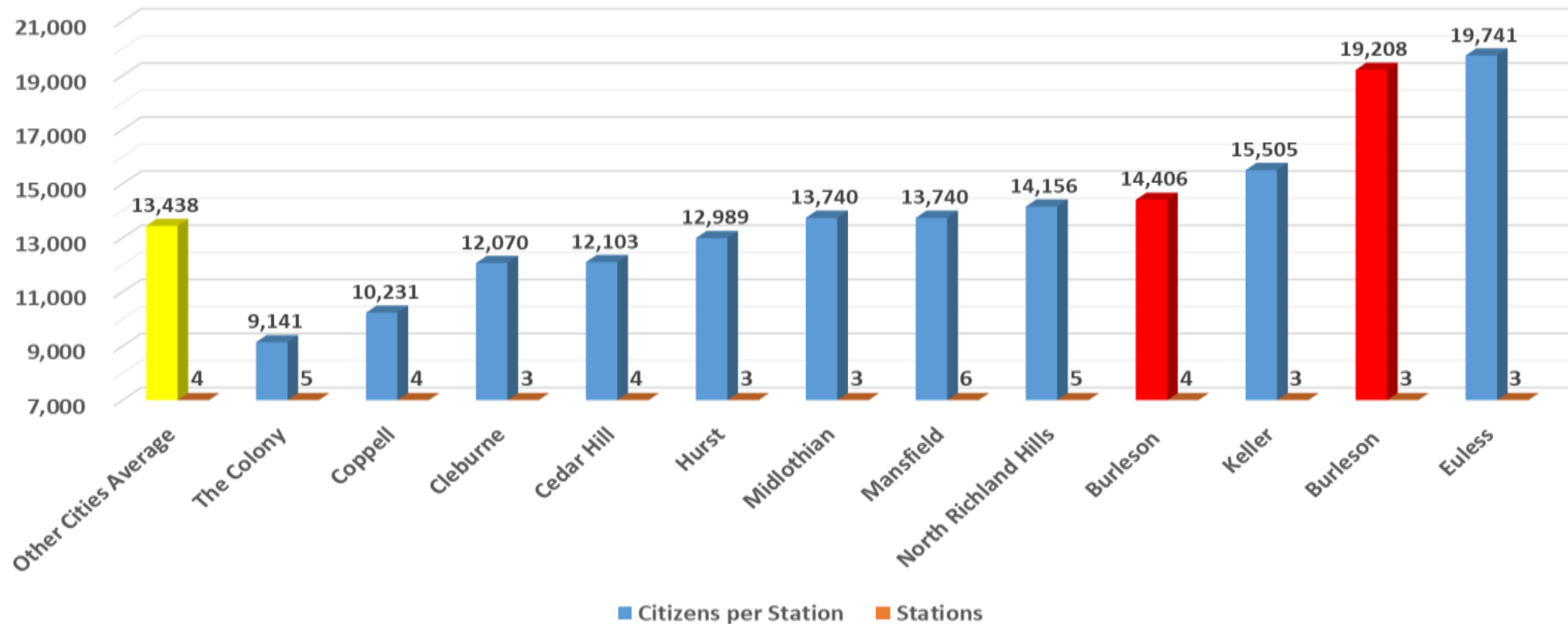

The Euless Fire Department stands out as an outlier in citizens per station compared to peer cities. Their 2024 call volume of 6,428 is 42.5% lower than Burleson's 9,150 calls. Additionally, Euless covers 16.3 square miles, whereas Burleson spans 28.26 square miles, further highlighting the unique operational demands on our system.

# System Changes & Needs with the Addition of Station 4

---

## Ladder Tower Purchase & Placement

- A new Tower Ladder truck will be purchased to enhance aerial firefighting and rescue capabilities.
- Since Station 4 is located in the county area, the Tower Ladder will be stationed at Station 1 to better serve the city core.
- This restores bucket capabilities previously lost in recent years.

## Engine & Ambulance Deployment Adjustments

- An engine will be relocated to Station 4 to ensure fire/EMS coverage in the expanding west side.
- The 4th ambulance will be double-company at Station 1, reducing excessive back-and-forth movement across the city and improving EMS efficiency.

## Minimum Staffing at Station 4

- Engine 4 will be staffed with a guaranteed 4-person crew, including one dedicated position as a firefighter/paramedic to maintain advanced EMS response capabilities.

# Proposed Staffing for Engine 4 & 4th Ambulance Cost Estimation

---

### Engine 4 Staffing:

- 1 Lieutenant
- 1 Engineer
- 1 Firefighter/EMT
- 1 Firefighter/Paramedic

### 4th Ambulance Staffing:

- 1 Firefighter/Paramedic
- 1 Firefighter/EMT

### Cost Breakdown:

- **Average cost per position: \$123,261.10** (*Includes base salary & benefits, with no additional certification pay beyond known paramedic pay*).
- **Staffing multiplier: 3.5 per position** (*Covers three shifts + time off relief*).
- **Total FTEs required: 21 (Engine:  $4 \times 3.5 = 14$  | Ambulance:  $2 \times 3.5 = 7$ )**
- *Total annual Ambulance cost: \$862,827.70*
- *Total annual Engine cost: \$1,725,655.40*
- **Total annual staffing cost: \$2,588,483.10**

 **Note:** Salary estimates are based on **current rates** and do not account for **future cost escalations**, including **COLA adjustments, step plan increases, additional certification pay, overtime variations, or FLSA impacts**. Actual costs may increase over time and require future budget adjustments.



# Alternative Fire & EMS Coverage Amid Budget Constraints

---

With upcoming CIP and operational constraints, the CMO has requested the Fire Department to explore alternative solutions to ensure emergency coverage in the growing west side of Burleson.

## Strengthen Collaboration with Johnson County ESD #1

- ✓ **Automatic Aid Expansion** – Increase **pre-designated responses** for high-priority incidents.
- ✓ **Mutual Aid Agreements** – Ensure consistent **resource sharing** without long-term financial commitments.
- ✓ **Contract for Services** – Evaluate a **formal contract** with ESD for interim response coverage if **call volume approaches 400+ annually**.

## Establish a Pre-Construction Presence

- ✓ **Responding from ESD Facilities** – Explore **staging a Burleson unit** at an ESD station to reduce response times.
- ✓ **Utilize the Training Division Fire Academy** – **Station personnel temporarily** at the Fire Academy to provide **limited emergency response** coverage in the area.

### Current CIP Timeline for Station 4

Year	Milestone
2025	<ul style="list-style-type: none"><li>• Confirm land use &amp; conduct Council presentations.</li><li>• Reassess timeline with Council in CIP discussions.</li></ul>
2026	<ul style="list-style-type: none"><li>• Plan operational staffing needs as design is set begin in 2027.</li><li>• A phased hiring plan will need to be implemented.</li></ul>
2027	<ul style="list-style-type: none"><li>• Select architect &amp; construction team.</li><li>• Begin pre-construction planning.</li></ul>
2028	<ul style="list-style-type: none"><li>• Finalize architectural plans.</li><li>• Order apparatus (Ladder Tower &amp; Brush Truck).</li></ul>
2029	<ul style="list-style-type: none"><li>• Begin construction.</li></ul>
2030	<ul style="list-style-type: none"><li>• Apparatus delivered.</li><li>• Station 4 opens; construction completed.</li></ul>

# Additional Needs Concurrent with Station 4 Implementation

### 4th Ambulance Staffing

- Several staffing models to consider, ranging from peak-time staffing to full 24-hour staffing, ensuring resources align with demand and operational efficiency.

### Fire Inspector / Investigator

- Fire inspections are primarily conducted by crews, creating conflicts with operational duties and training time. A dedicated inspector will improve efficiency, compliance, and fire prevention efforts.

### Lieutenant for Training

- The training office is overwhelmed with no dedicated support. A Training Lieutenant is essential to deliver training to crews, maintain operational readiness, and ensure compliance with evolving fire and EMS standards.

### Deputy Emergency Manager

- The Emergency Management Office lacks redundancy and additional staff to handle increasing workload demands.
- A Deputy Emergency Manager is needed to support disaster preparedness, emergency response coordination, and continuity of operations as the city's risk profile grows.

# Council Feedback on Key Considerations for Station 4 & EMS Expansion

Timing & Funding	Alternative Coverage Solutions	Operational Impact
<ul style="list-style-type: none"><li>• <b>Prioritize funding decisions</b> to align with <b>CIP constraints</b> and long-term financial planning.</li><li>• <b>Refine the operational budget</b> to support a <b>phased staffing approach</b> that meets service demands.</li><li>• <b>Avoid funding delays</b>, as <b>station design, construction, and phased hiring</b> require approximately <b>3.5 years</b> for full implementation.</li></ul>	<ul style="list-style-type: none"><li>• <b>Explore automatic/mutual aid agreements</b> and <b>interim coverage contract options</b> with ESD to enhance service reliability.</li><li>• <b>Assess feasibility</b> of <b>staging personnel</b> at the <b>Fire Academy or an ESD facility</b> to improve response times.</li><li>• <b>Avoid long-term reliance on outside agencies</b>—work toward self-sufficiency.</li></ul>	<ul style="list-style-type: none"><li>• <b>Initiate staffing and resource planning</b> to maintain adequate emergency response.</li><li>• <b>Phase in additional personnel and apparatus</b> to match increasing call volume.</li><li>• <b>Plan for long-term growth</b>, ensuring sustainability beyond initial staffing and equipment.</li><li>• <b>Continue strategic planning for concurrent Fire Department needs</b> to support overall operations.</li></ul>



Questions or Comments?